

SUMMARY OF LANDSCAPE AND DRAINAGE QUANTITIES

SHEET TITLE

DRAINAGE PLAN - LIMIT OF WORK L1
 LANDSCAPE PLAN L2
 PLANTING DETAILS L3

QTY.	UNIT	KEY	BOTANICAL NAME	COMMON NAME	FURNISH	REMARKS
------	------	-----	----------------	-------------	---------	---------

Plant Materials

10	EA	RK	<i>Rosa 'Knock Out'</i>	Knock Out Rose	#3 Cont.	4' O.C.
16	EA	MC	<i>Muhlenbergia Capillaris</i>	Pinl Muhly Grass	#3 Cont.	3' O.C.
24	EA	IV	<i>Ilex Vomitoria 'Nana'</i>	Dwarf Yaupon Holly	#3 Cont.	3' O.C.
42	EA	LM	<i>Liriope muscari 'Varigata'</i>	Varigated Liriope	#1 Cont.	1' O.C.

Descriptions

8	CY	1670	Mulch for Planting			See Site Work
7	CY	SP	River Rock			See Site Work
70	SY	1670	Post Emergence Plant Bed Herbicide Treatment			
70	SY	1670	Pre Emergence Plant Bed Herbicide Treatment			
100	SY	SP	Supplemental Seeding & Repairing			
4	MG	1670	Water for Planting			4000 Gallon Total
150	LF	SP	Steel Edging			See Site Work
200	LF	SP	Tree Protection Fence			See Site Work
1	Lump Sum	SP	Yard Inlets Channel Drain			See Site Work
1	Lump Sum	SP	French Drain			See Site Work
5	EA	SP	Large Boulder			See Site Work
5	EA	SP	Medium Boulder			See Site Work
5	CY	SP	Topsoil			
1	Lump Sum	1650	Selective Tree Removal And Replacement			



W.S. ARCHITECTS, PA
 2305-109 DUNSMON DRIVE
 RALEIGH, NORTH CAROLINA 27608
 919.772.9797
 www.wsarchitectspa.com

Project Title
BRUNSWICK CTY. REST AREA-RENOV.
 US 17 AT NC 130 SHALLOTTE, NORTH CAROLINA

SHEET DESCRIPTION:

PLOT DATE: 6/14/2023

REVISION:

PROJECT DESIGNER:

AZAD ATASHI, RLA

DRAWING TITLE

COVER SHEET

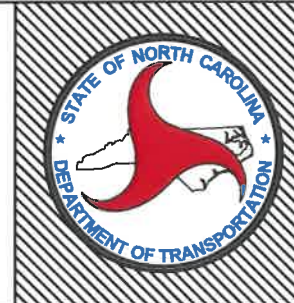

SCO I.D.# 21-24079-01A

PROJECT#

SHEET NO : TOTAL SHEET NO :

0

3

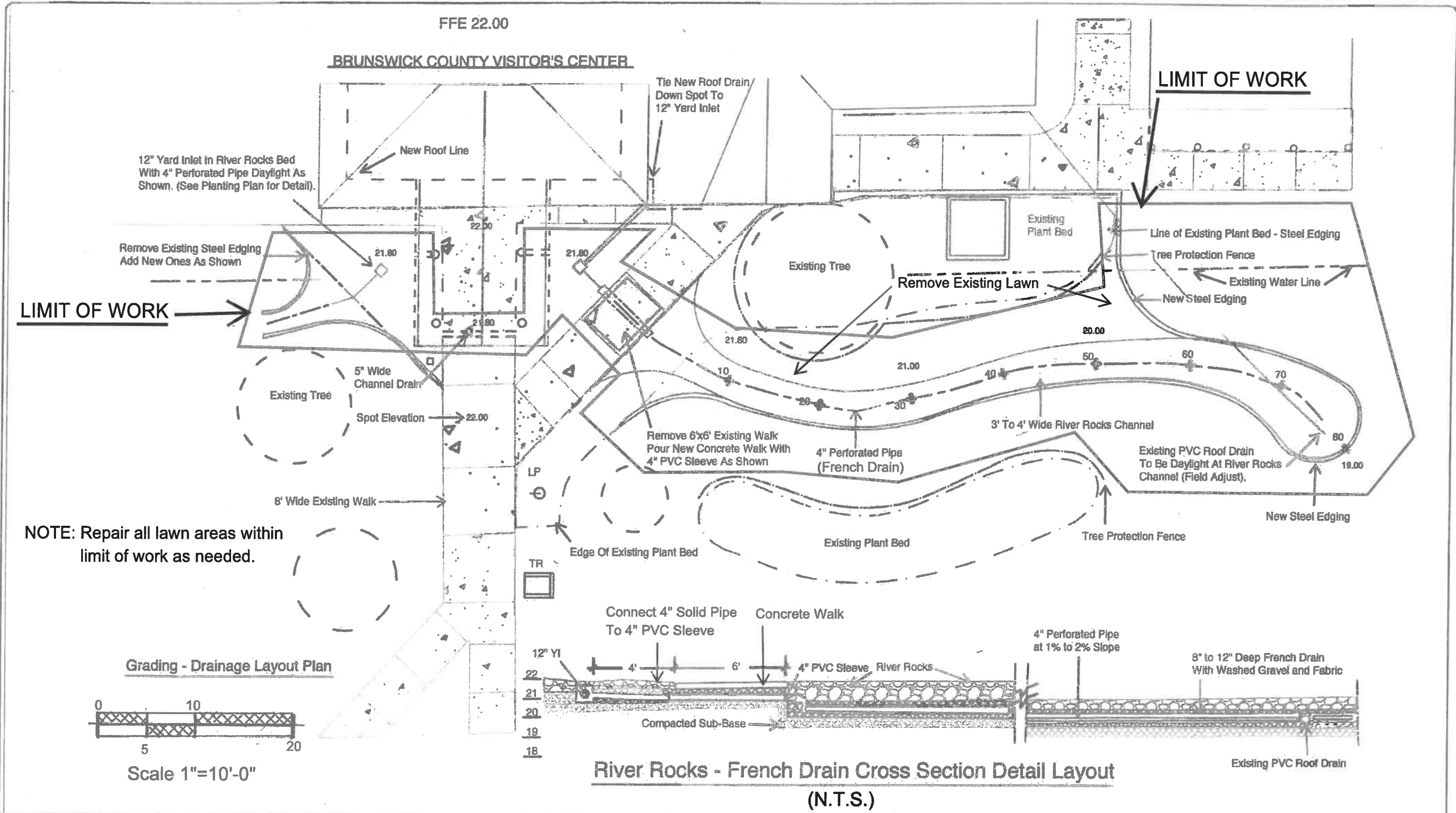

Project Title
BRUNSWICK CTY. REST AREA-RENOV.
 US 17 AT NC 130 SHALLOTTE, NORTH CAROLINA

SHEET DESCRIPTION:

PLOT DATE: 6/14/2023

REVISION: —

PROJECT DESIGNER:
 Azad Atashi, RLA

DRAWING TITLE
DRAINAGE PLAN
LIMIT OF WORK

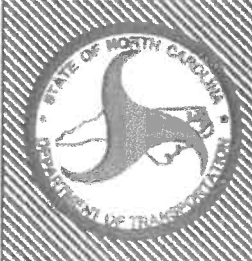

SCO I.D.# 21-24079-01A

PROJECT# —

SHEET NO. : L1 **TOTAL SHEET NO. :** 3

BRUNSWICK COUNTY VISITOR'S CENTER

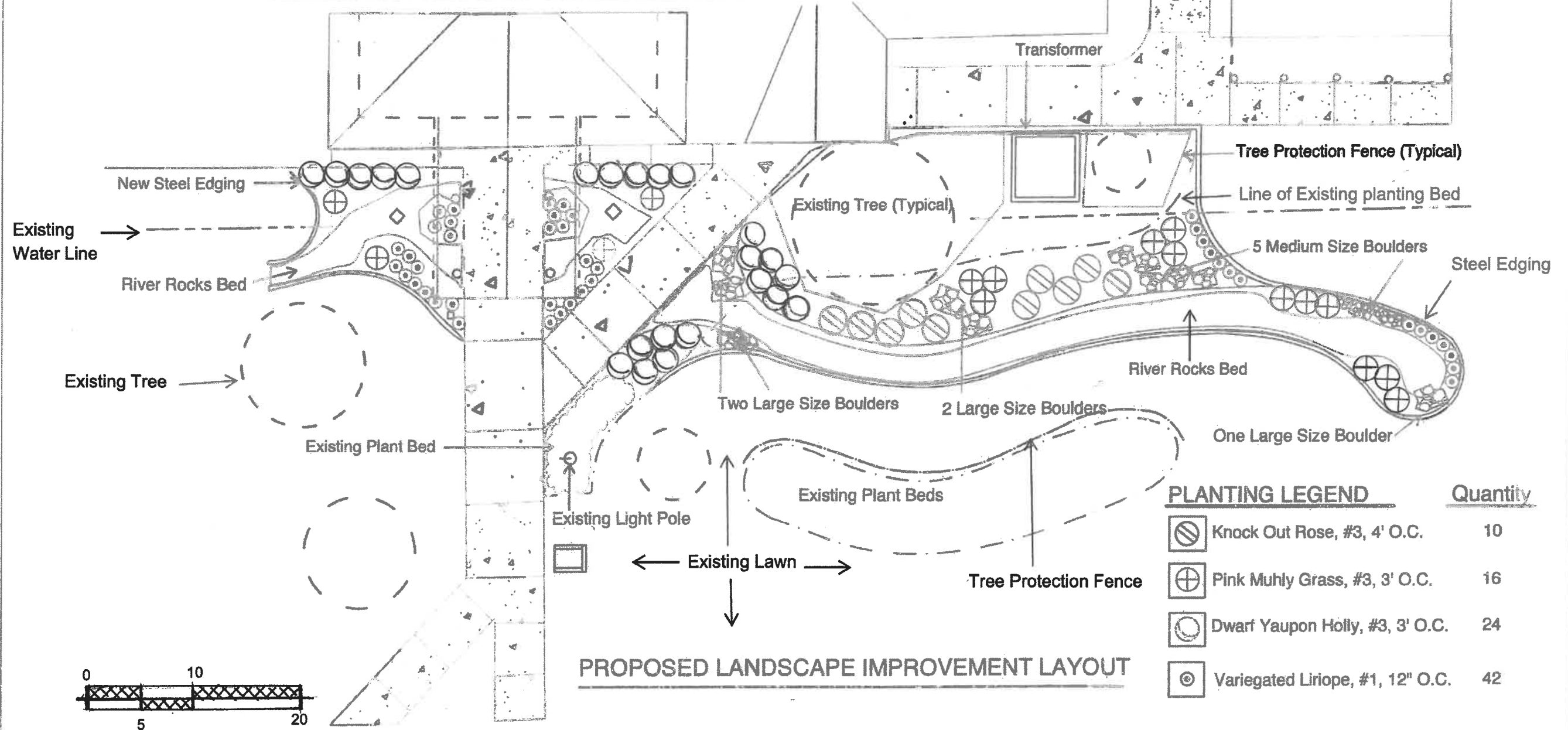

PLANTING LEGEND		Quantity
	Knock Out Rose, #3, 4' O.C.	10
	Pink Muhly Grass, #3, 3' O.C.	16
	Dwarf Yaupon Holly, #3, 3' O.C.	24
	Variegated Liriope, #1, 12" O.C.	42

PROPOSED LANDSCAPE IMPROVEMENT LAYOUT

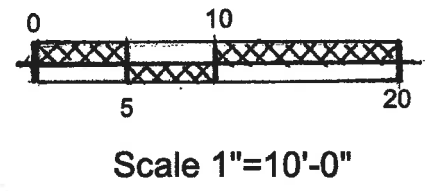

Project Title
BRUNSWICK CTY. REST AREA-RENOV.
 US 17 AT NC 130 SHALLOTTE, NORTH CAROLINA

SHEET DESCRIPTION:
 PLOT DATE: **6/14/2023**
 REVISION: **-**
 PROJECT DESIGNER:
Azad Atashi, RLA

DRAWING TITLE
LANDSCAPE PLAN

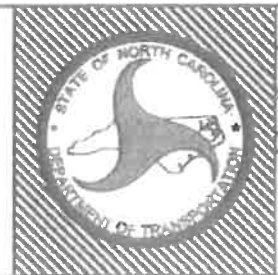

SDO I.D.# **21-24079-01A**
 PROJECT# **-**
 SHEET NO. **L2** / TOTAL SHEET NO. **3**

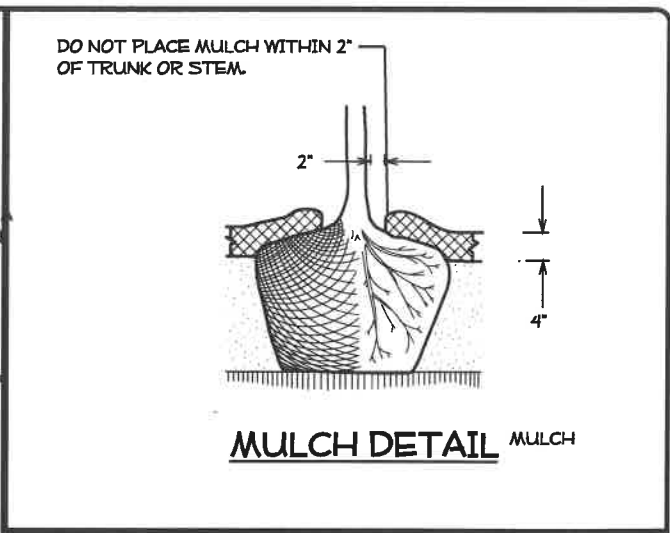
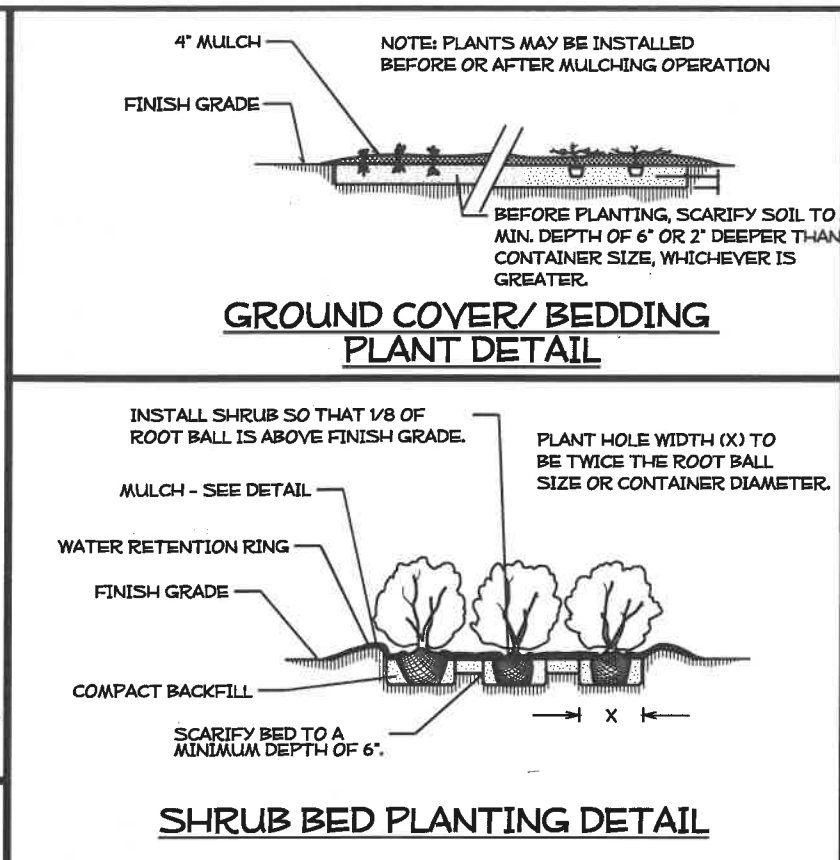
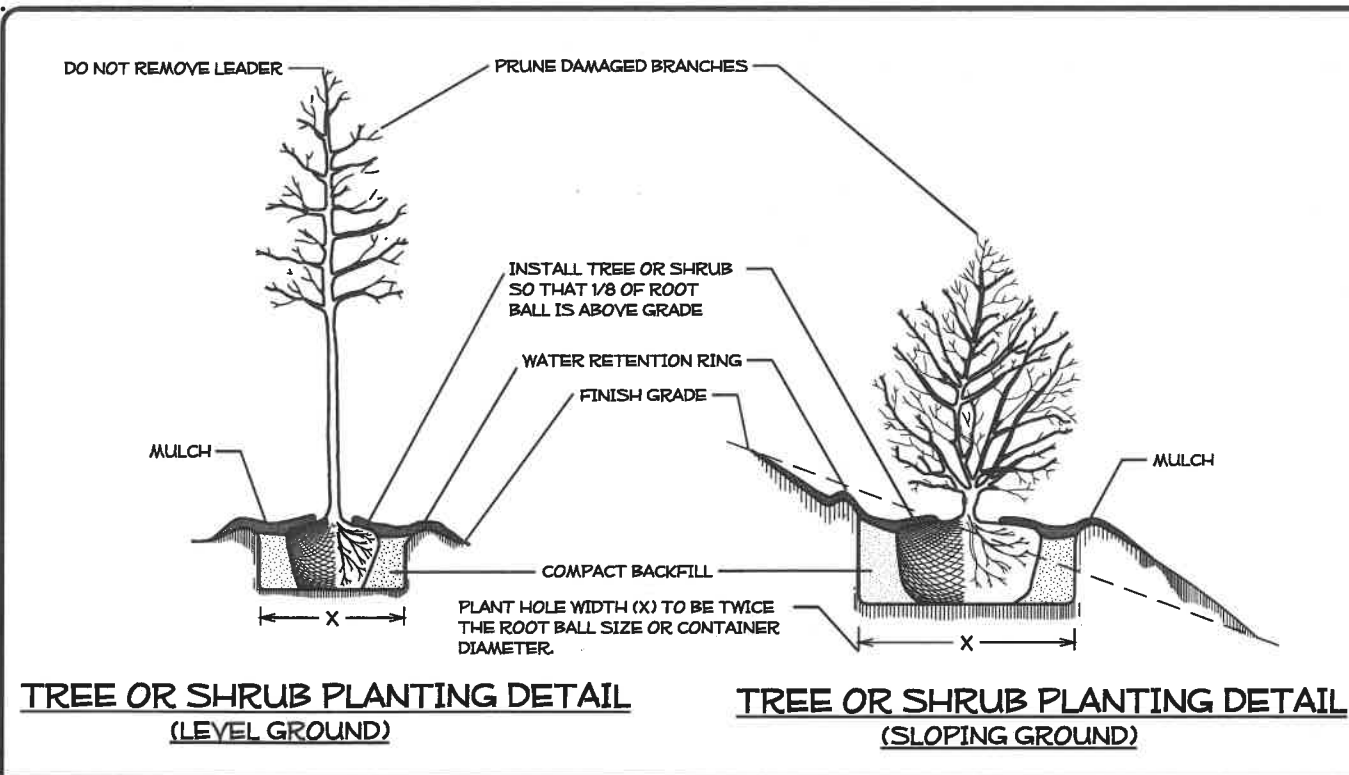

- NOTES:**
- SCHEDULE FOR PLANT HOLE SIZE: PLANT HOLE WIDTH (X) TO BE TWICE THE ROOT BALL SIZE OR CONTAINER DIAMETER.
 - SEE STANDARD SPECIFICATIONS FOR PLANT BED FUMIGATION AND HERBICIDAL TREATMENT.
 - APPLY FERTILIZER AT PLANTING TIME IN THE FORM OF A SLOW RELEASE PELLET OR TABLET. APPLY AT RATE RECOMMENDED BY MANUFACTURER. BOTH RATE AND FORMULATION MUST BE APPROVED BY FIELD ENGINEER PRIOR TO APPLICATION.
 - REMOVE WIRE BASKET AND FOLD BURLAP BACK FROM TOP OF ROOT BALL BEFORE BACKFILLING IS COMPLETE.
 - ALL PRUNING TO FOLLOW STANDARD ARBORICULTURAL PRACTICES AS SPECIFIED BY INTERNATIONAL SOCIETY OF ARBORICULTURE.
 - DO NOT ATTEMPT TO STRAIGHTEN A TREE THAT HAS BEEN PLANTED AT AN ANGLE WITH THE USE OF STAKING OR GUYING. DIG TREE AND REPLANT TO UPRIGHT POSITION.

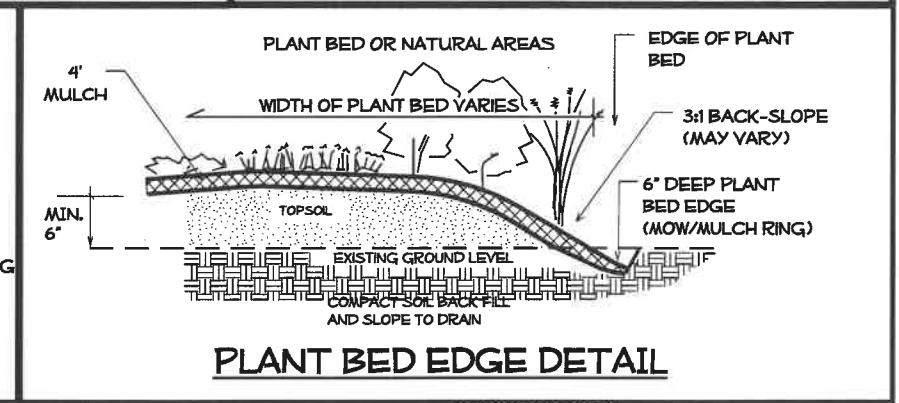
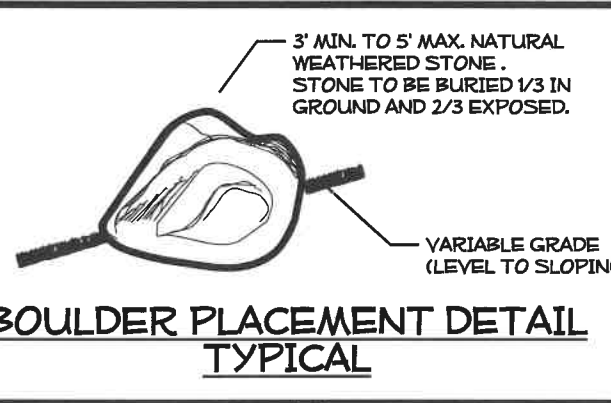
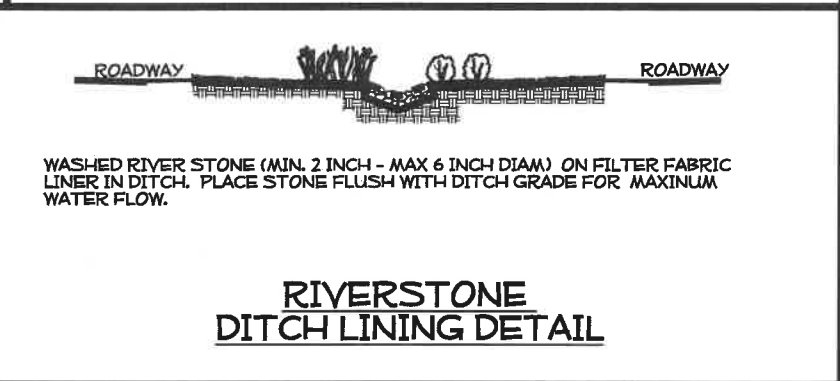
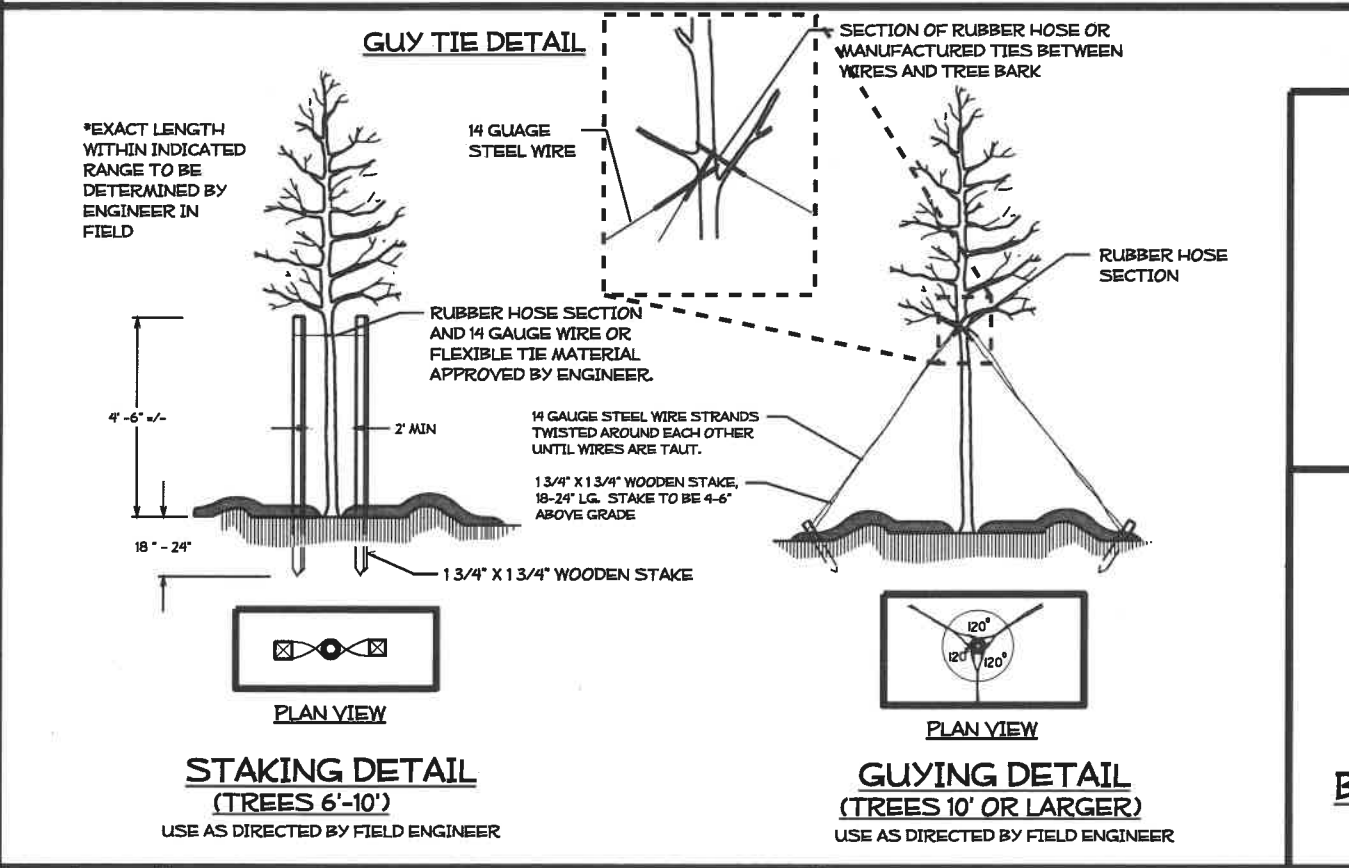

NCDOT - ROADSIDE ENVIRONMENTAL UNIT
LANDSCAPE DESIGN & DEVELOPMENT
1557 MAIL SERVICE CENTER RALEIGH NC 27699-1557
PH: 919-733-2920 FAX: 919-733-9810
HTTP://WWW.NCDOT.ORG/DOH/OPERATIONS/DP_CHIEF_ENG/ROADSIDE/

BRUNSWICK CTY. REST AREA-RENOV.
US 17 NC 130 Shallotte, North Carolina
Contact : 919-707-2951

REV ENGINEER
Azad Atashi

SHEET DESCRIPTION	PREL. DESIGN DATE :
	CHECKED BY & DATE : AA 6/14/2023
	FINAL DESIGN DATE : 6/14/2023

PLANTING DETAILS

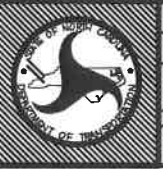

T.I.P. #	
WBS #	
FED ID. #	
SHEET NO. : L3	TOTAL SHEET NO. : 3