

REFERENCE: B-5308

PROJECT: 17BP.3.R.79

CONTENTS

<u>SHEET NO.</u>	<u>DESCRIPTION</u>
1	TITLE SHEET
2	LEGEND (SOIL & ROCK)
3	SITE PLAN
4	PROFILE
5-7	BORE LOGS

STATE OF NORTH CAROLINA
DEPARTMENT OF TRANSPORTATION
DIVISION OF HIGHWAYS
GEOTECHNICAL ENGINEERING UNIT

STRUCTURE
SUBSURFACE INVESTIGATION

COUNTY SAMPSON
PROJECT DESCRIPTION BRIDGE NO. 152 ON -L- (SR 1455)
OVER CAESAR SWAMP

STATE	STATE PROJECT REFERENCE NO.	SHEET NO.	TOTAL SHEETS
N.C.	B-5308	1	7

CAUTION NOTICE

THE SUBSURFACE INFORMATION AND THE SUBSURFACE INVESTIGATION ON WHICH IT IS BASED WERE MADE FOR THE PURPOSE OF STUDY, PLANNING AND DESIGN, AND NOT FOR CONSTRUCTION OR PAY PURPOSES. THE VARIOUS FIELD BORING LOGS, ROCK CORES AND SOIL TEST DATA AVAILABLE MAY BE REVIEWED OR INSPECTED IN RALEIGH BY CONTACTING THE N. C. DEPARTMENT OF TRANSPORTATION, GEOTECHNICAL ENGINEERING UNIT AT (919) 707-6850. THE SUBSURFACE PLANS AND REPORTS, FIELD BORING LOGS, ROCK CORES AND SOIL TEST DATA ARE NOT PART OF THE CONTRACT.

GENERAL SOIL AND ROCK STRATA DESCRIPTIONS AND INDICATED BOUNDARIES ARE BASED ON A GEOTECHNICAL INTERPRETATION OF ALL AVAILABLE SUBSURFACE DATA AND MAY NOT NECESSARILY REFLECT THE ACTUAL SUBSURFACE CONDITIONS BETWEEN BORINGS OR BETWEEN SAMPLED STRATA WITHIN THE BOREHOLE. THE LABORATORY SAMPLE DATA AND THE IN SITU (IN-PLACE) TEST DATA CAN BE RELIED ON ONLY TO THE DEGREE OF RELIABILITY INHERENT IN THE STANDARD TEST METHOD. THE OBSERVED WATER LEVELS OR SOIL MOISTURE CONDITIONS INDICATED IN THE SUBSURFACE INVESTIGATIONS ARE AS RECORDED AT THE TIME OF THE INVESTIGATION. THESE WATER LEVELS OR SOIL MOISTURE CONDITIONS MAY VARY CONSIDERABLY WITH TIME ACCORDING TO CLIMATIC CONDITIONS INCLUDING TEMPERATURES, PRECIPITATION AND WIND, AS WELL AS OTHER NON-CLIMATIC FACTORS.

THE BIDDER OR CONTRACTOR IS CAUTIONED THAT DETAILS SHOWN ON THE SUBSURFACE PLANS ARE PRELIMINARY ONLY AND IN MANY CASES THE FINAL DESIGN DETAILS ARE DIFFERENT. FOR BIDDING AND CONSTRUCTION PURPOSES, REFER TO THE CONSTRUCTION PLANS AND DOCUMENTS FOR FINAL DESIGN INFORMATION ON THIS PROJECT. THE DEPARTMENT DOES NOT WARRANT OR GUARANTEE THE SUFFICIENCY OR ACCURACY OF THE INVESTIGATION MADE, NOR THE INTERPRETATIONS MADE, OR OPINION OF THE DEPARTMENT AS TO THE TYPE OF MATERIALS AND CONDITIONS TO BE ENCOUNTERED. THE BIDDER OR CONTRACTOR IS CAUTIONED TO MAKE SUCH INDEPENDENT SUBSURFACE INVESTIGATIONS AS HE DEEMS NECESSARY TO SATISFY HIMSELF AS TO CONDITIONS TO BE ENCOUNTERED ON THE PROJECT. THE CONTRACTOR SHALL HAVE NO CLAIM FOR ADDITIONAL COMPENSATION OR FOR AN EXTENSION OF TIME FOR ANY REASON RESULTING FROM THE ACTUAL CONDITIONS ENCOUNTERED AT THE SITE DIFFERING FROM THOSE INDICATED IN THE SUBSURFACE INFORMATION.

- NOTES:
1. THE INFORMATION CONTAINED HEREIN IS NOT IMPLIED OR GUARANTEED BY THE N. C. DEPARTMENT OF TRANSPORTATION AS ACCURATE NOR IS IT CONSIDERED PART OF THE PLANS, SPECIFICATIONS OR CONTRACT FOR THE PROJECT.
 2. BY HAVING REQUESTED THIS INFORMATION, THE CONTRACTOR SPECIFICALLY WAIVES ANY CLAIMS FOR INCREASED COMPENSATION OR EXTENSION OF TIME BASED ON DIFFERENCES BETWEEN THE CONDITIONS INDICATED HEREIN AND THE ACTUAL CONDITIONS AT THE PROJECT SITE.

PERSONNEL

C.J. CORNETTE

S.N. ZIMARINO

R.E. SMITH

J.M. EDMONDSON

INVESTIGATED BY T.C. BOTTOMS

DRAWN BY C.J. CORNETTE

CHECKED BY D.N. ARGENBRIGHT

SUBMITTED BY D.N. ARGENBRIGHT

DATE MAY 2018



DocuSigned by:
Tyler C. Bottoms 6/28/2018
48A2D3BD08CF740... SIGNATURE DATE

**DOCUMENT NOT CONSIDERED FINAL
UNLESS ALL SIGNATURES COMPLETED**

NORTH CAROLINA DEPARTMENT OF TRANSPORTATION
DIVISION OF HIGHWAYS
GEOTECHNICAL ENGINEERING UNIT
SUBSURFACE INVESTIGATION
SOIL AND ROCK LEGEND, TERMS, SYMBOLS, AND ABBREVIATIONS

Table with multiple columns: SOIL DESCRIPTION, GRADATION, ROCK DESCRIPTION, TERMS AND DEFINITIONS, SOIL LEGEND AND AASHTO CLASSIFICATION, MINERALOGICAL COMPOSITION, COMPRESSIBILITY, PERCENTAGE OF MATERIAL, GROUND WATER, MISCELLANEOUS SYMBOLS, RECOMMENDATION SYMBOLS, ABBREVIATIONS, EQUIPMENT USED ON SUBJECT PROJECT, FRACTURE SPACING, BEDDING, INDURATION, PLASTICITY, COLOR.

SITE PLAN

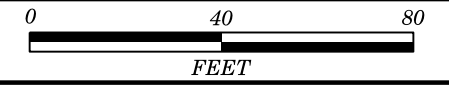

SKEW = 90°

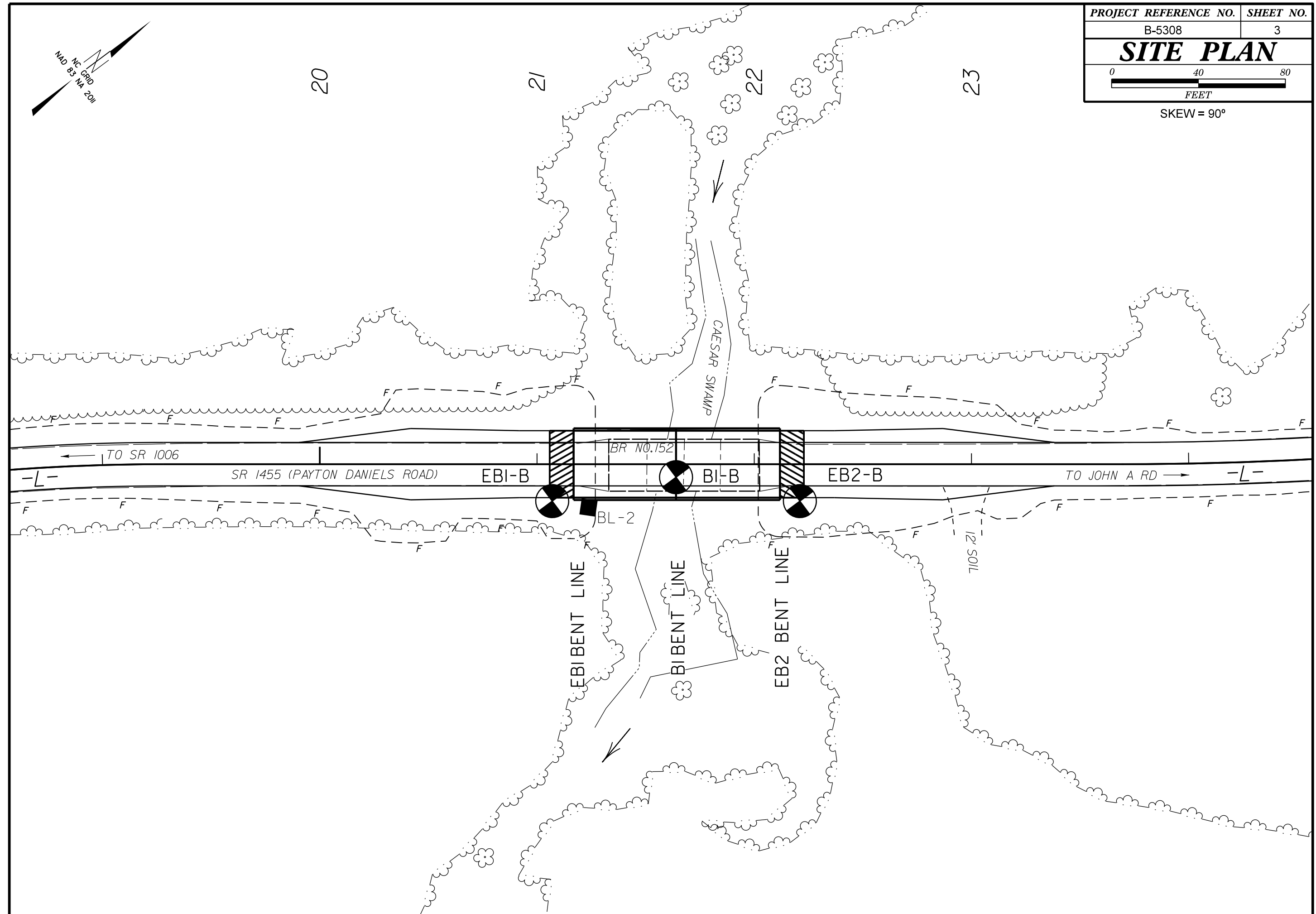
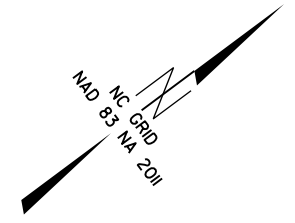

5/14/99

PROJECT REFERENCE NO. B-5308	SHEET NO. 4
ROADWAY DESIGN ENGINEER	HYDRAULICS ENGINEER
INCOMPLETE PLANS DO NOT USE FOR R/W ACQUISITION	
DOCUMENT NOT CONSIDERED FINAL UNLESS ALL SIGNATURES COMPLETED	

PROFILE THROUGH BORINGS PROJECTED ALONG -L-

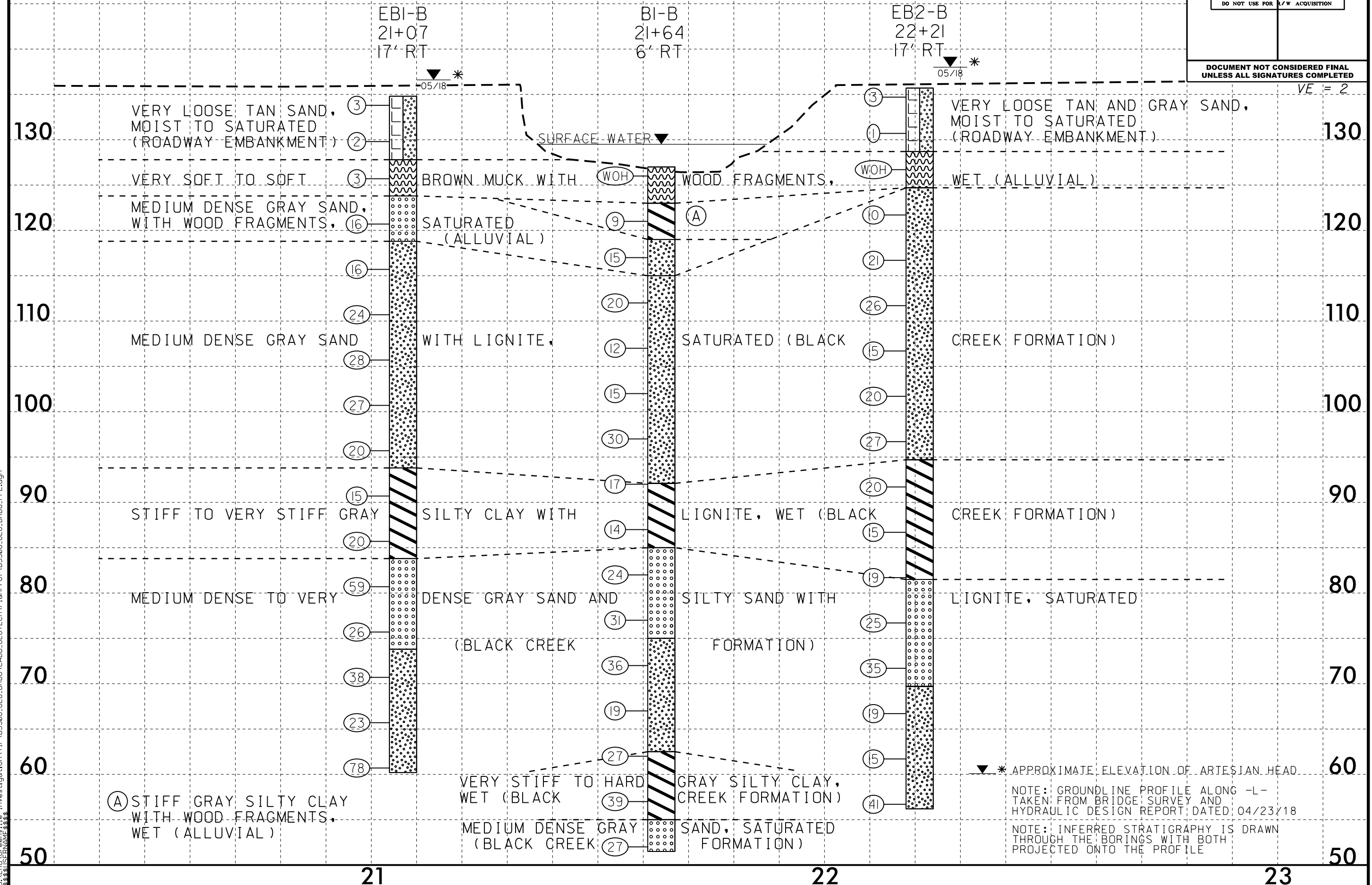

18-MAY-2018 08:16 S:\ERC\Projects\11e_Investigation\TIP_B5308_GEO_BRDG\CADD_GEO\TECH\PI\onProf\B5308_GEO_BRDG_PFL.dgn

GEOTECHNICAL BORING REPORT

BORE LOG

WBS 17BP.3.R.79		TIP B-5308		COUNTY SAMPSON		GEOLOGIST Zimarino, S. N.	
SITE DESCRIPTION BRIDGE NUMBER 152 ON -L- (SR 1455) OVER CAESAR SWAMP						GROUND WTR (ft)	
BORING NO. EB2-B		STATION 22+21		OFFSET 17 ft RT		ALIGNMENT -L-	
COLLAR ELEV. 135.7 ft		TOTAL DEPTH 79.5 ft		NORTHING 500,720		EASTING 2,141,344	
DRILL RIG/HAMMER EFF./DATE GFO0075 CME-45C 84% 08/21/2017		DRILL METHOD Mud Rotary		HAMMER TYPE Automatic			
DRILLER Smith, R. E.		START DATE 05/07/18		COMP. DATE 05/07/18		SURFACE WATER DEPTH N/A	

WBS 17BP.3.R.79		TIP B-5308		COUNTY SAMPSON		GEOLOGIST Zimarino, S. N.	
SITE DESCRIPTION BRIDGE NUMBER 152 ON -L- (SR 1455) OVER CAESAR SWAMP						GROUND WTR (ft)	
BORING NO. EB2-B		STATION 22+21		OFFSET 17 ft RT		ALIGNMENT -L-	
COLLAR ELEV. 135.7 ft		TOTAL DEPTH 79.5 ft		NORTHING 500,720		EASTING 2,141,344	
DRILL RIG/HAMMER EFF./DATE GFO0075 CME-45C 84% 08/21/2017		DRILL METHOD Mud Rotary		HAMMER TYPE Automatic			
DRILLER Smith, R. E.		START DATE 05/07/18		COMP. DATE 05/07/18		SURFACE WATER DEPTH N/A	

ELEV (ft)	DRIVE ELEV (ft)	DEPTH (ft)	BLOW COUNT			BLOWS PER FOOT					SAMP. NO.	LOG MOI	LOG G	SOIL AND ROCK DESCRIPTION	DEPTH (ft)
			0.5ft	0.5ft	0.5ft	0	25	50	75	100					
140															
135.7	135.7	0.0	1	2	1									GROUND SURFACE	0.0
131.7	131.7	4.0	WOH	WOH	1									ROADWAY EMBANKMENT TAN AND GRAY SAND, MOIST TO SATURATED	
127.7	127.7	8.0	WOH	WOH	WOH									ALLUVIAL BROWN MUCK, WET	7.0
122.7	122.7	13.0	2	5	5									COASTAL PLAIN GRAY SAND WITH LIGNITE, SATURATED (BLACK CREEK FORMATION)	11.0
117.7	117.7	18.0	6	7	14										
112.7	112.7	23.0	8	12	14										
107.7	107.7	28.0	6	8	7										
102.7	102.7	33.0	6	9	11										
97.7	97.7	38.0	6	12	15										
92.7	92.7	43.0	6	8	12									COASTAL PLAIN GRAY SILTY CLAY, WET (BLACK CREEK FORMATION)	41.0
87.7	87.7	48.0	2	6	9										
82.7	82.7	53.0	4	5	14										
77.7	77.7	58.0	6	11	14										
72.7	72.7	63.0	10	11	24										
67.7	67.7	68.0	5	7	12										
62.7	62.7	73.0	3	6	9										

ELEV (ft)	DRIVE ELEV (ft)	DEPTH (ft)	BLOW COUNT			BLOWS PER FOOT					SAMP. NO.	LOG MOI	LOG G	SOIL AND ROCK DESCRIPTION	DEPTH (ft)
			0.5ft	0.5ft	0.5ft	0	25	50	75	100					
60															
57.7	57.7	78.0	9	18	23									Match Line	
56.2														COASTAL PLAIN GRAY SILTY SAND, SATURATED (BLACK CREEK FORMATION) (continued)	79.5
														Boring Terminated at Elevation 56.2 ft in Dense Sand	
														Approximate Elevation of Artesian Head: 138.0'	

NCDOT BORE DOUBLE B5308_GEO_BRDG152.GPJ_NC_DOT.GDT 5/18/18