

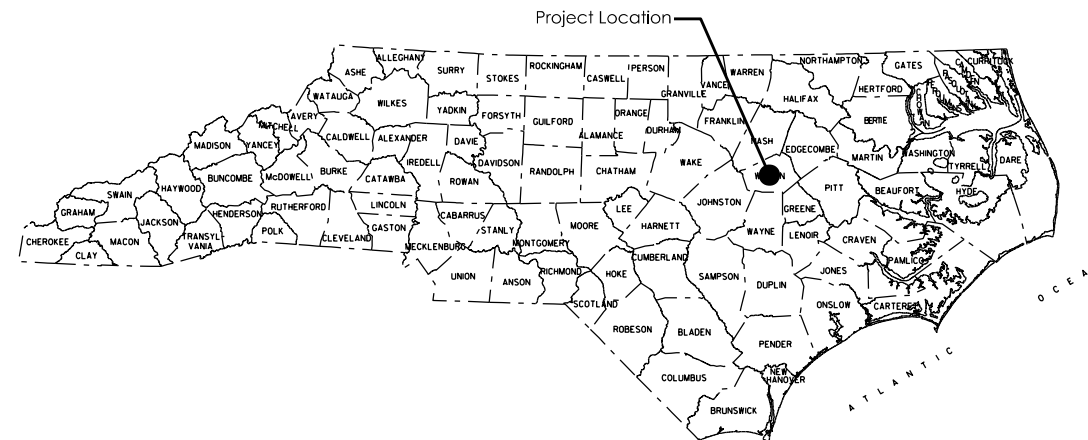

HIGHWAY LANDSCAPE DEVELOPMENT PROJECT

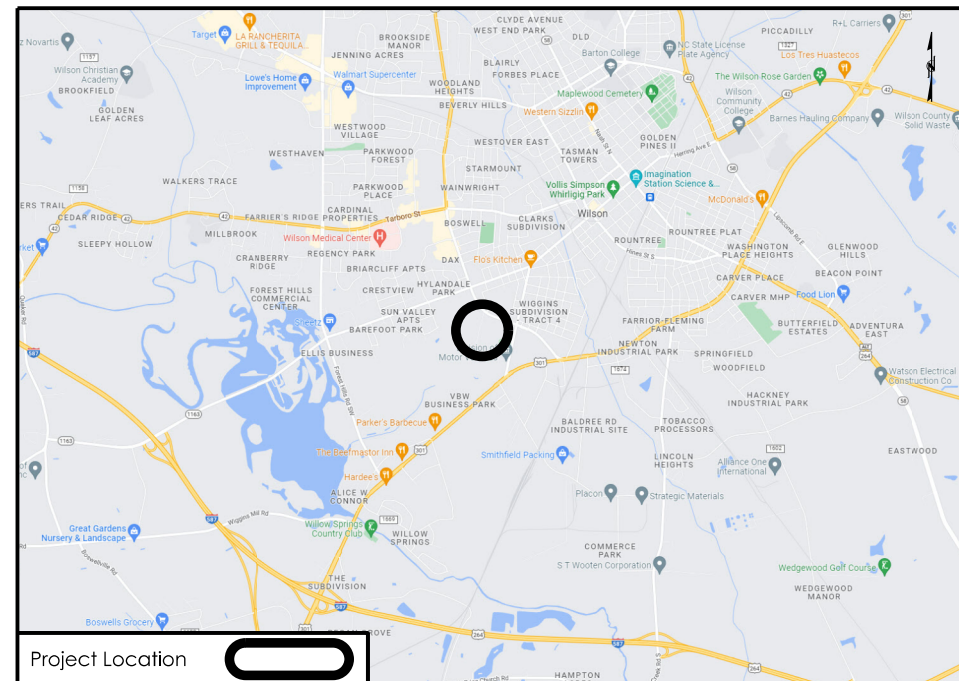

T.I.P. #	STATE PROJECT W.B.S. #	SHEET #	SHEET # TOTAL
-----	44601.04	L1	9
FED. PROJ. #	DESCRIPTION		DIVISION
4SP.10981.14	Enhancement		4



Summary of Quantities
2 Year Establishment

DES	SEC	QTY	UNIT	KEY	BOTANICAL NAME	COMMON NAME	FURNISH	REMARKS	A.S.N.S.
Shrubs									
L	1670	33	ea	DC	<i>Distylium 'PHIDIST-V'</i>	Cinnamon Girl® Distylium	15-18"; #3	2.5' O.C.	5.4
L	1670	25	ea	RP	<i>Rosa 'Meiggili'</i>	Peach Drift® Rose	12-15"; #3	2' O.C.	3.2
Grasses/Groundcovers/Perennials									
L	1670	103	ea	LV	<i>Liriope muscari 'Variegata'</i>	Variegated Lily Turf	6-12"; #1 Cont.	1' O.C.	13.3
L	1670	75	sy	TB	<i>Cynodon dactylon x C. transvaalensis</i>	TifTuf Bermudagrass	Sod	Tight Seams	n/a
Other Vegetation Costs									
L	1670	39	sy		Existing Plant Bed Removal				
L	1670	24	ea		Monthly Establishment				
L	1670	17	cy		Mulch for Planting (Establishment Year 1)			Depth of 4"	
L	1670	8	cy		Mulch for Planting (Establishment Year 2)			Depth of 2"	
L	1670	157	sy		Pre emergence Herbicidal Treatment				
L	1670	157	sy		Post emergence Herbicidal Treatment				
L	1670	3	m/g		Water for Planting (Establishment Year 1)				
L	1670	2	m/g		Water for Planting (Establishment Year 2)				
Other Construction Costs									
L	848	36	sy		4" Concrete Sidewalk				
L	SP	1	ea		Aluminum Cast Memorial Plaque & Stand				
L	SP	1	LS		Aluminum Handrails				
L	SP	2	ea		Bench				
L	SP	235	sf		Brick Pavers				
L	SP	1	LS		Demolition				
L	SP	13.5	cy		Fill Soil				
L	SP	1	ea		Flagpole (30'; Aluminum)				
L	SP	1	LS		Flagpole Lighting Installation				
L	SP	25	ea		Granite Pavers				
L	SP	12	ea		Granite Pavers (Engraved)				
L	SP	1	LS		Landscape Grading				
L	SP	28	cy		Topsoil				

* m/g - 1,000 Gallons

Division 4 Office Memorial

NOTES:

- Existing conditions shown on the plans are based on survey information and roadway plans, actual site conditions may vary.
- Prior to any demolition or work taking place, the contractor shall locate and verify all utility lines and structures within the construction areas (water, sewer, gas, electrical, etc.)
- The contractor shall take the necessary precautions to prevent damage of adjacent plant material, facilities, and structures to remain. The contractor shall restore disturbed areas to their original condition and to the satisfaction of the Division Roadside Environmental Engineer.
- The utilities shown on the plans are approximate locations. The contractor shall locate and protect in place all existing utilities before digging occurs and major construction begins.
- Demolition, removal, and disposal of items from the site must be completely in accordance with the law. The contractor is responsible for making a site visit to determine and verify all demolition requirements prior to bidding.
- The contractor shall verify all conditions and dimensions at the job site prior to construction, and if discrepancies are found, notify the Division Roadside Environmental Engineer for clarification.

CONVENTIONAL SYMBOLS

County Line	-----
City or Town Line	-----
Exist. Right of Way Line Marker	-----▲-----
Prop. Right of Way Line Marker	-----▲-----
(By Others)	-----▲-----
Prop Right of Way Line Marker	-----▲-----
(By Contract)	-----▲-----
Exist. Control of Access Line	-----○-----
Prop. Control of Access Line	-----○-----
Property Line	-----
Easement Line	-----
Slope Stake Line	-----
Exist. Fence	-----
Prop. Woven Wire Fence	-----
Prop. Chain Link Fence	-----
Exist. Road	-----
Prop. Road	-----
Guardrail	-----
Survey Line	-----
Denotes Line Equality	-----
Bridge	-----
Culvert	-----
Railroad	-----
Woods	-----
Exist. Telephone Pole	-----
Prop. Telephone Pole	-----
Tower Pole and Line	-----
Exist. Power Pole	-----
Prop. Power Pole	-----
Sanitary Sewer Line	-----
Water Line	-----
Gas Line	-----
Picnic Shelter	-----
Regeneration	-----
Reforestation	-----

INDEX OF L SHEETS:

- L 1.0 - Title Sheet
- L 2.0 - Demolition Plan
- L 3.0 - Planting Plan
- L 4.0 - Section Elevations
- L 5.0 - Planting Details
- L 6.0 - L 9.0 - Hardscape Details

PREPARED BY: K. Cooper DATE: 5/16/2023

REVISIONS

DATE	DESCRIPTION

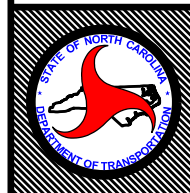

STATE OF
NORTH CAROLINA
DEPARTMENT OF TRANSPORTATION

LOCATION: Division 4 Office in Wilson

TYPE of WORK: Enhancement

COUNTY: Wilson

2014 American Standard for Nursery Stock

2018 NCDOT STANDARD SPECIFICATIONS

PREPARED IN THE OFFICE OF:
NCDOT- ROADSIDE ENVIRONMENTAL UNIT
AESTHETIC ENGINEERING SECTION
1557 MAIL SERVICE CENTER
RALEIGH, NC 27699 919-707-2920

Notes

- The existing conditions shown on the plans are based on aerial maps and field notes. Actual site conditions may vary.
- Prior to any demolition or work taking place, the contractor shall locate and verify all utility lines and structures within the construction areas (water, sewer, gas, electrical, etc.)
- The contractor shall take the necessary precautions to prevent damage of adjacent plant material, facilities, curbs, and structures to remain. The contractors shall restore any disturbed area to its original condition to the satisfaction of the Engineer.
- Fill soil shall be used to fill any voids remaining after the existing sidewalk and stairs are removed for areas where the walkway will be raised and for areas not receiving new sod or plant material. Topsoil will be used to fill any voids remaining for areas that will only receive new sod and plant material.
- Sod will be applied to all turf areas that are disturbed by construction that are not planned to receive new plant beds or hardscapes. (TifTuf Bermuda).
- The contractor will remove and store items, such as lights, flagpole, etc., that fall into the construction zone to a holding area until construction is complete. Any item not being reused will become the property of the contractor.
- Demolition, removal, and disposal of items from the site must be completed in accordance with the law. The contractor is responsible for making a site visit to determine and verify all demolition requirements prior to bidding.

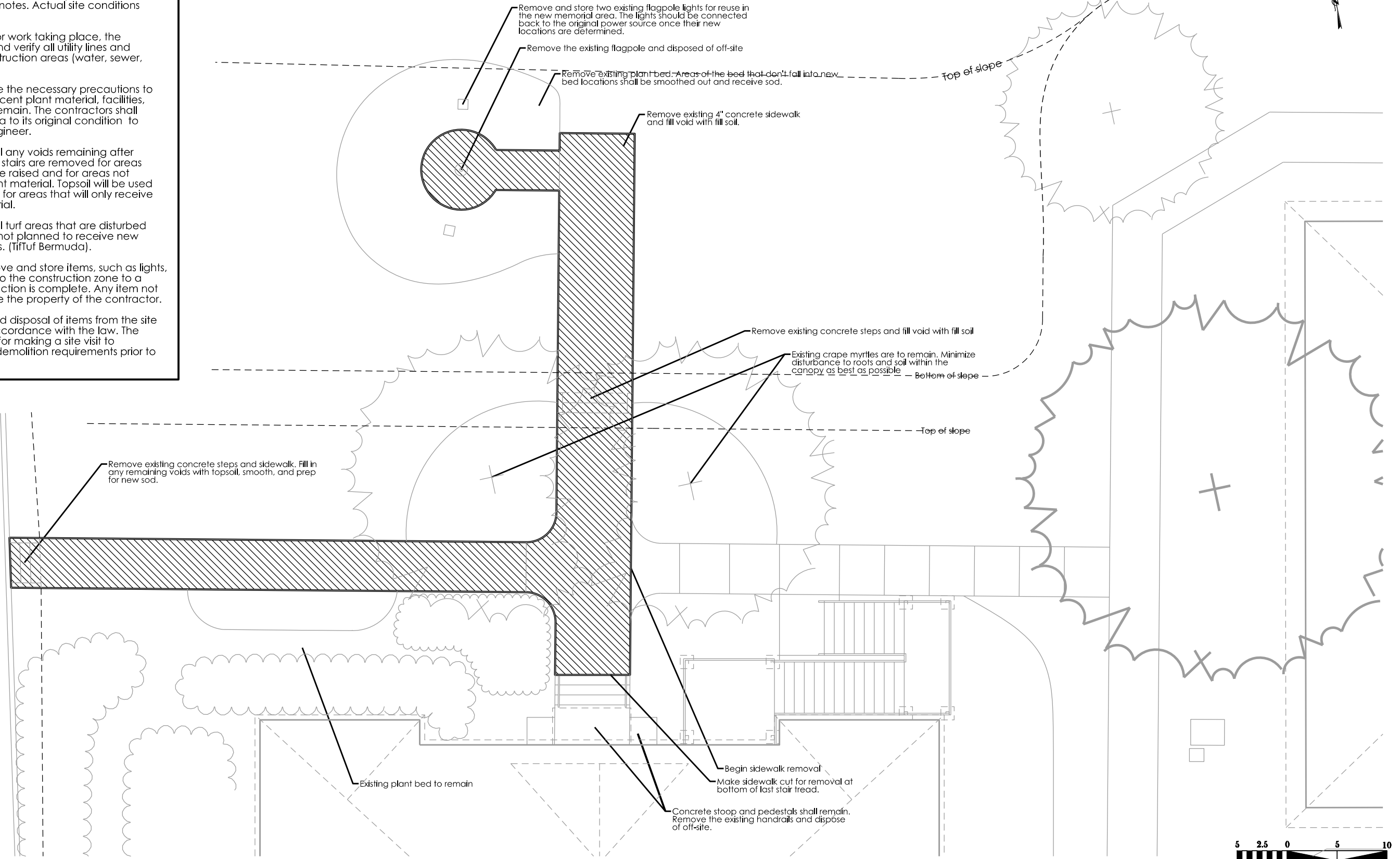

NCDOT - ROADSIDE ENVIRONMENTAL UNIT
 AESTHETIC ENGINEERING SECTION
 1557 MAIL SERVICE CENTER RALEIGH NC 27699-1557
 PH: 919-707-2935 FAX: 919-715-2554
http://www.ncdot.org/doh/operations/dp_chief_eng/roadside/

Division 4 Office Memorial
 Wilson County
 WBS #: 44601.04

SHEET DESCRIPTION:	PREL. DESIGN DATE: -----	Demolition Plan
	FINAL DESIGN DATE: -----	Landscape Plan Sheet
	PROJECT LANDSCAPE ARCHITECT: Kyle Cooper, PLA	



T.I.P. #	-----
WBS #	44601.04
FED I.D. #	4SP.10981.14
SHEET NO:	L-2
TOTAL SHEET NO:	L-9

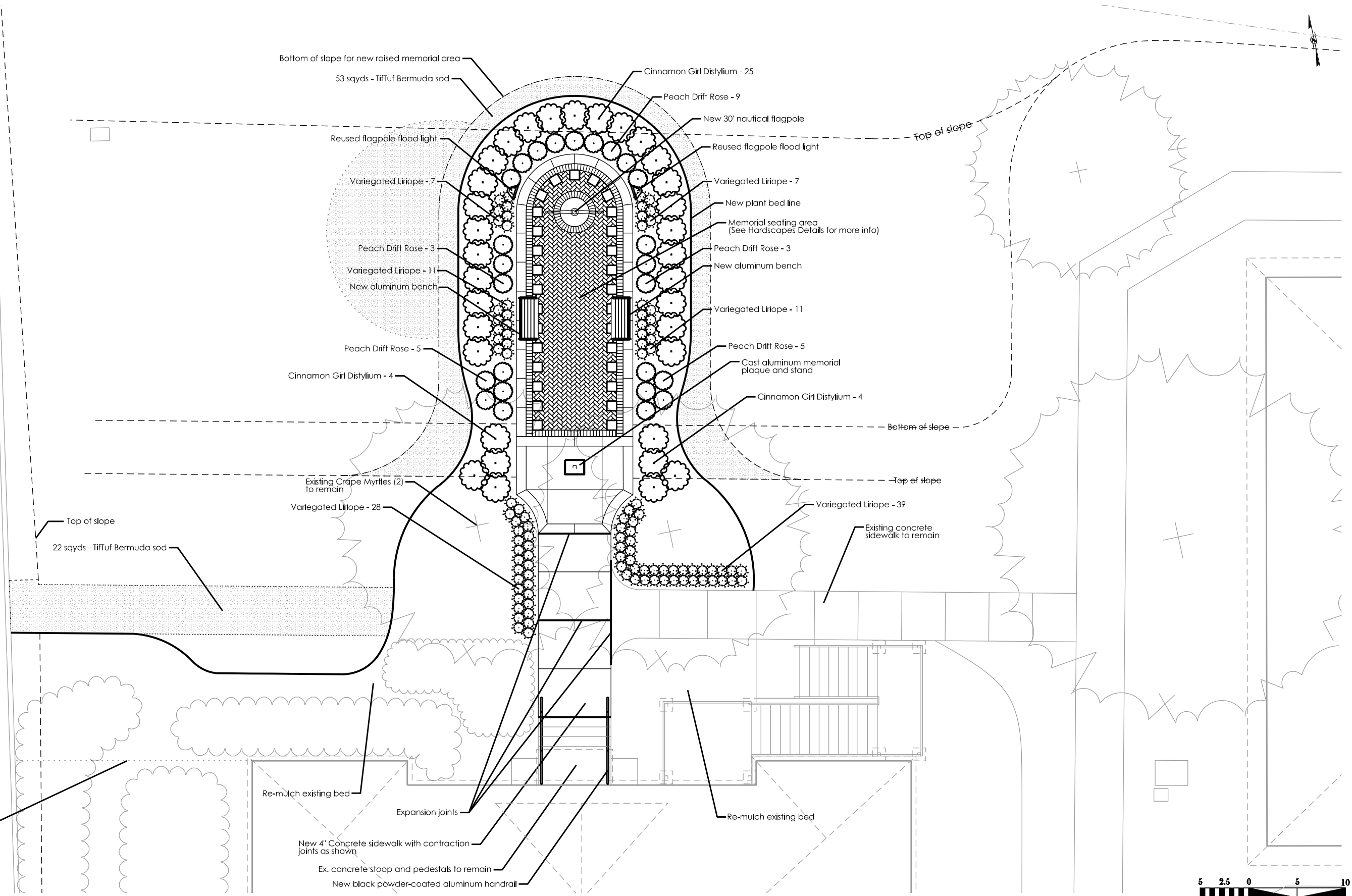

NCDOT - ROADSIDE ENVIRONMENTAL UNIT
 AESTHETIC ENGINEERING SECTION
 1557 MAIL SERVICE CENTER RALEIGH NC 27699-1557
 PH: 919-707-2935 FAX: 919-715-2554
http://www.ncdot.org/doh/operations/dp_chief_eng/roadside/

Division 4 Office Memorial
 Wilson County
 WBS #: 44601.04

SHEET DESCRIPTION:	PREL. DESIGN DATE: -----
	FINAL DESIGN DATE: -----
	PROJECT LANDSCAPE ARCHITECT: Kyle Cooper, PLA

Planting Plan
 Landscape Plan Sheet



T.I.P. #	-----
WBS #	44601.04
FED.I.D. #	4SP.10981.14
SHEET NO.:	L-3
TOTAL SHEET NO.:	L-9

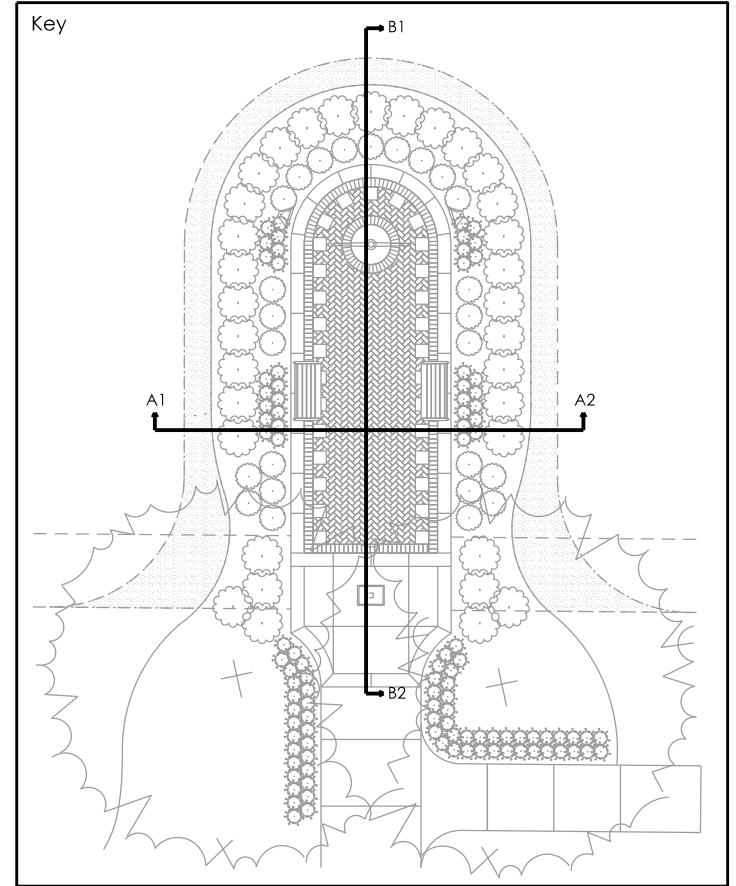
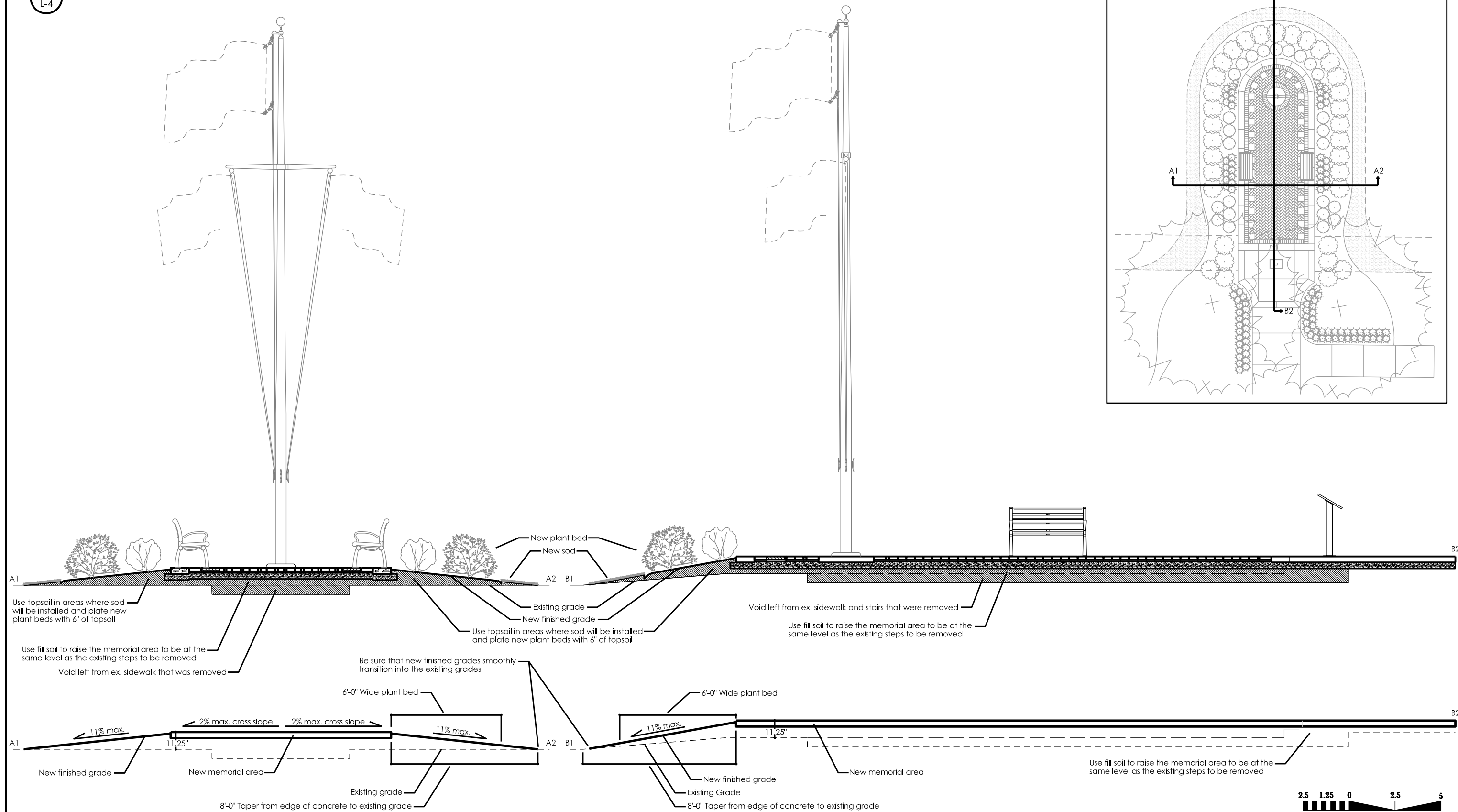

 NCDOT - ROADSIDE ENVIRONMENTAL UNIT
AESTHETIC ENGINEERING SECTION
1557 MAIL SERVICE CENTER RALEIGH NC 27699-1557
PH: 919-707-2935 FAX: 919-715-2554
http://www.ncdot.org/doh/operations/dp_chief_eng/roadside/

Division 4 Office Memorial
Wilson County
WBS #: 44601.04

SHEET DESCRIPTION:	PREL. DESIGN DATE: -----
	FINAL DESIGN DATE: -----
	PROJECT LANDSCAPE ARCHITECT: Kyle Cooper, PLA

Section Elevations
Landscape Plan Sheet

	T.I.P. # -----
	WBS # 44601.04
	FED I.D. # 4SP.10981.14
	SHEET NO: L-4 TOTAL SHEET NO: L-9

NOTES:

-  SCHEDULE FOR PLANT HOLE SIZE: PLANT HOLE WIDTH (X) TO BE TWICE THE ROOT BALL SIZE OR CONTAINER DIAMETER.
-  SEE STANDARD SPECIFICATIONS FOR PLANT BED FUMIGATION AND HERBICIDAL TREATMENT.
-  APPLY FERTILIZER AT PLANTING TIME IN THE FORM OF A SLOW RELEASE PELLET OR TABLET. APPLY AT RATE RECOMMENDED BY MANUFACTURER. BOTH RATE AND FORMULATION MUST BE APPROVED BY FIELD ENGINEER PRIOR TO APPLICATION.
-  REMOVE TOP 1#3 OF WIRE BASKET AND FOLD BURLAP BACK FROM TOP OF ROOT BALL BEFORE BACKFILLING IS COMPLETE.
-  ALL PRUNING TO FOLLOW STANDARD ARBORICULTURAL PRACTICES AS SPECIFIED BY INTERNATIONAL SOCIETY OF ARBORICULTURE.
-  DO NOT ATTEMPT TO STRAIGHTEN A TREE THAT HAS BEEN PLANTED AT AN ANGLE WITH THE USE OF STAKING OR GUYING. DIG TREE AND REPLANT TO UPRIGHT POSITION.

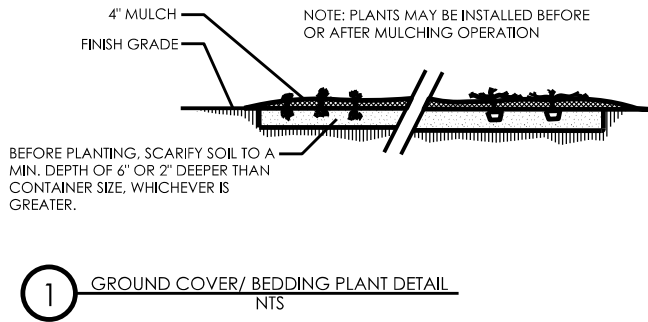

1 GROUND COVER/ BEDDING PLANT DETAIL
NTS

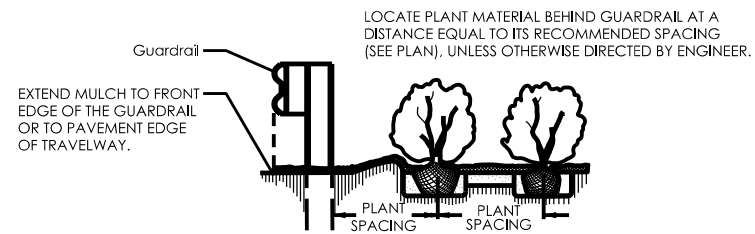

2 Guardrail Mulching Detail
NTS

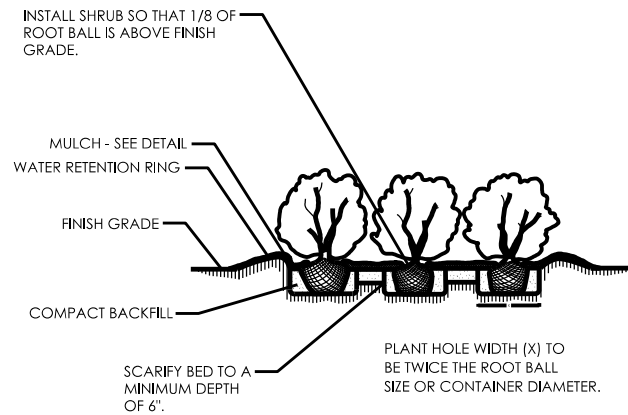

3 SHRUB BED PLANTING DETAIL
NTS

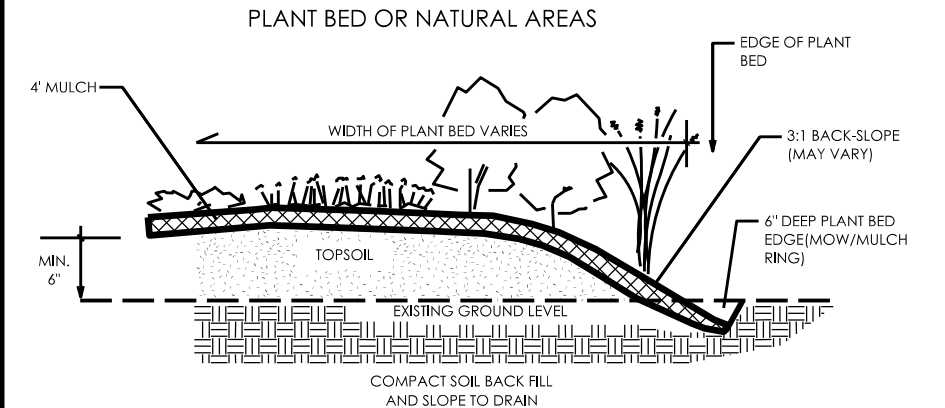

4 PLANT BED EDGE DETAIL
NTS

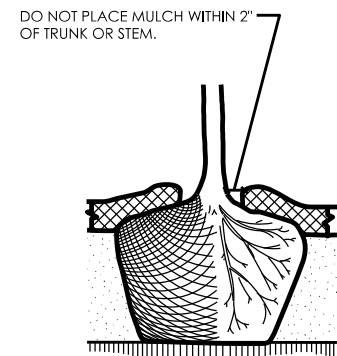

5 MULCH DETAIL
NTS

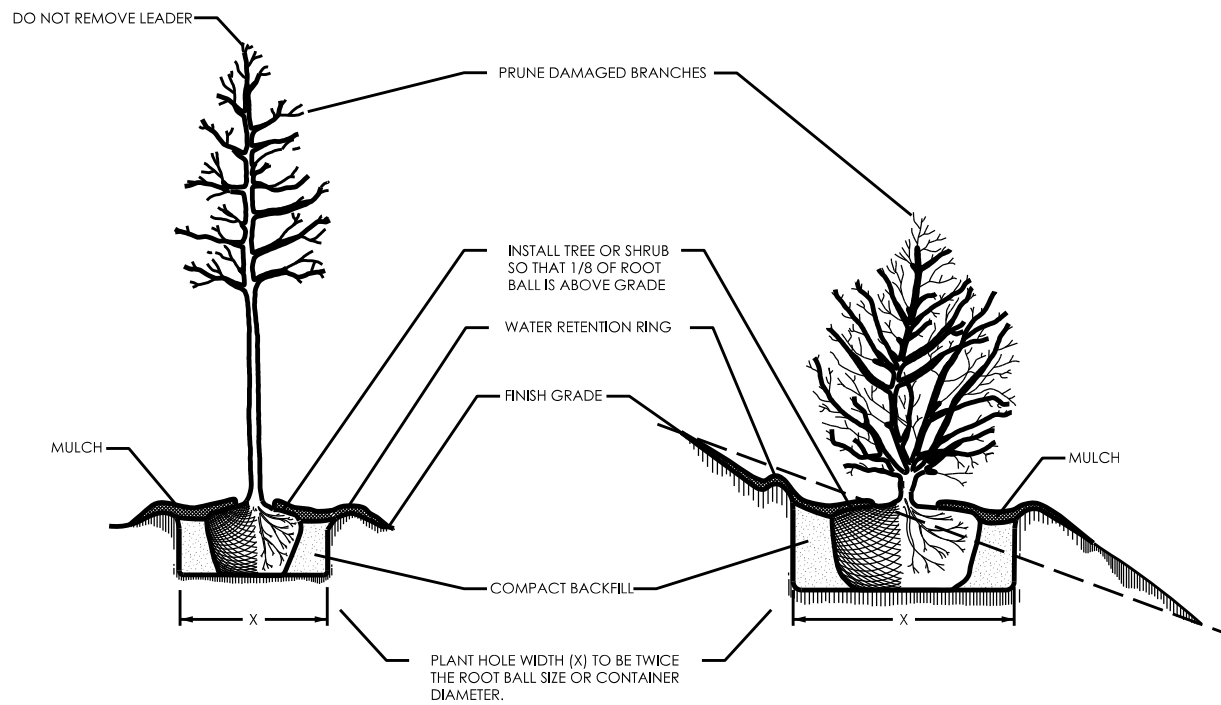

6 TREE OR SHRUB PLANTING DETAIL
NTS

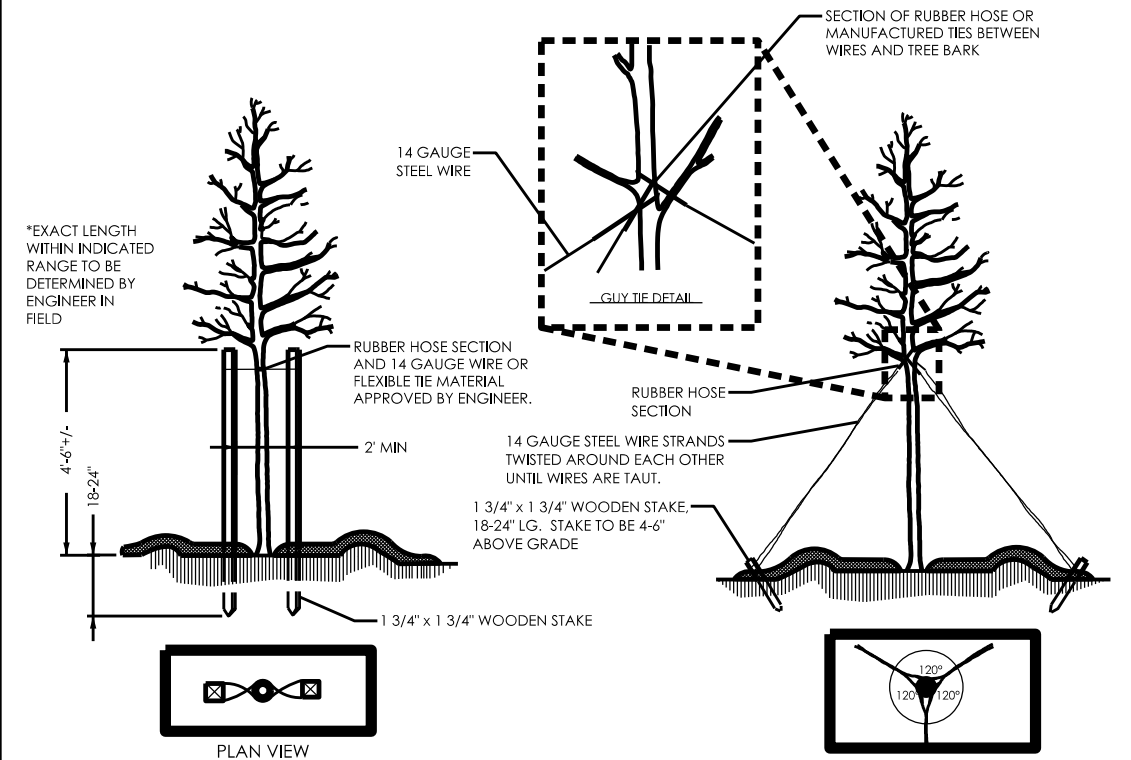

7 TREE STAKING DETAIL
NTS

8 TREE GUYING DETAIL
NTS



NCDOT - ROADSIDE ENVIRONMENTAL UNIT
AESTHETIC ENGINEERING SECTION
1557 MAIL SERVICE CENTER RALEIGH NC 27699-1557
PH: 919-707-2935 FAX: 919-715-2554
http://www.ncdot.org/doh/operations/dp_chief_eng/roadside/

Division 4 Office Memorial
Wilson County
WBS #: 44601.04

SHEET DESCRIPTION:	PREL. DESIGN DATE: -----
	FINAL DESIGN DATE: -----
PROJECT LANDSCAPE ARCHITECT:	Kyle Cooper, PLA

Planting Details
Landscape Plan Sheet



T.I.P. #	-----
WBS #	44601.04
FED. I.D. #	4SP.10981.14
SHEET NO.:	L-5
TOTAL SHEET NO.:	L-9

ENGRAVED GRANITE MEMORIAL PAVERS (Black, 3/4" tall Arial font inscribed on white/light grey, 12" square granite pavers)

- | | | | | | | | | | | | |
|--|--|---|--|--|--|--|--|---|--------------------------------------|--|--|
| ①
MACK THOMAS
BATCHELOR JR.
NASH CO.
MAINTENANCE | ②
CHARLIE DANIEL
EATMON
NASH CO.
MAINTENANCE | ③
CHARLES GREY
LEWIS
NASH CO.
MAINTENANCE | ④
CARL VANCE
OLIVER
JOHNSTON CO.
MAINTENANCE | ⑤
FOREST MAXWELL
BARRETT JR.
EDGECOMBE
BRIDGE
MAINTENANCE | ⑥
JOHN PORTER
EDGECOMBE CO.
MAINTENANCE | ⑦
JOSEPH HARRELL
WILLIAMS
NASH CO.
MAINTENANCE | ⑧
TRAVIS COBB
ELLIS
ROADSIDE
ENVIRONMENTAL | ⑨
WILLIAM CHARLES
KING
WILSON CO.
MAINTENANCE | ⑩
CARL RAY
COLLINS
ROAD OIL | ⑪
WILLIAM GRAY
BAILEY
SELMA
CONSTRUCTION | ⑫
ANNA GAVIN
BRADSHAW
WILSON CO.
MAINTENANCE |
|--|--|---|--|--|--|--|--|---|--------------------------------------|--|--|

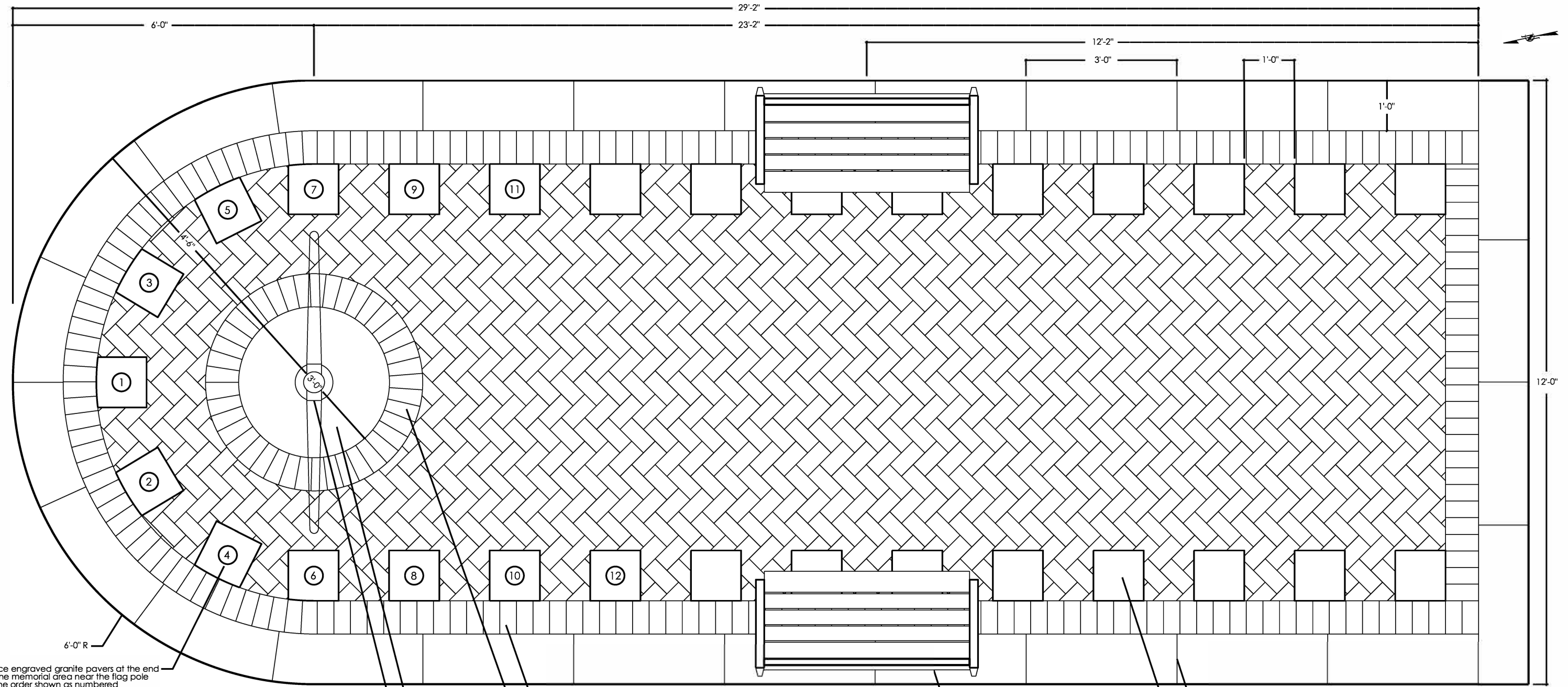

Place engraved granite pavers at the end of the memorial area near the flag pole in the order shown as numbered

- Brick pavers (4" x 8" x 2.25") shall be placed in a sailor course along the entire inside edge of the concrete border and be flush against the new border as shown (Red color similar to existing bricks in buildings)
- Brick pavers (4" x 8" x 2.25") shall be placed in a sailor course along the entire outside edge of the concrete pad as shown
- 4" Concrete pad around the new flag pole (3' Dia. circle)
- 30' Single mast aluminum nautical flagpole with yardarm centered within concrete circle
- 4' Contoured, black powder-coated aluminum bench with recycled plastic planks (Center back foot within the concrete border)
- 12" x 12" x 2" Granite memorial pavers placed as shown (White/light grey color)
- Contraction joints are to have 3' spacings within border areas

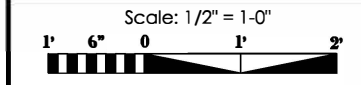

 NCDOT - ROADSIDE ENVIRONMENTAL UNIT
AESTHETIC ENGINEERING SECTION
1557 MAIL SERVICE CENTER RALEIGH NC 27699-1557
PH: 919-707-2935 FAX: 919-715-2554
http://www.ncdot.org/doh/operations/dp_chief_eng/roadside/

Division 4 Office Memorial
Wilson County
WBS #: 44601.04

SHEET DESCRIPTION:	PREL. DESIGN DATE: -----
	FINAL DESIGN DATE: -----
	PROJECT LANDSCAPE ARCHITECT: Kyle Cooper, PLA

Hardscape Details
Landscape Plan Sheet

T.I.P. # -----
WBS # 44601.04
FED I.D. # 4SP.10981.14
SHEET NO. L-6 TOTAL SHEET NO. L-9

1 Handrail Plan View Detail
1/2" = 1'-0"

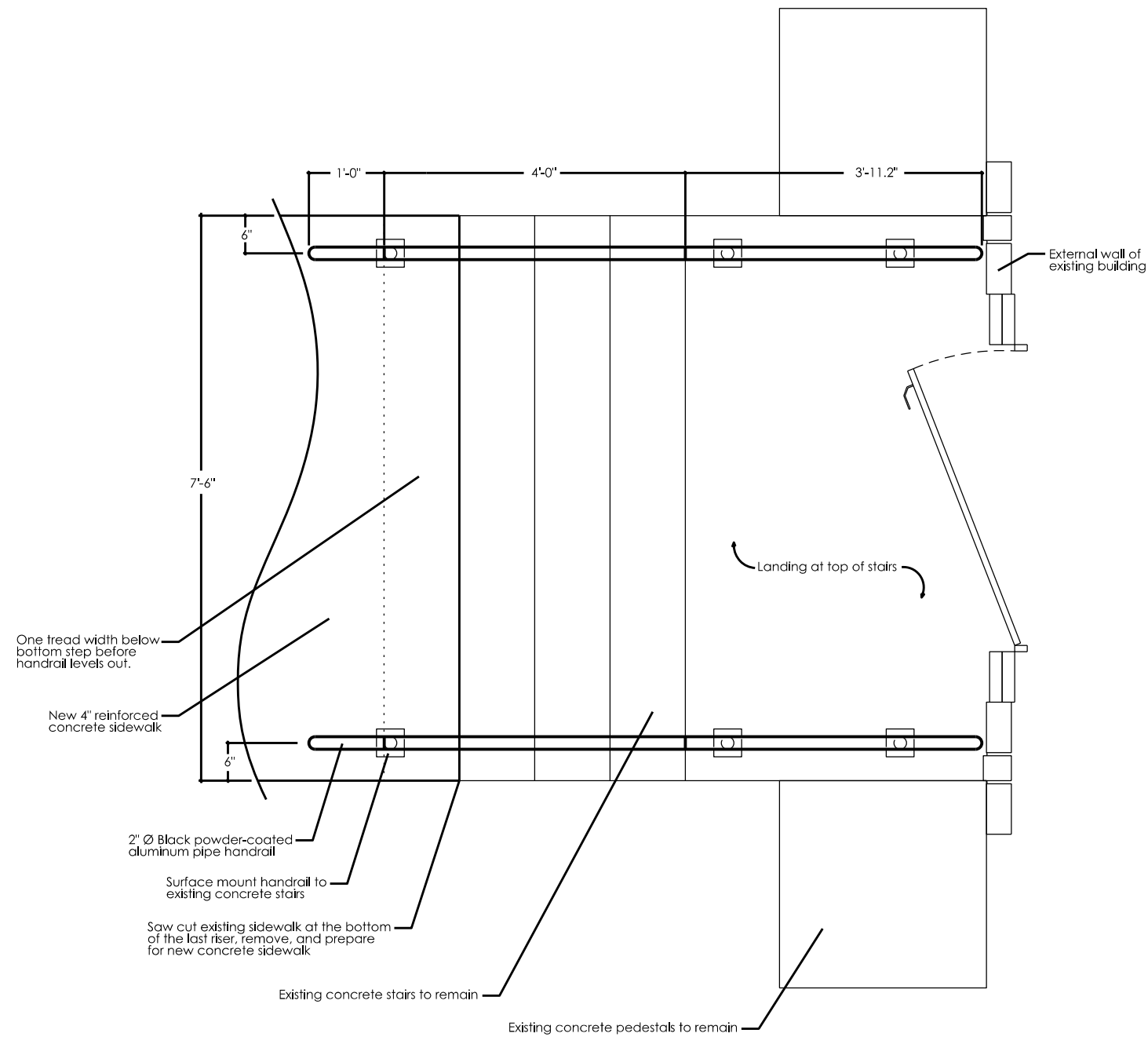

2 Handrail Section Detail
1/2" = 1'-0"

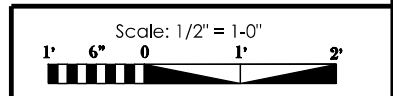
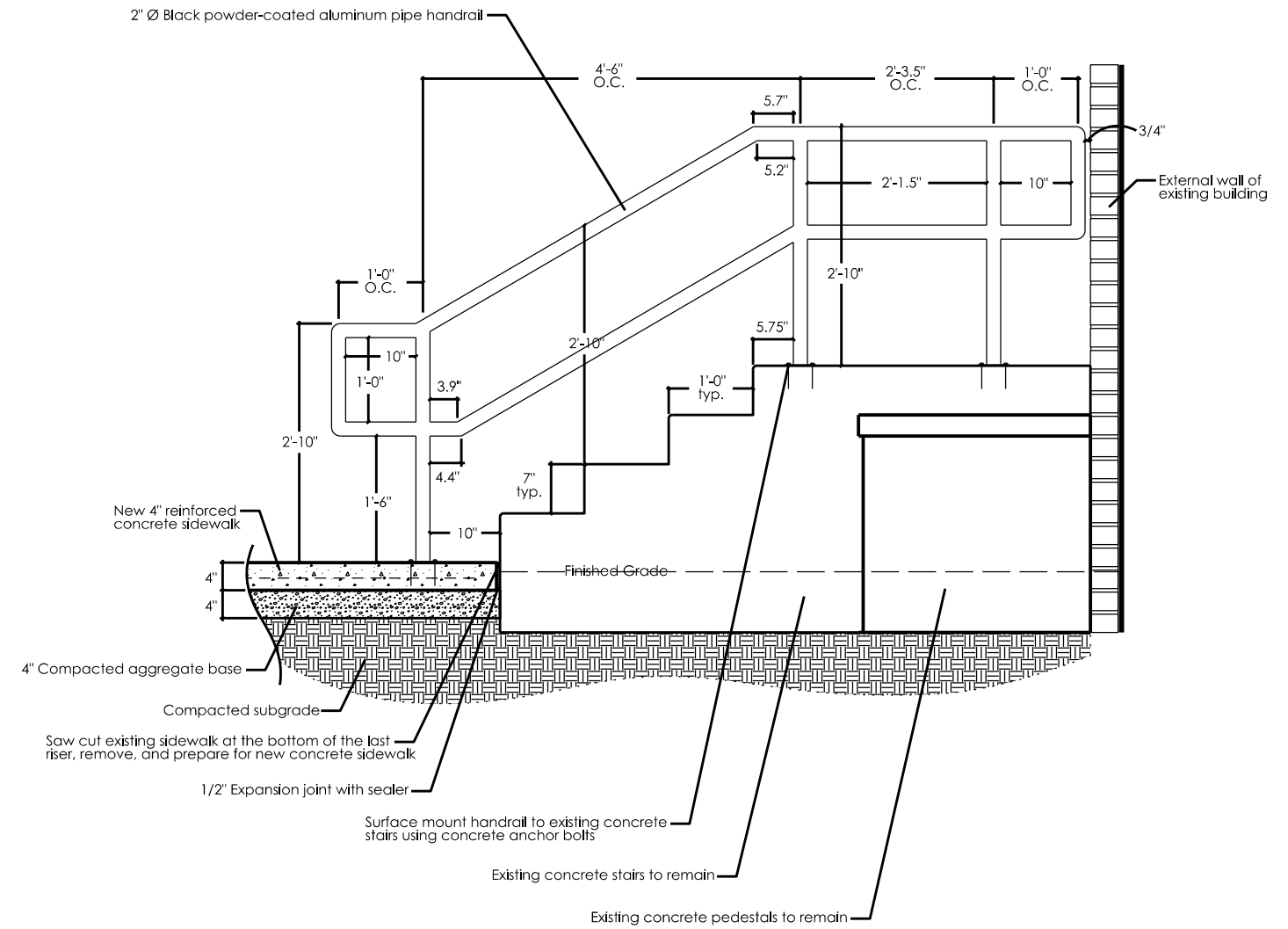

NCDOT - ROADSIDE ENVIRONMENTAL UNIT
AESTHETIC ENGINEERING SECTION
1557 MAIL SERVICE CENTER RALEIGH NC 27699-1557
PH: 919-707-2935 FAX: 919-715-2554
http://www.ncdot.org/doh/operations/dp_chief_eng/roadside/

Division 4 Office Memorial
Wilson County
WBS #: 44601.04

SHEET DESCRIPTION:	PREL. DESIGN DATE: -----	Hardscape Details
	FINAL DESIGN DATE: -----	
	PROJECT LANDSCAPE ARCHITECT: Kyle Cooper, PLA	



T.I.P. # -----
WBS # 44601.04
FED I.D. # 4SP.10981.14
SHEET NO: L-7
TOTAL SHEET NO: L-9

1
L-8
Handrail Section Detail
1/2" = 1'-0"

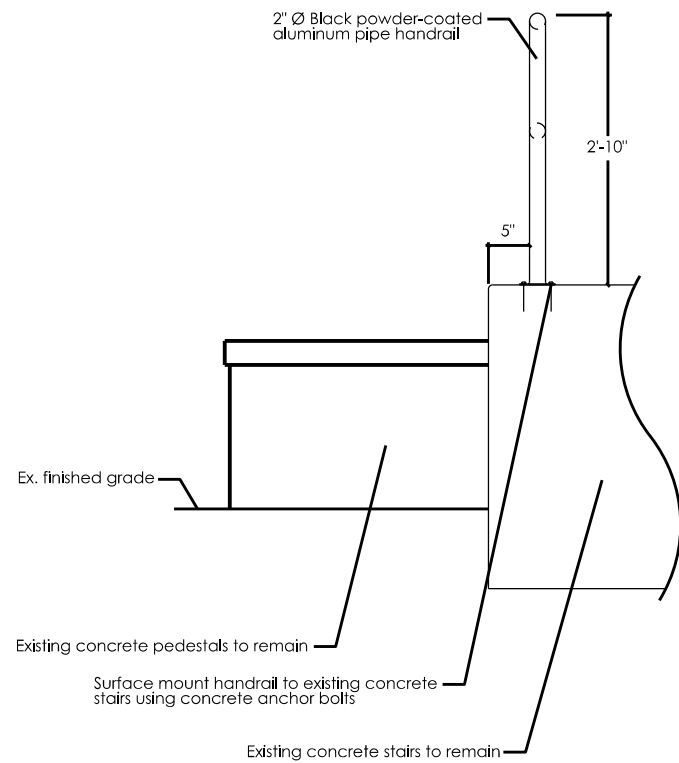

2
L-8
Bench Attachment Detail
1/2" = 1'-0"

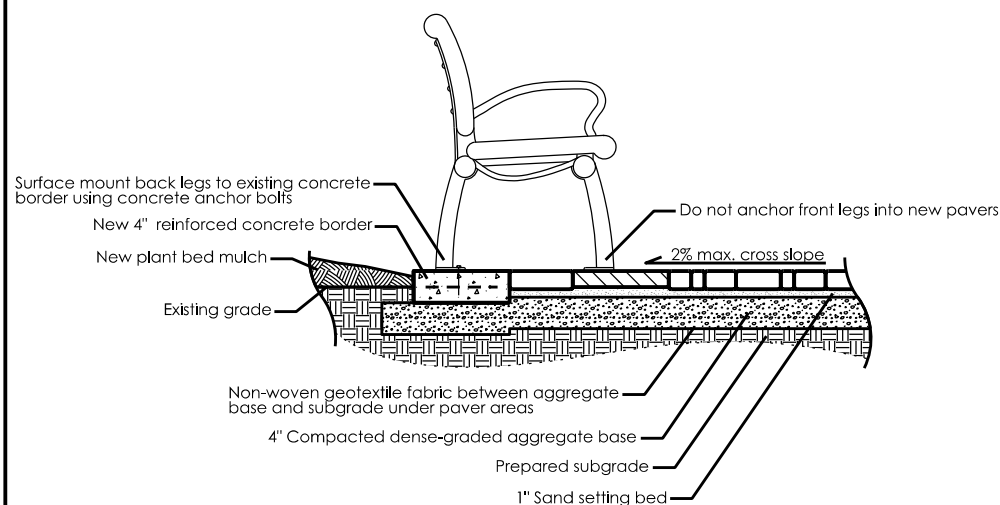

3
L-8
Aluminum Memorial Plaque and Stand
1/2" = 1'-0"

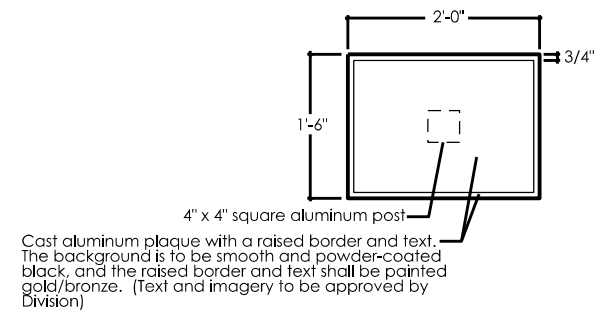
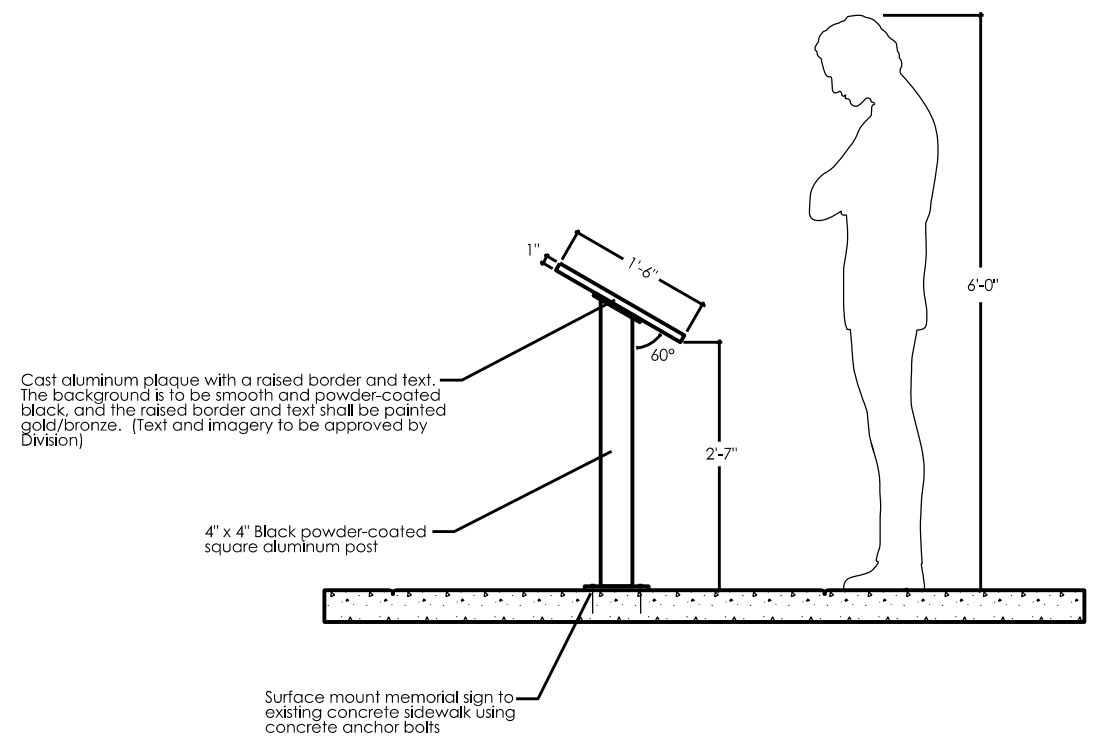

Cast aluminum plaque with a raised border and text. The background is to be smooth and powder-coated black, and the raised border and text shall be painted gold/bronze. (Text and imagery to be approved by Division)

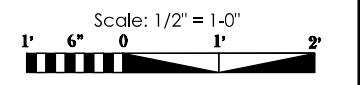
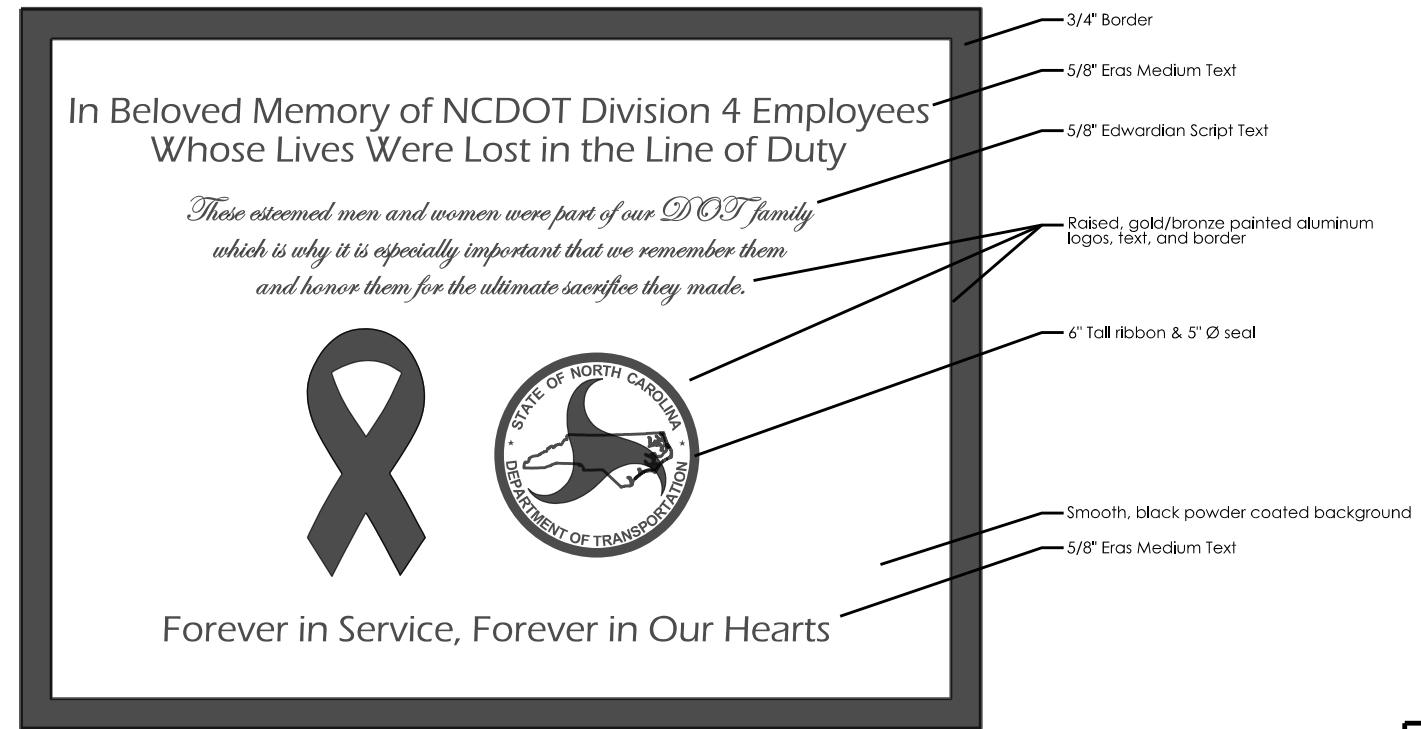

1 Nautical Flag Pole Section Detail
1/4" = 1'-0"

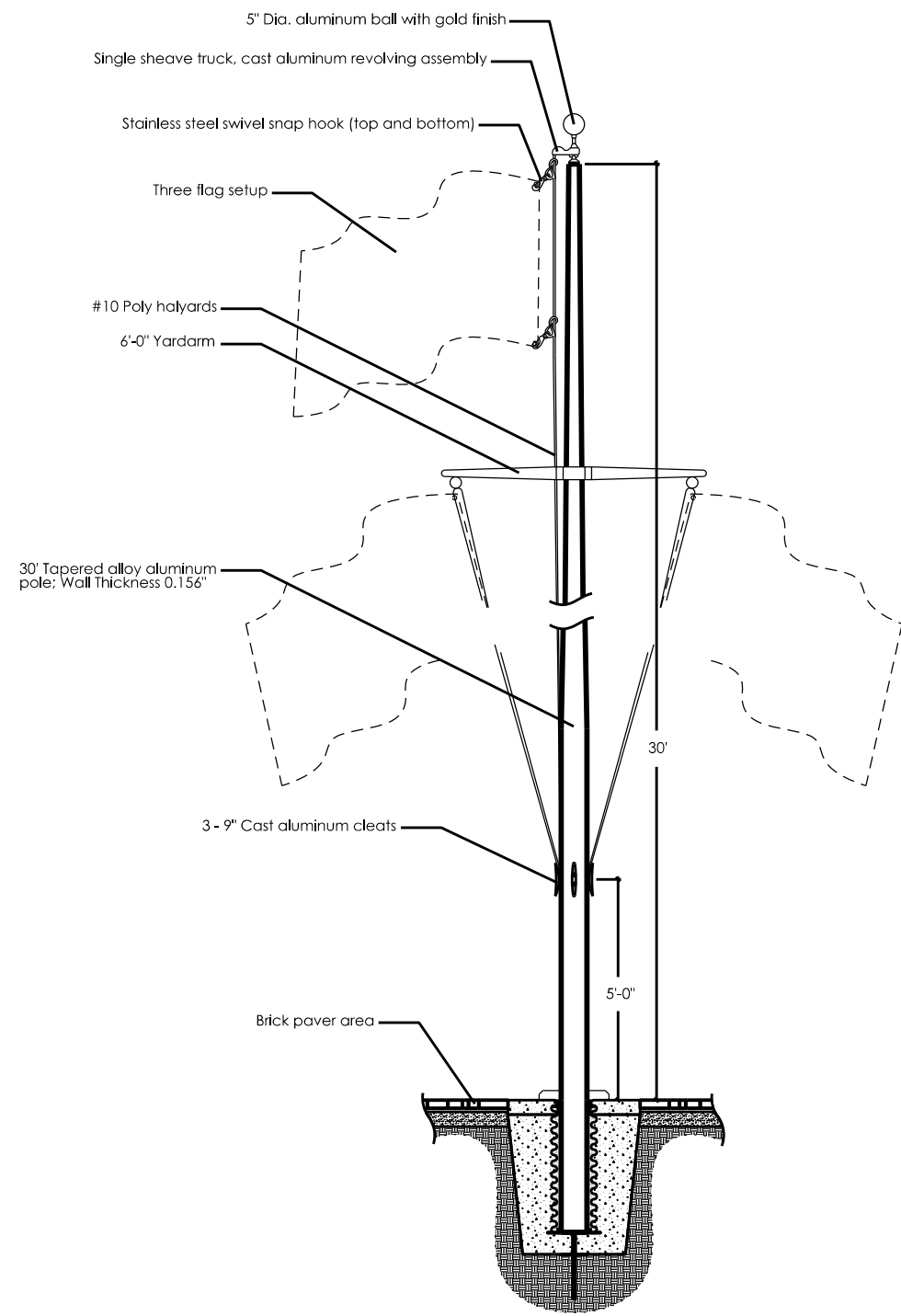

2 Concrete Border & Pavers Section Detail
1" = 1'-0"

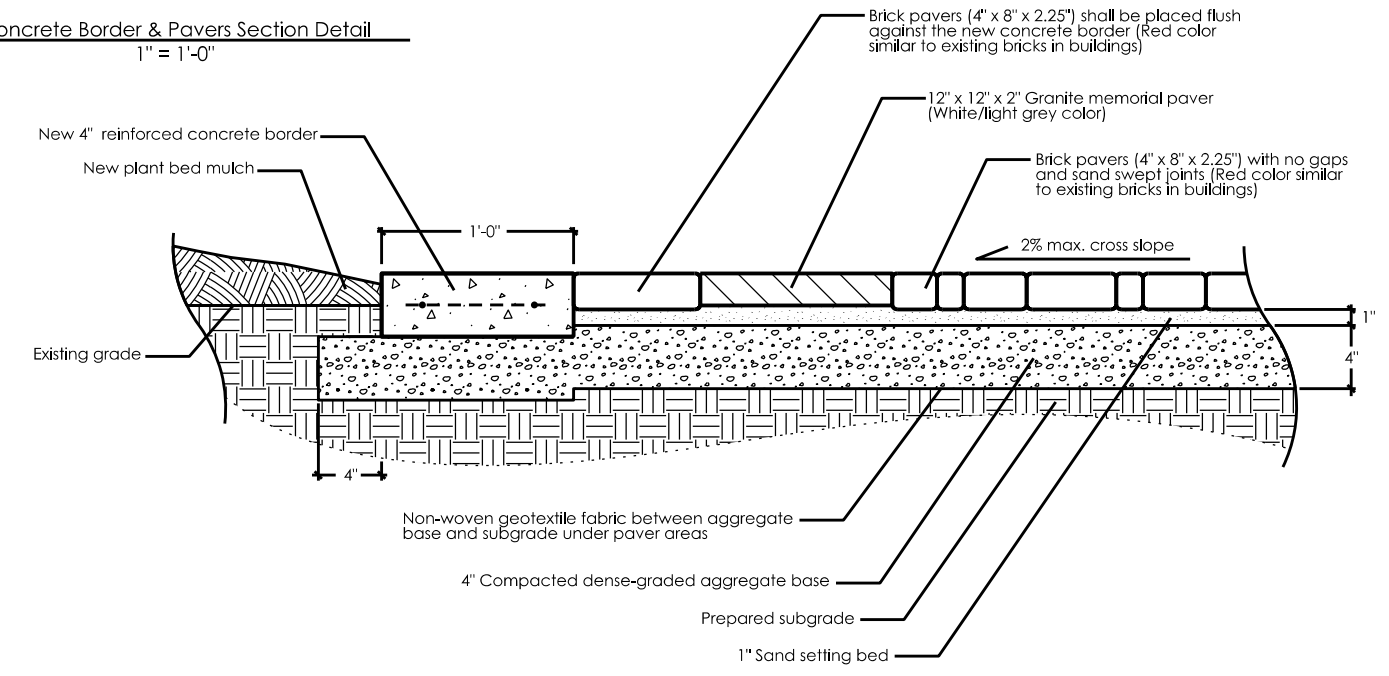

3 Flag Pole Footing Section Detail
1/2" = 1'-0"

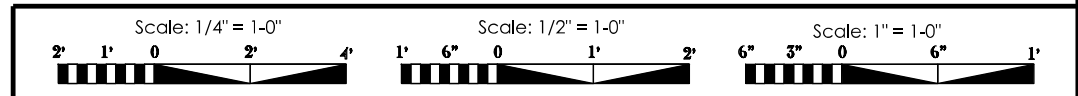
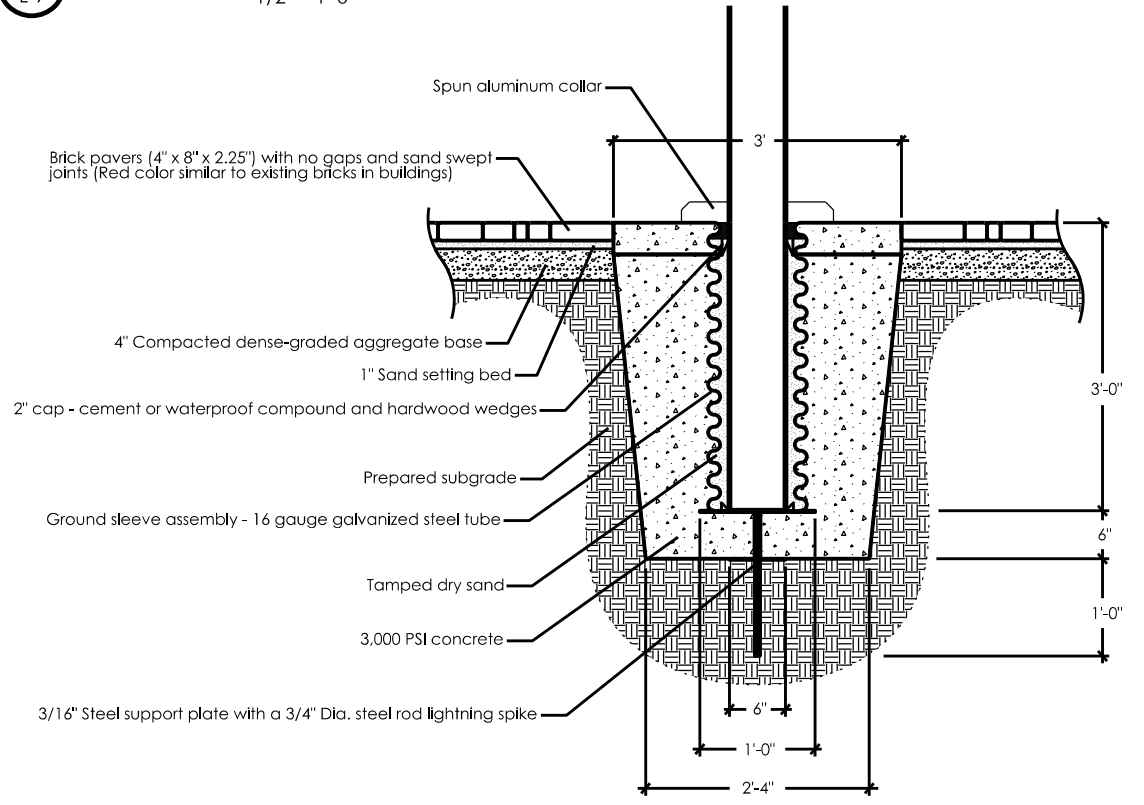

NCDOT - ROADSIDE ENVIRONMENTAL UNIT
AESTHETIC ENGINEERING SECTION
1557 MAIL SERVICE CENTER RALEIGH NC 27699-1557
PH: 919-707-2935 FAX: 919-715-2554
http://www.ncdot.org/doh/operations/dp_chief_eng/roadside/

Division 4 Office Memorial
Wilson County
WBS #: 44601.04

SHEET DESCRIPTION:	PREL. DESIGN DATE: -----	Hardscape Details
	FINAL DESIGN DATE: -----	
PROJECT LANDSCAPE ARCHITECT:	Kyle Cooper, PLA	



T.I.P. #	-----
WBS #	44601.04
FED I.D. #	4SP.10981.14
SHEET NO.:	L-9
TOTAL SHEET NO.:	L-9