

REFERENCE: SF-320029

PROJECT: BP4.R004.1

CONTENTS

<u>SHEET NO.</u>	<u>DESCRIPTION</u>
1	TITLE SHEET
2	LEGEND (SOIL & ROCK)
3	SITE PLAN
4	PROFILE
5	BORE LOG

STATE OF NORTH CAROLINA
 DEPARTMENT OF TRANSPORTATION
 DIVISION OF HIGHWAYS
 GEOTECHNICAL ENGINEERING UNIT

STRUCTURE
SUBSURFACE INVESTIGATION

COUNTY EDGEcombe
 PROJECT DESCRIPTION CULVERT NO. 29 ON -L- (SR 1124) OVER CORN CREEK AT STA. 15+39

STATE	STATE PROJECT REFERENCE NO.	SHEET NO.	TOTAL SHEETS
N.C.	SF-320029	1	5

CAUTION NOTICE

THE SUBSURFACE INFORMATION AND THE SUBSURFACE INVESTIGATION ON WHICH IT IS BASED WERE MADE FOR THE PURPOSE OF STUDY, PLANNING AND DESIGN, AND NOT FOR CONSTRUCTION OR PAY PURPOSES. THE VARIOUS FIELD BORING LOGS, ROCK CORES AND SOIL TEST DATA AVAILABLE MAY BE REVIEWED OR INSPECTED IN RALEIGH BY CONTACTING THE N. C. DEPARTMENT OF TRANSPORTATION, GEOTECHNICAL ENGINEERING UNIT AT (919) 707-6850. THE SUBSURFACE PLANS AND REPORTS, FIELD BORING LOGS, ROCK CORES AND SOIL TEST DATA ARE NOT PART OF THE CONTRACT.

GENERAL SOIL AND ROCK STRATA DESCRIPTIONS AND INDICATED BOUNDARIES ARE BASED ON A GEOTECHNICAL INTERPRETATION OF ALL AVAILABLE SUBSURFACE DATA AND MAY NOT NECESSARILY REFLECT THE ACTUAL SUBSURFACE CONDITIONS BETWEEN BORINGS OR BETWEEN SAMPLED STRATA WITHIN THE BOREHOLE. THE LABORATORY SAMPLE DATA AND THE IN SITU (IN-PLACE) TEST DATA CAN BE RELIED ON ONLY TO THE DEGREE OF RELIABILITY INHERENT IN THE STANDARD TEST METHOD. THE OBSERVED WATER LEVELS OR SOIL MOISTURE CONDITIONS INDICATED IN THE SUBSURFACE INVESTIGATIONS ARE AS RECORDED AT THE TIME OF THE INVESTIGATION. THESE WATER LEVELS OR SOIL MOISTURE CONDITIONS MAY VARY CONSIDERABLY WITH TIME ACCORDING TO CLIMATIC CONDITIONS INCLUDING TEMPERATURES, PRECIPITATION AND WIND, AS WELL AS OTHER NON-CLIMATIC FACTORS.

THE BIDDER OR CONTRACTOR IS CAUTIONED THAT DETAILS SHOWN ON THE SUBSURFACE PLANS ARE PRELIMINARY ONLY AND IN MANY CASES THE FINAL DESIGN DETAILS ARE DIFFERENT. FOR BIDDING AND CONSTRUCTION PURPOSES, REFER TO THE CONSTRUCTION PLANS AND DOCUMENTS FOR FINAL DESIGN INFORMATION ON THIS PROJECT. THE DEPARTMENT DOES NOT WARRANT OR GUARANTEE THE SUFFICIENCY OR ACCURACY OF THE INVESTIGATION MADE, NOR THE INTERPRETATIONS MADE, OR OPINION OF THE DEPARTMENT AS TO THE TYPE OF MATERIALS AND CONDITIONS TO BE ENCOUNTERED. THE BIDDER OR CONTRACTOR IS CAUTIONED TO MAKE SUCH INDEPENDENT SUBSURFACE INVESTIGATIONS AS HE DEEMS NECESSARY TO SATISFY HIMSELF AS TO CONDITIONS TO BE ENCOUNTERED ON THE PROJECT. THE CONTRACTOR SHALL HAVE NO CLAIM FOR ADDITIONAL COMPENSATION OR FOR AN EXTENSION OF TIME FOR ANY REASON RESULTING FROM THE ACTUAL CONDITIONS ENCOUNTERED AT THE SITE DIFFERING FROM THOSE INDICATED IN THE SUBSURFACE INFORMATION.

- NOTES:
- THE INFORMATION CONTAINED HEREIN IS NOT IMPLIED OR GUARANTEED BY THE N. C. DEPARTMENT OF TRANSPORTATION AS ACCURATE NOR IS IT CONSIDERED PART OF THE PLANS, SPECIFICATIONS OR CONTRACT FOR THE PROJECT.
 - BY HAVING REQUESTED THIS INFORMATION, THE CONTRACTOR SPECIFICALLY WAIVES ANY CLAIMS FOR INCREASED COMPENSATION OR EXTENSION OF TIME BASED ON DIFFERENCES BETWEEN THE CONDITIONS INDICATED HEREIN AND THE ACTUAL CONDITIONS AT THE PROJECT SITE.

PERSONNEL

A.N. JONES

N.O. MOORE

D.G. PINTER

INVESTIGATED BY T.C. BOTTOMS

DRAWN BY S.N. ZIMARINO

CHECKED BY D.N. ARGENBRIGHT

SUBMITTED BY D.N. ARGENBRIGHT

DATE MAY 2021

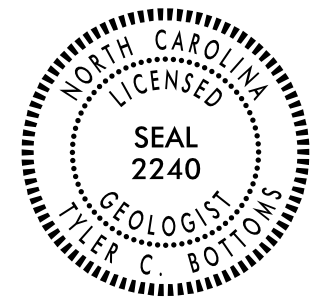

DocuSigned by:
Tyler Bottoms 5/20/2021
 48A2D3BD08CF4A6...
 SIGNATURE DATE

**DOCUMENT NOT CONSIDERED FINAL
 UNLESS ALL SIGNATURES COMPLETED**

NORTH CAROLINA DEPARTMENT OF TRANSPORTATION
DIVISION OF HIGHWAYS
GEOTECHNICAL ENGINEERING UNIT
SUBSURFACE INVESTIGATION
SOIL AND ROCK LEGEND, TERMS, SYMBOLS, AND ABBREVIATIONS

Table with multiple columns: SOIL DESCRIPTION, GRADATION, ROCK DESCRIPTION, TERMS AND DEFINITIONS, SOIL LEGEND AND AASHTO CLASSIFICATION, MINERALOGICAL COMPOSITION, COMPRESSIBILITY, PERCENTAGE OF MATERIAL, GROUND WATER, MISCELLANEOUS SYMBOLS, RECOMMENDATION SYMBOLS, ABBREVIATIONS, EQUIPMENT USED ON SUBJECT PROJECT, FRACTURE SPACING, BEDDING, INDURATION, PLASTICITY, COLOR.

PROJECT REFERENCE NO.	SHEET NO.
SF-320029	3
SITE PLAN	

SKEW: 113°

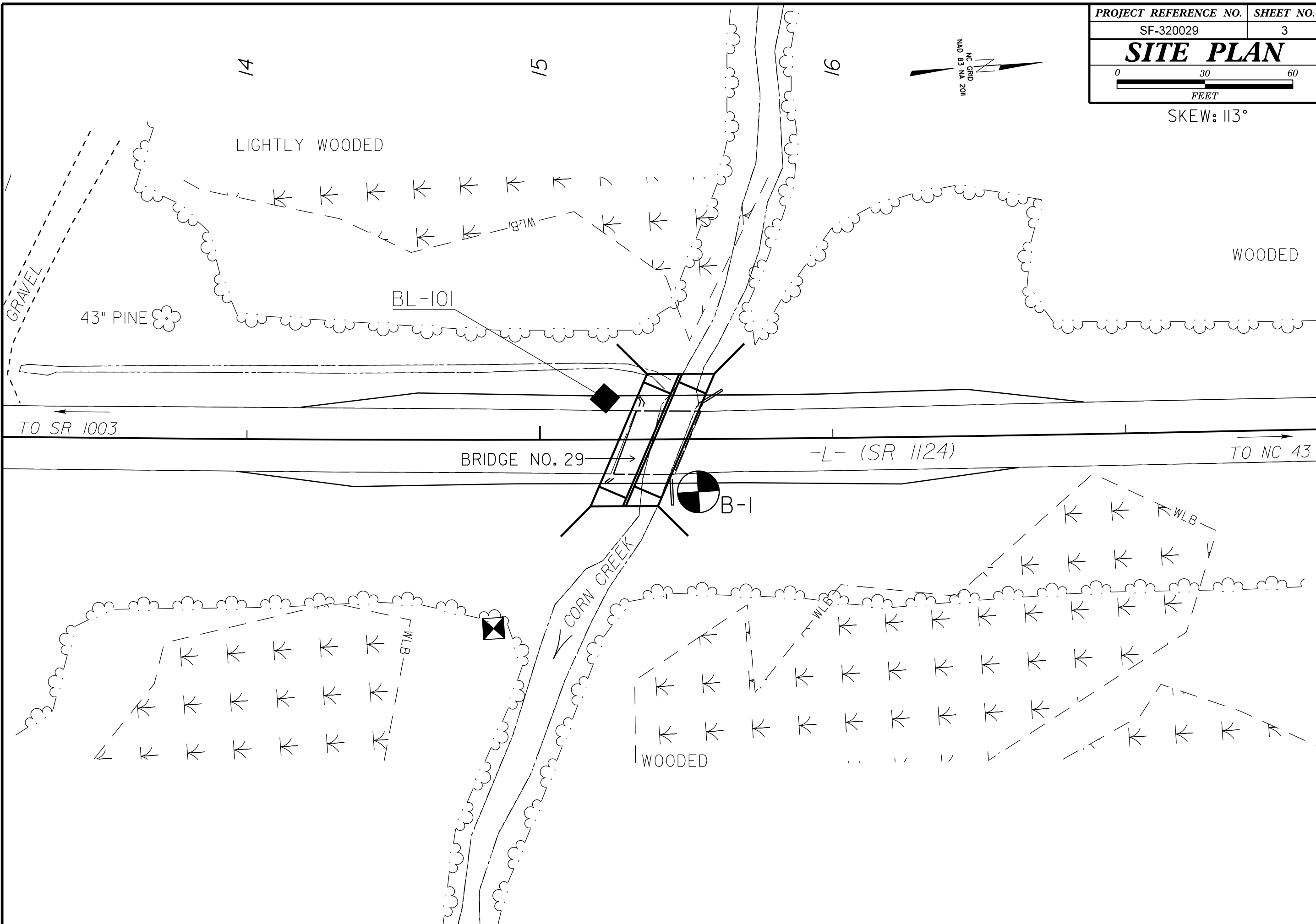
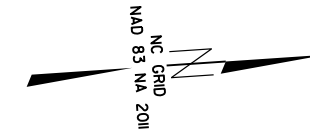

TO SR 1003

BRIDGE NO. 29

-L- (SR 1124)

TO NC 43

B-1

CORN CREEK

LIGHTLY WOODED

WOODED

WOODED

GRAVEL

43" PINE

BL-101

WLB

WLB

WLB

14

15

16

GEOTECHNICAL BORING REPORT

BORE LOG

WBS BP4.R004.1		TIP SF-320029		COUNTY EDGECOMBE		GEOLOGIST Jones, A. N.											
SITE DESCRIPTION Culvert No. 29 on -L- (SR 1124) over Corn Creek							GROUND WTR (ft)										
BORING NO. B-1		STATION 15+54		OFFSET 18 ft RT		ALIGNMENT -L-											
COLLAR ELEV. 88.4 ft		TOTAL DEPTH 36.2 ft		NORTHING 762,073		EASTING 2,372,554											
DRILL RIG/HAMMER EFF./DATE RFC0067 CME-550X 88% 10/22/2020				DRILL METHOD Wash Boring		HAMMER TYPE Automatic											
DRILLER Pinter, D. G.		START DATE 05/06/21		COMP. DATE 05/06/21		SURFACE WATER DEPTH N/A											
ELEV (ft)	DRIVE ELEV (ft)	DEPTH (ft)	BLOW COUNT			BLOWS PER FOOT					SAMP. NO.	LOG	SOIL AND ROCK DESCRIPTION				
			0.5ft	0.5ft	0.5ft	0	25	50	75	100			ELEV. (ft)	DEPTH (ft)			
90														88.4	0.0	GROUND SURFACE	
																	ROADWAY EMBANKMENT ORANGE AND GRAY SANDY CLAY, MOIST TO WET
85	83.7	4.7	WOH	WOH	WOH									83.2	5.2	ALLUVIAL GRAY SANDY SILT WITH TRACE ORGANICS AND GRAVEL, WET	
80	78.7	9.7	2	7	8									77.9	10.5	COASTAL PLAIN GRAY AND BLUE SILTY SAND WITH TRACE SHELL FRAGMENTS AND GRAVEL, SATURATED (YORKTOWN FORMATION)	
75	76.2	12.2	3	2	4									74.2	14.2	GRAY AND BLUE SANDY SILT WITH TRACE MICA AND GRAVEL, WET	
70	73.7	14.7	WOH	1	2									69.2	19.2	GRAY AND BLUE SILTY SAND WITH TRACE MICA, SATURATED	
	71.2	17.2	WOH	1	3									65.2	23.2	GRAY AND BLUE SILTY CLAY, WET	
	68.7	19.7	2	4	2									60.4	28.0	GRAY AND BLUE SILTY SAND WITH SHELL FRAGMENTS, SATURATED	
65	66.2	22.2	1	1	2									52.2	36.2	Boring Terminated at Elevation 52.2 ft in Loose Silty Sand	
	63.7	24.7	5	5	5												
60	58.7	29.7	1	1	1												
55	53.7	34.7	3	3	4												

NCDOT BORE DOUBLE_SF320029_GEO_CULV.GPJ_NC_DOT.GDT_5/12/21