

**This electronic collection of documents is provided
for the convenience of the user
and is Not a Certified Document –**

**The documents contained herein were originally issued
and sealed by the individuals whose names and license
numbers appear on each page, on the dates appearing
with their signature on that page.**

**This file or an individual page
shall not be considered a certified document.**

000

TIP PROJECT: W-5204-G

CONTRACT: DD00262

STATE OF NORTH CAROLINA
DIVISION OF HIGHWAYS

JOHNSTON COUNTY

STATE	STATE PROJECT REFERENCE NO.	SHEET NO.	TOTAL SHEETS
N.C.	W-5204-G	1	
STATE PROJ. NO.	F. A. PROJ. NO.	DESCRIPTION	
45334.1.FD6	HSIP-1330(10)	PE	
45334.2.6	HSIP-1330(10)	RW & UTIL.	
45334.3.9	HSIP-1330(10)	CONST.	

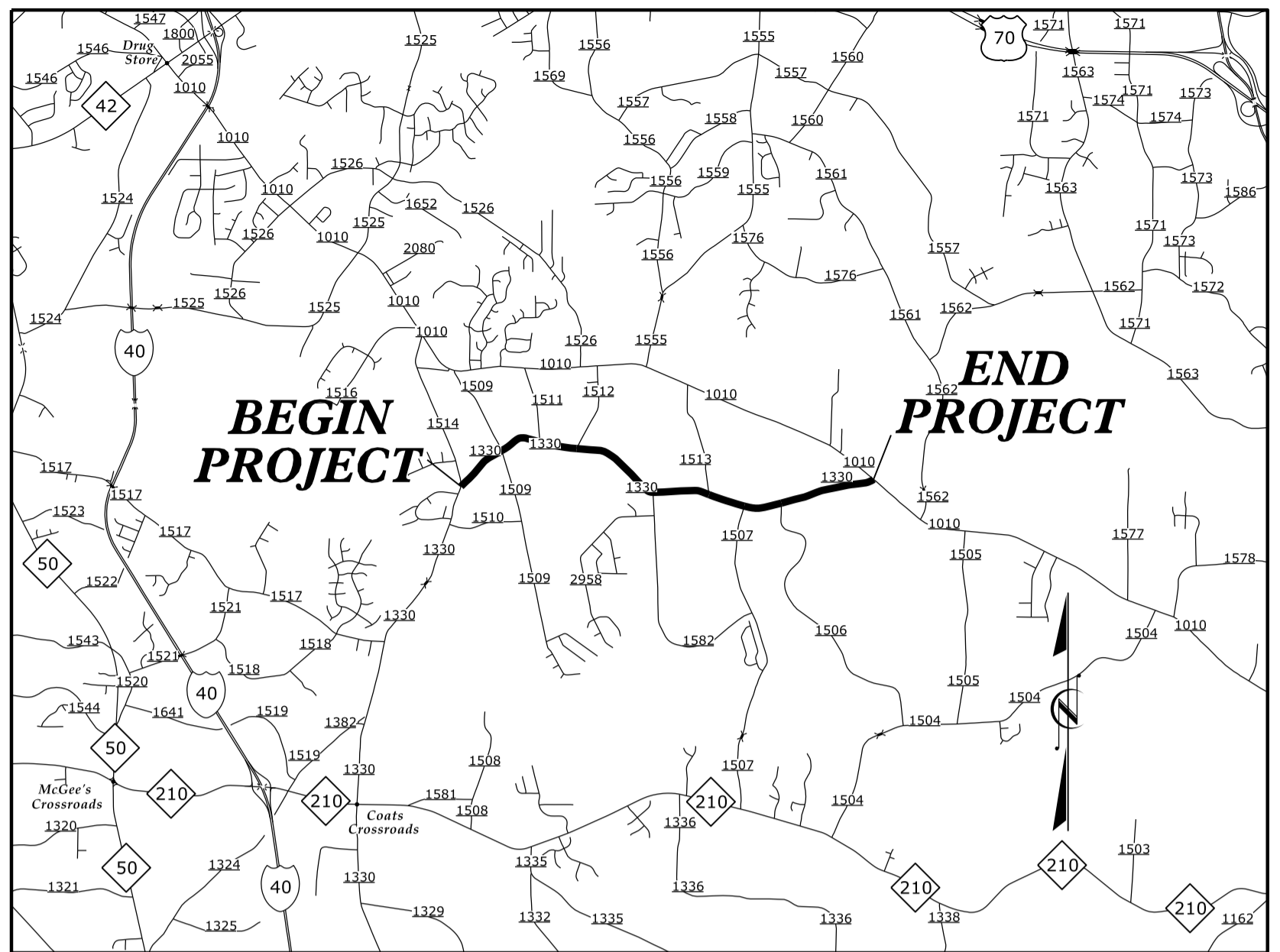

VICINITY MAP

LOCATION: SECTION 1: SR 1330 (POLENTA RD) FROM SR 1514 (MCLEMORE RD) TO SR 1010 (CLEVELAND RD).
SECTION 2: SR 1330 (RALEIGH RD) FROM SR 1510 (SONNY RD) TO SR 1514 (MCLEMORE RD), AND NORTH ALONG SR 1514 (MCLEMORE RD) TO SR 3162 (LASSITER FARM RD).

TYPE OF WORK: SECTION 1: GRADING, PAVING AND SIGNING
SECTION 2: SIGNING

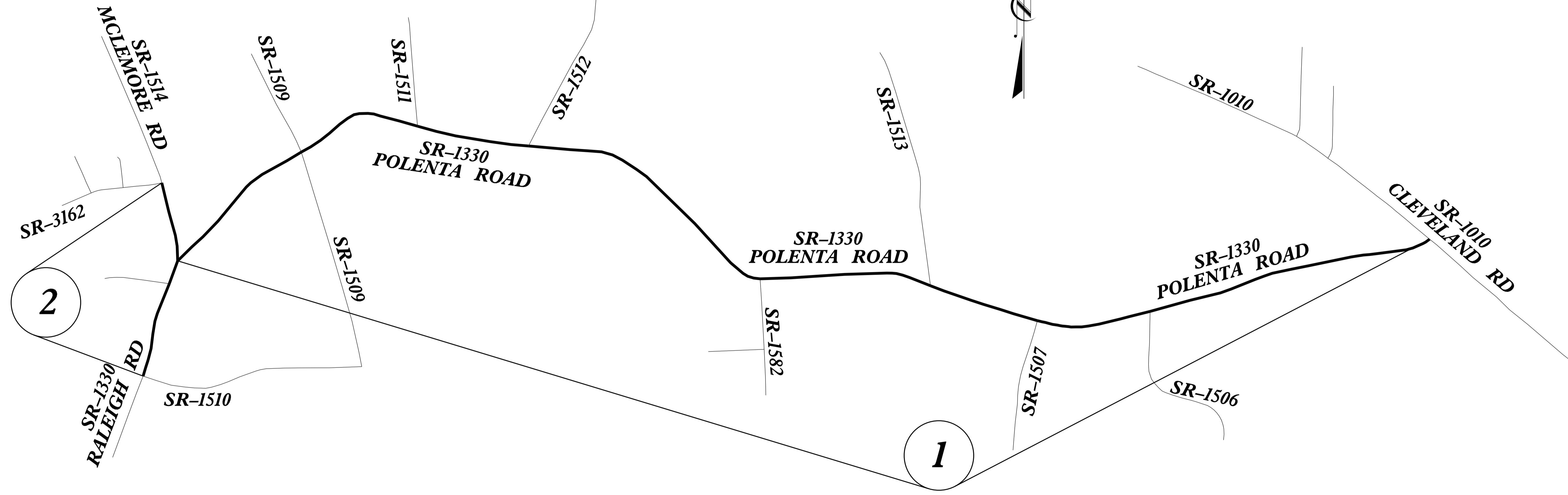

DESIGN DATA
ADT 2016 = 5700

FUNC CLASS = LOCAL

SUBREGIONAL TIER

PROJECT LENGTH

LENGTH ROADWAY TIP PROJECT W-5204-G = 3.75 MILES
TOTAL LENGTH TIP PROJECT W-5204-G = 3.75 MILES

Prepared in the Office of:
DIVISION OF HIGHWAYS
Division 4 DDC
509 Ward Blvd., Wilson NC, 27895

2018 STANDARD SPECIFICATIONS

RIGHT OF WAY DATE:
N/A

LETTING DATE:
MAY 22, 2018

R.L. KEETER, P.E.
PROJECT ENGINEER

N.A. GAINEY, P.E.
PROJECT DESIGN ENGINEER

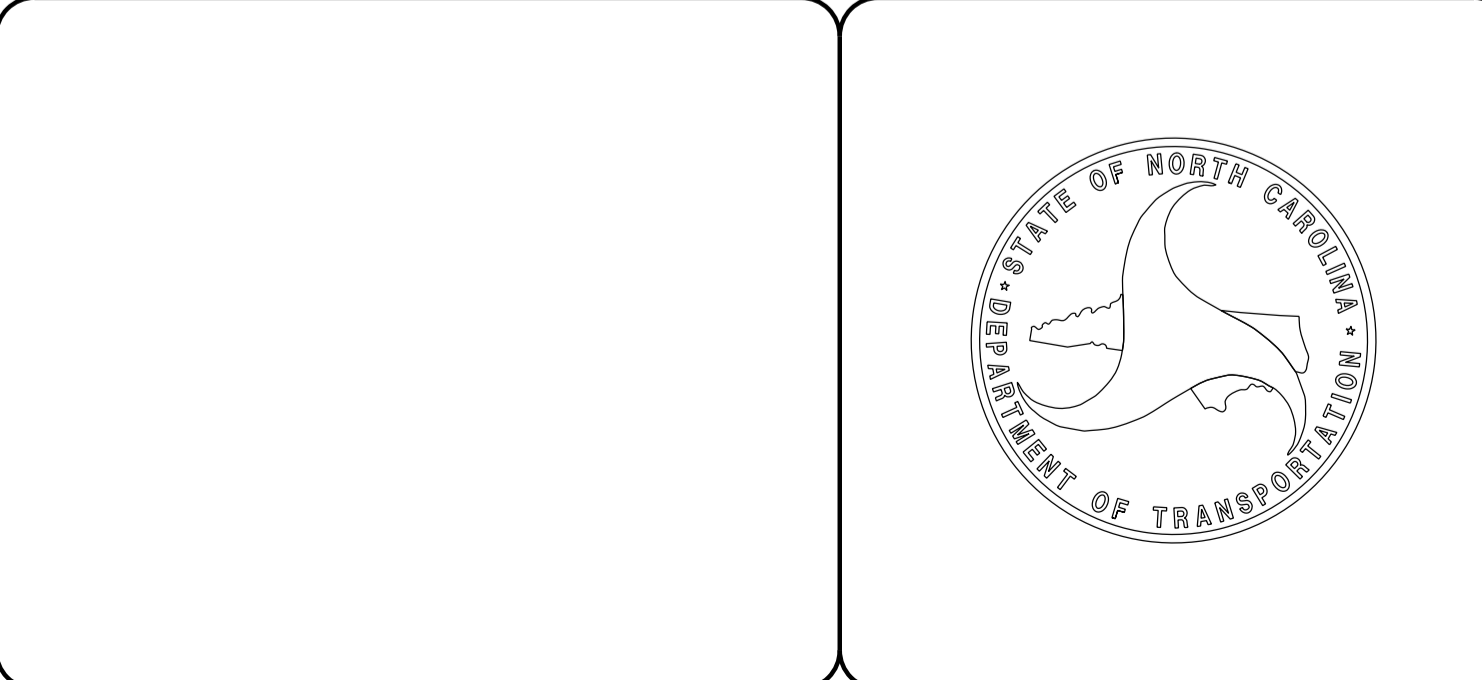

27-MAR-2018 15:58
Z:\W5204G_Roadway\Proj\W5204G_ddc4_1sh.dgn
\$\$\$\$\$USER\$NAME\$\$\$\$\$

6/2/99

PAVEMENT SCHEDULE

B1	PROP. OPEN-GRADED ASPHALT FRICTION COURSE, TYPE FC-1 MOD., AT AN AVERAGE RATE OF 90 LBS. PER SQ. YARD	T	EARTH MATERIAL
C1	PROP. APPROX. 1.5" ASPHALT CONC. SURFACE COURSE, TYPE S9.5B, AT AN AVERAGE RATE OF 168 LBS. PER SQ. YARD	U	EXISTING PAVEMENT
E1	PROP. APPROX. 5.5" ASPHALT CONC. BASE COURSE, TYPE B25.0C, AT AN AVERAGE RATE OF 627 LBS. PER SQ. YARD	Z	SHOULDER RECONSTRUCTION
M1	MILL EXISTING ASPHALT PAVEMENT 1.5" IN DEPTH		

NOTE: PAVEMENT EDGE SLOPES ARE 1:1 UNLESS SHOWN OTHERWISE.

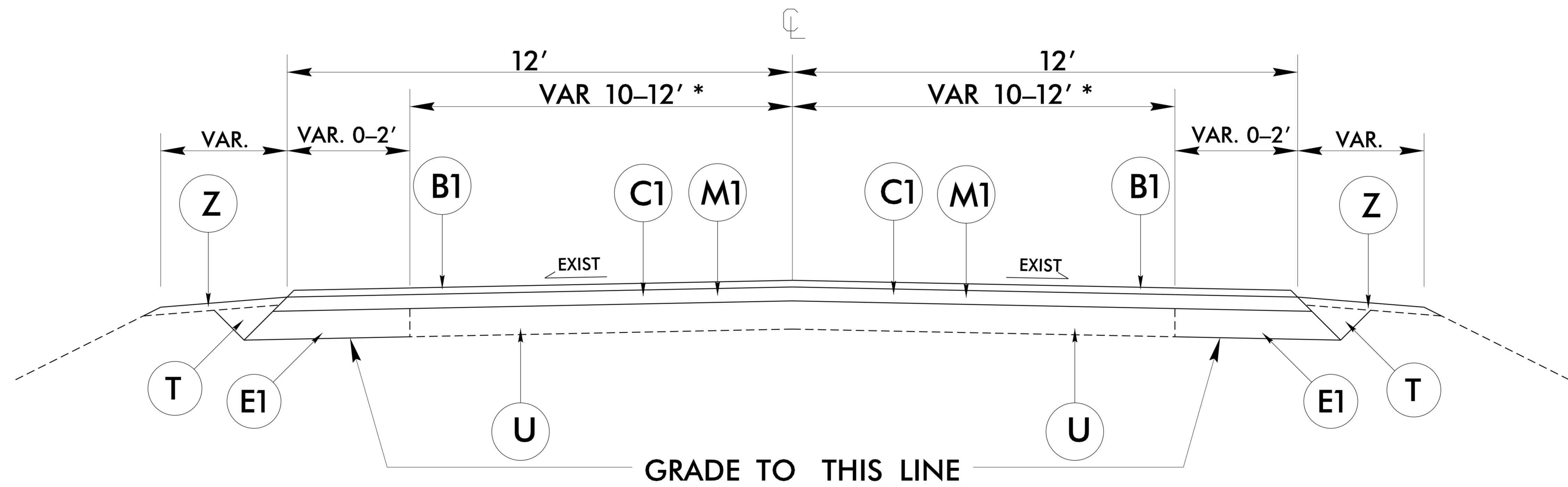

TYPICAL SECTION NO. 1
 SR 1330 – FROM SR 1514 TO SR 1010

*
 IN LOCATIONS WHERE EXISTING PAVEMENT IS WIDER THAN 12' EACH SIDE OF THE CENTERLINE (TURN LANES, 3 LANE SECTIONS AND PREVIOUSLY WIDENED AREAS) MAINTAIN EXISTING WIDTH. MILL, FILL AND OVERLAY WITH OGAF C PER THE PAVEMENT SCHEDULE.

NOTE: FINAL PAVEMENT MARKINGS TO BE PLACED TO MAINTAIN 1' PAVED SHOULDERS

27-MAR-2008 15:31
Z:\W5204G\Roadway\Proj\W-5204G-ddc4-1.txd

PROJECT NO.	SHEET NO.	TOTAL NO.
W-5204G - 45334.3.9		

SUMMARY OF QUANTITIES

PROJECT NO	COUNTY	MAP NO	ROUTE	DESCRIPTION	TYP	LANES	LANE TYPE	FINAL SURFACE TESTING REQUIRED	WARM MIX ASPHALT REQUIRED	LENGTH MI	WIDTH FT	1.5" MILLING	ASPHALT CONC BASE COURSE, TYPE B25.0C TON	ASPHALT CONC SURFACE COURSE, TYPE S9.5B TON	OGAFC, TYPE FC- 1 MOD TON	ASPHALT BINDER FOR PLANT MIX TON	POLYMER MODIFIED ASPHALT BINDER FOR PLANT MIX TON	SHOULDER RECONSTRUCTION SMI	AGGREGATE SHOULDER BORROW TON	INDUCTIVE LOOP SAWCUT LF
W-5204G	Johnston	1	SR-1330	SR-1330 FROM SR-1514 TO SR-1010	1	2	2WU	NO	NO	3.75	24	52310	1,820	4,890	2,620	375	160	7.50	2,000.00	400
TOTAL FOR MAP NO. 1										3.75		52,310	1,820	4,890	2,620	375	160	7.50	2,000	400
GRAND TOTAL										3.75		52,310	1,820	4,890	2,620	375	160	7.50	2,000	400

PROJECT NO.	SHEET NO.	TOTAL NO.
W-5204G - 45334.3.9		

THERMOPLASTIC AND PAINT QUANTITIES

PROJECT NO	COUNTY	MAP NO	ROUTE	DESCRIPTION	TYP NO	LANES	LANE TYPE	LENGTH	WIDTH	4413000000-E	4457000000-N	4510000000-N	4688000000-E	4690000000-E		4700000000-E	4710000000-E
										WORK ZONE ADV/GEN WARNING SIGNING SF	TEMPORARY TRAFFIC CONTROL LS	LAW ENFORCEMENT HR	6" X 90 M WHITE THERMO LF	6" X 120 M YELLOW THERMO LF	6" X 120 M WHITE THERMO LF	12" X 90 M YELLOW THERMO LF	24" X 120 M WHITE THERMO LF
W-5204G	Johnston	1	SR-1330	SR-1330 FROM SR-1514 TO SR-1010	1	2	2WU	3.75	24	420	1	40	39,600	38,382	614	204	220
TOTAL FOR MAP NO. 1								3.75		420	1	40	39,600	38,382	614	204	220
GRAND TOTAL								3.75		420	1	40	39,600	38,382	614	204	220
														38,996			

PROJECT NO.	SHEET NO.	TOTAL NO.
W-5204G - 45334.3.9		

THERMOPLASTIC AND PAINT QUANTITIES

PROJECT NO	COUNTY	MAP NO	ROUTE	DESCRIPTION	TYP	LANES	LANE TYPE	LENGTH	WIDTH	4725000000-E				4721000000-E	4815000000-E		4825000000-E
										THERMO LT ARROW 90 M EA	THERMO RT ARROW 90 M EA	THERMO STR ARROW 90 M EA	THERMO STR+RT ARROW 90 M EA	THERMO CHARACTERS 120 M (SCHOOL) & (STOP AHEAD) EA	6" WHITE PAINT LF	6" YELLOW PAINT LF	12" YELLOW PAINT LF
W-5204G	Johnston	1	SR-1330	SR-1330 FROM SR-1514 TO SR-1010	1	2	2WU	3.75	24	16	5	2	1	30	40,214	38,382	204
TOTAL FOR MAP NO. 1								3.75		16	5	2	1	30	40,214	38,382	204
GRAND TOTAL								3.75		16	5	2	1	30	40,214	38,382	204
										24				78,596			

PROJECT NO.	SHEET NO.	TOTAL NO.
W-5204G - 45334.3.9		

THERMOPLASTIC AND PAINT QUANTITIES

PROJECT NO	COUNTY	MAP NO	ROUTE	DESCRIPTION	TYP NO	LANES	LANE TYPE	LENGTH	WIDTH	4835000000-E	4845000000-N				4840000000-N	4900000000-N
										24" WHITE PAINT LF	PAINT LT ARROW EA	PAINT RT ARROW EA	PAINT STR ARROW EA	PAINT STR+RT ARROW EA	PAINT CHARACTERS (SCHOOL) EA	RAISED PAVEMENT MARKERS EA
W-5204G	Johnston	1	SR-1330	SR-1330 FROM SR-1514 TO SR-1010	1	2	2WU	3.75	24	220	16	5	2	1	30	340
TOTAL FOR MAP NO. 1								3.75		220	16	5	2	1	30	340
GRAND TOTAL								3.75		220	16	5	2	1	30	340
										24						

**STATE OF NORTH CAROLINA
DEPARTMENT OF TRANSPORTATION**

**SIGNING PLAN
JOHNSTON COUNTY**

**LOCATION: SECTION 1: SR 1330 (POLENTA RD) FROM SR 1514 (MCLEMORE RD) TO SR 1010 (CLEVELAND RD)
SECTION 2: SR 1330 (RALEIGH RD) FROM SR 1510 (SONNY RD) TO SR 1514 (MCLEMORE RD), AND
NORTH ALONG SR 1514 (MCLEMORE RD) TO SR 3162 (LASSITER FARM RD).**

T.I.P.: W-5204G

ROADWAY STANDARD DRAWING

THE FOLLOWING ROADWAY STANDARDS AS APPEAR IN "ROADWAY STANDARD DRAWINGS" - PROJECT SERVICES UNIT - N.C. DEPARTMENT OF TRANSPORTATION - RALEIGH, N.C., DATED JANUARY 2018 ARE APPLICABLE TO THIS PROJECT AND BY REFERENCE HEREBY ARE CONSIDERED A PART OF THESE PLANS:

STD. NO.	TITLE
904.10	ORIENTATION OF GROUND MOUNTED SIGNS
904.50	MOUNTING OF TYPE 'D', 'E' AND 'F' SIGNS ON 'U' CHANNEL POSTS

SUMMARY OF QUANTITIES

ITEM NO.		ITEM DESCRIPTION	QUANTITY	UNIT
DESC. NO.	SECT. NO.			
4025000000	901	CONTRACTOR FURNISHED, TYPE E SIGN	296	SF
4072000000	903	SUPPORTS, 3 LB STEEL U-CHANNEL	556	LF
4102000000	904	SIGN ERECTION, TYPE E	53	EA
4155000000	907	DISPOSAL OF SIGN SYSTEM, U-CHANNEL	52	EA
4158000000	907	DISPOSAL OF SIGN SYSTEM, WOOD	1	EA





GENERAL NOTES

- . SIGNS FURNISHED BY CONTRACTOR
- . ALL EXISTING SIGNS WITHIN THE PROJECT LIMITS SHALL REMAIN UNLESS REPLACED BY NEW SIGN SYSTEM AS INDICATED ON SHEET SIGN-3
- . ALL 'E' AND 'F' SIGNS SHALL BE FIELD LOCATED BY THE ENGINEER
- . WHEN EXISTING SIGNS ARE REMOVED AND INSTALLED ON NEW SUPPORTS, THE RE-ERECTION SHALL IMMEDIATELY FOLLOW THE REMOVAL.
- . THE BACKGROUND FOR TYPE E & F SIGNS SHALL BE TYPE C REFLECTIVE SHEETING.

INDEX

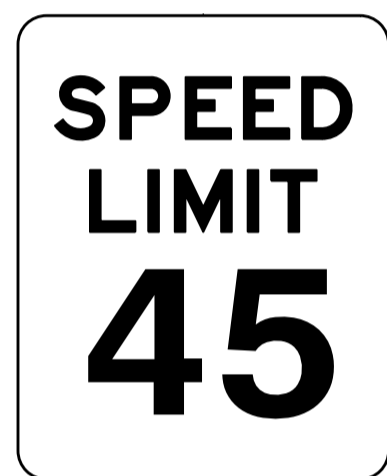
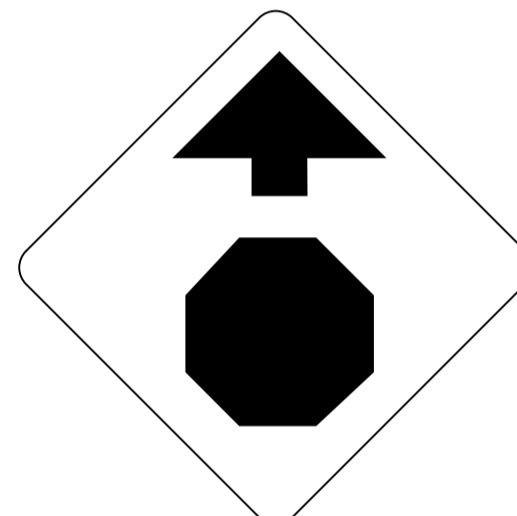
SHEET NO.	DESCRIPTION
SIGN-1	TITLE SHEET AND "E" SIGNS
SIGN-2	TYPE "E" SIGNS (CONT.)
SIGN-3	SIGNING LOCATION SUMMARY

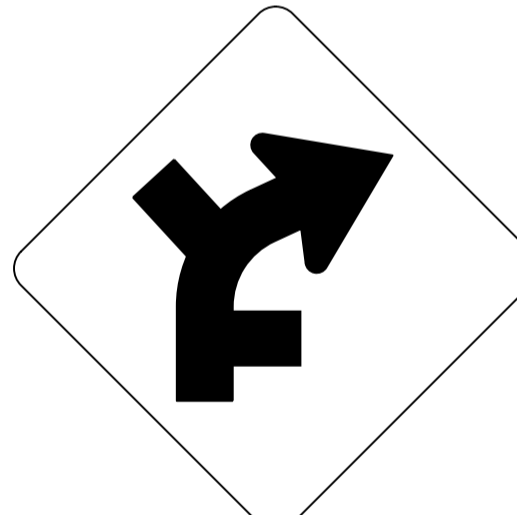
TYPE "E" SIGNS

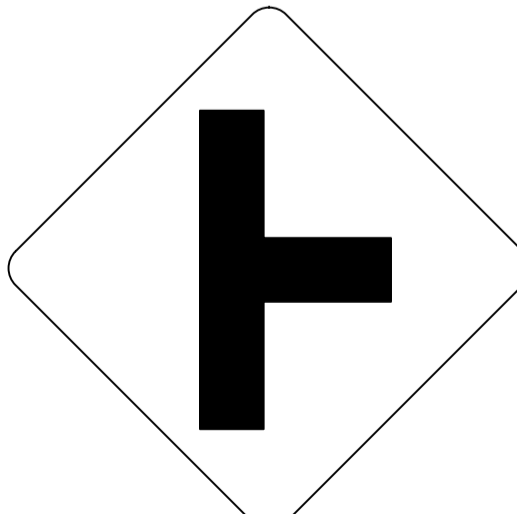
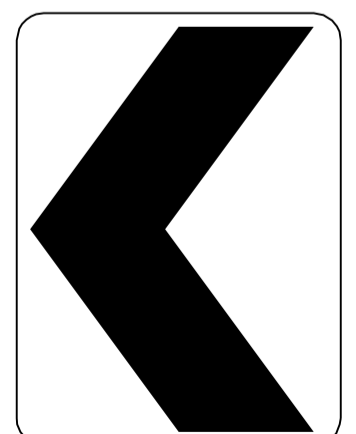
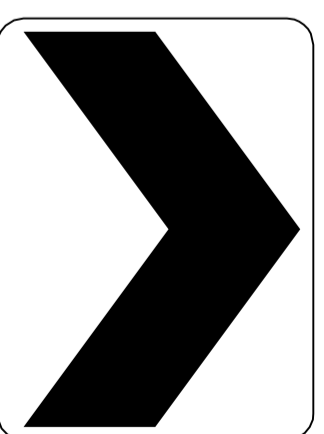
<p>(401) QUANTITY REQ'D <u>15</u></p>  <p>24 X 30 R2-1</p> <p>ONE "U" POST PER SIGN</p>	<p>(402) QUANTITY REQ'D <u>1</u></p>  <p>36 X 36 W3-1</p> <p>ONE "U" POST PER SIGN</p>	<p>(403) QUANTITY REQ'D <u>2</u></p>  <p>36 X 36 W1-10L</p> <p>ONE "U" POST PER SIGN</p>
<p>(404) QUANTITY REQ'D <u>1</u></p>  <p>36 X 36 W1-10R</p> <p>ONE "U" POST PER SIGN</p>	<p>(405) QUANTITY REQ'D <u>1</u></p>  <p>36 X 36 W1-10R MODIFIED</p> <p>ONE "U" POST PER SIGN</p>	<p>(406) QUANTITY REQ'D <u>5</u></p>  <p>24 X 24 W13-1</p> <p>ONE "U" POST PER SIGN</p>
<p>(407) QUANTITY REQ'D <u>1</u></p>  <p>36 X 36 W2-2R</p> <p>ONE "U" POST PER SIGN</p>	<p>(408) QUANTITY REQ'D <u>12</u></p>  <p>24 X 30 W1-8L</p> <p>ONE "U" POST PER SIGN</p>	<p>(409) QUANTITY REQ'D <u>12</u></p>  <p>24 X 30 W1-8R</p> <p>ONE "U" POST PER SIGN</p>



STATE OF NORTH CAROLINA
DEPARTMENT OF TRANSPORTATION

T.I.P.: W-5204G

SIGNING PLAN
JOHNSTON COUNTY

LOCATION: SECTION 1: SR 1330 (POLENTA RD) FROM SR 1514 (MCLEMORE RD) TO SR 1010 (CLEVELAND RD)
SECTION 2: SR 1330 (RALEIGH RD) FROM SR 1510 (SONNY RD) TO SR 1514 (MCLEMORE RD), AND
NORTH ALONG SR 1514 (MCLEMORE RD) TO SR 3162 (LASSITER FARM RD).

TYPE "E" SIGNS

<p>410 QUANTITY REQ'D <u>2</u></p>  <p>36 X 36 W1-2R</p> <p>ONE "U" POST PER SIGN</p>	<p>411 QUANTITY REQ'D <u>1</u></p>  <p>36 X 36 W1-2L</p> <p>ONE "U" POST PER SIGN</p>
---	---

PROPOSED SIGN LOCATIONS

SECTION 1: SR 1330 (POLENTA ROAD)

Mile Post	Side of Road	Sign face	Sign Number	Description
0.00				Intersection SR 1010 (for reference only)
0.04	Right	West Bound	401	Speed Limit 45 MPH
0.09	Left	East Bound	402	Stop Ahead
0.37	Left	East Bound	401	Speed Limit 45 MPH
0.40	Right	West Bound	401	Speed Limit 45 MPH
0.75	Left	East Bound	401	Speed Limit 45 MPH
0.79				Intersection SR 1506 (for reference only)
0.82	Right	West Bound	401	Speed Limit 45 MPH
1.07	Left	East Bound	401	Speed Limit 45 MPH
1.10				Intersection SR 1507 (for reference only)
1.15	Right	West Bound	401	Speed Limit 45 MPH
1.36	Left	East Bound	401	Speed Limit 45 MPH
1.37	Right	West Bound	403 & 406	W1-10L & W13-1
1.41				Intersection SR 1513 (for reference only)
1.65	Left	East Bound	405 & 406	W1-10R Modified & W13-1
1.77	Left	East Bound	401	Speed Limit 45 MPH
1.78	Right	West Bound	410 & 406	W1-2R & W13-1
1.88				Intersection SR 1582 (for reference only)
1.90	Left	Both	408 & 409	24"x30" Chevron
1.91	Left	Both	408 & 409	24"x30" Chevron
1.92	Left	Both	408 & 409	24"x30" Chevron
1.93	Left	Both	408 & 409	24"x30" Chevron
1.94	Left	Both	408 & 409	24"x30" Chevron
2.23	Right	West Bound	401	Speed Limit 45 MPH
2.29	Right	West Bound	411	W1-2L
2.38	Left	East Bound	401	Speed Limit 45 MPH
2.52	Left	East Bound	410	W1-2R
2.64				Intersection SR 1512 (for reference only)
2.67	Right	West Bound	401	Speed Limit 45 MPH
2.71	Left	East Bound	401	Speed Limit 45 MPH
2.80	Right	West Bound	407	W2-2R
2.95				Intersection SR 1511 (for reference only)
3.07	Left	Both	408 & 409	24"x30" Chevron
3.10	Left	Both	408 & 409	24"x30" Chevron
3.13	Left	Both	408 & 409	24"x30" Chevron
3.16	Left	Both	408 & 409	24"x30" Chevron
3.30				Intersection SR 1509 (for reference only)
3.64	Left	East Bound	401	Speed Limit 45 MPH

SECTION 2: SR 1330 (RALEIGH ROAD) / SR 1514 (MCLEMORE ROAD)

Mile Post	Side of Road	Sign face	Sign Number	Description
0.00				Intersection of SR 1510 (for reference only)
0.25	Right	North Bound	403 & 406	W1-10L & W13-1
0.32	Right	Both	408 & 409	24"x30" Chevron
0.34				Intersection of SR 1330 (for reference only)
0.37	Right	Both	408 & 409	24"x30" Chevron
0.38	Right	Both	408 & 409	24"x30" Chevron
0.44	Right	North Bound	401	Speed Limit 45 MPH
0.44	Left	South Bound	404 & 406	W1-10R & W13-1
0.55				Intersection of SR 3162 (for reference only)

NOTE: REMOVE EXISTING SIGN SYSTEM AT PROPOSED SIGN LOCATIONS
ALL OTHER SIGNS WITHIN PROJECT LIMITS TO REMAIN