

STATE	STATE PROJECT REFERENCE NO.	SHEET NO.	TOTAL SHEETS
N.C.	SF-970091	1	6

REFERENCE: SF-970091

PROJECT: 17BP.4.R.94

**STATE OF NORTH CAROLINA
DEPARTMENT OF TRANSPORTATION
DIVISION OF HIGHWAYS
GEOTECHNICAL ENGINEERING UNIT**

**STRUCTURE
SUBSURFACE INVESTIGATION**

COUNTY WILSON
PROJECT DESCRIPTION REPLACE BRIDGE NO. 091
ON SR 1339 (SHARPE STORE ROAD) OVER
TRIBUTARY OF TOWN CREEK
SITE DESCRIPTION 13+22 -L-

CONTENTS

<u>SHEET NO.</u>	<u>DESCRIPTION</u>
1	TITLE SHEET
2, 2A	LEGEND (SOIL & ROCK)
3	SITE PLAN
4-5	BORE LOGS

PERSONNEL

<u>B. SMITH, PG</u>
<u>M. SHIPMAN, EI</u>
<u>A. RULEY</u>
<u>M.G. MOSELEY</u>
<u>J. MOSELEY</u>

INVESTIGATED BY B. SMITH, PG
DRAWN BY B. SMITH, PG
CHECKED BY B. WORLEY, PG
SUBMITTED BY B. SMITH, PG
DATE NOVEMBER, 2018

Prepared in the Office of:



NC FIRM LICENSE No: P-0339 and C-487
504 Meadowlands Drive
Hillsborough, NC 27278
(919) 732-3883
(919) 732-6676 (FAX)

CAUTION NOTICE

THE SUBSURFACE INFORMATION AND THE SUBSURFACE INVESTIGATION ON WHICH IT IS BASED WERE MADE FOR THE PURPOSE OF STUDY, PLANNING AND DESIGN, AND NOT FOR CONSTRUCTION OR PAY PURPOSES. THE VARIOUS FIELD BORING LOGS, ROCK CORES AND SOIL TEST DATA AVAILABLE MAY BE REVIEWED OR INSPECTED IN RALEIGH BY CONTACTING THE N. C. DEPARTMENT OF TRANSPORTATION, GEOTECHNICAL ENGINEERING UNIT AT (919) 707-6850. THE SUBSURFACE PLANS AND REPORTS, FIELD BORING LOGS, ROCK CORES AND SOIL TEST DATA ARE NOT PART OF THE CONTRACT.

GENERAL SOIL AND ROCK STRATA DESCRIPTIONS AND INDICATED BOUNDARIES ARE BASED ON A GEOTECHNICAL INTERPRETATION OF ALL AVAILABLE SUBSURFACE DATA AND MAY NOT NECESSARILY REFLECT THE ACTUAL SUBSURFACE CONDITIONS BETWEEN BORINGS OR BETWEEN SAMPLED STRATA WITHIN THE BOREHOLE. THE LABORATORY SAMPLE DATA AND THE IN SITU (IN-PLACE) TEST DATA CAN BE RELIED ON ONLY TO THE DEGREE OF RELIABILITY INHERENT IN THE STANDARD TEST METHOD. THE OBSERVED WATER LEVELS OR SOIL MOISTURE CONDITIONS INDICATED IN THE SUBSURFACE INVESTIGATIONS ARE AS RECORDED AT THE TIME OF THE INVESTIGATION. THESE WATER LEVELS OR SOIL MOISTURE CONDITIONS MAY VARY CONSIDERABLY WITH TIME ACCORDING TO CLIMATIC CONDITIONS INCLUDING TEMPERATURES, PRECIPITATION AND WIND, AS WELL AS OTHER NON-CLIMATIC FACTORS.

THE BIDDER OR CONTRACTOR IS CAUTIONED THAT DETAILS SHOWN ON THE SUBSURFACE PLANS ARE PRELIMINARY ONLY AND IN MANY CASES THE FINAL DESIGN DETAILS ARE DIFFERENT. FOR BIDDING AND CONSTRUCTION PURPOSES, REFER TO THE CONSTRUCTION PLANS AND DOCUMENTS FOR FINAL DESIGN INFORMATION ON THIS PROJECT. THE DEPARTMENT DOES NOT WARRANT OR GUARANTEE THE SUFFICIENCY OR ACCURACY OF THE INVESTIGATION MADE, NOR THE INTERPRETATIONS MADE, OR OPINION OF THE DEPARTMENT AS TO THE TYPE OF MATERIALS AND CONDITIONS TO BE ENCOUNTERED. THE BIDDER OR CONTRACTOR IS CAUTIONED TO MAKE SUCH INDEPENDENT SUBSURFACE INVESTIGATIONS AS HE DEEMS NECESSARY TO SATISFY HIMSELF AS TO CONDITIONS TO BE ENCOUNTERED ON THE PROJECT. THE CONTRACTOR SHALL HAVE NO CLAIM FOR ADDITIONAL COMPENSATION OR FOR AN EXTENSION OF TIME FOR ANY REASON RESULTING FROM THE ACTUAL CONDITIONS ENCOUNTERED AT THE SITE DIFFERING FROM THOSE INDICATED IN THE SUBSURFACE INFORMATION.

NOTES:

- THE INFORMATION CONTAINED HEREIN IS NOT IMPLIED OR GUARANTEED BY THE N. C. DEPARTMENT OF TRANSPORTATION AS ACCURATE NOR IS IT CONSIDERED PART OF THE PLANS, SPECIFICATIONS OR CONTRACT FOR THE PROJECT.
- BY HAVING REQUESTED THIS INFORMATION, THE CONTRACTOR SPECIFICALLY WAIVES ANY CLAIMS FOR INCREASED COMPENSATION OR EXTENSION OF TIME BASED ON DIFFERENCES BETWEEN THE CONDITIONS INDICATED HEREIN AND THE ACTUAL CONDITIONS AT THE PROJECT SITE.



DocuSigned by: 1/30/2019
BE61A49304C542F SIGNATURE DATE

**DOCUMENT NOT CONSIDERED FINAL
UNLESS ALL SIGNATURES COMPLETED**

**NORTH CAROLINA DEPARTMENT OF TRANSPORTATION
DIVISION OF HIGHWAYS
GEOTECHNICAL ENGINEERING UNIT**

SUBSURFACE INVESTIGATION





SOIL AND ROCK LEGEND, TERMS, SYMBOLS, AND ABBREVIATIONS (PAGE 1 OF 2)

SOIL DESCRIPTION										GRADATION																																																
SOIL IS CONSIDERED UNCONSOLIDATED, SEMI-CONSOLIDATED, OR WEATHERED EARTH MATERIALS THAT CAN BE PENETRATED WITH A CONTINUOUS FLIGHT POWER AUGER AND YIELD LESS THAN 100 BLOWS PER FOOT ACCORDING TO THE STANDARD PENETRATION TEST (AASHTO T 206, ASTM D1586). SOIL CLASSIFICATION IS BASED ON THE AASHTO SYSTEM. BASIC DESCRIPTIONS GENERALLY INCLUDE THE FOLLOWING: CONSISTENCY, COLOR, TEXTURE, MOISTURE, AASHTO CLASSIFICATION, AND OTHER PERTINENT FACTORS SUCH AS MINERALOGICAL COMPOSITION, ANGULARITY, STRUCTURE, PLASTICITY, ETC. FOR EXAMPLE, VERY STIFF, GRAY, SILTY CLAY, MOIST WITH INTERBEDDED FINE SAND LAYERS, HIGHLY PLASTIC, A-7-6										WELL GRADED - INDICATES A GOOD REPRESENTATION OF PARTICLE SIZES FROM FINE TO COARSE. UNIFORMLY GRADED - INDICATES THAT SOIL PARTICLES ARE ALL APPROXIMATELY THE SAME SIZE. GAP-GRADED - INDICATES A MIXTURE OF UNIFORM PARTICLE SIZES OF TWO OR MORE SIZES.																																																
SOIL LEGEND AND AASHTO CLASSIFICATION										ANGULARITY OF GRAINS																																																
THE ANGULARITY OR ROUNDNESS OF SOIL GRAINS IS DESIGNATED BY THE TERMS: ANGULAR, SUBANGULAR, SUBROUNDED, OR ROUNDED.										MINERALOGICAL COMPOSITION																																																
MINERAL NAMES SUCH AS QUARTZ, FELDSPAR, MICA, TALC, KAOLIN, ETC. ARE USED IN DESCRIPTIONS WHEN THEY ARE CONSIDERED OF SIGNIFICANCE.										COMPRESSIBILITY																																																
SLIGHTLY COMPRESSIBLE LL < 31 MODERATELY COMPRESSIBLE LL = 31 - 50 HIGHLY COMPRESSIBLE LL > 50										PERCENTAGE OF MATERIAL																																																
<table border="1" style="width:100%; border-collapse: collapse;"> <tr> <th style="width: 25%;">ORGANIC MATERIAL</th> <th style="width: 25%;">GRANULAR SOILS</th> <th style="width: 25%;">SILT - CLAY SOILS</th> <th style="width: 25%;">OTHER MATERIAL</th> </tr> <tr> <td>TRACE OF ORGANIC MATTER</td> <td>2 - 3%</td> <td>3 - 5%</td> <td>TRACE 1 - 10%</td> </tr> <tr> <td>LITTLE ORGANIC MATTER</td> <td>3 - 5%</td> <td>5 - 12%</td> <td>LITTLE 10 - 20%</td> </tr> <tr> <td>MODERATELY ORGANIC</td> <td>5 - 10%</td> <td>12 - 20%</td> <td>SOME 20 - 35%</td> </tr> <tr> <td>HIGHLY ORGANIC</td> <td>> 10%</td> <td>> 20%</td> <td>HIGHLY 35% AND ABOVE</td> </tr> </table>										ORGANIC MATERIAL	GRANULAR SOILS	SILT - CLAY SOILS	OTHER MATERIAL	TRACE OF ORGANIC MATTER	2 - 3%	3 - 5%	TRACE 1 - 10%	LITTLE ORGANIC MATTER	3 - 5%	5 - 12%	LITTLE 10 - 20%	MODERATELY ORGANIC	5 - 10%	12 - 20%	SOME 20 - 35%	HIGHLY ORGANIC	> 10%	> 20%	HIGHLY 35% AND ABOVE	GROUND WATER																												
ORGANIC MATERIAL	GRANULAR SOILS	SILT - CLAY SOILS	OTHER MATERIAL																																																							
TRACE OF ORGANIC MATTER	2 - 3%	3 - 5%	TRACE 1 - 10%																																																							
LITTLE ORGANIC MATTER	3 - 5%	5 - 12%	LITTLE 10 - 20%																																																							
MODERATELY ORGANIC	5 - 10%	12 - 20%	SOME 20 - 35%																																																							
HIGHLY ORGANIC	> 10%	> 20%	HIGHLY 35% AND ABOVE																																																							
										MISCELLANEOUS SYMBOLS																																																
<table border="1" style="width:100%; border-collapse: collapse;"> <tr> <th style="width: 25%;">PRIMARY SOIL TYPE</th> <th style="width: 25%;">COMPACTNESS OR CONSISTENCY</th> <th style="width: 25%;">RANGE OF STANDARD PENETRATION RESISTANCE (N-VALUE)</th> <th style="width: 25%;">RANGE OF UNCONFINED COMPRESSIVE STRENGTH (TONS/FT²)</th> </tr> <tr> <td>GENERALLY GRANULAR MATERIAL (NON-COHESIVE)</td> <td>VERY LOOSE LOOSE MEDIUM DENSE DENSE VERY DENSE</td> <td>< 4 4 TO 10 10 TO 30 30 TO 50 > 50</td> <td>N/A</td> </tr> <tr> <td>GENERALLY SILT-CLAY MATERIAL (COHESIVE)</td> <td>VERY SOFT SOFT MEDIUM STIFF STIFF VERY STIFF HARD</td> <td>< 2 2 TO 4 4 TO 8 8 TO 15 15 TO 30 > 30</td> <td>< 0.25 0.25 TO 0.5 0.5 TO 1.0 1 TO 2 2 TO 4 > 4</td> </tr> </table>										PRIMARY SOIL TYPE	COMPACTNESS OR CONSISTENCY	RANGE OF STANDARD PENETRATION RESISTANCE (N-VALUE)	RANGE OF UNCONFINED COMPRESSIVE STRENGTH (TONS/FT ²)	GENERALLY GRANULAR MATERIAL (NON-COHESIVE)	VERY LOOSE LOOSE MEDIUM DENSE DENSE VERY DENSE	< 4 4 TO 10 10 TO 30 30 TO 50 > 50	N/A	GENERALLY SILT-CLAY MATERIAL (COHESIVE)	VERY SOFT SOFT MEDIUM STIFF STIFF VERY STIFF HARD	< 2 2 TO 4 4 TO 8 8 TO 15 15 TO 30 > 30	< 0.25 0.25 TO 0.5 0.5 TO 1.0 1 TO 2 2 TO 4 > 4	<table border="1" style="width:100%; border-collapse: collapse;"> <tr> <td> ROADWAY EMBANKMENT (RE) WITH SOIL DESCRIPTION</td> <td> DIP & DIP DIRECTION OF ROCK STRUCTURES</td> <td> TEST BORING</td> <td> SLOPE INDICATOR INSTALLATION</td> </tr> <tr> <td> SOIL SYMBOL</td> <td> AUGER BORING</td> <td> CONE PENETROMETER TEST</td> <td> SOUNDING ROD</td> </tr> <tr> <td> ARTIFICIAL FILL (AF) OTHER THAN ROADWAY EMBANKMENT</td> <td> CORE BORING</td> <td> TEST BORING WITH CORE</td> <td> SPT N-VALUE</td> </tr> <tr> <td> INFERRED SOIL BOUNDARY</td> <td> MONITORING WELL</td> <td> PIEZOMETER INSTALLATION</td> <td></td> </tr> <tr> <td> INFERRED ROCK LINE</td> <td> ALLUVIAL SOIL BOUNDARY</td> <td></td> <td></td> </tr> </table>										ROADWAY EMBANKMENT (RE) WITH SOIL DESCRIPTION	DIP & DIP DIRECTION OF ROCK STRUCTURES	TEST BORING	SLOPE INDICATOR INSTALLATION	SOIL SYMBOL	AUGER BORING	CONE PENETROMETER TEST	SOUNDING ROD	ARTIFICIAL FILL (AF) OTHER THAN ROADWAY EMBANKMENT	CORE BORING	TEST BORING WITH CORE	SPT N-VALUE	INFERRED SOIL BOUNDARY	MONITORING WELL	PIEZOMETER INSTALLATION		INFERRED ROCK LINE	ALLUVIAL SOIL BOUNDARY									
PRIMARY SOIL TYPE	COMPACTNESS OR CONSISTENCY	RANGE OF STANDARD PENETRATION RESISTANCE (N-VALUE)	RANGE OF UNCONFINED COMPRESSIVE STRENGTH (TONS/FT ²)																																																							
GENERALLY GRANULAR MATERIAL (NON-COHESIVE)	VERY LOOSE LOOSE MEDIUM DENSE DENSE VERY DENSE	< 4 4 TO 10 10 TO 30 30 TO 50 > 50	N/A																																																							
GENERALLY SILT-CLAY MATERIAL (COHESIVE)	VERY SOFT SOFT MEDIUM STIFF STIFF VERY STIFF HARD	< 2 2 TO 4 4 TO 8 8 TO 15 15 TO 30 > 30	< 0.25 0.25 TO 0.5 0.5 TO 1.0 1 TO 2 2 TO 4 > 4																																																							
ROADWAY EMBANKMENT (RE) WITH SOIL DESCRIPTION	DIP & DIP DIRECTION OF ROCK STRUCTURES	TEST BORING	SLOPE INDICATOR INSTALLATION																																																							
SOIL SYMBOL	AUGER BORING	CONE PENETROMETER TEST	SOUNDING ROD																																																							
ARTIFICIAL FILL (AF) OTHER THAN ROADWAY EMBANKMENT	CORE BORING	TEST BORING WITH CORE	SPT N-VALUE																																																							
INFERRED SOIL BOUNDARY	MONITORING WELL	PIEZOMETER INSTALLATION																																																								
INFERRED ROCK LINE	ALLUVIAL SOIL BOUNDARY																																																									
TEXTURE OR GRAIN SIZE										RECOMMENDATION SYMBOLS																																																
<table border="1" style="width:100%; border-collapse: collapse;"> <tr> <th style="width: 20%;">U.S. STD. SIEVE SIZE OPENING (MM)</th> <th style="width: 10%;">4</th> <th style="width: 10%;">10</th> <th style="width: 10%;">40</th> <th style="width: 10%;">60</th> <th style="width: 10%;">200</th> <th style="width: 10%;">270</th> </tr> <tr> <td></td> <td>4.76</td> <td>2.00</td> <td>0.42</td> <td>0.25</td> <td>0.075</td> <td>0.053</td> </tr> </table>										U.S. STD. SIEVE SIZE OPENING (MM)	4	10	40	60	200	270		4.76	2.00	0.42	0.25	0.075	0.053	<table border="1" style="width:100%; border-collapse: collapse;"> <tr> <td> UNDERCUT</td> <td> UNCLASSIFIED EXCAVATION - UNSUITABLE WASTE</td> <td> UNCLASSIFIED EXCAVATION - ACCEPTABLE, BUT NOT TO BE USED IN THE TOP 3 FEET OF EMBANKMENT OR BACKFILL</td> </tr> <tr> <td> SHALLOW UNDERCUT</td> <td> UNCLASSIFIED EXCAVATION - ACCEPTABLE DEGRADABLE ROCK</td> <td></td> </tr> </table>										UNDERCUT	UNCLASSIFIED EXCAVATION - UNSUITABLE WASTE	UNCLASSIFIED EXCAVATION - ACCEPTABLE, BUT NOT TO BE USED IN THE TOP 3 FEET OF EMBANKMENT OR BACKFILL	SHALLOW UNDERCUT	UNCLASSIFIED EXCAVATION - ACCEPTABLE DEGRADABLE ROCK																				
U.S. STD. SIEVE SIZE OPENING (MM)	4	10	40	60	200	270																																																				
	4.76	2.00	0.42	0.25	0.075	0.053																																																				
UNDERCUT	UNCLASSIFIED EXCAVATION - UNSUITABLE WASTE	UNCLASSIFIED EXCAVATION - ACCEPTABLE, BUT NOT TO BE USED IN THE TOP 3 FEET OF EMBANKMENT OR BACKFILL																																																								
SHALLOW UNDERCUT	UNCLASSIFIED EXCAVATION - ACCEPTABLE DEGRADABLE ROCK																																																									
<table border="1" style="width:100%; border-collapse: collapse;"> <tr> <th style="width: 10%;">GRAIN SIZE</th> <th style="width: 10%;">MM</th> <th style="width: 10%;">305</th> <th style="width: 10%;">75</th> <th style="width: 10%;">2.0</th> <th style="width: 10%;">0.25</th> <th style="width: 10%;">0.05</th> <th style="width: 10%;">0.005</th> </tr> <tr> <td></td> <td>IN.</td> <td>12</td> <td>3</td> <td></td> <td></td> <td></td> <td></td> </tr> </table>										GRAIN SIZE	MM	305	75	2.0	0.25	0.05	0.005		IN.	12	3					ABBREVIATIONS																																
GRAIN SIZE	MM	305	75	2.0	0.25	0.05	0.005																																																			
	IN.	12	3																																																							
<table border="1" style="width:100%; border-collapse: collapse;"> <tr> <td>AR - AUGER REFUSAL</td> <td>MED. - MEDIUM</td> <td>VST - VANE SHEAR TEST</td> </tr> <tr> <td>BT - BORING TERMINATED</td> <td>MICA - MICACEOUS</td> <td>WEA. - WEATHERED</td> </tr> <tr> <td>CL - CLAY</td> <td>MOD. - MODERATELY</td> <td>U - UNIT WEIGHT</td> </tr> <tr> <td>CPT - CONE PENETRATION TEST</td> <td>NP - NON PLASTIC</td> <td>U_g - DRY UNIT WEIGHT</td> </tr> <tr> <td>CSE. - COARSE</td> <td>ORG. - ORGANIC</td> <td></td> </tr> <tr> <td>DMT - DILATOMETER TEST</td> <td>PMT - PRESSUREMETER TEST</td> <td style="text-align: center;">SAMPLE ABBREVIATIONS</td> </tr> <tr> <td>DPT - DYNAMIC PENETRATION TEST</td> <td>SAP. - SAPROLITIC</td> <td>S - BULK</td> </tr> <tr> <td>e - VOID RATIO</td> <td>SD. - SAND, SANDY</td> <td>SS - SPLIT SPOON</td> </tr> <tr> <td>F - FINE</td> <td>SL. - SILT, SILTY</td> <td>ST - SHELBY TUBE</td> </tr> <tr> <td>FOSS. - FOSSILIFEROUS</td> <td>SLL. - SLIGHTLY</td> <td>RS - ROCK</td> </tr> <tr> <td>FRAC. - FRACTURED, FRACTURES</td> <td>TCR - TRICONE REFUSAL</td> <td>RT - RECOMPACTED TRIAXIAL</td> </tr> <tr> <td>FRAGS. - FRAGMENTS</td> <td>w - MOISTURE CONTENT</td> <td>CBR - CALIFORNIA BEARING RATIO</td> </tr> <tr> <td>HI. - HIGHLY</td> <td>v - VERY</td> <td></td> </tr> </table>										AR - AUGER REFUSAL	MED. - MEDIUM	VST - VANE SHEAR TEST	BT - BORING TERMINATED	MICA - MICACEOUS	WEA. - WEATHERED	CL - CLAY	MOD. - MODERATELY	U - UNIT WEIGHT	CPT - CONE PENETRATION TEST	NP - NON PLASTIC	U _g - DRY UNIT WEIGHT	CSE. - COARSE	ORG. - ORGANIC		DMT - DILATOMETER TEST	PMT - PRESSUREMETER TEST	SAMPLE ABBREVIATIONS	DPT - DYNAMIC PENETRATION TEST	SAP. - SAPROLITIC	S - BULK	e - VOID RATIO	SD. - SAND, SANDY	SS - SPLIT SPOON	F - FINE	SL. - SILT, SILTY	ST - SHELBY TUBE	FOSS. - FOSSILIFEROUS	SLL. - SLIGHTLY	RS - ROCK	FRAC. - FRACTURED, FRACTURES	TCR - TRICONE REFUSAL	RT - RECOMPACTED TRIAXIAL	FRAGS. - FRAGMENTS	w - MOISTURE CONTENT	CBR - CALIFORNIA BEARING RATIO	HI. - HIGHLY	v - VERY		EQUIPMENT USED ON SUBJECT PROJECT									
AR - AUGER REFUSAL	MED. - MEDIUM	VST - VANE SHEAR TEST																																																								
BT - BORING TERMINATED	MICA - MICACEOUS	WEA. - WEATHERED																																																								
CL - CLAY	MOD. - MODERATELY	U - UNIT WEIGHT																																																								
CPT - CONE PENETRATION TEST	NP - NON PLASTIC	U _g - DRY UNIT WEIGHT																																																								
CSE. - COARSE	ORG. - ORGANIC																																																									
DMT - DILATOMETER TEST	PMT - PRESSUREMETER TEST	SAMPLE ABBREVIATIONS																																																								
DPT - DYNAMIC PENETRATION TEST	SAP. - SAPROLITIC	S - BULK																																																								
e - VOID RATIO	SD. - SAND, SANDY	SS - SPLIT SPOON																																																								
F - FINE	SL. - SILT, SILTY	ST - SHELBY TUBE																																																								
FOSS. - FOSSILIFEROUS	SLL. - SLIGHTLY	RS - ROCK																																																								
FRAC. - FRACTURED, FRACTURES	TCR - TRICONE REFUSAL	RT - RECOMPACTED TRIAXIAL																																																								
FRAGS. - FRAGMENTS	w - MOISTURE CONTENT	CBR - CALIFORNIA BEARING RATIO																																																								
HI. - HIGHLY	v - VERY																																																									
<table border="1" style="width:100%; border-collapse: collapse;"> <tr> <th style="width: 33%;">DRILL UNITS:</th> <th style="width: 33%;">ADVANCING TOOLS:</th> <th style="width: 33%;">HAMMER TYPE:</th> </tr> <tr> <td><input checked="" type="checkbox"/> CME-450</td> <td><input type="checkbox"/> CLAY BITS</td> <td><input checked="" type="checkbox"/> AUTOMATIC <input type="checkbox"/> MANUAL</td> </tr> <tr> <td><input type="checkbox"/> CME-55</td> <td><input type="checkbox"/> 6' CONTINUOUS FLIGHT AUGER</td> <td></td> </tr> <tr> <td><input type="checkbox"/> CME-550</td> <td><input checked="" type="checkbox"/> 2.25' HOLLOW STEM AUGERS</td> <td>CORE SIZE:</td> </tr> <tr> <td><input type="checkbox"/> VANE SHEAR TEST</td> <td><input type="checkbox"/> HARD FACED FINGER BITS</td> <td><input type="checkbox"/> -B _____ <input type="checkbox"/> -H _____</td> </tr> <tr> <td><input type="checkbox"/> PORTABLE HOIST</td> <td><input type="checkbox"/> TUNG-CARBIDE INSERTS</td> <td><input type="checkbox"/> -N _____</td> </tr> <tr> <td></td> <td><input type="checkbox"/> CASING <input type="checkbox"/> W/ ADVANCER</td> <td>HAND TOOLS:</td> </tr> <tr> <td></td> <td><input type="checkbox"/> TRICONE _____ STEEL TEETH</td> <td><input type="checkbox"/> POST HOLE DIGGER</td> </tr> <tr> <td></td> <td><input type="checkbox"/> TRICONE _____ TUNG-CARB.</td> <td><input type="checkbox"/> HAND AUGER</td> </tr> <tr> <td></td> <td><input type="checkbox"/> CORE BIT</td> <td><input type="checkbox"/> SOUNDING ROD</td> </tr> <tr> <td></td> <td></td> <td><input type="checkbox"/> VANE SHEAR TEST</td> </tr> </table>										DRILL UNITS:	ADVANCING TOOLS:	HAMMER TYPE:	<input checked="" type="checkbox"/> CME-450	<input type="checkbox"/> CLAY BITS	<input checked="" type="checkbox"/> AUTOMATIC <input type="checkbox"/> MANUAL	<input type="checkbox"/> CME-55	<input type="checkbox"/> 6' CONTINUOUS FLIGHT AUGER		<input type="checkbox"/> CME-550	<input checked="" type="checkbox"/> 2.25' HOLLOW STEM AUGERS	CORE SIZE:	<input type="checkbox"/> VANE SHEAR TEST	<input type="checkbox"/> HARD FACED FINGER BITS	<input type="checkbox"/> -B _____ <input type="checkbox"/> -H _____	<input type="checkbox"/> PORTABLE HOIST	<input type="checkbox"/> TUNG-CARBIDE INSERTS	<input type="checkbox"/> -N _____		<input type="checkbox"/> CASING <input type="checkbox"/> W/ ADVANCER	HAND TOOLS:		<input type="checkbox"/> TRICONE _____ STEEL TEETH	<input type="checkbox"/> POST HOLE DIGGER		<input type="checkbox"/> TRICONE _____ TUNG-CARB.	<input type="checkbox"/> HAND AUGER		<input type="checkbox"/> CORE BIT	<input type="checkbox"/> SOUNDING ROD			<input type="checkbox"/> VANE SHEAR TEST																
DRILL UNITS:	ADVANCING TOOLS:	HAMMER TYPE:																																																								
<input checked="" type="checkbox"/> CME-450	<input type="checkbox"/> CLAY BITS	<input checked="" type="checkbox"/> AUTOMATIC <input type="checkbox"/> MANUAL																																																								
<input type="checkbox"/> CME-55	<input type="checkbox"/> 6' CONTINUOUS FLIGHT AUGER																																																									
<input type="checkbox"/> CME-550	<input checked="" type="checkbox"/> 2.25' HOLLOW STEM AUGERS	CORE SIZE:																																																								
<input type="checkbox"/> VANE SHEAR TEST	<input type="checkbox"/> HARD FACED FINGER BITS	<input type="checkbox"/> -B _____ <input type="checkbox"/> -H _____																																																								
<input type="checkbox"/> PORTABLE HOIST	<input type="checkbox"/> TUNG-CARBIDE INSERTS	<input type="checkbox"/> -N _____																																																								
	<input type="checkbox"/> CASING <input type="checkbox"/> W/ ADVANCER	HAND TOOLS:																																																								
	<input type="checkbox"/> TRICONE _____ STEEL TEETH	<input type="checkbox"/> POST HOLE DIGGER																																																								
	<input type="checkbox"/> TRICONE _____ TUNG-CARB.	<input type="checkbox"/> HAND AUGER																																																								
	<input type="checkbox"/> CORE BIT	<input type="checkbox"/> SOUNDING ROD																																																								
		<input type="checkbox"/> VANE SHEAR TEST																																																								
PLASTICITY																																																										
<table border="1" style="width:100%; border-collapse: collapse;"> <tr> <th style="width: 50%;">PLASTICITY INDEX (PI)</th> <th style="width: 50%;">DRY STRENGTH</th> </tr> <tr> <td>NON PLASTIC</td> <td>VERY LOW</td> </tr> <tr> <td>SLIGHTLY PLASTIC</td> <td>SLIGHT</td> </tr> <tr> <td>MODERATELY PLASTIC</td> <td>MEDIUM</td> </tr> <tr> <td>HIGHLY PLASTIC</td> <td>HIGH</td> </tr> </table>										PLASTICITY INDEX (PI)	DRY STRENGTH	NON PLASTIC	VERY LOW	SLIGHTLY PLASTIC	SLIGHT	MODERATELY PLASTIC	MEDIUM	HIGHLY PLASTIC	HIGH																																							
PLASTICITY INDEX (PI)	DRY STRENGTH																																																									
NON PLASTIC	VERY LOW																																																									
SLIGHTLY PLASTIC	SLIGHT																																																									
MODERATELY PLASTIC	MEDIUM																																																									
HIGHLY PLASTIC	HIGH																																																									
COLOR																																																										
DESCRIPTIONS MAY INCLUDE COLOR OR COLOR COMBINATIONS (TAN, RED, YELLOW-BROWN, BLUE-GRAY). MODIFIERS SUCH AS LIGHT, DARK, STREAKED, ETC. ARE USED TO DESCRIBE APPEARANCE.																																																										

**NORTH CAROLINA DEPARTMENT OF TRANSPORTATION
DIVISION OF HIGHWAYS
GEOTECHNICAL ENGINEERING UNIT**

SUBSURFACE INVESTIGATION

SOIL AND ROCK LEGEND, TERMS, SYMBOLS, AND ABBREVIATIONS (PAGE 2 OF 2)

ROCK DESCRIPTION		TERMS AND DEFINITIONS	
<p>HARD ROCK IS NON-COASTAL PLAIN MATERIAL THAT WOULD YIELD SPT REFUSAL IF TESTED. AN INFERRED ROCK LINE INDICATES THE LEVEL AT WHICH NON-COASTAL PLAIN MATERIAL WOULD YIELD SPT REFUSAL. SPT REFUSAL IS PENETRATION BY A SPLIT SPOON SAMPLER EQUAL TO OR LESS THAN 0.1 FOOT PER 60 BLOWS IN NON-COASTAL PLAIN MATERIAL. THE TRANSITION BETWEEN SOIL AND ROCK IS OFTEN REPRESENTED BY A ZONE OF WEATHERED ROCK. ROCK MATERIALS ARE TYPICALLY DIVIDED AS FOLLOWS:</p>		<p>ALLUVIUM (ALLUV.) - SOILS THAT HAVE BEEN TRANSPORTED BY WATER. AQUIFER - A WATER BEARING FORMATION OR STRATA. ARENACEOUS - APPLIED TO ROCKS THAT HAVE BEEN DERIVED FROM SAND OR THAT CONTAIN SAND. ARGILLACEOUS - APPLIED TO ALL ROCKS OR SUBSTANCES COMPOSED OF CLAY MINERALS, OR HAVING A NOTABLE PROPORTION OF CLAY IN THEIR COMPOSITION, SUCH AS SHALE, SLATE, ETC. ARTESIAN - GROUND WATER THAT IS UNDER SUFFICIENT PRESSURE TO RISE ABOVE THE LEVEL AT WHICH IT IS ENCOUNTERED, BUT WHICH DOES NOT NECESSARILY RISE TO OR ABOVE THE GROUND SURFACE. CALCAREOUS (CALC.) - SOILS THAT CONTAIN APPRECIABLE AMOUNTS OF CALCIUM CARBONATE. COLLUVIUM - ROCK FRAGMENTS MIXED WITH SOIL DEPOSITED BY GRAVITY ON SLOPE OR AT BOTTOM OF SLOPE. CORE RECOVERY (REC.) - TOTAL LENGTH OF ALL MATERIAL RECOVERED IN THE CORE BARREL DIVIDED BY TOTAL LENGTH OF CORE RUN AND EXPRESSED AS A PERCENTAGE. DIKE - A TABULAR BODY OF IGNEOUS ROCK THAT CUTS ACROSS THE STRUCTURE OF ADJACENT ROCKS OR CUTS MASSIVE ROCK. DIP - THE ANGLE AT WHICH A STRATUM OR ANY PLANAR FEATURE IS INCLINED FROM THE HORIZONTAL. DIP DIRECTION (DIP AZIMUTH) - THE DIRECTION OR BEARING OF THE HORIZONTAL TRACE OF THE LINE OF DIP, MEASURED CLOCKWISE FROM NORTH. FAULT - A FRACTURE OR FRACTURE ZONE ALONG WHICH THERE HAS BEEN DISPLACEMENT OF THE SIDES RELATIVE TO ONE ANOTHER PARALLEL TO THE FRACTURE. FISSILE - A PROPERTY OF SPLITTING ALONG CLOSELY SPACED PARALLEL PLANES. FLOAT - ROCK FRAGMENTS ON SURFACE NEAR THEIR ORIGINAL POSITION AND DISLODGED FROM PARENT MATERIAL. FLOOD PLAIN (FP) - LAND BORDERING A STREAM, BUILT OF SEDIMENTS DEPOSITED BY THE STREAM. FORMATION (FM.) - A MAPPABLE GEOLOGIC UNIT THAT CAN BE RECOGNIZED AND TRACED IN THE FIELD. JOINT - FRACTURE IN ROCK ALONG WHICH NO APPRECIABLE MOVEMENT HAS OCCURRED. LEDGE - A SHELF-LIKE RIDGE OR PROJECTION OF ROCK WHOSE THICKNESS IS SMALL COMPARED TO ITS LATERAL EXTENT. LENS - A BODY OF SOIL OR ROCK THAT THINS OUT IN ONE OR MORE DIRECTIONS. MOTTLED (MOT.) - IRREGULARLY MARKED WITH SPOTS OF DIFFERENT COLORS. MOTTLING IN SOILS USUALLY INDICATES POOR AERATION AND LACK OF GOOD DRAINAGE. PERCHED WATER - WATER MAINTAINED ABOVE THE NORMAL GROUND WATER LEVEL BY THE PRESENCE OF AN INTERVENING IMPERVIOUS STRATUM. RESIDUAL (RES.) SOIL - SOIL FORMED IN PLACE BY THE WEATHERING OF ROCK. ROCK QUALITY DESIGNATION (ROD) - A MEASURE OF ROCK QUALITY DESCRIBED BY TOTAL LENGTH OF ROCK SEGMENTS EQUAL TO OR GREATER THAN 4 INCHES DIVIDED BY THE TOTAL LENGTH OF CORE RUN AND EXPRESSED AS A PERCENTAGE. SAPROLITE (SAP.) - RESIDUAL SOIL THAT RETAINS THE RELIC STRUCTURE OR FABRIC OF THE PARENT ROCK. SILL - AN INTRUSIVE BODY OF IGNEOUS ROCK OF APPROXIMATELY UNIFORM THICKNESS AND RELATIVELY THIN COMPARED WITH ITS LATERAL EXTENT, THAT HAS BEEN EMPLACED PARALLEL TO THE BEDDING OR SCHISTOSITY OF THE INTRUDED ROCKS. SLICKENSIDE - POLISHED AND STRIATED SURFACE THAT RESULTS FROM FRICTION ALONG A FAULT OR SLIP PLANE. STANDARD PENETRATION TEST (PENETRATION RESISTANCE) (SPT) - NUMBER OF BLOWS IN OR BPF) OF A 140 LB. HAMMER FALLING 30 INCHES REQUIRED TO PRODUCE A PENETRATION OF 1 FOOT INTO SOIL WITH A 2 INCH OUTSIDE DIAMETER SPLIT SPOON SAMPLER. SPT REFUSAL IS PENETRATION EQUAL TO OR LESS THAN 0.1 FOOT PER 60 BLOWS. STRATA CORE RECOVERY (SREC.) - TOTAL LENGTH OF STRATA MATERIAL RECOVERED DIVIDED BY TOTAL LENGTH OF STRATUM AND EXPRESSED AS A PERCENTAGE. STRATA ROCK QUALITY DESIGNATION (SROD) - A MEASURE OF ROCK QUALITY DESCRIBED BY TOTAL LENGTH OF ROCK SEGMENTS WITHIN A STRATUM EQUAL TO OR GREATER THAN 4 INCHES DIVIDED BY THE TOTAL LENGTH OF STRATA AND EXPRESSED AS A PERCENTAGE. TOPSOIL (TS.) - SURFACE SOILS USUALLY CONTAINING ORGANIC MATTER.</p>	
WEATHERED ROCK (WR)		NON-COASTAL PLAIN MATERIAL THAT WOULD YIELD SPT N VALUES > 100 BLOWS PER FOOT IF TESTED.	
CRYSTALLINE ROCK (CR)		FINE TO COARSE GRAIN IGNEOUS AND METAMORPHIC ROCK THAT WOULD YIELD SPT REFUSAL IF TESTED. ROCK TYPE INCLUDES GRANITE, GNEISS, GABBRO, SCHIST, ETC.	
NON-CRYSTALLINE ROCK (NCR)		FINE TO COARSE GRAIN METAMORPHIC AND NON-COASTAL PLAIN SEDIMENTARY ROCK THAT WOULD YIELD SPT REFUSAL IF TESTED. ROCK TYPE INCLUDES PHYLLITE, SLATE, SANDSTONE, ETC.	
COASTAL PLAIN SEDIMENTARY ROCK (CP)		COASTAL PLAIN SEDIMENTS CEMENTED INTO ROCK, BUT MAY NOT YIELD SPT REFUSAL. ROCK TYPE INCLUDES LIMESTONE, SANDSTONE, CEMENTED SHELL BEDS, ETC.	
WEATHERING			
FRESH	ROCK FRESH, CRYSTALS BRIGHT, FEW JOINTS MAY SHOW SLIGHT STAINING. ROCK RINGS UNDER HAMMER IF CRYSTALLINE.		
VERY SLIGHT (V SL.)	ROCK GENERALLY FRESH, JOINTS STAINED, SOME JOINTS MAY SHOW THIN CLAY COATINGS IF OPEN, CRYSTALS ON A BROKEN SPECIMEN FACE SHINE BRIGHTLY. ROCK RINGS UNDER HAMMER BLOWS IF OF A CRYSTALLINE NATURE.		
SLIGHT (SL.)	ROCK GENERALLY FRESH, JOINTS STAINED AND DISCOLORATION EXTENDS INTO ROCK UP TO 1 INCH. OPEN JOINTS MAY CONTAIN CLAY. IN GRANITOID ROCKS SOME OCCASIONAL FELDSPAR CRYSTALS ARE DULL AND DISCOLORED. CRYSTALLINE ROCKS RING UNDER HAMMER BLOWS.		
MODERATE (MOD.)	SIGNIFICANT PORTIONS OF ROCK SHOW DISCOLORATION AND WEATHERING EFFECTS. IN GRANITOID ROCKS, MOST FELDSPARS ARE DULL AND DISCOLORED, SOME SHOW CLAY. ROCK HAS DULL SOUND UNDER HAMMER BLOWS AND SHOWS SIGNIFICANT LOSS OF STRENGTH AS COMPARED WITH FRESH ROCK.		
MODERATELY SEVERE (MOD. SEV.)	ALL ROCK EXCEPT QUARTZ DISCOLORED OR STAINED. IN GRANITOID ROCKS, ALL FELDSPARS DULL AND DISCOLORED AND A MAJORITY SHOW KAOLINIZATION. ROCK SHOWS SEVERE LOSS OF STRENGTH AND CAN BE EXCAVATED WITH A GEOLOGIST'S PICK. ROCK GIVES "CLUNK" SOUND WHEN STRUCK. <i>IF TESTED, WOULD YIELD SPT REFUSAL</i>		
SEVERE (SEV.)	ALL ROCK EXCEPT QUARTZ DISCOLORED OR STAINED. ROCK FABRIC CLEAR AND EVIDENT BUT REDUCED IN STRENGTH TO STRONG SOIL. IN GRANITOID ROCKS ALL FELDSPARS ARE KAOLINIZED TO SOME EXTENT. SOME FRAGMENTS OF STRONG ROCK USUALLY REMAIN. <i>IF TESTED, WOULD YIELD SPT N VALUES > 100 BPF</i>		
VERY SEVERE (V SEV.)	ALL ROCK EXCEPT QUARTZ DISCOLORED OR STAINED. ROCK FABRIC ELEMENTS ARE DISCERNIBLE BUT MASS IS EFFECTIVELY REDUCED TO SOIL STATUS, WITH ONLY FRAGMENTS OF STRONG ROCK REMAINING. SAPROLITE IS AN EXAMPLE OF ROCK WEATHERED TO A DEGREE THAT ONLY MINOR VESTIGES OF ORIGINAL ROCK FABRIC REMAIN. <i>IF TESTED, WOULD YIELD SPT N VALUES < 100 BPF</i>		
COMPLETE	ROCK REDUCED TO SOIL. ROCK FABRIC NOT DISCERNIBLE, OR DISCERNIBLE ONLY IN SMALL AND SCATTERED CONCENTRATIONS. QUARTZ MAY BE PRESENT AS DIKES OR STRINGERS. SAPROLITE IS ALSO AN EXAMPLE.		
ROCK HARDNESS			
VERY HARD	CANNOT BE SCRATCHED BY KNIFE OR SHARP PICK. BREAKING OF HAND SPECIMENS REQUIRES SEVERAL HARD BLOWS OF THE GEOLOGIST'S PICK.		
HARD	CAN BE SCRATCHED BY KNIFE OR PICK ONLY WITH DIFFICULTY. HARD HAMMER BLOWS REQUIRED TO DETACH HAND SPECIMEN.		
MODERATELY HARD	CAN BE SCRATCHED BY KNIFE OR PICK. GOUGES OR GROOVES TO 0.25 INCHES DEEP CAN BE EXCAVATED BY HARD BLOW OF A GEOLOGIST'S PICK. HAND SPECIMENS CAN BE DETACHED BY MODERATE BLOWS.		
MEDIUM HARD	CAN BE GROOVED OR GOUGED 0.05 INCHES DEEP BY FIRM PRESSURE OF KNIFE OR PICK POINT. CAN BE EXCAVATED IN SMALL CHIPS TO PIECES 1 INCH MAXIMUM SIZE BY HARD BLOWS OF THE POINT OF A GEOLOGIST'S PICK.		
SOFT	CAN BE GROOVED OR GOUGED READILY BY KNIFE OR PICK. CAN BE EXCAVATED IN FRAGMENTS FROM CHIPS TO SEVERAL INCHES IN SIZE BY MODERATE BLOWS OF A PICK POINT. SMALL, THIN PIECES CAN BE BROKEN BY FINGER PRESSURE.		
VERY SOFT	CAN BE CARVED WITH KNIFE. CAN BE EXCAVATED READILY WITH POINT OF PICK. PIECES 1 INCH OR MORE IN THICKNESS CAN BE BROKEN BY FINGER PRESSURE. CAN BE SCRATCHED READILY BY FINGERNAIL.		
FRACTURE SPACING		BEDDING	
TERM	SPACING	TERM	THICKNESS
VERY WIDE	MORE THAN 10 FEET	VERY THICKLY BEDDED	4 FEET
WIDE	3 TO 10 FEET	THICKLY BEDDED	1.5 - 4 FEET
MODERATELY CLOSE	1 TO 3 FEET	THINLY BEDDED	0.16 - 1.5 FEET
CLOSE	0.16 TO 1 FOOT	VERY THINLY BEDDED	0.03 - 0.16 FEET
VERY CLOSE	LESS THAN 0.16 FEET	THICKLY LAMINATED	0.008 - 0.03 FEET
		THINLY LAMINATED	< 0.008 FEET
INDURATION			
FOR SEDIMENTARY ROCKS, INDURATION IS THE HARDENING OF MATERIAL BY CEMENTING, HEAT, PRESSURE, ETC.			
FRIABLE	RUBBING WITH FINGER FREES NUMEROUS GRAINS; GENTLE BLOW BY HAMMER DISINTEGRATES SAMPLE.		
MODERATELY INDURATED	GRAINS CAN BE SEPARATED FROM SAMPLE WITH STEEL PROBE; BREAKS EASILY WHEN HIT WITH HAMMER.		
INDURATED	GRAINS ARE DIFFICULT TO SEPARATE WITH STEEL PROBE; DIFFICULT TO BREAK WITH HAMMER.		
EXTREMELY INDURATED	SHARP HAMMER BLOWS REQUIRED TO BREAK SAMPLE; SAMPLE BREAKS ACROSS GRAINS.		
		BENCH MARK:	
		ELEVATION: FEET	
NOTES:			
Elevations obtained from 970091.merge.tin (file dated: 5/18/2018)			
DATE: 8-15-14			

PROJECT REFERENCE NO.	SHEET NO.
SF-970091	3
SITE PLAN	

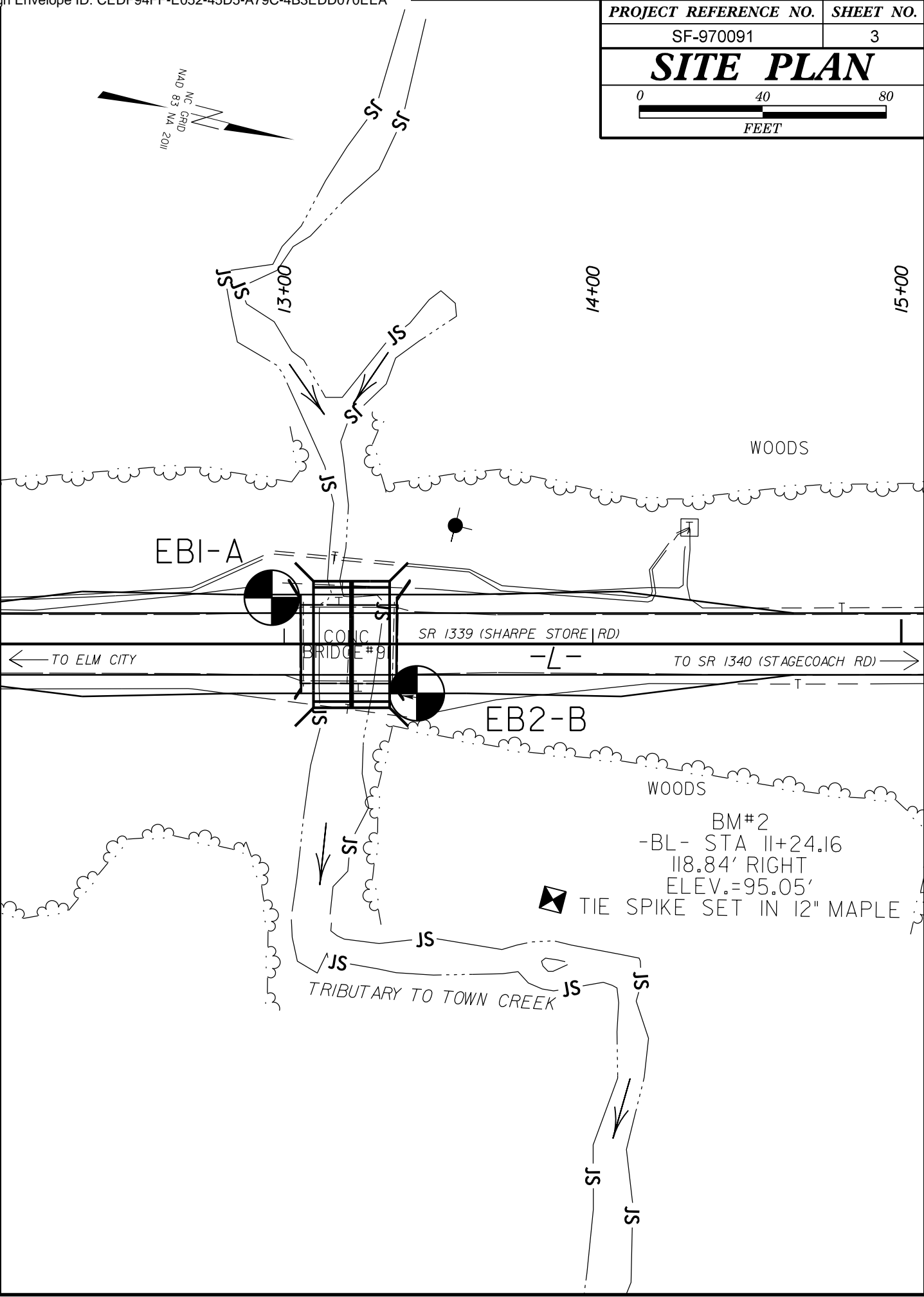
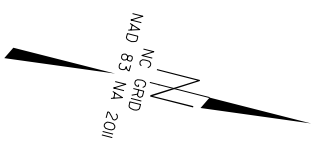

EBI-A

CONC BRIDGE #9

SR 1339 (SHARPE STORE RD)

← TO ELM CITY

TO SR 1340 (STAGECOACH RD) →

EB2-B

WOODS

BM#2
 -BL- STA 11+24.16
 118.84' RIGHT
 ELEV.=95.05'

TIE SPIKE SET IN 12" MAPLE

TRIBUTARY TO TOWN CREEK

GEOTECHNICAL BORING REPORT

BORE LOG

WBS 17BP.4.R.94		TIP SF-970091		COUNTY WILSON		GEOLOGIST Shipman, M.	
SITE DESCRIPTION Replace Bridge No. 091 on SR 1339 (Sharpe Store Road) over Tributary of Town Creek							GROUND WTR (ft)
BORING NO. EB1-A		STATION 12+96		OFFSET 15 ft LT		ALIGNMENT -L-	0 HR. Dry
COLLAR ELEV. 120.2 ft		TOTAL DEPTH 23.9 ft		NORTHING 754,066		EASTING 2,335,010	24 HR. 3.2
DRILL RIG/HAMMER EFF./DATE SUM3359 CME-450 85% 11/30/2017				DRILL METHOD H.S. Augers		HAMMER TYPE Automatic	
DRILLER Moseley, M.G.		START DATE 10/24/18		COMP. DATE 10/24/18		SURFACE WATER DEPTH N/A	

ELEV (ft)	DRIVE ELEV (ft)	DEPTH (ft)	BLOW COUNT			BLOWS PER FOOT					SAMP. NO.	MOI	LOG	SOIL AND ROCK DESCRIPTION			
			0.5ft	0.5ft	0.5ft	0	25	50	75	100				ELEV. (ft)	DEPTH (ft)		
125																	
120	120.2	0.0													120.2	GROUND SURFACE	0.0
			4	3	2											ROADWAY EMBANKMENT brown, silty SAND (A-2-4)	
115	116.6	3.6	WOH	1	1										117.2	ALLUVIAL gray, clayey SILT (A-5) with trace organics	3.0
															114.1	gray, clayey, silty SAND (A-2-5)	6.1
110	111.6	8.6													110.6	COASTAL PLAIN (YORKTOWN FORMATION) green-gray, silty CLAY (A-7) with little fossil fragments	9.6
105	106.6	13.6															
100	101.6	18.6															
	96.6	23.6													97.2	WEATHERED ROCK (Metavolcanic Rock)	23.0
	96.3	23.9	100/0.3												96.3	NON-CRYSTALLINE ROCK (Metavolcanic Rock) Boring Terminated with Standard Penetration Test Refusal at Elevation 96.3 ft on Non-Crystalline Rock (Metavolcanic Rock) - Strata change noted in the split spoon at 9.6 feet. - Harder drilling reported at 23.0 feet was interpreted as Weathered Rock. - Auger refusal at 23.9 feet.	23.9
			60/0.0														

NCDOT BORE SINGLE_SF970091_GEO_BRD0091_GINT.GPJ_NC_DOT.GDT_11/14/18

GEOTECHNICAL BORING REPORT BORE LOG

WBS 17BP.4.R.94	TIP SF-970091	COUNTY WILSON	GEOLOGIST Ruley, A.
SITE DESCRIPTION Replace Bridge No. 091 on SR 1339 (Sharpe Store Road) over Tributary of Town Creek			GROUND WTR (ft)
BORING NO. EB2-B	STATION 13+43	OFFSET 16 ft RT	ALIGNMENT -L-
COLLAR ELEV. 120.3 ft	TOTAL DEPTH 23.9 ft	NORTHING 754,120	EASTING 2,335,028
DRILL RIG/HAMMER EFF./DATE SUM3359 CME-450 85% 11/30/2017		DRILL METHOD H.S. Augers	HAMMER TYPE Automatic
DRILLER Moseley, M.G.	START DATE 10/24/18	COMP. DATE 10/24/18	SURFACE WATER DEPTH N/A

ELEV (ft)	DRIVE ELEV (ft)	DEPTH (ft)	BLOW COUNT			BLOWS PER FOOT					SAMP. NO.	MOI	LOG	SOIL AND ROCK DESCRIPTION	DEPTH (ft)	
			0.5ft	0.5ft	0.5ft	0	25	50	75	100						ELEV. (ft)
125																
120	120.3	0.0	3	3	3									120.3	GROUND SURFACE	0.0
														117.3	ROADWAY EMBANKMENT brown, silty SAND (A-2-4)	3.0
115	116.5	3.8	WOH	2	3										ALLUVIAL brown, clayey, silty SAND (A-2-5) with trace gravel and organics	
														111.0	COASTAL PLAIN (YORKTOWN FORMATION) green-gray, silty CLAY (A-7) with very thinly bedded sand and trace to some fossil fragments	9.3
110	111.5	8.8	2	2	2											
105	106.5	13.8	2	1	2											
100	101.5	18.8	3	3	4											
	96.5	23.8	60/0.1											97.0	WEATHERED ROCK (Metavolcanic Rock)	23.3
														96.4	NON-CRYSTALLINE ROCK (Metavolcanic Rock) Boring Terminated with Standard Penetration Test Refusal at Elevation 96.4 ft on Non-Crystalline Rock (Metavolcanic Rock) - Strata change noted in the split spoon at 9.3 feet. - Harder drilling reported at 23.3 feet was interpreted as Weathered Rock. - Auger refusal at 23.8 feet.	23.9

NCDOT BORE SINGLE SF970091_GEO_BRD0091_GINT.GPJ_NC_DOT.GDT 11/14/18