

PROJECT: BENSON, NC INTERCHANGE IMPROVEMENTS



PROPOSED HIGHWAY LANDSCAPE DEVELOPMENT PROJECT



T.I.P. #	STATE PROJECT W.B.S.#	SHEET#	SHEET # TOTAL
	-----	L1	9
FED. PROJ. #	DESCRIPTION		DIVISION
	LANDSCAPE		4

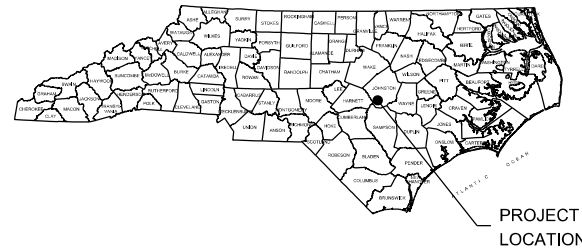
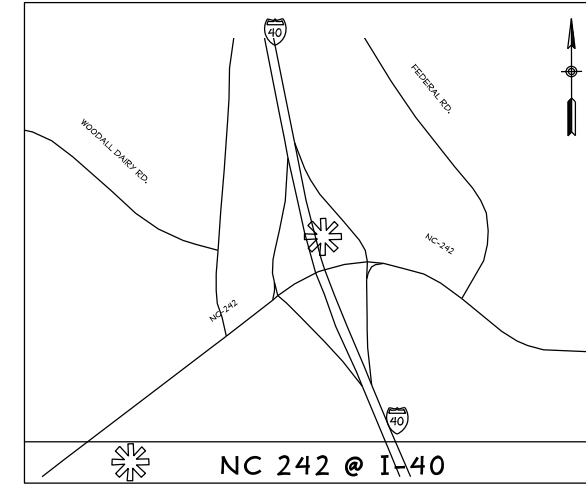
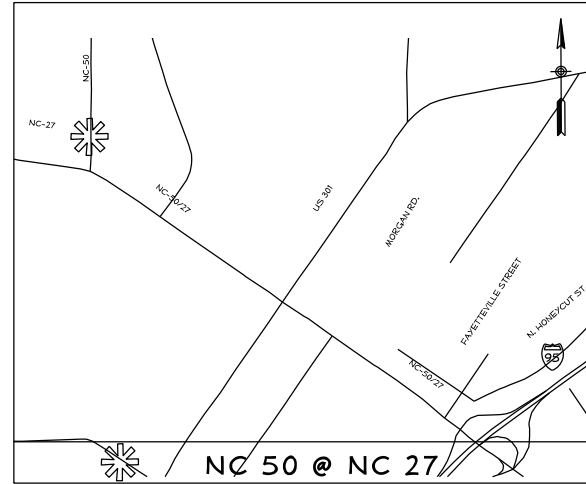
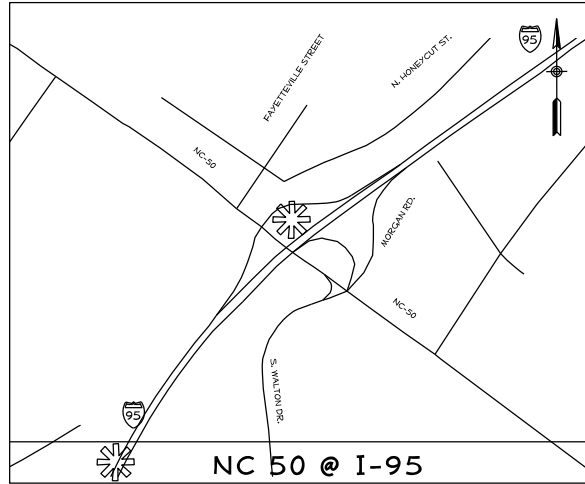

PROJECT LOCATION

SUMMARY OF PROJECT QUANTITIES					
TREES	QTY	BOTANICAL NAME / COMMON NAME	CONT	CAL	REMARKS
CC	20	Cercis canadensis 'Hearts of Gold' / Forest Pansy Redbud	B & B	2"Cal	Full & Heavy; Single Straight Leader
LW	106	Lagerstroemia x 'Natchez' / White Crape Myrtle Multi-Trunk	B & B	2"Cal	Full & Heavy; Single Straight Leader
IL	40	Ilex x 'Nellie R Stevens' / Nellie Stevens Holly	B & B	2"Cal	Full & Heavy; Single Straight Leader

SHRUB AREAS	QTY	BOTANICAL NAME / COMMON NAME	CONT	SPACING	REMARKS
LD	160	Loropetalum chinense Daruma / Dwarf Loropetalum	5 gal	60" o.c.	Full & Heavy
PH	4,572	Panicum virgatum 'Heavy Metal' / Blue Switch Grass	1 gal	18" o.c.	Full & Heavy
HX	355	Hemerocallis x 'Buttered Popcorn' / Daylily	1 gal	24" o.c.	Full & Heavy
LB2	621	Liriope muscari 'Big Blue' / Big Blue Lilyturf	1 gal	18" o.c.	Full & Heavy
NT	135	Nassella tenuissima / Mexican Feather Grass	1 gal	24" o.c.	Full & Heavy

MISC.	QTY	ITEM	UNIT	REMARKS / NOTES
	17	Tree Removal	EA	Remove tree and grind stump
	1	Inlet Protection	EA	Per NCDOT Standard Detail 1632.03
	1	Grading To Fix Drainage Issues	LS	At I-95 / NC 50 Intersection
	420	Double-Shredded Hardwood Mulch	CY	
	40	Water	M/G	One (1) Year After Final Acceptance
	2,700	Turf Seeding	SF	
	232	Stone Wall	FF	At NC 50 / NC 27 Intersection
	50	Stone Wall Caps	EA	At NC 50 / NC 27 Intersection

CONVENTIONAL SYMBOLS

Ex. Tree Line	
Meadow Edge	
Ex. Tree	
Ex. Swale	
Centerline	
Prop. Plant	
Bed Edge	
Ex. Guardrail	
Ex. Contour	

INDEX OF SHEETS:

- L1 ... TITLE SHEET,
- SUMMARY OF QUANTITIES
- LP1-4 ... NC50 @ I-95 PLANTING PLANS
- LP5 ... NC50 @ NC27 PLANTING PLANS
- LP6-7 ... NC242 @ I-40 PLANTING PLANS
- LD1 ... PLANTING DETAIL SHEET

PREPARED BY:
OBS LANDSCAPE ARCHITECTS
 PO BOX 28504
 RALEIGH, NC 27611
 (919) 755-0046
 OBSLA.NET
 DATE: 22 APRIL 2015

REVISIONS

DATE	DESCRIPTION



Seal:

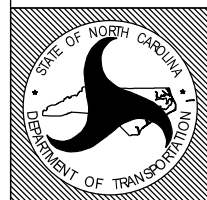
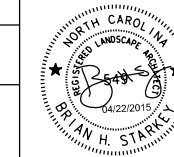

STATE OF
NORTH CAROLINA
 DEPARTMENT OF TRANSPORTATION

LOCATION: **BENSON, NC**
 TYPE of WORK: **LANDSCAPE IMPROVEMENTS**
 COUNTY: **JOHNSTON COUNTY**

2004 American Standard for Nursery Stock
 2012 NCDOT STANDARD SPECIFICATIONS
 PREPARED IN THE OFFICE OF:
 NCDOT- ROADSIDE ENVIRONMENTAL UNIT
 LANDSCAPE DESIGN & DEVELOPMENT SECTION
 1557 MAIL SERVICE CENTER
 RALEIGH NC 27699 919-707-2935

\$\$\$\$\$SYTIME\$\$\$\$\$
 \$\$\$SDGN\$\$\$\$\$
 \$\$\$SERNAME\$\$\$\$\$

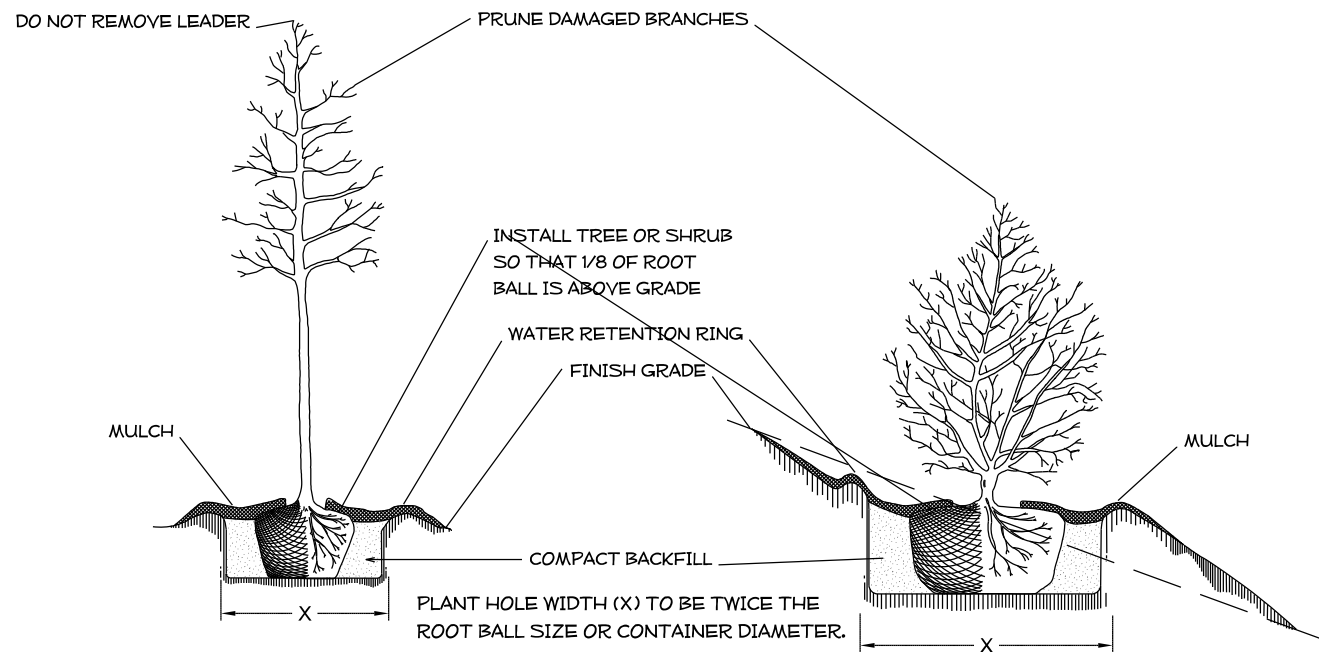

TREE OR SHRUB PLANTING DETAIL
(LEVEL GROUND)

TREE OR SHRUB PLANTING DETAIL
(SLOPING GROUND)

NOTES:

SCHEDULE FOR PLANT HOLE SIZE: PLANT HOLE WIDTH (X) TO BE TWICE THE ROOT BALL SIZE OR CONTAINER DIAMETER.

SEE STANDARD SPECIFICATIONS FOR PLANT BED FUMIGATION AND HERBICIDAL TREATMENT.

APPLY FERTILIZER AT PLANTING TIME IN THE FORM OF A SLOW RELEASE PELLETT OR TABLET. APPLY AT RATE RECOMMENDED BY MANUFACTURER. BOTH RATE AND FORMULATION MUST BE APPROVED BY FIELD ENGINEER PRIOR TO APPLICATION.

REMOVE WIRE BASKET AND FOLD BURLAP BACK FROM TOP OF ROOT BALL BEFORE BACKFILLING IS COMPLETE.

ALL PRUNING TO FOLLOW STANDARD ARBORICULTURAL PRACTICES AS SPECIFIED BY INTERNATIONAL SOCIETY OF ARBORICULTURE.

DO NOT ATTEMPT TO STRAIGHTEN A TREE THAT HAS BEEN PLANTED AT AN ANGLE WITH THE USE OF STAKING OR GUYING. IF NECESSARY, USE STAKES TO UPRIGHT POSITION.

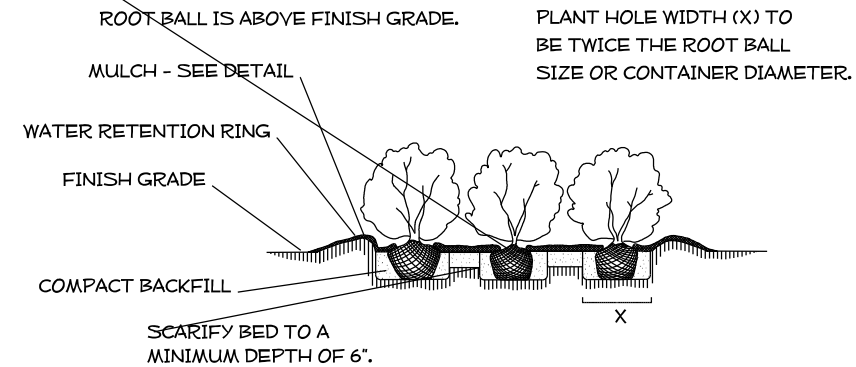

SHRUB BED PLANTING DETAIL

DO NOT PLACE MULCH WITHIN 2" OF TRUNK OR STEM.

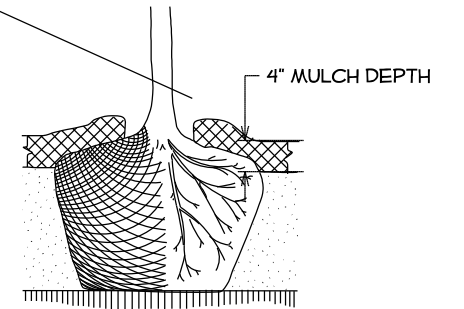

MULCH DETAIL

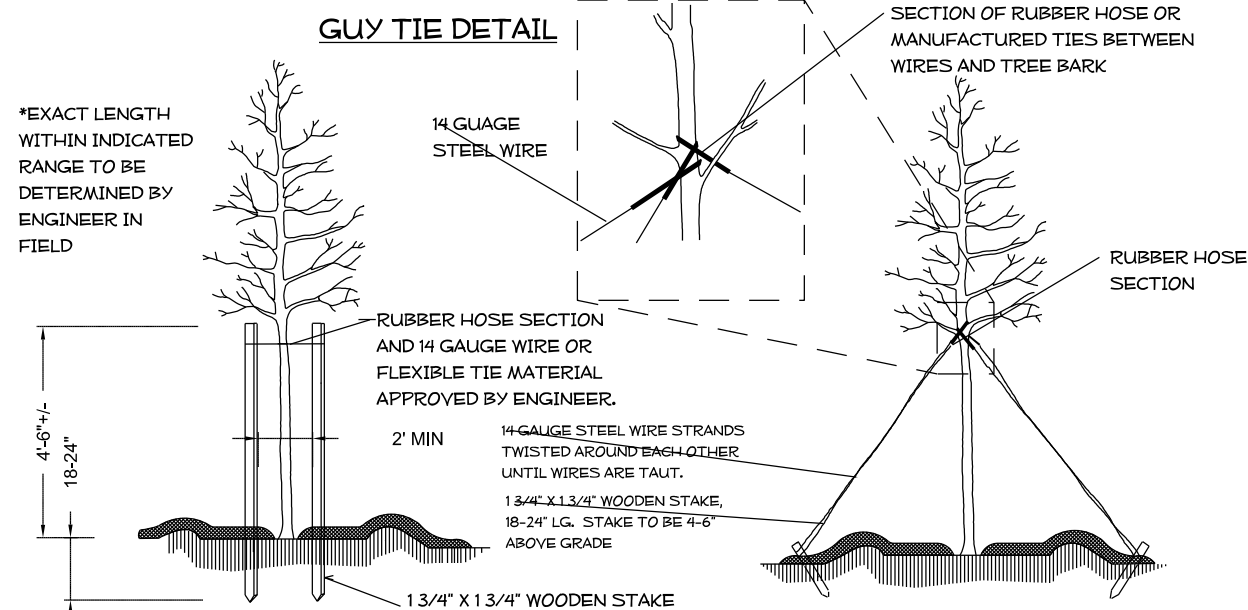

STAKING DETAIL
(TREES 6'-10')

USE AS DIRECTED BY FIELD ENGINEER

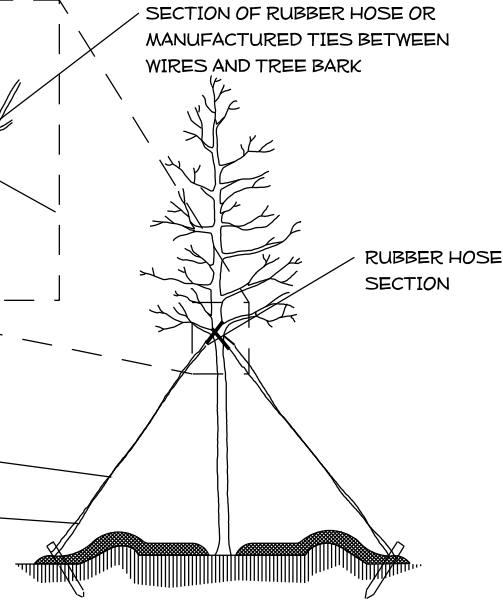

GUYING DETAIL
(TREES 10' OR LARGER)

USE AS DIRECTED BY FIELD ENGINEER

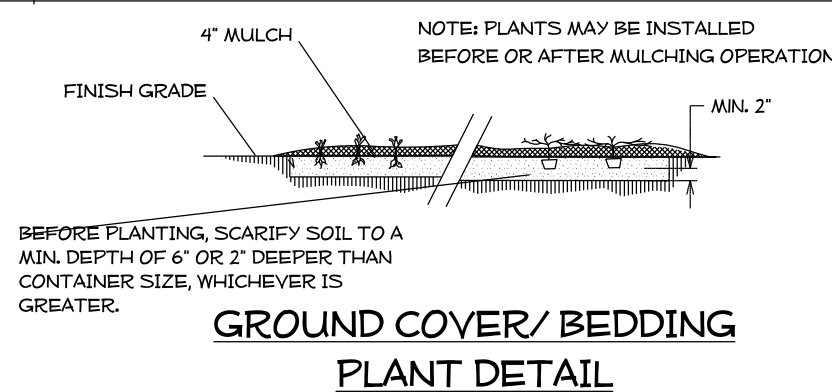

GROUND COVER/ BEDDING PLANT DETAIL

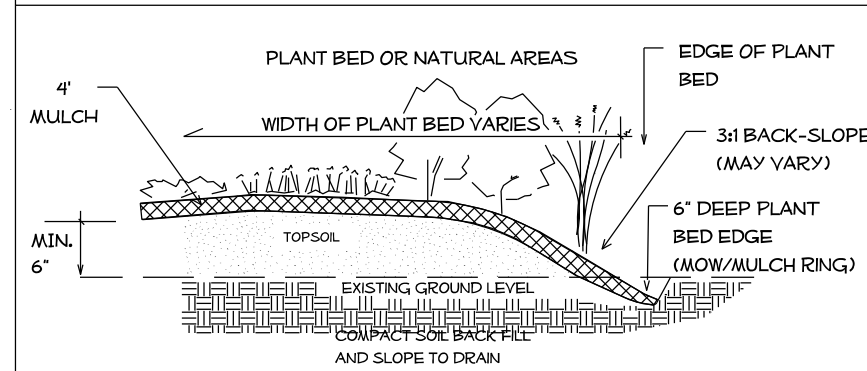

PLANT BED EDGE DETAIL

BLOCK WALL DETAIL

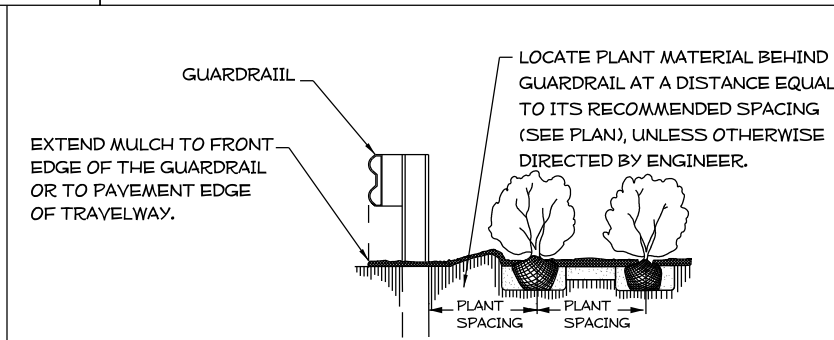

GUARDRAIL MULCHING DETAIL

USE AS DIRECTED BY FIELD ENGINEER



NCDOT - ROADSIDE ENVIRONMENTAL UNIT
LANDSCAPE DESIGN & DEVELOPMENT
1557 MAIL SERVICE CENTER, RALEIGH, NC 27699-1557
PH: 919-707-2920 FAX: 919-715-2554
HTTP://WWW.NCDOT.ORG/DOH/OPERATIONS/DP_CHIEF_ENG/ROADSIDE/

BENSON IMPROVEMENTS

PROJECT #: -----

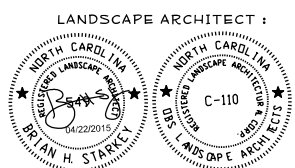

LANDSCAPE ARCHITECT :
LANDSCAPE DETAILS

PREL DESIGN DATE:
10/02/2014
CHECKED BY & DATE :
BHS 04/22/2015
FINAL DESIGN DATE :
04/22/2015



SHEET NO :
LD-1
TOTAL SHEET NO :
9

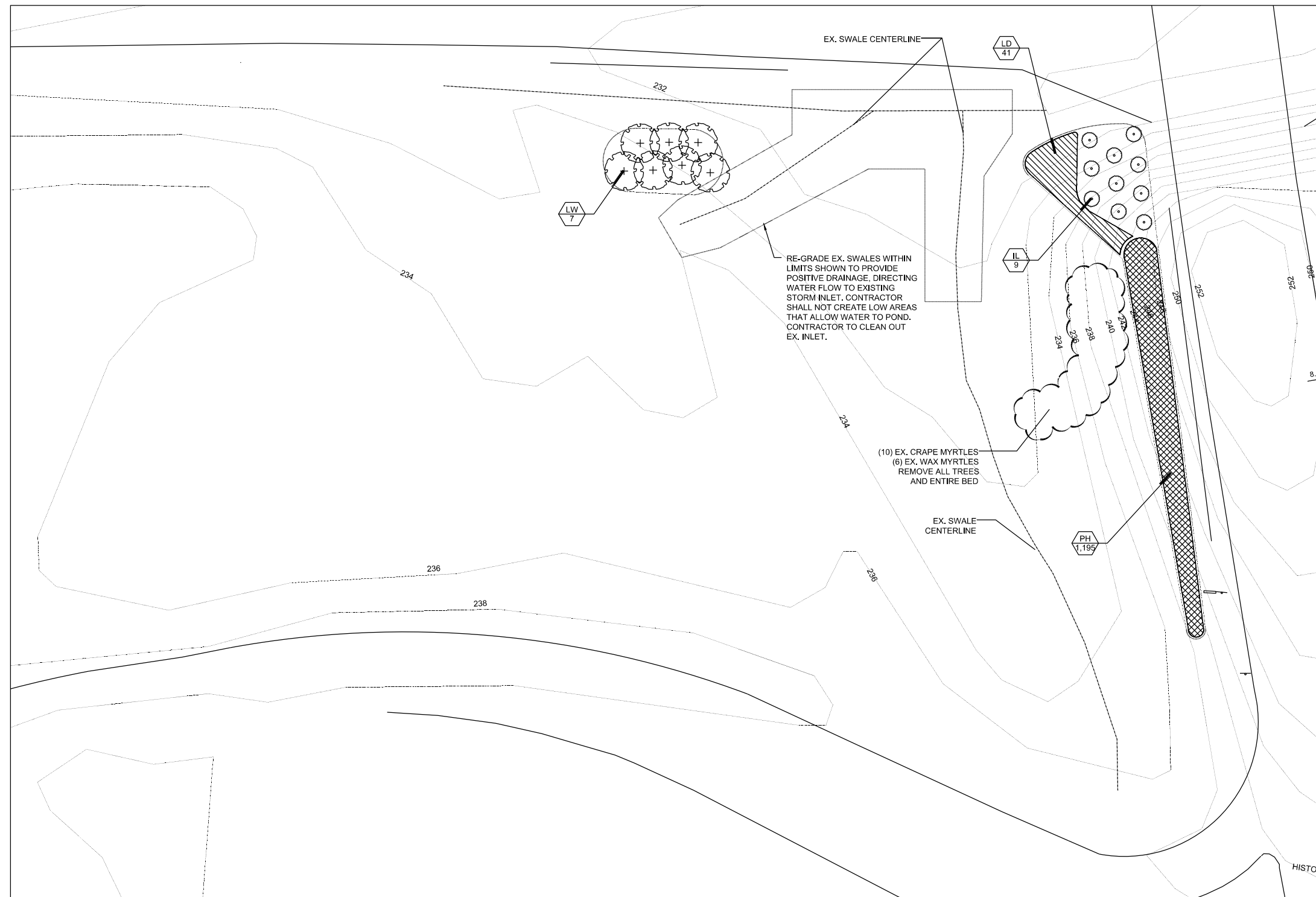

GENERAL PLANTING NOTES:

1. Identify any subsurface utilities prior to commencing work.
2. All plant materials to comply with American Standard for Nursery Stock ANSI.Z60.
3. Substitutions of plant materials specified can only occur with prior approval by Landscape Architect.
4. Maintain positive drainage.
5. Edge all plant materials as defined by details.
6. Contractor to perform soil test in all new plant beds and amend soils as recommended.
7. Install plants and mulch plant beds with 3" shredded hardwood mulch.
8. All trees to be installed after October 1.
9. All trees to be in uniform bed of mulch with the bed edge no less than 5' and no more than 6' from the trunk of the tree.
10. Areas disturbed by construction and not noted for plants shall be seeded and strawed with a Bermuda to match existing turf areas.
11. Contractor to guarantee plant materials for a one year period following substantial completion.
12. Areas damaged by activities of contractor shall be re-established to pre-disturbance condition at no additional cost to the owner.
13. Use herbicides, pesticides, and fertilizer in a manner consistent with the federal insecticide, fungicide, and rodenticide act and in accordance with label restrictions.
14. Contractor shall protect any existing planting not involved in new construction.
15. Contractor shall insure that all plant material is free of fire ants prior to installation.
16. Landscape Architect / Owner shall approve placement of trees prior to planting.

PLANT KEY:

- IL Ilex x 'Nellie R Stevens' / Nellie Stevens Holly
- LW Lagerstroemia x 'Natchez' / White Crape Myrtle Multi-trunk
- LD Loropetalum chinense 'Daruma' / Dwarf Loropetalum
- PH Panicum virgatum 'Heavy Metal' / Blue Switchgrass

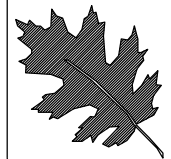
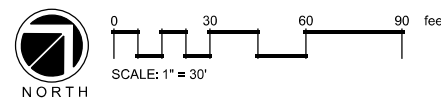
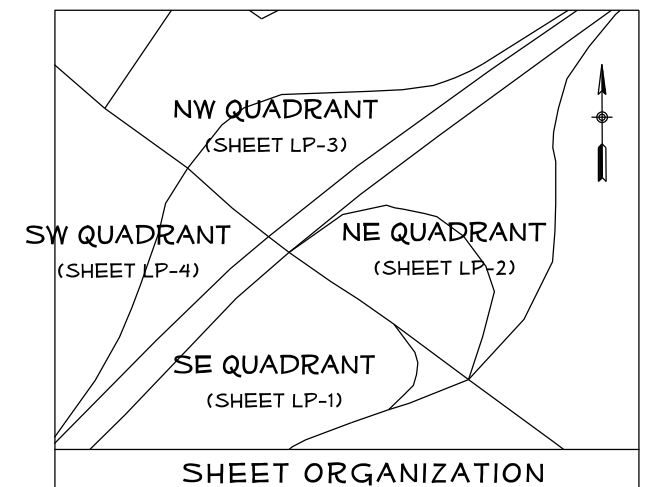

NCDOT - ROADSIDE ENVIRONMENTAL UNIT
 LANDSCAPE DESIGN & DEVELOPMENT
 1557 MAIL SERVICE CENTER, RALEIGH, NC 27699-1557
 PH: 919-707-2920 FAX: 919-715-2554
[HTTP://WWW.NCDOT.ORG/DOH/OPERATIONS/DP_CHIEF_ENG/ROADSIDE/](http://www.ncdot.org/DOH/OPERATIONS/DP_CHIEF_ENG/ROADSIDE/)

LANDSCAPE IMPROVEMENTS
195 @ NC50
 BENSON, NC
 PROJECT #: -----

LANDSCAPE ARCHITECT :

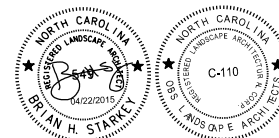

SHEET DESCRIPTION:

LANDSCAPE PLANS
 SE QUADRANT

PREL DESIGN DATE:
 10/02/14
 CHECKED BY & DATE:
 BHS - 04/22/15
 FINAL DESIGN DATE:
 04/22/15

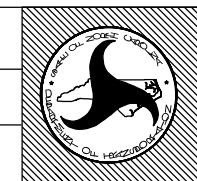

SHEET NO :
LP-1
 TOTAL SHEET NO : 9

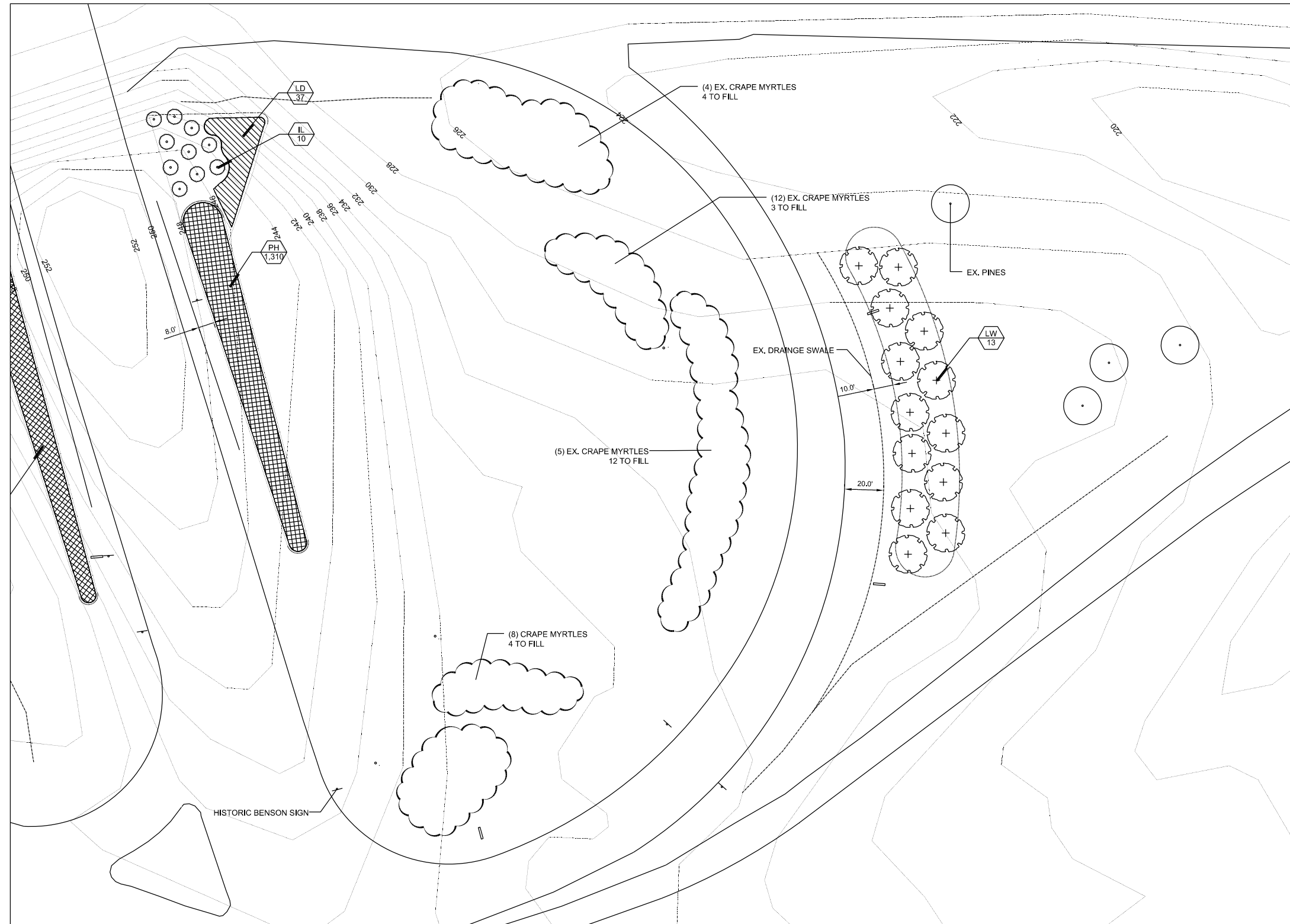

GENERAL PLANTING NOTES:

1. Identify any subsurface utilities prior to commencing work.
2. All plant materials to comply with American Standard for Nursery Stock ANSI.Z60.
3. Substitutions of plant materials specified can only occur with prior approval by Landscape Architect.
4. Maintain positive drainage.
5. Edge all plant materials as defined by details.
6. Contractor to perform soil test in all new plant beds and amend soils as recommended.
7. Install plants and mulch plant beds with 3" shredded hardwood mulch.
8. All trees to be installed after October 1.
9. All trees to be in uniform bed of mulch with the bed edge no less than 5' and no more than 6' from the trunk of the tree.
10. Areas disturbed by construction and not noted for plants shall be seeded and strawed with a Bermuda to match existing turf areas.
11. Contractor to guarantee plant materials for a one year period following substantial completion.
12. Areas damaged by activities of contractor shall be re-established to pre-disturbance condition at no additional cost to the owner.
13. Use herbicides, pesticides, and fertilizer in a manner consistent with the federal insecticide, fungicide, and rodenticide act and in accordance with label restrictions.
14. Contractor shall protect any existing planting not involved in new construction.
15. Contractor shall insure that all plant material is free of fire ants prior to installation.
16. Landscape Architect / Owner shall approve placement of trees prior to planting.

PLANT KEY:

- IL Ilex x 'Nellie R Stevens' / Nellie Stevens Holly
- LW Lagerstroemia x 'Natchez' / White Crape Myrtle Multi-trunk
- LD Loropetalum chinense 'Daruma' / Dwarf Loropetalum
- PH Panicum virgatum 'Heavy Metal' / Blue Switchgrass

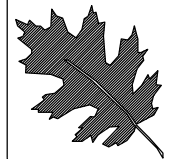
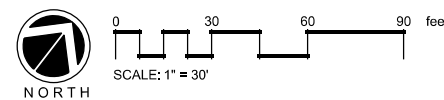
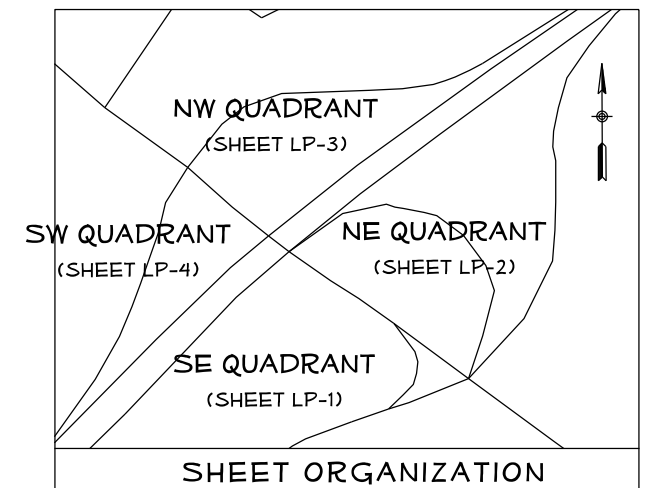

NCDOT - ROADSIDE ENVIRONMENTAL UNIT
 LANDSCAPE DESIGN & DEVELOPMENT
 1557 MAIL SERVICE CENTER, RALEIGH, NC 27699-1557
 PH: 919-707-2920 FAX: 919-715-2554
 HTTP://WWW.NCDOT.ORG/DOH/OPERATIONS/DP_CHIEF_ENG/ROADSIDE/

LANDSCAPE IMPROVEMENTS
 I95 @ NC50
 BENSON, NC
 PROJECT #: -----

LANDSCAPE ARCHITECT :



SHEET DESCRIPTION:

LANDSCAPE PLANS
 NE QUADRANT

PREL DESIGN DATE:
 10/02/14
 CHECKED BY & DATE:
 BHS - 04/22/15
 FINAL DESIGN DATE:
 04/22/15

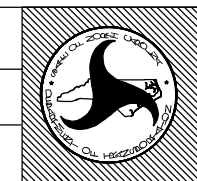

SHEET NO :
LP-2
 TOTAL SHEET NO : 9

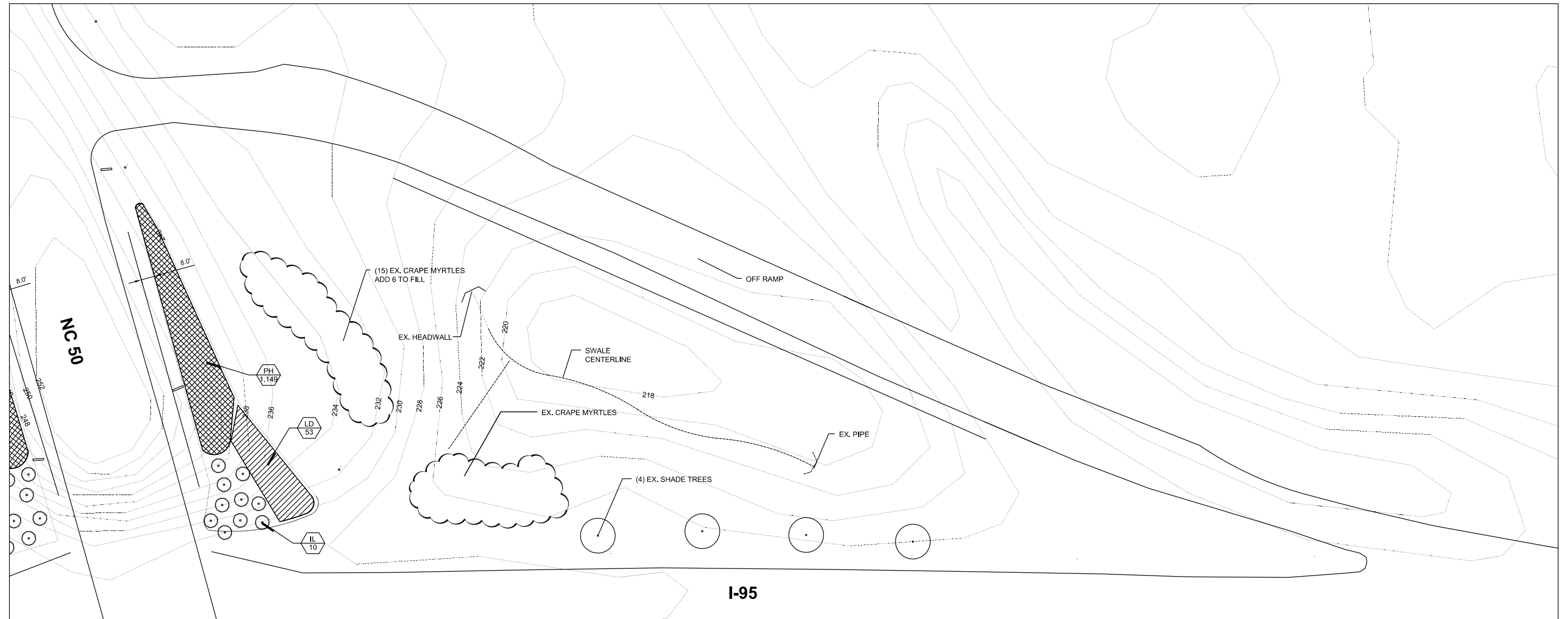

GENERAL PLANTING NOTES:

1. Identify any subsurface utilities prior to commencing work.
2. All plant materials to comply with American Standard for Nursery Stock ANSI.Z60.
3. Substitutions of plant materials specified can only occur with prior approval by Landscape Architect.
4. Maintain positive drainage.
5. Edge all plant materials as defined by details.
6. Contractor to perform soil test in all new plant beds and amend soils as recommended.
7. Install plants and mulch plant beds with 3" shredded hardwood mulch.
8. All trees to be installed after October 1.
9. All trees to be in uniform bed of mulch with the bed edge no less than 5' and no more than 6' from the trunk of the tree.
10. Areas disturbed by construction and not noted for plants shall be seeded and strawed with a Bermuda to match existing turf areas.
11. Contractor to guarantee plant materials for a one year period following substantial completion.
12. Areas damaged by activities of contractor shall be re-established to pre-disturbance condition at no additional cost to the owner.
13. Use herbicides, pesticides, and fertilizer in a manner consistent with the federal insecticide, fungicide, and rodenticide act and in accordance with label restrictions.
14. Contractor shall protect any existing planting not involved in new construction.
15. Contractor shall insure that all plant material is free of fire ants prior to installation.
16. Landscape Architect / Owner shall approve placement of trees prior to planting.

PLANT KEY:

- IL Ilex x 'Nellie R Stevens' / Nellie Stevens Holly
- LW Lagerstroemia x 'Natchez' / White Crape Myrtle Multi-trunk
- LD Loropetalum chinense 'Daruma' / Dwarf Loropetalum
- PH Panicum virgatum 'Heavy Metal' / Blue Switchgrass

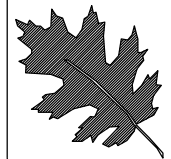
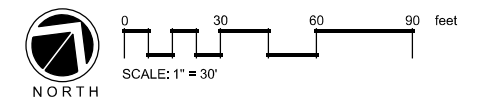
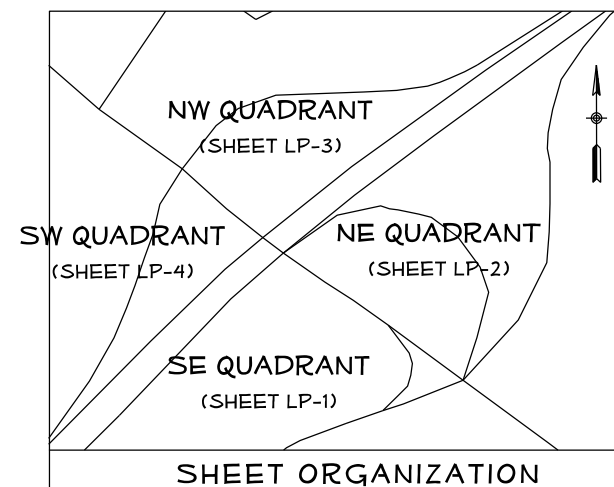

NCDOT - ROADSIDE ENVIRONMENTAL UNIT
LANDSCAPE DESIGN & DEVELOPMENT
 1557 MAIL SERVICE CENTER, RALEIGH, NC 27699-1557
 PH: 919-707-2920 FAX: 919-715-2554
[HTTP://WWW.NCDOT.ORG/DOH/OPERATIONS/DP_CHIEF_ENG/ROADSIDE/](http://www.ncdot.org/DOH/OPERATIONS/DP_CHIEF_ENG/ROADSIDE/)

LANDSCAPE IMPROVEMENTS
I95 @ NC50
 BENSON, NC
 PROJECT #: -----

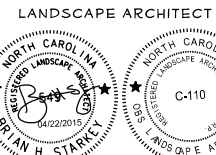

SHEET DESCRIPTION:

LANDSCAPE PLANS
 NW QUADRANT

PREL DESIGN DATE:
 10/02/14
 CHECKED BY & DATE:
 BHS - 04/22/15
 FINAL DESIGN DATE:
 04/22/15

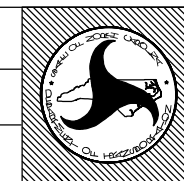

SHEET NO:
LP-3
 TOTAL SHEET NO: 9



GENERAL PLANTING NOTES:

1. Identify any subsurface utilities prior to commencing work.
2. All plant materials to comply with American Standard for Nursery Stock ANSI.Z60.
3. Substitutions of plant materials specified can only occur with prior approval by Landscape Architect.
4. Maintain positive drainage.
5. Edge all plant materials as defined by details.
6. Contractor to perform soil test in all new plant beds and amend soils as recommended.
7. Install plants and mulch plant beds with 3" shredded hardwood mulch.
8. All trees to be installed after October 1.
9. All trees to be in uniform bed of mulch with the bed edge no less than 5' and no more than 6' from the trunk of the tree.
10. Areas disturbed by construction and not noted for plants shall be seeded and strawed with a Bermuda to match existing turf areas.
11. Contractor to guarantee plant materials for a one year period following substantial completion.
12. Areas damaged by activities of contractor shall be re-established to pre-disturbance condition at no additional cost to the owner.
13. Use herbicides, pesticides, and fertilizer in a manner consistent with the federal insecticide, fungicide, and rodenticide act and in accordance with label restrictions.
14. Contractor shall protect any existing planting not involved in new construction.
15. Contractor shall insure that all plant material is free of fire ants prior to installation.
16. Landscape Architect / Owner shall approve placement of trees prior to planting.

PLANT KEY:

- IL Ilex x 'Nellie R Stevens' / Nellie Stevens Holly
- LW Lagerstroemia x 'Natchez' / White Crape Myrtle Multi-trunk
- LD Loropetalum chinense 'Daruma' / Dwarf Loropetalum
- PH Panicum virgatum 'Heavy Metal' / Blue Switchgrass

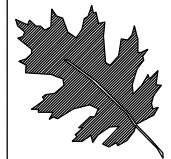
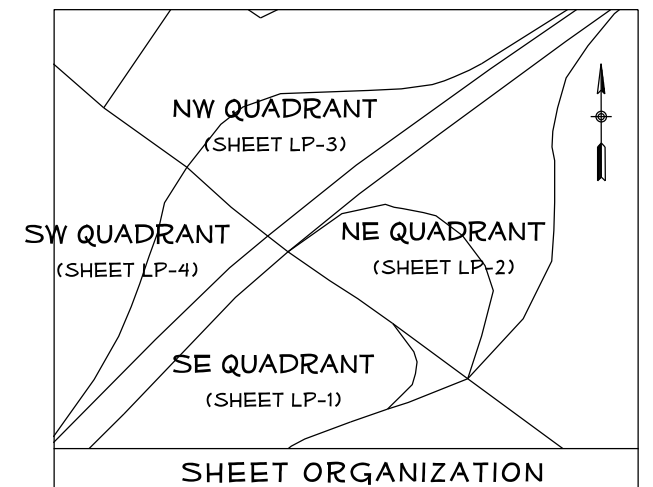
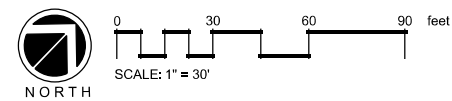

NCDOT - ROADSIDE ENVIRONMENTAL UNIT
 LANDSCAPE DESIGN & DEVELOPMENT
 1557 MAIL SERVICE CENTER, RALEIGH, NC 27699-1557
 PH: 919-707-2920 FAX: 919-715-2554
 HTTP://WWW.NCDOT.ORG/DOH/OPERATIONS/DP_CHIEF_ENG/ROADSIDE/

LANDSCAPE IMPROVEMENTS
I95 @ NC50
 BENSON, NC
 PROJECT #: -----

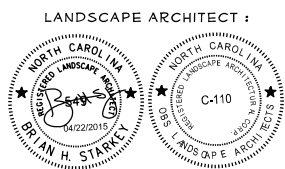

SHEET DESCRIPTION:

LANDSCAPE PLANS
 SW QUADRANT

PREL DESIGN DATE:
 10/02/14
 CHECKED BY & DATE:
 BHS - 04/22/15
 FINAL DESIGN DATE:
 04/22/2015

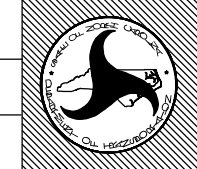

SHEET NO:
LP-4
 TOTAL SHEET NO: 9

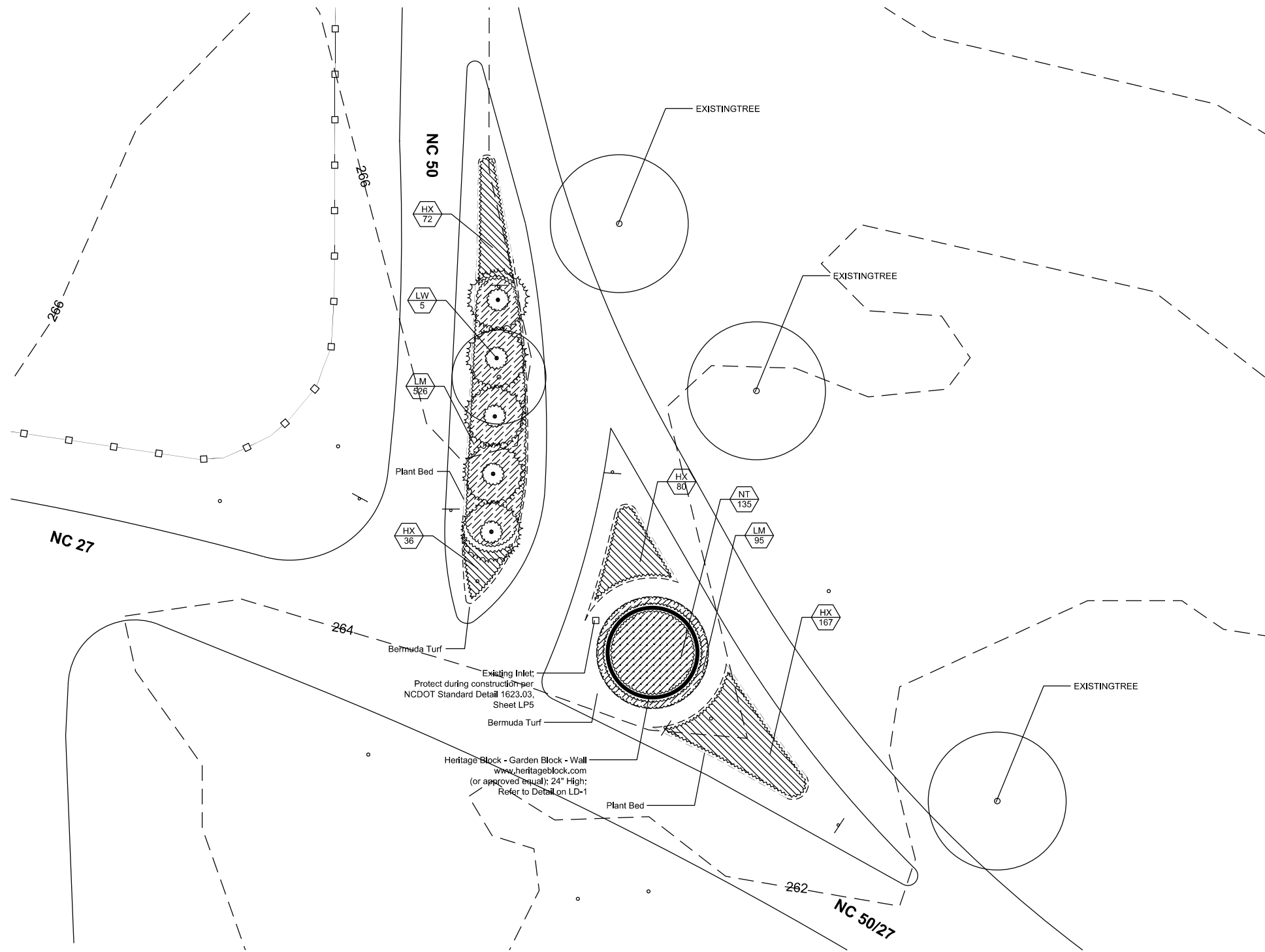

GENERAL PLANTING NOTES:

1. Identify any subsurface utilities prior to commencing work.
2. All plant materials to comply with American Standard for Nursery Stock ANSI.Z60.
3. Substitutions of plant materials specified can only occur with prior approval by Landscape Architect.
4. Maintain positive drainage.
5. Establish plant bed configuration. Landscape Architect to approve bed layout in field.
6. Edge all plant materials as defined by details.
7. Contractor to perform soil test in all new plant beds and amend soils as recommended.
8. Install plants and mulch plant beds with 3" shredded hardwood mulch.
9. All trees to have a min. 5' diameter mulch ring.
10. All trees to be installed after October 1.
11. Areas disturbed by construction and not noted for plants shall be seeded and strawed with Bermuda to match existing turf areas.
12. Contractor to guarantee plant materials for a one year period following substantial completion.
13. Areas damaged by activities of contractor shall be re-established to pre-disturbance condition at no additional cost to the owner.
14. Use herbicides, pesticides, and fertilizer in a manner consistent with the federal insecticide, fungicide, and rodenticide act and in accordance with label restrictions.
15. Contractor shall protect any existing planting not involved in new construction.
16. Contractor shall insure that all plant material is free of fire ants prior to installation.
17. Landscape Architect / Owner shall approve placement of trees prior to planting.

PLANT KEY:

- LW Lagerstroemia x 'Natchez' / White Crape Myrtle Multi-trunk
- HX Hemerocallis x 'Buttered Popcorn' / Daylily
- LM Liriope muscari 'Big Blue' / Big Blue Lilyturf
- NT Nasella tenuissima / Mexican Feather Grass

Existing Inlet:
Protect during construction per
NCDOT Standard Detail 1623.03,
Sheet LP5

Heritage Block - Garden Block - Wall
www.heritageblock.com
(or approved equal); 24" High;
Refer to Detail on LD-1

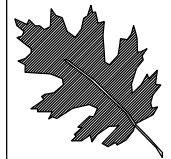
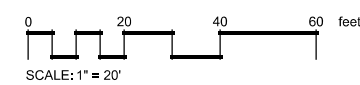

NCDOT - ROADSIDE ENVIRONMENTAL UNIT
LANDSCAPE DESIGN & DEVELOPMENT
1557 MAIL SERVICE CENTER, RALEIGH, NC 27699-1557
PH: 919-707-2920 FAX: 919-715-2554
[HTTP://WWW.NCDOT.ORG/DOH/OPERATIONS/DP_CHIEF_ENG/ROADSIDE/](http://www.ncdot.org/DOH/OPERATIONS/DP_CHIEF_ENG/ROADSIDE/)

LANDSCAPE IMPROVEMENTS
NC50 @ NC27
BENSON, NC
PROJECT #: -----

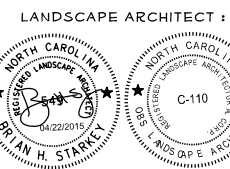

SHEET DESCRIPTION:

LANDSCAPE PLANS

PREL DESIGN DATE:
10/02/14
CHECKED BY & DATE:
BHS - 04/22/15
FINAL DESIGN DATE:
04/22/15

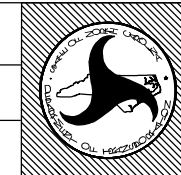

SHEET NO:
LP-5
TOTAL SHEET NO: 9

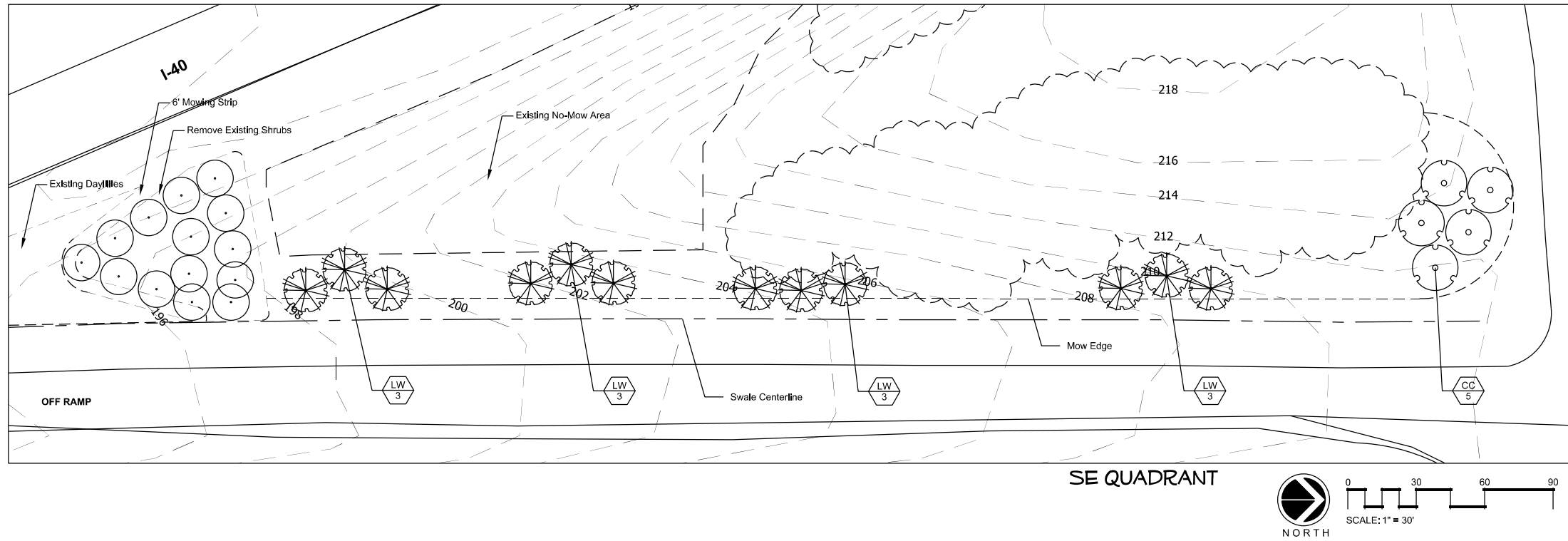

GENERAL PLANTING NOTES:

1. Identify any subsurface utilities prior to commencing work.
2. All plant materials to comply with American Standard for Nursery Stock ANSI.Z60.
3. Substitutions of plant materials specified can only occur with prior approval by Landscape Architect.
4. Maintain positive drainage.
5. Edge all plant materials as defined by details.
6. Contractor to perform soil test in all new plant beds and amend soils as recommended.
7. Install plants and mulch plant beds with 3" shredded hardwood mulch.
8. All trees to be installed after October 1.
9. All trees to be in uniform bed of mulch with the bed edge no less than 5' and no more than 6' from the trunk of the tree.
10. Areas disturbed by construction and not noted for plants shall be seeded and strawed with Bermuda to match existing turf areas.
11. Contractor to guarantee plant materials for a one year period following substantial completion.
12. Areas damaged by activities of contractor shall be re-established to pre-disturbance condition at no additional cost to the owner.
13. Use herbicides, pesticides, and fertilizer in a manner consistent with the federal insecticide, fungicide, and rodenticide act and in accordance with label restrictions.
14. Contractor shall protect any existing planting not involved in new construction.
15. Contractor shall insure that all plant material is free of fire ants prior to installation.
16. Landscape Architect / Owner shall approve placement of trees prior to planting.

PLANT KEY:

- CH *Cercis canadensis* 'Hearts of Gold' / Forest Pansy Redbud
- LW *Lagerstroemia* x 'Natchez' / White Crape Myrtle Multi-trunk

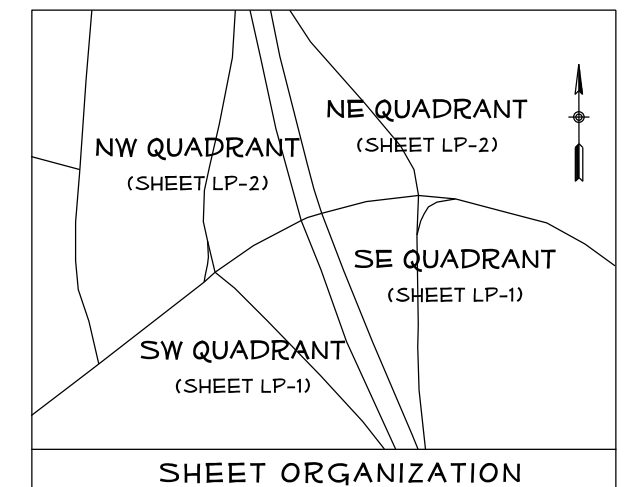
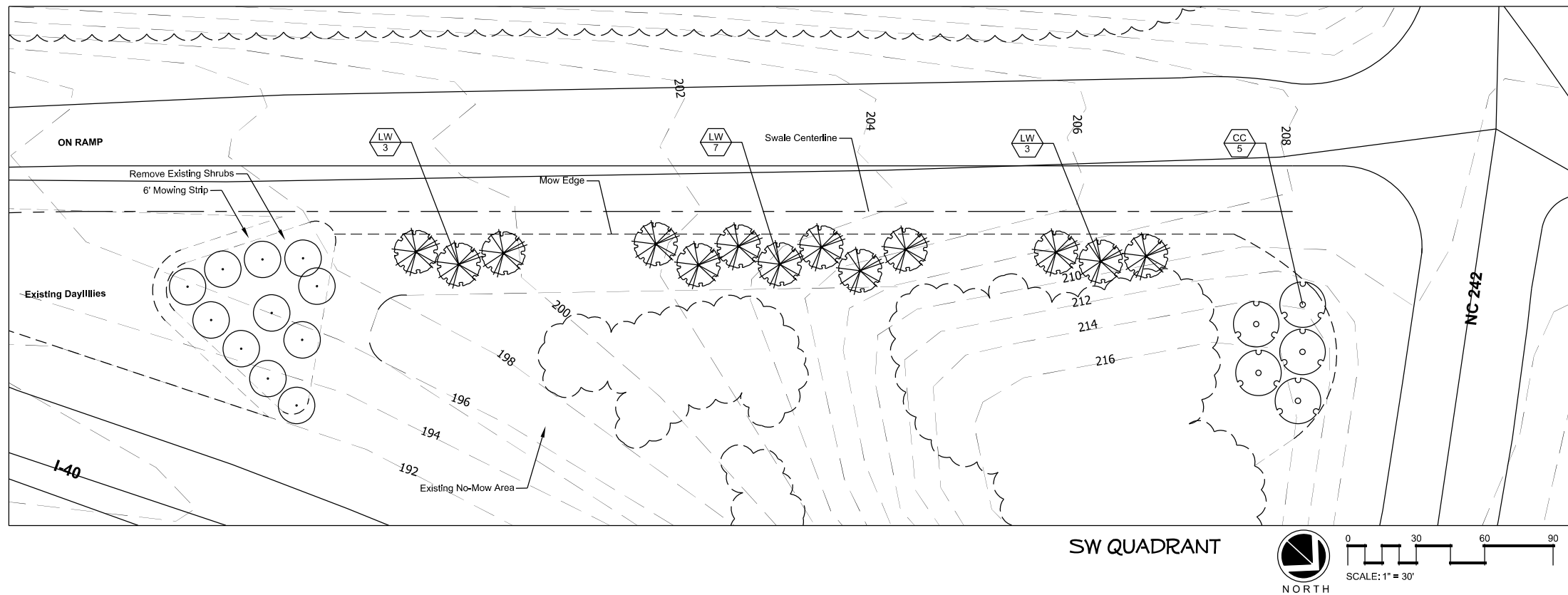

NCDOT - ROADSIDE ENVIRONMENTAL UNIT
 LANDSCAPE DESIGN & DEVELOPMENT
 1557 MAIL SERVICE CENTER, RALEIGH, NC 27699-1557
 PH: 919-707-2920 FAX: 919-715-2554
 HTTP://WWW.NCDOT.ORG/DOH/OPERATIONS/DP_CHIEF_ENG/ROADSIDE/

LANDSCAPE IMPROVEMENTS
 I40 @ NC242
 BENSON, NC
 PROJECT #: -----

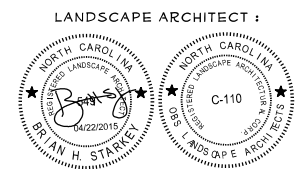

LANDSCAPE ARCHITECT :
 LANDSCAPE PLANS
 SOUTHERN QUADRANTS

PREL DESIGN DATE:
 10/02/14
 CHECKED BY & DATE:
 BHS - 04/22/2015
 FINAL DESIGN DATE:
 04/22/2015

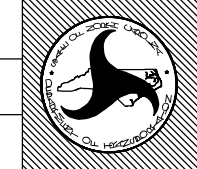

SHEET NO :
LP-6
 TOTAL SHEET NO : 9

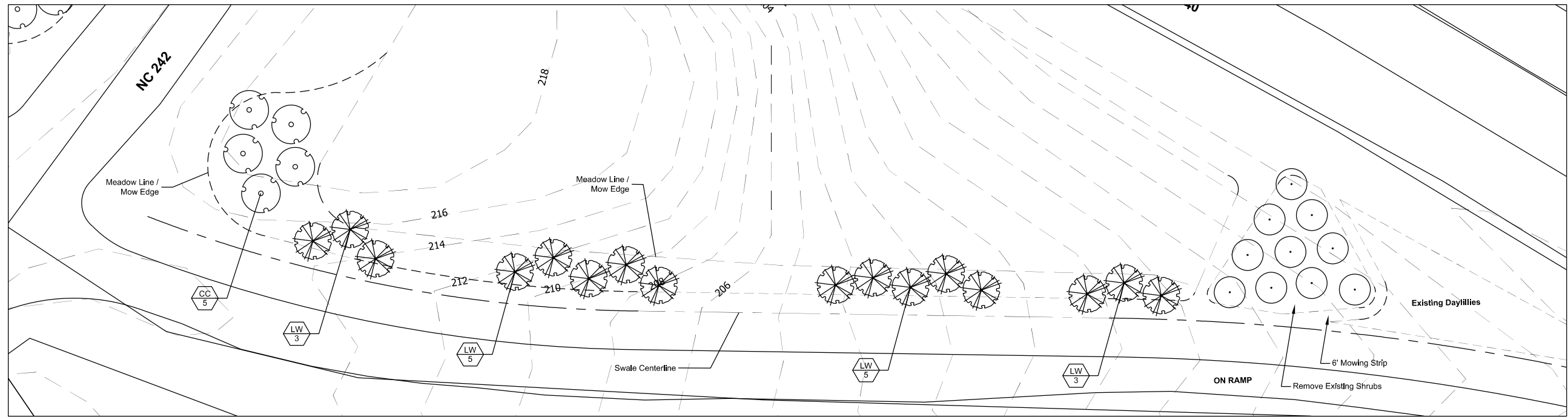

NE QUADRANT

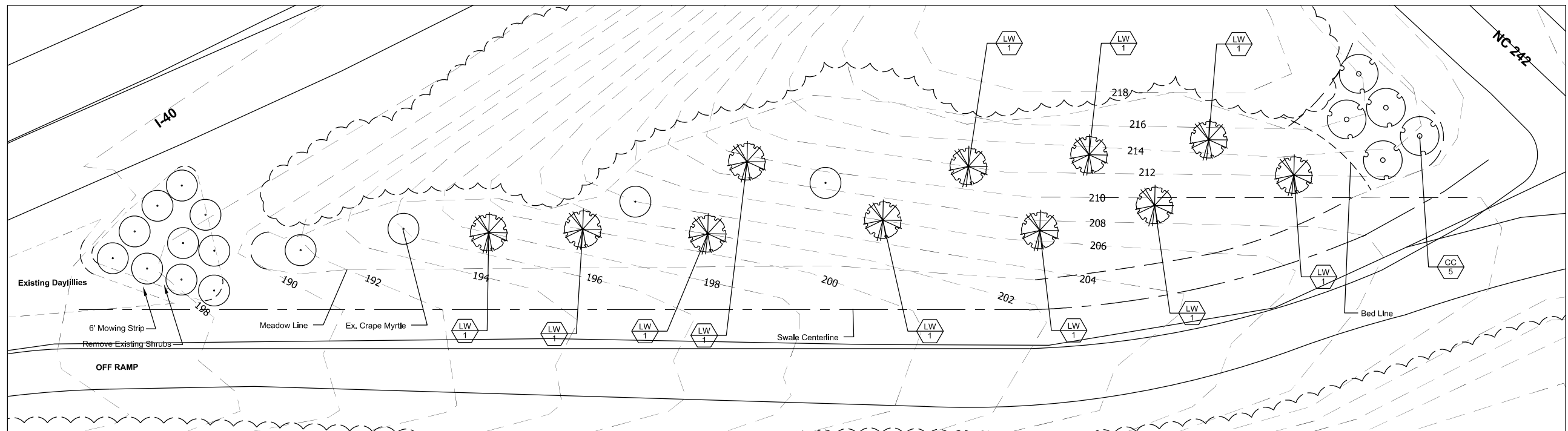
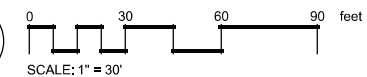

NW QUADRANT

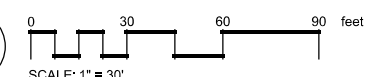

PLANT KEY:

- CH Cercis canadensis 'Hearts of Gold' / Forest Pansy Redbud
- LW Lagerstroemia x 'Natchez' / White Crape Myrtle Multi-trunk

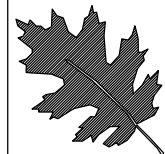

NCDOT - ROADSIDE ENVIRONMENTAL UNIT
 LANDSCAPE DESIGN & DEVELOPMENT
 1557 MAIL SERVICE CENTER, RALEIGH, NC 27699-1557
 PH: 919-707-2920 FAX: 919-715-2554
[HTTP://WWW.NCDOT.ORG/DOH/OPERATIONS/DP_CHIEF_ENG/ROADSIDE/](http://www.ncdot.org/DOH/OPERATIONS/DP_CHIEF_ENG/ROADSIDE/)

LANDSCAPE IMPROVEMENTS
 I40 @ NC242
 BENSON, NC
 PROJECT #: -----

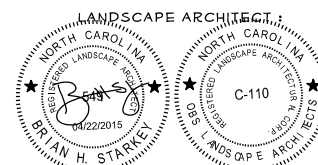

SHEET DESCRIPTION:

LANDSCAPE PLANS
 NORTHERN QUADRANTS

PREL DESIGN DATE:
10/02/14
 CHECKED BY & DATE:
BHS - 04/22/15
 FINAL DESIGN DATE:
04/22/2015

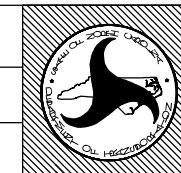

SHEET NO:
LP-7
 TOTAL SHEET NO: 9