



STATE OF NORTH CAROLINA  
DEPARTMENT OF TRANSPORTATION

ROY COOPER  
GOVERNOR

J.R. "JOEY" HOPKINS  
SECRETARY

November 15, 2023

**Addendum No. 1**

RE: **DD00441**  
**Wayne County**

To Whom It May Concern:

Reference is made to the above-mentioned project. The following changes/additions have been made:

1. There was an error in the Description of Map #6, SR-1731/Piney Grove Church Road. The Description of this map has been corrected on the Summary of Quantities and an additional map sheet has been included to highlight this map. Please replace both Summary of Quantities sheets and all the map sheets in the proposal with the attached pages.
2. There are 3 maps that include shoulder reconstruction but the item/quantity for borrow was inadvertently left out. This has been corrected on the revised Summary of Quantities. Please also add the attached Proposal Item Sheets dated Nov 15, 2023 to the proposal as pages 124 and 125, as the original Proposal Item Sheets were not included in the advertised proposal.

***This sheet and attachments shall be made a part of the plans and bid documents and shall be submitted with the bid. Bids submitted without the addenda and attachments will be considered non-responsive.***

If there are any questions, please contact me at (252) 640-6433.

Sincerely,

DocuSigned by:  
*Vickie P. Gardner*  
BD9FE36C1AA642B...

11/15/2023

Vickie P. Gardner  
Division Four Contract Engineer

VPG/  
Attachments

Mailing Address:  
NC DEPARTMENT OF TRANSPORTATION  
DIVISION FOUR OFFICE  
POST OFFICE BOX 3165  
WILSON, NC 27895

Telephone: (252) 640-6400  
Fax: (252) 234-6174  
Customer Service: 1-877-368-4968

Website: [www.ncdot.gov](http://www.ncdot.gov)

Location:  
509 WARD BOULEVARD  
WILSON, NC 27895

PROJECT NO.	SHEET NO.	TOTAL NO.
2024CPT.04.12.10961,	1	2
2024CPT.04.12.20961		

### SUMMARY OF QUANTITIES

PROJECT NO	COUNTY	MAP NO	ROUTE	DESCRIPTION	TYP NO	LANES	LANE TYPE	FINAL SURFACE TESTING REQUIRED	WARM MIX ASPHALT REQUIRED	LENGTH		BEGIN MP	END MP	010600000-E	122000000-E	124500000-E	129700000-E	133000000-E	150300000-E	151900000-E	152300000-E	157500000-E	170400000-E	600000000-E	607101000-E	608400000-E	611700000-N					
										BORROW	INCIDENTAL STONE BASE			SHOULDER RECONSTRUCTION	1½" MILLING	INCIDENTAL MILLING	INTERMEDIATE COURSE, 119.0C	SURFACE COURSE, S9.5B	SURFACE COURSE, S9.5C	ASPHALT BINDER FOR PLANT MIX	PATCHING EXISTING PAVEMENT	TEMPORARY SILT FENCE	WATTLE	SEED & MULCHING	RESPONSE FOR EROSION CONTROL							
										MI	FT			TONS	SMI	SY	SY	TONS	TONS	TONS	TONS	TONS	LF	LF	AC	EA						
2024CPT.04.12.20961	Wayne	1	US-117 ALT	FROM SR-1581 SCALE DR TO SR-1548 SOUTH ST	1	2	2WU	NO	NO	0.473	32	19.64	20.113																			
		"	"	FROM SR-1548 SOUTH ST TO SR-1548 NORTH ST	1	2	2WU	NO	NO	0.17	24	20.113	20.283																			
		"	"	FROM SR-1548 NORTH ST TO TWO-LANE	1	3	2WU - Two-lane two-way undivided traffic	NO	NO	0.303	32	20.283	20.586																			
		"	"	FROM CENTER LANE SECTION TO SR-1537 AIRPORT RD	1	2	2WD	NO	NO	0.568	24	20.586	21.154																			
<b>TOTAL FOR MAP NO. 1</b>										<b>1.514</b>																						
<b>TOTAL FOR PROJ NO. 2024CPT.04.12.10961</b>										<b>1.514</b>		<b>80.622</b>	<b>82.136</b>			<b>40</b>		<b>24,959</b>	<b>5,000</b>			<b>1,808</b>	<b>106</b>									
2024CPT.04.12.20961	Wayne	2	SR-1008 / STEVENS MILL ROAD	FROM 250 FT NORTH OF RRX TO SR-1223 BLACK JACK CHURCH RD	2	2	2WU	NO	NO	3.9	20	0.35	4.25	800	40	7.80		500	2,261	4,554		406	40	800	800	3.90	1					
<b>TOTAL FOR MAP NO. 2</b>										<b>3.9</b>				<b>800</b>	<b>40</b>	<b>7.80</b>		<b>500</b>	<b>2,261</b>	<b>4,554</b>		<b>406</b>	<b>40</b>	<b>800</b>	<b>800</b>	<b>3.90</b>	<b>1</b>					
2024CPT.04.12.20961	Wayne	3	SR-1008 / STEVENS MILL ROAD	FROM NC-581 TO 250 FT NORTH OF RRX JOINT	3	2	2WU	NO	NO	0.35	36	0	0.35									612										
<b>TOTAL FOR MAP NO. 3</b>										<b>0.35</b>												<b>612</b>										
2024CPT.04.12.20961	Wayne	4	SR-1719 / SOUTH BESTON ROAD	FROM SR-1731 PINEY GROOVE CHURCH RD TO COUNTRY RD	2	2	2WU	NO	NO	1.932	24	0	1.932	400	30	3.86		250	1,120	2,256		202	30	400	400	1.93	1					
<b>TOTAL FOR MAP NO. 4</b>										<b>1.932</b>				<b>400</b>	<b>30</b>	<b>3.86</b>		<b>250</b>	<b>1,120</b>	<b>2,256</b>		<b>202</b>	<b>30</b>	<b>400</b>	<b>400</b>	<b>1.93</b>	<b>1</b>					
2024CPT.04.12.20961	Wayne	5	SR-1719 / NORTH BESTON ROAD	FROM US HWY 70 TO SR-1714 PARKSTOWN RD	4	2	2WU	NO	NO	4.223	20	2.03	6.253									4,113										
<b>TOTAL FOR MAP NO. 5</b>										<b>4.223</b>												<b>4,113</b>										
2024CPT.04.12.20961	Wayne	6	SR-1731 / PINEY GROVE CHURCH ROAD	FROM SR-1719 S BESTON RD TO WHITEHALL BRIDGE/NEUSE RIVER	2	2	2WU	NO	NO	4.44	24	1.86	6.3	900	40	8.88		250	2,574	5,184		464	65	1,000	1,000	4.44	1					
<b>TOTAL FOR MAP NO. 6</b>										<b>4.44</b>				<b>900</b>	<b>40</b>	<b>8.88</b>		<b>250</b>	<b>2,574</b>	<b>5,184</b>		<b>464</b>	<b>65</b>	<b>1,000</b>	<b>1,000</b>	<b>4.44</b>	<b>1</b>					
2024CPT.04.12.20961	Wayne	7	SR-1918 / PECAN ROAD	FROM NC-581 TO SR-1926 OLD MOUNT OLIVE RD	4	2	2WD	NO	NO	2.37	24	0	2.37									625										
<b>TOTAL FOR MAP NO. 7</b>										<b>2.37</b>												<b>625</b>										
2024CPT.04.12.20961	Wayne	8	SR-1305 / WEST HOOKS RIVER ROAD	FROM SR-1300 SALEM CHURCH RD TO US-117	5	2	2WU	NO	NO	0.73	20	0	0.73									10										
<b>TOTAL FOR MAP NO. 8</b>										<b>0.73</b>												<b>10</b>										
2024CPT.04.12.20961	Wayne	9	SR-1306 / FEDELON TRAIL	FROM SR-1300 SALEM CHURCH RD TO US-117	5	2	2WU	NO	NO	0.92	20	0	0.92									10										
<b>TOTAL FOR MAP NO. 9</b>										<b>0.92</b>												<b>10</b>										
<b>TOTAL FOR PROJ NO. 2024CPT.04.12.20961</b>										<b>18.865</b>		<b>4.24</b>	<b>23.105</b>	<b>2,100</b>	<b>210</b>	<b>20.54</b>	<b>7,392</b>	<b>2,550</b>	<b>5,955</b>	<b>20,830</b>		<b>1,651</b>	<b>245</b>	<b>2,200</b>	<b>2,200</b>	<b>10.27</b>	<b>3</b>					
<b>GRAND TOTAL</b>										<b>20.379</b>		<b>84.862</b>	<b>105.241</b>	<b>2,100</b>	<b>250</b>	<b>20.54</b>	<b>32,351</b>	<b>7,550</b>	<b>5,955</b>	<b>20,830</b>	<b>1,808</b>	<b>1,757</b>	<b>245</b>	<b>2,200</b>	<b>2,200</b>	<b>10.27</b>	<b>3</b>					

PROJECT NO.	SHEET NO.	TOTAL NO.
2024CPT.04.12.10961,	2	2
2024CPT.04.12.20961		

### THERMOPLASTIC AND PAINT QUANTITIES

PROJECT NO	COUNTY	MAP NO	ROUTE	DESCRIPTION	TYP NO	LANES	LANE TYPE	LENGTH	WIDTH	BEGIN MP	END MP	4413000000-E	4457000000-N	4688000000-E	4695000000-E	4704000000-E	4709000000-E	4720000000-E	4725000000-E		4890000000-E					
												WORK ZONE	TEMPORARY	6" X 90 M	6" X 90 M	8" X 90 M	8" X 90 M	THERMOPLASTIC	THERMOPLASTIC	THERMO RXR	THERMO LT	THERMO STR	THERMO RT	4" X 50 M	4" X 50 M	
												ADVANCE/GENERAL	TRAFFIC	YELLOW	WHITE	WHITE	YELLOW	PAVEMENT	PAVEMENT	90 M	ARROW	& RT ARROW	ARROW	WHITE HOT	YELLOW HOT	
								MI	FT			SF	LS	LF	LF	LF	LF	LF	EA	EA	EA	EA	LF	LF		
2024CPT.04.12.10961	Wayne	1	US-117 ALT	FROM SR-1581 SCALE DR TO SR-1548 SOUTH ST	1	2	2WU	0.473	32	19.64	20.113	26	0.05	8,514	5,089	70	60			13						
		"	"	FROM SR-1548 SOUTH ST TO SR-1548 NORTH ST	1	2	2WU	0.17	24	20.113	20.283	10	0.05	1,829	1,829		60									
		"	"	FROM SR-1548 NORTH ST TO TWO-LANE	1	3	2WU	0.303	32	20.283	20.586	17	0.05	5,454	3,260		60			8						
		"	"	FROM CENTER LANE SECTION TO SR-1537 AIRPORT RD	1	2	2WU	0.568	24	20.586	21.154	32	0.05	6,112	6,112											
<b>TOTAL FOR MAP NO. 1</b>								<b>1.514</b>				<b>85</b>	<b>0.20</b>	<b>21,909</b>	<b>16,290</b>	<b>70</b>	<b>180</b>			<b>21</b>						
<b>TOTAL FOR PROJ NO. 2024CPT.04.12.10961</b>								<b>1.514</b>			<b>80.622</b>	<b>82.136</b>	<b>85</b>	<b>0.20</b>	<b>21,909</b>	<b>16,290</b>	<b>70</b>	<b>180</b>			<b>21</b>					
														<b>38,199</b>		<b>250</b>					<b>21</b>					
2024CPT.04.12.20961	Wayne	2	SR-1008 / STEVENS MILL ROAD	FROM 250 FT NORTH OF RRX TO SR-1223 BLACK JACK CHURCH RD	2	2	2WU	3.9	20	0.35	4.25	218	0.15					50	70	4			41,184	35,100		
<b>TOTAL FOR MAP NO. 2</b>								<b>3.9</b>				<b>218</b>	<b>0.15</b>					<b>50</b>	<b>70</b>	<b>4</b>				<b>41,184</b>	<b>35,100</b>	
2024CPT.04.12.20961	Wayne	3	SR-1008 / STEVENS MILL ROAD	FROM NC-581 TO 250 FT NORTH OF RRX JOINT	3	2	2WU	0.35	36	0	0.35	20	0.05	7,000	3,696											
<b>TOTAL FOR MAP NO. 3</b>								<b>0.35</b>				<b>20</b>	<b>0.05</b>	<b>7,000</b>	<b>3,696</b>											
2024CPT.04.12.20961	Wayne	4	SR-1719 / SOUTH BESTON ROAD	FROM SR-1731 PINEY GROOVE CHURCH RD TO COUNTRY RD	2	2	2WU	1.932	24	0	1.932	108	0.10							2	2		20,788	17,388		
<b>TOTAL FOR MAP NO. 4</b>								<b>1.932</b>				<b>108</b>	<b>0.10</b>								<b>2</b>	<b>2</b>		<b>20,788</b>	<b>17,388</b>	
2024CPT.04.12.20961	Wayne	5	SR-1719 / NORTH BESTON ROAD	FROM US HWY 70 TO SR-1714 PARKSTOWN RD	4	2	2WU	4.223	20	2.03	6.253	236	0.15					150	120	4			45,439	38,007		
<b>TOTAL FOR MAP NO. 5</b>								<b>4.223</b>				<b>236</b>	<b>0.15</b>					<b>150</b>	<b>120</b>	<b>4</b>				<b>45,439</b>	<b>38,007</b>	
2024CPT.04.12.20961	Wayne	6	SR-1731 / PINEY GROVE CHURCH ROAD	FROM SR-1719 S BESTON RD TO WHITEHALL BRIDGE/NEUSE RIVER	2	2	2WU	4.44	24	1.86	6.3	249	0.15										47,774	39,960		
<b>TOTAL FOR MAP NO. 6</b>								<b>4.44</b>				<b>249</b>	<b>0.15</b>											<b>47,774</b>	<b>39,960</b>	
2024CPT.04.12.20961	Wayne	7	SR-1918 / PECAN ROAD	FROM NC-581 TO SR-1926 OLD MOUNT OLIVE RD	4	2	2WD	2.37	24	0	2.37	133	0.10							2	2		25,501	21,330		
<b>TOTAL FOR MAP NO. 7</b>								<b>2.37</b>				<b>133</b>	<b>0.10</b>								<b>2</b>	<b>2</b>		<b>25,501</b>	<b>21,330</b>	
2024CPT.04.12.20961	Wayne	8	SR-1305 / WEST HOOKS RIVER ROAD	FROM SR-1300 SALEM CHURCH RD TO US-117	5	2	2WU	0.73	20	0	0.73	41	0.05					50	70	4			7,855	6,570		
<b>TOTAL FOR MAP NO. 8</b>								<b>0.73</b>				<b>41</b>	<b>0.05</b>					<b>50</b>	<b>70</b>	<b>4</b>				<b>7,855</b>	<b>6,570</b>	
2024CPT.04.12.20961	Wayne	9	SR-1306 / FEDELON TRAIL	FROM SR-1300 SALEM CHURCH RD TO US-117	5	2	2WU	0.92	20	0	0.92	52	0.05					50	70	4			9,899	8,280		
<b>TOTAL FOR MAP NO. 9</b>								<b>0.92</b>				<b>52</b>	<b>0.05</b>					<b>50</b>	<b>70</b>	<b>4</b>				<b>9,899</b>	<b>8,280</b>	
<b>TOTAL FOR PROJ NO. 2024CPT.04.12.20961</b>								<b>18.865</b>		<b>4.24</b>	<b>23.105</b>	<b>1,057</b>	<b>0.800</b>	<b>7,000</b>	<b>3,696</b>			<b>300</b>	<b>330</b>	<b>16</b>	<b>4</b>	<b>2</b>	<b>2</b>		<b>198,440</b>	<b>166,635</b>
														<b>10,696</b>							<b>8</b>			<b>365,075</b>		
<b>GRAND TOTAL</b>								<b>20.379</b>			<b>84.862</b>	<b>105.241</b>	<b>1,142</b>	<b>1.000</b>	<b>28,909</b>	<b>19,986</b>	<b>70</b>	<b>180</b>	<b>300</b>	<b>330</b>	<b>16</b>	<b>25</b>	<b>2</b>	<b>2</b>	<b>198,440</b>	<b>166,635</b>
														<b>48,895</b>		<b>250</b>					<b>29</b>			<b>365,075</b>		

# WAYNE COUNTY

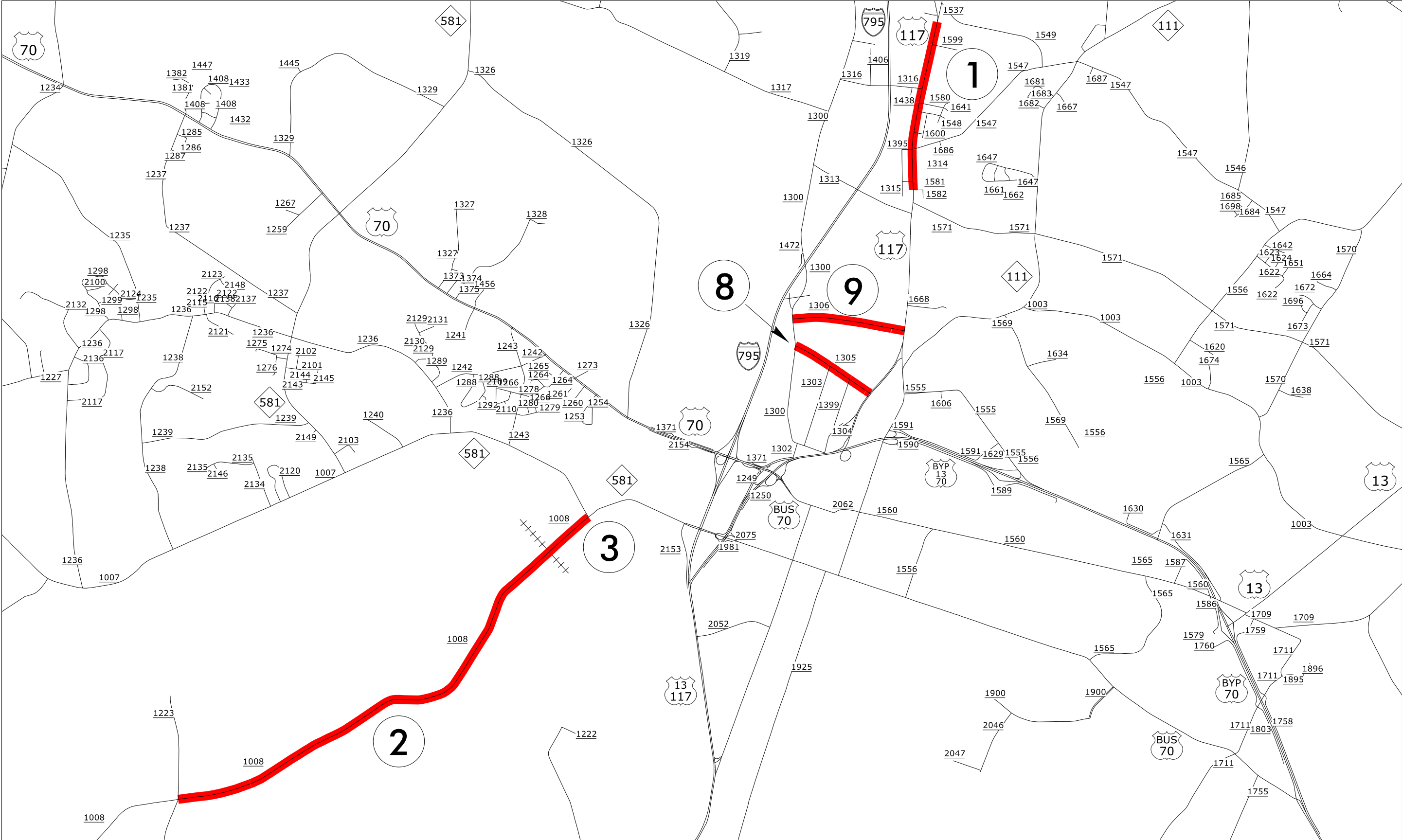

# WAYNE COUNTY

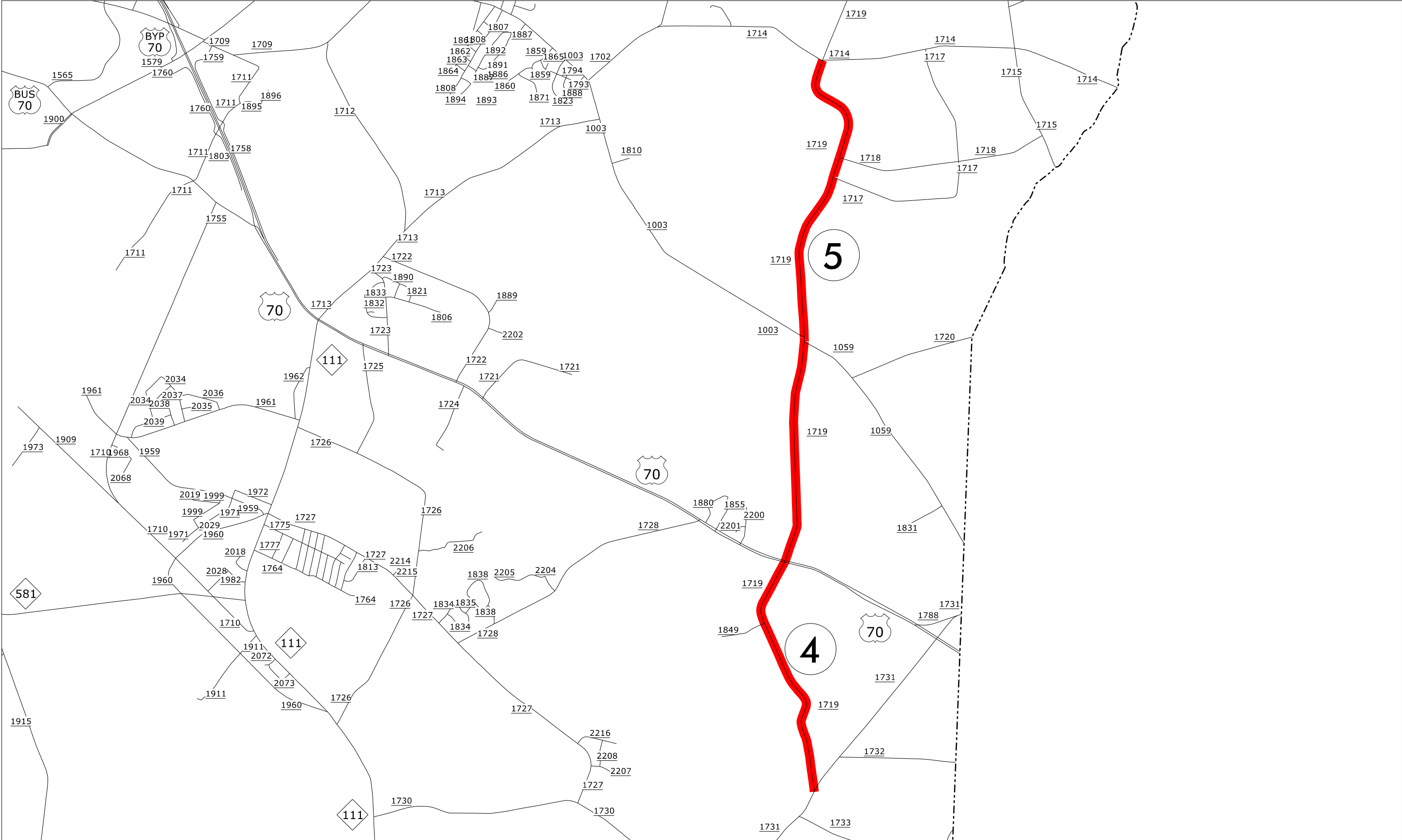

# WAYNE COUNTY

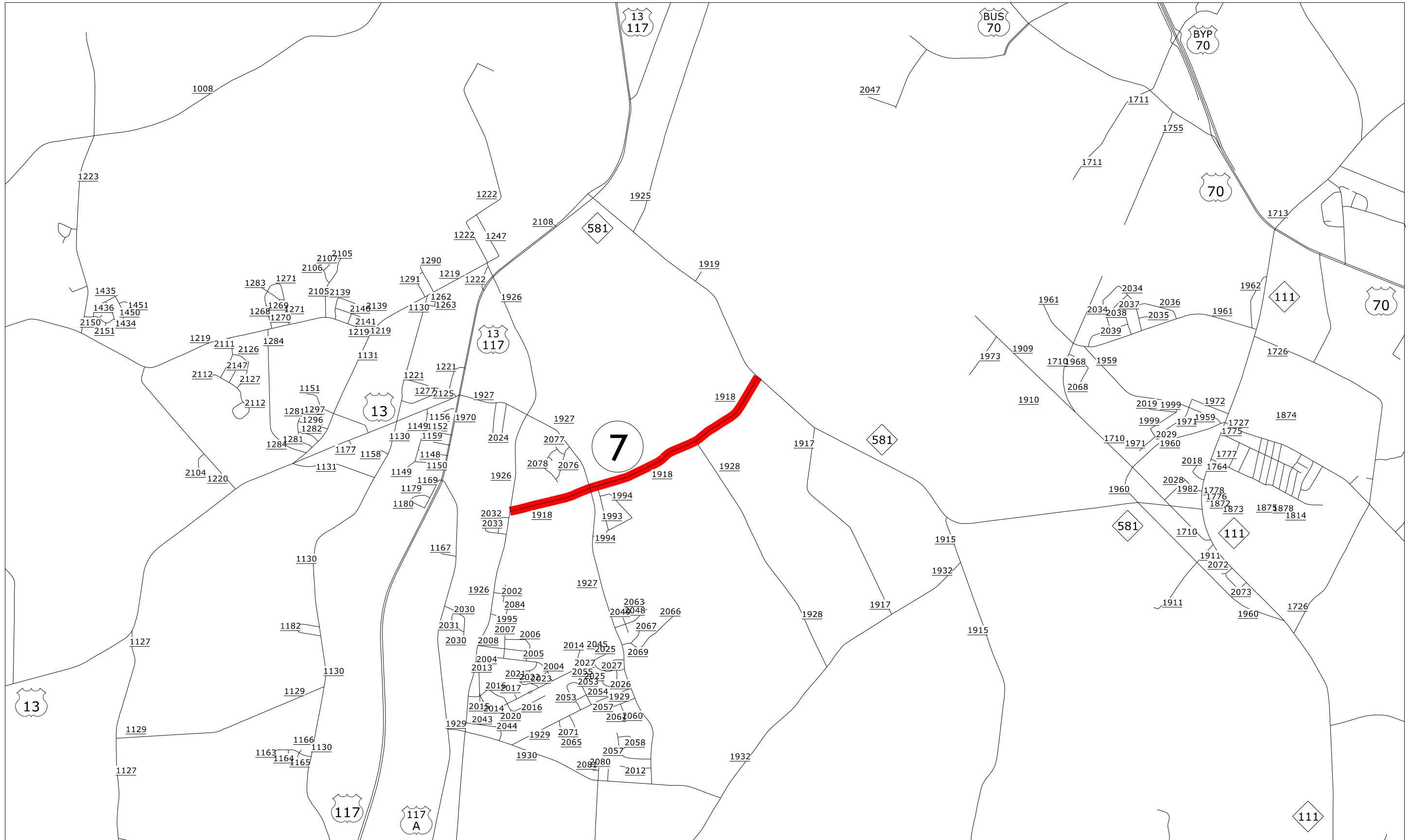

# WAYNE COUNTY

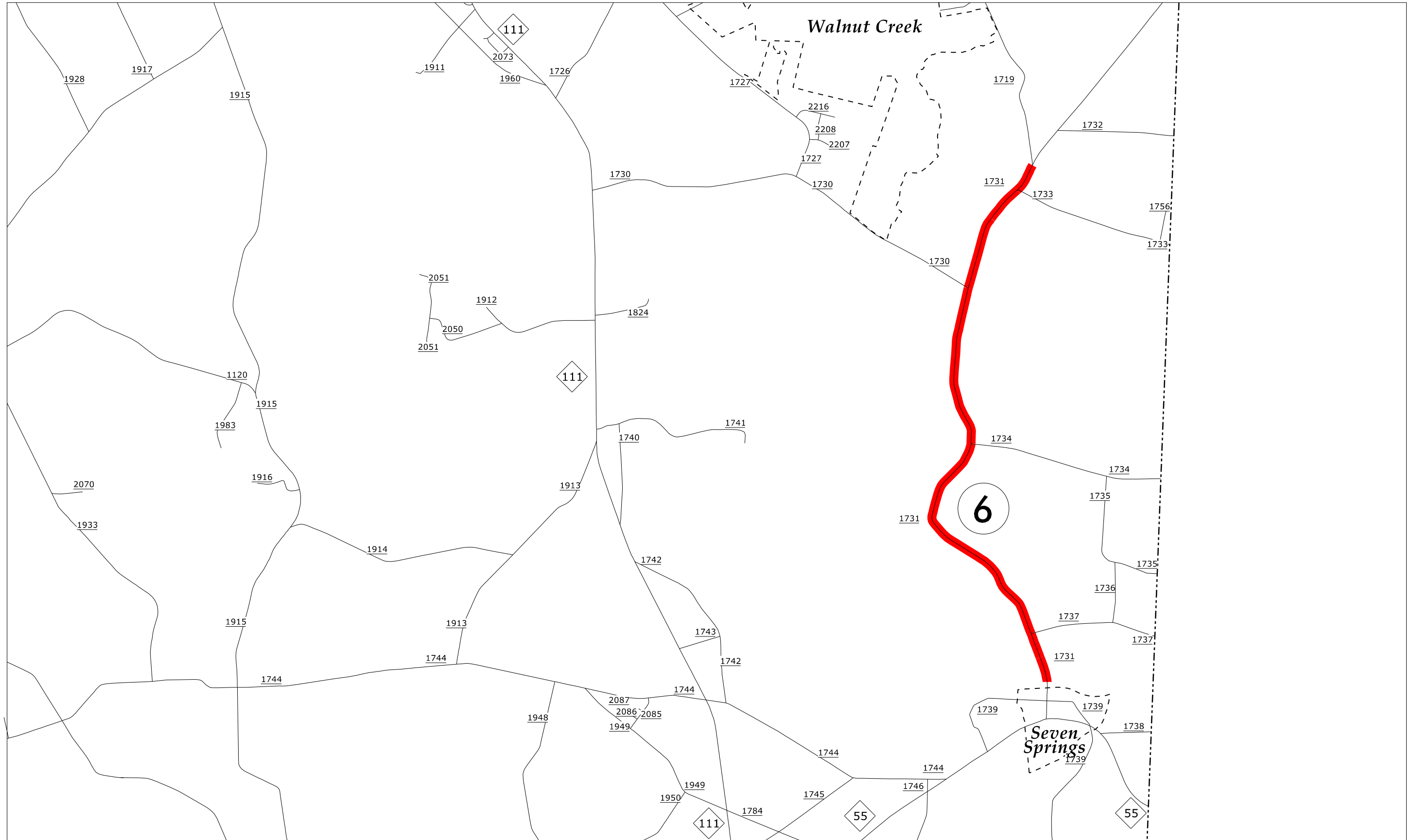

County: WAYNE

Line #	Item Number	Sec #	Description	Quantity	Unit Cost	Amount
<b>ROADWAY ITEMS</b>						
0001	0000100000-N	800	MOBILIZATION	Lump Sum	L.S.	
0002	1220000000-E	545	INCIDENTAL STONE BASE	250 TON		
0003	1245000000-E	SP	SHOULDER RECONSTRUCTION	20.54 SMI		
0004	1297000000-E	607	MILLING ASPHALT PAVEMENT, **** DEPTH (1.5")	32,351 SY		
0005	1330000000-E	607	INCIDENTAL MILLING	7,550 SY		
0006	1503000000-E	610	ASPHALT CONC INTERMEDIATE COURSE, TYPE I19.0C	5,955 TON		
0007	1519000000-E	610	ASPHALT CONC SURFACE COURSE, TYPE S9.5B	20,830 TON		
0008	1523000000-E	610	ASPHALT CONC SURFACE COURSE, TYPE S9.5C	1,808 TON		
0009	1575000000-E	620	ASPHALT BINDER FOR PLANT MIX	1,757 TON		
0010	1704000000-E	SP	PATCHING EXISTING PAVEMENT	245 TON		
0011	4413000000-E	SP	WORK ZONE ADVANCE/GENERAL WARNING SIGNING	1,142 SF		
0012	4457000000-N	SP	TEMPORARY TRAFFIC CONTROL	Lump Sum	L.S.	
0013	4688000000-E	1205	THERMOPLASTIC PAVEMENT MARKING LINES (6", 90 MILS)	48,895 LF		
0014	4695000000-E	1205	THERMOPLASTIC PAVEMENT MARKING LINES (8", 90 MILS)	250 LF		
0015	4704000000-E	1205	THERMOPLASTIC PAVEMENT MARKING LINES (16", 90 MILS)	300 LF		
0016	4709000000-E	1205	THERMOPLASTIC PAVEMENT MARKING LINES (24", 90 MILS)	330 LF		
0017	4720000000-E	1205	THERMOPLASTIC PAVEMENT MARKING CHARACTER (90 MILS)	16 EA		



County: WAYNE

Line #	Item Number	Sec #	Description	Quantity	Unit Cost	Amount
0018	4725000000-E	1205	THERMOPLASTIC PAVEMENT MARKING SYMBOL (90 MILS)	29 EA		
0019	4890000000-E	SP	GENERIC PAVEMENT MARKING ITEM HOT SPRAY THERMOPLASTIC PAVEMENT MARKING LINES (4", 50 MILS)	365,075 LF		
0020	6000000000-E	1605	TEMPORARY SILT FENCE	2,200 LF		
0021	6071010000-E	SP	WATTLE	2,200 LF		
0022	6084000000-E	1660	SEEDING & MULCHING	10.27 ACR		
0023	6117000000-N	SP	RESPONSE FOR EROSION CONTROL	3 EA		
0024	0106000000-E	230	BORROW EXCAVATION	2,100 CY		

0949/Nov15/Q493318.81/D79295110000/E24

Total Amount Of Bid For Entire Project :