



PAT McCrory
Governor

NICHOLAS J. TENNYSON
Secretary

November 30, 2016

Addendum No. 1

RE: **DD00189**
ASPHALT SURFACE TREATMENT
JOHNSTON AND WAYNE COUNTIES

To Whom It May Concern:

Reference is made to the above-mentioned project. The following changes/additions/deletions have been made:

1. Replace Pages 75-84 of the proposal with the attached Pages 75-84.

This sheet and attachments shall be made a part of the plans and bid documents and shall be submitted with the bid. Bids submitted without the addenda and attachments will be considered non-responsive.

If there are any questions, please contact me at (252) 237-6164

Sincerely,

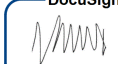
DocuSigned by:

BC8FE3BCFE014EA...
11/30/2016

J. Charles Cauley
Division Four Contracts and Proposals Engineer

JCC/
Attachment

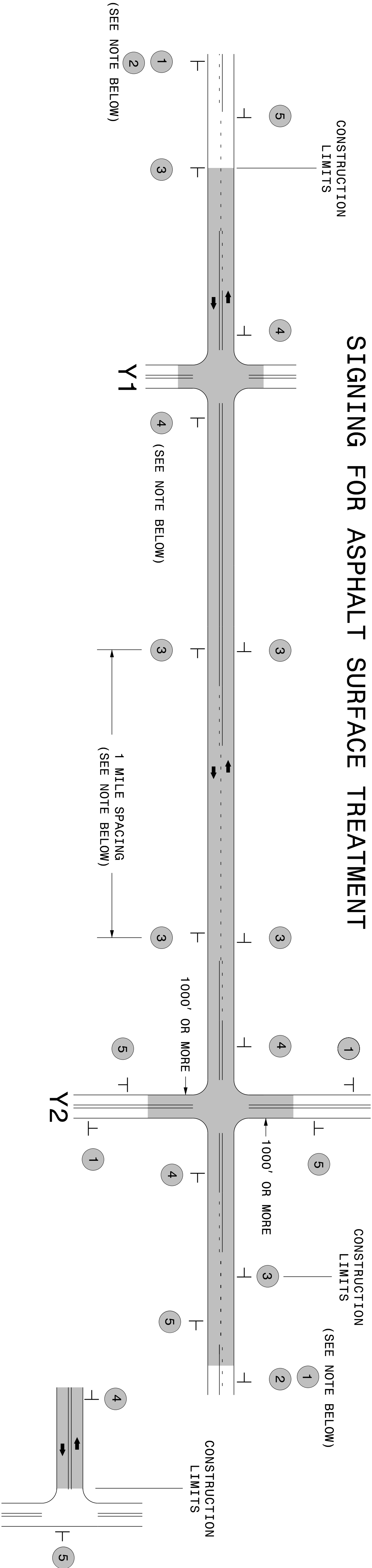



LEGEND

STATIONARY SIGN

DIRECTION OF TRAFFIC FLOW

MAINLINE (-L-) SIGNING

-Y- LINE SIGNING

<div>1</div> <div>ROAD WORK AHEAD</div> <div>W20-1 48" X 48"</div>	PLACE 1000' PRIOR TO BEGINNING OF CONSTRUCTION LIMITS. ONLY USED ON -Y- LINES IF RESURFACING LIMITS EXTEND 1000' ALONG -Y- LINE.
<div>2</div> <div>NEXT XX MILES</div> <div>W7-30P 24" X 18"</div>	#2 SIGN ONLY USED WHEN RESURFACING LIMITS ARE 2 OR MORE MILES IN LENGTH. ROUND UP TO NEXT WHOLE NUMBER. (NO FRACTIONAL OR DECIMAL NUMBERS)
<div>3</div> <div>LOOSE GRAVEL</div> <div>W8-7 48" X 48"</div>	<div>- ALTERNATE THE FOLLOWING TWO SIGNS:</div> <div>- STARTING WITH "LOOSE GRAVEL" (W8-7) FOLLOWED BY "UNMARKED PAVEMENT".</div> <div>- PLACE INITIALLY AT THE CONSTRUCTION LIMITS AND SPACED 1 MILE APART THEREAFTER.</div>
<div>UNMARKED PAVEMENT</div> <div>SP 48" X 48"</div>	<div>- AT TEE INTERSECTIONS INSTALL INITIALLY 0.5 MILE FROM INTERSECTION AND SPACE 1 MILE APART THEREAFTER.</div>
<div>4</div> <div>ROAD UNDER CONST</div> <div>SP 13106 48" X 48"</div>	<div>- THESE ARE FOR -Y- LINES THAT ARE "THROUGH" ROADWAYS.</div> <div>- DEAD END AND SUBDIVISION ROADS ARE NOT "THROUGH" ROADWAYS.</div> <div>- INSTALL 500' +/- FROM EACH -Y- LINE APPROACH AS SHOWN ABOVE.</div> <div>- FOR MULTIPLE -Y- LINES THAT ARE SEPARATED BY 0.25 MILES OR LESS, TREAT AS A SINGLE UNIT AND INSTALL WITHIN 500' OF EACH APPROACH.</div> <div>- A MAXIMUM OF 2 SIGN SETS PER MILE. DO NOT INSTALL WHEN -Y- LINES ARE WITHIN 0.5 MILES FROM "END ROAD WORK" SIGN.</div> <div>- FOR TEE INTERSECTIONS, INSTALL WITHIN 500' +/- OF THE INTERSECTION ALONG -L- LINE.</div>
<div>5</div> <div>END ROAD WORK</div> <div>G20-2 A 48" X 24"</div>	PLACE 500' FOLLOWING THE END OF CONSTRUCTION LIMITS OR AS SHOWN WHEN WORK ENDS AT A 3-WAY TEE INTERSECTION.

NO REQUIRED STATIONARY SIGNING FOR THE FOLLOWING -Y- LINE CONDITIONS:

- 1) LESS THAN 1000' OF RESURFACING ALONG -Y- LINE
- 2) SUBDIVISION ROADS
- 3) DEAD END ROADS

WHEN PAVING/CONSTRUCTION ACTIVITIES PROCEED ACROSS AN UNSIGNED -Y- LINE, ADVANCE WARNING PORTABLE SIGNS SHALL BE USED ALONG THE -Y- LINE AS SHOWN BELOW. REMOVE UPON COMPLETION OF WORK.



PLACED 500' IN ADVANCE OF FLAGGER. PLACED 250' IN ADVANCE OF FLAGGER.

DIVISION OF HIGHWAYS

STATE OF NORTH CAROLINA

DEPARTMENT OF TRANSPORTATION

WORK ZONE TRAFFIC CONTROL

ADVANCE WARNING SIGNS FOR ASPHALT SURFACE TREATMENTS 2 LANE ROADWAYS

Route Listing for Johnston County

2017CPT.04.10.20512.1

Map	County	Route	From	To	Length (MI)
1	Johnston	SR 1928	SR 1927	SR 1003	1.13
2	Johnston	SR 2133	SR 1934	US 301	1.07
3	Johnston	SR 2321	SR 2141	SR 2320	1.87
4	Johnston	SR 2345	NC 222	SR 2385	0.66
5	Johnston	SR 2353	SR 2385	SR 2357	1.7
6	Johnston	SR 2374	SR 2309	SR 2305	1.65
7	Johnston	SR 2388	SR 2328	I-95 RAMP	0.79
8	Johnston	SR 2393	SR 2302	SR 2305	1.28
9	Johnston	SR 2525	SR 2523	SR 2526	0.6
10	Johnston	SR 2536	Wayne CL	SR 2372	1.52
11	Johnston	SR 1508	NC 210	Dead End	1.02
12	Johnston	SR 1581	NC 210	SR 1508	0.54
13	Johnston	SR 2348	NC 222	SR 2346	0.8
14	Johnston	SR 2349	NC 222	Co Line	1.14
15	Johnston	SR 2350	SR 2349	Co Line	0.47
16	Johnston	SR 2516	SR 2309	SR 2310	2.21
17	Johnston	SR 1184	SR 1009	Dead End	1.29
18	Johnston	SR 1350	SR 1330	SR 1308	1.1
19	Johnston	SR 1907	US 70	SR 1501	1.86
20	Johnston	SR 1910	SR 1908	SR 1913	0.82
21	Johnston	SR 1911	SR 1910	Dead End	0.61
22	Johnston	SR 1912	SR 1910	SR 1914	0.91
23	Johnston	SR 2128	SR 2127	SR 2129	1.4
24	Johnston	SR 2143	SR 1934	Co Line	4.21
25	Johnston	SR 2381	SR 2392	SR 2329	0.28
26	Johnston	SR 2390	SR 2399	SR 2408	2.34
27	Johnston	SR 2392	SR 1001	SR 2329	1.58
28	Johnston	SR 1149	SR 1149	SR 1148	1.29
29	Johnston	SR 1168	NC 50	US 301	3.7
30	Johnston	SR 1185	SR 1009	SR 1136	3.27
31	Johnston	SR 1231	SR 1185	Dead End	0.98
32	Johnston	SR 1349	SR 1308	SR 1350	1.11
33	Johnston	SR 1554	SR 1552	Cul-De-Sac	1.59
34	Johnston	SR 2118	NC 42	SR 2117	1.3
35	Johnston	SR 2122	SR 2123	NC 39	1.37
36	Johnston	SR 2132	SR 1934	NC 39	1.06
37	Johnston	SR 2524	SR 1007	SR 2523	1.7
38	Johnston	SR 1138	SR 1144	SR 1116	2.535
39	Johnston	SR 1579	SR 1010	SR 1010	1.39

Johnston County

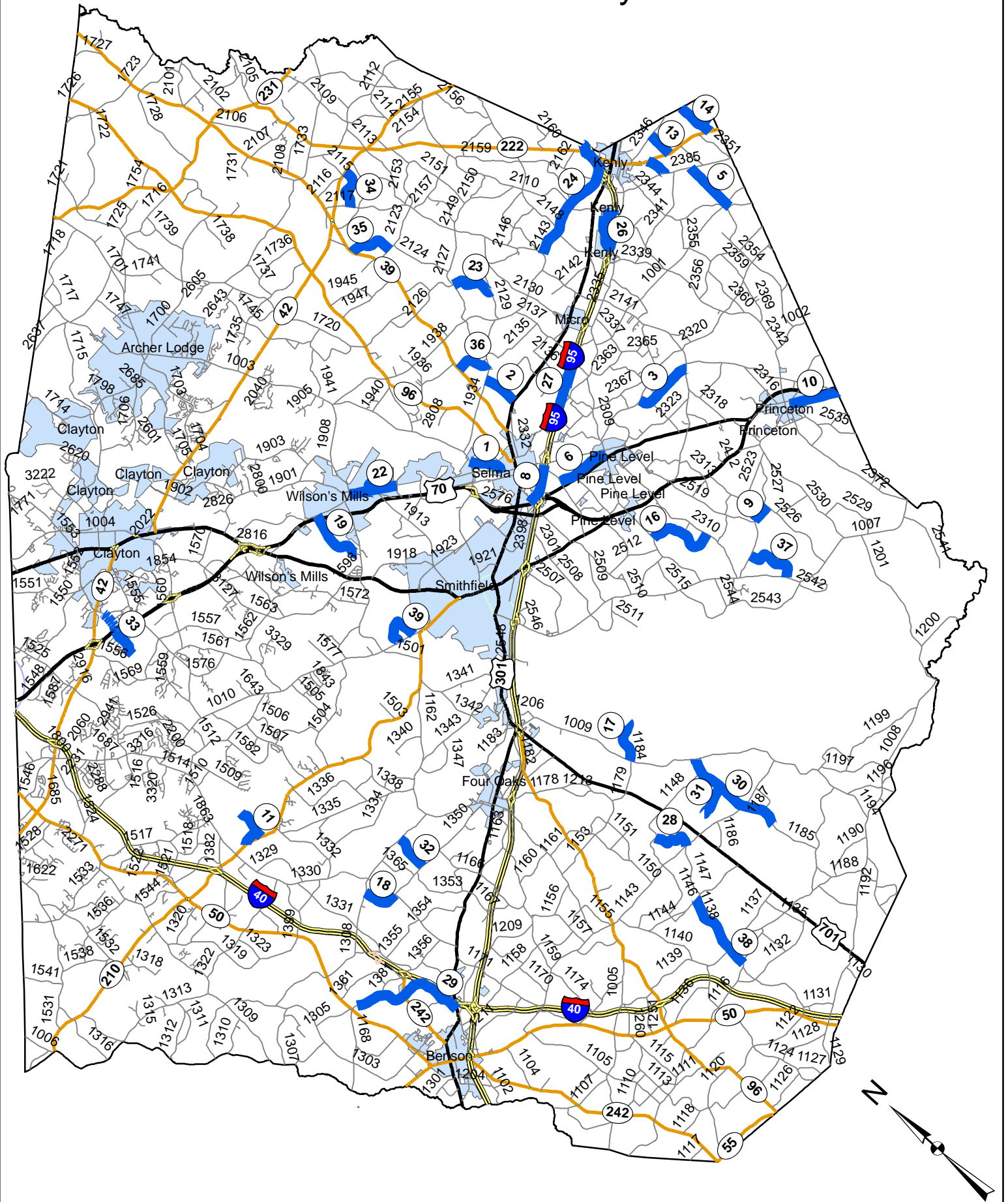

Johnston County

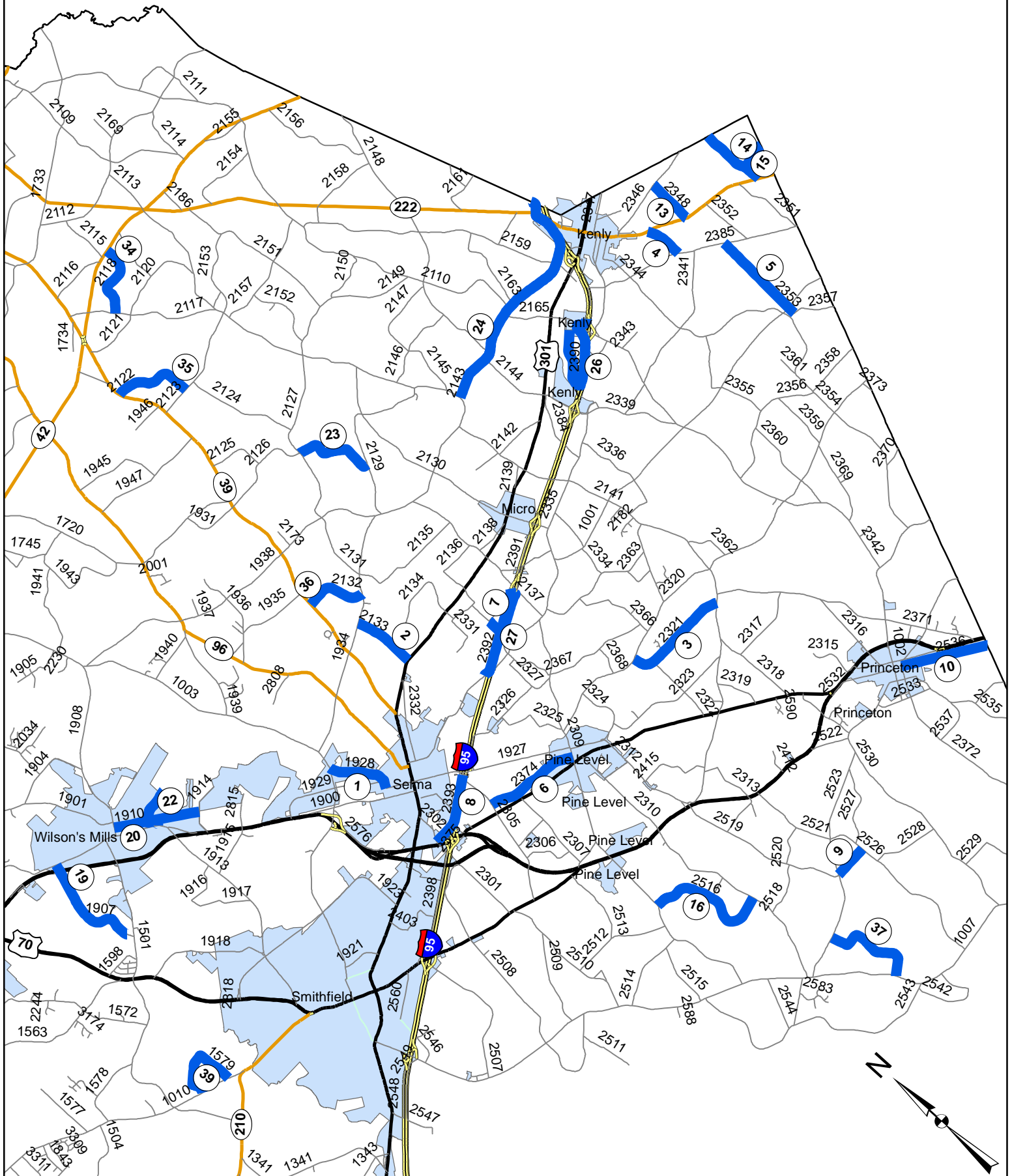

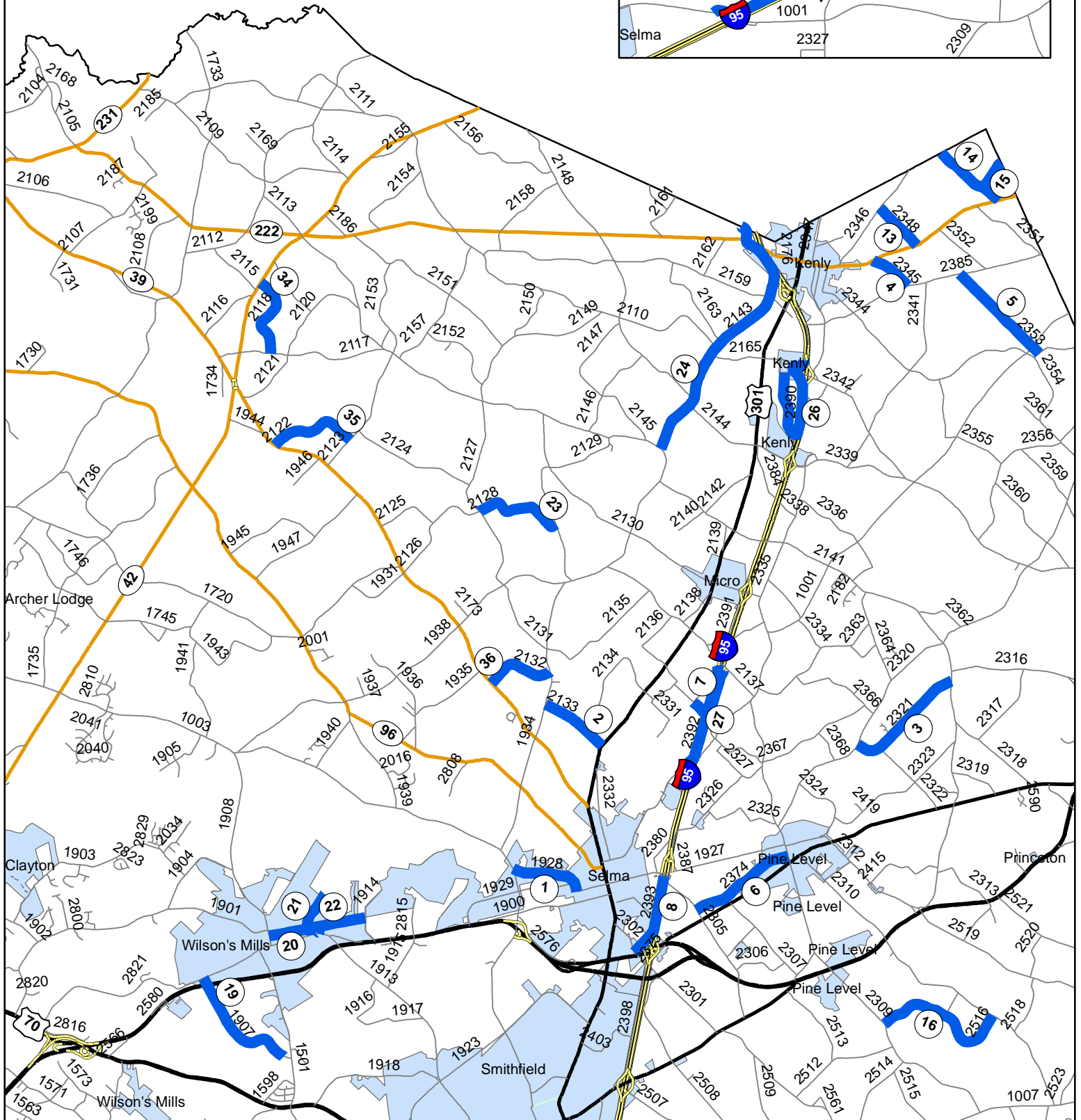

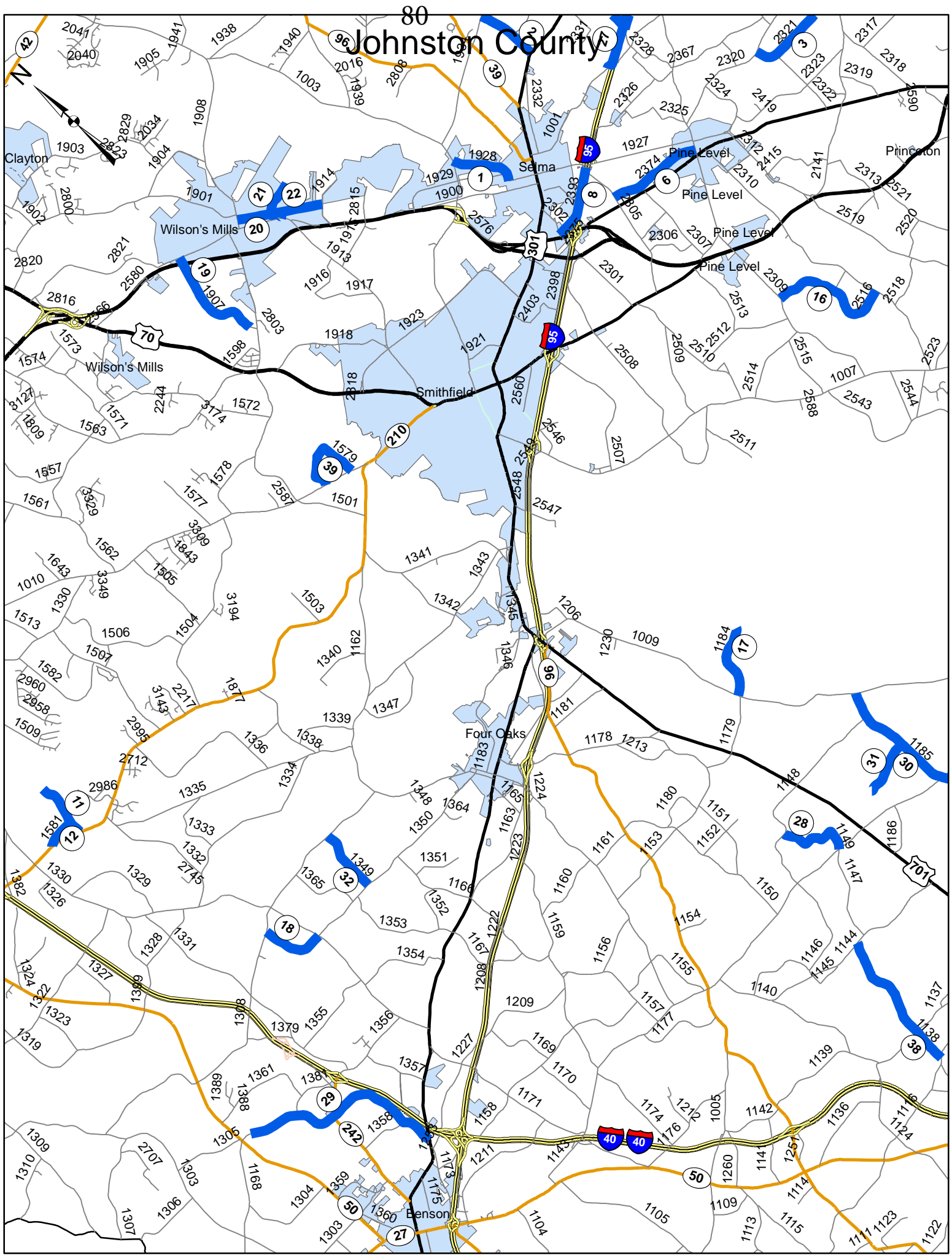

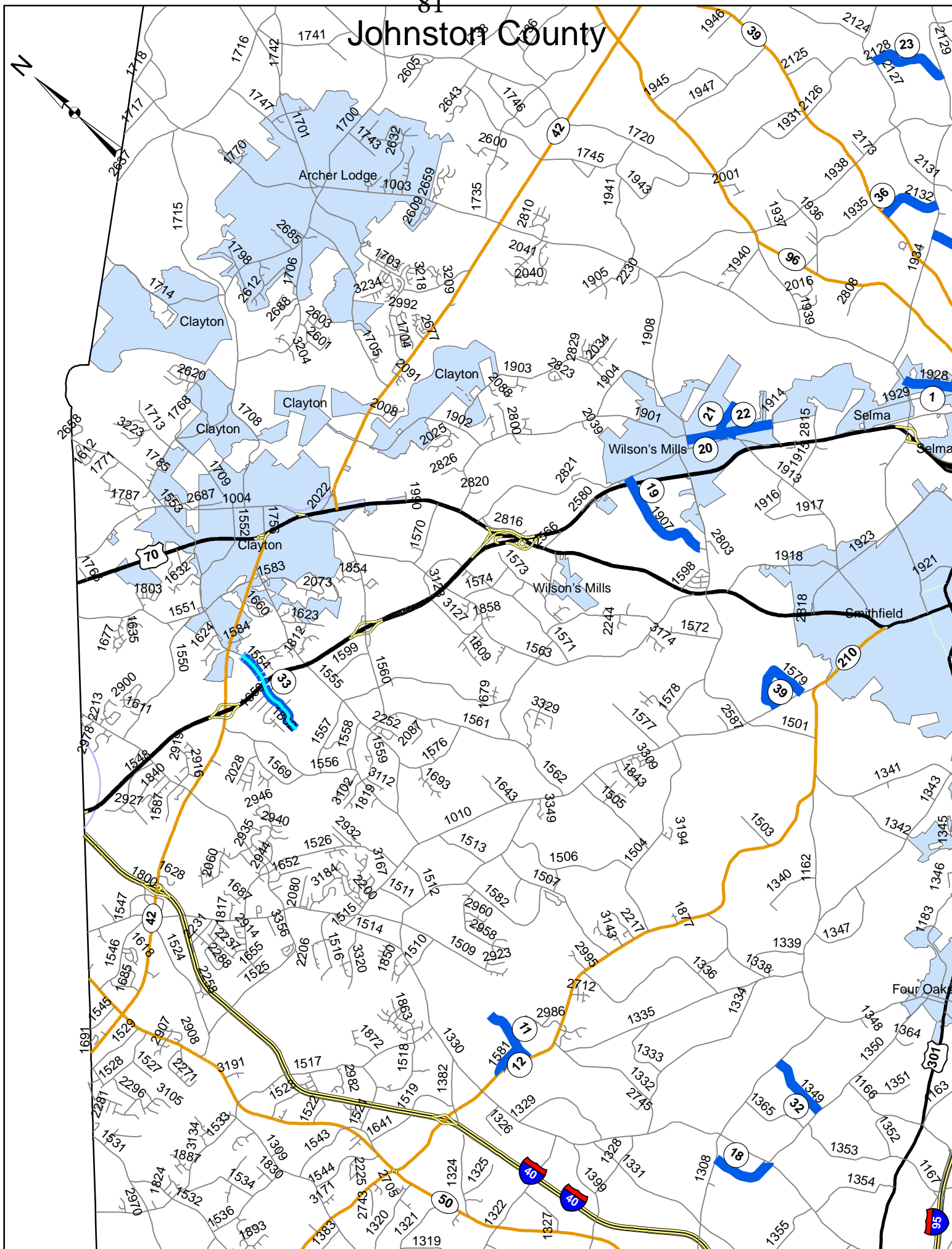

Route Listing for Wayne County

2017CPT.04.10.20962.1

Map	County	Route	From	To	Length (MI)
1	Wayne	SR 1744	NC 55	NC 111	9.424
2	Wayne	SR 1932	SR 1744	SR 1745	2.664
3	Wayne	SR 1913	NC 111	SR 1744	2.21
4	Wayne	SR 1937	SR 1932	NC 55	4.17
5	Wayne	SR 1716	SR 1715	Greene CL	1.42
6	Wayne	SR 1731	US 70	NCL Seven Springs	6.51
7	Wayne	SR 1754	NC 55	SR 1746	7.32
8	Wayne	SR 1719	SR 1731	SR 1003	3.87
9	Wayne	SR 1512	SR 1505	Wilson CL	1.353
10	Wayne	SR 1746	SR 1744	SR1752	1.71

Wayne County

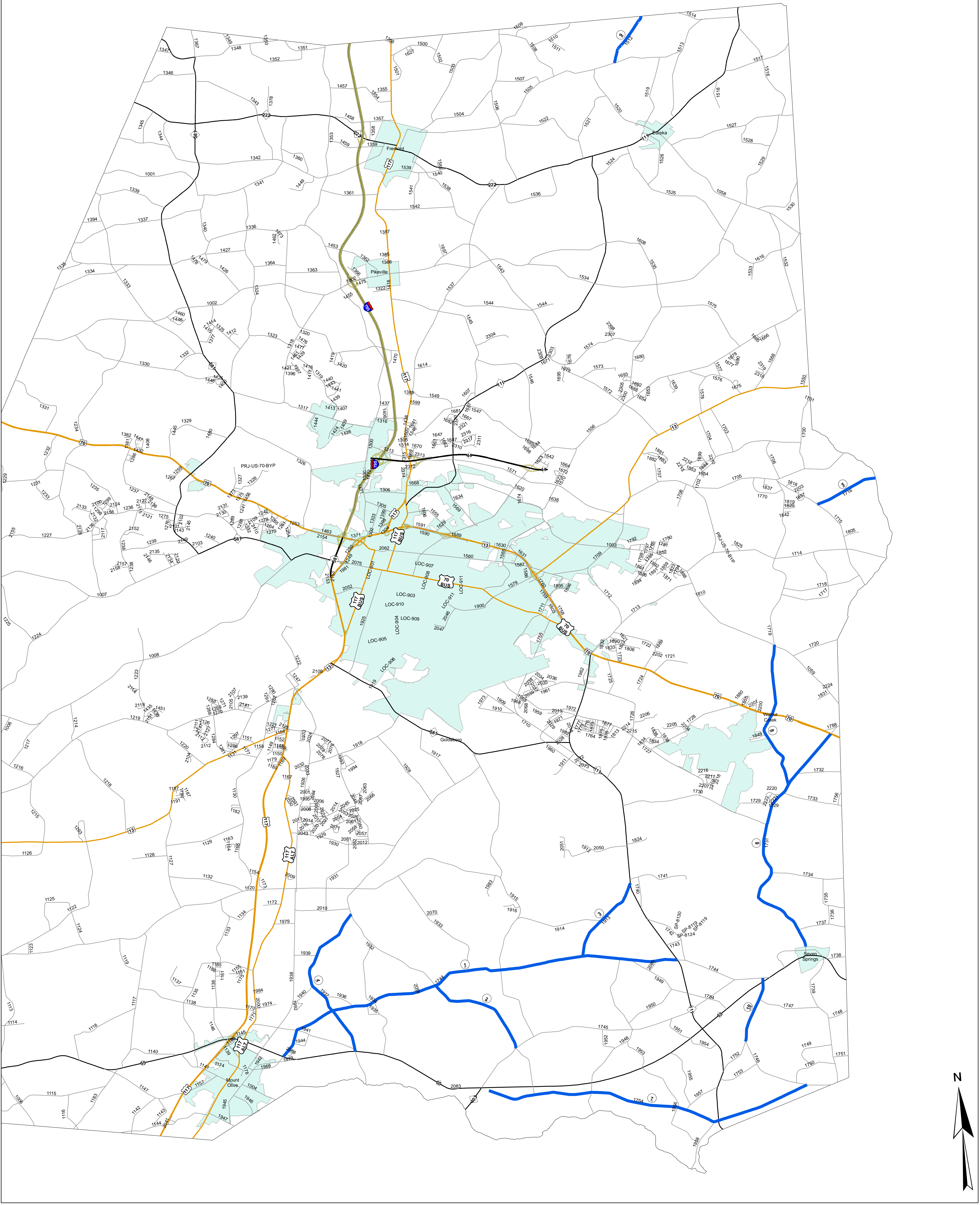

Nov 21, 2016 11:06 am

ITEMIZED PROPOSAL FOR CONTRACT NO. DD00189

Page 1 of 1

County : Johnston, Wayne

Line #	Item Number	Sec #	Description	Quantity	Unit Cost	Amount
ROADWAY ITEMS						
0001	1803500000-E	SP	ASPHALT SURFACE TREATMENT, DOUBLE SEAL	1,135,739.73 SY		
0002	1838000000-E	SP	EMULSION FOR ASPHALT SURFACE TREATMENT	567,869.867 GAL		
0003	4810000000-E	1205	PAINT PAVEMENT MARKING LINES (4")	3,577,580.16 LF		
0004	4835000000-E	1205	PAINT PAVEMENT MARKING LINES (24")	200 LF		
0005	4840000000-N	1205	PAINT PAVEMENT MARKING CHARAC- TER	20 EA		
0006	4845000000-N	1205	PAINT PAVEMENT MARKING SYMBOL	40 EA		
1106/Nov21/Q5281449.757/D22971500000/E6						
			Total Amount Of Bid For Entire Project :			