

STATE	STATE PROJECT REFERENCE NO.	SHEET NO.	TOTAL SHEETS
N.C.	W-5205L	1	
STATE PROJ. NO.	F.A. PROJ. NO.	DESCRIPTION	
45335.1.12	HSIP-0401(242)	PE, CONST.	

STATE OF NORTH CAROLINA
 DIVISION OF HIGHWAYS
WAKE COUNTY

**LOCATION: US 401 OVER SWIFT CREEK (BRIDGES 86 AND 89)
 AND PAVED MEDIAN 800' NORTH OF SWIFT CREEK**

**TYPE OF WORK: RESET/REPLACE EXISTING GUARDRAIL, MINOR SHOULDER
 GRADING AND INSTALL FLEXIBLE DELINEATOR POSTS**

See Sheet 1-A For Index of Sheets
 See Sheet 1-B For Conventional Symbols

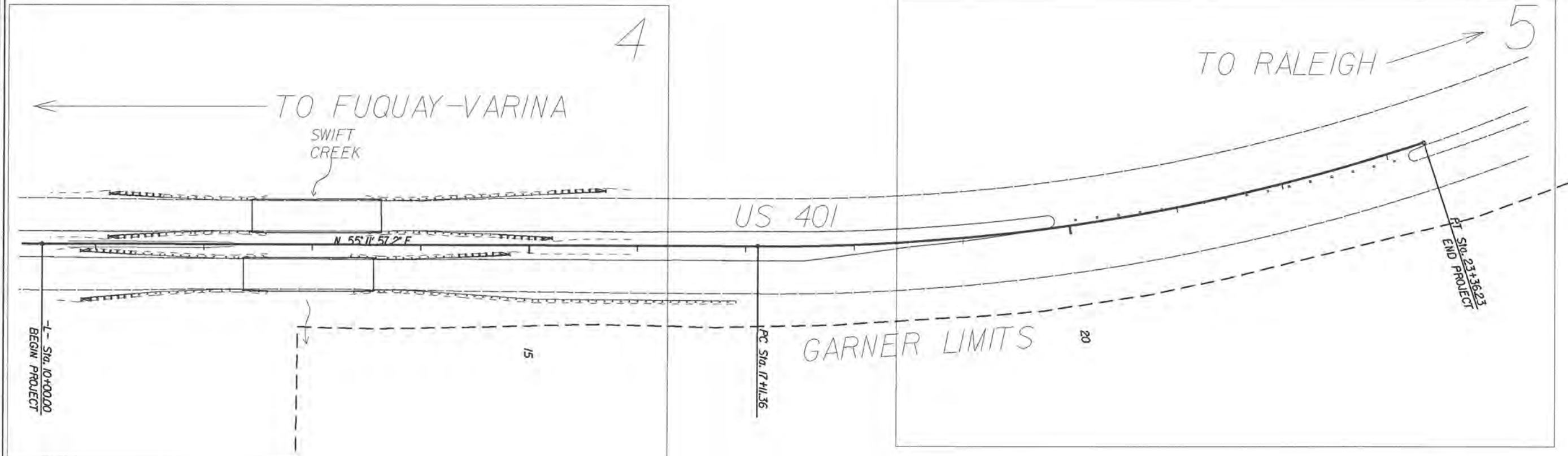
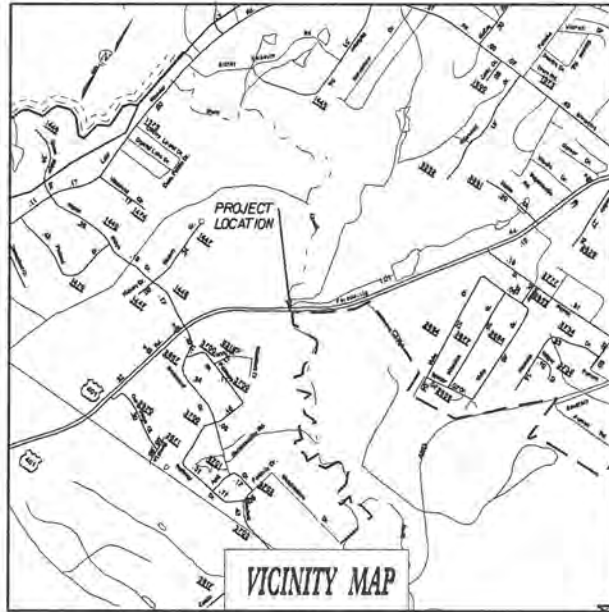

GRAPHIC SCALES



PROJECT LENGTH

Length TIP Project W-5205L = 0.25 Miles

Prepared In the Office of:
DIVISION OF HIGHWAYS

2612 N. Duke St., Durham, NC 27704

1995 STANDARD SPECIFICATIONS

Ben Upshaw, PE
 PROJECT ENGINEER

LETTING DATE:
 JAN 22 2014

Christopher Hoffman
 PROJECT DESIGN ENGINEER

DIVISION DESIGN ENGINEER



12/9/2013
 SIGNATURE: *Ben Upshaw* PE

DIVISION OF HIGHWAYS
 STATE OF NORTH CAROLINA

FIFTH DIVISION
 J.W. Bowman, P.E.
 DIVISION ENGINEER

08-DEC-2013 09:49
 R:\Roadway\2013\W-5205L_Rdy.tsh.dgn
 R:\Roadway\2013\W-5205L_Rdy.tsh.dgn

PROJECT: W-5205L Contract: DE00079

B/17/99

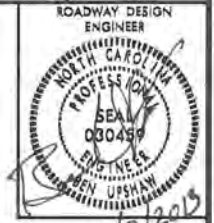

12/9/2013

INDEX OF SHEETS

SHEET NUMBER	SHEET
1	TITLE SHEET
1-A	INDEX OF SHEETS, GENERAL NOTES, AND LIST OF STANDARD DRAWINGS
1-B	CONVENTIONAL SYMBOLS
1-C	SURVEY CONTROL
2	TYPICAL SECTION
2-A thru 2-B	DETAIL SHEETS
4-5	PLAN SHEET
TMP-1 THRU TMP-2	TRANSPORTATION MANAGEMENT PLANS
EC-1	EROSION CONTROL PLAN
X-0 THRU X-5	CROSS-SECTIONS

EFF. 01-17-2012
 REV. 10-30-2012
 2012 ROADWAY ENGLISH STANDARD DRAWINGS

The following Roadway Standards as appear in "Roadway Standard Drawings" Highway Design Branch - N. C. Department of Transportation - Raleigh, N. C., Dated January, 2012 are applicable to this project and by reference hereby are considered a part of these plans:

- | STD. NO. | TITLE |
|--|--|
| DIVISION 2 - EARTHWORK | |
| 225.01 | Guide for Grading Subgrade - Interstate and Freeway |
| DIVISION 5 - SUBGRADE, BASES AND SHOULDERS | |
| 560.01 | Method of Shoulder Construction - High Side of Superelevated Curve - Method I |
| DIVISION 8 - INCIDENTALS | |
| 862.01 | Guardrail Placement |
| 862.02 | Guardrail Installation |
| 862.03 | Structure Anchor Units (Details in Lieu of Standard Drawing as March 2013 Letting) |

GENERAL NOTES: 2012 SPECIFICATIONS
 EFFECTIVE: 01-17-2012
 REVISED: 07-30-2012

SHOULDER CONSTRUCTION:
 ASPHALT, EARTH, AND CONCRETE SHOULDER CONSTRUCTION ON THE HIGH SIDE OF SUPERELEVATED CURVES SHALL BE IN ACCORDANCE WITH STD. NO. 560.01

SIDE ROADS:
 THE CONTRACTOR WILL BE REQUIRED TO DO ALL NECESSARY WORK TO PROVIDE SUITABLE CONNECTIONS WITH ALL ROADS, STREETS, AND DRIVES ENTERING THIS PROJECT. THIS WORK WILL BE PAID FOR AT THE CONTRACT UNIT PRICE FOR THE PARTICULAR ITEMS INVOLVED.

GUARDRAIL:
 THE GUARDRAIL LOCATIONS SHOWN ON THE PLANS MAY BE ADJUSTED DURING CONSTRUCTION AS DIRECTED BY THE ENGINEER. THE CONTRACTOR SHOULD CONSULT WITH THE ENGINEER PRIOR TO ORDERING GUARDRAIL MATERIAL.

UTILITIES:
 UTILITY OWNERS ON THIS PROJECT ARE
 ATT/D (DISTRIBUTION), CITY OF RALEIGH, DUKE ENERGY,
 TIME WARNER CABLE AND PALMETTONET INC.

STATE OF NORTH CAROLINA
DIVISION OF HIGHWAYS

CONVENTIONAL SYMBOLS

*S.U.E = SUBSURFACE UTILITY ENGINEER

ROADS & RELATED ITEMS

Edge of Pavement	-----
Curb	-----
Prop. Slope Stakes Cut	----- C
Prop. Slope Stakes Fill	----- F
Prop. Woven Wire Fence	----- ○ ○
Prop. Chain Link Fence	----- □ □
Prop. Barbed Wire Fence	----- ◇ ◇
Prop. Wheelchair Ramp	----- WCR
Exist. Guardrail	----- + +
Prop. Guardrail	----- + +
Equality Symbol	----- ⊕
Pavement Removal	----- XXXX

RIGHT OF WAY

Baseline Control Point	----- ◆
Existing Right of Way Marker	----- △
Exist. Right of Way Line w/Marker	----- △
Prop. Right of Way Line with Proposed	----- ▲
RW Marker (Iron Pin & Cap)	----- ▲
Prop. Right of Way Line with Proposed	----- (Concrete or Granite) RW Marker
Exist. Control of Access Line	----- ⊙
Prop. Control of Access Line	----- ⊙
Exist. Easement Line	----- E
Prop. Temp. Construction Easement Line	----- E
Prop. Temp. Drainage Easement Line	----- TDE
Prop. Perm. Drainage Easement Line	----- PDE

HYDROLOGY

Stream or Body of Water	-----
Flow Arrow	----- →
Disappearing Stream	----- └┘
Spring	----- ○
Swamp Marsh	----- ⋈
Shoreline	----- -----
Falls, Rapids	----- -----
Prop Lateral, Tail, Head Ditches	----- ----- FDM

STRUCTURES

MAJOR	
Bridge, Tunnel, or Box Culvert	----- CONC
Bridge Wing Wall, Head Wall and End Wall	----- (CONC WW)

MINOR	
Head & End Wall	----- CONC HW
Pipe Culvert	----- =====
Footbridge	----- X-----X
Drainage Boxes	----- □ CB
Paved Ditch Gutter	----- -----

UTILITIES

Exist. Pole	----- ●
Exist. Power Pole	----- ▲
Prop. Power Pole	----- ○
Exist. Telephone Pole	----- ●
Prop. Telephone Pole	----- ○
Exist. Joint Use Pole	----- ▲
Prop. Joint Use Pole	----- ○
Telephone Pedestal	----- □
Cable TV Pedestal	----- □
Hydrant	----- ◇
Satellite Dish	----- ∩
Exist. Water Valve	----- ⊗
Sewer Clean Out	----- ⊕
Power Manhole	----- ⊕
Telephone Booth	----- ⊕
Water Manhole	----- ⊕
Light Pole	----- ⊕
H-Frame Pole	----- ⊕
Power Line Tower	----- ⊕
Pole with Base	----- □
Gas Valve	----- ◇
Gas Meter	----- ⊕
Telephone Manhole	----- ⊕
Power Transformer	----- ⊕
Sanitary Sewer Manhole	----- ⊕
Storm Sewer Manhole	----- ⊕
Tank; Water, Gas, Oil	----- ○
Water Tank With Legs	----- ○
Traffic Signal Junction Box	----- ⊕
Fiber Optic Splice Box	----- ⊕
Television or Radio Tower	----- ⊕
Utility Power Line Connects to Traffic Signal Lines Cut Into the Pavement	----- TS TS

Recorded Water Line	----- W W
Designated Water Line (S.U.E.*)	----- W W
Sanitary Sewer	----- SS SS
Recorded Sanitary Sewer Force Main	----- FSS FSS
Designated Sanitary Sewer Force Main(S.U.E.*)	----- FSS FSS
Recorded Gas Line	----- G G
Designated Gas Line (S.U.E.*)	----- G G
Storm Sewer	----- S S
Recorded Power Line	----- P P
Designated Power Line (S.U.E.*)	----- P P
Recorded Telephone Cable	----- T T
Designated Telephone Cable (S.U.E.*)	----- T T
Recorded U/G Telephone Conduit	----- TC TC
Designated U/G Telephone Conduit (S.U.E.*)	----- TC TC
Unknown Utility (S.U.E.*)	----- ?UTL ?UTL
Recorded Television Cable	----- TV TV
Designated Television Cable (S.U.E.*)	----- TV TV
Recorded Fiber Optics Cable	----- FO FO
Designated Fiber Optics Cable (S.U.E.*)	----- FO FO
Exist. Water Meter	----- ⊕
U/G Test Hole (S.U.E.*)	----- ⊕
Abandoned According to U/G Record	----- ATTUR
End of Information	----- E.O.I.

BOUNDARIES & PROPERTIES

State Line	-----
County Line	-----
Township Line	-----
City Line	-----
Reservation Line	-----
Property Line	-----
Property Line Symbol	----- PL
Exist. Iron Pin	----- ⊕
Property Corner	----- +
Property Monument	----- ECM
Property Number	----- 123
Parcel Number	----- 6
Fence Line	----- X X X X WW & ISBW
Existing Wetland Boundaries	----- WLB
Proposed Wetland Boundaries	----- WLB
Existing Endangered Animal Boundaries	----- EAB
Existing Endangered Plant Boundaries	----- EPB

BUILDINGS & OTHER CULTURE

Buildings	----- □
Foundations	----- └┘
Area Outline	----- ∠
Gate	----- ↗
Gas Pump Vent or U/G Tank Cap	----- ○
Church	----- ⊕
School	----- ⊕
Park	----- ⊕
Cemetery	----- ⊕
Dam	----- -----
Sign	----- SO
Well	----- OW
Small Mine	----- ⊕
Swimming Pool	----- ▨

TOPOGRAPHY

Loose Surface	----- -----
Hard Surface	----- -----
Change in Road Surface	----- -----
Curb	----- -----
Right of Way Symbol	----- R/W
Guard Post	----- ⊕ GP
Paved Walk	----- -----
Bridge	----- -----
Box Culvert or Tunnel	----- -----
Ferry	----- -----
Culvert	----- -----
Footbridge	----- -----
Trail, Footpath	----- -----
Light House	----- ⊕

VEGETATION

Single Tree	----- ⊕
Single Shrub	----- ○
Hedge	----- -----
Woods Line	----- -----
Orchard	----- ⊕ ⊕ ⊕ ⊕
Vineyard	----- VINEYARD

RAILROADS

Standard Gauge	----- -----
RR Signal Milepost	----- MILEPOST 35
Switch	----- SWITCH

10/26/98
09-OCT-2003 09:41
P:\Roadway\NCDOT\AD\5205L\1-B.dgn

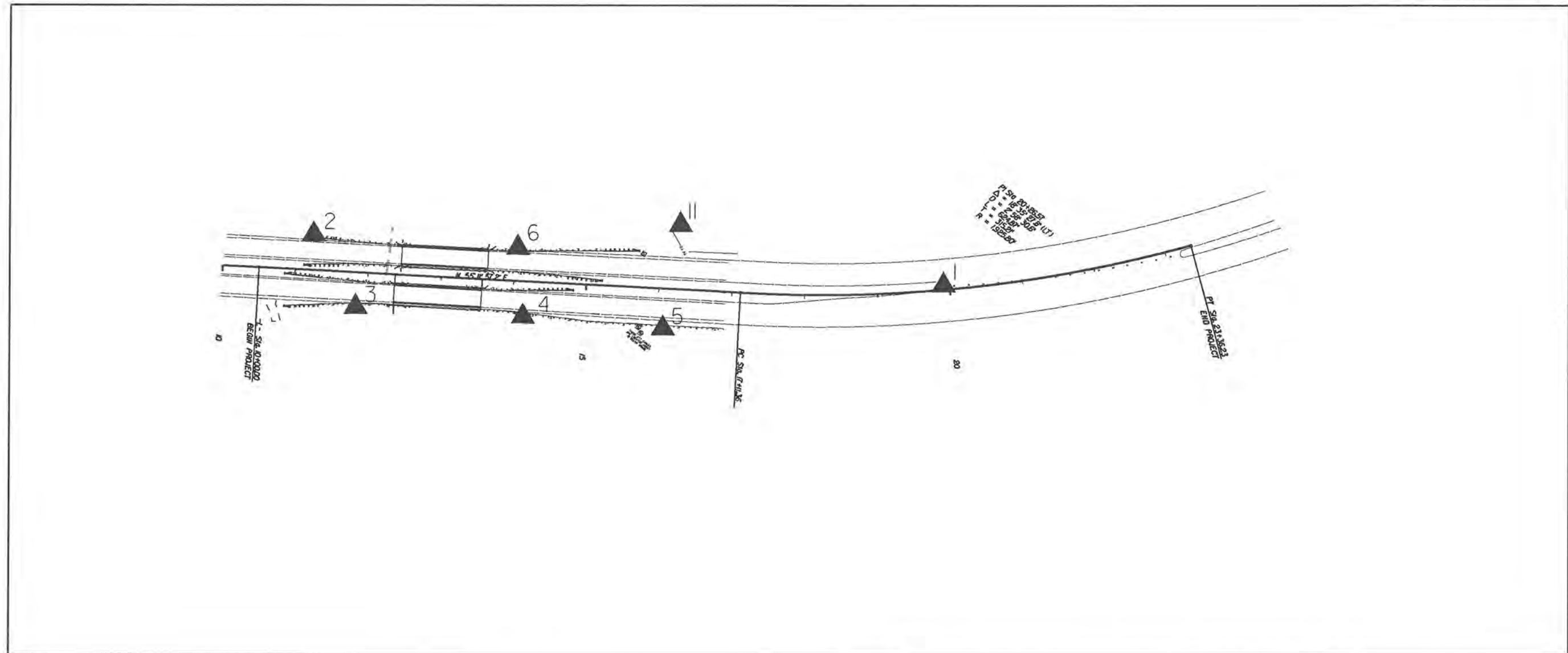

SURVEY CONTROL SYMBOL

SURVEY CONTROL DATA

POINT	NORTH	EAST	ELEVATION
1	705715.703	2095295.374	258.475
2	705240.437	2094569.54	260.303
3	705197.071	2094675.77	261.56
4	705327.509	2094865.216	259.876
5	705432.49	2095027.027	259.247
6	705397.877	2094801.718	259.329
11	705559.693	2094959.017	250.954

POINT	ALIGNMENT DATA	
	NORTH	EAST
POT Sta 10+00	705158.7042	2094537.7516
PC Sta 17+11.36	705536.1588	2095080.8221
PT Sta 23+36.23	705966.7617	2095529.8599
----	---	---
----	---	---
----	---	---

SURVEY CONTROL DATA
US 401 @ Swift Creek

DIVISION 05 WAKE COUNTY

REVISIONS	INTL.	DATE

N.C. DEPARTMENT of TRANSPORTATION
 DIVISION of HIGHWAYS
 DIVISION FIVE DESIGN UNIT

SCALE: N/A DATE: 9 DEC 2013

PREPARED BY: CAH
 REVIEWED BY: BJU

T	EARTH MATERIAL
Y	AGGREGATE SHOULDER BORROW

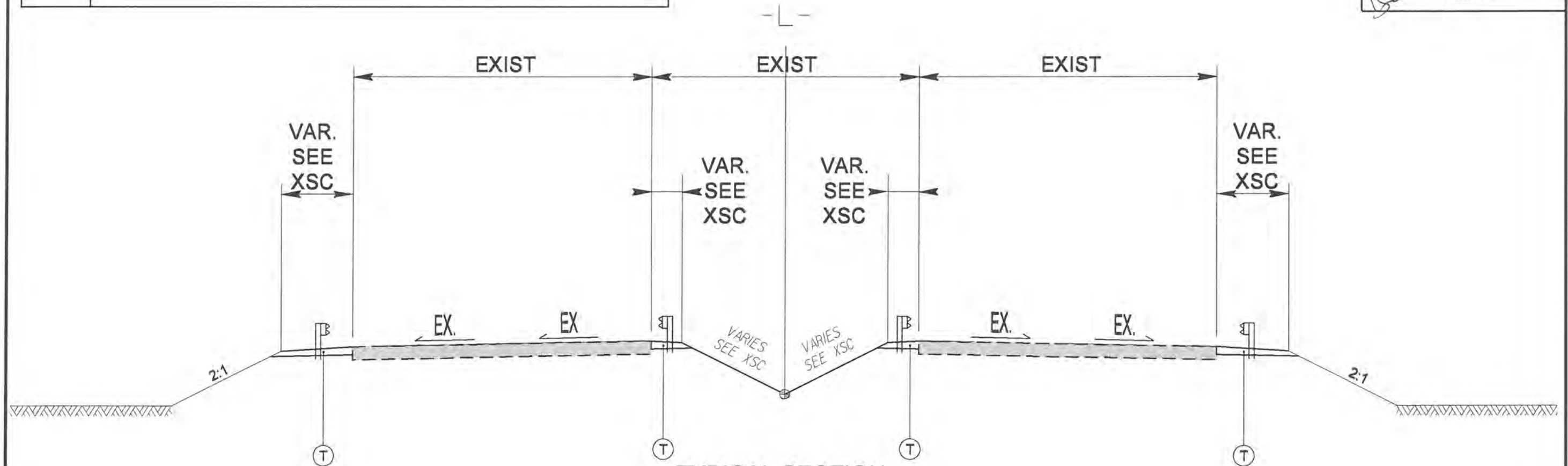

TYPICAL SECTION
 STA. 11+50 TO 12+35
 STA. 13+65 TO 16+00

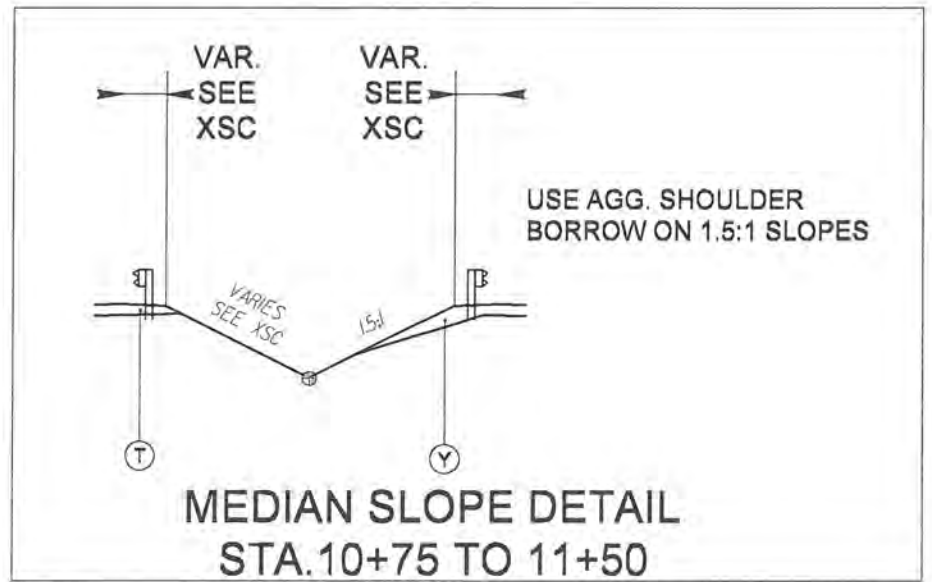

NOTE:
 REMOVE GUARDRAIL AS DIRECTED BY THE ENGINEER TO FACILITATE GRADING OF SHOULDERS.

REINSTALL/REPLACE GUARDRAIL SECTIONS AS DIRECTED BY THE ENGINEER.

GUARDRAIL REMOVE AND RESET/REPLACE, WITH SHOULDER GRADING ON US 401 @ SWIFT CREEK		
DIVISION 05 WAKE COUNTY		
REVISIONS	INT.	DATE
N.C. DEPARTMENT of TRANSPORTATION DIVISION of HIGHWAYS DIVISION FIVE DESIGN UNIT		SCALES: NTS DATE: 9 DEC 2013 PREPARED BY: CAH REVIEWED BY: BJU

STATE OF NORTH CAROLINA DEPT. OF TRANSPORTATION DIVISION OF HIGHWAYS RALEIGH, N.C.

ENGLISH DETAIL DRAWING FOR STRUCTURE ANCHOR UNITS GUARDRAIL ANCHOR UNIT, TYPE III FOR ATTACHMENT TO RAIL ON BRIDGE - SUB REGIONAL TIER

SHEET 2 OF 7 862d03

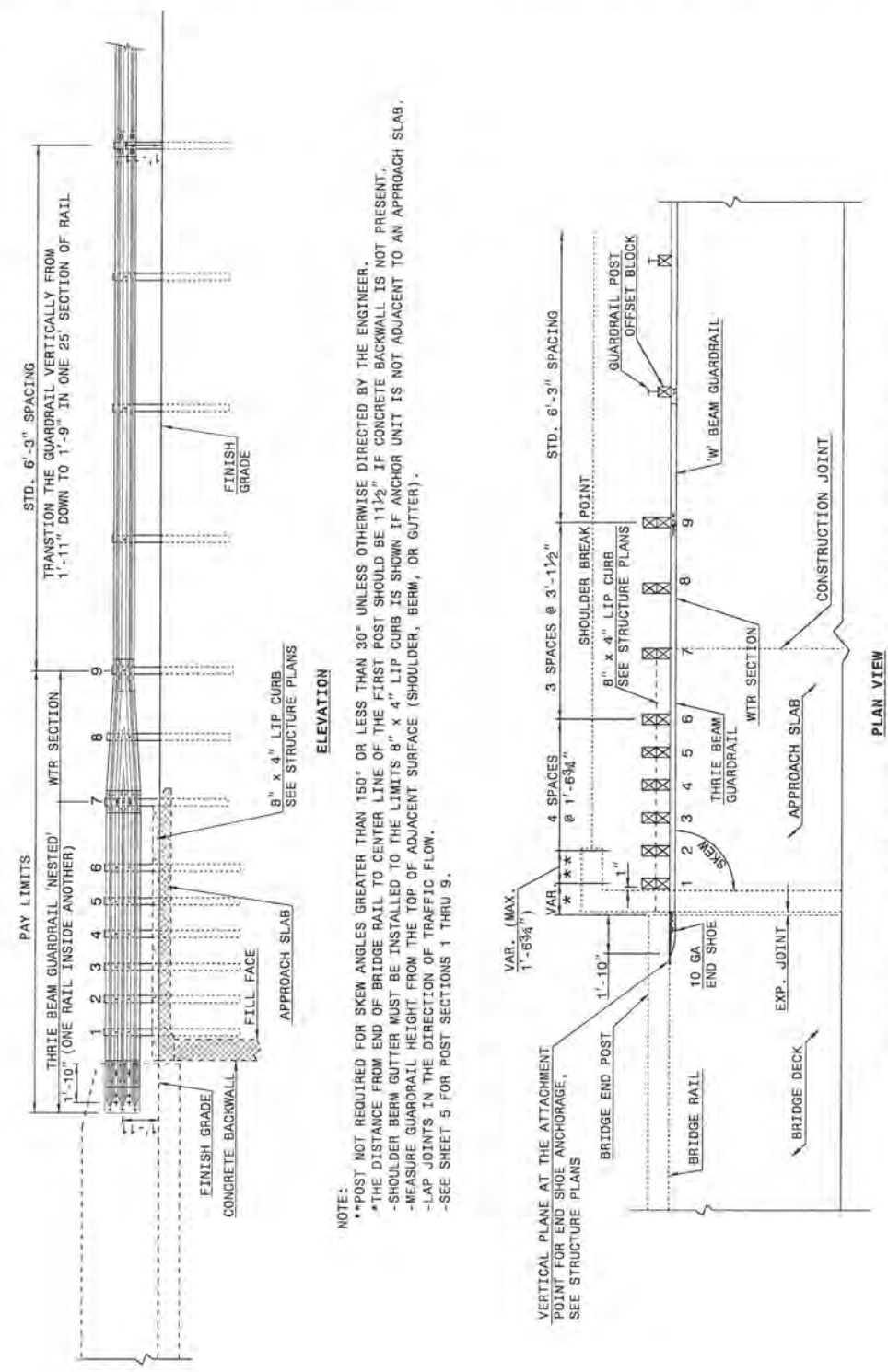

NOTE:
 **POST NOT REQUIRED FOR SKEW ANGLES GREATER THAN 150° OR LESS THAN 30° UNLESS OTHERWISE DIRECTED BY THE ENGINEER.
 *THE DISTANCE FROM END OF BRIDGE RAIL TO CENTER LINE OF THE FIRST POST SHOULD BE 11 1/2" IF CONCRETE BACKWALL IS NOT PRESENT.
 -SHOULDER BERM GUTTER MUST BE INSTALLED TO THE LIMITS 8" X 4" LIP CURB IS SHOWN IF ANCHOR UNIT IS NOT ADJACENT TO AN APPROACH SLAB.
 -MEASURE GUARDRAIL HEIGHT FROM THE TOP OF ADJACENT SURFACE (SHOULDER, BERM, OR GUTTER).
 -LAP JOINTS IN THE DIRECTION OF TRAFFIC FLOW.
 -SEE SHEET 5 FOR POST SECTIONS 1 THRU 9.

STATE OF NORTH CAROLINA DEPT. OF TRANSPORTATION DIVISION OF HIGHWAYS RALEIGH, N.C.

ENGLISH DETAIL DRAWING FOR STRUCTURE ANCHOR UNITS GUARDRAIL ANCHOR UNIT, TYPE III FOR ATTACHMENT TO RAIL ON BRIDGE - SUB REGIONAL TIER

SHEET 2 OF 7 862d03

STATE OF NORTH CAROLINA DEPT. OF TRANSPORTATION DIVISION OF HIGHWAYS RALEIGH, N.C.

ENGLISH DETAIL DRAWING FOR STRUCTURE ANCHOR UNITS GUARDRAIL ANCHOR UNIT, TYPE III

SHEET 3 OF 7 862d03

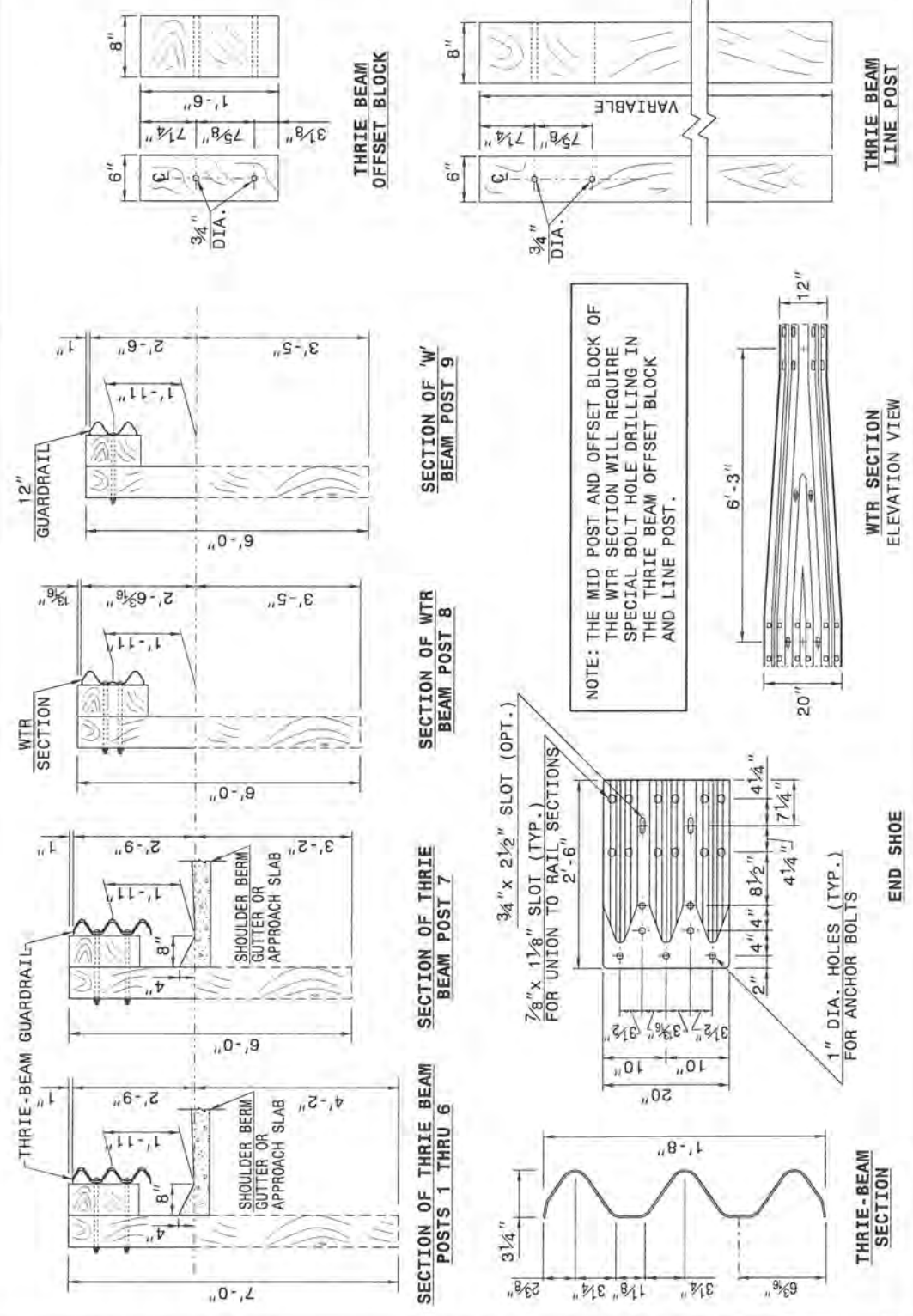

STATE OF NORTH CAROLINA DEPT. OF TRANSPORTATION DIVISION OF HIGHWAYS RALEIGH, N.C.

ENGLISH DETAIL DRAWING FOR STRUCTURE ANCHOR UNITS GUARDRAIL ANCHOR UNIT, TYPE III

SHEET 3 OF 7 862d03

CONTRACT STANDARDS AND DEVELOPMENT UNIT
 Office 919-707-6950 FAX 919-250-4119

SEE TITLE BLOCK

ORIGINAL BY: J. HOWERTON DATE: 06-22-12
 MODIFIED BY: DATE:
 CHECKED BY: DATE:
 FILE SPEC.: DATE:

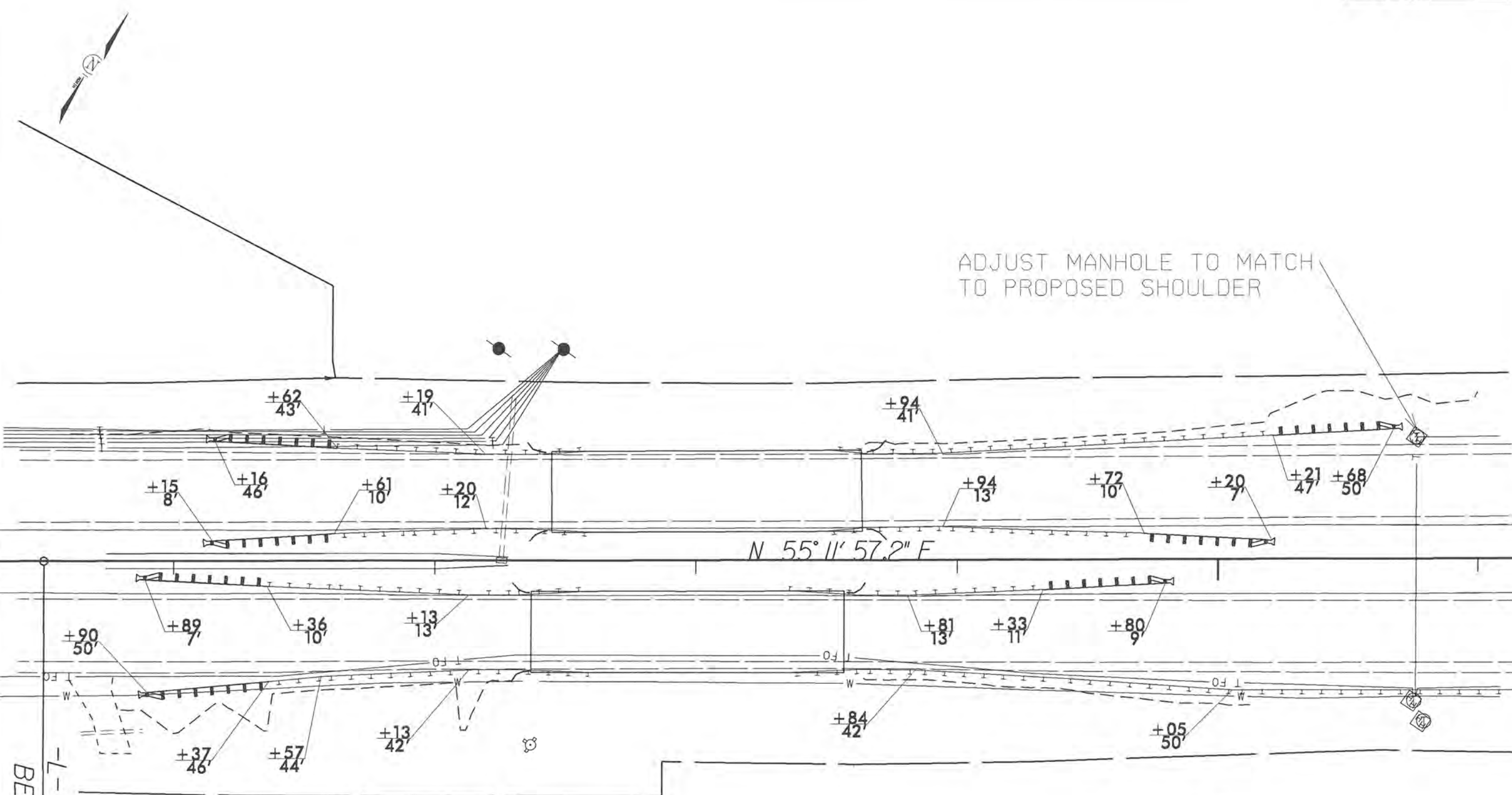

-1- Sta. 10+00.00
 BEGIN PROJECT

15

DIVISION FIVE DESIGN SEAL 030499 ENGINEER BEN UPSHAW 12/9/13 P.E. SIGNATURE	GUARDRAIL REMOVE AND RESET WITH SHOULDER GRADING ON US 401 @ SWIFT CREEK		 NORTH CAROLINA DEPARTMENT OF TRANSPORTATION											
	DIVISION 05 WAKE COUNTY													
<table border="1"> <thead> <tr> <th>REVISIONS</th> <th>INT.</th> <th>DATE</th> </tr> </thead> <tbody> <tr> <td> </td> <td> </td> <td> </td> </tr> <tr> <td> </td> <td> </td> <td> </td> </tr> <tr> <td> </td> <td> </td> <td> </td> </tr> </tbody> </table>		REVISIONS	INT.	DATE										SCALE: 40' = 1' DATE: 6 Nov 2013
REVISIONS	INT.	DATE												
N.C. DEPARTMENT of TRANSPORTATION DIVISION of HIGHWAYS DIVISION FIVE DESIGN UNIT		PREPARED BY: CAH REVIEWED BY: BJU	SCALE: 40' = 1' DATE: 6 Nov 2013											

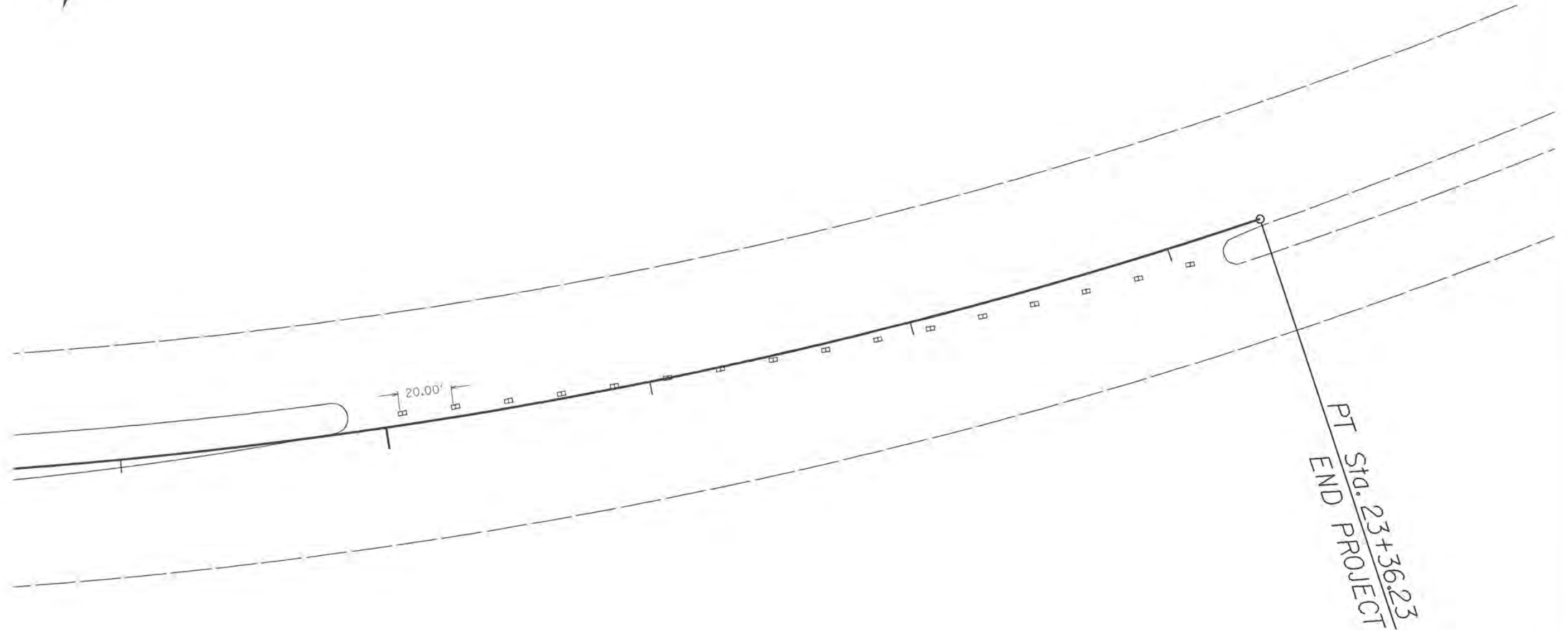

20

LEGEND

- TYPE II SINGLE YELLOW DELINEATORS ON MAIN LINE AT 20' SPACING, OR AS DIRECTED BY THE ENGINEER.

DIVISION FIVE DESIGN

SIGNATURE

PLACEMENT OF FLEXABLE DELINEATORS IN MEDIAN ON US 401 @ SWIFT CREEK

DIVISION 05 WAKE COUNTY	
REVISIONS	INT. DATE

N.C. DEPARTMENT of TRANSPORTATION
DIVISION of HIGHWAYS
DIVISION FIVE DESIGN UNIT

SCALE: 40'-1" DATE: 9 OCT 2013

PREPARED BY:	CAH
REVIEWED BY:	BJU
REVIEWED BY:	

STATE OF NORTH CAROLINA
DIVISION OF HIGHWAYS

STATE PROJECT REFERENCE NO.		SHEET NO.
W-5205L		TMP-1
STATE PROJ. NO.	F.A. PROJ. NO.	DESCRIPTION
45335.1.12	HSIP-0401(242)	PE /CONST.

TRANSPORTATION MANAGEMENT PLAN
WAKE COUNTY

ROADWAY STANDARD DRAWINGS

REV. SEPTEMBER 2011

ROADWAY STANDARD DRAWINGS

THE FOLLOWING ROADWAY STANDARDS AS APPEAR IN "ROADWAY STANDARD DRAWINGS" - PROJECT SERVICES UNIT - N.C. DEPARTMENT OF TRANSPORTATION - RALEIGH, N.C., DATED JANUARY 2012 ARE APPLICABLE TO THIS PROJECT AND BY REFERENCE HEREBY ARE CONSIDERED A PART OF THESE PLANS:

STD.NO.	TITLE
1101.01	WORK ZONE WARNING SIGNS
1101.02	TEMPORARY LANE CLOSURES
1101.04	TEMPORARY SHOULDER CLOSURES
1101.05	WORK ZONE VEHICLE ACCESSES
1101.11	TRAFFIC CONTROL DESIGN TABLES
1110.01	STATIONARY WORK ZONE SIGNS
1110.02	PORTABLE WORK ZONE SIGNS
1115.01	FLASHING ARROW BOARDS
1130.01	DRUMS
1150.01	FLAGGING DEVICES
1165.01	WORK VEHICLE LIGHTING SYSTEMS AND TMA DELINEATION

INDEX OF SHEETS

SHEET NO.	TITLE
TMP-1	LIST OF APPLICABLE ROADWAY STANDARD DRAWINGS, INDEX OF SHEETS AND LEGEND
TMP-2	PROJECT NOTES

LEGEND

GENERAL

- DIRECTION OF TRAFFIC FLOW
- NORTH ARROW
- PROPOSED PVMT. - - - - EXIST. PVMT.
- WORK AREA
- REMOVAL OF EXISTING PAVEMENT

TRAFFIC CONTROL DEVICES

- TYPE I BARRICADE
- TYPE II BARRICADE
- TYPE III BARRICADE
- CONE
- DRUM
- FLASHING ARROW PANEL (TYPE C)
- TYPE 'B' WARNING LIGHT
- STATIONARY SIGN
- PORTABLE SIGN
- WARNING FLAGS
- CRASH CUSHION
- CHANGEABLE MESSAGE SIGN
- TRUCK MOUNTED IMPACT ATTENUATOR (TMIA)
- POLICE
- FLAGGER

PAVEMENT MARKINGS

- CRYSTAL PAVEMENT MARKER
- YELLOW/YELLOW PAVEMENT MARKER
- CRYSTAL/RED PAVEMENT MARKER
- PAVEMENT MARKING SYMBOLS

PROJECT: 43445

STATE OF NORTH CAROLINA
DIVISION OF HIGHWAYS

STATE PROJECT REFERENCE NO.		SHEET NO.
W-5205L		TMP-2
STATE PROJ. NO.	F.A. PROJ. NO.	DESCRIPTION
45335.1.12	HSIP-0401(242)	PE / CONST.

TRANSPORTATION MANAGEMENT PLAN
WAKE COUNTY

PROJECT NOTES

CHANGES MAY BE REQUIRED WHEN PHYSICAL DIMENSIONS IN THE DETAIL DRAWINGS, STANDARD DETAILS, AND ROADWAY DETAILS ARE NOT ATTAINABLE TO MEET FIELD CONDITIONS OR RESULT IN DUPLICATE OR UNDESIRED OVERLAPPING OF DEVICES. MODIFICATION MAY INCLUDE: MOVING, SUPPLEMENTING, COVERING, OR REMOVAL OF DEVICES AS DIRECTED BY THE ENGINEER.

THE FOLLOWING GENERAL NOTES APPLY AT ALL TIMES FOR THE DURATION OF THE CONSTRUCTION PROJECT EXCEPT WHEN OTHERWISE NOTED IN THE PLAN OR DIRECTED BY THE ENGINEER.

TIME RESTRICTIONS

A) DO NOT CLOSE OR NARROW TRAVEL LANES AS FOLLOWS:

ROAD NAME	DAY AND TIME RESTRICTIONS
US 401 N.B.	MONDAY - FRIDAY 07:00-09:00 AM
US 401 S.B.	MONDAY - FRIDAY 04:00-07:00 PM

LANE AND SHOULDER CLOSURE REQUIREMENTS

- B) REMOVE LANE CLOSURE DEVICES FROM THE LANE WHEN WORK IS NOT BEING PERFORMED BEHIND THE LANE CLOSURE OR WHEN A LANE CLOSURE IS NO LONGER NEEDED OR AS DIRECTED BY THE ENGINEER.
- C) WHEN PERSONNEL AND/OR EQUIPMENT ARE WORKING WITHIN 15 FT OF AN OPEN TRAVEL LANE, CLOSE THE NEAREST OPEN SHOULDER USING ROADWAY STANDARD DRAWING NO. 1101.04 UNLESS THE WORK AREA IS PROTECTED BY BARRIER OR GUARDRAIL OR A LANE CLOSURE IS INSTALLED.
- D) WHEN PERSONNEL AND/OR EQUIPMENT ARE WORKING ON THE SHOULDER ADJACENT TO AN UNDIVIDED FACILITY AND WITHIN 5 FT OF AN OPEN TRAVEL LANE, CLOSE THE NEAREST OPEN TRAVEL LANE USING ROADWAY STANDARD DRAWING NO. 1101.02 UNLESS THE WORK AREA IS PROTECTED BY BARRIER OR GUARDRAIL.

WHEN PERSONNEL AND/OR EQUIPMENT ARE WORKING ON THE SHOULDER ADJACENT TO A DIVIDED FACILITY AND WITHIN 10 FT OF AN OPEN TRAVEL LANE, CLOSE THE NEAREST OPEN TRAVEL LANE USING ROADWAY STANDARD DRAWING NO. 1101.02 UNLESS THE WORK AREA IS PROTECTED BY BARRIER OR GUARDRAIL.
- E) DO NOT WORK SIMULTANEOUSLY WITHIN 15 FT ON BOTH SIDES OF AN OPEN TRAVELWAY, RAMP, OR LOOP WITHIN THE SAME LOCATION UNLESS PROTECTED WITH GUARDRAIL OR BARRIER.
- F) PROVIDE TRAFFIC CONTROL FOR APPROPRIATE LANE CLOSURES FOR SURVEYING DONE BY THE DEPARTMENT.

PAVEMENT EDGE DROP OFF REQUIREMENTS

- G) BACKFILL AT A 6:1 SLOPE UP TO THE EDGE AND ELEVATION OF EXISTING PAVEMENT IN AREAS ADJACENT TO AN OPENED TRAVEL LANE THAT HAS AN EDGE OF PAVEMENT DROP-OFF AS FOLLOWS:

BACKFILL DROP-OFFS THAT EXCEED 2 INCHES ON ROADWAYS WITH POSTED SPEED LIMITS OF 45 MPH OR GREATER.

BACKFILL DROP-OFFS THAT EXCEED 3 INCHES ON ROADWAYS WITH POSTED SPEED LIMITS LESS THAN 45 MPH.

BACKFILL WITH SUITABLE COMPACTED MATERIAL, AS APPROVED BY THE ENGINEER, AT NO EXPENSE TO THE DEPARTMENT.

- H) INSTALL ADVANCE WORK ZONE WARNING SIGNS WHEN WORK IS WITHIN 40 FT FROM THE EDGE OF TRAVEL LANE AND NO MORE THAN THREE (3) DAYS PRIOR TO THE BEGINNING OF CONSTRUCTION.
- I) ENSURE ALL NECESSARY SIGNING IS IN PLACE PRIOR TO ALTERING ANY TRAFFIC PATTERN.

TRAFFIC CONTROL DEVICES

- J) WHEN LANE CLOSURES ARE NOT IN EFFECT SPACE CHANNELIZING DEVICES IN WORK AREAS NO GREATER IN FEET THAN TWICE THE POSTED SPEED LIMIT (MPH) EXCEPT, 10 FT ON-CENTER IN RADII, AND 3 FT OFF THE EDGE OF AN OPEN TRAVELWAY. REFER TO STANDARD SPECIFICATIONS FOR ROADS AND STRUCTURES SECTIONS 1130 (DRUMS), 1135 (CONES) AND 1180 (SKINNY DRUMS) FOR ADDITIONAL REQUIREMENTS.

PROJECT: 43445

SITE DESCRIPTION	STABILIZATION TIME	TIMEFRAME EXCEPTIONS
PERIMETER DIKES, SWALES, DITCHES AND SLOPES	7 DAYS	NONE
HIGH QUALITY WATER (HOW) ZONES	7 DAYS	NONE
SLOPES STEEPER THAN 3:1	7 DAYS	IF SLOPES ARE 10' OR LESS IN LENGTH AND ARE NOT STEEPER THAN 2:1, 14 DAYS ARE ALLOWED.
SLOPES 3:1 OR FLATTER	14 DAYS	7 DAYS FOR SLOPES GREATER THAN 50' IN LENGTH.
ALL OTHER AREAS WITH SLOPES FLATTER THAN 4:1	14 DAYS	NONE, EXCEPT FOR PERIMETERS AND HOW ZONES.

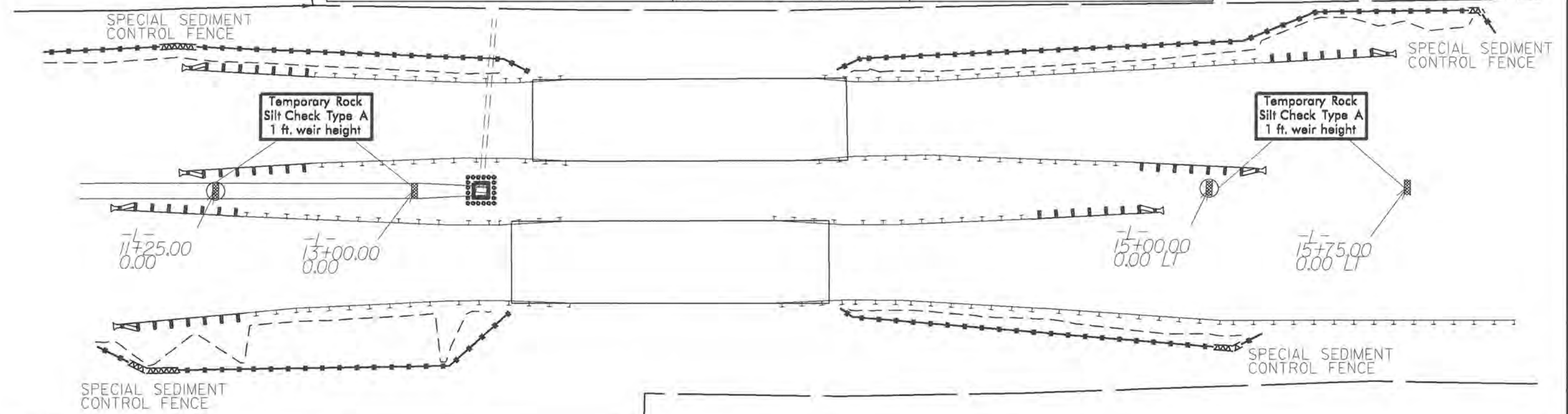

Std. #	Description	Symbol
1605.01	Temporary Silt Fence	
1606.01	Special Sediment Control Fence	▲▲▲▲▲▲▲▲
1622.01	Temporary Berms and Slope Drains	— T —
1630.02	Silt Basin Type B	▨
1630.03	Temporary Silt Ditch	—
1630.05	Temporary Diversion	— T —
1630.06	Special Stilling Basin	—
1632.03	Rock Inlet Sediment Trap Type B	□
1633.01	Temporary Rock Silt Check Type-A	▨
	Temporary Rock Silt Check Type-A with Matting and Polyacrylamide (PAM)	▨
1633.02	Temporary Rock Silt Check Type-B	▶
	Wattle	⤿
	Wattle with Polyacrylamide (PAM)	⤿
1634.02	Temporary Rock Sediment Dam Type-B	⊓
1635.01	Rock Pipe Inlet Sediment Trap Type-A	⊓

INSTALL EC MATTING IN THE PROPOSED DITCH LINE.

THESE EROSION AND SEDIMENT CONTROL PLANS COMPLY WITH THE REGULATIONS SET FORTH BY THE NCG-010000 GENERAL CONSTRUCTION PERMIT EFFECTIVE AUGUST 3, 2011 ISSUED BY THE NORTH CAROLINA DEPARTMENT OF ENVIRONMENT AND NATURAL RESOURCES DIVISION OF WATER QUALITY.

NOTE:
IF THE SHOULDERS ARE SEEDED AND MULCHED WITHIN 48 HOURS, NO EC IS NEEDED
ADJUST PLACEMENT OF SPECIAL SEDIMENT CONTROL FENCE AS DIRECTED BY THE ENGINEER

2012 STANDARD DRAWINGS			
1604.01	Railroad Erosion Control Detail	1632.01	Rock Inlet Sediment Trap Type A
1605.01	Temporary Silt Fence	1632.02	Rock Inlet Sediment Trap Type B
1606.01	Special Sediment Control Fence	1632.03	Rock Inlet Sediment Trap Type C
1607.01	Gravel Construction Entrance	1633.01	Temporary Rock Silt Check Type A
1622.01	Temporary Berms and Slope Drains	1633.02	Temporary Rock Silt Check Type B
1630.01	Riser Basin	1634.01	Temporary Rock Sediment Dam Type A
1630.02	Silt Basin Type B	1634.02	Temporary Rock Sediment Dam Type B
1630.03	Temporary Silt Ditch	1635.01	Rock Pipe Inlet Sediment Trap Type A
1630.04	Stilling Basin	1635.02	Rock Pipe Inlet Sediment Trap Type B
1630.05	Temporary Diversion	1640.01	Coir Fiber Baffle
1630.06	Special Stilling Basin	1645.01	Temporary Stream Crossing
1631.01	Matting Installation		

EC PLAN FOR
US 401 @ SWIFT CREEK

DIVISION 05 WAKE COUNTY

REVISIONS	INT.	DATE

SCALE: 40'=1" DATE: 6 Nov 2013

N.C. DEPARTMENT of TRANSPORTATION
DIVISION of HIGHWAYS
DIVISION FIVE DESIGN UNIT

PREPARED BY: CAH
REVIEWED BY: BJU
REVIEWED BY:

8/23/99

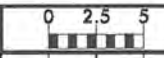

PROJ. REFERENCE NO.	SHEET NO.
W-5205L	X-1

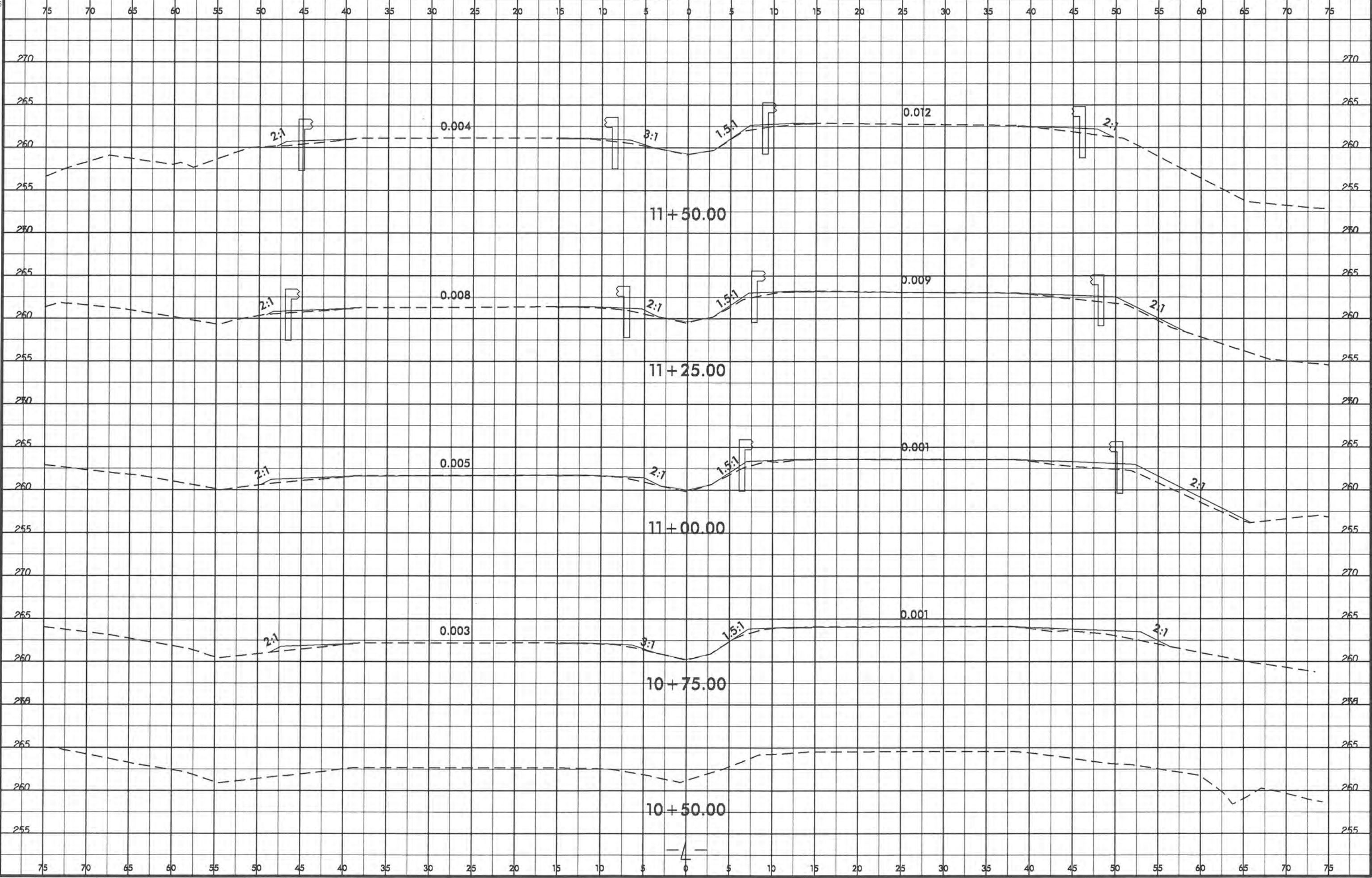

07-NOV-2013 08:31
 R:\Projects\1100\1100-Modeling\W5205L_Rdy_xpl.dgn
 \$\$\$\$

8/23/99

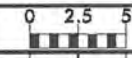

PROJ. REFERENCE NO.	SHEET NO.
W-5205L	X-2

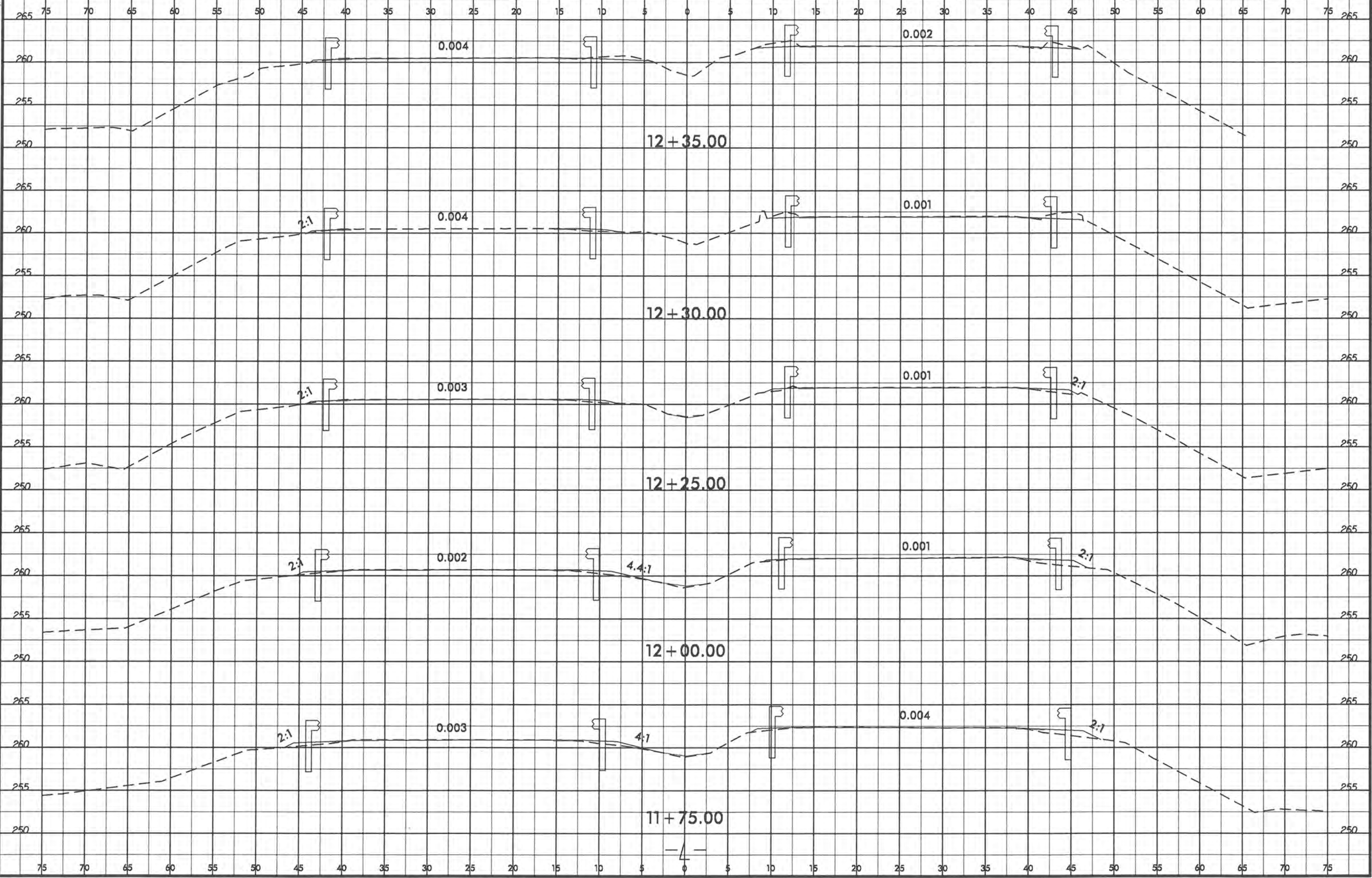

07-NOV-2013 08:31
\\s:\projects\1308\1308-Modeling\W5205L-Rdy_xpl.dgn

8/23/99

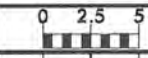

PROJ. REFERENCE NO.	SHEET NO.
W-5205L	X-3

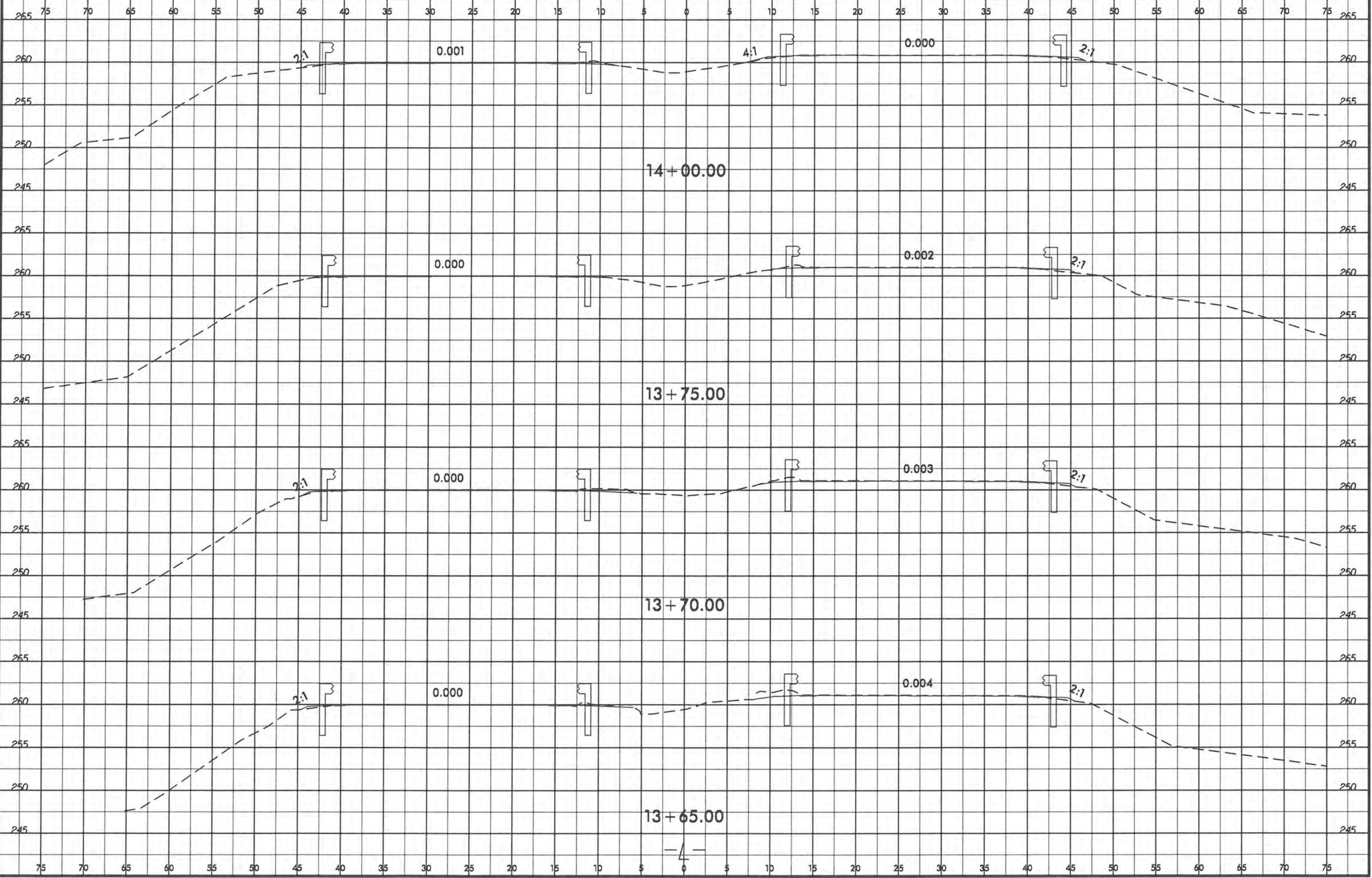

07-NOV-2003 08:31
C:\Users\jrb\Documents\Modelling\W5205L_Rdy_xpl.dgn

8/23/19



PROJ. REFERENCE NO.	SHEET NO.
W-5205L	X-4

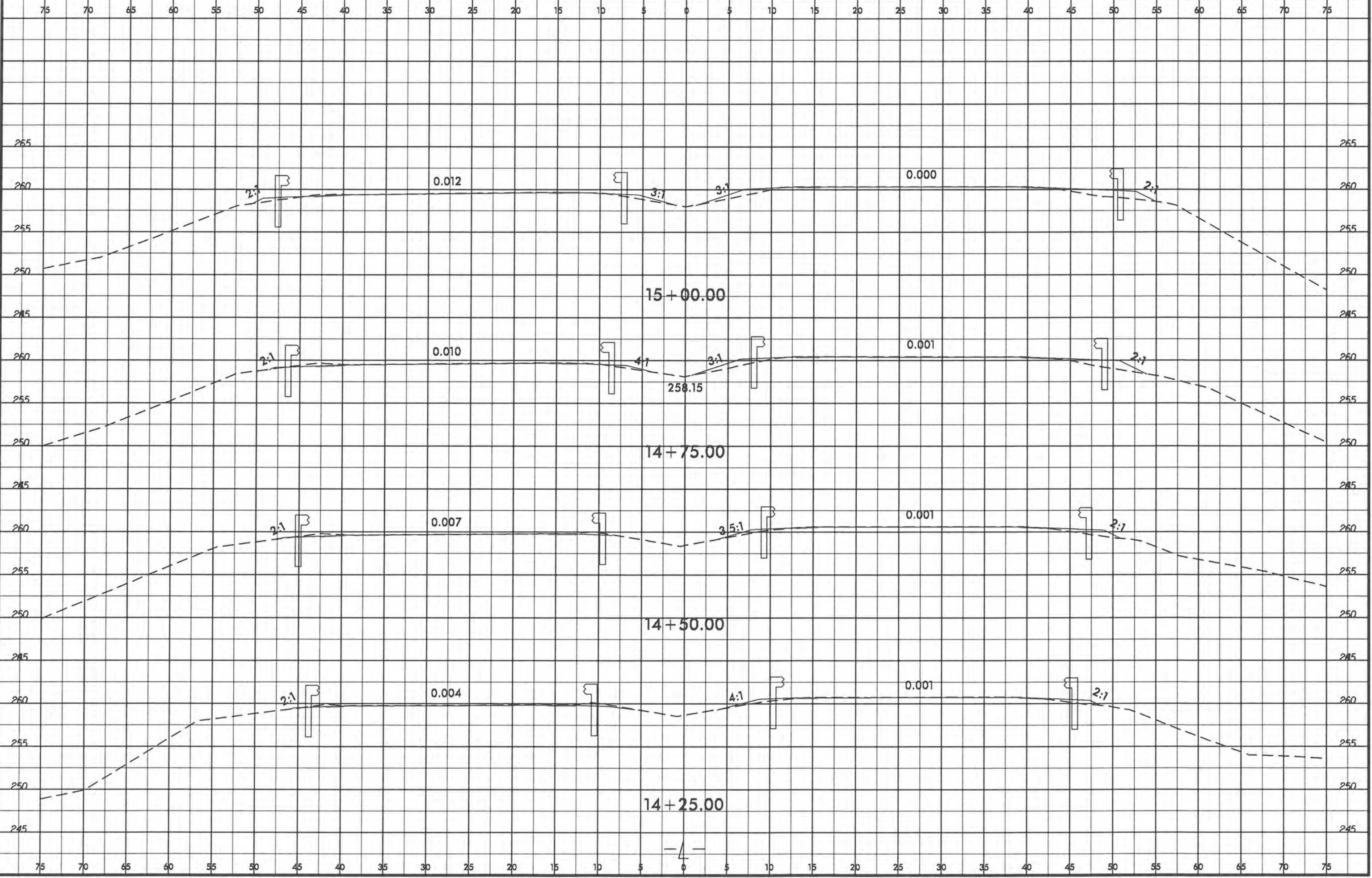

07-NOV-2015 08:31
 P:\11\115205L\115205L.dwg
 \$\$\$\$
 \$\$\$\$

8/23/99



PROJ. REFERENCE NO.	SHEET NO.
W-5205L	X-5

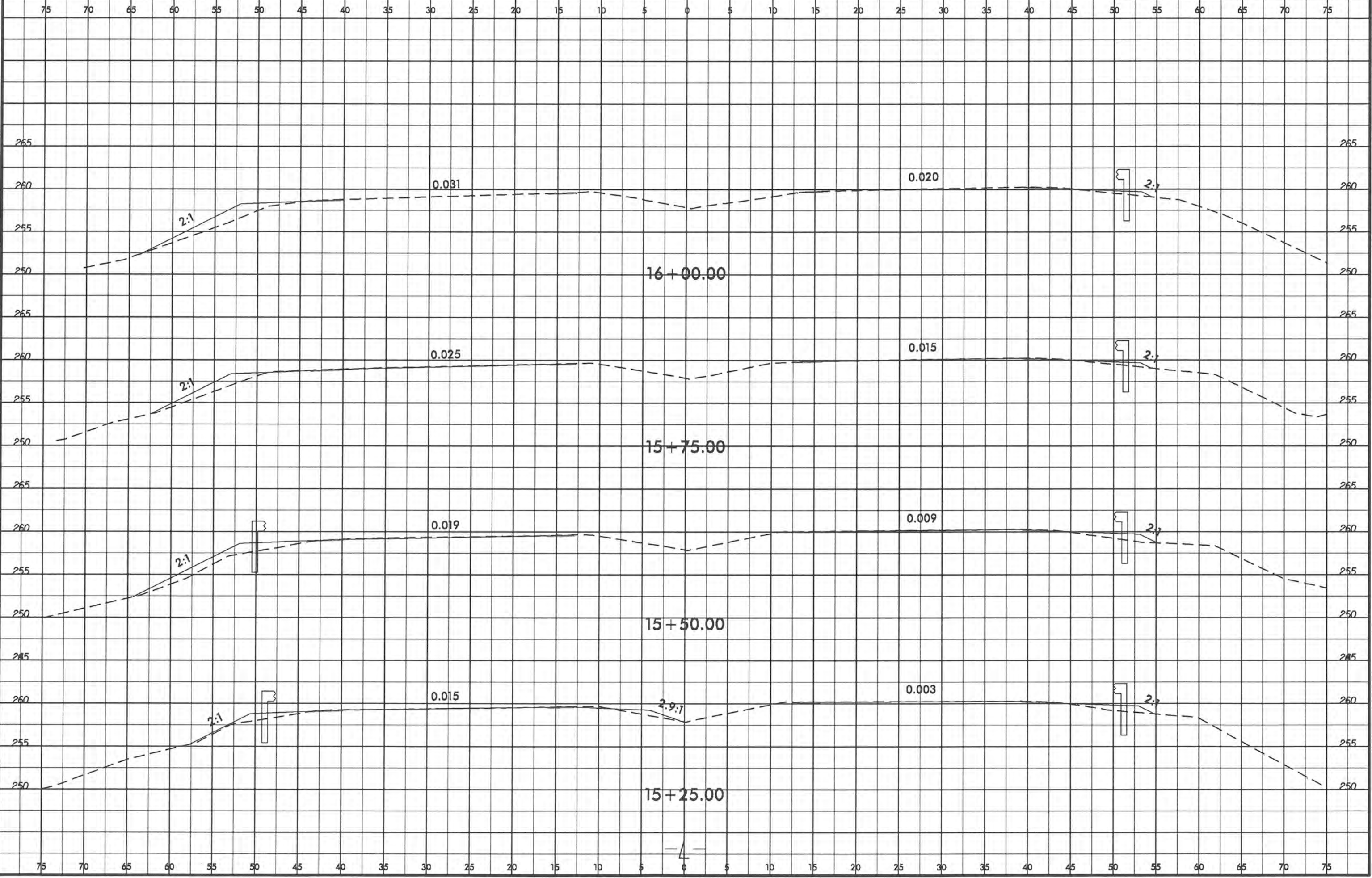

07-NOV-2003 08:31
 533101PSEHWA\W5205L_RdJ...pl.dgn