

# 2013 Setup and Pave Subdivision Resurfacing East Wake County

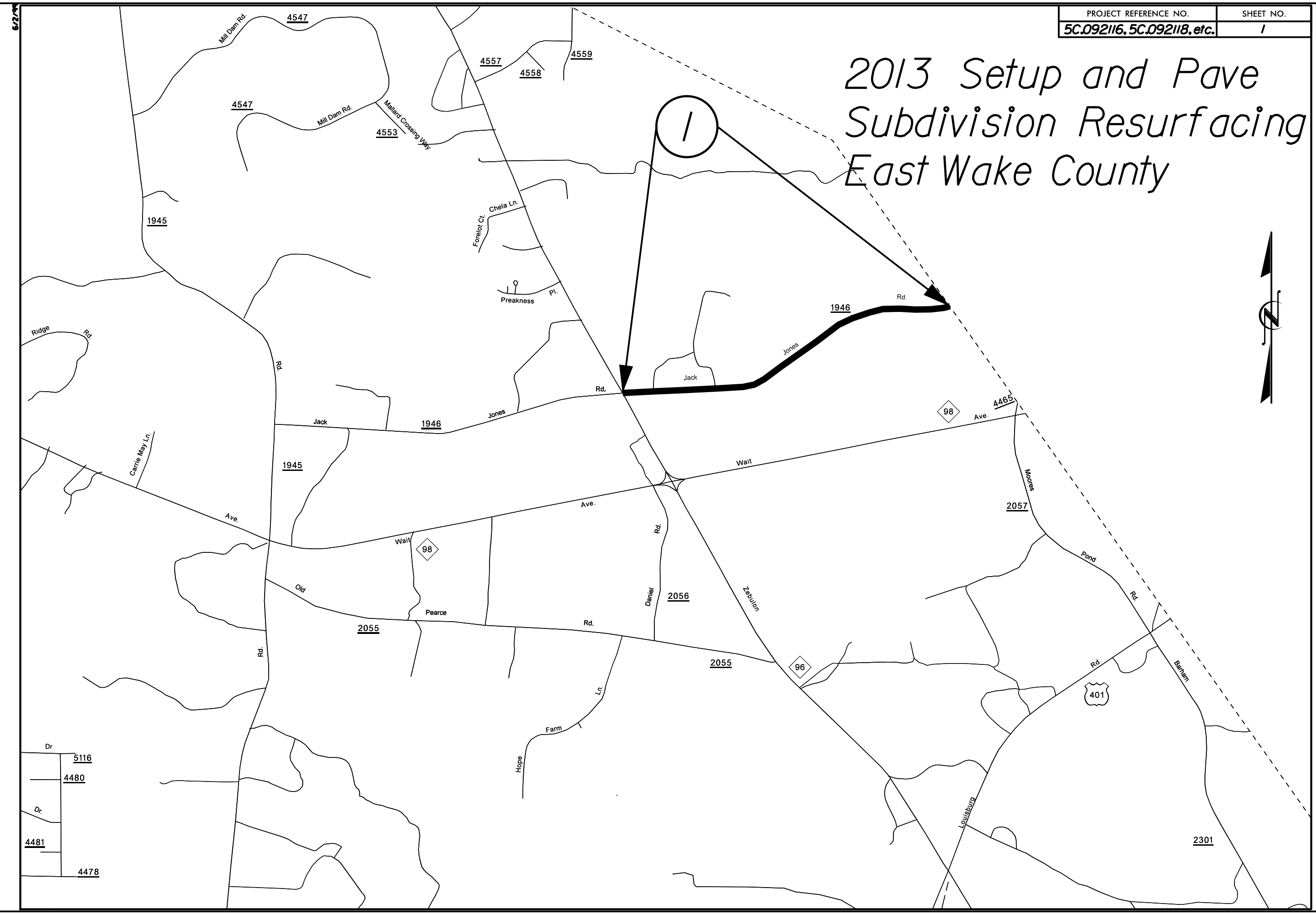

6.2.44

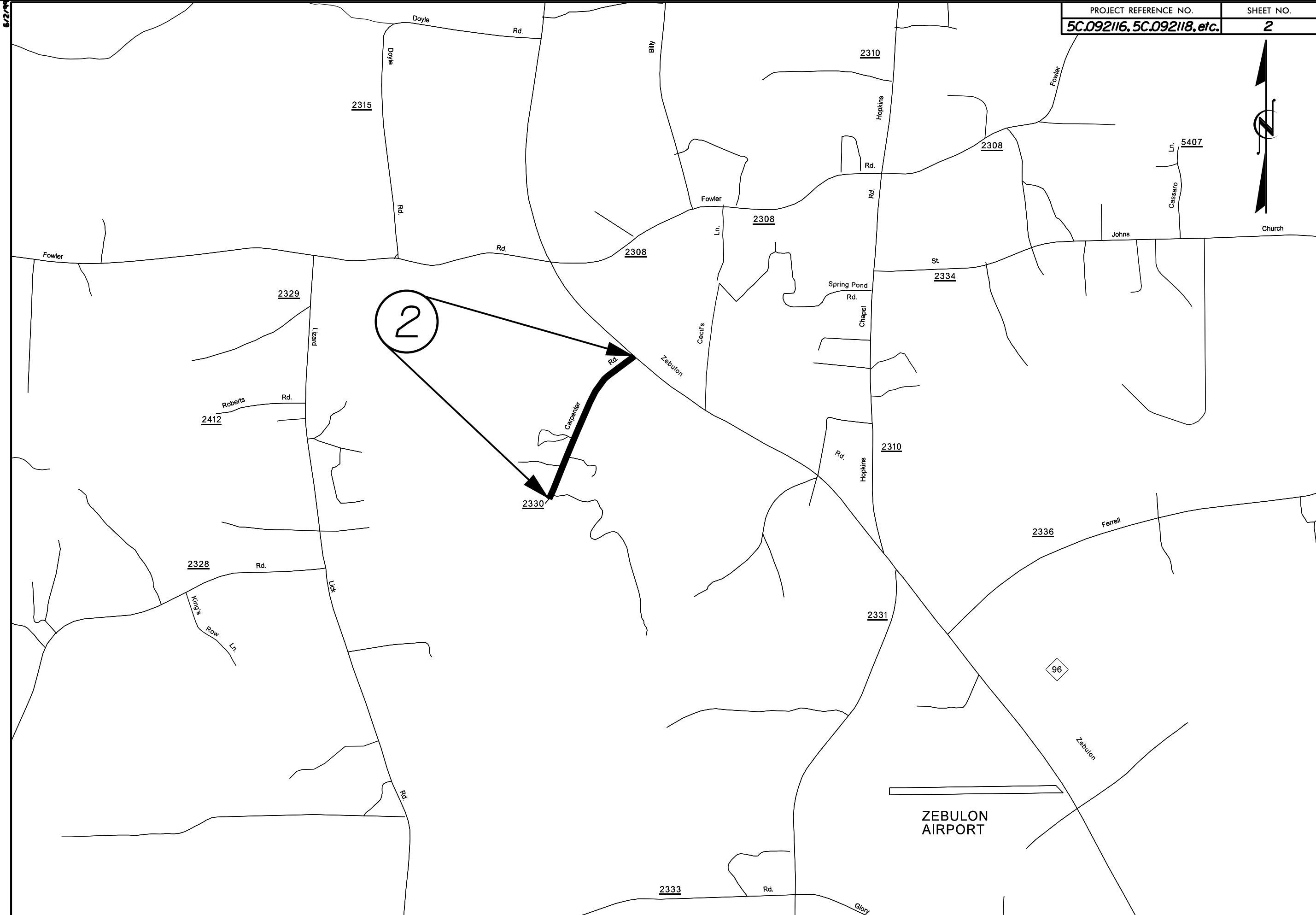



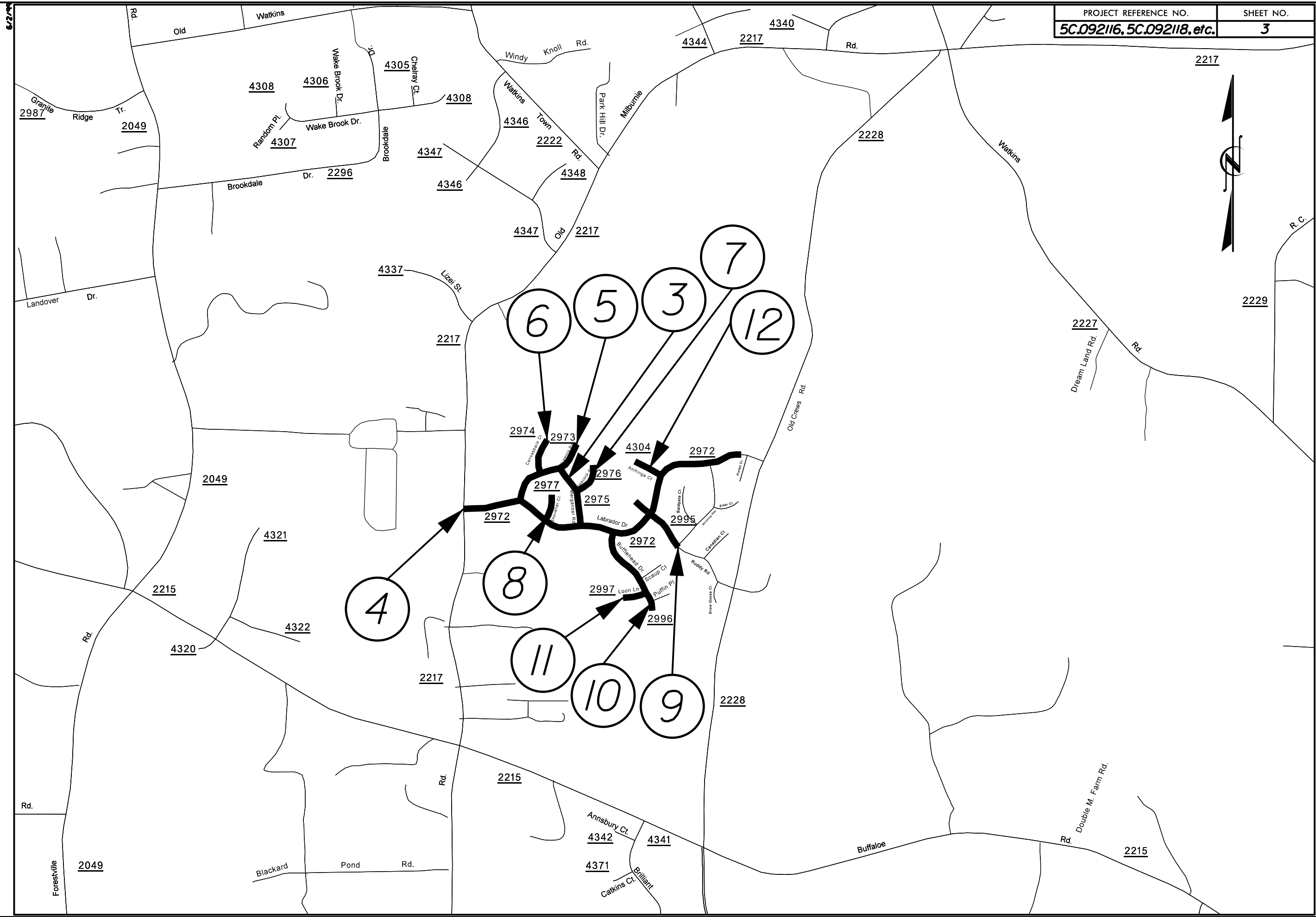

6/2/99

# PAVEMENT SCHEDULE

C	1½" ASPHALT CONCRETE SURFACE COURSE, TYPE SF9.5A, AT AN AVERAGE RATE OF 165 LBS. PER SQ. YD.
D	2½" ASPHALT CONCRETE INTERMEDIATE COURSE, TYPE I19.0B, AT AN AVERAGE RATE OF 285 LBS. PER SQ. YD.
U1	EXISTING PAVEMENT AND SUBGRADE
U2	EXISTING ABC TO BE CONDITIONED AND SHAPED
V	1½" MILLING

## NOTES

ALL UNPAVED S.R. ROADS TO BE RESURFACED 50' FROM EDGE OF PAVEMENT OF MAIN PROJECT  
 ALL PAVED S.R. ROADS TO BE RESURFACED TO THE ENDS OF THE RADII, OR AS DIRECTED BY THE ENGINEER.  
 PAVEMENT WIDENING AND INTERSECTIONS INCLUDED IN THE TABLE OF QUANTITIES.

PROJECT REFERENCE NO. <b>5C.092116, 5C.092118, etc.</b>	SHEET NO. <b>4</b>
--	-----------------------

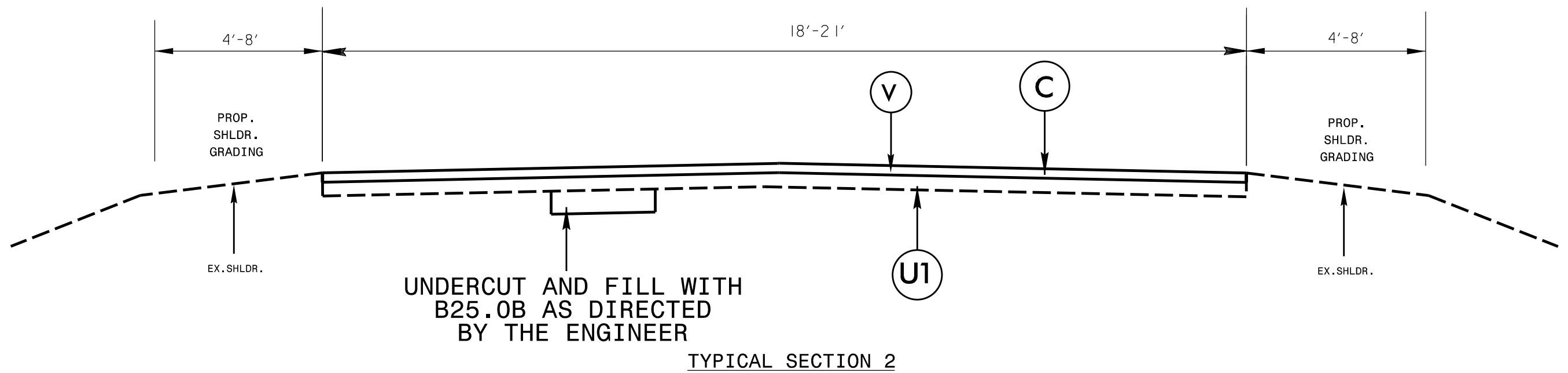
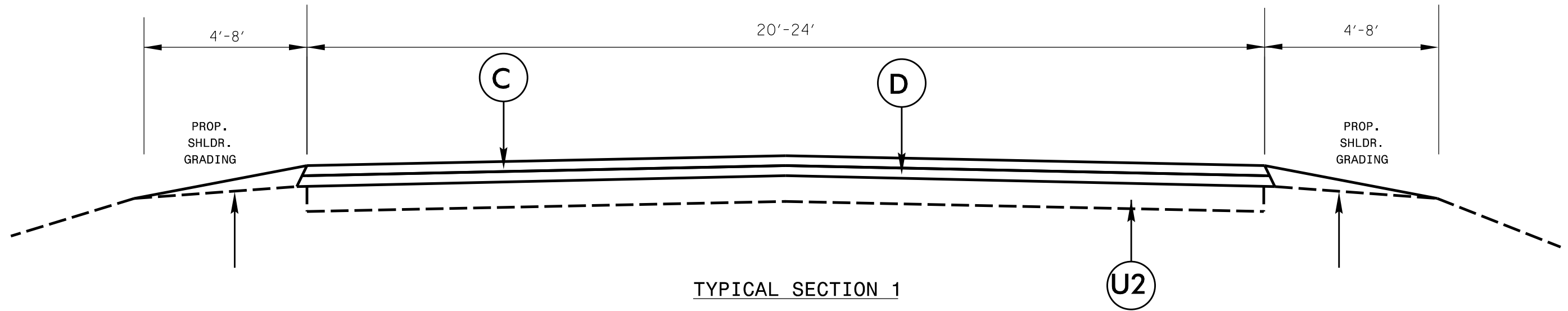
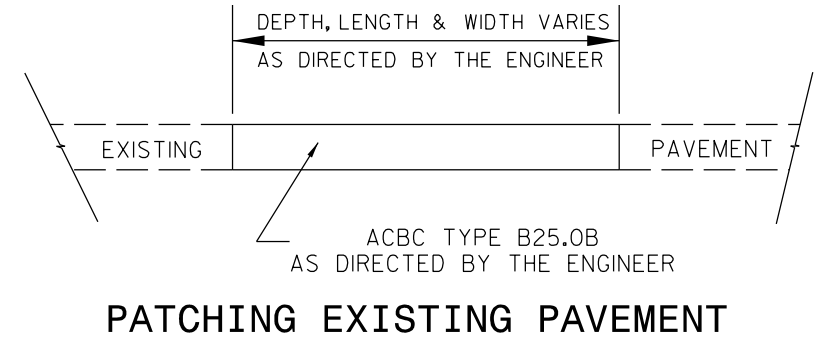



- NOTES:
- 1) DETAIL DOES NOT APPLY TO OGAFc AND ULTRA-THIN BONDED WEARING COURSE.
  - 2) BACKFILL SHOULDER WITH APPROVED MATERIAL.
  - 3) THE SHOULDER WEDGE DEVICE MAY BE DISENGAGED AT PAVED DRIVEWAYS AND SIDE STREETS.

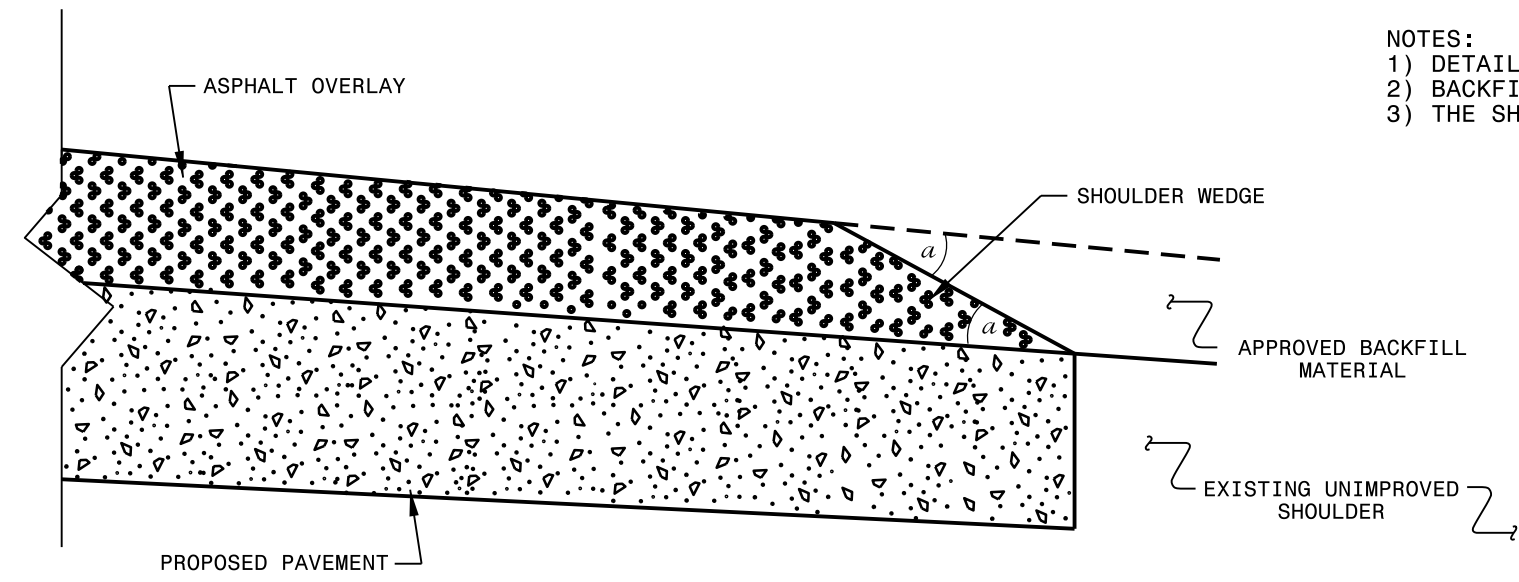

**SHOULDER WEDGE DETAIL**  
 (Resurfacing Projects w/ Widening or  
 with Existing Paved Shoulder having no dropoffs)

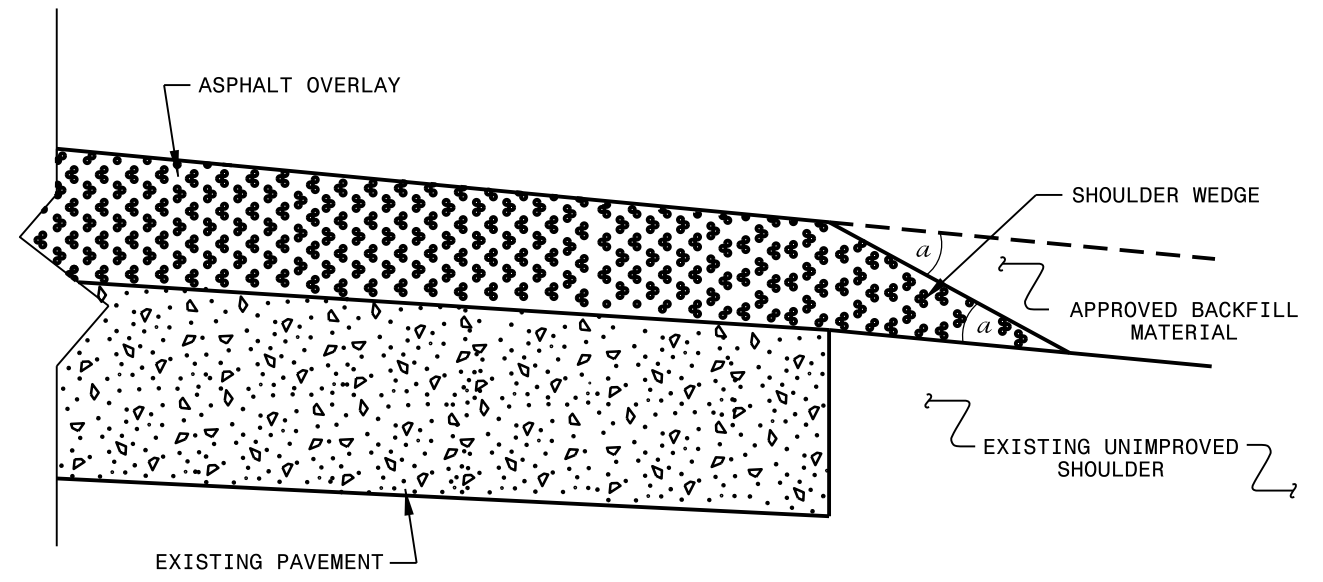

**SHOULDER WEDGE DETAIL**  
 (Resurfacing Projects w/ NO Widening)

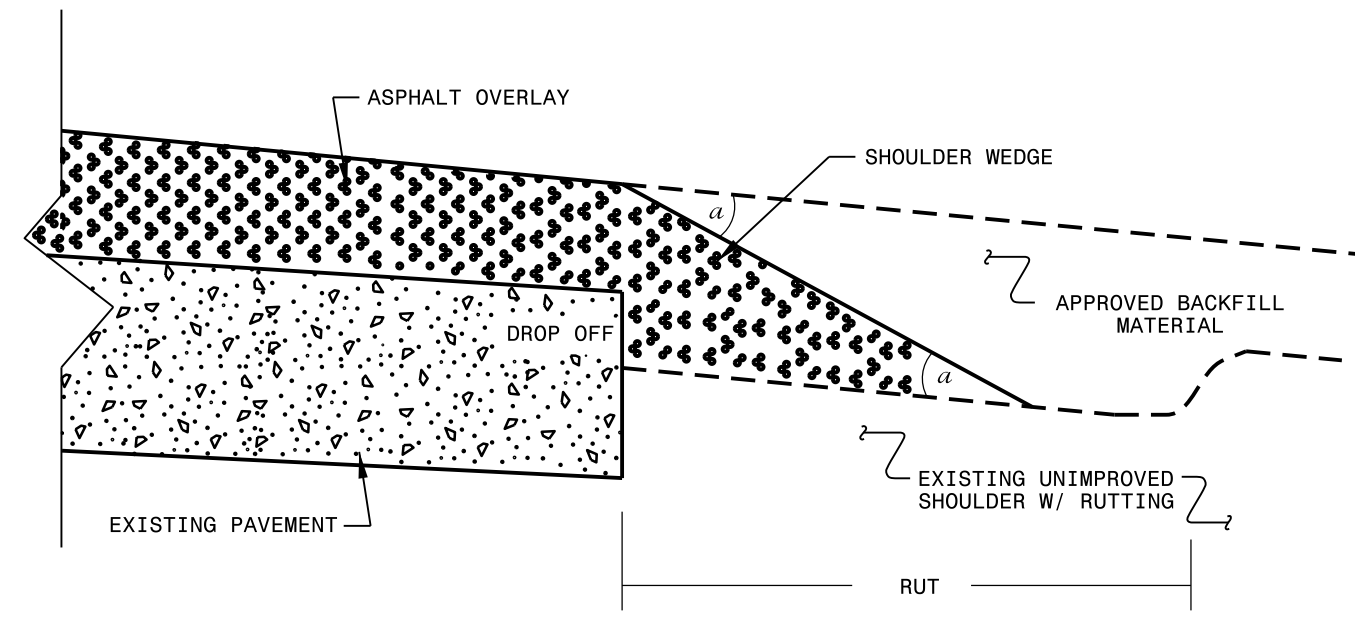

**SHOULDER WEDGE DETAIL**  
 (Resurfacing Adjacent to  
 Rutted Shoulder)

- SHOULDER WEDGE ANGLE = 30°

CONTRACT STANDARDS  
 AND DEVELOPMENT UNIT  
 Office 919-707-6950 FAX 919-250-4119

**SHOULDER WEDGE  
 DETAILS**

ORIGINAL BY: T.SPELL DATE: 7-19-11  
 MODIFIED BY: DATE: 10/16/12  
 CHECKED BY: DATE:  
 FILE SPEC.: susr/details/stand/shoulderwedgedetail.dgn

SYSTEMS DESIGN  
 USER NAME

**DIVISION OF HIGHWAYS  
STATE OF NORTH CAROLINA**

***SOIL STABILIZATION TIMEFRAMES***

<i>SITE DESCRIPTION</i>	<i>STABILIZATION TIME</i>	<i>TIMEFRAME EXCEPTIONS</i>
<b>PERIMETER DIKES, SWALES, DITCHES AND SLOPES</b>	<b>7 DAYS</b>	<b>NONE</b>
<b>HIGH QUALITY WATER (HOW) ZONES</b>	<b>7 DAYS</b>	<b>NONE</b>
<b>SLOPES STEEPER THAN 3:1</b>	<b>7 DAYS</b>	<b>IF SLOPES ARE 10' OR LESS IN LENGTH AND ARE NOT STEEPER THAN 2:1, 14 DAYS ARE ALLOWED.</b>
<b>SLOPES 3:1 OR FLATTER</b>	<b>14 DAYS</b>	<b>7 DAYS FOR SLOPES GREATER THAN 50' IN LENGTH.</b>
<b>ALL OTHER AREAS WITH SLOPES FLATTER THAN 4:1</b>	<b>14 DAYS</b>	<b>NONE, EXCEPT FOR PERIMETERS AND HOW ZONES.</b>

NOTES: Less than 5' - 10' undisturbed buffer from ROW, ditchline, water feature, or drainage inlet, add BMP.

BMP Options: Wattle, Silt Fence, or Hardened Aggregate.

## EROSION CONTROL DETAIL

PROJECT NO. 1-1111	DATE 10-22-2011
DESIGNED BY	CHECKED BY
PROJECT ENGINEER	HYDRAULICS ENGINEER

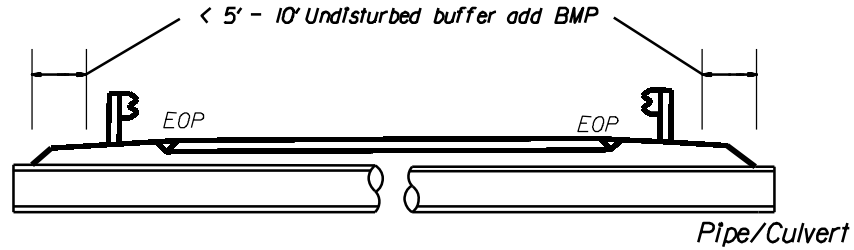

< 5' - 10' Undisturbed buffer from jurisdictional feature add BMP

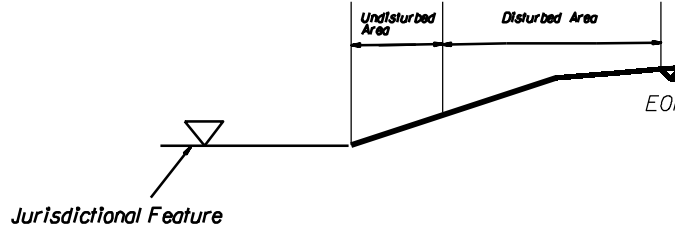

< 5' - 10' Undisturbed buffer from ditchline, add BMP

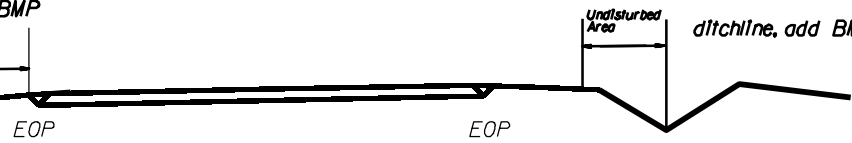

Use BMP's if shoulders and/or frontslopes and/or ditchline and/or backslopes are disturbed

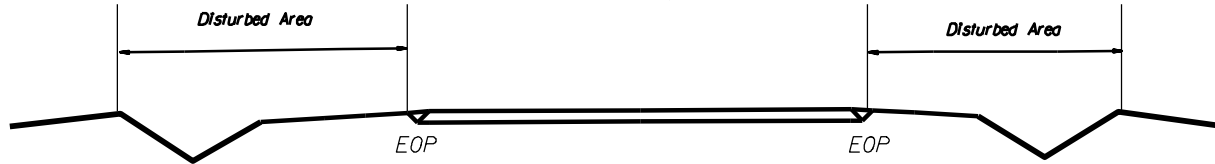

< 5' - 10' Undisturbed buffer from Inlet, add wattle

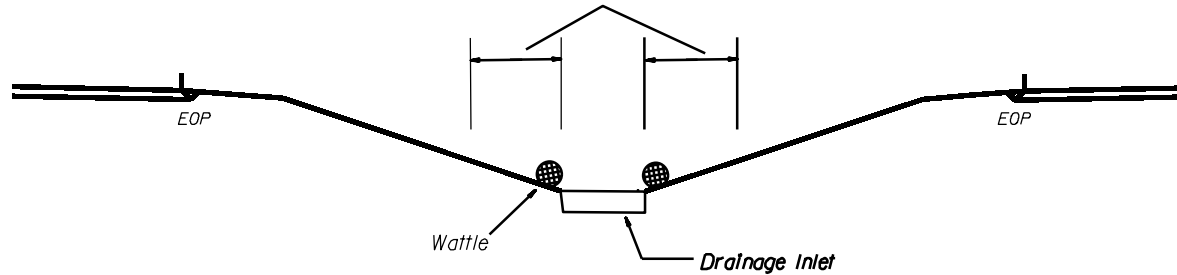

NOT TO SCALE



# WATTLE DETAIL

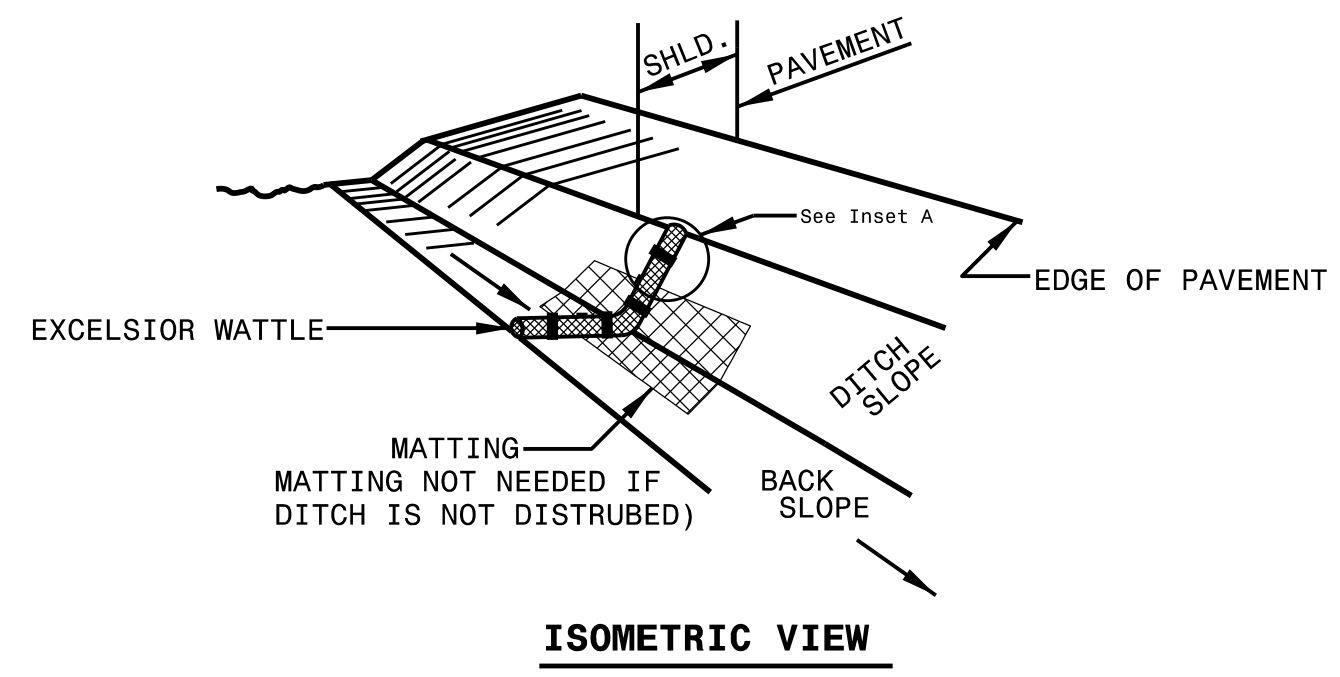

**NOTES:**

- USE MINIMUM 12 IN. DIAMETER EXCELSIOR WATTLE.
- USE 2 FT. WOODEN STAKES WITH A 2 IN. BY 2 IN. NOMINAL CROSS SECTION.
- ONLY INSTALL WATTLE(S) TO A HEIGHT IN DITCH SO FLOW WILL NOT WASH AROUND WATTLE AND SCOUR DITCH SLOPES AND AS DIRECTED.
- INSTALL A MINIMUM OF 2 UPSLOPE STAKES AND 4 DOWNSLOPE STAKES AT AN ANGLE TO WEDGE WATTLE TO BOTTOM OF DITCH.
- PROVIDE STAPLES MADE OF 0.125 IN. DIAMETER STEEL WIRE FORMED INTO A U SHAPE NOT LESS THAN 12" IN LENGTH.
- INSTALL STAPLES APPROXIMATELY EVERY 1 LINEAR FOOT ON BOTH SIDES OF WATTLE AND AT EACH END TO SECURE IT TO THE SOIL.
- IF DITCH WILL BE DISTURBED, INSTALL MATTING IN ACCORDANCE WITH SECTION 1631 OF THE STANDARD SPECIFICATIONS.

