

**This electronic collection of documents is provided  
for the convenience of the user  
and is Not a Certified Document –**

**The documents contained herein were originally issued  
and sealed by the individuals whose names and license  
numbers appear on each page, on the dates appearing  
with their signature on that page.**

**This file or an individual page  
shall not be considered a certified document.**

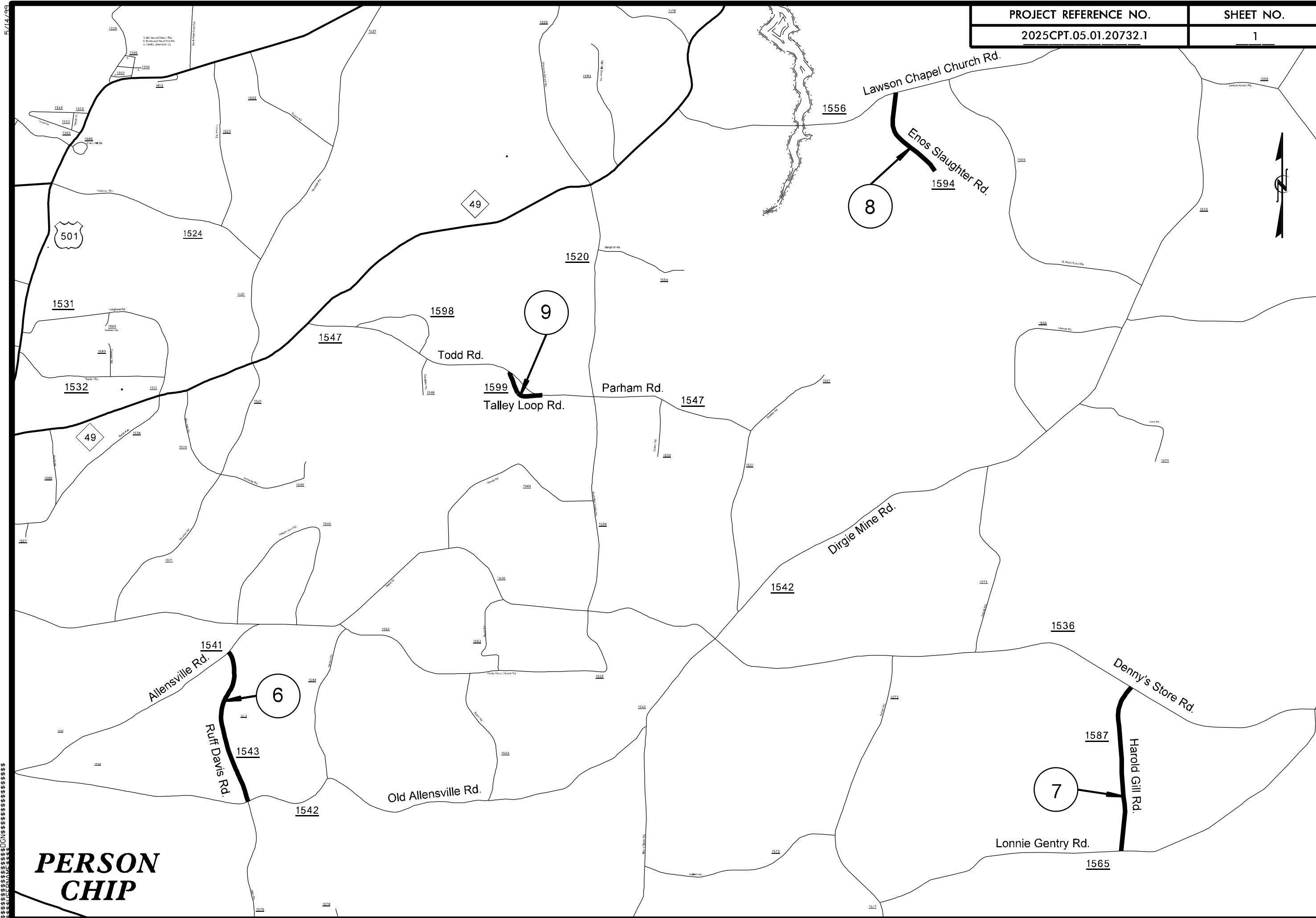

**PERSON  
CHIP**

5714799  
C:\PROJECTS\2025\2025CPT.05.01.20732.1\PERSON.CHIP

# PERSON CHIP

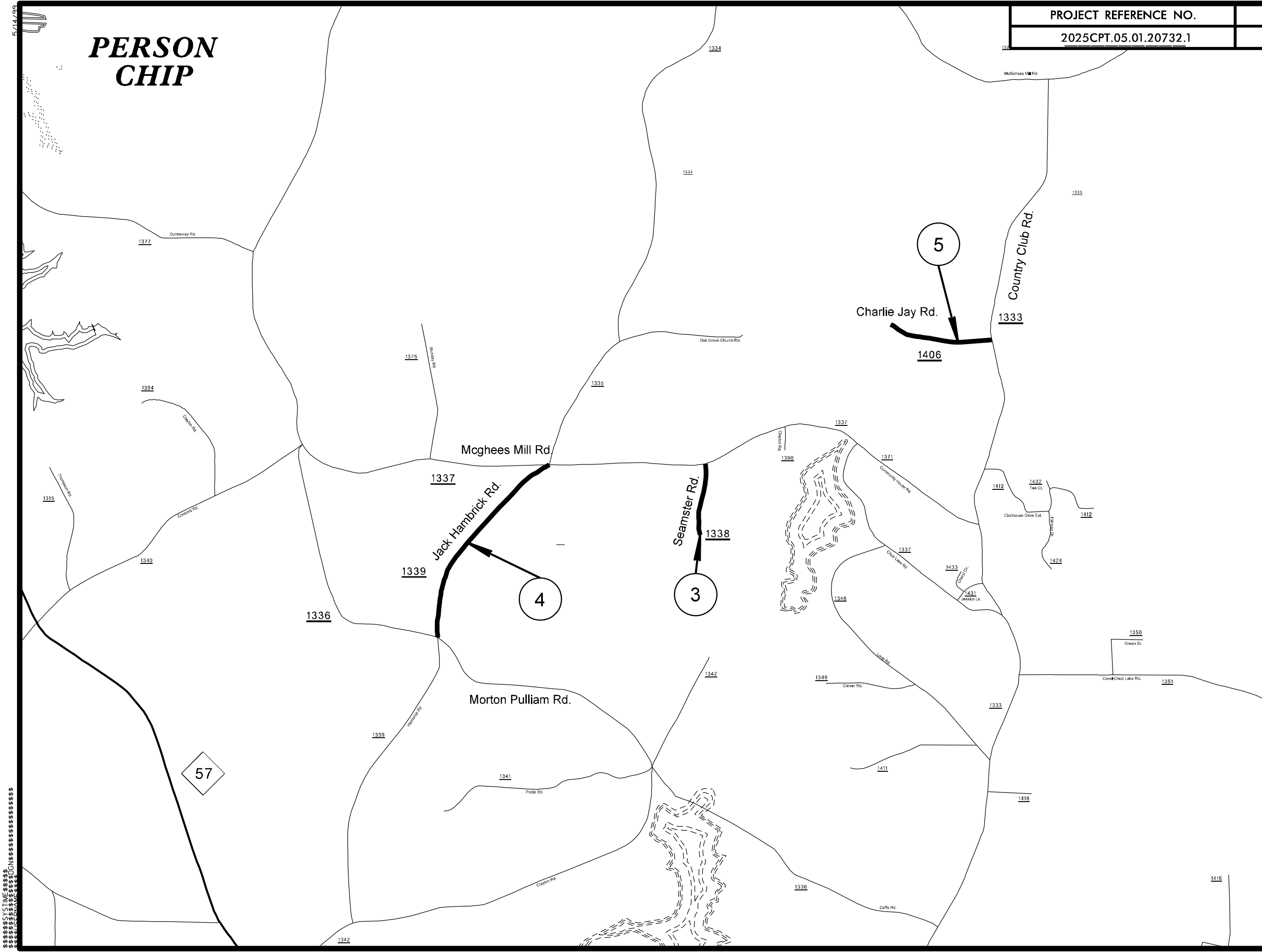

5/14/25  
C:\PROJECTS\PERSON CHIP\DWG\PERSON CHIP.DWG



# PAVEMENT SCHEDULE

PROJECT REFERENCE NO.

SHEET NO.

2025CPT.05.01.20732.1

4

F	PROP. ASPHALT SURFACE TREATMENT, DOUBLE SEAL
U	EXISTING PAVEMENT

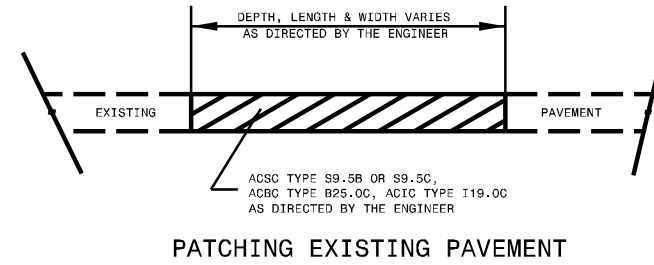

SEAL TYPES AND MATERIAL APPLICATION RATES					
MAP #	TYPE OF SEAL	LAYER	AGGREGATE TYPE	AGGREGATE TARGET RATES (LBS/SY)	EMULSION TARGET RATES (GAL/SY)
ALL MAPS	DOUBLE	BOTTOM	78M	18	0.30
		TOP	9M	9	0.25
			EMULSION TYPE		
N/A	FOG	WITHIN 5 DAYS OF DOUBLE SEAL	CSS-1H		0.12

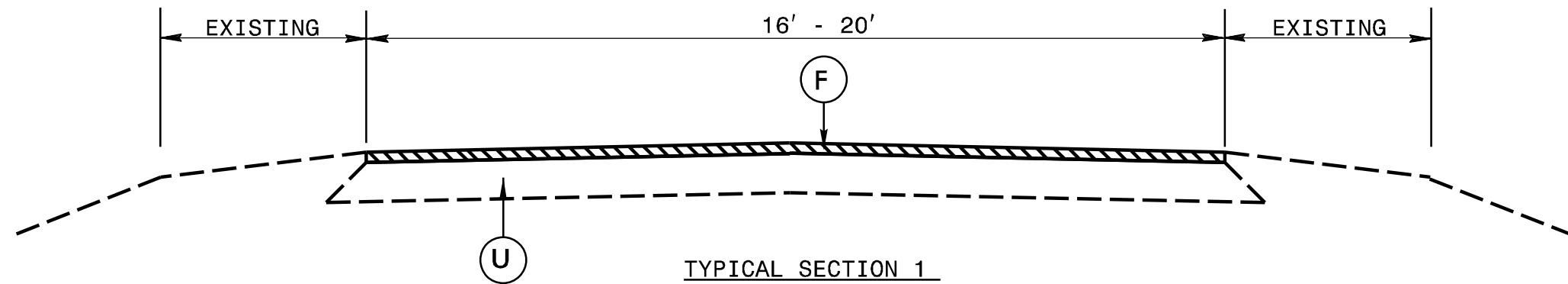



PROJECT NO.	SHEET NO.	TOTAL NO.
2025CPT.05.01.20732.1	6	

## SUMMARY OF QUANTITIES

PROJECT NO	COUNTY	MAP NO	ROUTE	DESCRIPTION	TYP NO	LANES	FINAL SURFACE TESTING REQUIRED	WARM MIX ASPHALT REQUIRED	LENGTH	WIDTH	1575000000-E	1704000000-E	1803500000-E	1838000000-E	
									MI	FT	ASPHALT BINDER FOR PLANT MIX	PATCHING EXISTING PAVEMENT	ASPHALT SURFACE TREATMENT, DOUBLE SEAL	EMULSION FOR ASPHALT SURFACE TREATMENT	
											TON	TONS	SY	GAL	
2025CPT.05.01.20732.1	Person	1	SR-1121 / WILLIE GRAY RD	SR 1123 / DICK HOLEMAN RD TO SR 1120 / BERRY PEARCE RD	1	2	NO	NO	1.983	20		3	23,559	12,958	
	Person	2	SR-1122 / AL GRAY RD	ORANGE COUNTY TO SR 1121 / WILLIE GRAY RD	1	2	NO	NO	0.486	20		10	5,702	3,136	
	Person	3	SR-1338 / SEAMSTER RD	SR 1337 / MCGHEES MILL RD TO CUL-DE-SAC	1	2	NO	NO	0.250	20		10	3,216	1,768	
	Person	4	SR-1339 / JACK HAMBRICK RD	SR 1336 / MORTON PULLIAM RD TO SR 1337 / MCGHEES MILL RD	1	2	NO	NO	0.920	20		10	10,795	5,937	
	Person	5	SR-1406 / CHARLIE JAY RD	SR 1333 / COUNTRY CLUB RD TO END MAINTENANCE	1	2	NO	NO	0.442	16		6	4,149	2,282	
	Person	6	SR-1543 / RUFF DAVIS RD	SR 1541 / ALLENSVILLE RD TO SR 1542 / OLD ALLENSVILLE RD	1	2	NO	NO	1.033	20		3	12,121	6,666	
	Person	7	SR-1587 / HAROLD GILL RD	SR 1565 / LONNIE GENTRY RD TO SR 1536 / DENNY'S STORE RD	1	2	NO	NO	1.097	20		10	12,871	7,079	
	Person	8	SR-1594 / ENOS SLAUGHTER RD	SR 1556 / LAWSON CHAPEL CHURCH RD TO DEAD END	1	2	NO	NO	0.631	20	1	31	7,404	4,072	
	Person	9	SR-1599 / TALLEY LOOP RD	SR 1547 / TODD RD TO SR 1547 / TODD RD	1	2	NO	NO	0.287	18	2	32	3,031	1,667	
<b>TOTAL FOR PROJ NO. 2025CPT.05.01.20732.1</b>											<b>7.129</b>	<b>3</b>	<b>115</b>	<b>82,848</b>	<b>45,565</b>
<b>GRAND TOTAL</b>											<b>7.129</b>	<b>3</b>	<b>115</b>	<b>82,848</b>	<b>45,565</b>

## THERMOPLASTIC AND PAINT QUANTITIES

PROJECT NO	COUNTY	MAP NO	ROUTE	DESCRIPTION	TYP NO	LANES	LENGTH	WIDTH	4413000000-E	4457000000-N	4890000000-E			
							MI	FT	WORK ZONE ADVANCE/GENERAL WARNING SIGNING	TEMPORARY TRAFFIC CONTROL	GENERIC MARKING ITEM HOT SPRAY THERMOPLASTIC PAVEMENT MARKING LINES,			
											SF	LS	LF	
2025CPT.05.01.20732.1	Person	1	SR-1121 / WILLIE GRAY RD	SR 1123 / DICK HOLEMAN RD TO SR 1120 / BERRY PEARCE RD	1	2	1.983	20	223	0.27	41,880			
	Person	2	SR-1122 / AL GRAY RD	ORANGE COUNTY TO SR 1121 / WILLIE GRAY RD	1	2	0.486	20	55	0.07	10,264			
	Person	3	SR-1338 / SEAMSTER RD	SR 1337 / MCGHEES MILL RD TO CUL-DE-SAC	1	2	0.250	20	35	0.04				
	Person	4	SR-1339 / JACK HAMBRICK RD	SR 1336 / MORTON PULLIAM RD TO SR 1337 / MCGHEES MILL RD	1	2	0.920	20	103	0.13	19,432			
	Person	5	SR-1406 / CHARLIE JAY RD	SR 1333 / COUNTRY CLUB RD TO END MAINTENANCE	1	2	0.442	16	50	0.04				
	Person	6	SR-1543 / RUFF DAVIS RD	SR 1541 / ALLENSVILLE RD TO SR 1542 / OLD ALLENSVILLE RD	1	2	1.033	20	116	0.14	21,816			
	Person	7	SR-1587 / HAROLD GILL RD	SR 1565 / LONNIE GENTRY RD TO SR 1536 / DENNY'S STORE RD	1	2	1.097	20	123	0.15	23,168			
	Person	8	SR-1594 / ENOS SLAUGHTER RD	SR 1556 / LAWSON CHAPEL CHURCH RD TO DEAD END	1	2	0.631	20	71	0.10				
	Person	9	SR-1599 / TALLEY LOOP RD	SR 1547 / TODD RD TO SR 1547 / TODD RD	1	2	0.287	18	33	0.06				
<b>TOTAL FOR PROJ NO. 2025CPT.05.01.20732.1</b>											<b>7.129</b>	<b>809</b>	<b>1.000</b>	<b>116,560</b>
<b>GRAND TOTAL</b>											<b>7.129</b>	<b>809</b>	<b>1.000</b>	<b>116,560</b>

# SIGNING FOR ASPHALT SURFACE TREATMENT

**LEGEND**

- ▷ PORTABLE SIGN
- └ STATIONARY SIGN
- ← DIRECTION OF TRAFFIC FLOW

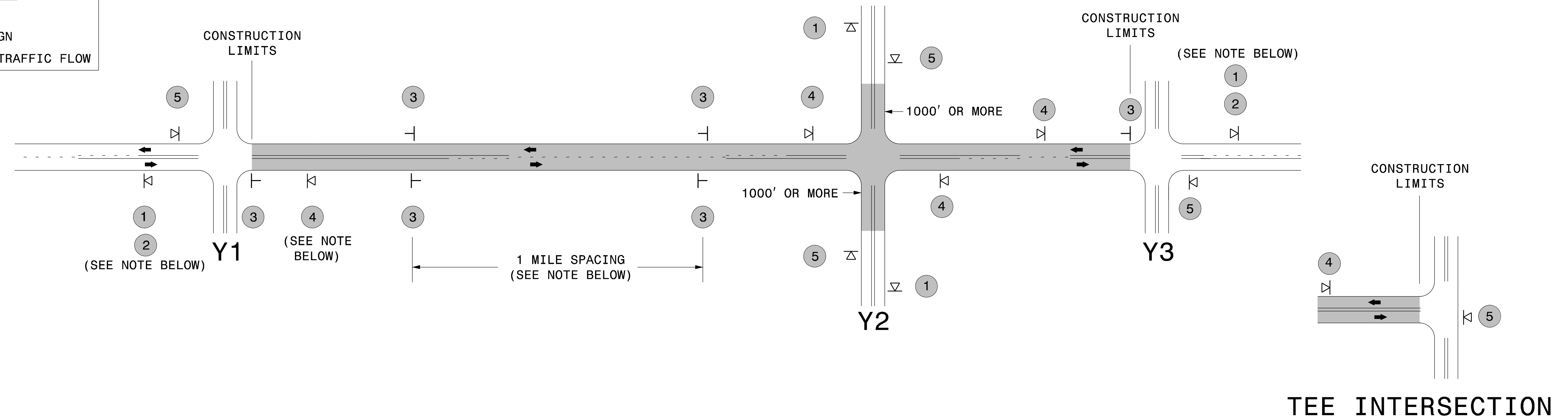

## MAINLINE (-L-) SIGNING

## -Y- LINE SIGNING

SIGNING NOTES AND PLACEMENT PER DIRECTION		<ul style="list-style-type: none"> <li>- PLACE 1000' PRIOR TO BEGINNING OF CONSTRUCTION LIMITS. ONLY USED ON -Y- LINES IF RESURFACING LIMITS EXTEND 1000' ALONG -Y- LINE.</li> <li>- SIGN #2 ONLY USED WHEN RESURFACING LIMITS ARE 2 OR MORE MILES IN LENGTH. ROUND UP TO THE NEAREST WHOLE NUMBER. DO NOT USE FRACTIONAL OR DECIMAL NUMBERS.</li> </ul>	<p><b>STATIONARY SIGNING NOT REQUIRED FOR THE FOLLOWING -Y- LINE CONDITIONS:</b></p> <ol style="list-style-type: none"> <li>1) LESS THAN 1000' OF RESURFACING ALONG -Y- LINE</li> <li>2) SUBDIVISION ROADS</li> <li>3) DEAD END ROADS</li> </ol> <p>WHEN PAVING/CONSTRUCTION ACTIVITIES PROCEED ACROSS AN UNSIGNED -Y- LINE, PORTABLE ADVANCE WARNING SIGNS SHALL BE USED ALONG THE -Y- LINE AS SHOWN BELOW. REMOVE UPON COMPLETION OF WORK.</p> <div style="display: flex; justify-content: space-around;"> <div style="text-align: center;"> <p>PLACED 500' IN ADVANCE OF FLAGGER.</p> </div> <div style="text-align: center;"> <p>PLACED 250' IN ADVANCE OF FLAGGER.</p> </div> </div>
		<ul style="list-style-type: none"> <li>- ALTERNATE THE FOLLOWING TWO SIGNS:</li> <li>- STARTING WITH "LOOSE GRAVEL" (W8-7) FOLLOWED BY "UNMARKED PAVEMENT".</li> <li>- PLACE INITIALLY AT THE CONSTRUCTION LIMITS AND SPACED 1 MILE APART THEREAFTER.</li> <li>- AT TEE INTERSECTIONS INSTALL INITIALLY 0.5 MILE FROM INTERSECTION AND SPACE 1 MILE APART THEREAFTER.</li> </ul>	
		<ul style="list-style-type: none"> <li>- THESE ARE FOR -Y- LINES THAT ARE "THROUGH" ROADWAYS. DEAD END AND SUBDIVISION ROADS ARE NOT "THROUGH" ROADWAYS.</li> <li>- INSTALL 500' +/- FROM EACH -Y- LINE APPROACH AS SHOWN ABOVE.</li> <li>- FOR MULTIPLE -Y- LINES THAT ARE SEPARATED BY 0.25 MILES OR LESS, TREAT AS A SINGLE UNIT AND INSTALL WITHIN 500' OF EACH APPROACH.</li> <li>- A MAXIMUM OF 2 SIGN SETS PER MILE. DO NOT INSTALL WHEN -Y- LINES ARE WITHIN 0.5 MILES FROM "END ROAD WORK" SIGN.</li> </ul>	
		<ul style="list-style-type: none"> <li>- PLACE 500' FOLLOWING THE END OF CONSTRUCTION LIMITS OR AS SHOWN WHEN WORK ENDS AT A 3-WAY TEE INTERSECTION.</li> </ul>	
	<p>THE ABOVE SIGNS ARE ALL THAT ARE REQUIRED FOR A CONTRACTOR TO BEGIN A RESURFACING CONTRACT. ANY ADDITIONAL SIGNS REQUESTED BY NCDOT DIVISIONS SHALL BE INSTALLED WITHIN 7 BUSINESS DAYS OF THE START OF CONTRACT WORK.</p>		

**MAPS LESS THAN 2 MILES**

FOR AST RESURFACING MAPS WITH CONSTRUCTION LIMITS LESS THAN 2 MILES IN LENGTH, USE A STATIONARY "LOOSE GRAVEL" SIGN AT THE BEGINNING CONSTRUCTION LIMIT FOLLOWED BY AN "UNMARKED PAVEMENT" SIGN MIDWAY THROUGH AND AN "END ROAD WORK" SIGN AT THE END CONSTRUCTION LIMIT.

**ADVANCE WARNING SIGNS FOR 2-LANE ROADWAY ASPHALT SURFACE TREATMENT**