

STATE OF NORTH CAROLINA
DEPARTMENT OF TRANSPORTATION
HIGHWAY DIVISION 6

PLANS
December 14, 2016

CONTRACT ID: DF00148

WBS ELEMENT NO.: 2017CPT.06.07.20242.1 & 2017CPT.06.07.20242.2

FEDERAL AID NO.: STATE FUNDED

COUNTY: COLUMBUS

TIP NO.: -----

LENGTH OF PROJECT: 47.074 MILES

ROUTE NO.: VARIOUS SECONDARY ROUTES

TYPE OF WORK: ASPHALT SURFACE TREATMENT – DOUBLE & TRIPLE SEALS

Updated 12/8/2016
Matthew Edwards

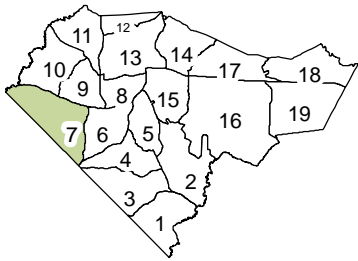

SECTION 7 Columbus County



Contract #: **DF00148**
 WBS: **Double Seals - 2017CPT.06.07.20242.1**
Triple Seals - 2017CPT.06.07.20242.2

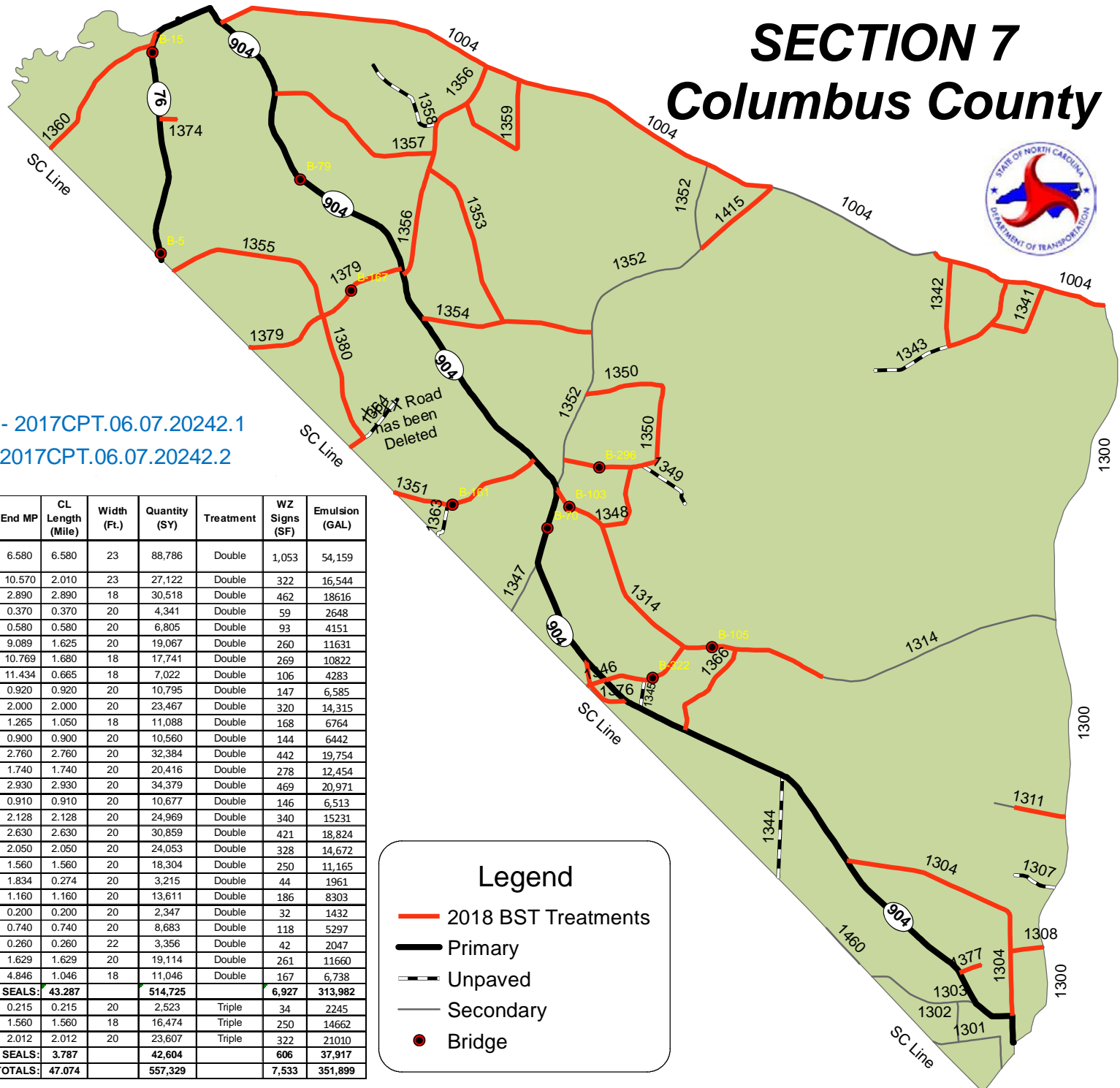

Map	SR	From	Begin MP	To	End MP	CL Length (Mile)	Width (Ft.)	Quantity (SY)	Treatment	WZ Signs (SF)	Emulsion (GAL)
1	SR 1004	NC 904	0.000	SR 1415	6.580	6.580	23	88,786	Double	1,053	54,159
2	SR 1004	SR 1410	8.560	SR 1300	10.570	2.010	23	27,122	Double	322	16,544
3	SR 1304	NC 904	0.000	C&G	2.890	2.890	18	30,518	Double	462	18,616
4	SR 1306	SR 1300	0.000	SR 1304	0.370	0.370	20	4,341	Double	59	2,648
5	SR 1311	SR 1300	0.000	END SECT	0.580	0.580	20	6,805	Double	93	4151
6	SR 1314	PVMT CHG	7.464	SR1346	9.089	1.625	20	19,067	Double	260	11,631
7	SR 1314	SR 1346	9.089	SR 1348	10.769	1.680	18	17,741	Double	269	10,822
8	SR 1314	SR 1348	10.769	NC 904	11.434	0.665	18	7,022	Double	106	4,283
9	SR 1341	SR 1004	0.000	SR 1342	0.920	0.920	20	10,795	Double	147	6,585
10	SR 1342	SR 1004	0.000	SR 1004	2.000	2.000	20	23,467	Double	320	14,315
11	SR 1346	NC 904	0.215	SR 1314	1.265	1.050	18	11,088	Double	168	6,764
12	SR 1348	SR 1314	0.000	SR 1350	0.900	0.900	20	10,560	Double	144	6,442
13	SR 1350	SR 1352	0.000	SR 1352	2.760	2.760	20	32,384	Double	442	19,754
14	SR 1351	NC 904	0.000	SC LINE	1.740	1.740	20	20,416	Double	278	12,454
15	SR 1353	SR 1352	0.000	SR 1356	2.930	2.930	20	34,379	Double	469	20,971
16	SR 1354	NC 904	0.000	SR 1353	0.910	0.910	20	10,677	Double	146	6,513
17	SR 1355	SR 1379	0.000	SC LINE	2.128	2.128	20	24,969	Double	340	15,231
18	SR 1356	NC 904	0.000	SR 1004	2.630	2.630	20	30,859	Double	421	18,824
19	SR 1357	SR 1356	0.000	NC 904	2.050	2.050	20	24,053	Double	328	14,672
20	SR 1359	SR 1004	0.000	SR 1356	1.560	1.560	20	18,304	Double	250	11,165
21	SR 1360	PVMT CHG	1.560	US 76	1.834	0.274	20	3,215	Double	44	1,961
22	SR 1366	NC 904	0.000	SR 1314	1.160	1.160	20	13,611	Double	186	8,303
23	SR 1374	US 76	0.000	DEAD END	0.200	0.200	20	2,347	Double	32	1,432
24	SR 1376	NC 904	0.000	NC 904	0.740	0.740	20	8,683	Double	118	5,297
25	SR 1377	NC 904	0.000	END MAINT	0.260	0.260	22	3,356	Double	42	2,047
26	SR 1380	SC LINE	0.000	SR 1379	1.629	1.629	20	19,114	Double	261	11,660
27	SR 1415	SR 1412	3.800	SR 1352	4.846	1.046	18	11,046	Double	167	6,738
SUBTOTALS - DOUBLE SEALS:								43,287	514,725	6,927	313,982
28	SR 1346	SC LINE	0.000	NC 904	0.215	0.215	20	2,523	Triple	34	2,245
29	SR 1360	SC LINE	0.000	PVMT CHG	1.560	1.560	18	16,474	Triple	250	14,662
30	SR 1379	SC LINE	0.000	NC 904	2.012	2.012	20	23,607	Triple	322	21,010
SUBTOTALS - TRIPLE SEALS:								3,787	42,604	606	37,917
TOTALS:								47,074	557,329	7,533	351,899

Legend

- 2018 BST Treatments
- Primary
- Unpaved
- Secondary
- Bridge

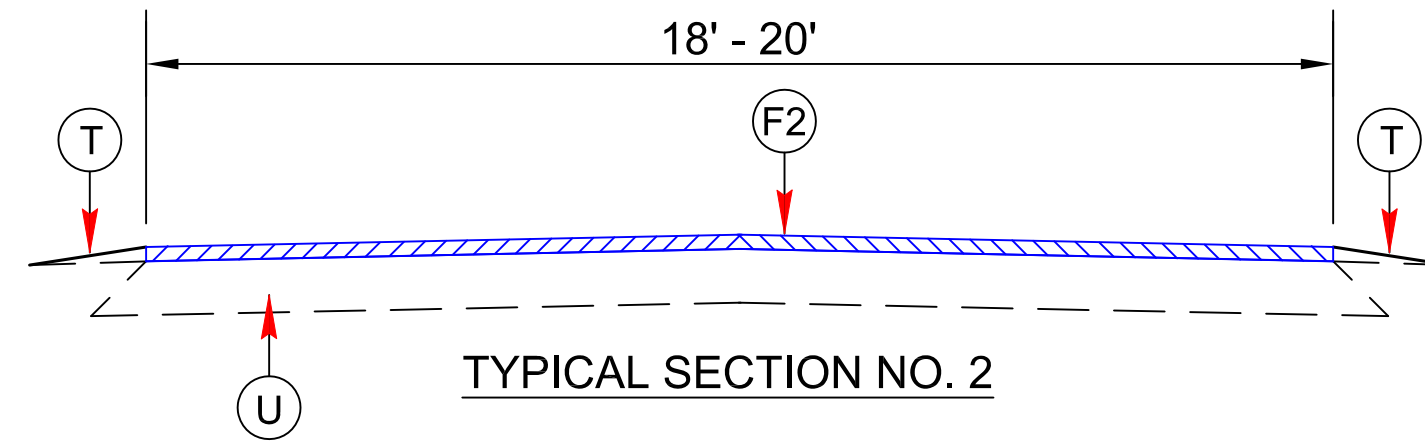
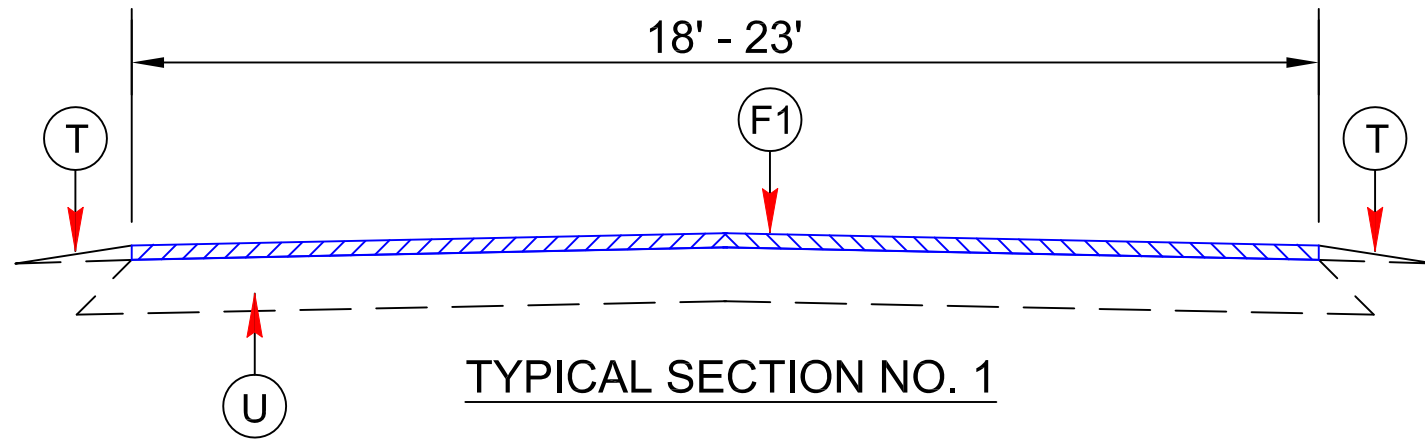

PAVEMENT SCHEDULE	
F1	DOUBLE SEAL PLACED ACCORDING TO THE SPECIAL PROVISIONS
F2	TRIPLE SEAL PLACED ACCORDING TO THE SPECIAL PROVISIONS
T	EXISTING SHOULDER
U	EXISTING ASPHALT

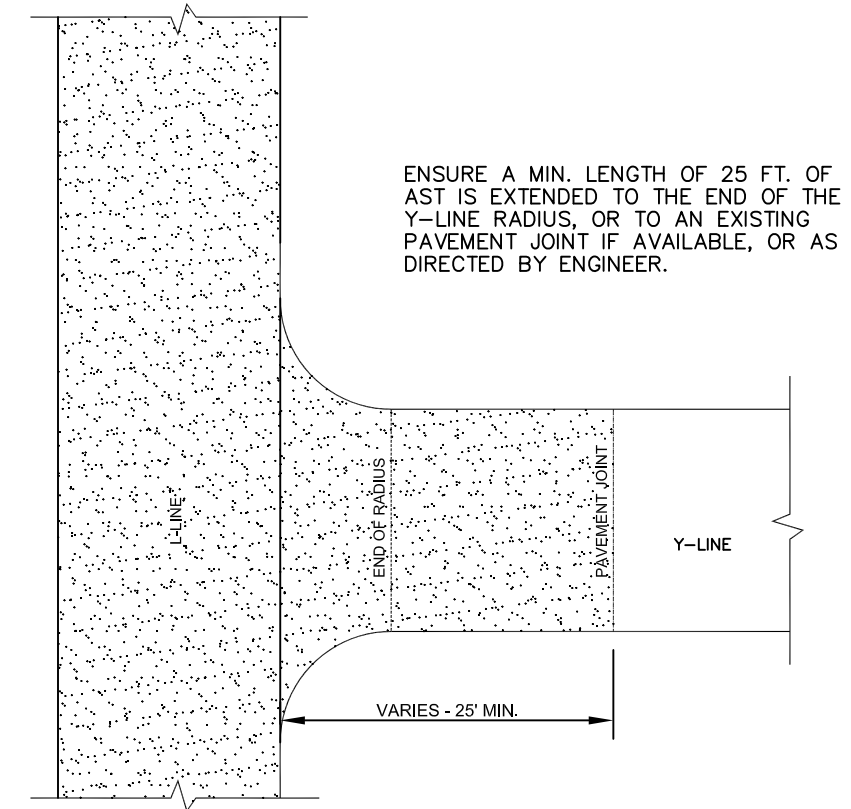

DETAIL 1
Y-LINE INTERSECTION TREATMENT

SIGNING FOR ASPHALT SURFACE TREATMENT

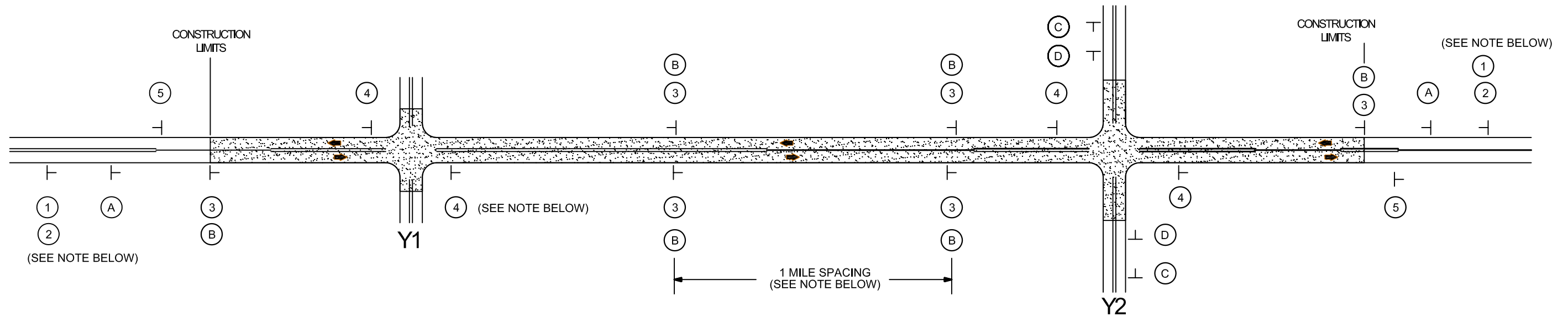

MAINLINE (-L-) SIGNING

-Y- LINE SIGNING

SIGNING NOTES AND PLACEMENT PER DIRECTION	 	<p>PLACE 1000' PRIOR TO BEGINNING OF CONSTRUCTION LIMITS.</p> <p>#2 SIGN ONLY USED WHEN RESURFACING LIMITS ARE 2 OR MORE MILES IN LENGTH. ROUND UP TO NEXT WHOLE NUMBER. (NO FRACTIONAL OR DECIMAL NUMBERS)</p>
	 	<p>ALTERNATE THE FOLLOWING TWO SIGNS: STARTING WITH "LOOSE GRAVEL" (W8-7) FOLLOWED BY "UNMARKED PAVEMENT".</p> <p>PLACE INITIALLY AT THE CONSTRUCTION LIMITS AND SPACED 1 MILE APART THEREAFTER. IF NO -Y- LINES EXIST, PLACE 2ND SET 1/2 MILE FROM THE CONSTRUCTION LIMITS AND THEN SPACE 1 MILE THEREAFTER.</p>
		<p>PLACE 500' PRIOR TO BEGINNING OF CONSTRUCTION LIMITS.</p>
	 	<p>PLACE INITIALLY AT THE CONSTRUCTION LIMITS AND SPACED 1 MILE APART THEREAFTER. IF NO -Y- LINES EXIST, PLACE 2ND SET 1/2 MILE FROM THE CONSTRUCTION LIMITS AND THEN SPACE 1 MILE THEREAFTER. SPEED LIMIT SIGN MAY BE PLACED ON SAME PART AS LOOSE GRAVEL SIGN, IF DESIRED. IF SO, ELIMINATE WORK ZONE SIGN (G20-5aP).</p>
		<p>THESE ARE FOR -Y- LINES THAT ARE "THROUGH" ROADWAYS. DEAD END AND SUBDIVISION ROADS ARE NOT "THROUGH" ROADWAYS. INSTALL 500' +/- FROM EACH -Y- LINE APPROACH AS SHOWN ABOVE. FOR MULTIPLE -Y- LINES THAT ARE SEPARATED BY 0.25 MILES OR LESS, TREAT AS A SINGLE UNIT AND INSTALL WITHIN 500' OF EACH APPROACH. A MAXIMUM OF 2 SIGN SETS PER MILE. DO NOT INSTALL WHEN -Y- LINES ARE WITHIN 0.5 MILES FROM "END ROAD WORK" SIGN.</p>
		<p>PLACE 500' FOLLOWING THE END OF CONSTRUCTION LIMITS.</p>

ADVANCE WARNING PORTABLE SIGNS MAY BE USED IN LIEU OF STATIONARY SIGNS ALONG THE -Y- LINE AS SHOWN BELOW. REMOVE UPON COMPLETION OF WORK EACH DAY. UNDER NO CIRCUMSTANCES SHALL PORTABLE SIGNS BE LEFT IN PLACE WHEN NO CONSTRUCTION ACTIVITY IS OCCURRING, OR WHEN CONTRACTOR IS NOT ON SITE.

PLACED 500' IN ADVANCE OF FLAGGER.

PLACED 250' IN ADVANCE OF FLAGGER.

NO REQUIRED STATIONARY SIGNING FOR THE FOLLOWING -Y- LINE CONDITIONS:

- 1 SUBDIVISION ROADS
- 2 DEAD END ROADS

LEGEND

└ STATIONARY SIGN

➔ DIRECTION OF TRAFFIC FLOW

NOTE:
IT IS THE CONTRACTOR'S RESPONSIBILITY TO ENSURE THE PROPER PLACEMENT AND LOCATION OF WORK ZONE SIGNING PER THE STANDARD DRAWING. NCDOT HAS THE RIGHT TO INSPECT THE PLANNED LOCATIONS AND REQUIRE ADJUSTMENT BY THE CONTRACTOR, AS NEEDED, OR AS DIRECTED BY THE ENGINEER.

ADVANCE WARNING SIGNS
FOR
ASPHALT SURFACE
TREATMENTS

OR OTHER ENGINEER APPROVED METHOD

Schedule of Quantities

Date: 12/12/2016
 Contract #: DF00148
 WBS: Double Seals - 2017CPT.06.07.20242.1
 Triple Seals - 2017CPT.06.07.20242.2

Division : 6
 County: Columbus
 Description: AST - Split & Triple Seals

Map	SR	From	Begin MP	To	End MP	CL Length (Mile)	Width (Ft.)	Quantity (SY)	Treatment	WZ Signs (SF)	Emulsion (GAL)
1	SR 1004	NC 904	0.000	SR 1415	6.580	6.580	23	88,786	Double	1,053	54,159
2	SR 1004	SR 1410	8.560	SR 1300	10.570	2.010	23	27,122	Double	322	16,544
3	SR 1304	NC 904	0.000	C&G	2.890	2.890	18	30,518	Double	462	18616
4	SR 1306	SR 1300	0.000	SR 1304	0.370	0.370	20	4,341	Double	59	2648
5	SR 1311	SR 1300	0.000	END SECT	0.580	0.580	20	6,805	Double	93	4151
6	SR 1314	PVMT CHG	7.464	SR1346	9.089	1.625	20	19,067	Double	260	11631
7	SR 1314	SR 1346	9.089	SR 1348	10.769	1.680	18	17,741	Double	269	10822
8	SR 1314	SR 1348	10.769	NC 904	11.434	0.665	18	7,022	Double	106	4283
9	SR 1341	SR 1004	0.000	SR 1342	0.920	0.920	20	10,795	Double	147	6,585
10	SR 1342	SR 1004	0.000	SR 1004	2.000	2.000	20	23,467	Double	320	14,315
11	SR 1346	NC 904	0.215	SR 1314	1.265	1.050	18	11,088	Double	168	6764
12	SR 1348	SR 1314	0.000	SR 1350	0.900	0.900	20	10,560	Double	144	6442
13	SR 1350	SR 1352	0.000	SR 1352	2.760	2.760	20	32,384	Double	442	19,754
14	SR 1351	NC 904	0.000	SC LINE	1.740	1.740	20	20,416	Double	278	12,454
15	SR 1353	SR 1352	0.000	SR 1356	2.930	2.930	20	34,379	Double	469	20,971
16	SR 1354	NC 904	0.000	SR 1353	0.910	0.910	20	10,677	Double	146	6,513
17	SR 1355	SR 1379	0.000	SC LINE	2.128	2.128	20	24,969	Double	340	15231
18	SR 1356	NC 904	0.000	SR 1004	2.630	2.630	20	30,859	Double	421	18,824
19	SR 1357	SR 1356	0.000	NC 904	2.050	2.050	20	24,053	Double	328	14,672
20	SR 1359	SR 1004	0.000	SR 1356	1.560	1.560	20	18,304	Double	250	11,165
21	SR 1360	PVMT CHG	1.560	US 76	1.834	0.274	20	3,215	Double	44	1961
22	SR 1366	NC 904	0.000	SR 1314	1.160	1.160	20	13,611	Double	186	8303
23	SR 1374	US 76	0.000	DEAD END	0.200	0.200	20	2,347	Double	32	1432
24	SR 1376	NC 904	0.000	NC 904	0.740	0.740	20	8,683	Double	118	5297
25	SR 1377	NC 904	0.000	END MAINT	0.260	0.260	22	3,356	Double	42	2047
26	SR 1380	SC LINE	0.000	SR 1379	1.629	1.629	20	19,114	Double	261	11660
27	SR 1415	SR 1412	3.800	SR 1352	4.846	1.046	18	11,046	Double	167	6,738
SUBTOTALS - DOUBLE SEALS:						43.287		514,725		6,927	313,982
28	SR 1346	SC LINE	0.000	NC 904	0.215	0.215	20	2,523	Triple	34	2245
29	SR 1360	SC LINE	0.000	PVMT CHG	1.560	1.560	18	16,474	Triple	250	14662
30	SR 1379	SC LINE	0.000	NC 904	2.012	2.012	20	23,607	Triple	322	21010
SUBTOTALS - TRIPLE SEALS:						3.787		42,604		606	37,917
TOTALS:						47.074		557,329		7,533	351,899