

STATE OF NORTH CAROLINA
DEPARTMENT OF TRANSPORTATION
HIGHWAY DIVISION 6

PLANS
February 6, 2017

CONTRACT ID: DF00152

WBS ELEMENT NO.: 2017CPT.06.08.20262.1

FEDERAL AID NO.: STATE FUNDED

COUNTY: CUMBERLAND

TIP NO.: -----

LENGTH OF PROJECT: 51.59 MILES

ROUTE NO.: VARIOUS SECONDARY ROUTES

TYPE OF WORK: ASPHALT SURFACE TREATMENT – DOUBLE SEALS

Cumberland County Seal Treatments WBS - 2017CPT.06.08.20262.1 Contract DF00152

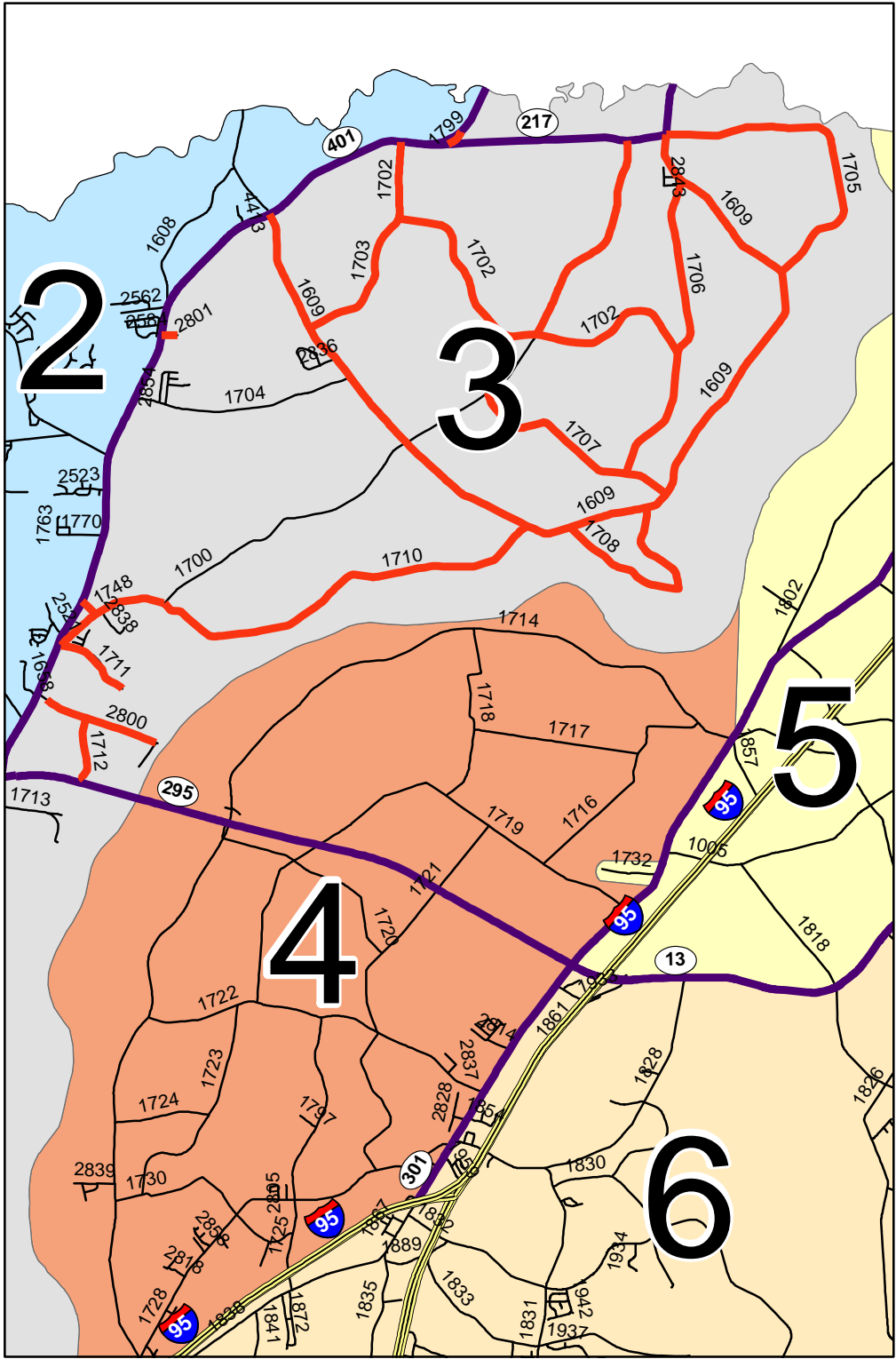

Map	SR	From	Begin MP	To	End MP	CL Length (Mile)	Width (Ft.)	Quantity (SY)	Treatment	WZ Signs (SF)	Emulsion (GAL)
1	SR 1242	Dead End	0.067	Cul De Sac	1.364	1.297	18	13,696	Double	208	8,355
2	SR 1242	SR 1344	1.4	Cul De Sac	1.662	0.262	22	3,382	Double	42	2,063
3	SR 1609	US 401	1.275	SR 1710	5.849	4.574	20	53,668	Double	732	32,737
4	SR 1609	SR 1710	5.849	NC 217	12.349	6.500	18	68,640	Double	1,040	41,870
5	SR 1700	NC 217	5.140	SR 1702	7.580	2.440	22	31,492	Double	390	19,210
6	SR 1702	SR 1706	0.000	SR 1700	5.020	5.020	20	58,901	Double	803	35,930
7	SR 1703	SR 1702	0.000	SR 1609	1.660	1.660	20	19,477	Double	266	11,881
8	SR 1705	NC 217	0.000	SR 1609	3.628	3.628	20	42,569	Double	580	25,967
9	SR 1706	SR 1609	0.000	SR 1707	3.440	3.440	20	40,363	Double	550	24,621
10	SR 1707	SR 1609	0.000	SR 1706	2.416	2.416	24	34,017	Double	387	20,750
11	SR 1708	SR 1609	0.000	SR 1609	2.480	2.480	20	29,099	Double	397	17,750
12	SR 1710	SR 1609	0.000	SR 1700	4.450	4.450	18	46,992	Double	712	28,665
13	SR 1710	SR 1700	4.450	US 401	5.750	1.300	22	16,779	Double	208	10,235
14	SR 1711	SR 1710	0.040	Dead End	0.890	0.540	20	6,336	Double	86	3,865
15	SR 1712	End 34' PVT	0.120	End Maintenance	1.299	1.179	20	13,834	Double	189	8,439
16	SR 1748	US 401	0.000	SR 1710	0.200	0.200	20	2,347	Double	32	1,432
17	SR 1799	US 401	0.000	NC 217	0.210	0.210	20	2,464	Double	34	1,503
18	SR 2280	I-95BUS-LP	0	End Maintenance	0.44	0.44	20	5,163	Double	70	3,149
19	SR 2285	US 301	0	NC 59	1.02	1.02	20	11,968	Double	163	7,300
20	SR 2331	US 301	0	Dead End	0.28	0.28	20	3,285	Double	45	2,004
21	SR 2335	SR 2337	0	Dead End	0.1	0.1	20	1,173	Double	16	716
22	SR 2336	SR 2337	0	Dead End	0.15	0.15	20	1,760	Double	24	1,074
23	SR 2337	SR 2205	5.078	Dead End	5.258	0.18	20	2,112	Double	29	1,288
24	SR 2342	SR 2219	0	Dead End	0.09	0.09	20	1,056	Double	14	644
25	SR 2354	US 301	0	SR 1007	0.207	0.207	24	2,915	Double	33	1,778
26	SR 2355	SR 1007	0	Dead End	1.19	1.19	20	13,963	Double	190	8,517
27	SR 2593	SR 1007	0	Dead End	0.769	0.769	20	9,023	Double	123	5,504
28	SR 2800	SR 1712	0.000	SR 2847	0.808	0.808	20	9,481	Double	129	5,783
29	SR 2801	US 401	0.000	Dead End	0.180	0.180	20	2,112	Double	29	1,288
30	SR 3952	SR 2354	0	Dead End	1.32	1.32	25	19,360	Double	211	11,810
TOTALS:						48.330		567,427		7,732	346,128

Legend

- Proposed Seal Treatments
- == Interstate
- Primary
- Secondary

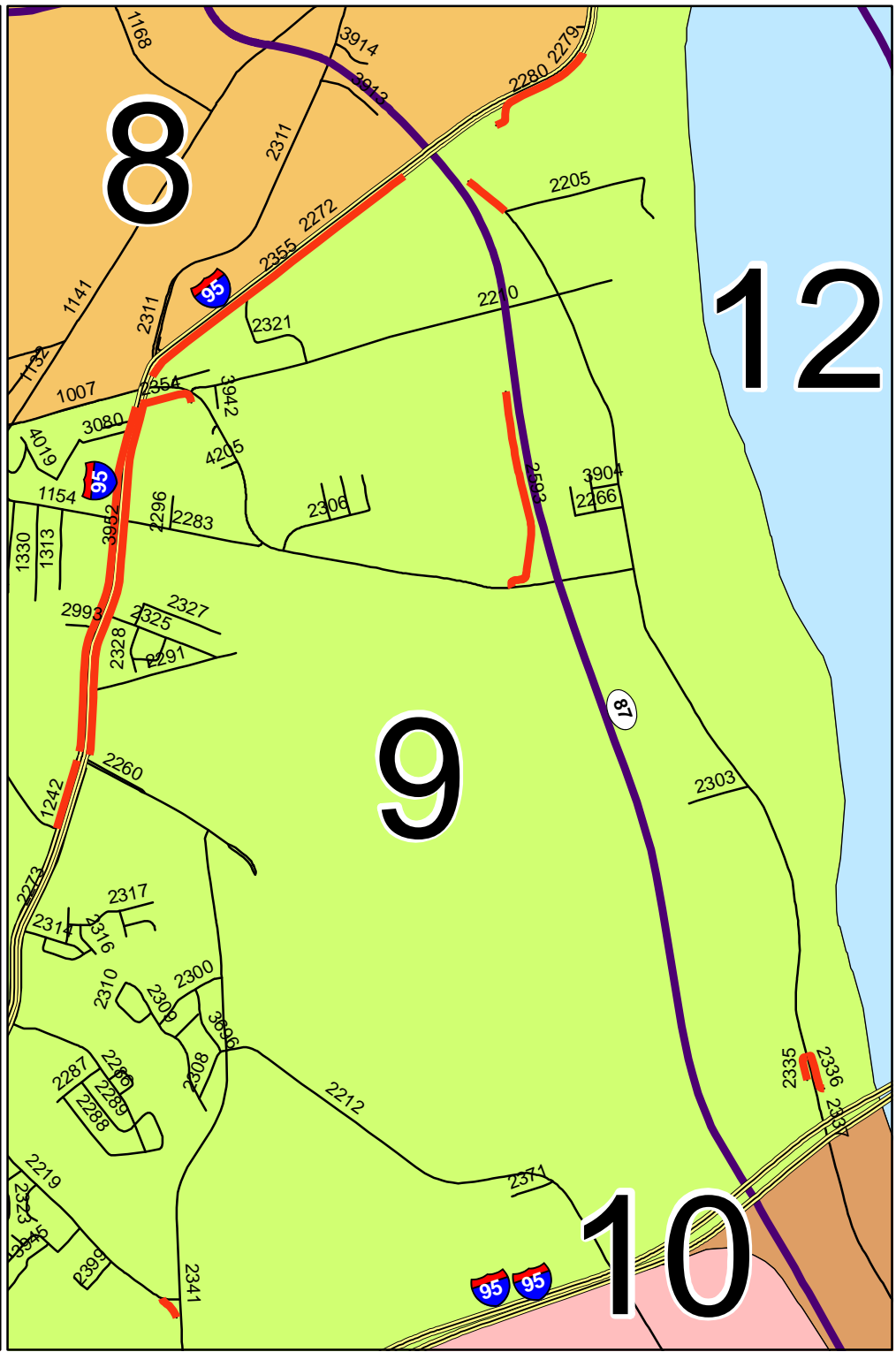
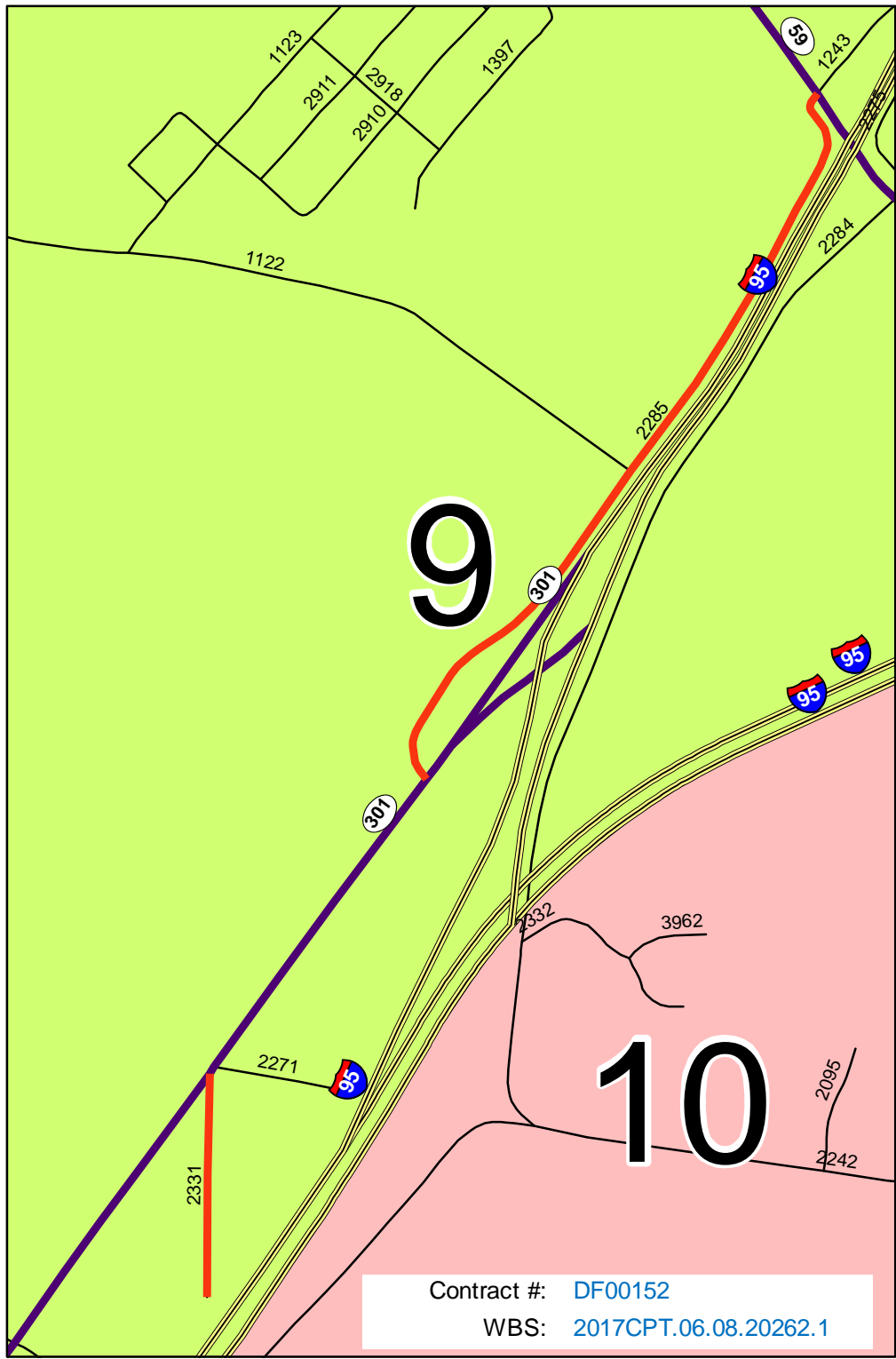

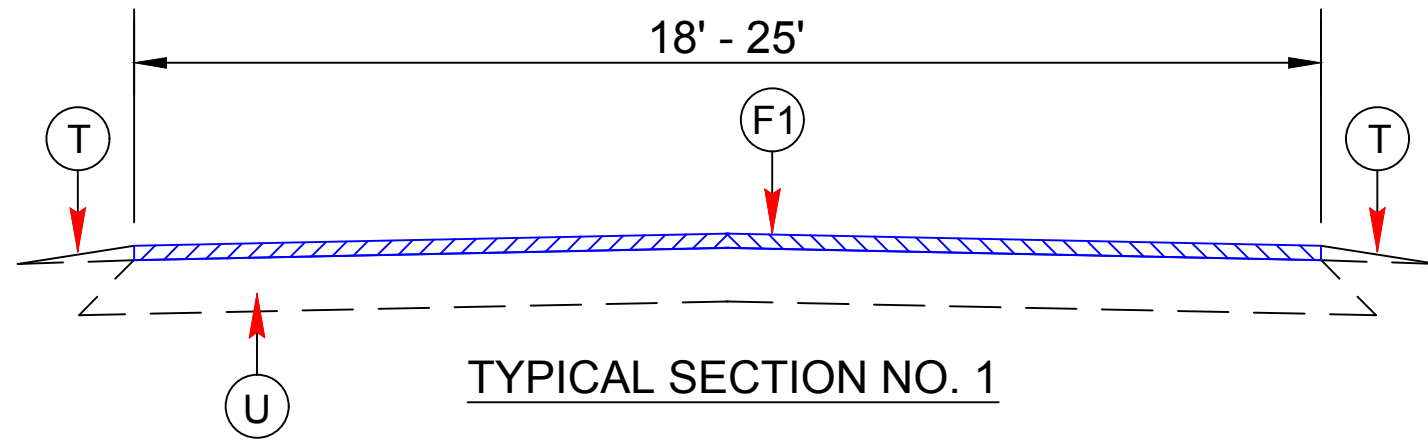

PAVEMENT SCHEDULE	
F1	DOUBLE SEAL PLACED ACCORDING TO THE SPECIAL PROVISIONS
T	EXISTING SHOULDER
U	EXISTING ASPHALT

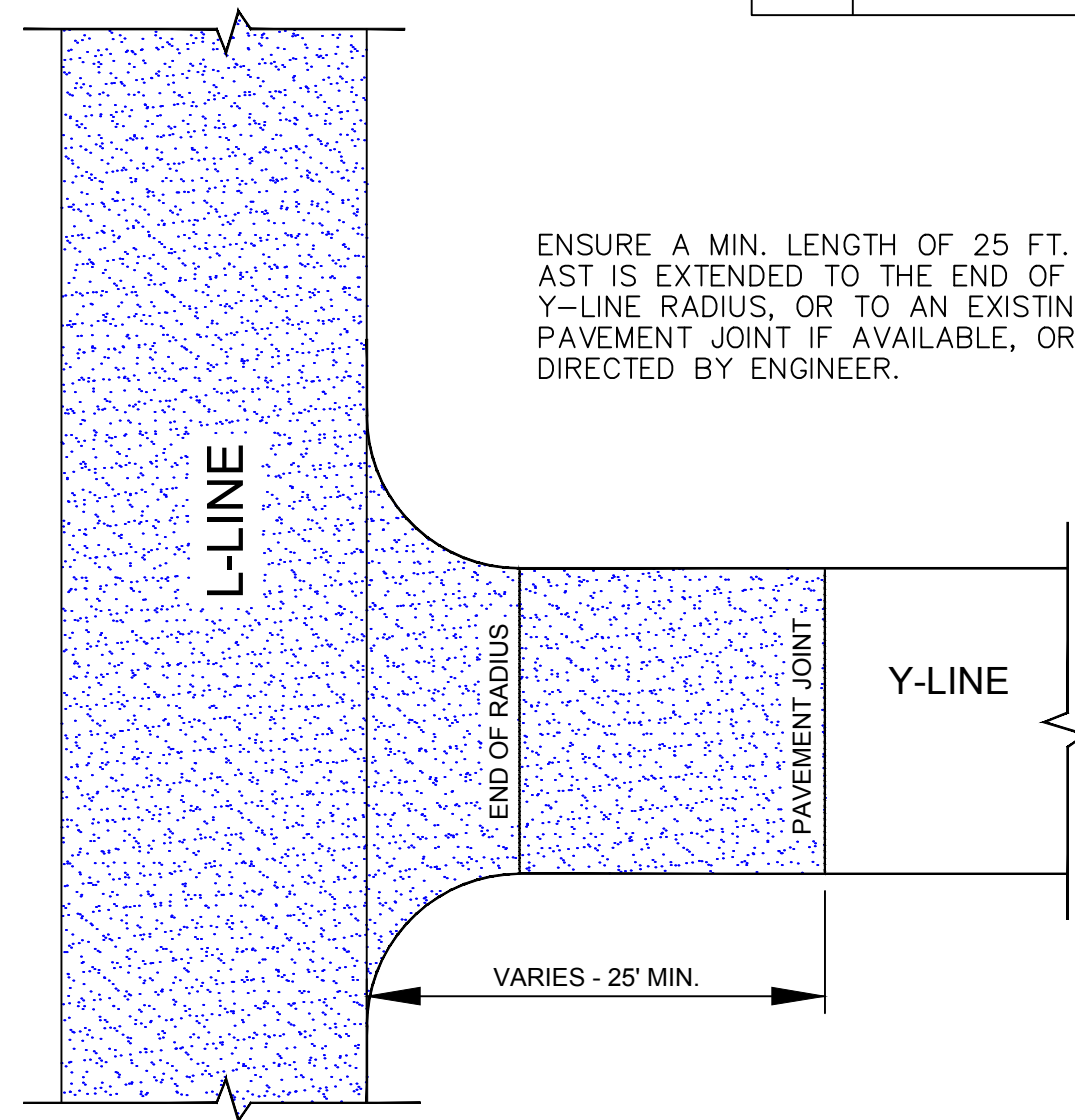

ENSURE A MIN. LENGTH OF 25 FT. OF AST IS EXTENDED TO THE END OF THE Y-LINE RADIUS, OR TO AN EXISTING PAVEMENT JOINT IF AVAILABLE, OR AS DIRECTED BY ENGINEER.

DETAIL 1
Y-LINE INTERSECTION TREATMENT

SIGNING FOR ASPHALT SURFACE TREATMENT

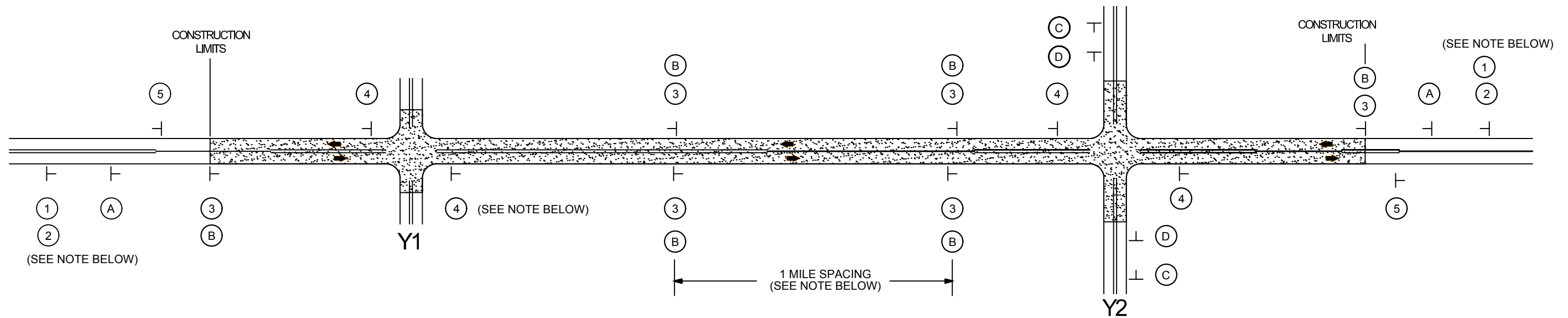

MAINLINE (-L-) SIGNING

-Y- LINE SIGNING

SIGNING NOTES AND PLACEMENT PER DIRECTION	 	<p>PLACE 1000' PRIOR TO BEGINNING OF CONSTRUCTION LIMITS.</p> <p>#2 SIGN ONLY USED WHEN RESURFACING LIMITS ARE 2 OR MORE MILES IN LENGTH. ROUND UP TO NEXT WHOLE NUMBER. (NO FRACTIONAL OR DECIMAL NUMBERS)</p>
	 	<p>ALTERNATE THE FOLLOWING TWO SIGNS: STARTING WITH "LOOSE GRAVEL" (W8-7) FOLLOWED BY "UNMARKED PAVEMENT".</p> <p>PLACE INITIALLY AT THE CONSTRUCTION LIMITS AND SPACED 1 MILE APART THEREAFTER. IF NO -Y- LINES EXIST, PLACE 2ND SET 1/2 MILE FROM THE CONSTRUCTION LIMITS AND THEN SPACE 1 MILE THEREAFTER.</p>
		<p>PLACE 500' PRIOR TO BEGINNING OF CONSTRUCTION LIMITS.</p>
		<p>PLACE INITIALLY AT THE CONSTRUCTION LIMITS AND SPACED 1 MILE APART THEREAFTER. IF NO -Y- LINES EXIST, PLACE 2ND SET 1/2 MILE FROM THE CONSTRUCTION LIMITS AND THEN SPACE 1 MILE THEREAFTER. SPEED LIMIT SIGN MAY BE PLACED ON SAME PART AS LOOSE GRAVEL SIGN, IF DESIRED. IF SO, ELIMINATE WORK ZONE SIGN (G20-5aP).</p>
		<p>THESE ARE FOR -Y- LINES THAT ARE "THROUGH" ROADWAYS. DEAD END AND SUBDIVISION ROADS ARE NOT "THROUGH" ROADWAYS. INSTALL 500' +/- FROM EACH -Y- LINE APPROACH AS SHOWN ABOVE. FOR MULTIPLE -Y- LINES THAT ARE SEPARATED BY 0.25 MILES OR LESS, TREAT AS A SINGLE UNIT AND INSTALL WITHIN 500' OF EACH APPROACH. A MAXIMUM OF 2 SIGN SETS PER MILE. DO NOT INSTALL WHEN -Y- LINES ARE WITHIN 0.5 MILES FROM "END ROAD WORK" SIGN.</p>
		<p>PLACE 500' FOLLOWING THE END OF CONSTRUCTION LIMITS.</p>

ADVANCE WARNING PORTABLE SIGNS MAY BE USED IN LIEU OF STATIONARY SIGNS ALONG THE -Y- LINE AS SHOWN BELOW. REMOVE UPON COMPLETION OF WORK EACH DAY. UNDER NO CIRCUMSTANCES SHALL PORTABLE SIGNS BE LEFT IN PLACE WHEN NO CONSTRUCTION ACTIVITY IS OCCURRING, OR WHEN CONTRACTOR IS NOT ON SITE.

PLACED 500' IN ADVANCE OF FLAGGER.

PLACED 250' IN ADVANCE OF FLAGGER.

NO REQUIRED STATIONARY SIGNING FOR THE FOLLOWING -Y- LINE CONDITIONS:

- 1 SUBDIVISION ROADS
- 2 DEAD END ROADS

LEGEND

└ STATIONARY SIGN

➔ DIRECTION OF TRAFFIC FLOW

NOTE:
IT IS THE CONTRACTOR'S RESPONSIBILITY TO ENSURE THE PROPER PLACEMENT AND LOCATION OF WORK ZONE SIGNING PER THE STANDARD DRAWING. NCDOT HAS THE RIGHT TO INSPECT THE PLANNED LOCATIONS AND REQUIRE ADJUSTMENT BY THE CONTRACTOR, AS NEEDED, OR AS DIRECTED BY THE ENGINEER.

ADVANCE WARNING SIGNS
FOR
ASPHALT SURFACE
TREATMENTS

OR OTHER ENGINEER APPROVED METHOD

Schedule of Quantities

Date: 2/1/2017
 Contract #: DF00152
 WBS: 2017CPT.06.08.20262.1

Division : 6
 County: Cumberland
 Description: AST - Double Seals

Map	SR	From	Begin MP	To	End MP	CL Length (Mile)	Width (Ft.)	Quantity (SY)	Treatment	WZ Signs (SF)	Emulsion (GAL)
1	SR 1242	Dead End	0.067	Cul De Sac	1.364	1.297	18	13,696	Double	208	8,355
2	SR 1242	SR 1344	1.4	Cul De Sac	1.662	0.262	22	3,382	Double	42	2,063
3	SR 1609	US 401	1.275	SR 1710	5.849	4.574	20	53,668	Double	732	32,737
4	SR 1609	SR 1710	5.849	NC 217	12.349	6.500	18	68,640	Double	1,040	41,870
5	SR 1700	NC 217	5.140	SR 1702	7.580	2.440	22	31,492	Double	390	19,210
6	SR 1700	SR 1609	0.000	NC 217	3.260	3.260	22	42,076	Double	522	25,666
7	SR 1702	SR 1706	0.000	SR 1700	5.020	5.020	20	58,901	Double	803	35,930
8	SR 1703	SR 1702	0.000	SR 1609	1.660	1.660	20	19,477	Double	266	11,881
9	SR 1705	NC 217	0.000	SR 1609	3.628	3.628	20	42,569	Double	580	25,967
10	SR 1706	SR 1609	0.000	SR 1707	3.440	3.440	20	40,363	Double	550	24,621
11	SR 1707	SR 1609	0.000	SR 1706	2.416	2.416	24	34,017	Double	387	20,750
12	SR 1708	SR 1609	0.000	SR 1609	2.480	2.480	20	29,099	Double	397	17,750
13	SR 1710	SR 1609	0.000	SR 1700	4.450	4.450	18	46,992	Double	712	28,665
14	SR 1710	SR 1700	4.450	US 401	5.750	1.300	22	16,779	Double	208	10,235
15	SR 1711	SR 1710	0.040	Dead End	0.890	0.540	20	6,336	Double	86	3,865
16	SR 1712	End 34' PVT	0.120	End Maintenance	1.299	1.179	20	13,834	Double	189	8,439
17	SR 1748	US 401	0.000	SR 1710	0.200	0.200	20	2,347	Double	32	1,432
18	SR 1799	US 401	0.000	NC 217	0.210	0.210	20	2,464	Double	34	1,503
19	SR 2280	I-95BUS-LP	0	End Maintenance	0.44	0.44	20	5,163	Double	70	3,149
20	SR 2285	US 301	0	NC 59	1.02	1.02	20	11,968	Double	163	7,300
21	SR 2331	US 301	0	Dead End	0.28	0.28	20	3,285	Double	45	2,004
22	SR 2335	SR 2337	0	Dead End	0.1	0.1	20	1,173	Double	16	716
23	SR 2336	SR 2337	0	Dead End	0.15	0.15	20	1,760	Double	24	1,074
24	SR 2337	SR 2205	5.078	Dead End	5.258	0.18	20	2,112	Double	29	1,288
25	SR 2342	SR 2219	0	Dead End	0.09	0.09	20	1,056	Double	14	644
26	SR 2354	US 301	0	SR 1007	0.207	0.207	24	2,915	Double	33	1,778
27	SR 2355	SR 1007	0	Dead End	1.19	1.19	20	13,963	Double	190	8,517
28	SR 2593	SR 1007	0	Dead End	0.769	0.769	20	9,023	Double	123	5,504
29	SR 2800	SR 1712	0.000	SR 2847	0.808	0.808	20	9,481	Double	129	5,783
30	SR 2801	US 401	0.000	Dead End	0.180	0.180	20	2,112	Double	29	1,288
31	SR 3952	SR 2354	0	Dead End	1.32	1.32	25	19,360	Double	211	11,810
TOTALS:						51.590		609,503		8,254	371,794