

STATE OF NORTH CAROLINA  
DEPARTMENT OF TRANSPORTATION  
HIGHWAY DIVISION 6

# PLANS

**Letting Date: October 2, 2024**

**REVISED 9-30-2024**

**CONTRACT ID: DF00495**

**TIP NO.: -----**

**FEDERAL AID NO.: STATE FUNDED**

**WBS ELEMENT NO.: 2025CPT.06.07.10261.1 & 2025CPT.06.07.20261.1**

**ROUTE NO.: VARIES**

**LOCATION: VARIES**

**COUNTY: CUMBERLAND**

**LENGTH OF PROJECT: 12.04 MILES**

**TYPE OF WORK: WIDENING, RESURFACING, MILLING & PAVEMENT MARKINGS**

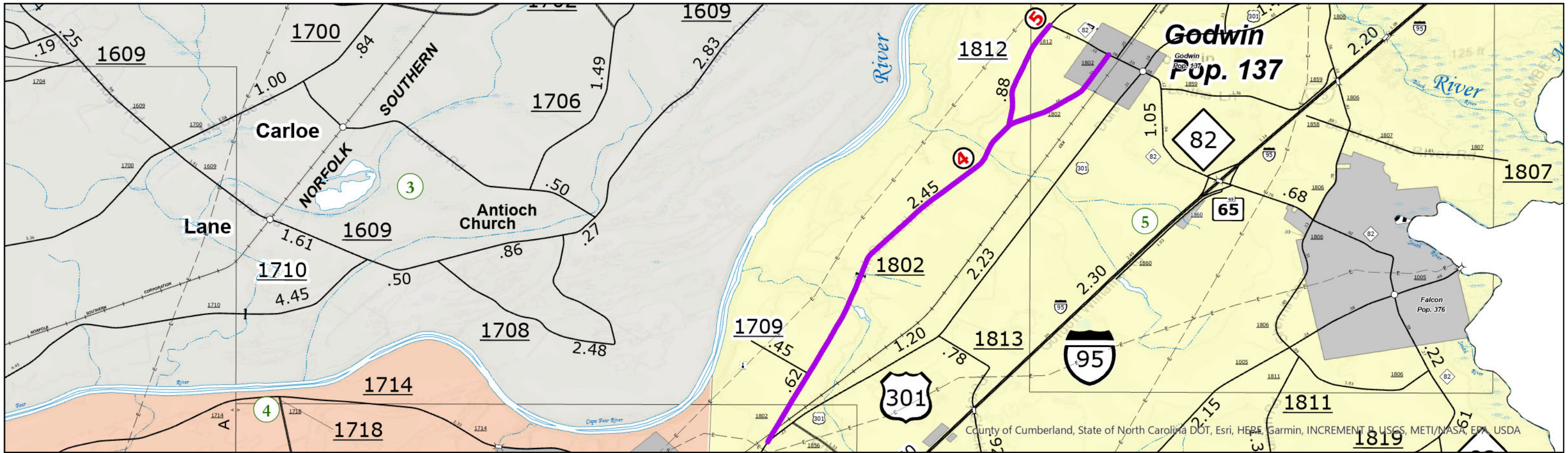

# Cumberland County Resurfacing, 2024

Contract: DF00495

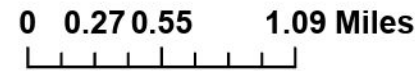

Legend

- WBS: 2025CPT.06.07.10261.1
- WBS: 2025CPT.06.07.20261.1

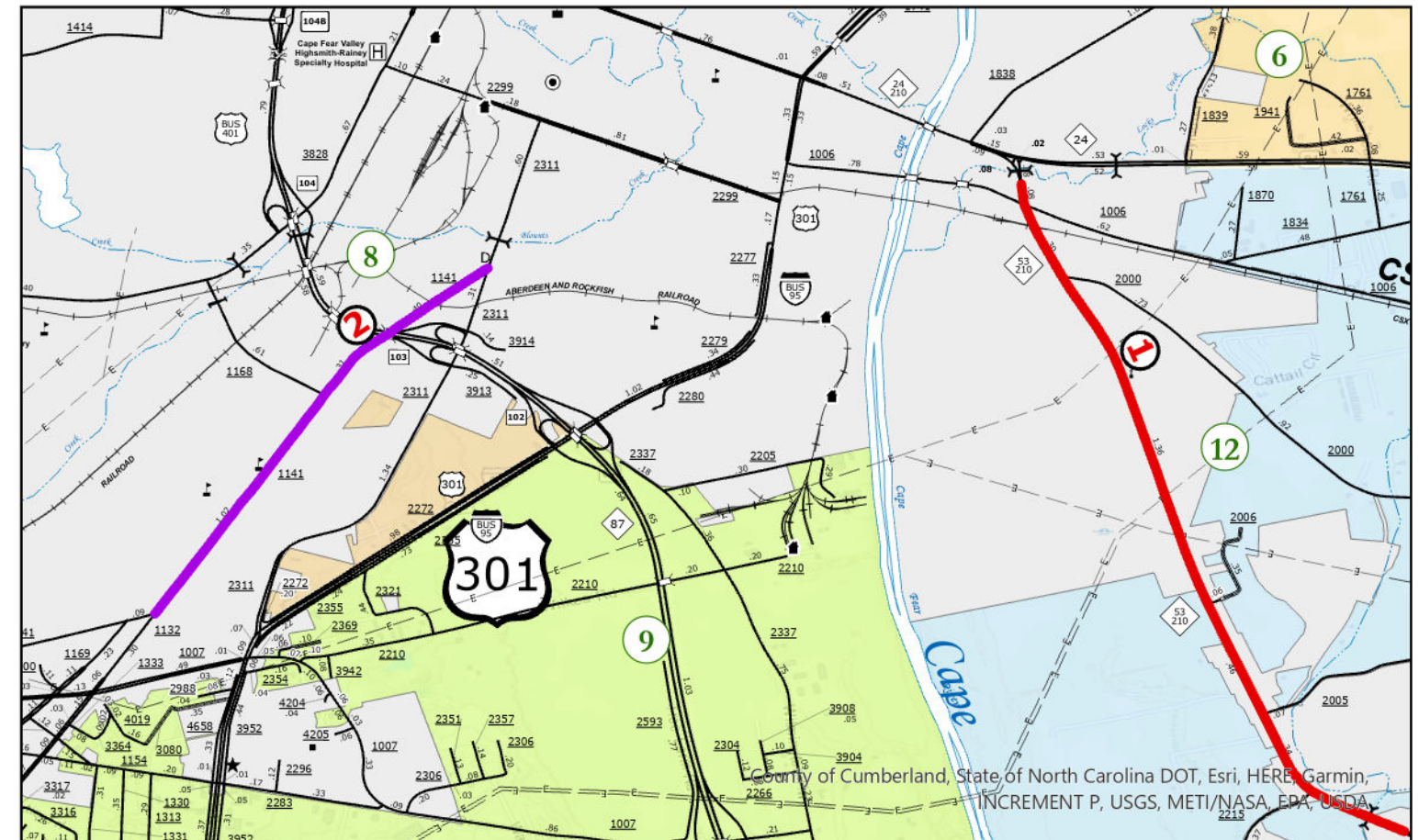
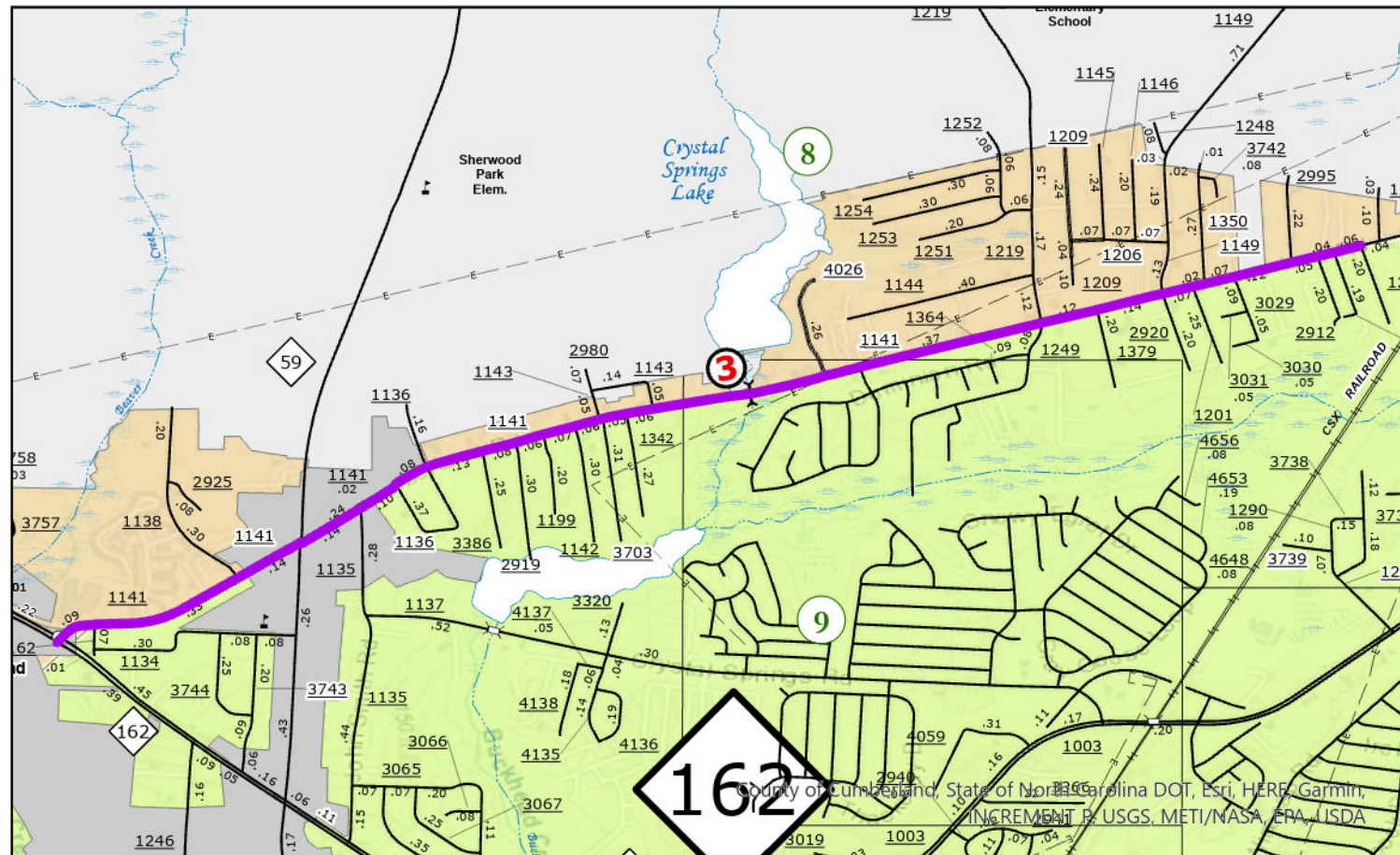

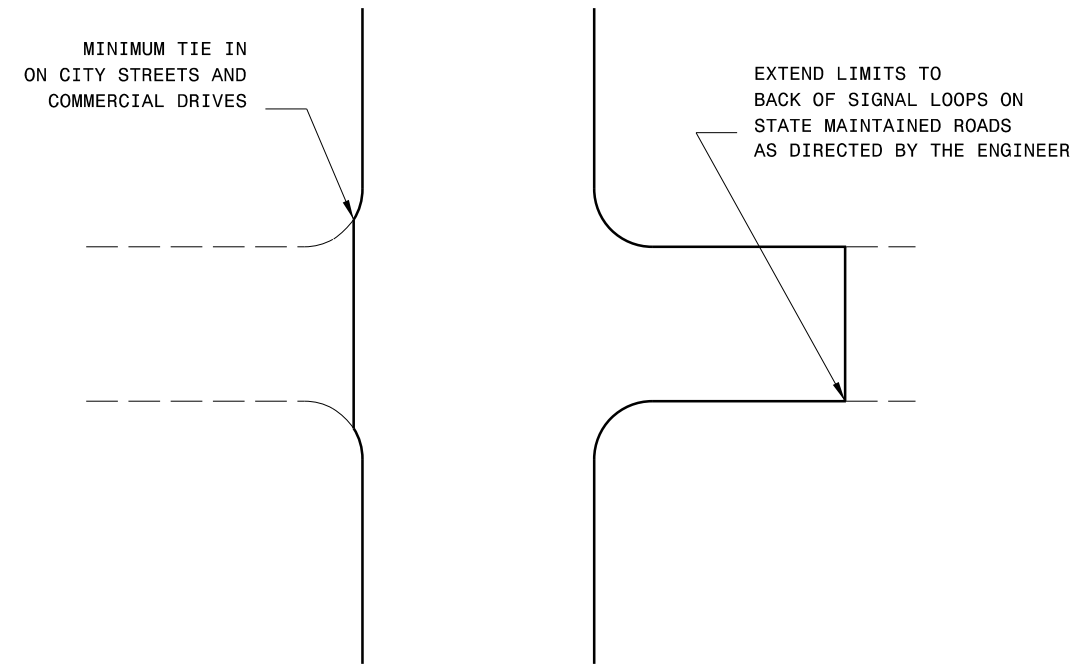

TYPICAL DETAIL OF PROJECT LIMITS AT SIGNALIZED Y LINES

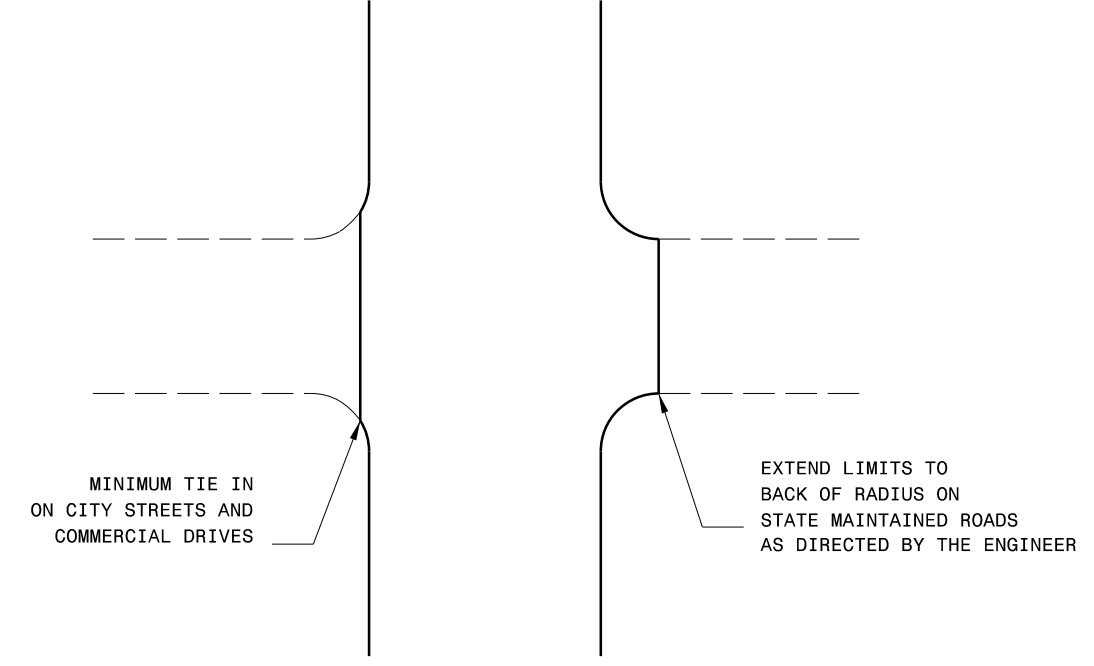

TYPICAL DETAIL OF PROJECT LIMITS AT UNSIGNALIZED Y LINES

ADDITIONAL INTERSECTIONS (NON-TYPICAL)

Extend paving limits to back of radius or loop on the following intersections:

MAP#	STREET NAME	COMMENTS
1	NC 53 RT Sapona Rd	81 Ft from EP of L-Line 1089 SY
1	NC 53 RT Peteland Dr	61 Ft from EP of L-Line 5070.32 SY
1	NC 53 RT La Dunham Rd	55 Ft from EP of L-Line 441.95 SY
1	NC 53 LT Fields Rd	72 Ft from EP of L-Line 709.76 SY
1	NC 53 LT Clinton Rd	80 Ft from EP of L-Line 924.44 SY
1	NC 53 RT Clinton Rd	102 Ft from EP of L-Line 1847.33 SY
2	SR 1141 LT Whitefield St	39 Ft from EP of L-Line 358.62 SY
3	SR 1141 RT Owen Dr	145 Ft from EP of L-Line 3641 SY
3	SR 1141 LT Owen Dr	114 Ft from EP of L-Line 2368 SY
3	SR 1141 LT Bolton St	106 Ft from EP of L-Line 588.88 SY
3	SR 1141 LT Yale St	73 Ft from EP of L-Line 567.77 SY
3	SR 1141 LT Lawndale St	69 Ft from EP of L-Line 629.12 SY
3	SR 1141 LT Mayfair St	52 Ft from EP of L-Line 386.41 SY
3	SR 1141 LT Sharon St	100 Ft from EP of L-Line 833.33 SY
3	SR 1141 LT Hopedale St	46 Ft from EP of L-Line 371.47 SY
3	SR 1141 LT Kim St	65 Ft from EP of L-Line 538.92 SY

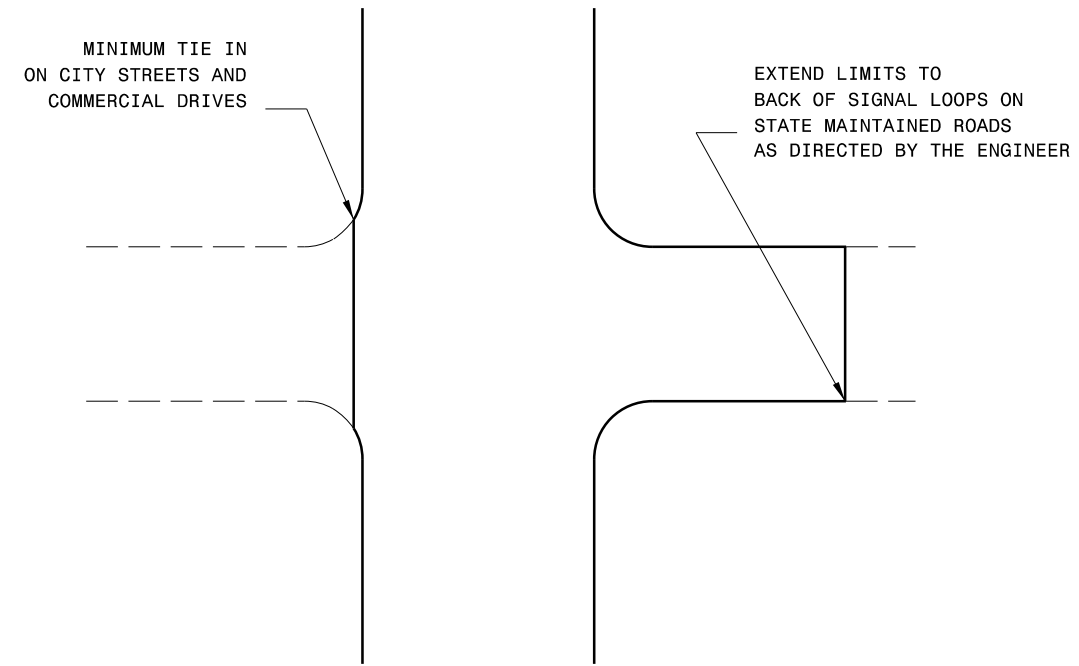

TYPICAL DETAIL OF PROJECT LIMITS AT SIGNALIZED Y LINES

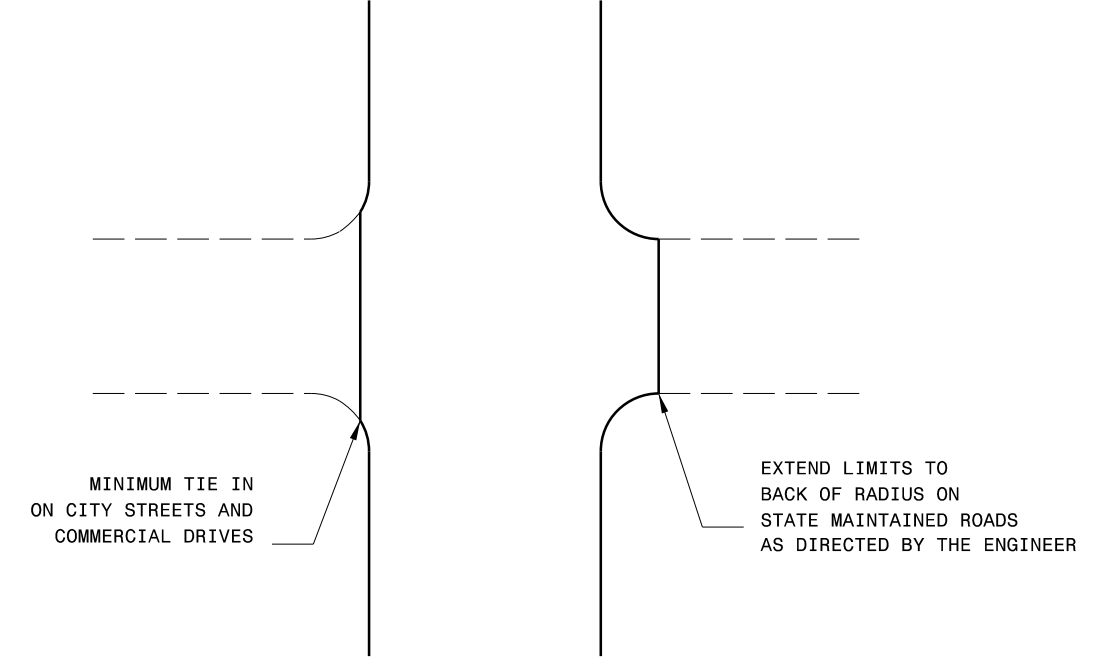

TYPICAL DETAIL OF PROJECT LIMITS AT UNSIGNALIZED Y LINES

ADDITIONAL INTERSECTIONS (NON-TYPICAL)		
Extend paving limits to back of radius or loop on the following intersections:		
MAP#	STREET NAME	COMMENTS
3	SR 1141 LT Carbine St	108 Ft from EP of L-Line 888 SY
3	SR 1141 RT Belhaven Rd	104 Ft from EP of L-Line 912.88 SY
3	SR 1141 RT Upchurch Dr	62 Ft from EP of L-Line 392.66 SY
3	SR 1141 LT Boone Trail	74 Ft from EP of L-Line 822.22 SY
3	SR 1141 RT Everitte St	97 Ft from EP of L-Line 808.33 SY
3	SR 1141 LT Ireland Dr	66 Ft from EP of L-Line 689.33 SY
3	SR 1141 RT Pine Springs Dr	76 Ft from EP of L-Line 1004.88 SY
3	SR 1141 RT Dumbarton Rd	139 Ft from EP of L-Line 1822.44 SY
3	SR 1141 LT Wavetree Dr	44 Ft from EP of L-Line 352 SY
3	SR 1141 LT Ake St	115 Ft from EP of L-Line 817.77 SY
3	SR 1141 LT Nobie St	115 Ft from EP of L-Line 817.77 SY
3	SR 1141 LT Stone Haven Dr	102 Ft from EP of L-Line 804.66 SY
3	SR 1141 LT Smith Rd	114 Ft from EP of L-Line 912 SY
3	SR 1141 RT Crystal Springs Dr	78 Ft from EP of L-Line 559.34 SY
3	SR 1141 RT Hope Mills Rd	90 Ft from EP of L-Line 1570 SY
3	SR 1141 LT Hope Mills Rd	92 Ft from EP of L-Line 1686 SY

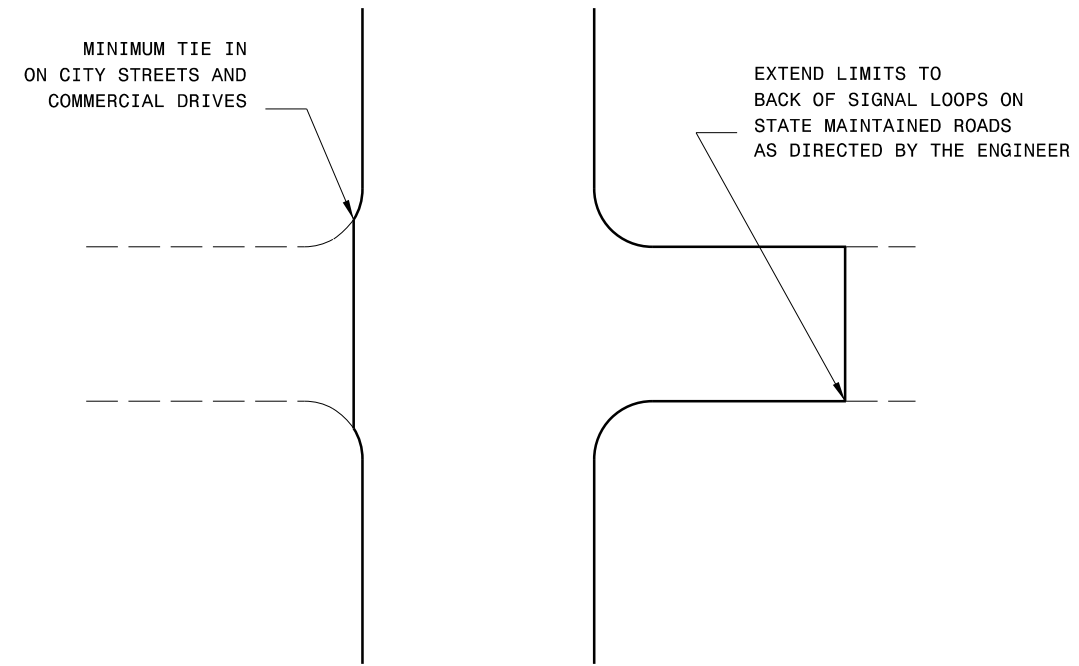

TYPICAL DETAIL OF PROJECT LIMITS AT SIGNALIZED Y LINES

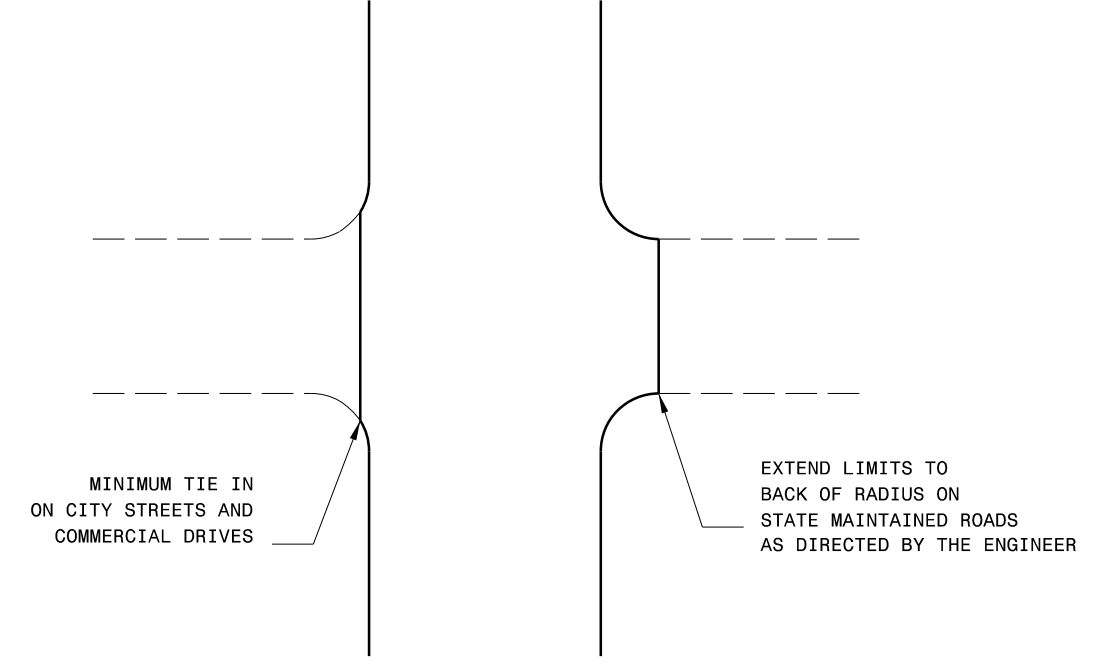

TYPICAL DETAIL OF PROJECT LIMITS AT UNSIGNALIZED Y LINES

ADDITIONAL INTERSECTIONS (NON-TYPICAL)		
Extend paving limits to back of radius or loop on the following intersections:		
MAP#	STREET NAME	COMMENTS
3	SR 1141 RT Horner Dr	85 Ft from EP of L-Line 632.77 SY
3	SR 1141 RT Penny Dr	127 Ft from EP of L-Line 1016 SY
3	SR 1141 RT Sedgefield Dr	47 Ft from EP of L-Line 339.44 SY
3	SR 1141 RT Wingate Rd	111 Ft from EP of L-Line 900 SY
3	SR 1141 LT Wingate Rd	64 Ft from EP of L-Line 618 SY
3	SR 1141 LT Wingate Rd	106 Ft from EP of L-Line 844 SY
3	SR 1141 RT John Smith Rd	127 Ft from EP of L-Line 1524 SY
3	SR 1141 RT Applebury Ln	40 Ft from EP of L-Line 328.88 SY
3	SR 1141 LT Brandy Ln	205 Ft from EP of L-Line 2756 SY
3	SR 1141 RT Natal Rd	100 Ft from EP of L-Line 1788 SY
4	SR 1802 LT Old Bluff Church Rd	60 Ft from EP of L-Line 580 SY
4	SR 1802 LT Burnett Rd	62 Ft from EP of L-Line 730 SY

PAVEMENT SCHEDULE	
C1	1 1/2" ASPHALT CONCRETE SURFACE COURSE, TYPE S9.5B, AT AN AVERAGE RATE OF 165 LBS. PER SQ. YD.
C2	1 1/2" ASPHALT CONCRETE SURFACE COURSE, TYPE S9.5C, AT AN AVERAGE RATE OF 168 LBS. PER SQ. YD.
E1	5 1/2" ASPHALT CONCRETE BASE COURSE, TYPE B25.0C, AT AN AVERAGE RATE OF 627 LBS. PER SQ. YD.
R1	EXISTING CURB AND GUTTER
T1	SHOULDER RECONSTRUCTION WITH AGGREGATE SHOULDER BORROW
U	EXISTING PAVEMENT
V1	0" - 1 1/2" MILLING
V2	1 1/2" MILLING

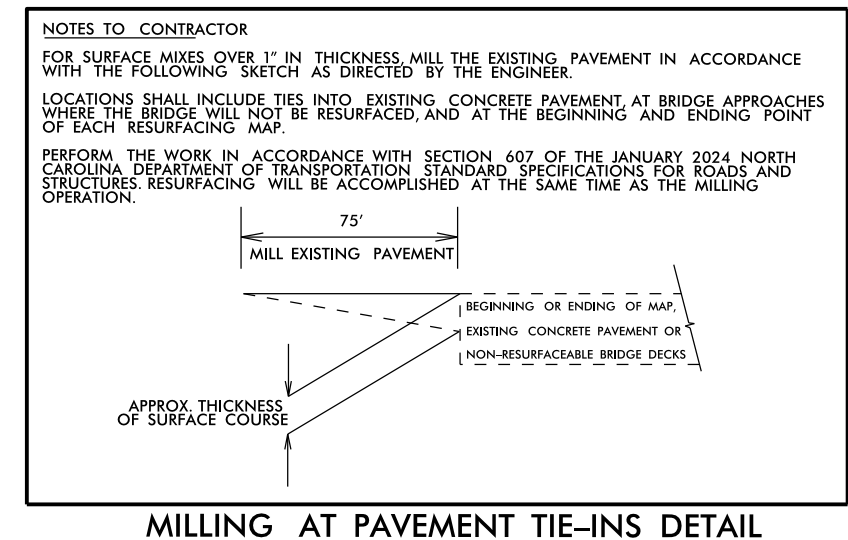
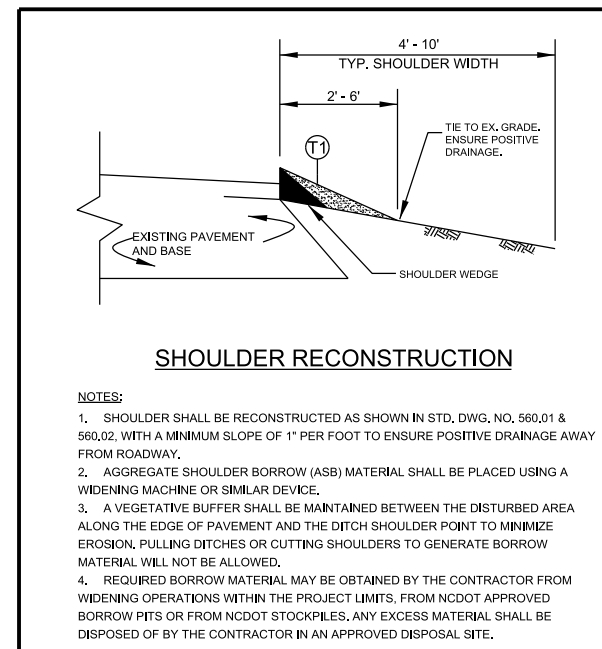
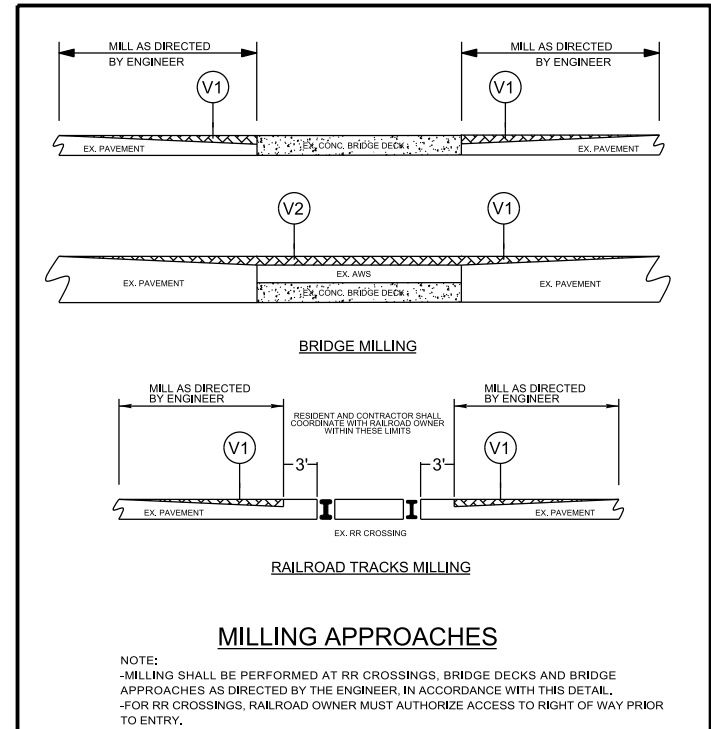
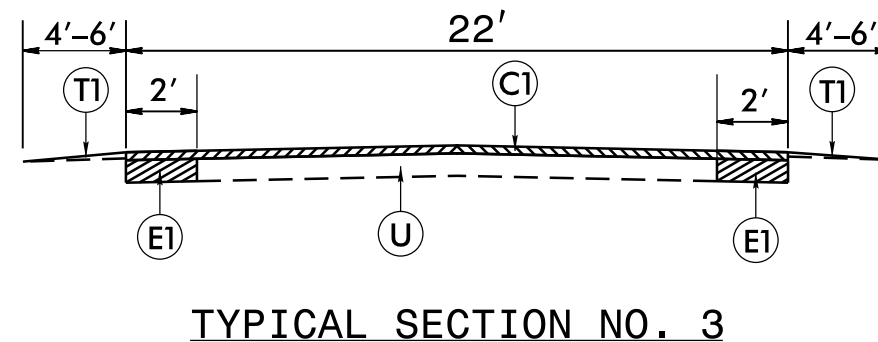
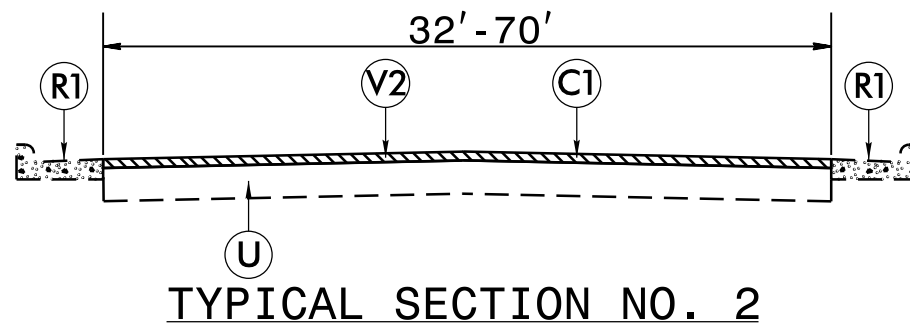
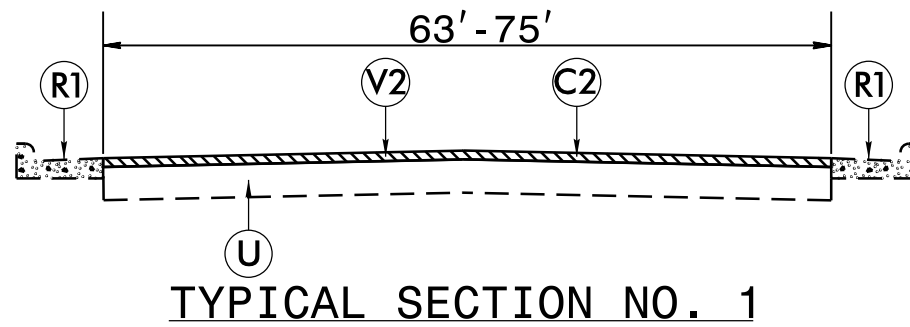

6/2/2024 20:57:57  
 C:\Users\jgibson\OneDrive\Documents\2024\Resurfacing\DF00495-2025CPT.06.07.10261.l.ctb.Fall 2024\_Cumber-land\Plans\TYPICAL.S.dgn  
 2024 SEP 20 14:57  
 3331125102610606

- NOTES:
- 1) DETAIL DOES NOT APPLY TO OGAFc AND ULTRA-THIN BONDED WEARING COURSE.
  - 2) BACKFILL SHOULDER WITH APPROVED MATERIAL.
  - 3) THE SHOULDER WEDGE DEVICE MAY BE DISENGAGED AT PAVED DRIVEWAYS AND SIDE STREETS.

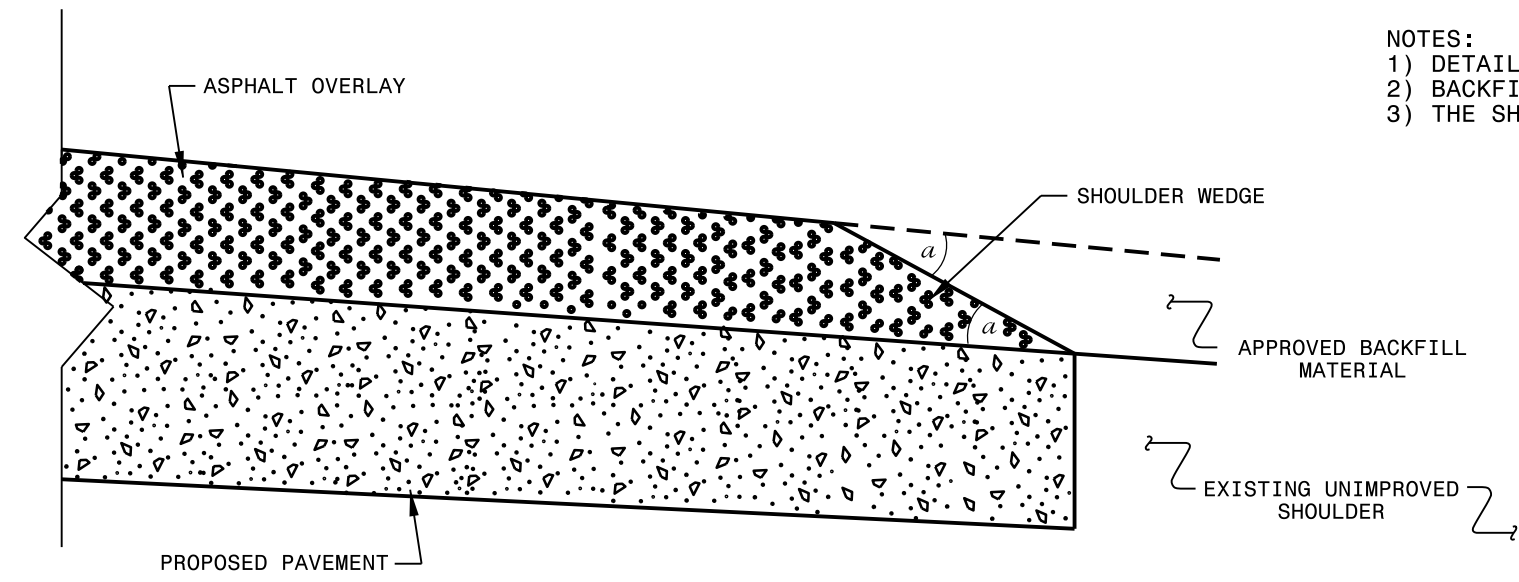

**SHOULDER WEDGE DETAIL**  
 (Resurfacing Projects w/ Widening or  
 with Existing Paved Shoulder having no dropoffs)

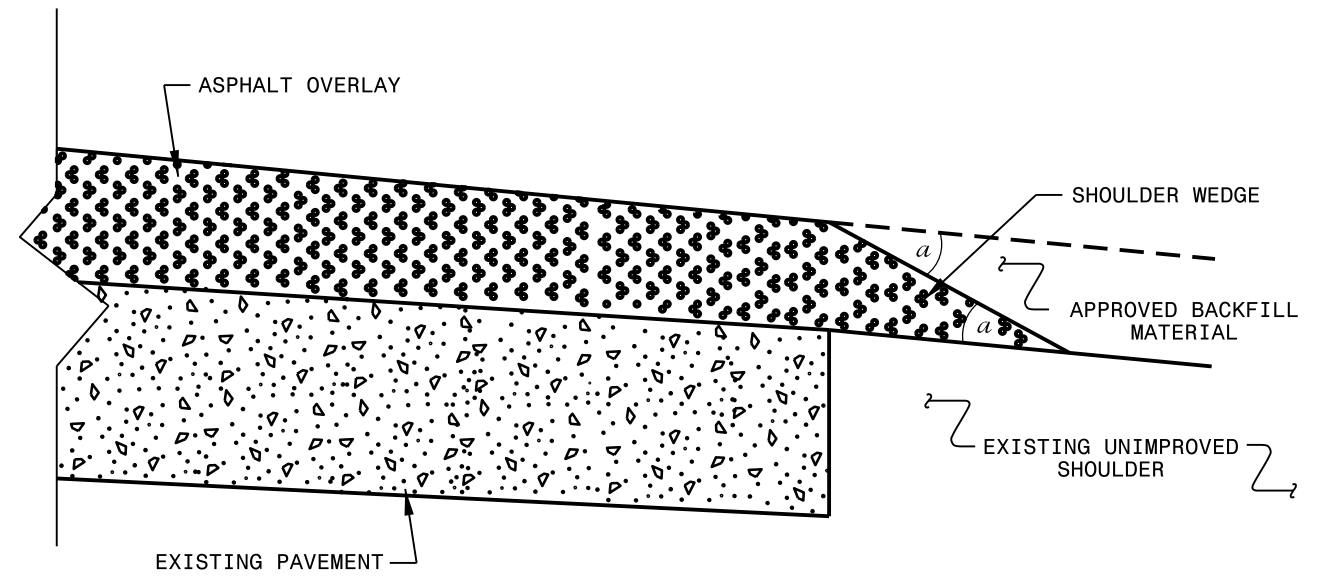

**SHOULDER WEDGE DETAIL**  
 (Resurfacing Projects w/ NO Widening)

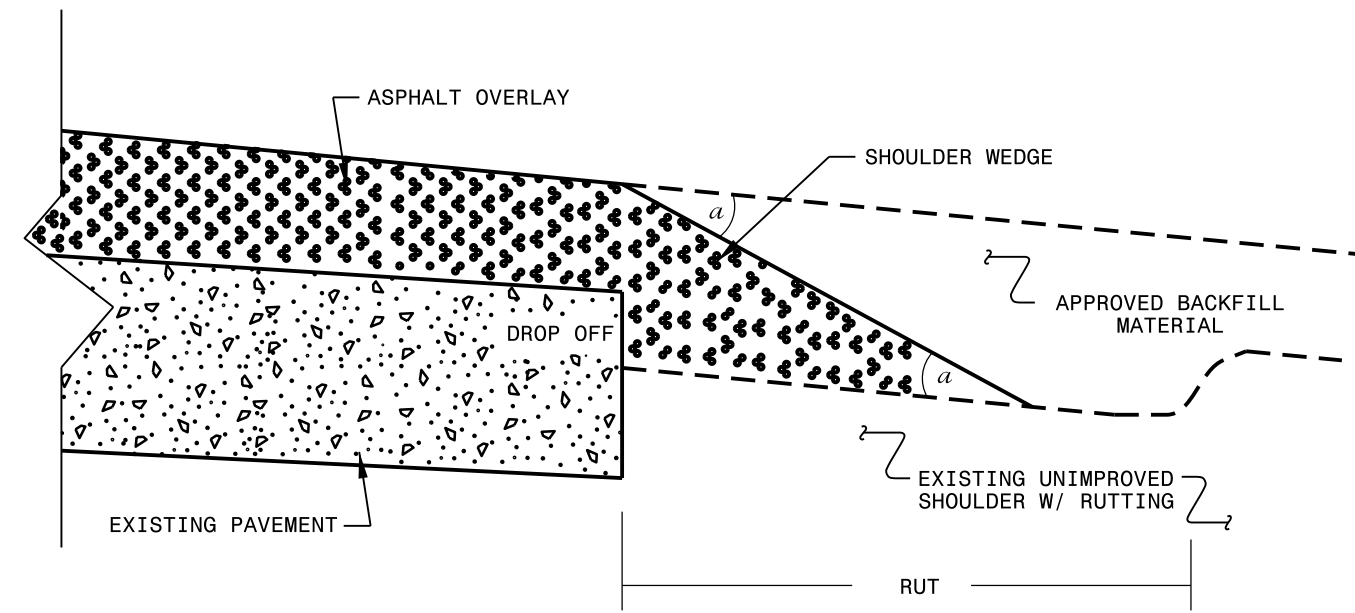

**SHOULDER WEDGE DETAIL**  
 (Resurfacing Adjacent to  
 Rutted Shoulder)

- SHOULDER WEDGE ANGLE = 30°

CONTRACT STANDARDS  
 AND DEVELOPMENT UNIT  
 Office 919-707-6950 FAX 919-250-4119

**SHOULDER WEDGE  
 DETAILS**

ORIGINAL BY: T.SPELL DATE: 7-19-11  
 MODIFIED BY: DATE: 10/16/12  
 CHECKED BY: DATE:  
 FILE SPEC.: susr/details/stand/shoulderwedgedetail.dgn

SYSTEMS DESIGN  
 USER NAME

# SIGNING FOR RESURFACING PROJECTS

**LEGEND**

┆ STATIONARY SIGN

← DIRECTION OF TRAFFIC FLOW

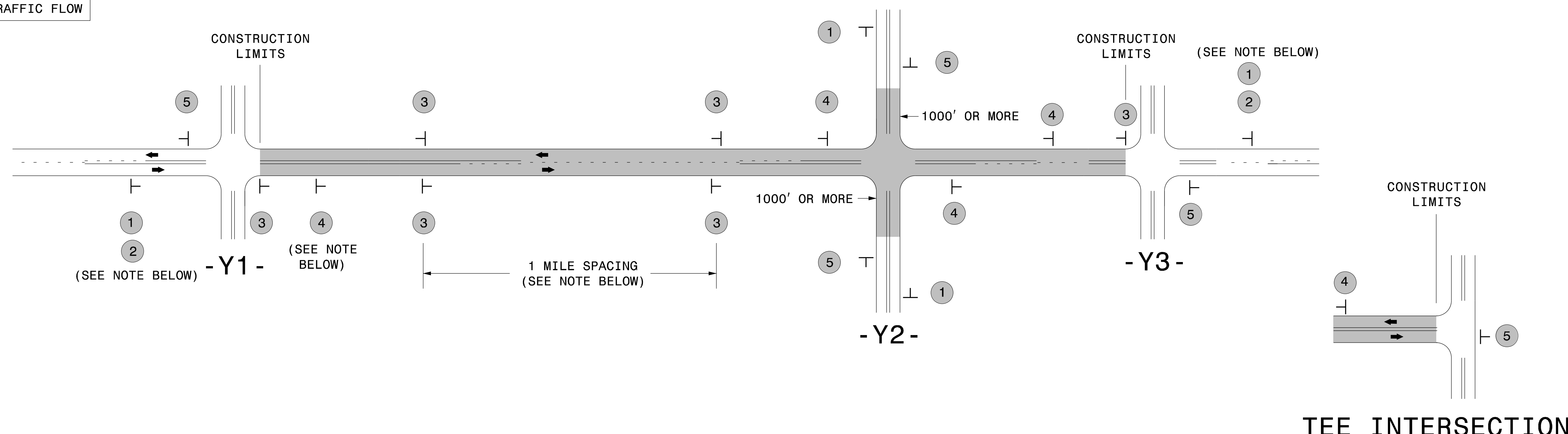

## MAINLINE (-L-) SIGNING

## -Y- LINE SIGNING

SIGNING NOTES AND PLACEMENT PER DIRECTION	1		PLACE 1000' PRIOR TO BEGINNING OF CONSTRUCTION LIMITS. ONLY USED ON -Y- LINES IF RESURFACING LIMITS EXTEND 1000' ALONG -Y- LINE.	<p>NO REQUIRED STATIONARY SIGNING FOR THE FOLLOWING -Y- LINE CONDITIONS:</p> <ol style="list-style-type: none"> <li>1) LESS THAN 1000' OF RESURFACING ALONG -Y- LINE</li> <li>2) SUBDIVISION ROADS</li> <li>3) DEAD END ROADS</li> </ol> <p>WHEN PAVING/CONSTRUCTION ACTIVITIES PROCEED ACROSS AN UNSIGNED -Y- LINE, PORTABLE ADVANCE WARNING SIGNS SHALL BE USED ALONG THE -Y- LINE AS SHOWN BELOW. REMOVE UPON COMPLETION OF WORK.</p> <div style="display: flex; justify-content: space-around;"> <div style="text-align: center;">               W20-1 48" X 48"              PLACED 500' IN ADVANCE OF FLAGGER.         </div> <div style="text-align: center;">               W20-7 A 48" X 48"              PLACED 250' IN ADVANCE OF FLAGGER.         </div> </div>
	2		#2 SIGN ONLY USED WHEN CONSTRUCTION LIMITS ARE 2 OR MORE MILES IN LENGTH. ROUND UP TO NEXT WHOLE NUMBER. (NO FRACTIONAL OR DECIMAL NUMBERS)	
	3		- PLACE INITIALLY AT THE CONSTRUCTION LIMITS AND SPACE 1 MILE APART THEREAFTER. - AT TEE INTERSECTIONS INSTALL INITIALLY 1/2 MILE FROM INTERSECTION AND SPACE 1 MILE APART THEREAFTER.	
	4		- THESE ARE FOR -Y- LINES THAT ARE "THROUGH" ROADWAYS. - DEAD END AND SUBDIVISION ROADS ARE NOT "THROUGH" ROADWAYS. - INSTALL 500' +/- FROM EACH -Y- LINE APPROACH AS SHOWN ABOVE. - FOR MULTIPLE -Y- LINES THAT ARE SEPARATED BY 0.25 MILES OR LESS, TREAT AS A SINGLE UNIT AND INSTALL WITHIN 500' OF EACH APPROACH. - A MAXIMUM OF 2 SIGN SETS PER MILE. DO NOT INSTALL WHEN -Y- LINES ARE WITHIN 0.5 MILES FROM "END ROAD WORK" SIGN. - FOR TEE INTERSECTIONS, INSTALL WITHIN 500' +/- OF THE INTERSECTION ALONG -L- LINE.	
	5		PLACE 500' FOLLOWING THE END OF CONSTRUCTION LIMITS OR AS SHOWN WHEN WORK ENDS AT A 3-WAY TEE INTERSECTION.	

THE ABOVE SIGNS ARE ALL THAT ARE REQUIRED FOR A CONTRACTOR TO BEGIN A RESURFACING CONTRACT. ANY ADDITIONAL SIGNS REQUESTED BY NCDOT DIVISIONS SHALL BE INSTALLED WITHIN 7 BUSINESS DAYS OF THE START OF CONTRACT WORK.

### MAPS LESS THAN 2 MILES

FOR RESURFACING MAPS WITH CONSTRUCTION LIMITS LESS THAN 2 MILES IN LENGTH, NO STATIONARY SIGNS ARE REQUIRED. USE PORTABLE "ROAD UNDER CONSTRUCTION" OR "ROAD WORK AHEAD" SIGNS IN LIEU OF STATIONARY ADVANCE WARNINGS SIGNS.

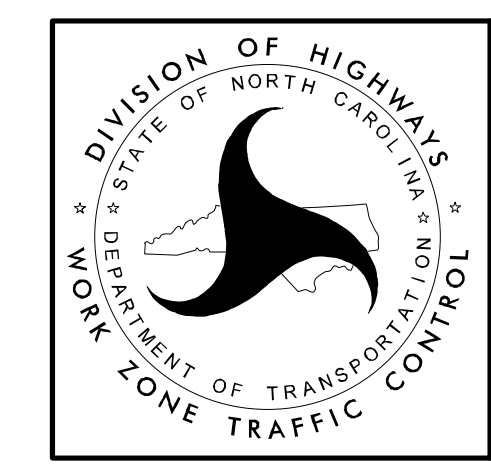

ADVANCE WARNING SIGNS FOR RURAL AND SUBURBAN 2-LANE ROADWAY RESURFACING



## URBAN / SUBURBAN WORKZONES

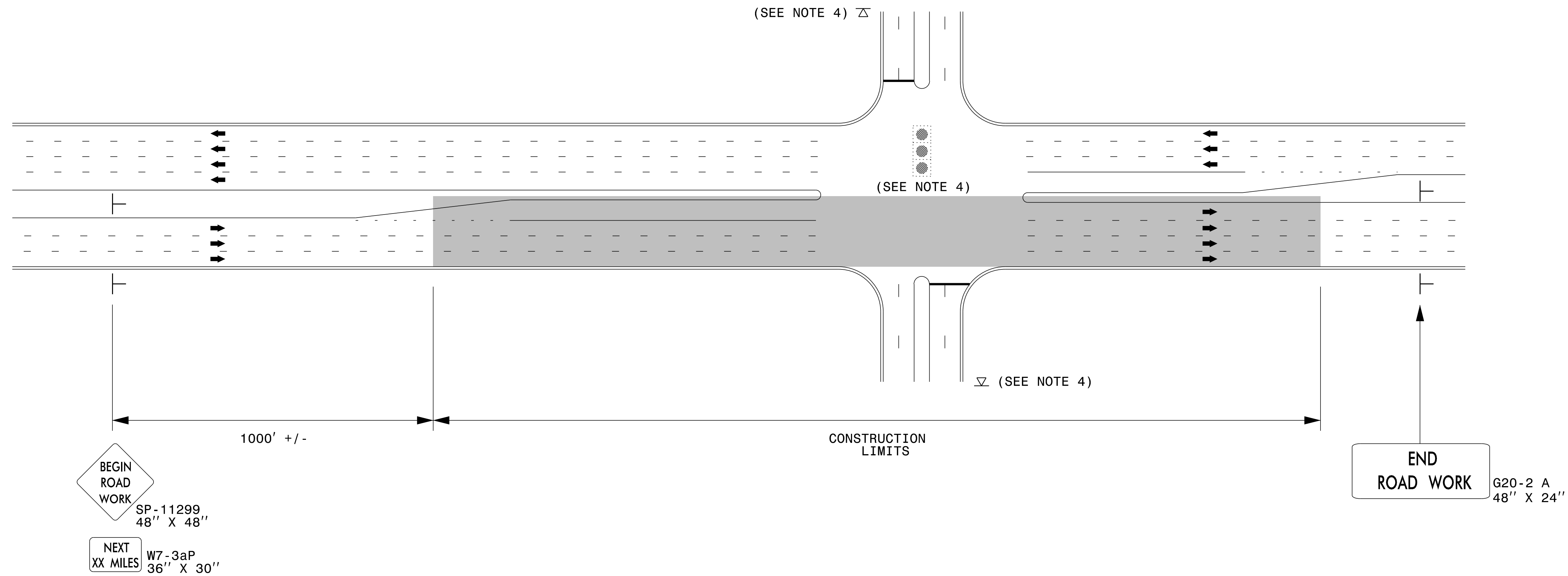

### NOTES:

- 1) 48" x 48" SIZED SIGNS (SP- 11299) MAY BE REDUCED TO 36" X 36" ON ROADWAYS WITH SPEED LIMITS OF 40 MPH OR LESS.
- 2) MOUNT SIGNS THAT ARE LARGER THAN 10 SQUARE FEET IN AREA ON TWO OR MORE WOOD OR U-CHANNEL SUPPORTS. PERFORATED SQUARE TUBING SUPPORT SYSTEMS MAY SUPPORT LARGER AREAS ON A SINGLE SUPPORT. FOLLOW MANUFACTURER'S RECOMMENDATIONS. THESE SYSTEMS SHALL BE NCHRP 350 COMPLIANT AND NCDOT APPROVED.
- 3) ADVANCE WARNING SIGNS NOT REQUIRED ON NON-SIGNALIZED SIDE STREETS.
- 4) MAY USE LAW ENFORCEMENT TO CONTROL TRAFFIC AT SIGNALIZED INTERSECTIONS AS DIRECTED BY THE ENGINEER. PROVIDE PORTABLE "ROAD WORK AHEAD" (W20-1) SIGNS 500' IN ADVANCE ALONG BOTH APPROACHES FROM THE SIDE STREETS WHEN PAVING PROCEEDS THROUGH THE INTERSECTION.
- 5) LATERAL CLEARANCE AT ALL SIGN LOCATIONS SHALL BE 2' AS MEASURED FROM THE EDGE OF PAVEMENT OR THE FACE OF THE CURB. WHEN UNABLE TO OBTAIN THE LATERAL CLEARANCE WITHIN THE MEDIAN AREA USE SHOULDER MOUNTS ONLY.
- 6) SIGN MOUNT LOCATIONS SHALL NOT BLOCK SIDEWALKS OR DRIVEWAYS.
- 7) IF STATIONARY GENERAL WARNING SIGNS ARE USED, THEY WILL BE PAID FOR PER SECTION 104 OF THE NCDOT STANDARD SPECIFICATIONS AS EXTRA WORK.
- 8) IF MILLED AREAS ARE NOT PAVED BACK BY THE END OF THE WORK DAY, PORTABLE SIGNS SHALL BE USED TO WARN DRIVERS OF THE PRESENT CONDITIONS. THESE ARE TO INCLUDE, BUT NOT LIMITED TO "ROUGH ROAD" W8-8, "UNEVEN LANES" W8-11, "GROOVED PAVEMENT" W8-15 w/MOTORCYCLE PLAQUE MOUNTED BELOW. THESE ARE TO BE DOUBLE INDICATED ON MULTI-LANE ROADWAYS WITH SPEED LIMITS 45 MPH AND GREATER WHERE LATERAL CLEARANCE CAN BE OBTAINED WITHIN THE MEDIAN AREAS. THESE PORTABLE SIGNS ARE INCIDENTAL TO THE OTHER ITEMS OF WORK INCLUDED IN THE TEMPORARY TRAFFIC CONTROL (LUMP SUM) PAY ITEM.

### LEGEND

- ┆ STATIONARY SIGN
- ➔ DIRECTION OF TRAFFIC FLOW

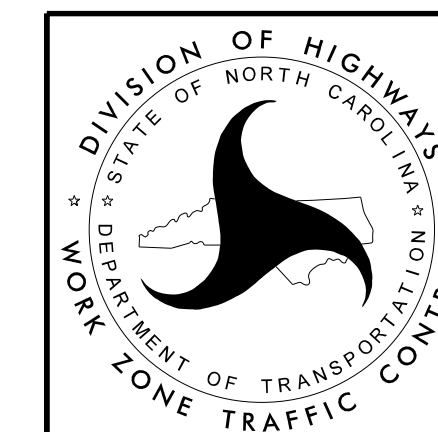

**RESURFACING ADVANCE  
WARNING SIGNS FOR  
URBAN / SUBURBAN  
FACILITIES**

### High Speed Detection (≥40 mph)

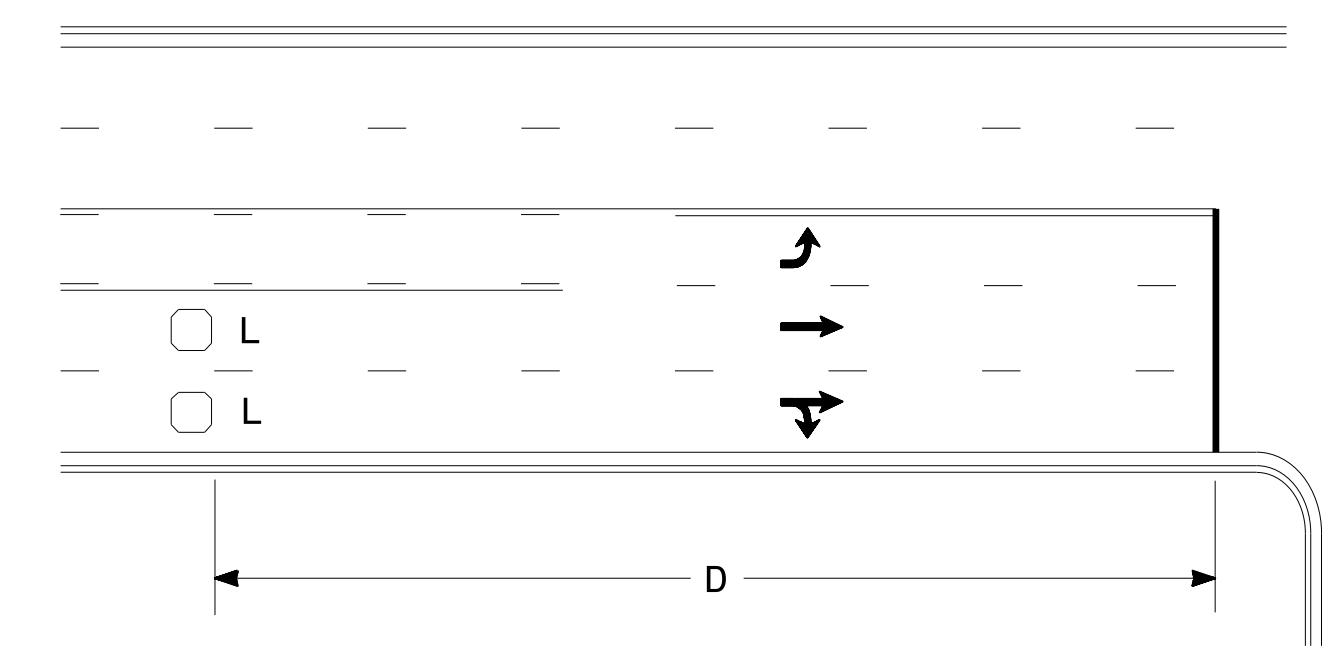

Speed Limit mph	D ft
40	250
45	300
50	355
55	420

L = 6ft X 6ft  
Wired in series for TS1  
Controllers  
Wired separately for TS2,  
170, and 2070L Controllers

Volume Density Operation

OR

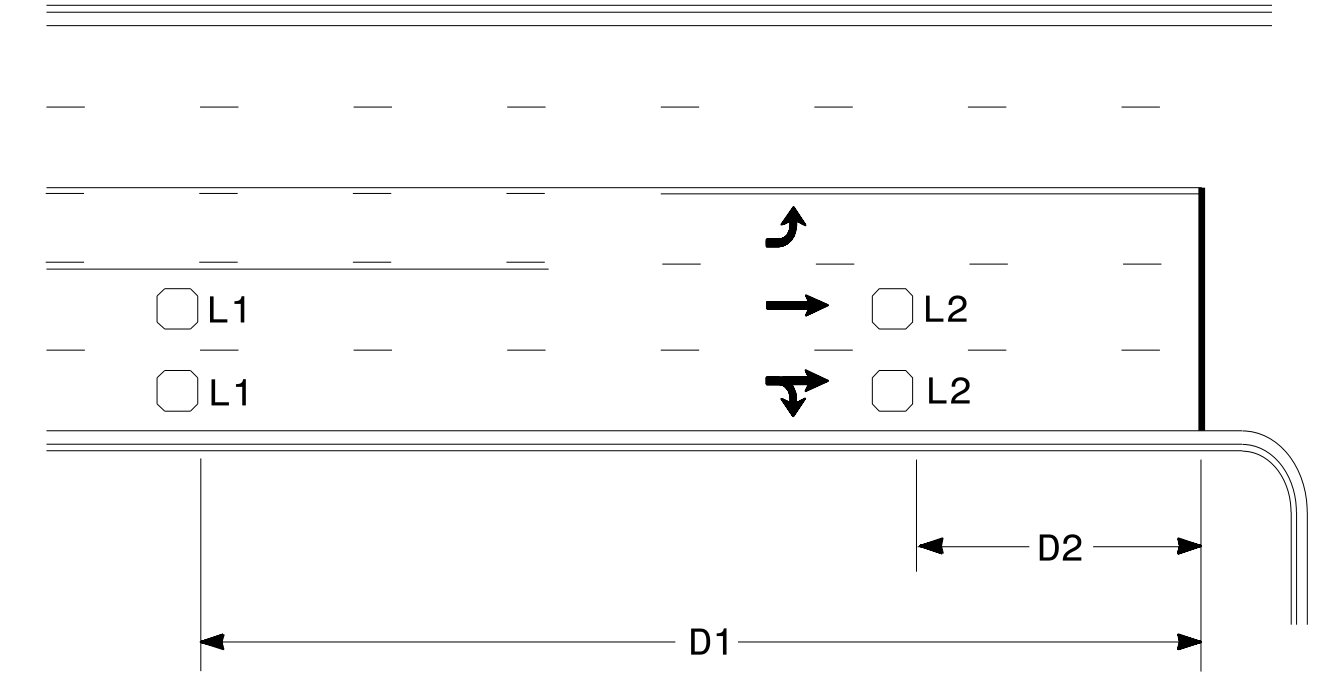

Speed Limit mph	D1 ft	D2 ft
40	250	80
45	300	90
50	355	100
55	420	110

L1 = 6ft X 6ft  
Wired in series  
L2 = 6ft X 6ft  
Wired in series

"Stretch" Operation

### Low Speed Detection (≤35 mph)

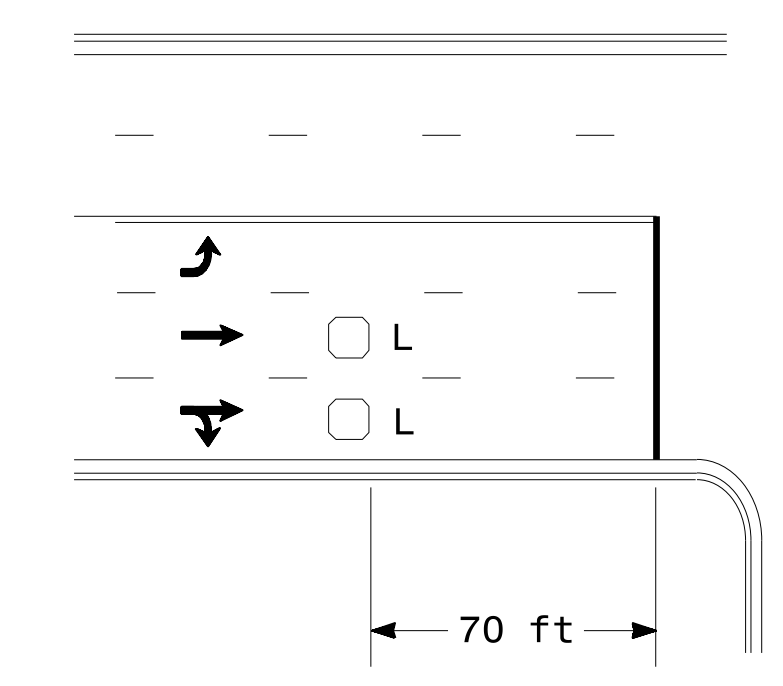

L = 6ft X 6ft  
Wired in series

OR

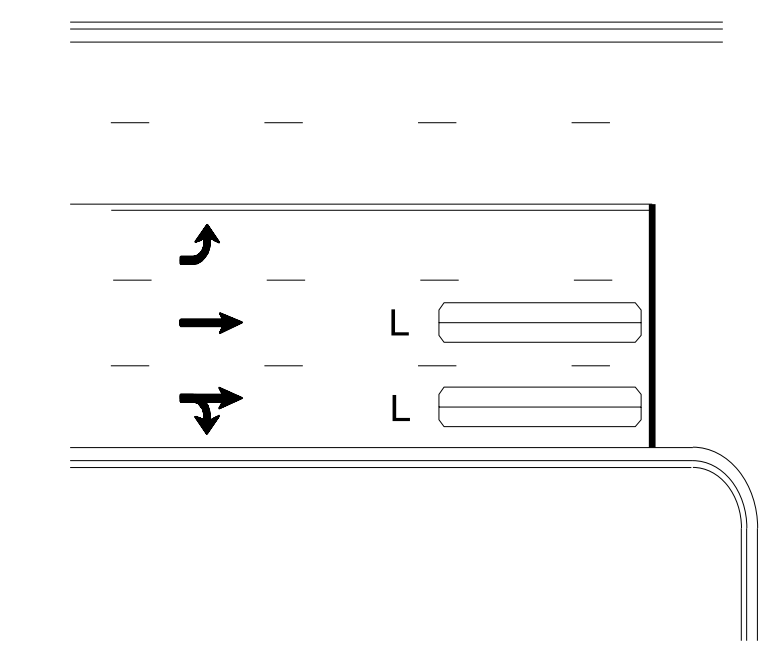

L = 6ft X 40ft  
Quadrupole loop, wired separately

### Left Turn Lane Detection

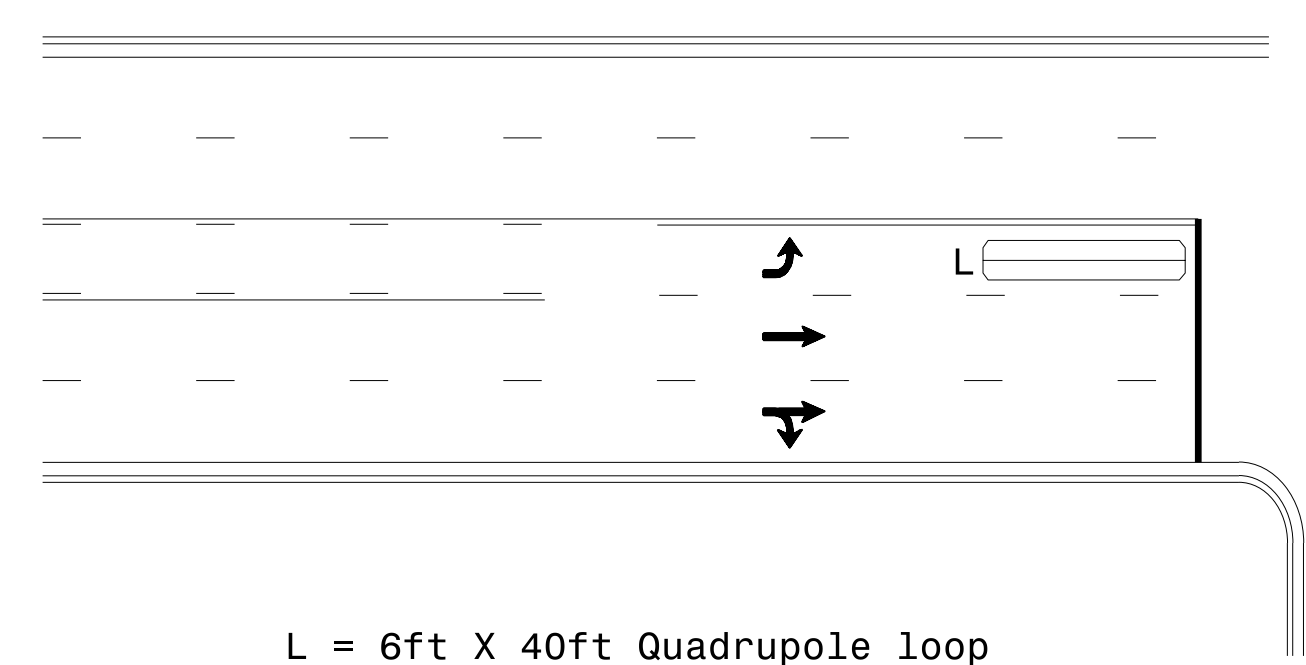

L = 6ft X 40ft Quadrupole loop

Presence Loop Detection

OR

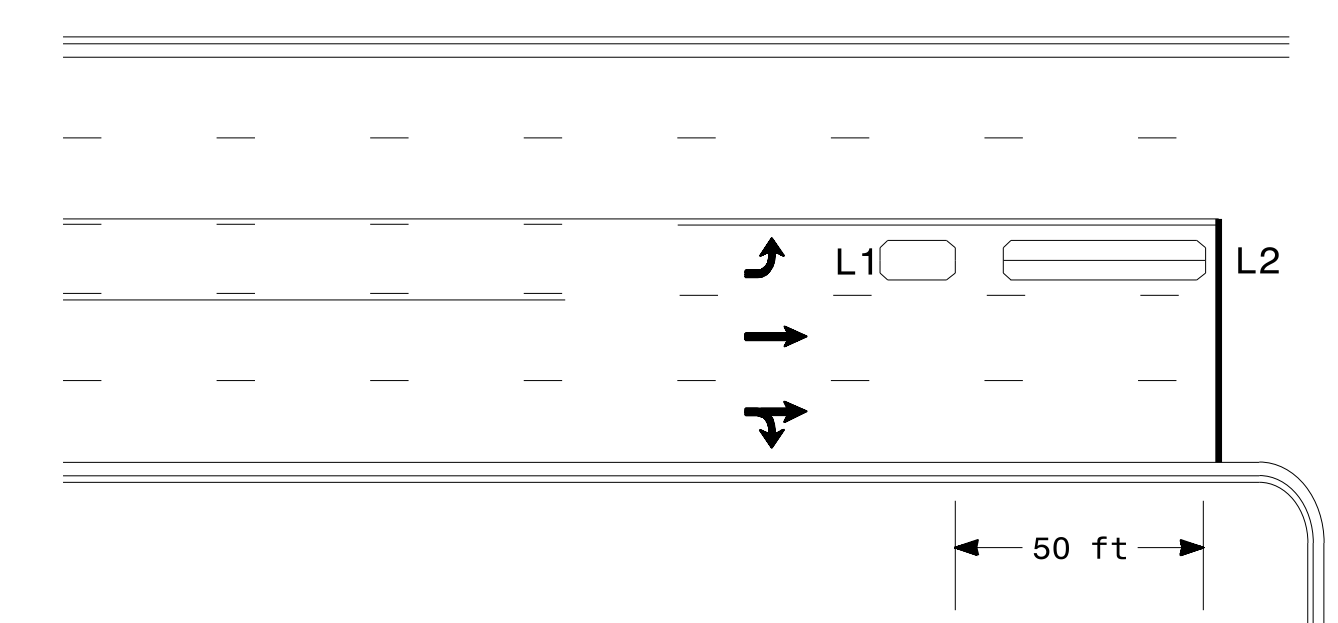

L1 = 6ft X 15ft Queue detector  
L2 = 6ft X 40ft Quadrupole loop

Queue Loop Detection

### Right Turn Lane Detection

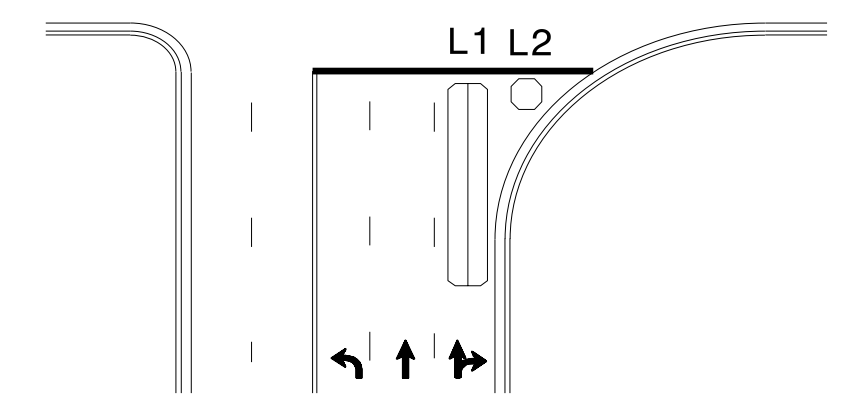

Shared Lane/  
Wide Radius Turn

L1 = 6ft X 40ft Quadrupole loop  
L2 = 6ft X 6ft [Minimum] Presence loop  
Wired separately

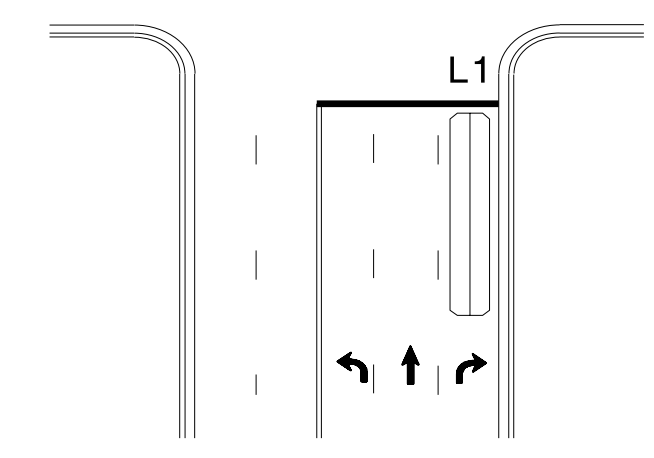

Standard Turn

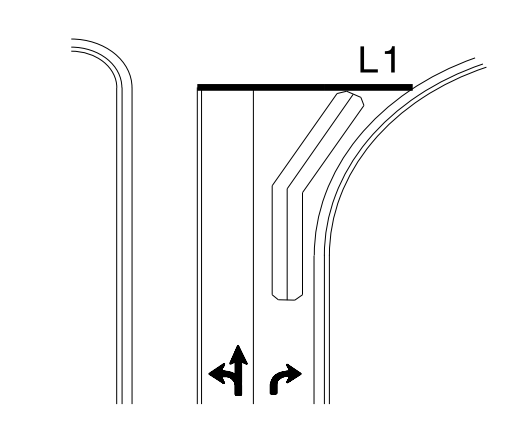

Wide Radius Turn

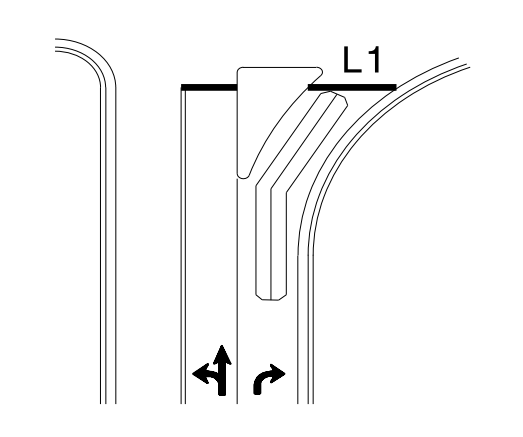

Channelized Turn

### Side Street Detection

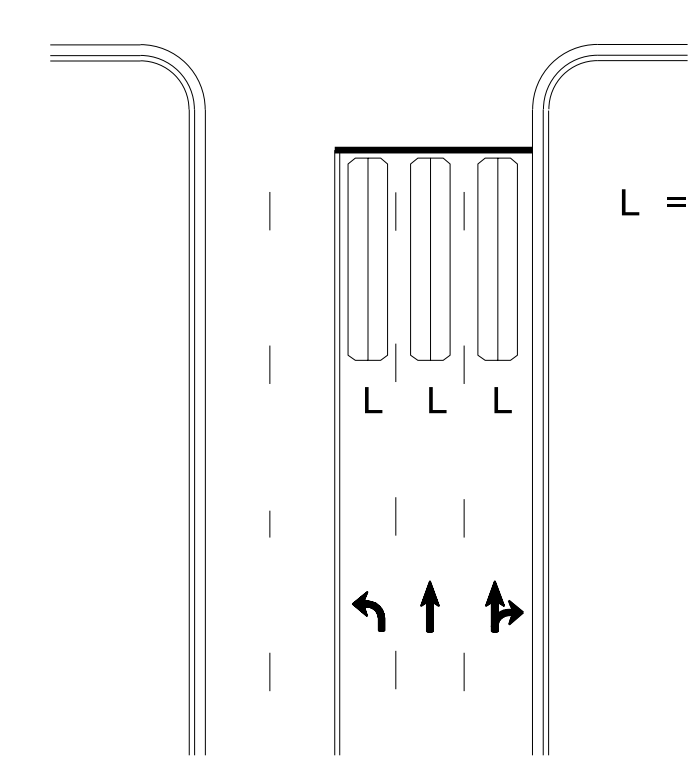

L = 6ft X 40ft  
Quadrupole loop  
Wired to separate  
detectors/channels

### Presence Loop Placement at Stop Lines

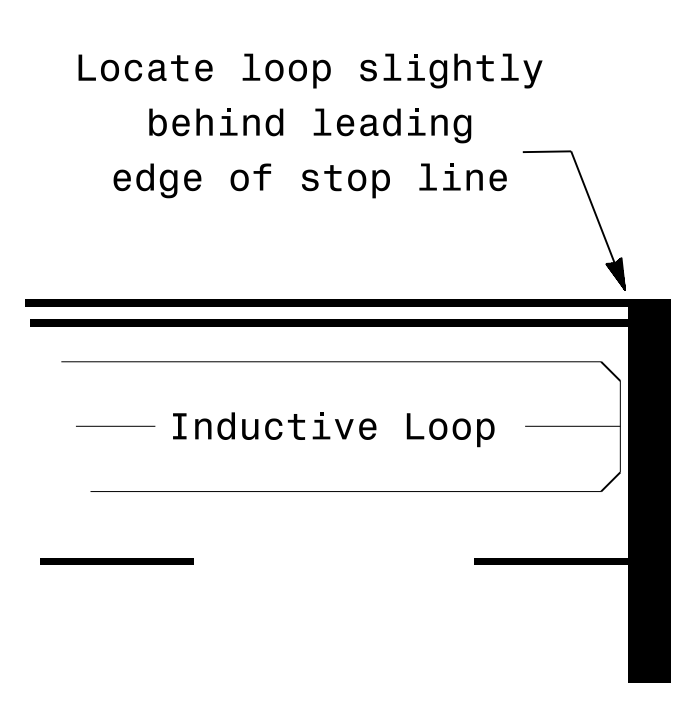

Locate loop slightly  
behind leading  
edge of stop line

Note:  
Loop may be located in advance  
of stop line under any of the  
following conditions:  
1) stop line is greater than 15'  
from edge of intersecting  
roadway  
2) loop detects a permissive or  
protected/permissive left turn  
3) for an exclusive right turn  
lane

### Recommended Number of Turns

Single 6' X 6' loop  
(when wired separately):

Length of Lead-in ft	Number of Turns
< 250	3
250-375	4
375-525	5
> 525	6

Quadrupole loops: Use 2-4-2 turns  
6' X 15' Loops:  
Lead-in < 150', use 2 turns  
Lead-in > 150', use 3 turns

Prepared In the Offices of:

750 N. Greenfield Pkwy, Garner, NC 27529

SCALE  
N/A

#### Typical Signal Loop Locations

PLAN DATE: January 2015	REVIEWED BY: JPG
PREPARED BY: PLA	REVIEWED BY:
REVISIONS	INIT. DATE

SEAL  
NORTH CAROLINA  
PROFESSIONAL ENGINEER  
PAMELA L. ALEXANDER  
23489

DocuSigned by:  
*P. Alexander*  
1/30/2015 11:00:00 AM  
DATE

SIG. INVENTORY NO.

**GUIDELINES FOR LANE WIDTHS ON RESURFACING PROJECTS**

Contractor shall place the new pavement markings in accordance with this table and detail unless otherwise directed by the Engineer.

<b>TWO LANE - TWO WAY ROADWAY - 55 MPH</b>		
ROADWAY WIDTH	LANE WIDTH	SHOULDER WIDTH
18'	9' *	0'
20'	10' *	0'
22'	10'	1'
24'	10'	2'
26'	11'	2'
28'	12'	2'
32'	12'	4'

\* May vary due to pavement width

<b>TWO LANE - TWO WAY ROADWAY</b>		<b>50</b>
<b>MPH OR LESS</b>		
ROADWAY WIDTH	LANE WIDTH	SHOULDER WIDTH
18'	9' *	0'
20'	10' *	0'
22'	10'	1'
24'	10'	2'
26'	11'	2'
28'	11'	3'
32'	11'	5'

\* May vary due to pavement width

**SCHEMATIC OF ROADWAY**

(NOT TO SCALE)

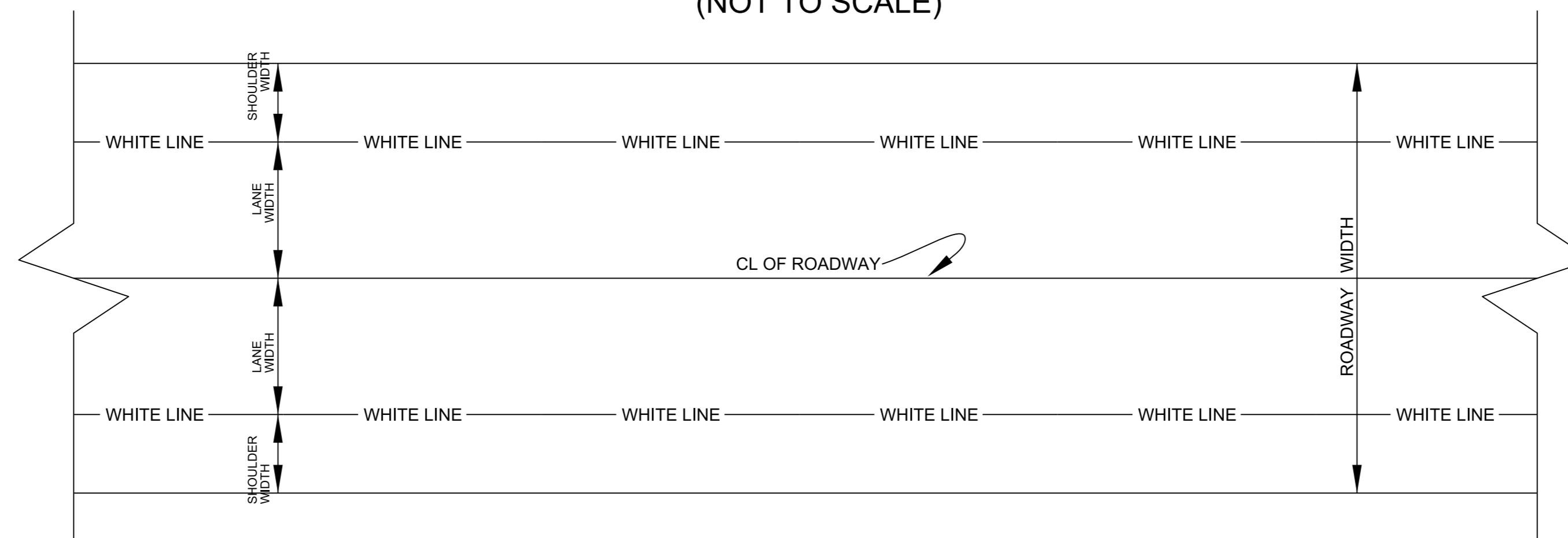

PROJECT NO.	SHEET NO.	TOTAL NO.
PT.06.07.10261.1, 2025CPT.06.07.2		

## SUMMARY OF QUANTITIES

PROJECT NO	COUNTY	MAP NO	ROUTE	DESCRIPTION	TYP NO	LANES	LANE TYPE	LENGTH	WIDTH	BEGIN MP	END MP	1220000000-E	1245000000-E	1260000000-E	1297000000-E	1330000000-E	1491000000-E	1519000000-E	1523000000-E	1575000000-E	2830000000-N	2845000000-N	7324000000-N	7444000000-E		
												INCIDENTAL STONE BASE	SHOULDER RECONSTRUCTION	AGGREGATE SHOULDER BORROW	1½" MILLING	INCIDENTAL MILLING	BASE COURSE, B25.0C	SURFACE COURSE, S9.5B	SURFACE COURSE, S9.5C	ASPHALT BINDER FOR PLANT MIX	ADJ. OF MANHOLES	ADJ. OF METER OR VALVE BOX	JUNCTION BOX (STANDARD SIZE)	INDUCTIVE LOOP SAWCUT		
												TONS	SMI	TON	SY	SY	TONS	TONS	TONS	TONS	EA	EA	EA	LF		
2025CPT.06.07.10261.1	Cumberland	1	NC-53	FROM PAVEMENT JOINT TO NC 24	1	5	MU	2.48	63	20.75	22.38	2			93,509	1,667			8,028	482	90	20	2.00	1,595.00		
<b>TOTAL FOR MAP NO. 1</b>								<b>2.48</b>				<b>2</b>			<b>93,509</b>	<b>1,667</b>			<b>8,028</b>	<b>482</b>	<b>90</b>	<b>20</b>	<b>2.00</b>	<b>1,595.00</b>		
<b>TOTAL FOR PROJ NO. 2025CPT.06.07.10261.1</b>								<b>2.48</b>				<b>2</b>			<b>93,509</b>	<b>1,667</b>			<b>8,028</b>	<b>482</b>	<b>90</b>	<b>20</b>	<b>2.00</b>	<b>1,595.00</b>		
2025CPT.06.07.20261.1	Cumberland	2	SR-1141 / SOUTHERN AVE	FROM SR 1132 TO SR 2311	2	3	2WU	1.74	32	4.583	6.323	2			33,041	1,667		2,901		194	90	100	2.00	540.00		
<b>TOTAL FOR MAP NO. 2</b>								<b>1.74</b>				<b>2</b>			<b>33,041</b>	<b>1,667</b>		<b>2,901</b>		<b>194</b>	<b>90</b>	<b>100</b>	<b>2.00</b>	<b>540.00</b>		
2025CPT.06.07.20261.1	Cumberland	3	SR-1141 OI / CUMBERLAND RD	FROM NC162 TO SR1148	2	3	2WU	2.96	32	0	2.96				114,752	9,722		9,474		635	78	80	4.00	4,320.00		
<b>TOTAL FOR MAP NO. 3</b>								<b>2.96</b>							<b>114,752</b>	<b>9,722</b>		<b>9,474</b>		<b>635</b>	<b>78</b>	<b>80</b>	<b>4.00</b>	<b>4,320.00</b>		
2025CPT.06.07.20261.1	Cumberland	4	SR-1802 / SISK CULBRETH RD	FROM US301 TO NC82	3	2	2WU	3.98	22	0	3.98	83	7.95	1,286		556	2,928	4,284		419						
<b>TOTAL FOR MAP NO. 4</b>								<b>3.98</b>				<b>83</b>	<b>7.95</b>	<b>1,286</b>		<b>556</b>	<b>2,928</b>	<b>4,284</b>		<b>419</b>						
2025CPT.06.07.20261.1	Cumberland	5	SR-1812 / BURNETT RD	FROM SR1802 TO NC82	3	2	2WU	0.88	22	0	0.88	28	1.80	285		647	937		92							
<b>TOTAL FOR MAP NO. 5</b>								<b>0.88</b>				<b>28</b>	<b>1.80</b>	<b>285</b>		<b>647</b>	<b>937</b>		<b>92</b>							
<b>TOTAL FOR PROJ NO. 2025CPT.06.07.20261.1</b>								<b>9.56</b>				<b>113</b>	<b>9.75</b>	<b>1,571</b>	<b>147,793</b>	<b>11,945</b>	<b>3,575</b>	<b>17,596</b>		<b>1,340</b>	<b>168</b>	<b>180</b>	<b>6.00</b>	<b>4,860.00</b>		
<b>GRAND TOTAL</b>								<b>12.04</b>				<b>115</b>	<b>9.75</b>	<b>1,571</b>	<b>241,302</b>	<b>13,612</b>	<b>3,575</b>	<b>17,596</b>	<b>8,028</b>	<b>1,822</b>	<b>258</b>	<b>200</b>	<b>8.00</b>	<b>6,455.00</b>		

PROJECT NO.	SHEET NO.	TOTAL NO.
.06.07.10261.1, 2025CPT.06.07		

### THERMOPLASTIC AND PAINT QUANTITIES

PROJECT NO	COUNTY	MAP NO	ROUTE	DESCRIPTION	TYP NO	LANES	LANE TYPE	LENGTH	WIDTH	BEGIN MP	END MP	4413000000-E WORK ZONE ADVANCE/GE NERAL WARNING SIGNING	4457000000-N TEMPORARY TRAFFIC CONTROL	4685000000-E		4688000000-E		4695000000-E		4709000000-E 24" X 90 M WHITE THERMO	4720000000-E THERMO MSG SCHOOL 90 M	4725000000-E			4810000000-E		4815000000-E						
														4" X 90 M WHITE THERMO	4" X 90 M YELLOW THERMO	6" X 90 M YELLOW THERMO	6" X 90 M WHITE THERMO	8" X 90 M WHITE THERMO	8" X 90 M YELLOW THERMO			THERMO LT ARROW 90 M	THERMO RT ARROW 90 M	THERMO STR ARROW 90 M	THERMO STR & LT ARROW 90 M	THERMO STR & RT ARROW 90 M	4" WHITE PAINT	4" YELLOW PAINT	6" YELLOW PAINT	6" WHITE PAINT			
														LF	LF	LF	LF	LF	LF			EA	EA	EA	EA	EA	EA	EA	EA	EA	EA	EA	EA
2025CPT.06.07.10261.1	Cumberland	1	NC-53	FROM PAVEMENT JOINT TO NC 24	1	5	MU	2.48	63	20.75	22.38	126	1.00	1,010	22,505			711	110	370	EA	77	7	5	2	1	1,010	22,505					
TOTAL FOR MAP NO. 1								2.48				126	1.000	1,010	22,505			711	110	370		77	7	5	2	1	1,010	22,505					
TOTAL FOR PROJ NO. 2025CPT.06.07.10261.1								2.48				126	1.000	1,010	22,505			711	110	370		77	7	5	2	1	1,010	22,505					
														23,515		821		92			23,515												
2025CPT.06.07.20261.1	Cumberland	2	SR-1141 / SOUTHERN AVE	FROM SR 1132 TO SR 2311	2	3	2WU	1.74	32	4.583	6.323	642		360	14,500	130		1,350	175	400	2	54	2				360	14,500	130				
TOTAL FOR MAP NO. 2								1.74				642		360	14,500	130		1,350	175	400	2	54	2				360	14,500	130				
2025CPT.06.07.20261.1	Cumberland	3	SR-1141 OI / CUMBERLAND RD	FROM NC162 TO SR1148	2	3	2WU	2.96	32	0	2.96	332		2,250	29,800	2,320		1,170	150	150		45	8	22		8	2,250	29,800	2,320				
TOTAL FOR MAP NO. 3								2.96				332		2,250	29,800	2,320		1,170	150	150		1,170	150	150		45	8	22		8	2,250	29,800	2,320
2025CPT.06.07.20261.1	Cumberland	4	SR-1802 / SISK CULBRETH RD	FROM US301 TO NC82	3	2	2WU	3.98	22	0	3.98	445		41,500	33,000	150	150			75							41,500	33,000	150	150			
TOTAL FOR MAP NO. 4								3.98				445		41,500	33,000	150	150			75								41,500	33,000	150	150		
2025CPT.06.07.20261.1	Cumberland	5	SR-1812 / BURNETT RD	FROM SR1802 TO NC82	3	2	2WU	0.88	22	0	0.88	99		9,500	8,000												9,500	8,000					
TOTAL FOR MAP NO. 5								0.88				99		9,500	8,000														9,500	8,000			
TOTAL FOR PROJ NO. 2025CPT.06.07.20261.1								9.56				1,518		53,610	85,300	2,600	150		2,520	175	625	2	99	10	22		8	53,610	85,300	2,600	150		
														138,910		2,750		2,695		139			138,910		2,750								
GRAND TOTAL								12.04				1,644	1.000	54,620	107,805	2,600	150		3,231	285	995	2	176	17	27		9	54,620	107,805	2,600	150		
														162,425		2,750		3,516		231			162,425		2,750								

PROJECT NO	COUNTY	MAP NO	ROUTE	DESCRIPTION	TYP NO	LANES	LANE TYPE	LENGTH	WIDTH	BEGIN MP	END MP	4820000000-E		4835000000-E	4840000000-N	4845000000-N			4891000000-E			4900000000-N					
												8" WHITE PAINT	8" YELLOW PAINT	24" WHITE PAINT	PAINT MSG SCHOOL	PAINT LT ARROW	PAINT RT ARROW	PAINT STR ARROW	PAINT STR & LT ARROW	PAINT STR & RT ARROW	GENERIC MARKING, 4" X 90 M WHITE THERMO (SKIP & MINI SKIP)	GENERIC MARKING, 16" X 90 M WHITE THERMO (RXR CROSSBUCK)	GENERIC MARKING, 24" X 90 M WHITE THERMO	CRYSTAL & RED MARKERS	YELLOW & YELLOW MARKERS		
												LF	LF	LF	EA	EA	EA	EA	EA	EA	EA	EA	EA	EA	EA	EA	EA
2025CPT.06.07.10261.1	Cumberland	1	NC-53	FROM PAVEMENT JOINT TO NC 24	1	5	MU	2.48	63	20.75	22.38	711	110	370		77	7	5	2	1	6,800	200		400	300		
TOTAL FOR MAP NO. 1								2.48				711	110	370		77	7	5	2	1	6,800	200		400	300		
TOTAL FOR PROJ NO. 2025CPT.06.07.10261.1								2.48				711	110	370		77	7	5	2	1	6,800	200		400	300		
												821		92			7,000			700							
2025CPT.06.07.20261.1	Cumberland	2	SR-1141 / SOUTHERN AVE	FROM SR 1132 TO SR 2311	2	3	2WU	1.74	32	4.583	6.323	1,350	175	400	2	54	2				240		100	250	200		
TOTAL FOR MAP NO. 2								1.74				1,350	175	400	2	54	2						240		100	250	200
2025CPT.06.07.20261.1	Cumberland	3	SR-1141 OI / CUMBERLAND RD	FROM NC162 TO SR1148	2	3	2WU	2.96	32	0	2.96	1,170		150		45	8	22			6,800			425	400		
TOTAL FOR MAP NO. 3								2.96				1,170		150		45	8	22			6,800			425	400		
2025CPT.06.07.20261.1	Cumberland	4	SR-1802 / SISK CULBRETH RD	FROM US301 TO NC82	3	2	2WU	3.98	22	0	3.98			75								100		260			
TOTAL FOR MAP NO. 4								3.98						75											100		260
2025CPT.06.07.20261.1	Cumberland	5	SR-1812 / BURNETT RD	FROM SR1802 TO NC82	3	2	2WU	0.88	22	0	0.88													60			
TOTAL FOR MAP NO. 5								0.88																		60	
TOTAL FOR PROJ NO. 2025CPT.06.07.20261.1								9.56				2,520	175	625	2	99	10	22		8	7,040	100	100	675	920		
														2,695		139		7,240			1,595						
GRAND TOTAL								12.04				3,231	285	995	2	176	17	27	2	9	13,840	300	100	1,075	1,220		
														3,516		231		14,240			2,295						