

STATE OF NORTH CAROLINA  
DEPARTMENT OF TRANSPORTATION  
HIGHWAY DIVISION 6

# PLANS

**Let Date: October 17, 2018**

**CONTRACT ID: DF00231**

**WBS ELEMENT NO.: 2019CPT.06.13.20092.1**

**FEDERAL AID NO.: STATE FUNDED**

**COUNTY: BLADEN**

**TIP NO.: -----**

**LENGTH OF PROJECT: 63.463 MILES**

**ROUTE NO.: VARIOUS SECONDARY ROUTES**

**LOCATION: VARIOUS**

**TYPE OF WORK: ASPHALT SURFACE TREATMENT – DOUBLE SEALS**

**This electronic collection of documents is provided  
for the convenience of the user  
and is Not a Certified Document –**

**The documents contained herein were originally issued  
and sealed by the individuals whose names and license  
numbers appear on each page, on the dates appearing  
with their signature on that page.**

**This file or an individual page  
shall not be considered a certified document.**

# 2019 Bladen County Contract BST

Date: 9/19/2018  
Contract #: DF00231  
WBS: Double Seals - 2019CPT.06.13.20092.1

Division : 6  
County: Bladen  
Description: AST - Double Seals

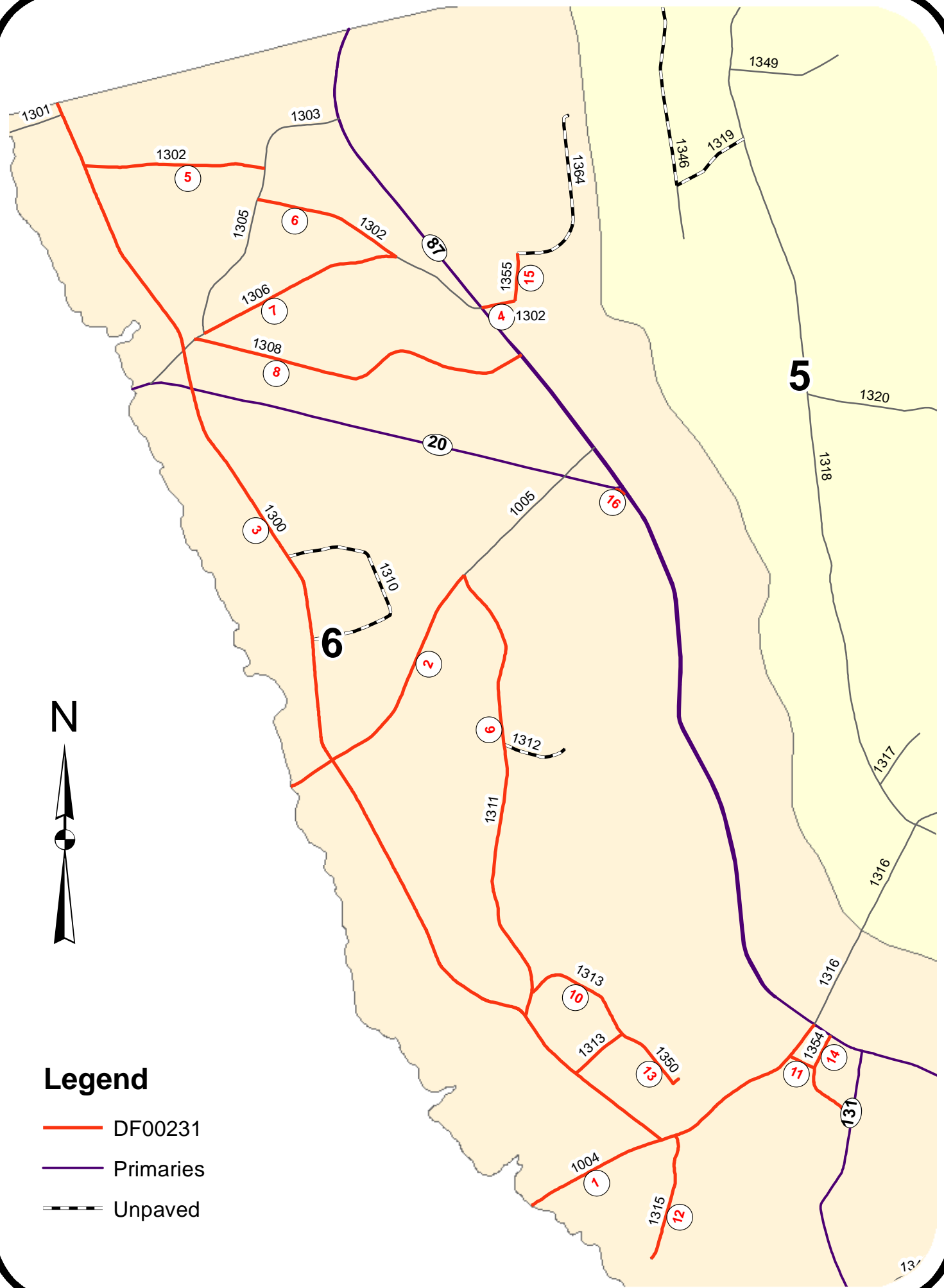

- Legend**
- DF00231
  - Primaries
  - Unpaved

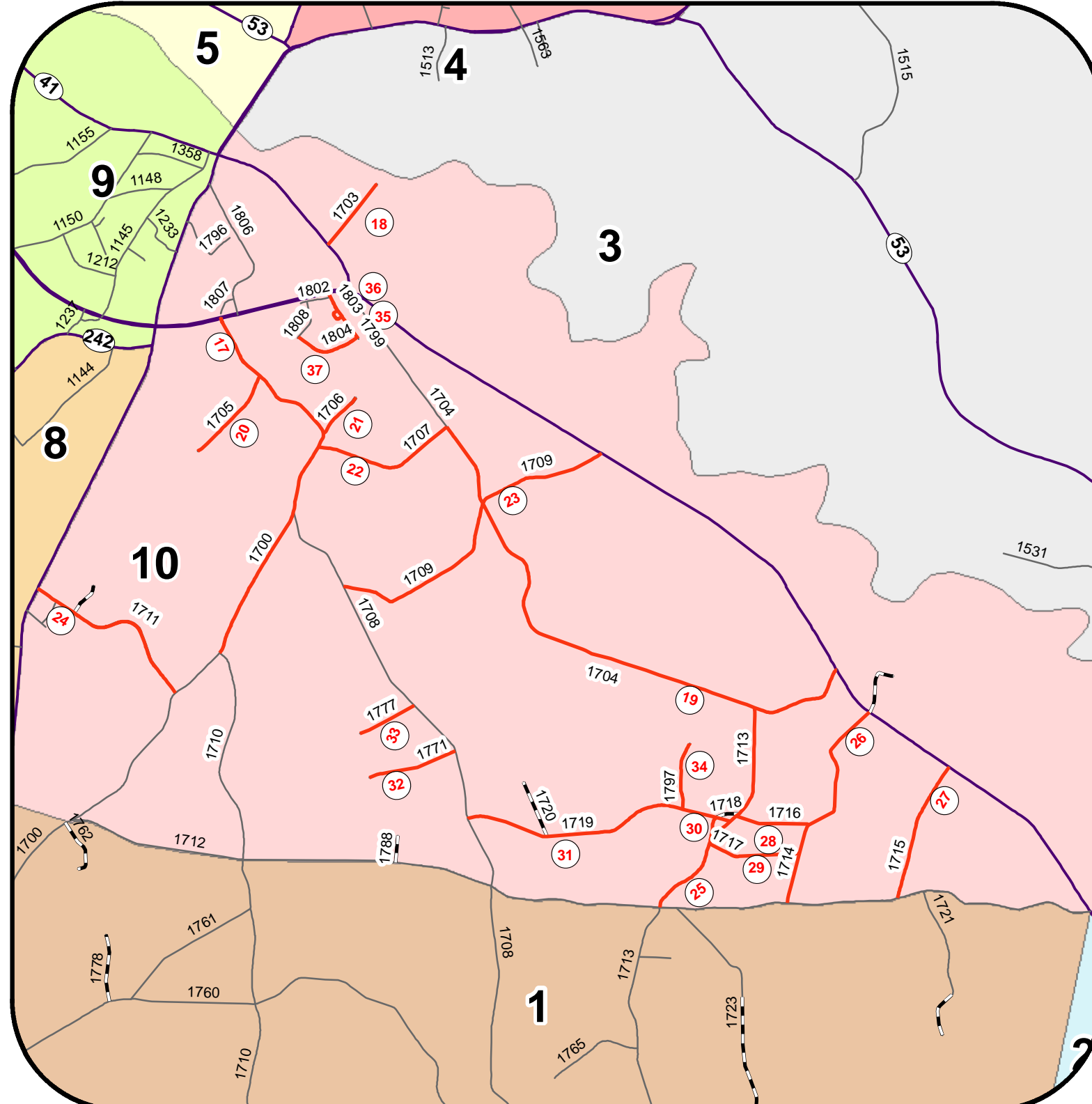

- Legend**
- DF00231
  - Primaries
  - Unpaved

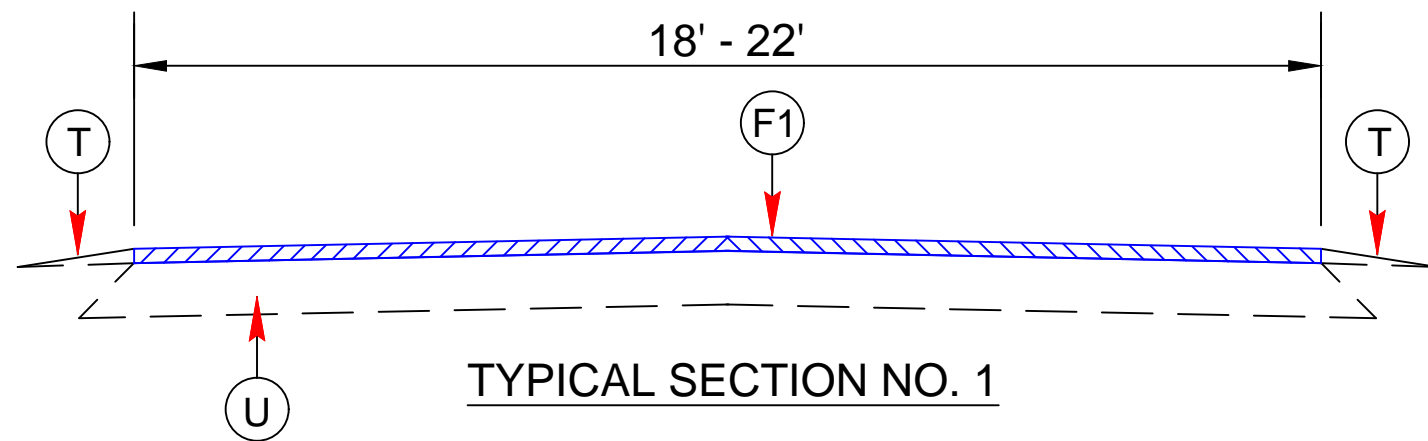

PAVEMENT SCHEDULE	
F1	DOUBLE SEAL PLACED ACCORDING TO THE SPECIAL PROVISIONS
T	EXISTING SHOULDER
U	EXISTING ASPHALT

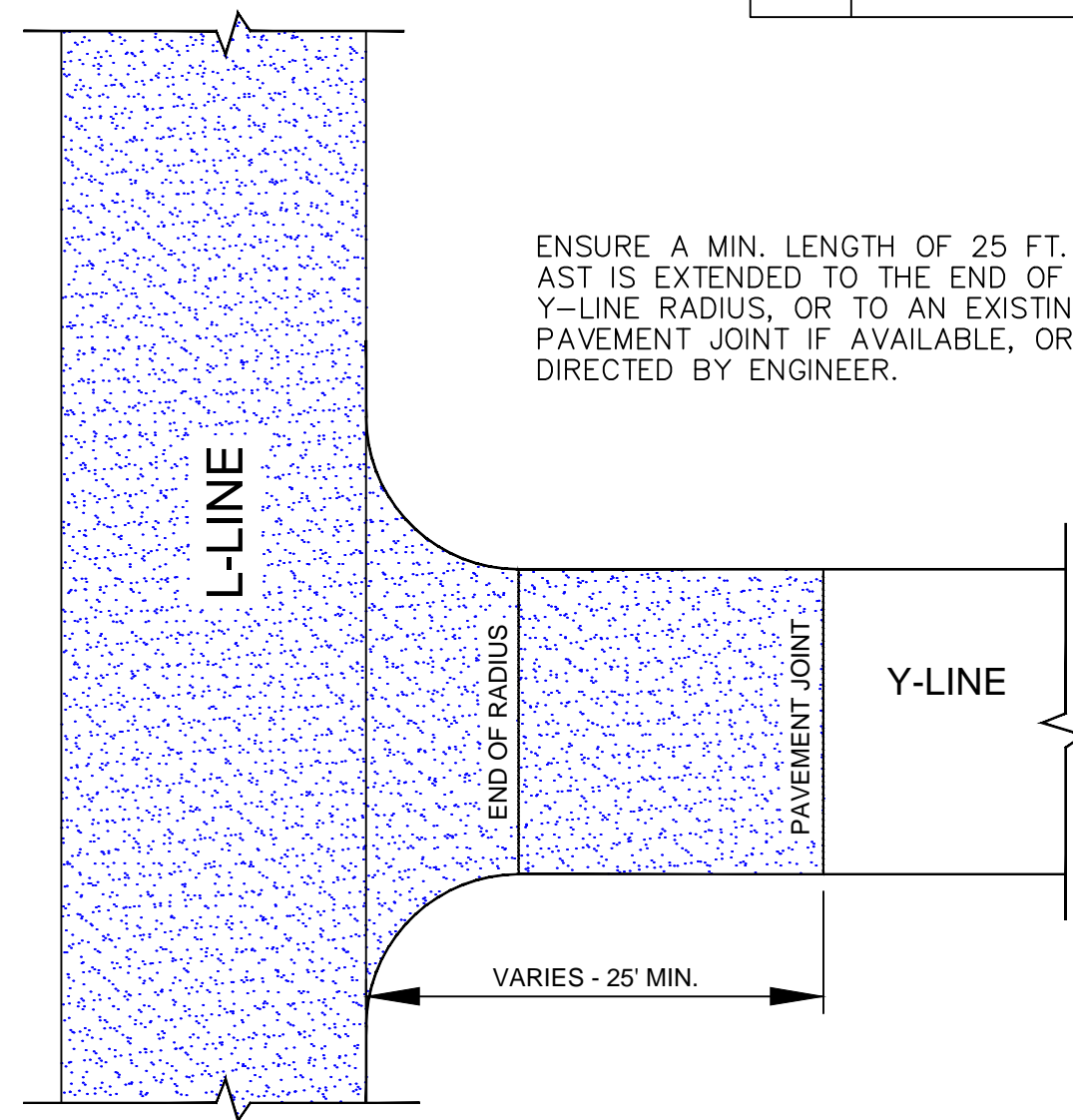

**DETAIL 1**  
Y-LINE INTERSECTION TREATMENT

# SIGNING FOR ASPHALT SURFACE TREATMENT

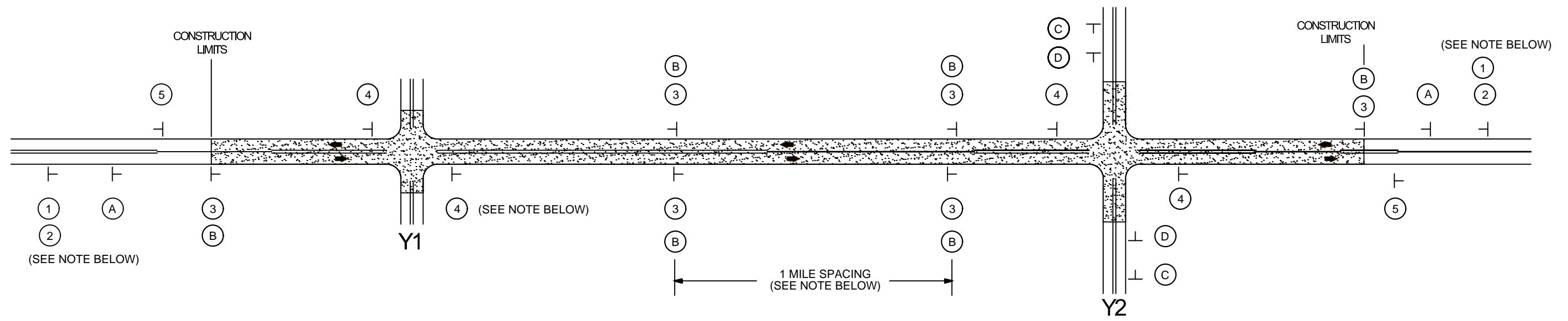

## MAINLINE (-L-) SIGNING

## -Y- LINE SIGNING

SIGNING NOTES AND PLACEMENT PER DIRECTION	 	<p>PLACE 1000' PRIOR TO BEGINNING OF CONSTRUCTION LIMITS.</p> <p>#2 SIGN ONLY USED WHEN RESURFACING LIMITS ARE 2 OR MORE MILES IN LENGTH. ROUND UP TO NEXT WHOLE NUMBER. (NO FRACTIONAL OR DECIMAL NUMBERS)</p>
	 	<p>ALTERNATE THE FOLLOWING TWO SIGNS: STARTING WITH "LOOSE GRAVEL" (W8-7) FOLLOWED BY "UNMARKED PAVEMENT".</p> <p>PLACE INITIALLY AT THE CONSTRUCTION LIMITS AND SPACED 1 MILE APART THEREAFTER. IF NO -Y- LINES EXIST, PLACE 2ND SET 1/2 MILE FROM THE CONSTRUCTION LIMITS AND THEN SPACE 1 MILE THEREAFTER.</p>
		<p>PLACE 500' PRIOR TO BEGINNING OF CONSTRUCTION LIMITS.</p>
		<p>PLACE INITIALLY AT THE CONSTRUCTION LIMITS AND SPACED 1 MILE APART THEREAFTER. IF NO -Y- LINES EXIST, PLACE 2ND SET 1/2 MILE FROM THE CONSTRUCTION LIMITS AND THEN SPACE 1 MILE THEREAFTER. SPEED LIMIT SIGN MAY BE PLACED ON SAME PART AS LOOSE GRAVEL SIGN, IF DESIRED. IF SO, ELIMINATE WORK ZONE SIGN (G20-5aP).</p>
		<p>THESE ARE FOR -Y- LINES THAT ARE "THROUGH" ROADWAYS. DEAD END AND SUBDIVISION ROADS ARE NOT "THROUGH" ROADWAYS. INSTALL 500' +/- FROM EACH -Y- LINE APPROACH AS SHOWN ABOVE. FOR MULTIPLE -Y- LINES THAT ARE SEPARATED BY 0.25 MILES OR LESS, TREAT AS A SINGLE UNIT AND INSTALL WITHIN 500' OF EACH APPROACH. A MAXIMUM OF 2 SIGN SETS PER MILE. DO NOT INSTALL WHEN -Y- LINES ARE WITHIN 0.5 MILES FROM "END ROAD WORK" SIGN.</p>
		<p>PLACE 500' FOLLOWING THE END OF CONSTRUCTION LIMITS.</p>

ADVANCE WARNING PORTABLE SIGNS MAY BE USED IN LIEU OF STATIONARY SIGNS ALONG THE -Y- LINE AS SHOWN BELOW. REMOVE UPON COMPLETION OF WORK EACH DAY. UNDER NO CIRCUMSTANCES SHALL PORTABLE SIGNS BE LEFT IN PLACE WHEN NO CONSTRUCTION ACTIVITY IS OCCURRING, OR WHEN CONTRACTOR IS NOT ON SITE.

PLACED 500' IN ADVANCE OF FLAGGER.

PLACED 250' IN ADVANCE OF FLAGGER.

**NO REQUIRED STATIONARY SIGNING FOR THE FOLLOWING -Y- LINE CONDITIONS:**

- 1 SUBDIVISION ROADS
- 2 DEAD END ROADS

**LEGEND**

└ STATIONARY SIGN

➔ DIRECTION OF TRAFFIC FLOW

**NOTE:**  
IT IS THE CONTRACTOR'S RESPONSIBILITY TO ENSURE THE PROPER PLACEMENT AND LOCATION OF WORK ZONE SIGNING PER THE STANDARD DRAWING. NCDOT HAS THE RIGHT TO INSPECT THE PLANNED LOCATIONS AND REQUIRE ADJUSTMENT BY THE CONTRACTOR, AS NEEDED, OR AS DIRECTED BY THE ENGINEER.

ADVANCE WARNING SIGNS  
FOR  
ASPHALT SURFACE  
TREATMENTS

OR OTHER ENGINEER APPROVED METHOD