

STATE OF NORTH CAROLINA
DEPARTMENT OF TRANSPORTATION
HIGHWAY DIVISION 6

PLANS

Letting Date: October 19, 2022

CONTRACT ID: DF00412

TIP NO.: -----

FEDERAL AID NO.: STATE FUNDED

WBS ELEMENT NO.: 2023CPT.06.02.10261.1 & 2023CPT.06.02.20261.1

ROUTE NO.: NC 690 & Various SR Routes

LOCATION: Various

COUNTY: Cumberland

LENGTH OF PROJECT: 18.81 MILES

TYPE OF WORK: RESURFACING, MILLING & PVT. MKGS.

**This electronic collection of documents is provided
for the convenience of the user
and is Not a Certified Document –**

**The documents contained herein were originally issued
and sealed by the individuals whose names and license
numbers appear on each page, on the dates appearing
with their signature on that page.**

**This file or an individual page
shall not be considered a certified document.**

PAVEMENT SCHEDULE

C1	1" ASPHALT CONCRETE SURFACE COURSE, TYPE S9.5B, AT AN AVERAGE RATE OF 110 LBS. PER SQ. YD.
C2	1½" ASPHALT CONCRETE SURFACE COURSE, TYPE S9.5B, AT AN AVERAGE RATE OF 165 LBS. PER SQ. YD.
C3	1½" ASPHALT CONCRETE SURFACE COURSE, TYPE S9.5C, AT AN AVERAGE RATE OF 168 LBS. PER SQ. YD.
E1	5½" ASPHALT CONCRETE BASE COURSE, TYPE B25.0C, AT AN AVERAGE RATE OF 627 LBS. PER SQ. YD.
F1	#67M MAT COAT
R1	EXISTING CURB AND GUTTER
T1	SHOULDER RECONSTRUCTION WITH AGGREGATE SHOULDER BORROW
U	EXISTING ASPHALT PAVEMENT
V1	0"-1½" MILLING (10' FROM EDGE OF PAVEMENT)
V2	¾" MILLING
V3	1½" MILLING

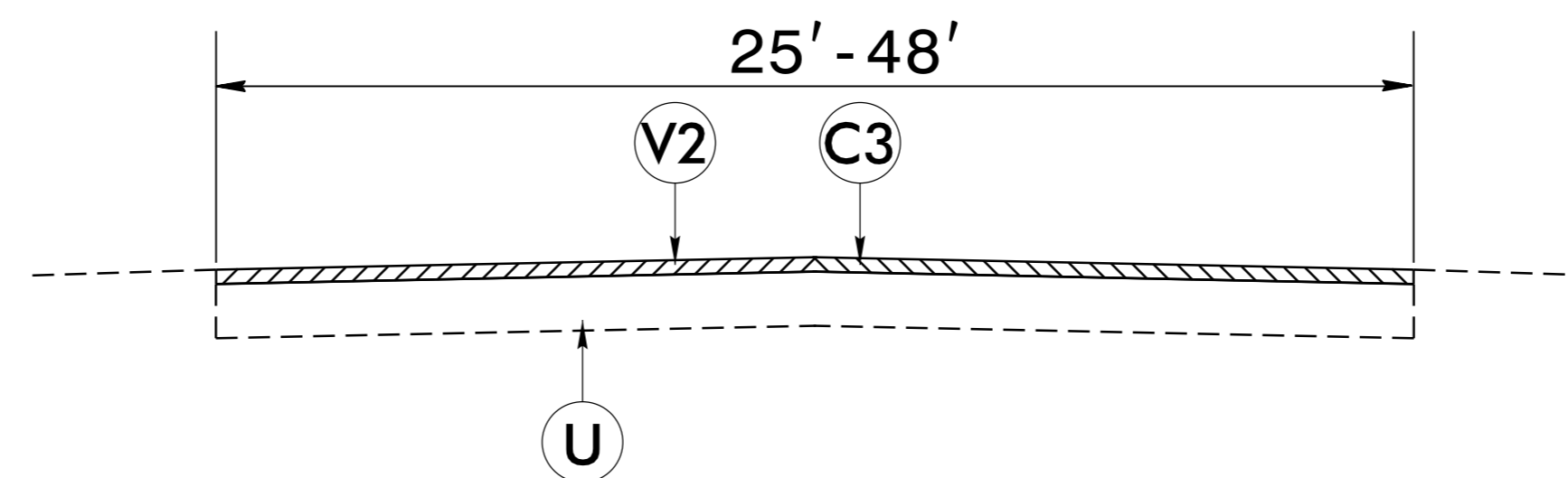

TYPICAL SECTION NO. 1

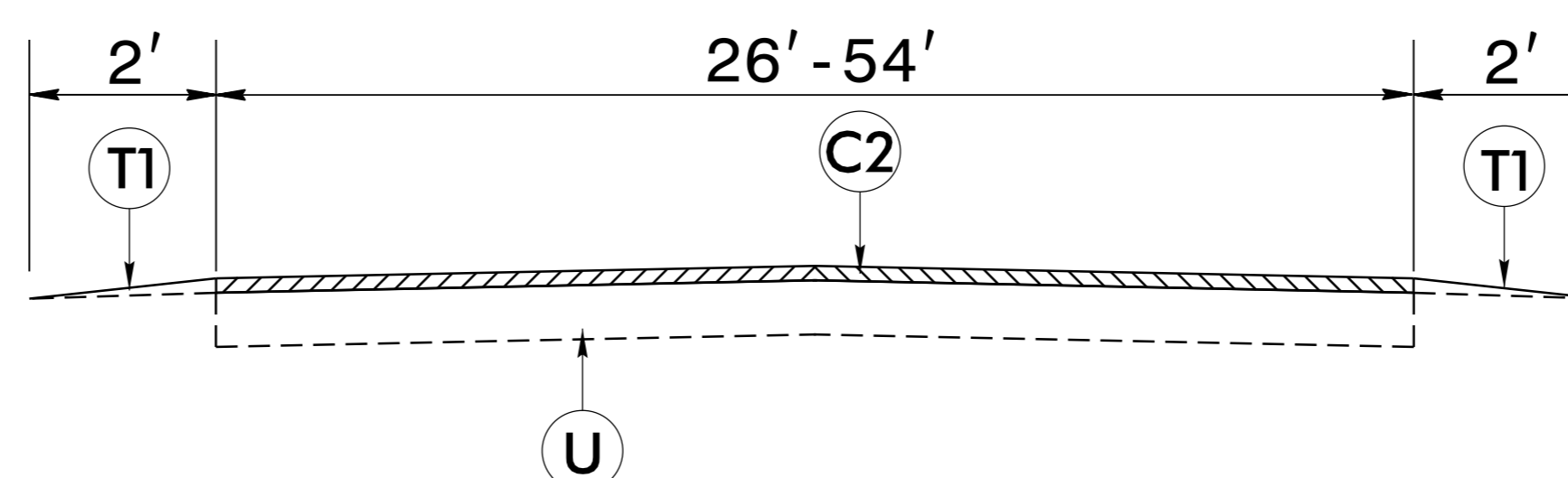

TYPICAL SECTION NO. 2

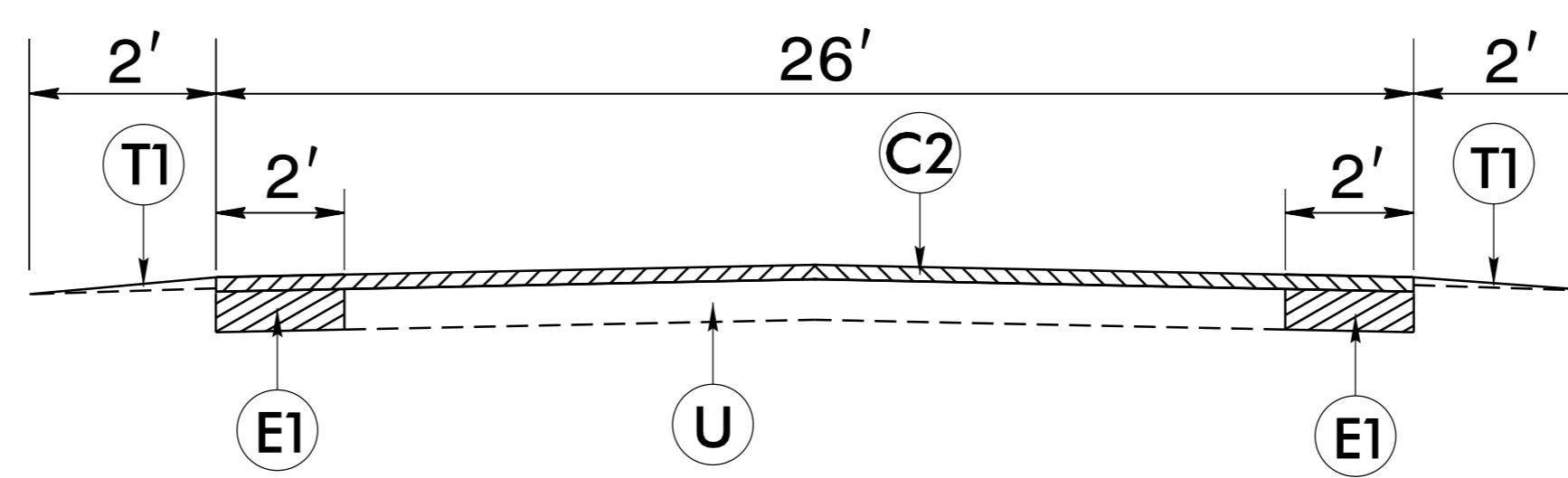

TYPICAL SECTION NO. 3

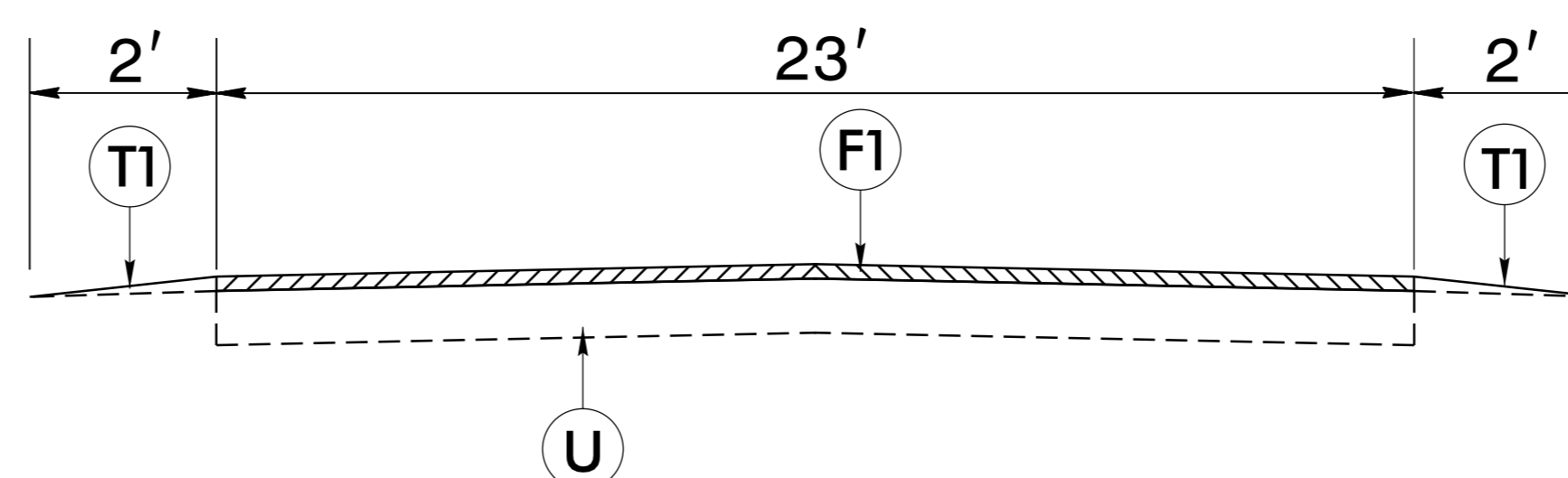

TYPICAL SECTION NO. 4

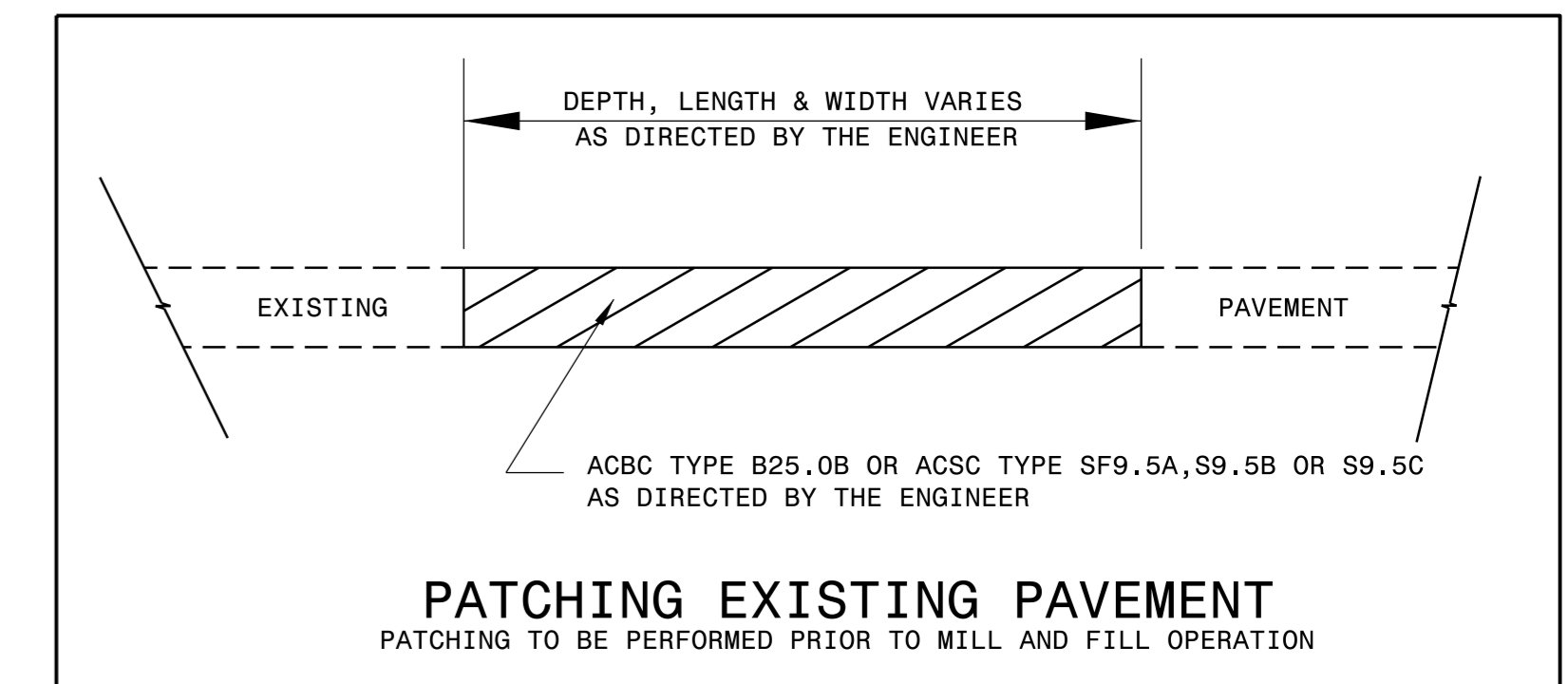
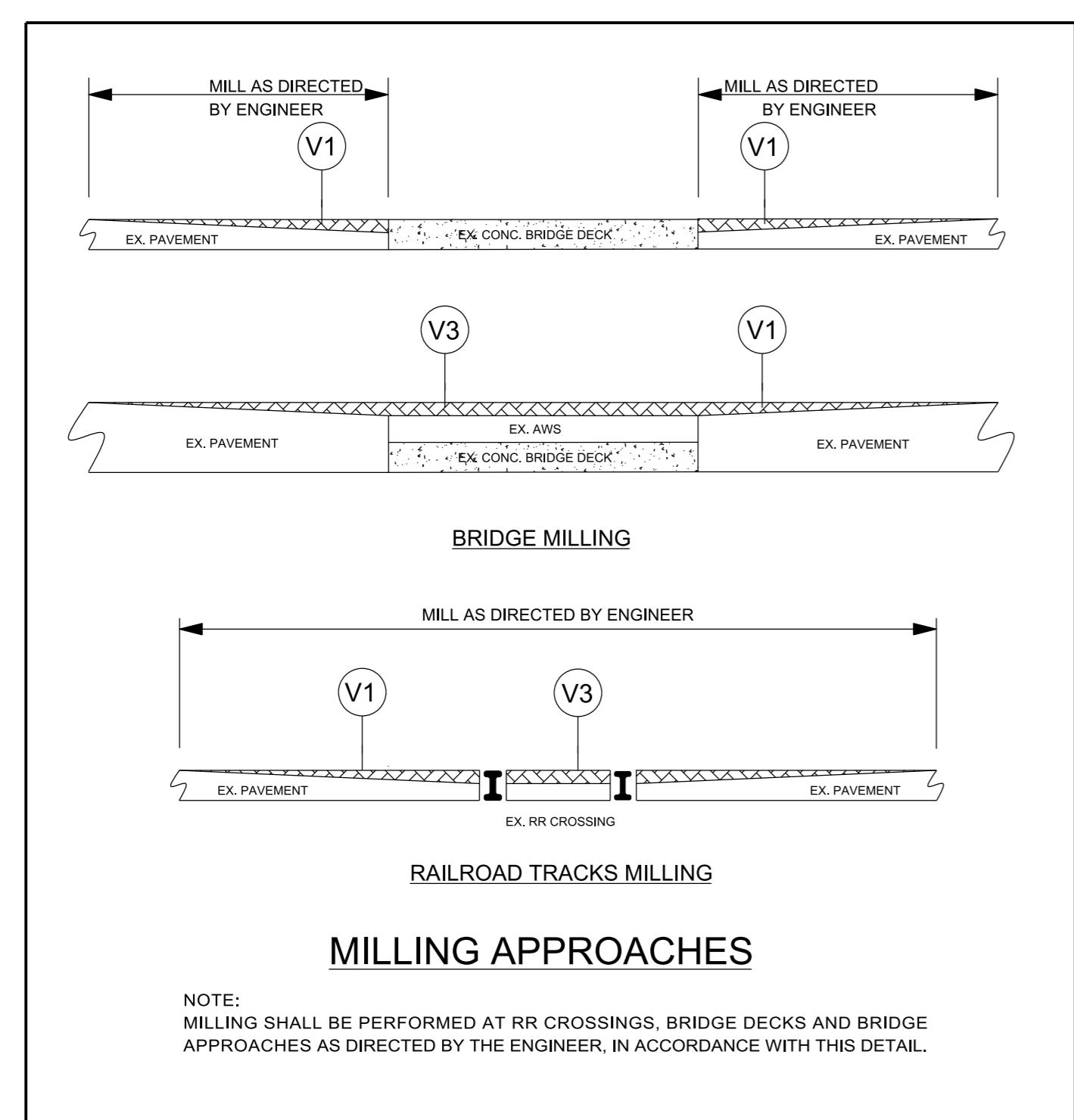

6/2/99 16-SEP-2022 08:42 \\work-Files\Projects\Resurfacing\2022 Fall\11\2\Cumber-1.mxd\typ.dgn

Cumberland County Resurfacing Fall 2022

WBS: 2023CPT.06.02.10261.1 & 2023CPT.06.02.20261.1

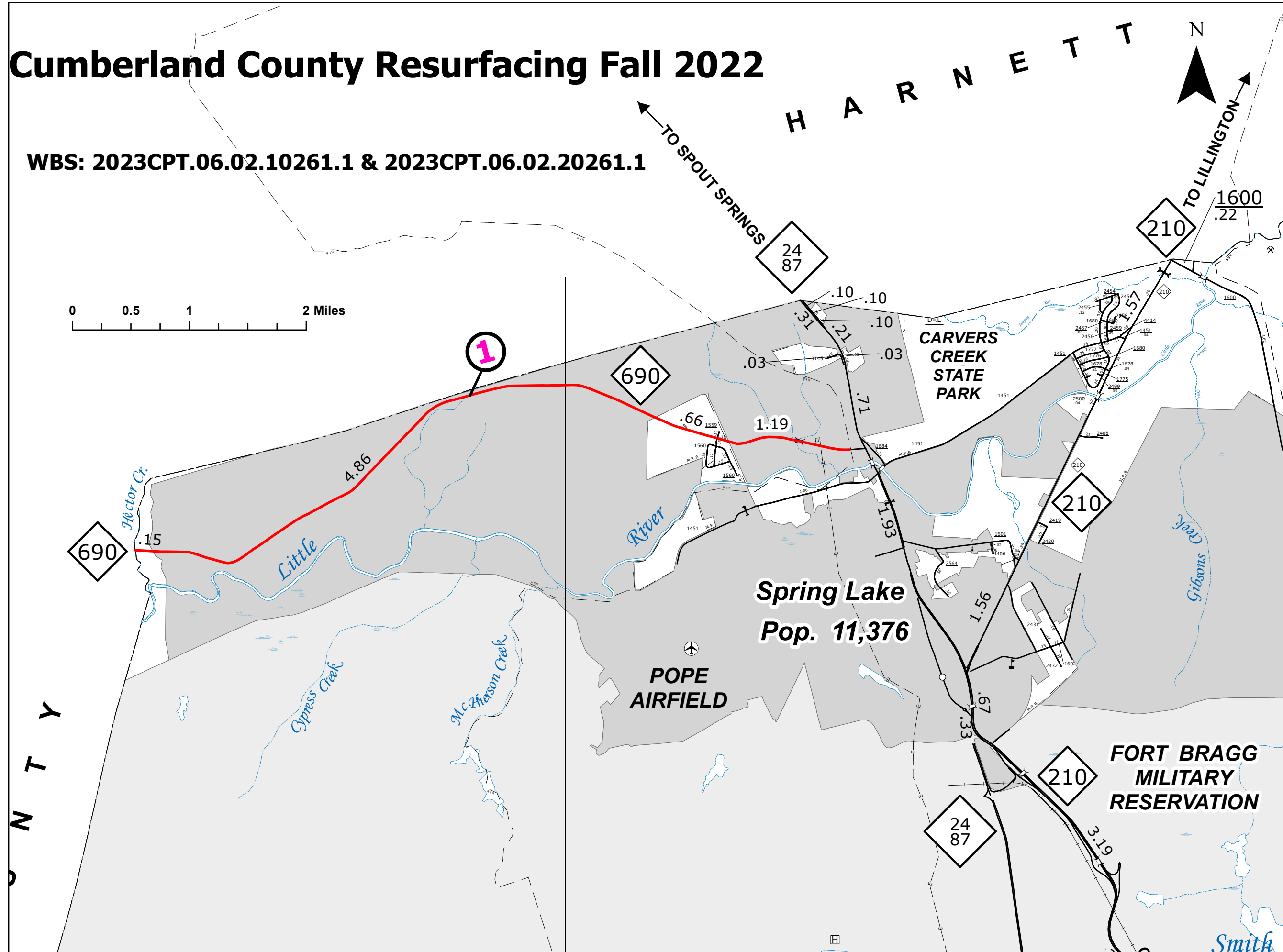
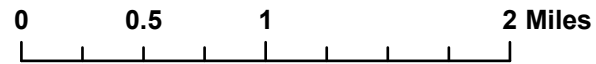

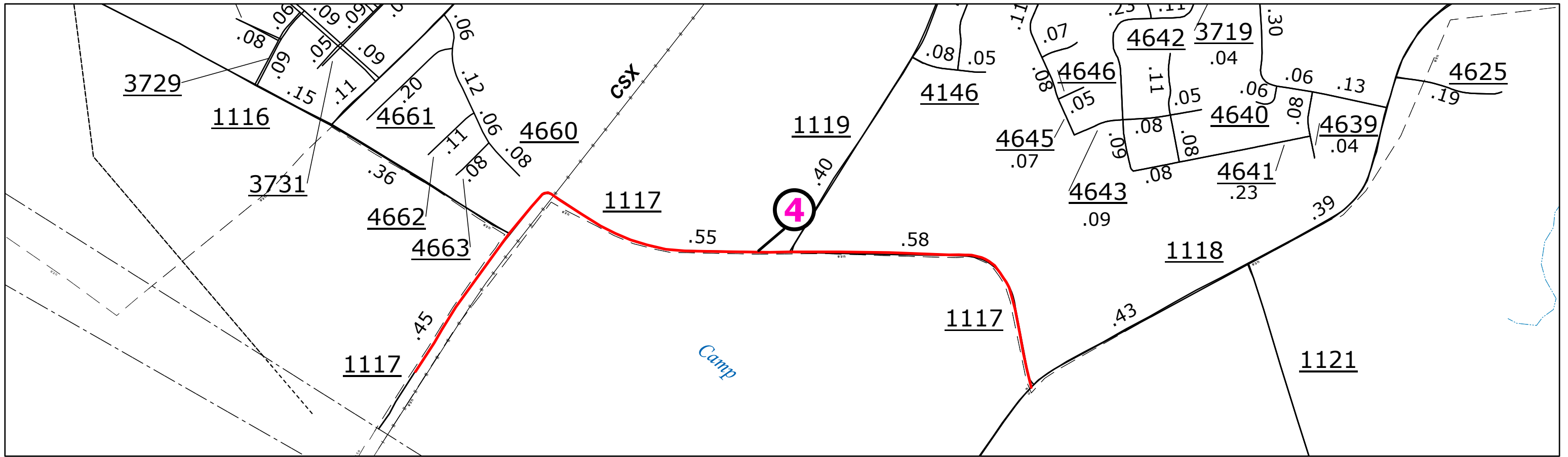

Cumberland County Resurfacing Fall 2022

WBS: 2023CPT.06.02.10261.1 & 2023CPT.06.02.20261.1

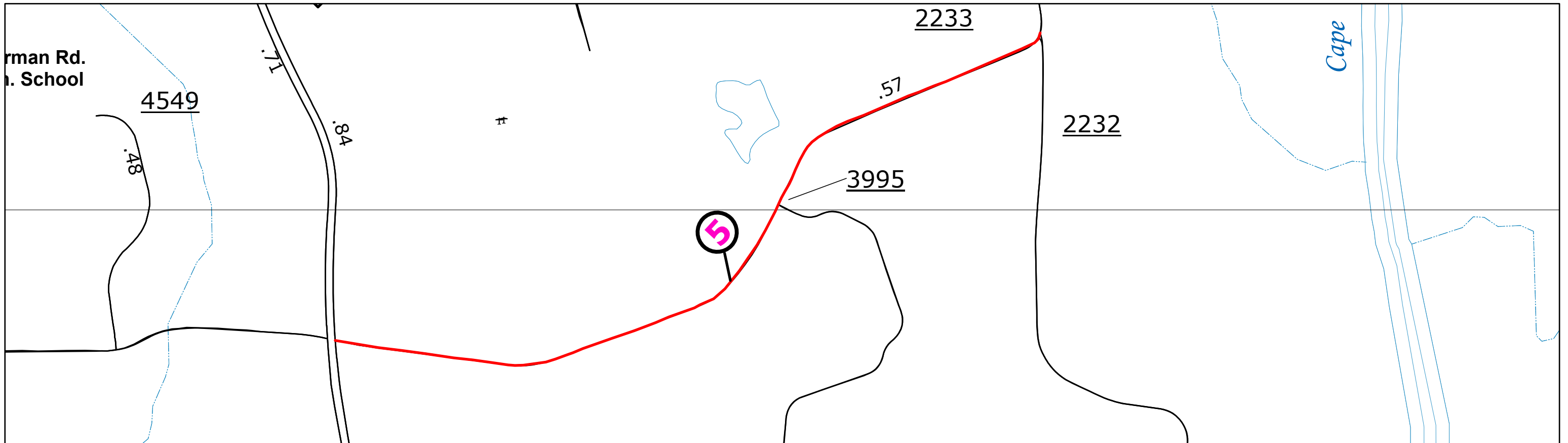
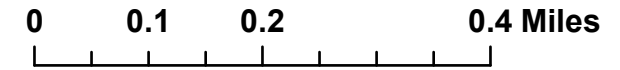

- NOTES:
 1) DETAIL DOES NOT APPLY TO OGAFD AND ULTRA-THIN BONDED WEARING COURSE.
 2) BACKFILL SHOULDER WITH APPROVED MATERIAL.
 3) THE SHOULDER WEDGE DEVICE MAY BE DISENGAGED AT PAVED DRIVEWAYS AND SIDE STREETS.

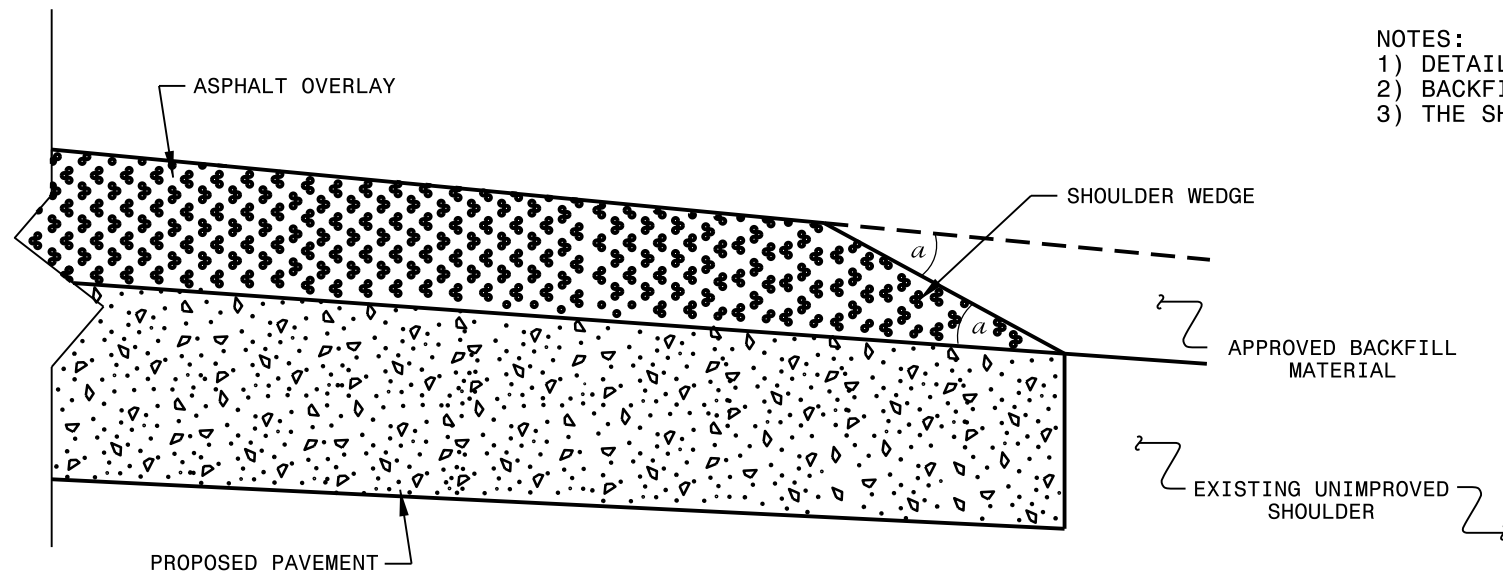

SHOULDER WEDGE DETAIL
 (Resurfacing Projects w/ Widening or
 with Existing Paved Shoulder having no dropoffs)

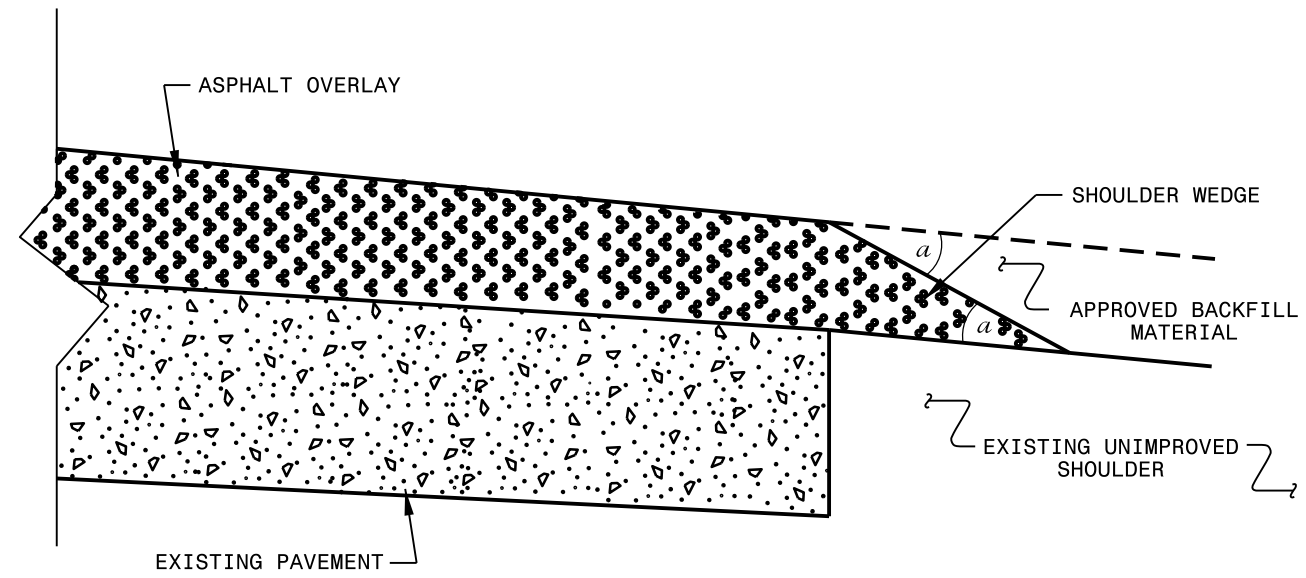

SHOULDER WEDGE DETAIL
 (Resurfacing Projects w/ NO Widening)

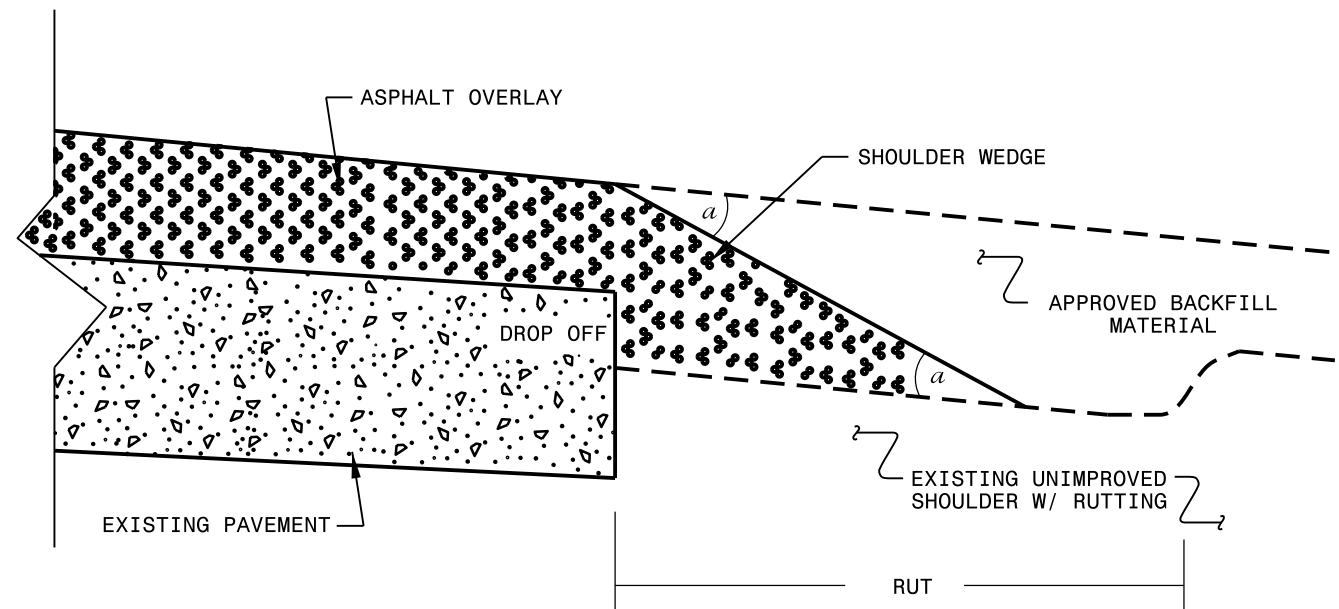

SHOULDER WEDGE DETAIL
 (Resurfacing Adjacent to
 Rutted Shoulder)

- SHOULDER WEDGE ANGLE = 30°

CONTRACT STANDARDS AND DEVELOPMENT UNIT	
Office 919-707-6950	FAX 919-250-4119
SHOULDER WEDGE DETAILS	
ORIGINAL BY: T.SPELL	DATE: 7-19-11
MODIFIED BY:	DATE: 10/16/12
CHECKED BY:	DATE:
FILE SPEC.: susr/details/stand/shoulderwedgedetail.dgn	

SYSTEMS DESIGN
 USER NAME

SIGNING FOR RESURFACING PROJECTS

LEGEND

┃ STATIONARY SIGN

← DIRECTION OF TRAFFIC FLOW

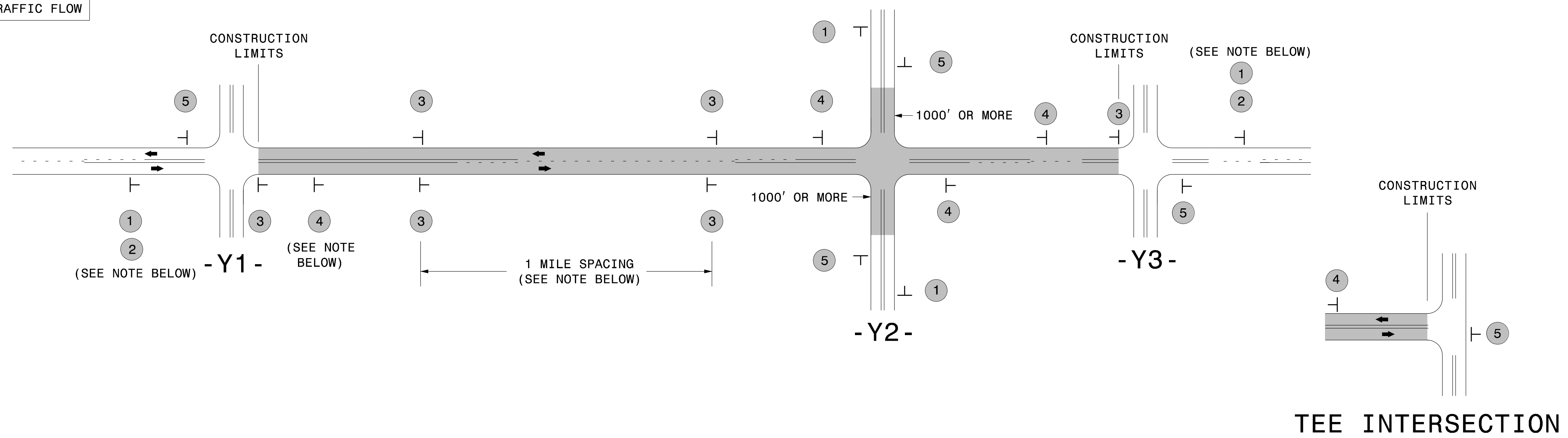

MAINLINE (-L-) SIGNING

-Y- LINE SIGNING

SIGNING NOTES AND PLACEMENT PER DIRECTION	1	 <small>W20-1 48" X 48"</small>	PLACE 1000' PRIOR TO BEGINNING OF CONSTRUCTION LIMITS. ONLY USED ON -Y- LINES IF RESURFACING LIMITS EXTEND 1000' ALONG -Y- LINE.	
	2	 <small>NEXT XX MILES W7-3aP 24" X 18"</small>	#2 SIGN ONLY USED WHEN CONSTRUCTION LIMITS ARE 2 OR MORE MILES IN LENGTH. ROUND UP TO NEXT WHOLE NUMBER. (NO FRACTIONAL OR DECIMAL NUMBERS)	
	3	 <small>SP 13107 48" X 48"</small>	- PLACE INITIALLY AT THE CONSTRUCTION LIMITS AND SPACE 1 MILE APART THEREAFTER. - AT TEE INTERSECTIONS INSTALL INITIALLY 1/2 MILE FROM INTERSECTION AND SPACE 1 MILE APART THEREAFTER.	
	4	 <small>SP 13106 48" X 48"</small>	- THESE ARE FOR -Y- LINES THAT ARE "THROUGH" ROADWAYS. - DEAD END AND SUBDIVISION ROADS ARE NOT "THROUGH" ROADWAYS. - INSTALL 500' +/- FROM EACH -Y- LINE APPROACH AS SHOWN ABOVE. - FOR MULTIPLE -Y- LINES THAT ARE SEPARATED BY 0.25 MILES OR LESS, TREAT AS A SINGLE UNIT AND INSTALL WITHIN 500' OF EACH APPROACH. - A MAXIMUM OF 2 SIGN SETS PER MILE. DO NOT INSTALL WHEN -Y- LINES ARE WITHIN 0.5 MILES FROM "END ROAD WORK" SIGN. - FOR TEE INTERSECTIONS, INSTALL WITHIN 500' +/- OF THE INTERSECTION ALONG -L- LINE.	
	5	 <small>G20-2 A 48" X 24"</small>	PLACE 500' FOLLOWING THE END OF CONSTRUCTION LIMITS OR AS SHOWN WHEN WORK ENDS AT A 3-WAY TEE INTERSECTION.	

NO REQUIRED STATIONARY SIGNING FOR THE FOLLOWING -Y- LINE CONDITIONS:

- 1) LESS THAN 1000' OF RESURFACING ALONG -Y- LINE
- 2) SUBDIVISION ROADS
- 3) DEAD END ROADS

WHEN PAVING/CONSTRUCTION ACTIVITIES PROCEED ACROSS AN UNSIGNED -Y- LINE, PORTABLE ADVANCE WARNING SIGNS SHALL BE USED ALONG THE -Y- LINE AS SHOWN BELOW. REMOVE UPON COMPLETION OF WORK.

 <small>W20-1 48" X 48"</small> PLACED 500' IN ADVANCE OF FLAGGER.	 <small>W20-7 A 48" X 48"</small> PLACED 250' IN ADVANCE OF FLAGGER.
--	--

THE ABOVE SIGNS ARE ALL THAT ARE REQUIRED FOR A CONTRACTOR TO BEGIN A RESURFACING CONTRACT. ANY ADDITIONAL SIGNS REQUESTED BY NCDOT DIVISIONS SHALL BE INSTALLED WITHIN 7 BUSINESS DAYS OF THE START OF CONTRACT WORK.

MAPS LESS THAN 2 MILES

FOR RESURFACING MAPS WITH CONSTRUCTION LIMITS LESS THAN 2 MILES IN LENGTH, NO STATIONARY SIGNS ARE REQUIRED. USE PORTABLE "ROAD UNDER CONSTRUCTION" OR "ROAD WORK AHEAD" SIGNS IN LIEU OF STATIONARY ADVANCE WARNINGS SIGNS.

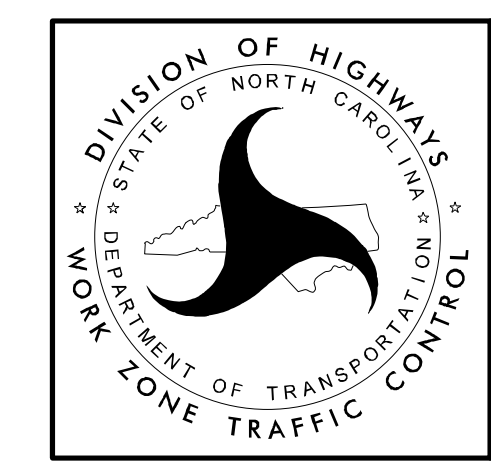

ADVANCE WARNING SIGNS FOR RURAL AND SUBURBAN 2-LANE ROADWAY RESURFACING

High Speed Detection (≥40 mph)

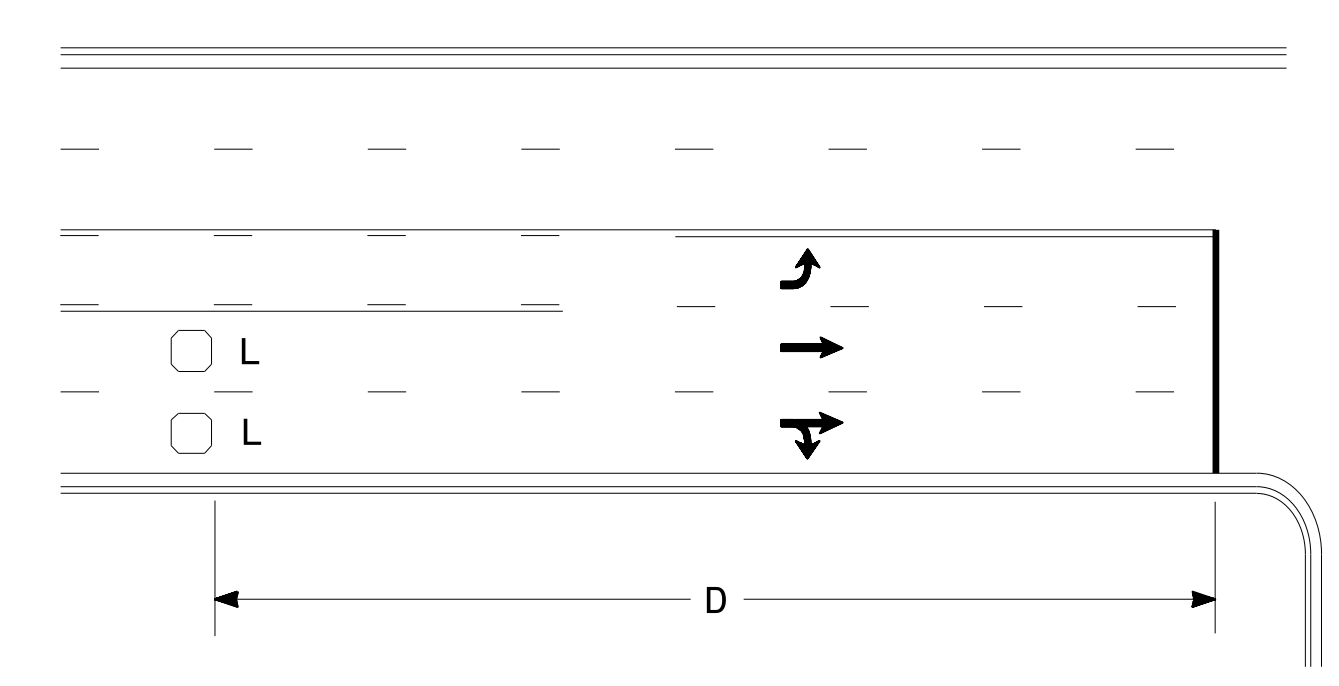

Speed Limit mph	D ft
40	250
45	300
50	355
55	420

L = 6ft X 6ft
Wired in series for TS1
Controllers
Wired separately for TS2,
170, and 2070L Controllers

Volume Density Operation

OR

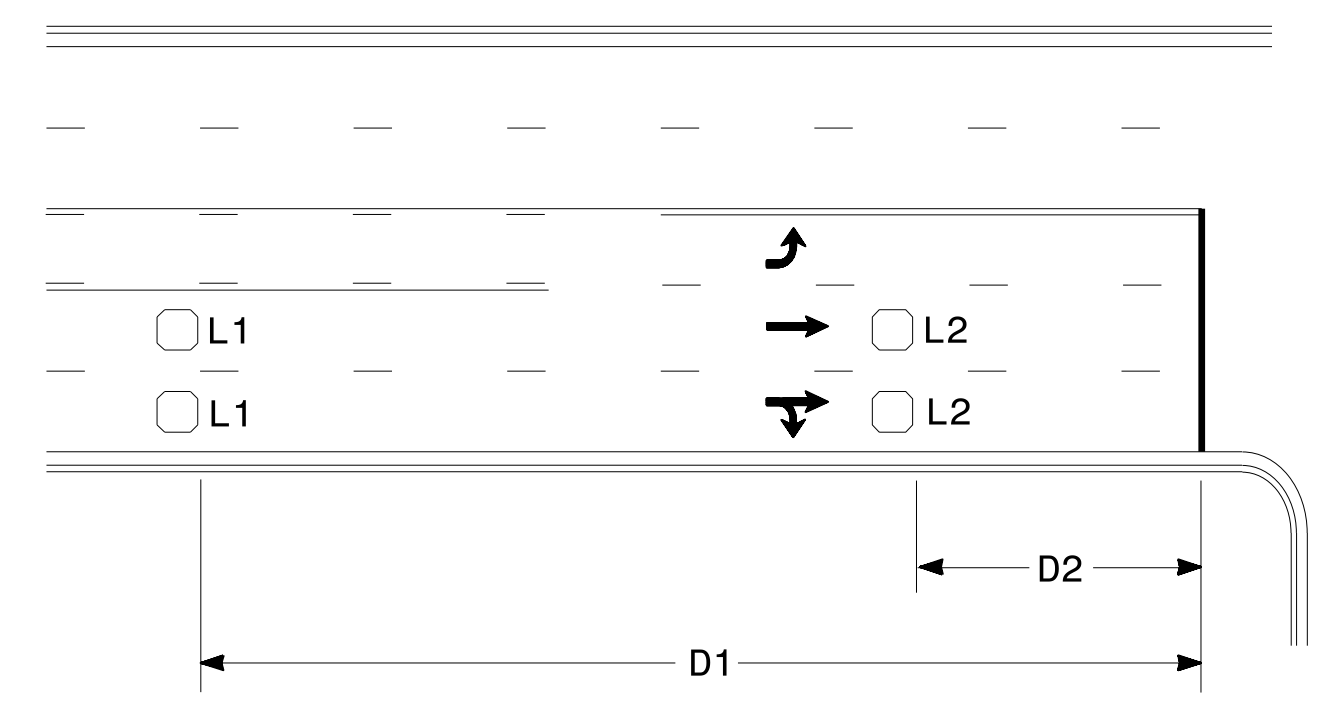

Speed Limit mph	D1 ft	D2 ft
40	250	80
45	300	90
50	355	100
55	420	110

L1 = 6ft X 6ft
Wired in series
L2 = 6ft X 6ft
Wired in series

"Stretch" Operation

Low Speed Detection (≤35 mph)

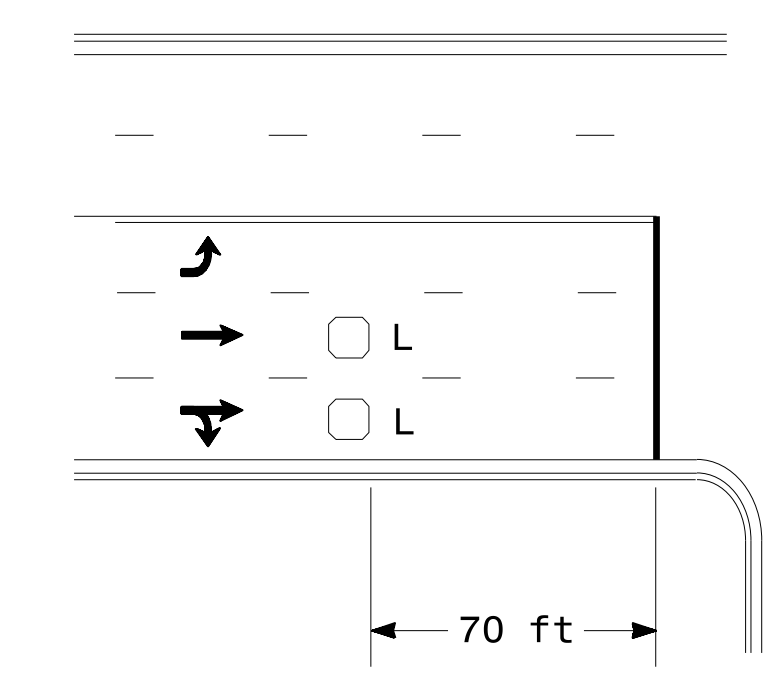

L = 6ft X 6ft
Wired in series

OR

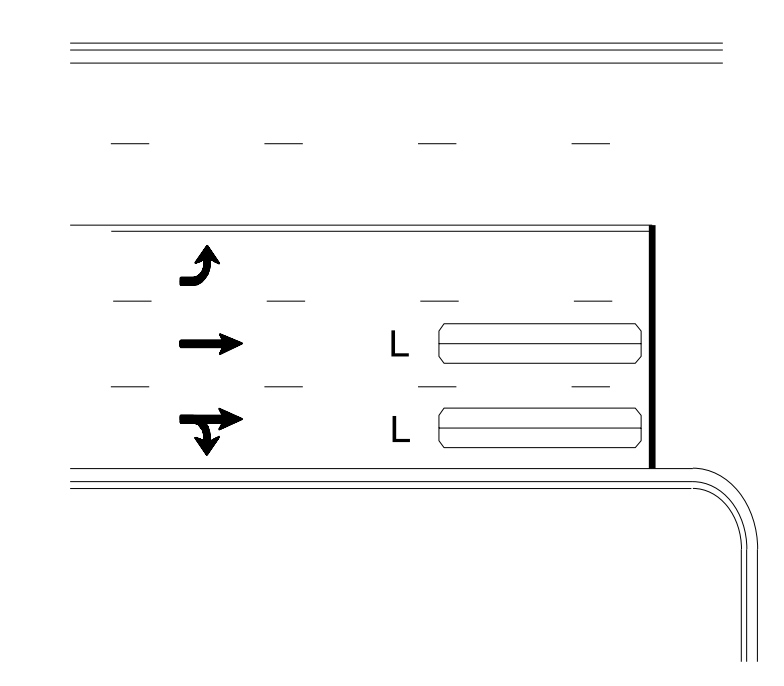

L = 6ft X 40ft
Quadrupole loop, wired separately

Left Turn Lane Detection

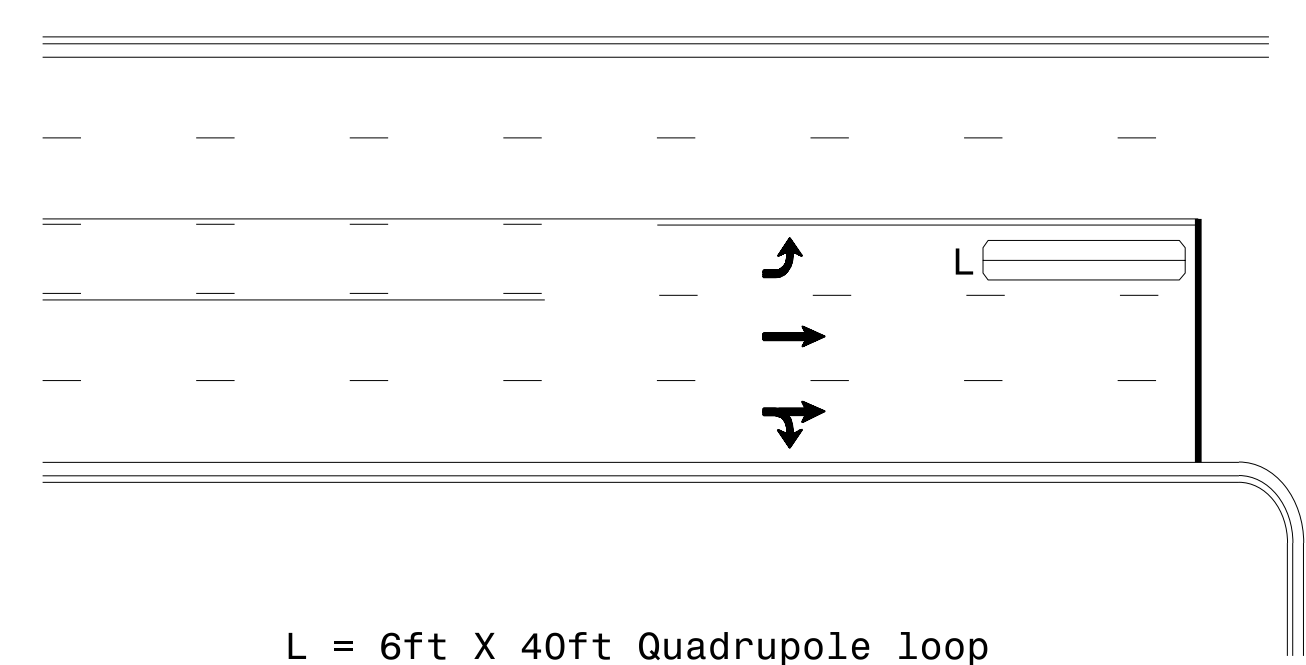

L = 6ft X 40ft Quadrupole loop

Presence Loop Detection

OR

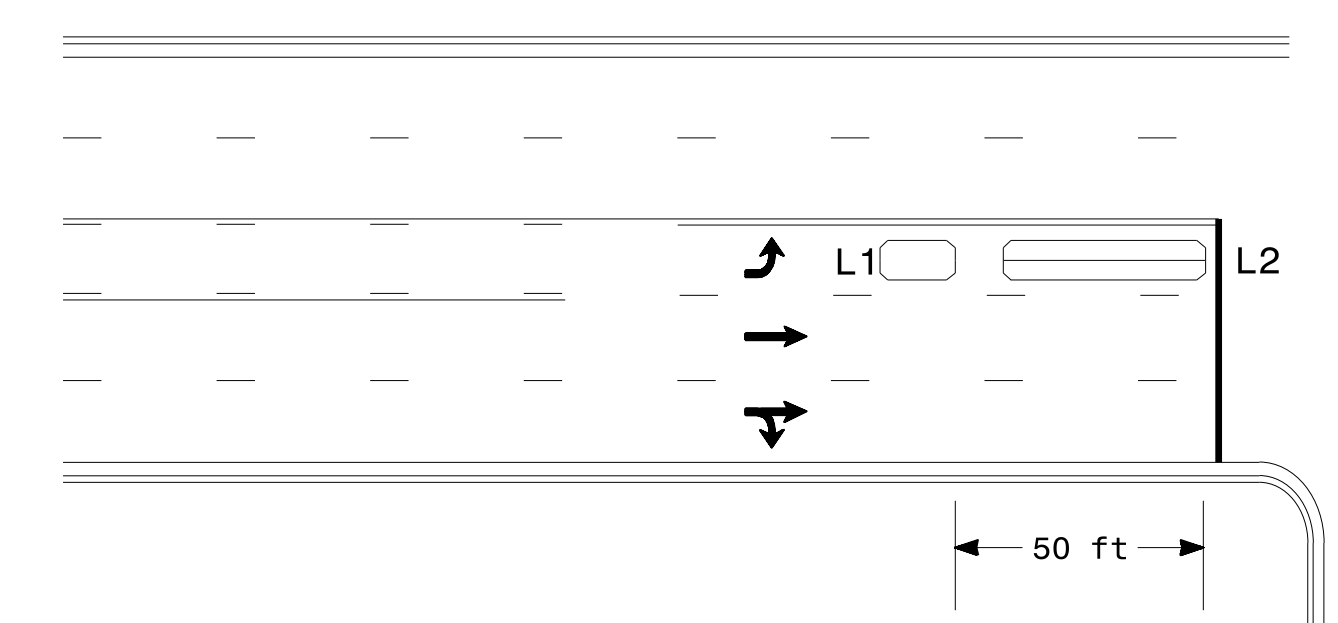

L1 = 6ft X 15ft Queue detector
L2 = 6ft X 40ft Quadrupole loop

Queue Loop Detection

Right Turn Lane Detection

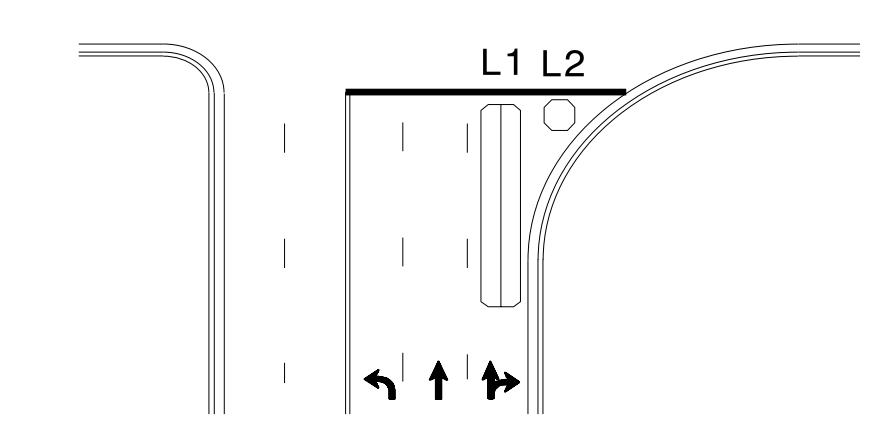

Shared Lane/
Wide Radius Turn

L1 = 6ft X 40ft Quadrupole loop
L2 = 6ft X 6ft [Minimum] Presence loop
Wired separately

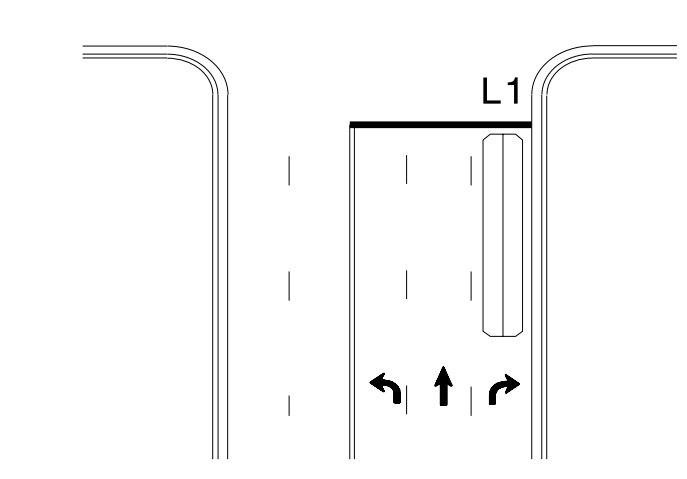

Standard Turn

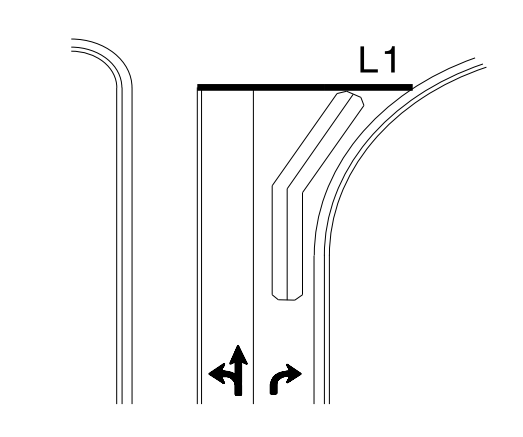

Wide Radius Turn

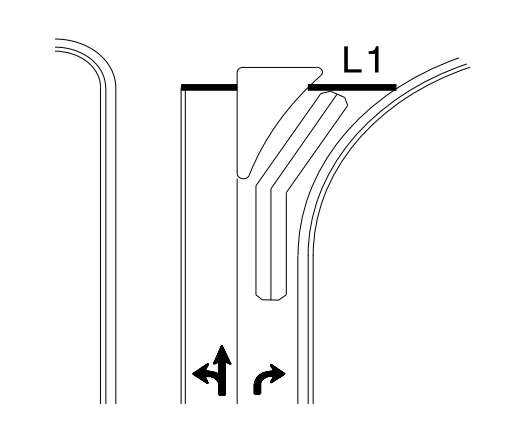

Channelized Turn

Side Street Detection

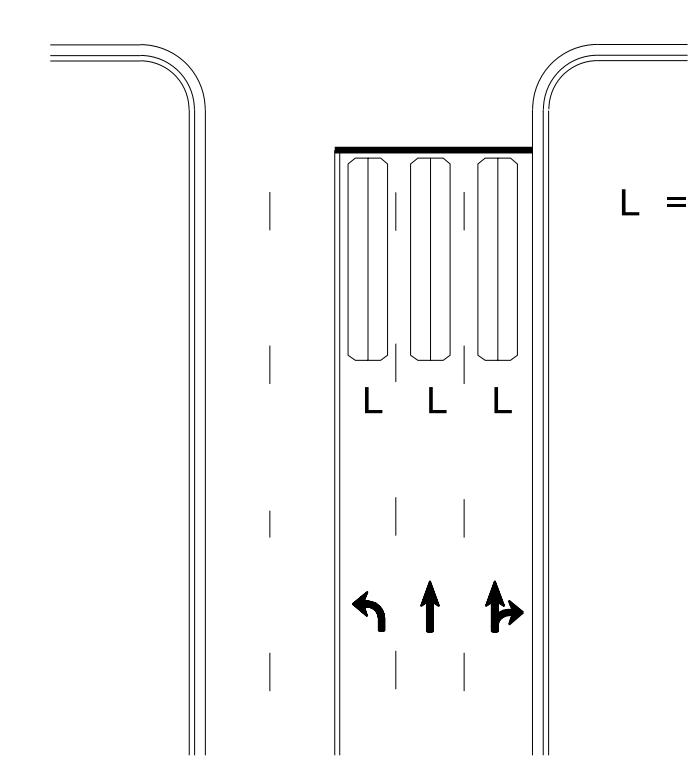

L = 6ft X 40ft
Quadrupole loop
Wired to separate
detectors/channels

Presence Loop Placement at Stop Lines

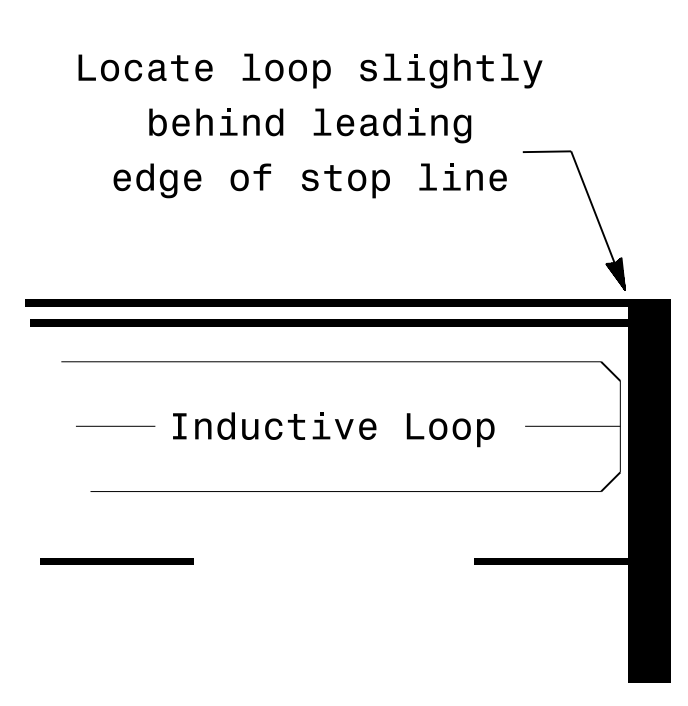

Locate loop slightly
behind leading
edge of stop line

Note:
Loop may be located in advance
of stop line under any of the
following conditions:
1) stop line is greater than 15'
from edge of intersecting
roadway
2) loop detects a permissive or
protected/permissive left turn
3) for an exclusive right turn
lane

Recommended Number of Turns

Single 6' X 6' loop
(when wired separately):

Length of Lead-in ft	Number of Turns
< 250	3
250-375	4
375-525	5
> 525	6

Quadrupole loops: Use 2-4-2 turns
6' X 15' Loops:
Lead-in < 150', use 2 turns
Lead-in > 150', use 3 turns

750 N. Greenfield Pkwy, Garner, NC 27529

Typical Signal Loop Locations

PLAN DATE: January 2015	REVIEWED BY: JPG
PREPARED BY: PLA	REVIEWED BY:
REVISIONS	INIT. DATE

SCALE: N/A

SEAL

1/30/2015

GUIDELINES FOR LANE WIDTHS ON RESURFACING PROJECTS

Contractor shall place the new pavement markings in accordance with this table and detail unless otherwise directed by the Engineer.

TWO LANE - TWO WAY ROADWAY - 55 MPH		
ROADWAY WIDTH	LANE WIDTH	SHOULDER WIDTH
18'	9' *	0'
20'	10' *	0'
22'	10'	1'
24'	10'	2'
26'	11'	2'
28'	12'	2'
32'	12'	4'

* May vary due to pavement width

TWO LANE - TWO WAY ROADWAY		50
MPH OR LESS		
ROADWAY WIDTH	LANE WIDTH	SHOULDER WIDTH
18'	9' *	0'
20'	10' *	0'
22'	10'	1'
24'	10'	2'
26'	11'	2'
28'	11'	3'
32'	11'	5'

* May vary due to pavement width

SCHEMATIC OF ROADWAY

(NOT TO SCALE)

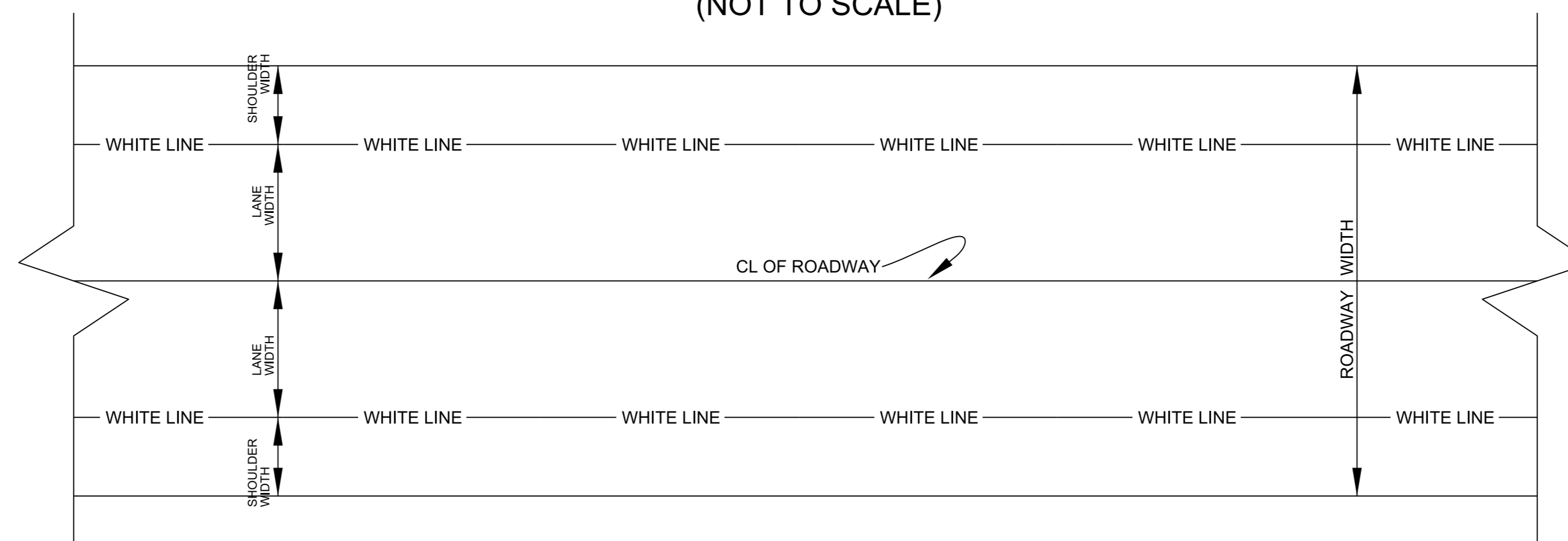

PROJECT NO	COUNTY	MAP NO	ROUTE	DESCRIPTION	TYP NO	LANES	LANE TYPE	FINAL SURFACE TESTING REQUIRED	WARM MIX ASPHALT REQUIRED	1523000000-E		1575000000-E	1704000000-E	1775500000-E	1838000000-E	2830000000-N	2845000000-N	7324000000-N	7444000000-E	
										SURFACE COURSE, S9.5C	ASPHALT BINDER FOR PLANT MIX	PATCHING EXISTING PAVEMENT	ASPHALT SURFACE TREATMENT, MATCOAT, #67 STONE	EMULSION FOR ASPHALT SURFACE TREATMENT	ADJ. OF MANHOLES	ADJ. OF METER OR VALVE BOX	JUNCTION BOX (STANDARD SIZE)	INDUCTIVE LOOP SAWCUT		
																			MI	FT
2023CPT.06.02.10261.1	Cumberland	1	NC HWY 690	FROM MOORECO. LINE MP 0.00 TO NC HWY 24/87 PVMT JT MP 6.74	1	2	2WU	NO	NO	6.74	25	8,602	516				1	1.00	450.00	
TOTAL FOR MAP NO. 1										6.74		8,602	516				1	1.00	450.00	
TOTAL FOR PROJ NO. 2023CPT.06.02.10261.1										6.74		8,602	516				1	1.00	450.00	
2023CPT.06.02.20261.1	Cumberland	2	SR 1106	FROM NC HWY 162 MP 0.00 TO SR 1104 MP 1.30	2	2	2WU	NO	NO	1.24	26		123	46			3	1.00	450.00	
TOTAL FOR MAP NO. 2										1.24		123	46				3	1.00	450.00	
2023CPT.06.02.20261.1	Cumberland	3	SR 1112	FROM SR 1140 MP 6.50 TO HOKE CO. LINE MP 8.32	2	2	2WU	NO	NO	1.82	29		168					1.00	500.00	
TOTAL FOR MAP NO. 3										1.82		168						1.00	500.00	
2023CPT.06.02.20261.1	Cumberland	4	SR 1117	FROM SR 1118 MP 0.00 TO END U-2519AA-AB PROJECT LIMITS MP 1.41	3	2	2WU	NO	NO	1.41	26		185							
TOTAL FOR MAP NO. 4										1.41		185								
2023CPT.06.02.20261.1	Cumberland	5	SR 2233	FROM SR 2232 MP 5.37 TO NC HWY 87 MP 6.82	4	2	2WU	NO	NO	1.38	23		105		18,621	8,007				
TOTAL FOR MAP NO. 5										1.38		105		18,621	8,007					
2023CPT.06.02.20261.1	Cumberland	6	SR 2299A	FROM US 301/I 95 BUS MP 0.00 TO SR 2311 MP 0.82	5	3	MU	NO	NO	0.79	33		85			20	10	1.00	600.00	
TOTAL FOR MAP NO. 6										0.79		85			20	10	1.00	600.00		
2023CPT.06.02.20261.1	Cumberland	7	SR 2299B	FROM SR 2311 MP 0.54 TO US 301/I 95 BUS MP 1.36	5	3	MU	NO	NO	0.79	33		85			36	21	1.00	600.00	
TOTAL FOR MAP NO. 7										0.79		85			36	21	1.00	600.00		
2023CPT.06.02.20261.1	Cumberland	8	SR 2311	FROM RXR PVMT JT MP 1.58 TO SR 2299 MP 2.31	5	5	MU	NO	NO	0.73	60		142			30	32	1.00	1,350.00	
TOTAL FOR MAP NO. 8										0.73		142			30	32	1.00	1,350.00		
2023CPT.06.02.20261.1	Cumberland	9	SR 3828	FROM NC24/87 ON & OFF RAMPS PVMT JT MP 0.05 TO WALTER ST PVMT JT MP 0.99	5	5	MU	NO	NO	0.94	60		194			39	21	2.00	2,600.00	
TOTAL FOR MAP NO. 9										0.94		194			39	21	2.00	2,600.00		
2023CPT.06.02.20261.1	Cumberland	10	SR 4160	FROM US HWY 401 MP 0.00 TO NC HWY 162 PVMT JT MP 0.60	5 &	3	2WU	NO	NO	0.58	38		83	6			6	1.00	1,000.00	
TOTAL FOR MAP NO. 10										0.58		83	6			6	1.00	1,000.00		
2023CPT.06.02.20261.1	Cumberland	11	SR 4617	FROM SR 1137 MP 0.00 TO SR 4619 MP 0.30	6	2	2WU	NO	NO	0.29	31		24			9	2			
TOTAL FOR MAP NO. 11										0.29		24			9	2				
2023CPT.06.02.20261.1	Cumberland	12	SR 4618	FROM SR 4623 MP 0.00 TO SR 4619 MP 0.91	6	2	2WU	NO	NO	0.9	31		66			34	17			
TOTAL FOR MAP NO. 12										0.9		66			34	17				
2023CPT.06.02.20261.1	Cumberland	13	SR 4619	FROM SR 4618 MP 0.00 TO CUL-DE-SAC MP 0.37	6	2	2WU	NO	NO	0.37	31		28			16	13			
TOTAL FOR MAP NO. 13										0.37		28			16	13				
2023CPT.06.02.20261.1	Cumberland	14	SR 4620	FROM SR 4619 MP 0.00 TO CUL-DE-SAC MP 0.03	6	2	2WU	NO	NO	0.03	31		3			1				
TOTAL FOR MAP NO. 14										0.03		3			1					
2023CPT.06.02.20261.1	Cumberland	15	SR 4621	FROM SR 4618 MP 0.00 TO CUL-DE-SAC MP 0.03	6	2	2WU	NO	NO	0.03	31		3			1				
TOTAL FOR MAP NO. 15										0.03		3			1					
2023CPT.06.02.20261.1	Cumberland	16	SR 4622	FROM SR 4618 MP 0.00 TO SR 4619 MP 0.23	6	2	2WU	NO	NO	0.23	31		17			5	5			
TOTAL FOR MAP NO. 16										0.23		17			5	5				
2023CPT.06.02.20261.1	Cumberland	17	SR 4623	FROM SR 4618 MP 0.00 TO CUL-DE-SAC MP 0.32	6	2	2WU	NO	NO	0.32	31		24			9	5			
TOTAL FOR MAP NO. 17										0.32		24			9	5				
2023CPT.06.02.20261.1	Cumberland	18	SR 4624	FROM SR 4618 MP 0.00 TO SR 4619 MP 0.22	6	2	2WU	NO	NO	0.22	31		16			3	4			
TOTAL FOR MAP NO. 18										0.22		16			3	4				
TOTAL FOR PROJ NO. 2023CPT.06.02.20261.1										12.07		1,351	52	18,621	8,007	203	139	8.00	7,100.00	
GRAND TOTAL										18.81		8,602	1,867	52	18,621	8,007	203	140	9.00	7,550.00

THERMOPLASTIC AND PAINT QUANTITIES

															PROJECT NO.		SHEET NO.	TOTAL NO.			
															2023CPT.06.02.10261.1, 2023CPT.06.02.20261.1						
PROJECT NO	COUNTY	MAP NO	ROUTE	DESCRIPTION	TYP NO	LANES	LANE TYPE	LENGTH		4413000000-E WORK ZONE ADVANCE/GENERAL WARNING SIGNING	4457000000-N TEMPORARY TRAFFIC CONTROL	4685000000-E		4688000000-E	4695000000-E	4700000000-E	4720000000-E		4725000000-E		
								MI	FT			4" X 90 M WHITE THERMO	4" X 90 M YELLOW THERMO	6" X 90 M WHITE THERMO	8" X 90 M WHITE THERMO	12" X 90 M YELLOW THERMO	THERMO MSG ONLY 90 M	THERMO MSG SCHOOL 90 M	THERMO LT ARROW 90 M	THERMO STR & RT ARROW 90 M	
									SF	LS	LF	LF	LF	LF	LF	EA	EA	EA	EA		
2023CPT.06.02.10261.1	Cumberland	1	NC HWY 690	FROM MOORECO. LINE MP 0.00 TO NC HWY 24/87 PVMT JT MP 6.74	1	2	2WU	6.74	25	757	1.00	72,653	61,757			25			3	2	
TOTAL FOR MAP NO. 1								6.74		757	1	72,653	61,757			25			3	2	
TOTAL FOR PROJ NO. 2023CPT.06.02.10261.1								6.74		757	1	72,653	61,757			25			3	2	
											134,410						5				
2023CPT.06.02.20261.1	Cumberland	2	SR 1106	FROM NC HWY 162 MP 0.00 TO SR 1104 MP 1.30	2	2	2WU	1.24	26	139		13,728	16,018			420			6	2	
TOTAL FOR MAP NO. 2								1.24		139		13,728	16,018			420			6	2	
2023CPT.06.02.20261.1	Cumberland	3	SR 1112	FROM SR 1140 MP 6.50 TO HOKE CO. LINE MP 8.32	2	2	2WU	1.82	29	257		19,219	19,735			800			3		
TOTAL FOR MAP NO. 3								1.82		257		19,219	19,735			800			3		
2023CPT.06.02.20261.1	Cumberland	4	SR 1117	FROM SR 1118 MP 0.00 TO END U- 2519AA-AB PROJECT LIMITS MP 1.41	3	2	2WU	1.41	26	158		14,890	12,660								
TOTAL FOR MAP NO. 4								1.41		158		14,890	12,660								
2023CPT.06.02.20261.1	Cumberland	5	SR 2233	FROM SR 2232 MP 5.37 TO NC HWY 87 MP 6.82	4	2	2WU	1.38	23	155		14,573	13,116								
TOTAL FOR MAP NO. 5								1.38		155		14,573	13,116								
2023CPT.06.02.20261.1	Cumberland	6	SR 2299A	FROM US 301/I 95 BUS MP 0.00 TO SR 2311 MP 0.82	5	3	MU	0.79	33	88			4,382		400		8			4	
TOTAL FOR MAP NO. 6								0.79		88			4,382		400		8			4	
2023CPT.06.02.20261.1	Cumberland	7	SR 2299B	FROM SR 2311 MP 0.54 TO US 301/I 95 BUS MP 1.36	5	3	MU	0.79	33	88			4,382		270				1	2	
TOTAL FOR MAP NO. 7								0.79		88			4,382		270				1	2	
2023CPT.06.02.20261.1	Cumberland	8	SR 2311	FROM RXR PVMT JT MP 1.58 TO SR 2299 MP 2.31	5	5	MU	0.73	60	82			6,316		897	90	8		17	3	
TOTAL FOR MAP NO. 8								0.73		82			6,316		897	90	8		17	3	
2023CPT.06.02.20261.1	Cumberland	9	SR 3828	FROM NC24/87 ON & OFF RAMPS PVMT JT MP 0.05 TO WALTER ST PVMT JT MP 0.99	5	5	MU	0.94	60	105			8,775	635	1,992				32	11	
TOTAL FOR MAP NO. 9								0.94		105			8,775	635	1,992				32	11	
2023CPT.06.02.20261.1	Cumberland	10	SR 4160	FROM US HWY 401 MP 0.00 TO NC HWY 162 PVMT JT MP 0.60	5 &	3	2WU	0.58	38	75		6,864	8,866		250	100	4	12	24	2	
TOTAL FOR MAP NO. 10								0.58		75		6,864	8,866		250	100	4	12	24	2	
2023CPT.06.02.20261.1	Cumberland	11	SR 4617	FROM SR 1137 MP 0.00 TO SR 4619 MP 0.30	6	2	2WU	0.29	31	36											
TOTAL FOR MAP NO. 11								0.29		36											
2023CPT.06.02.20261.1	Cumberland	12	SR 4618	FROM SR 4623 MP 0.00 TO SR 4619 MP 0.91	6	2	2WU	0.9	31	101											
TOTAL FOR MAP NO. 12								0.9		101											
2023CPT.06.02.20261.1	Cumberland	13	SR 4619	FROM SR 4618 MP 0.00 TO CUL-DE- SAC MP 0.37	6	2	2WU	0.37	31	41											
TOTAL FOR MAP NO. 13								0.37		41											
2023CPT.06.02.20261.1	Cumberland	14	SR 4620	FROM SR 4619 MP 0.00 TO CUL-DE- SAC MP 0.03	6	2	2WU	0.03	31	4											
TOTAL FOR MAP NO. 14								0.03		4											
2023CPT.06.02.20261.1	Cumberland	15	SR 4621	FROM SR 4618 MP 0.00 TO CUL-DE- SAC MP 0.03	6	2	2WU	0.03	31	4											
TOTAL FOR MAP NO. 15								0.03		4											
2023CPT.06.02.20261.1	Cumberland	16	SR 4622	FROM SR 4618 MP 0.00 TO SR 4619 MP 0.23	6	2	2WU	0.23	31	26											
TOTAL FOR MAP NO. 16								0.23		26											
2023CPT.06.02.20261.1	Cumberland	17	SR 4623	FROM SR 4618 MP 0.00 TO CUL-DE- SAC MP 0.32	6	2	2WU	0.32	31	36											
TOTAL FOR MAP NO. 17								0.32		36											
2023CPT.06.02.20261.1	Cumberland	18	SR 4624	FROM SR 4618 MP 0.00 TO SR 4619 MP 0.22	6	2	2WU	0.22	31	25											
TOTAL FOR MAP NO. 18								0.22		25											
TOTAL FOR PROJ NO. 2023CPT.06.02.20261.1								12.07		1,420	1	69,274	94,250	635	3,809	1,410	20	12	83	24	
											163,524		32		107						
GRAND TOTAL								18.81		2,177	1	141,927	156,007	635	3,809	1,435	20	12	86	26	
											297,934		32		112						

PROJECT NO	COUNTY	MAP NO	ROUTE	DESCRIPTION	TYP NO	LANES	LANE TYPE	LENGTH		WIDTH	4725000000-E			4810000000-E		4820000000-E	4830000000-E	4835000000-E	4840000000-N	
								MI	FT		THERMO RT ARROW 90 M	THERMO STR & LT ARROW 90 M	THERMO STR ARROW 90 M	4" YELLOW PAINT	4" WHITE PAINT	8" WHITE PAINT	16" WHITE PAINT	24" WHITE PAINT	PAINT MSG RXR	PAINT MSG ONLY
								EA	EA		EA	LF	LF	LF	LF	LF	EA	EA		
2023CPT.06.02.10261.1	Cumberland	1	NC HWY 690	FROM MOORECO. LINE MP 0.00 TO NC HWY 24/87 PVMT JT MP 6.74	1	2	2WU	6.74	25				61,757	100			20			
TOTAL FOR MAP NO. 1								6.74					61,757	100			20			
TOTAL FOR PROJ NO. 2023CPT.06.02.10261.1								6.74					61,757	100			20			
											61,857									
2023CPT.06.02.20261.1	Cumberland	2	SR 1106	FROM NC HWY 162 MP 0.00 TO SR 1104 MP 1.30	2	2	2WU	1.24	26		2									
TOTAL FOR MAP NO. 2								1.24			2									
2023CPT.06.02.20261.1	Cumberland	3	SR 1112	FROM SR 1140 MP 6.50 TO HOKE CO. LINE MP 8.32	2	2	2WU	1.82	29		4	2								
TOTAL FOR MAP NO. 3								1.82			4	2								
2023CPT.06.02.20261.1	Cumberland	4	SR 1117	FROM SR 1118 MP 0.00 TO END U-2519AA-AB PROJECT LIMITS MP 1.41	3	2	2WU	1.41	26											
TOTAL FOR MAP NO. 4								1.41												
2023CPT.06.02.20261.1	Cumberland	5	SR 2233	FROM SR 2232 MP 5.37 TO NC HWY 87 MP 6.82	4	2	2WU	1.38	23											
TOTAL FOR MAP NO. 5								1.38												
2023CPT.06.02.20261.1	Cumberland	6	SR 2299A	FROM US 301/I 95 BUS MP 0.00 TO SR 2311 MP 0.82	5	3	MU	0.79	33		2	4	1	4,382	1,400	400	180	290	4	8
TOTAL FOR MAP NO. 6								0.79			2	4	1	4,382	1,400	400	180	290	4	8
2023CPT.06.02.20261.1	Cumberland	7	SR 2299B	FROM SR 2311 MP 0.54 TO US 301/I 95 BUS MP 1.36	5	3	MU	0.79	33		4	4	3	4,382	1,400	270		120		
TOTAL FOR MAP NO. 7								0.79			4	4	3	4,382	1,400	270		120		
2023CPT.06.02.20261.1	Cumberland	8	SR 2311	FROM RXR PVMT JT MP 1.58 TO SR 2299 MP 2.31	5	5	MU	0.73	60		4		10	6,316	2,579	897	410	588	10	8
TOTAL FOR MAP NO. 8								0.73			4		10	6,316	2,579	897	410	588	10	8
2023CPT.06.02.20261.1	Cumberland	9	SR 3828	FROM NC24/87 ON & OFF RAMPS PVMT JT MP 0.05 TO WALTER ST PVMT JT MP 0.99	5	5	MU	0.94	60		5		31	8,775	3,586	1,992		805		
TOTAL FOR MAP NO. 9								0.94			5		31	8,775	3,586	1,992		805		
2023CPT.06.02.20261.1	Cumberland	10	SR 4160	FROM US HWY 401 MP 0.00 TO NC HWY 162 PVMT JT MP 0.60	5 & 3	3	2WU	0.58	38		4	2		650	1,075			45		4
TOTAL FOR MAP NO. 10								0.58			4	2		650	1,075			45		4
2023CPT.06.02.20261.1	Cumberland	11	SR 4617	FROM SR 1137 MP 0.00 TO SR 4619 MP 0.30	6	2	2WU	0.29	31											
TOTAL FOR MAP NO. 11								0.29												
2023CPT.06.02.20261.1	Cumberland	12	SR 4618	FROM SR 4623 MP 0.00 TO SR 4619 MP 0.91	6	2	2WU	0.9	31											
TOTAL FOR MAP NO. 12								0.9												
2023CPT.06.02.20261.1	Cumberland	13	SR 4619	FROM SR 4618 MP 0.00 TO CUL-DE-SAC MP 0.37	6	2	2WU	0.37	31											
TOTAL FOR MAP NO. 13								0.37												
2023CPT.06.02.20261.1	Cumberland	14	SR 4620	FROM SR 4619 MP 0.00 TO CUL-DE-SAC MP 0.03	6	2	2WU	0.03	31											
TOTAL FOR MAP NO. 14								0.03												
2023CPT.06.02.20261.1	Cumberland	15	SR 4621	FROM SR 4618 MP 0.00 TO CUL-DE-SAC MP 0.03	6	2	2WU	0.03	31											
TOTAL FOR MAP NO. 15								0.03												
2023CPT.06.02.20261.1	Cumberland	16	SR 4622	FROM SR 4618 MP 0.00 TO SR 4619 MP 0.23	6	2	2WU	0.23	31											
TOTAL FOR MAP NO. 16								0.23												
2023CPT.06.02.20261.1	Cumberland	17	SR 4623	FROM SR 4618 MP 0.00 TO CUL-DE-SAC MP 0.32	6	2	2WU	0.32	31											
TOTAL FOR MAP NO. 17								0.32												
2023CPT.06.02.20261.1	Cumberland	18	SR 4624	FROM SR 4618 MP 0.00 TO SR 4619 MP 0.22	6	2	2WU	0.22	31											
TOTAL FOR MAP NO. 18								0.22												
TOTAL FOR PROJ NO. 2023CPT.06.02.20261.1								12.07			25	12	45	24,505	10,040	3,559	590	1,848	14	20
											82		34,545				34			
GRAND TOTAL								18.81			25	12	45	86,262	10,140	3,559	590	1,868	14	20
											82		96,402				34			

PROJECT NO	COUNTY	MAP NO	ROUTE	DESCRIPTION	TYP NO	LANES	LANE TYPE	LENGTH		WIDTH		4845000000-N					4891000000-E			4892000000-N	4900000000-N			
								MI	FT	EA	EA	EA	EA	EA	EA	EA	LF	LF	LF	EA	EA	EA		
2023CPT.06.02.10261.1	Cumberland	1	NC HWY 690	FROM MOORECO. LINE MP 0.00 TO NC HWY 24/87 PVMT JT MP 6.74	1	2	2WU	6.74	25			3	2				100	20			12	470		
TOTAL FOR MAP NO. 1								6.74		3	2					100	20			12	470			
TOTAL FOR PROJ NO. 2023CPT.06.02.10261.1								6.74		3	2				100	20			12	470				
										5					120			482						
2023CPT.06.02.20261.1	Cumberland	2	SR 1106	FROM NC HWY 162 MP 0.00 TO SR 1104 MP 1.30	2	2	2WU	1.24	26								407	30			24	90		
TOTAL FOR MAP NO. 2								1.24							407	30			24	90				
2023CPT.06.02.20261.1	Cumberland	3	SR 1112	FROM SR 1140 MP 6.50 TO HOKE CO. LINE MP 8.32	2	2	2WU	1.82	29								800	60	50	2	50	150		
TOTAL FOR MAP NO. 3								1.82							800	60	50	2	50	150				
2023CPT.06.02.20261.1	Cumberland	4	SR 1117	FROM SR 1118 MP 0.00 TO END U-2519AA-AB PROJECT LIMITS MP 1.41	3	2	2WU	1.41	26									75	180	4		94		
TOTAL FOR MAP NO. 4								1.41								75	180	4		94				
2023CPT.06.02.20261.1	Cumberland	5	SR 2233	FROM SR 2232 MP 5.37 TO NC HWY 87 MP 6.82	4	2	2WU	1.38	23													91		
TOTAL FOR MAP NO. 5								1.38															91	
2023CPT.06.02.20261.1	Cumberland	6	SR 2299A	FROM US 301/I 95 BUS MP 0.00 TO SR 2311 MP 0.82	5	3	MU	0.79	33				4	2	1	4	1,400	240	180	4	69			
TOTAL FOR MAP NO. 6								0.79				4	2	1	4	1,400	240	180	4	69				
2023CPT.06.02.20261.1	Cumberland	7	SR 2299B	FROM SR 2311 MP 0.54 TO US 301/I 95 BUS MP 1.36	5	3	MU	0.79	33			1	2	4	3	4	1,400					70		
TOTAL FOR MAP NO. 7								0.79			1	2	4	3	4	1,400							70	
2023CPT.06.02.20261.1	Cumberland	8	SR 2311	FROM RXR PVMT JT MP 1.58 TO SR 2299 MP 2.31	5	5	MU	0.73	60			17	3	4	10		2,579	400	410	10	160	105		
TOTAL FOR MAP NO. 8								0.73			17	3	4	10		2,579	400	410	10	160	105			
2023CPT.06.02.20261.1	Cumberland	9	SR 3828	FROM NC24/87 ON & OFF RAMP PVMT JT MP 0.05 TO WALTER ST PVMT JT MP 0.99	5	5	MU	0.94	60			32	11	5	31		3,586	100			275	112		
TOTAL FOR MAP NO. 9								0.94			32	11	5	31		3,586	100			275	112			
2023CPT.06.02.20261.1	Cumberland	10	SR 4160	FROM US HWY 401 MP 0.00 TO NC HWY 162 PVMT JT MP 0.60	5 &	3	2WU	0.58	38			2		8	2		1,267	220			60	80		
TOTAL FOR MAP NO. 10								0.58			2		8	2		1,267	220			60	80			
2023CPT.06.02.20261.1	Cumberland	11	SR 4617	FROM SR 1137 MP 0.00 TO SR 4619 MP 0.30	6	2	2WU	0.29	31															
TOTAL FOR MAP NO. 11								0.29																
2023CPT.06.02.20261.1	Cumberland	12	SR 4618	FROM SR 4623 MP 0.00 TO SR 4619 MP 0.91	6	2	2WU	0.9	31															
TOTAL FOR MAP NO. 12								0.9																
2023CPT.06.02.20261.1	Cumberland	13	SR 4619	FROM SR 4618 MP 0.00 TO CUL-DE-SAC MP 0.37	6	2	2WU	0.37	31															
TOTAL FOR MAP NO. 13								0.37																
2023CPT.06.02.20261.1	Cumberland	14	SR 4620	FROM SR 4619 MP 0.00 TO CUL-DE-SAC MP 0.03	6	2	2WU	0.03	31															
TOTAL FOR MAP NO. 14								0.03																
2023CPT.06.02.20261.1	Cumberland	15	SR 4621	FROM SR 4618 MP 0.00 TO CUL-DE-SAC MP 0.03	6	2	2WU	0.03	31															
TOTAL FOR MAP NO. 15								0.03																
2023CPT.06.02.20261.1	Cumberland	16	SR 4622	FROM SR 4618 MP 0.00 TO SR 4619 MP 0.23	6	2	2WU	0.23	31															
TOTAL FOR MAP NO. 16								0.23																
2023CPT.06.02.20261.1	Cumberland	17	SR 4623	FROM SR 4618 MP 0.00 TO CUL-DE-SAC MP 0.32	6	2	2WU	0.32	31															
TOTAL FOR MAP NO. 17								0.32																
2023CPT.06.02.20261.1	Cumberland	18	SR 4624	FROM SR 4618 MP 0.00 TO SR 4619 MP 0.22	6	2	2WU	0.22	31															
TOTAL FOR MAP NO. 18								0.22																
TOTAL FOR PROJ NO. 2023CPT.06.02.20261.1								12.07		52	20	23	45	10	11,439	1,125	820	20	638	792				
										150					13,384			1,430						
GRAND TOTAL								18.81		55	22	23	45	10	11,539	1,145	820	20	650	1,262				
										155					13,504			1,912						