

STATE OF NORTH CAROLINA
DEPARTMENT OF TRANSPORTATION
HIGHWAY DIVISION 6

PLANS

Let Date: November 7, 2018

CONTRACT ID: D6D1.POC.005

TIP No.: -----

FEDERAL AID NO.: STATE FUNDED

WBS ELEMENT NO.: 2019CPT.06.15.10782.1 & 2019CPT.06.15.20782.1

ROUTE NO.: VARIOUS PRIMARY & SECONDARY ROUTES

LOCATION: VARIOUS

COUNTY: ROBESON

LENGTH OF PROJECT: 157.462 MILES

TYPE OF WORK: HOT Poured RUBBER ASPHALT JOINT SEALER

Robeson Crack Seal Contract

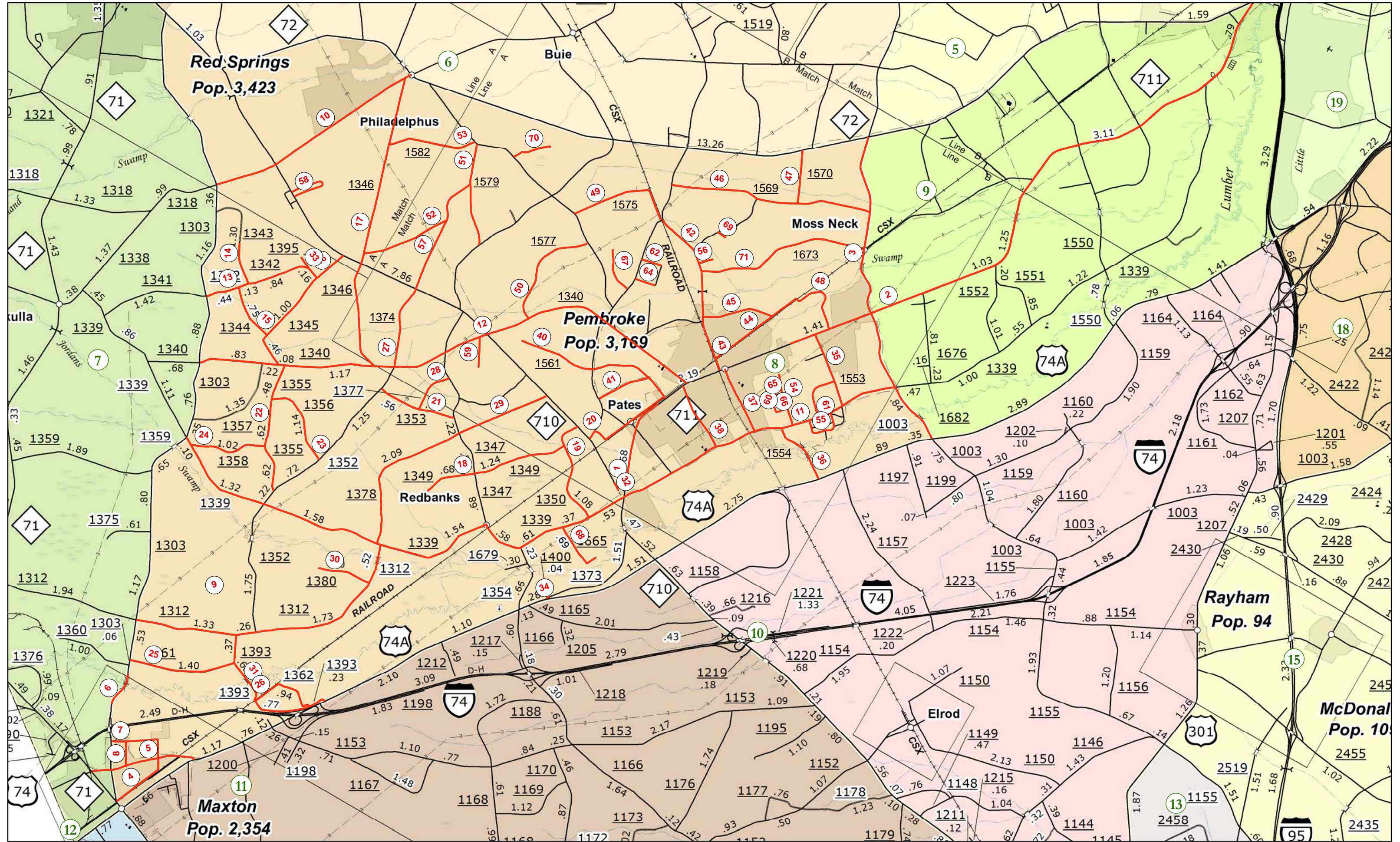

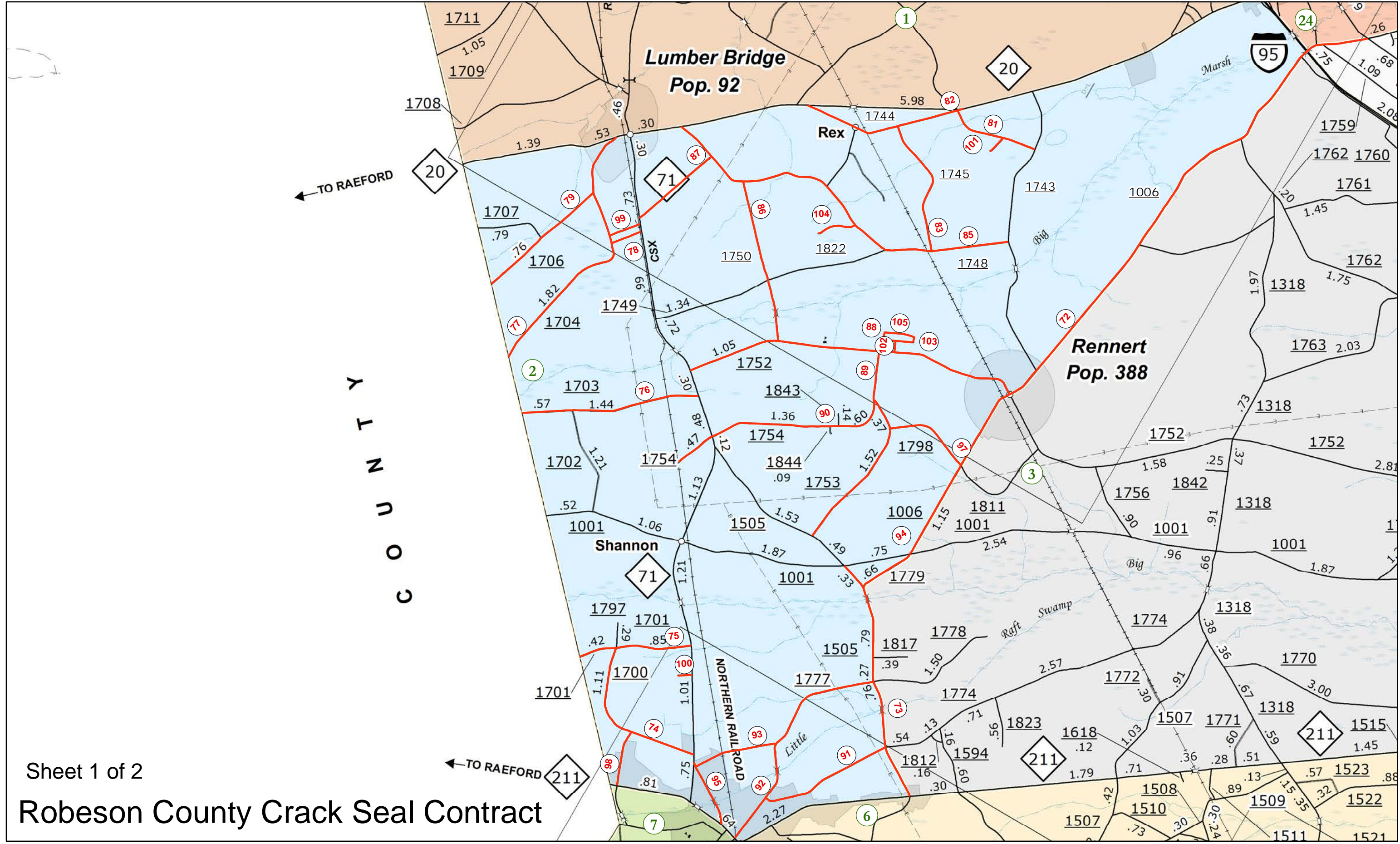

Sheet 1 of 2

Robeson County Crack Seal Contract

Primary – 2019CPT.06.15.10782.1

Map	Road	From	From MP	To	To MP	CL Length	Pounds Required
1	NC 711	NC 710	0	Begin C&G	1.24	1.24	4,340
2	NC 711	End C&G	3.15	NC 72	11.19	8.04	28,140
SUBTOTAL						9.280	32,480

Secondary – 2019CPT.06.15.20782.1

Map	Road	From	From MP	To	To MP	CL Length	Pounds Required
3	SR 1003	US 74	10.893	NC 72	15.164	4.271	14,949
4	SR 1301	NC 71	0.000	SR 1304	1.090	1.090	3,815
5	SR 1302	NC 71	0.567	US 74 BUS	1.957	1.390	4,865
6	SR 1303	PVMT CHG	9.190	PVMT CHG	9.659	0.469	1,642
7	SR 1304	SR1303	0.000	SR 1301	0.620	0.620	2,170
8	SR 1305	SR 1304	0.000	SR 1302	0.320	0.320	1,120
9	SR 1312	SR 1303	8.170	SR 1339	12.010	3.840	13,440
10	SR 1318	NC 72	11.261	SR 1303	14.211	2.950	10,325
11	SR 1339	SR 1003	6.280	SR 1303	16.869	10.589	37,062
12	SR 1340	SR 1303	0.680	NC 711	7.540	6.860	24,010
13	SR 1342	SR 1303	0.000	SR 1345	1.570	1.570	5,495
14	SR 1343	SR 1342	0.000	END PVMT	0.550	0.550	1,925
15	SR 1344	SR 1342	0.000	SR 1345	0.750	0.750	2,625
16	SR 1345	SR 1340	0.000	NC 710	1.920	1.920	6,720
17	SR 1346	SR 1340	0.000	SR 1318	3.920	3.920	13,720
18	SR 1349	SR 1350	0.000	DEAD END	1.920	1.920	6,720
19	SR 1350	NC 710	0.000	SR 1339	1.450	1.450	5,075
20	SR 1351	NC 710	0.000	SR 1561	1.254	1.254	4,389
21	SR 1353	SR 1352	0.000	SR 1347	1.030	1.030	3,605
22	SR 1355	SR 1352	0.000	SR 1340	1.720	1.720	6,020
23	SR 1356	SR 1352	0.000	SR 1355	1.140	1.140	3,990
24	SR 1358	SR 1339	0.000	SR 1355	1.010	1.010	3,535
25	SR 1361	SR 1303	0.000	SR 1393	1.400	1.400	4,900
26	SR 1362	SR 1393	0.000	SR 1393	0.940	0.940	3,290
27	SR 1374	NC 710	0.000	SR 1340	1.100	1.100	3,850
28	SR 1377	SR 1347	0.000	SR 1353	0.610	0.610	2,135
29	SR 1378	SR 1339	0.000	NC 710	3.34	3.340	11,690
30	SR 1380	SR 1312	0.000	DEAD END	0.7	0.700	2,450
31	SR 1393	SR 1312	0.000	US 74	1.975	1.975	6,913
32	SR 1394	NC 710	0.000	DEAD END	0.12	0.120	420
33	SR 1395	SR 1342	0.000	DEAD END	0.19	0.190	665
34	SR 1400	SR 1373	0.000	DEAD END	0.041	0.041	144
35	SR 1553	NC 711	0.000	SR 1339	1.005	1.005	3,518
36	SR 1554	US 74	0.000	SR 1339	0.857	0.857	3,000
37	SR 1555	SR 1339	0.000	NC 711	0.905	0.905	3,168
38	SR 1556	SR 1339	0.000	NC 711	0.91	0.910	3,185
39	SR 1557	SR 1339	0.000	SR 1351	0.87	0.870	3,045
40	SR 1561	NC 711	0.000	DEAD END	2.157	2.157	7,550

Map	Road	From	From MP	To	To MP	CL Length	Pounds Required
41	SR 1562	SR 1561	0.000	SR 1515	0.711	0.711	2,489
42	SR 1563	SR 1515	0.000	PVMNT CHG	1.302	1.302	4,557
43	SR 1563	PVMNT CHG	1.302	NC 711	2.202	0.900	3,150
44	SR 1564	SR 1563	0.000	MP 1.55	1.55	1.550	5,425
45	SR 1565	SR 1564	0.000	SR 1563	0.93	0.930	3,255
46	SR 1569	SR 1515	0.000	SR 1003	2.655	2.655	9,293
47	SR 1570	NC 72	0.000	SR 1569	0.7	0.700	2,450
48	SR 1571	NC 711	0.000	MP 1.55	0.668	0.668	2,338
49	SR 1575	SR 1515	0.000	SR 1578	1.453	1.453	5,086
50	SR 1577	SR 1340	0.000	SR 1578	1.5	1.500	5,250
51	SR 1579	SR 1578	0.000	SR 1576	1.35	1.350	4,725
52	SR 1580	SR 1346	0.000	SR 1579	1.8	1.800	6,300
53	SR 1582	SR 1578	0.000	SR 1346	1.16	1.160	4,060
54	SR 1583	SR 1339	0.000	DEAD END	0.69	0.690	2,415
55	SR 1604	SR 1339	0.000	SR 1339	0.65	0.650	2,275
56	SR 1605	SR 1563	0.000	CUL DE SAC	0.19	0.190	665
57	SR 1606	NC 710	0.000	SR 1580	0.98	0.980	3,430
58	SR 1613	NC 710	0.000	NC 710	0.86	0.860	3,010
59	SR 1614	SR 1340	0.000	DEAD END	0.4	0.400	1,400
60	SR 1615	SR 1583	0.000	SR 1630	0.27	0.270	945
61	SR 1616	SR 1553	0.000	SR 1339	0.67	0.670	2,345
62	SR 1626	SR 1515	0.000	SR 1627	0.28	0.280	980
63	SR 1627	SR 1626	0.000	SR 1628	0.27	0.270	945
64	SR 1628	SR 1515	0.000	SR 1627	0.27	0.270	945
65	SR 1629	SR 1583	0.000	SR 1630	0.16	0.160	560
66	SR 1630	SR 1615	0.000	SR 1629	0.21	0.210	735
67	SR 1636	SR 1515	0.000	DEAD END	0.6	0.600	2,100
68	SR 1665	SR 1339	0.000	DEAD END	0.711	0.711	2,489
69	SR 1669	SR 1568	0.000	CUL DE SAC	0.13	0.130	455
70	SR 1670	SR 1578	0.000	DEAD END	0.51	0.510	1,785
71	SR 1673	SR 1563	0.000	SR 1003	2.27	2.270	7,945
72	SR 1006	US 301	7.443	SR 1001	15.45	8.007	28,025
73	SR 1505	SR 1001	2.022	NC 211	4.792	2.770	9,695
74	SR 1700	NC 71	0.000	SR 1701	1.85	1.850	6,475
75	SR 1701	NC 71	0.000	HOKE CO	1.274	1.274	4,459
76	SR 1703	NC 71	0.000	HOKE CO	2.009	2.009	7,032
77	SR 1704	SR 1706	0.000	HOKE CO	2.433	2.433	8,516
78	SR 1705	NC 71	0.000	SR 1704	0.36	0.360	1,260

Map	Road	From	From MP	To	To MP	CL Length	Pounds Required
79	SR 1706	NC 20	0.000	HOKE CO	2.271	2.271	7,949
80	SR 1707	SR 1706	0.000	HOKE CO	0.793	0.793	2,776
81	SR 1729	NC 20	2.880	SR 1743	3.91	1.030	3,605
82	SR 1744	NC 20	0.000	NC 20	1.86	1.860	6,510
83	SR 1745	SR 1744	0.000	SR 1748	1.57	1.570	5,495
84	SR 1747	SR 1748	0.000	SR 1744	0.74	0.740	2,590
85	SR 1748	SR 1743	0.000	NC 20	4.333	4.333	15,166
86	SR 1750	SR 1748	0.000	SR 1752	1.839	1.839	6,437
87	SR 1751	SR 1748	0.000	NC 71	1.07	1.070	3,745
88	SR 1752	NC 71	0.000	SR 1006	3.8	3.800	13,300
89	SR 1753	SR 1752	0.000	SR 1505	2.449	2.449	8,572
90	SR 1754	SR 1753	0.000	DEAD END	2.526	2.526	8,841
91	SR 1774	SR 1776	0.000	SR 1505	1.51	1.510	5,285
92	SR 1776	NC 71	0.000	SR 1777	1.22	1.220	4,270
93	SR 1777	SR 1780	0.000	SR 1505	2.36	2.360	8,260
94	SR 1779	SR 1001	0.000	SR 1505	0.66	0.660	2,310
95	SR 1780	NC 71	0.000	NC 71	0.78	0.780	2,730
96	SR 1797	SR 1701	0.000	DEAD END	0.29	0.290	1,015
97	SR 1798	SR 1006	0.000	SR 1753	1.003	1.003	3,511
98	SR 1806	NC 211	0.000	SR 1700	0.632	0.632	2,212
99	SR 1814	NC 71	0.000	SR 1704	0.37	0.370	1,295
100	SR 1816	NC 71	0.000	DEAD END	0.16	0.160	560
101	SR 1818	SR 1729	0.000	DEAD END	0.21	0.210	735
102	SR 1820	SR 1752	0.000	SR 1821	0.13	0.130	455
103	SR 1821	DEAD END	0.000	SR 1825	0.39	0.390	1,365
104	SR 1822	SR 1748	0.000	DEAD END	0.45	0.450	1,575
105	SR 1825	SR 1821	0.000	SR 1821	0.48	0.480	1,680
SUBTOTAL						148.182	518,637
TOTAL						157.462	551,117