

**This electronic collection of documents is provided  
for the convenience of the user  
and is Not a Certified Document –**

**The documents contained herein were originally issued  
and sealed by the individuals whose names and license  
numbers appear on each page, on the dates appearing  
with their signature on that page.**

**This file or an individual page  
shall not be considered a certified document.**

16-NOV-2015 15:12 H:\DDC\Projects\W-5601AS SR 1704 (Palestine Rd) From US 401 to Reeves Rd\Roadway\Proj\W-5601AS\_Rdy\_Tsh.dgn  
 \$\$\$USERNAME\$\$\$

**TIP PROJECT: W-5601AS**

**WBS: 50138.3.46**

STATE OF NORTH CAROLINA  
DIVISION OF HIGHWAYS

**CUMBERLAND COUNTY**

**LOCATION: SR 1704 (PALESTINE RD) FROM US 401 TO SR 1609  
(E. REEVES BRIDGE RD)**

**TYPE OF WORK: 2' WIDENING, RESURFACING AND PAVEMENT MARKINGS**

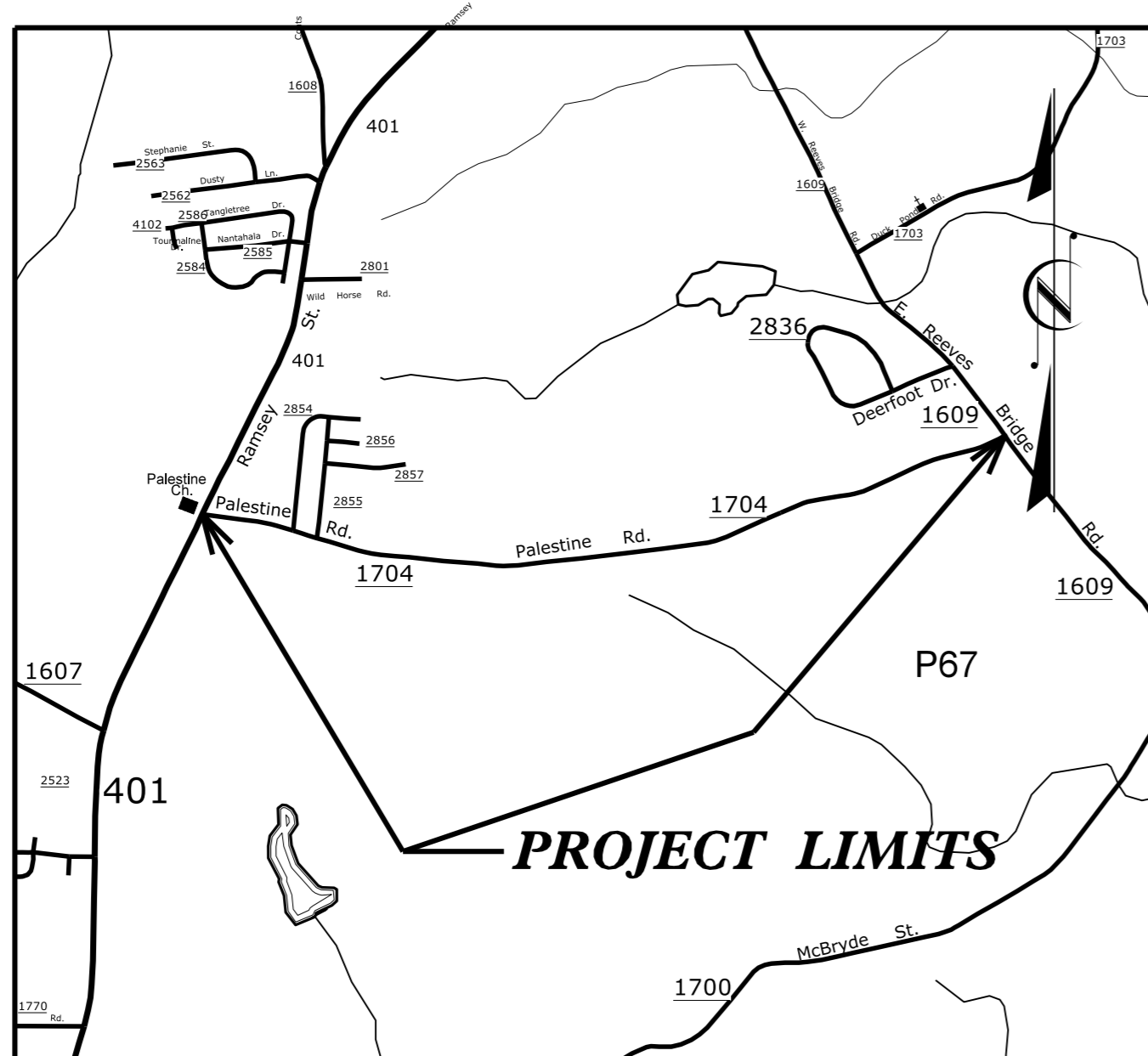

**VICINITY MAP  
(N.T.S.)**

STATE	STATE PROJECT REFERENCE NO.	SHEET NO.	TOTAL SHEETS
N.C.	W-5601AS	1	
STATE PROJ. NO.	F.A. PROJ. NO.	DESCRIPTION	
50138.1.46	HSIP-1704(5)	P.E.	
50138.2.46	HSIP-1704(5)	RW & UTIL	
50138.3.46	HSIP-1704(5)	CONSTR	

**DOCUMENT NOT CONSIDERED FINAL  
UNLESS ALL SIGNATURES COMPLETED**

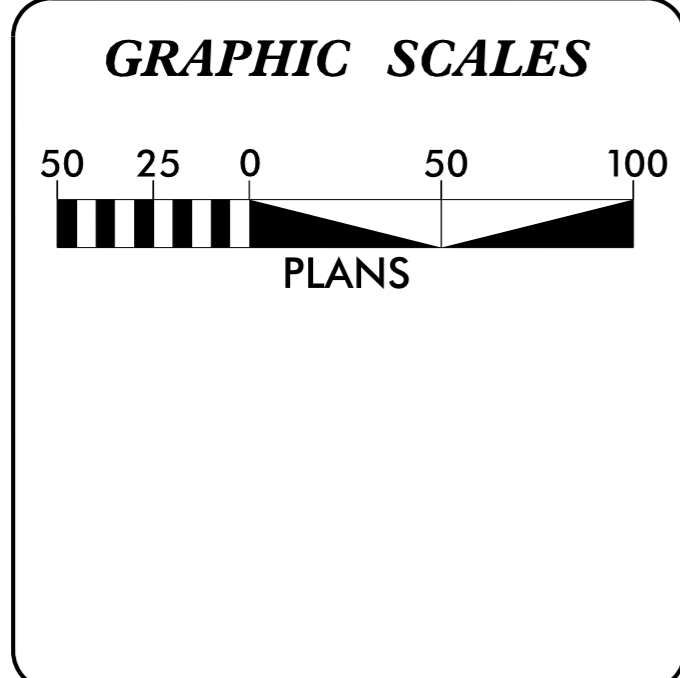
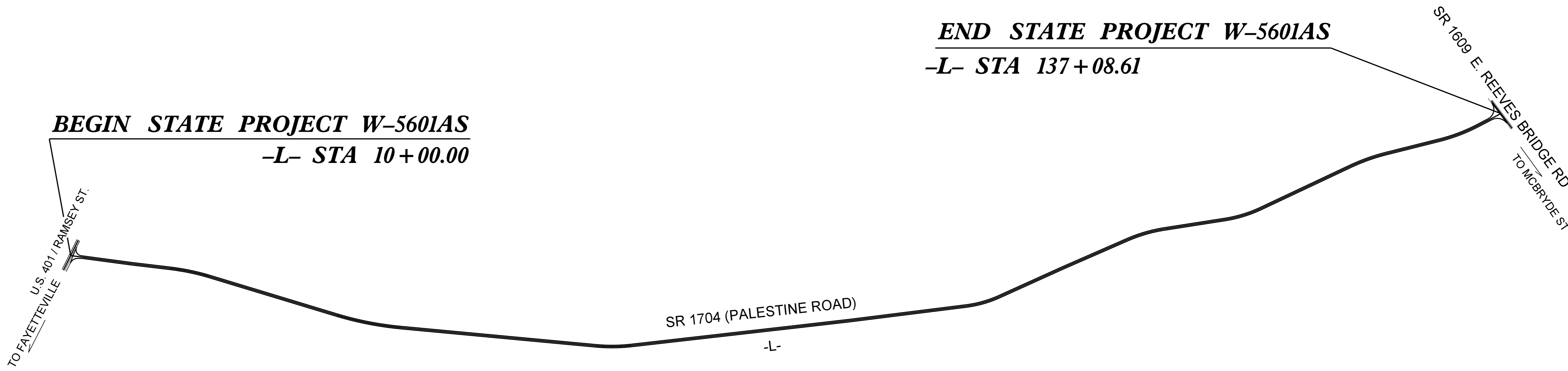

**DESIGN DATA**

ADT 2012 =	1,600
ADT 2032 =	2,890
V =	55 MPH

**PROJECT LENGTH**

TOTAL LENGTH FOR STATE PROJECT W-5601AS =	2.41 mi
---	---------

Prepared in the Office of:  
**DIVISION OF HIGHWAYS**  
431 Transportation Dr., Fayetteville NC, 28301

2012 STANDARD SPECIFICATIONS	
<b>RIGHT OF WAY DATE:</b> N/A	<b>SEAN MATUSZEWSKI</b> PROJECT ENGINEER
<b>LETTING DATE:</b> DECEMBER 16, 2015	<b>GLENDA SNIVELY</b> PROJECT DESIGN ENGINEER

PAVEMENT SCHEDULE	
C1	PROP. APPROX. 1½" ASPHALT CONCRETE SURFACE COURSE TYPE S9.5B, AT AN AVERAGE RATE OF 168 LBS. PER SQ. YD.
E1	PROP. APPROX. 5 1/2" ASPHALT CONCRETE BASE COURSE, TYPE B25.0B, AT AN AVERAGE RATE OF 627 LBS. PER SQ. YD.
T1	AGGREGATE SHOULDER BORROW
U	EXISTING PAVEMENT

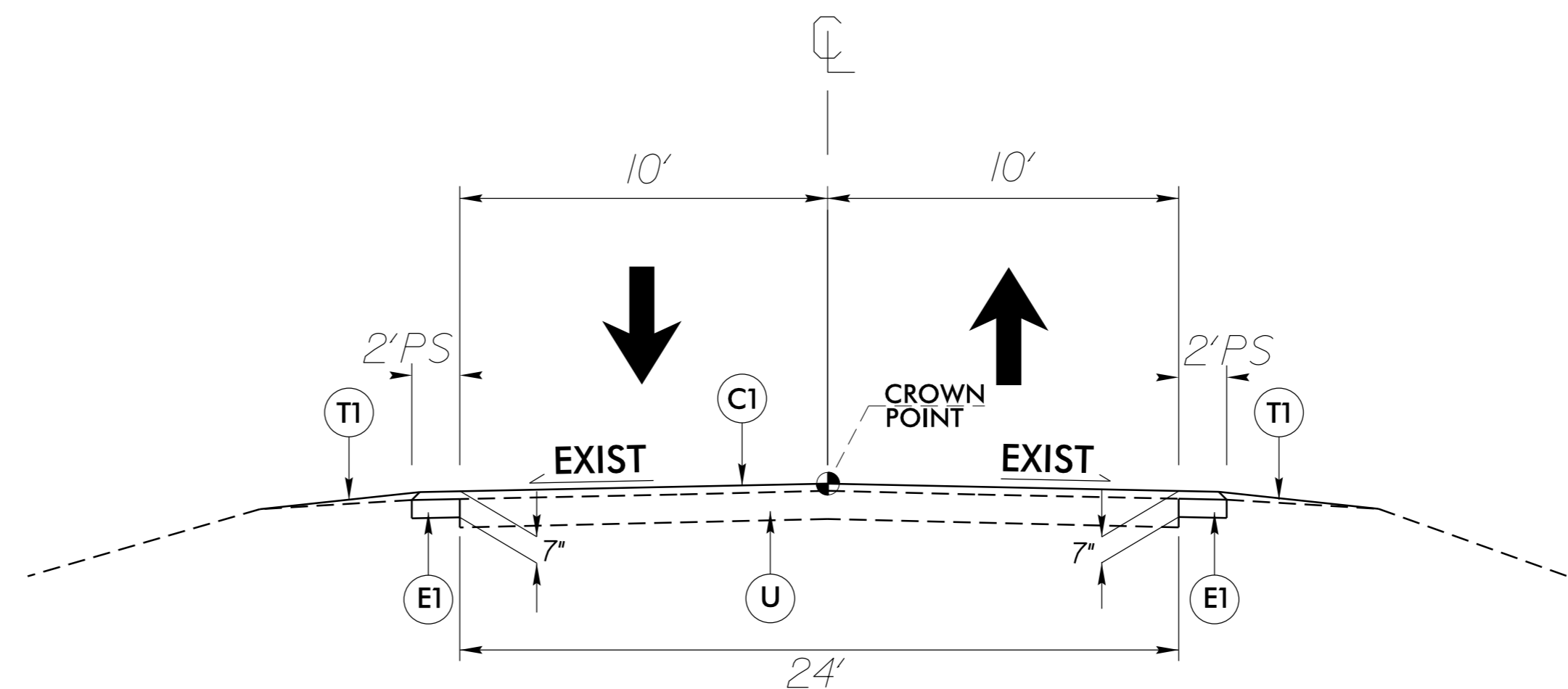

TYPICAL SECTION NO. 1

-L- STA. 11+04.46 TO STA 135+90.53

### MILLING AT PAVEMENT TIE-INS

#### NOTES TO CONTRACTOR

For surface mixes over 1" in thickness, mill the existing pavement in accordance with the following sketch as directed by the Engineer.

Locations shall include ties into existing concrete pavement, at bridge approaches where the bridge will not be resurfaced, and at the beginning and ending point of each resurfacing map.

Perform the work in accordance with Section 607 of the January 2012 North Carolina Department of Transportation Standard Specifications for Roads and Structures. Resurfacing will be accomplished at the same time as the milling operation.

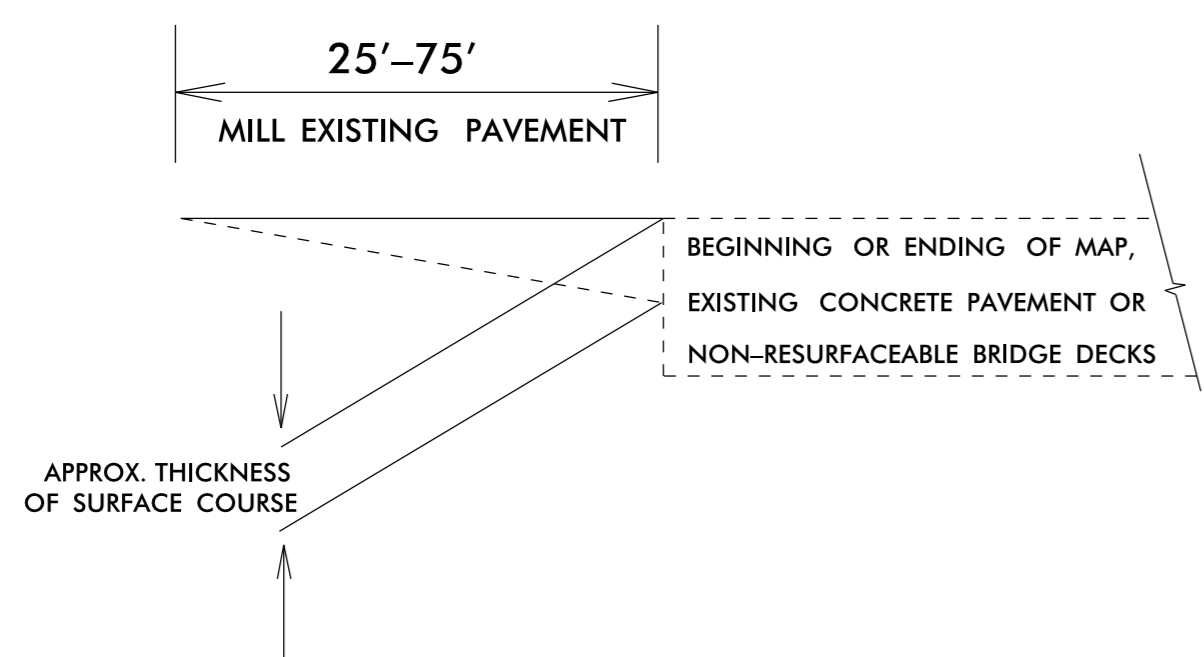

### PROJECT NOTES

1. The Contractor shall not work on both sides of the road simultaneously within the same area.
2. Ingress and egress shall be maintained to all businesses and dwellings on the project.
3. At the end of each workday, the Contractor shall be required to backfill any area adjacent to existing travelway that has been graded leaving no more than a 1½" drop-off.
4. A minimum of two-way, two-lane traffic (plus all existing left and right turn lanes) shall be maintained during periods of construction inactivity.
5. The Contractor shall not be allowed to stop traffic for more than 5 minutes at a time in any one direction.
6. During periods of construction inactivity, the difference in elevation between lanes shall not exceed 1-1/2 inch.
7. Access to police and fire station, fire hydrants, and hospitals shall be maintained at all times.
8. During periods of construction inactivity, place cones/drums 3' from existing edge of pavement (travelway) as directed by the Engineer.
9. Contractor to install Erosion Control devices as directed by the Engineer.
10. Contractor shall coordinate with the Division Six Traffic Services Unit (910-486-1452) for placement of all pavement markings and signs.