

HIGHWAY LANDSCAPE DEVELOPMENT PROJECT

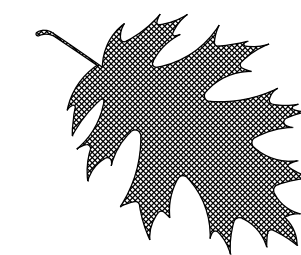

R-4903 NC 701 & NC 87 BYPASS IN ELIZABETHTOWN

T.I.P. #	STATE PROJECT W.B.S. #	SHEET #	SHEET # TOTAL
R-4903	40226.1.1	L1	6
FED. PROJ. #	DESCRIPTION		DIVISION
- - - -	TIP		6

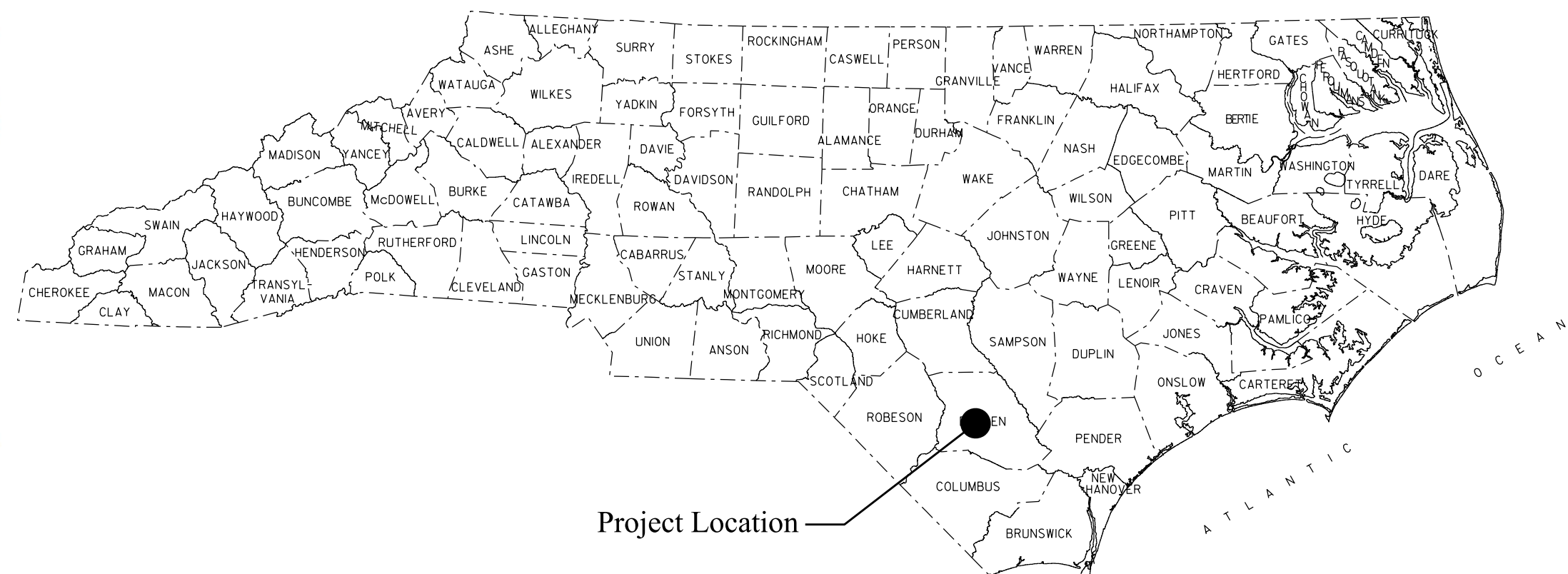
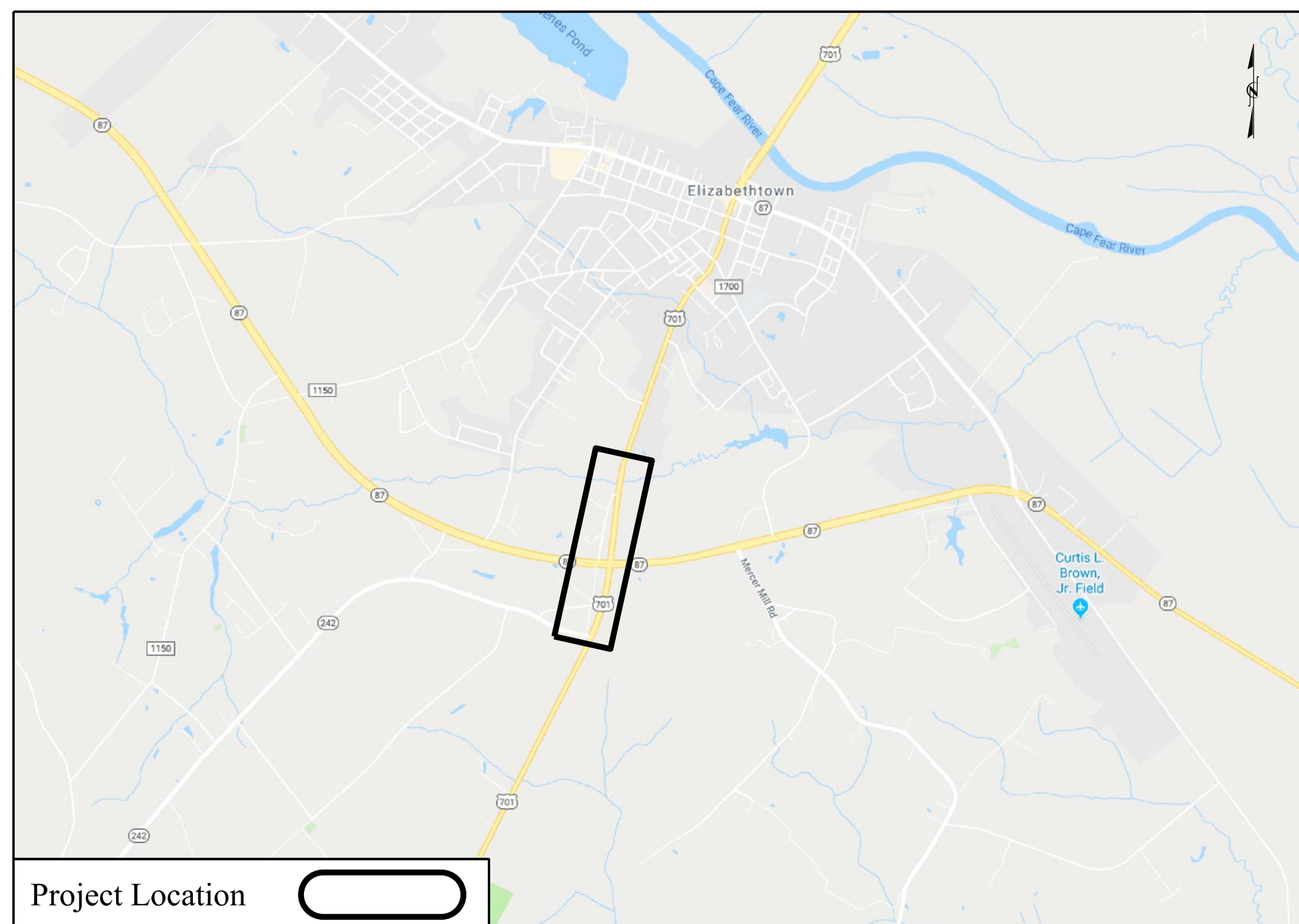

CONVENTIONAL SYMBOLS

County Line	-----
City or Town Line	-----
Exist. Right of Way Line Marker	-----▲-----
Prop. Right of Way Line Marker (By Others)	-----▲-----
Prop Right of Way Line Marker (By Contract)	-----▲-----
Exist. Control of Access Line	-----○-----
Prop. Control of Access Line	-----○-----
Property Line	-----
Easement Line	-----
Slope Stake Line	-----
Exist. Fence	-----
Prop. Woven Wire Fence	-----
Prop. Chain Link Fence	-----
Exist. Road	-----
Prop. Road	-----
Guardrail	-----
Survey Line	-----
Denotes Line Equality	-----
Bridge	-----
Culvert	-----
Railroad	-----
Woods	-----
Exist. Telephone Pole	-----
Prop. Telephone Pole	-----
Tower Pole and Line	-----
Exist. Power Pole	-----
Prop. Power Pole	-----
Sanitary Sewer Line	-----
Water Line	-----
Gas Line	-----
Picnic Shelter	-----
Regeneration	-----
Reforestation	-----

Summary of Quantities
1 Year Establishment

DES	SEC	QTY	UNIT	KEY	BOTANICAL NAME	COMMON NAME	SIZE	CALIPER	FURNISH	A.S.N.S.	REMARKS
Trees											
L	1670	27	ea	LT	<i>Lagerstroemia indica x fauriei</i> 'Tuscarora'	Tuscarora Crape Myrtle	7-8'		B&B	2.5	35' O.C.
L	1670	15	ea	QP	<i>Quercus phellos</i> 'Hightower'	Hightower Willow Oak		2-2.5"	B&B	2.2	100' O.C.
Grasses/Groundcovers/Perennials											
L	1670	3447	ea	HB	<i>Hemerocallis</i> 'Buttered Popcorn'	Buttered Popcorn Daylily	6-12"		#1 Cont	13.2.3	2' O.C.
L	1670	2052	ea	HJ	<i>Hemerocallis</i> 'Joan Senior'	Joan Senior Daylily	6-12"		#1 Cont	13.2.3	2' O.C.
Other Vegetation Costs											
L	SP	0.70	acre		Slit Seeding & Fertilization (Princess 77 Bermuda)						
L	1670	12	ea		Monthly Maintenance						
L	1670	298	cy		Mulch for Planting						4" Depth
L	1670	2484	sy		Post emergence Herbicidal Treatment						
L	1670	2484	sy		Pre emergence Herbicidal Treatment						
L	1651	2	ea		Selective Tree Removal, 15"						
L	1101	1	LS		Traffic Control						
L	1670	54	m/g		Water for Planting						

INDEX OF L SHEETS:

- L 1.0 - Title Sheet
- L 2.0 - Planting Details
- L 3.0 - L 6.0 - Planting Plans

PREPARED BY: KC DATE: 04/2018

REVISIONS

DATE	DESCRIPTION
04/06/2018	Remove Sod/ Add Aeration & Overseeding
03/06/2019	Add daylily bed near NC 242, three oak trees near the old US-701 road bed, & additional seeding

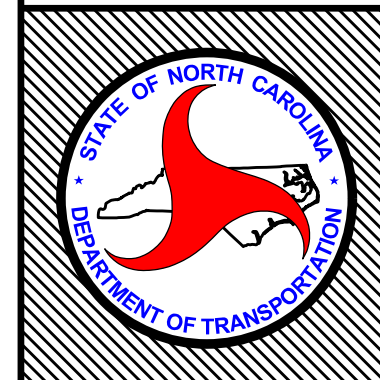

STATE OF
NORTH CAROLINA
DEPARTMENT OF TRANSPORTATION







LOCATION: NC 701 & NC 87 Bypass in Elizabethtown

TYPE OF WORK: TIP

COUNTY: Bladen County

2014 American Standard for Nursery Stock
2018 NCDOT STANDARD SPECIFICATIONS
PREPARED IN THE OFFICE OF:
NCDOT- ROADSIDE ENVIRONMENTAL UNIT
AESTHETIC ENGINEERING SECTION
1557 MAIL SERVICE CENTER
RALEIGH NC 27699 919-707-2920

NOTES:

-  SCHEDULE FOR PLANT HOLE SIZE: PLANT HOLE WIDTH (X) TO BE TWICE THE ROOT BALL SIZE OR CONTAINER DIAMETER.
-  SEE STANDARD SPECIFICATIONS FOR PLANT BED FUMIGATION AND HERBICIDAL TREATMENT.
-  APPLY FERTILIZER AT PLANTING TIME IN THE FORM OF A SLOW RELEASE PELLET OR TABLET. APPLY AT RATE RECOMMENDED BY MANUFACTURER. BOTH RATE AND FORMULATION MUST BE APPROVED BY FIELD ENGINEER PRIOR TO APPLICATION.
-  REMOVE WIRE BASKET AND FOLD BURLAP BACK FROM TOP OF ROOT BALL BEFORE BACKFILLING IS COMPLETE.
-  ALL PRUNING TO FOLLOW STANDARD ARBORICULTURAL PRACTICES AS SPECIFIED BY INTERNATIONAL SOCIETY OF ARBORICULTURE.
-  DO NOT ATTEMPT TO STRAIGHTEN A TREE THAT HAS BEEN PLANTED AT AN ANGLE WITH THE USE OF STAKING OR GUYING. DIG TREE AND REPLANT TO UPRIGHT POSITION.

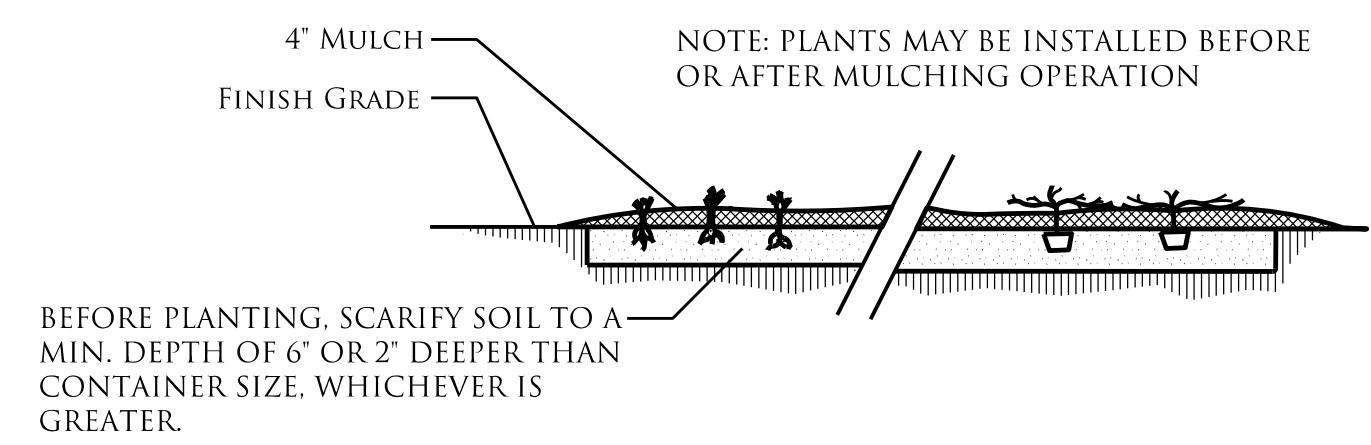

**GROUND COVER/ BEDDING
PLANT DETAIL**
NTS

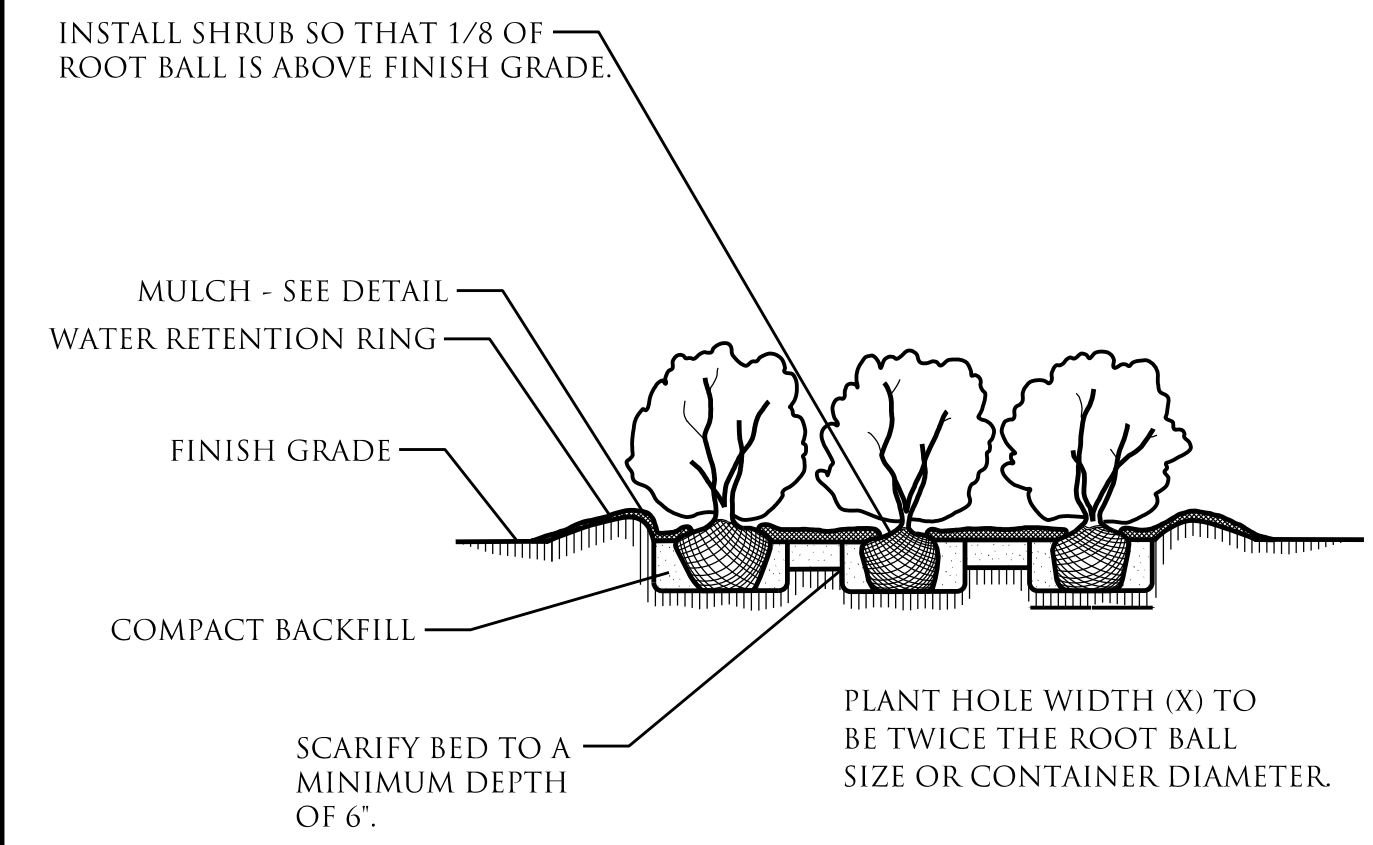

SHRUB BED PLANTING DETAIL
NTS

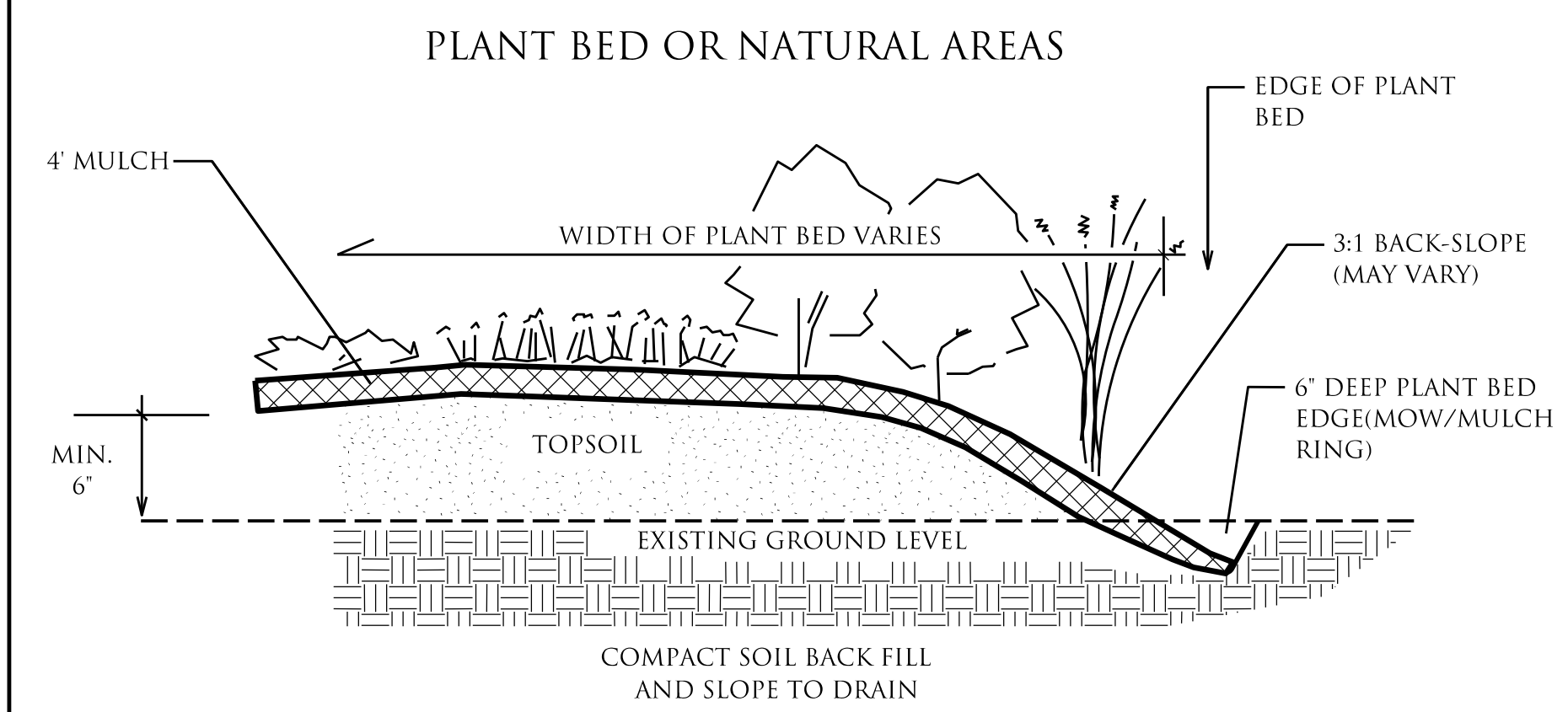

PLANT BED EDGE DETAIL
NTS

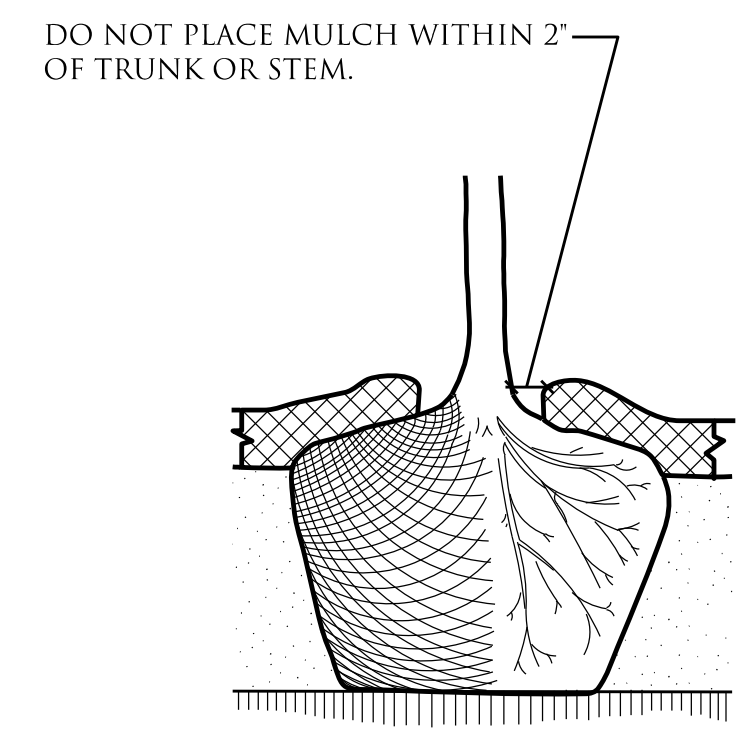

MULCH DETAIL
NTS

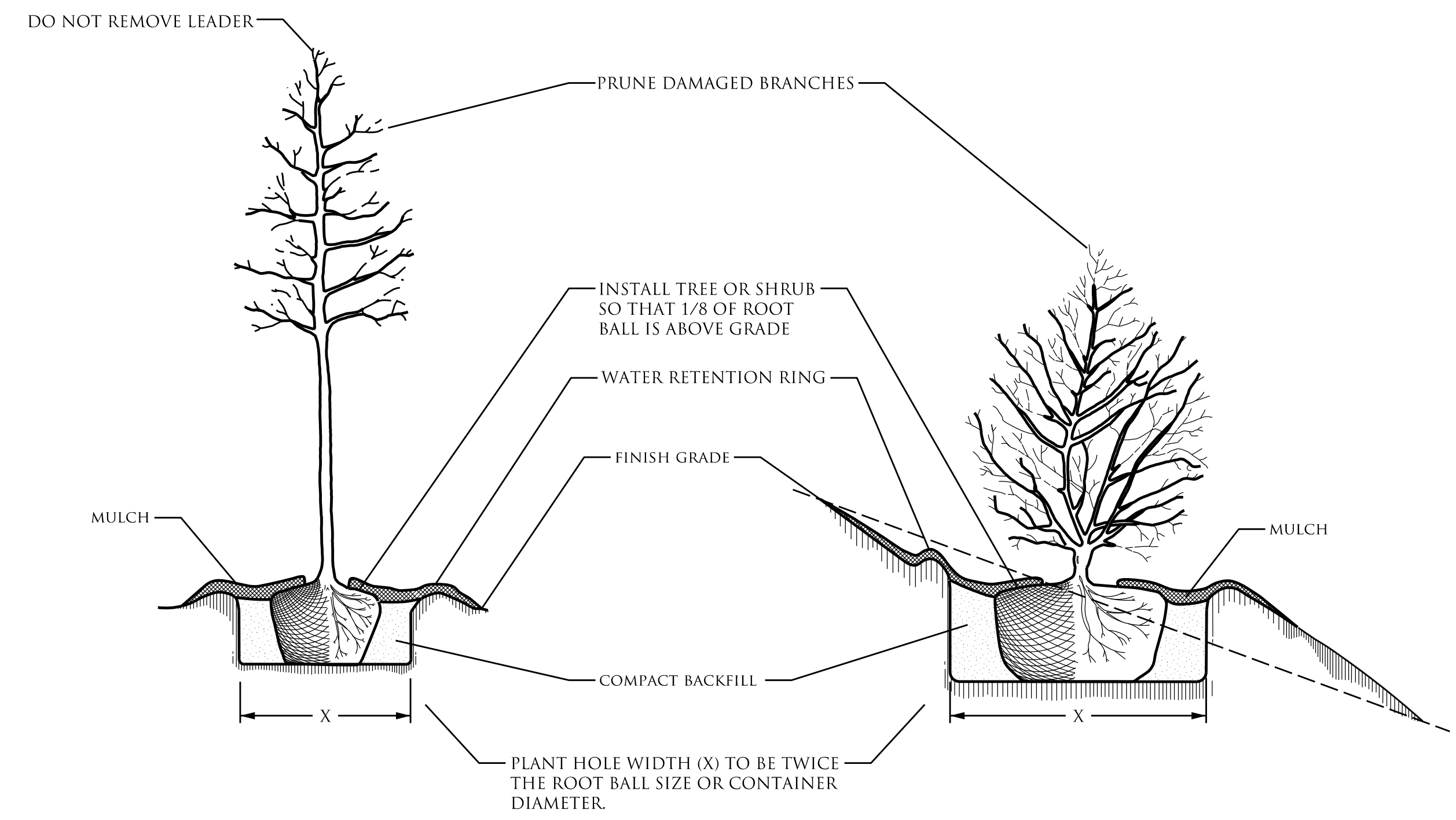

**TREE OR SHRUB PLANTING DETAIL
(LEVEL GROUND)**
NTS

**TREE OR SHRUB PLANTING DETAIL
(SLOPING GROUND)**
NTS

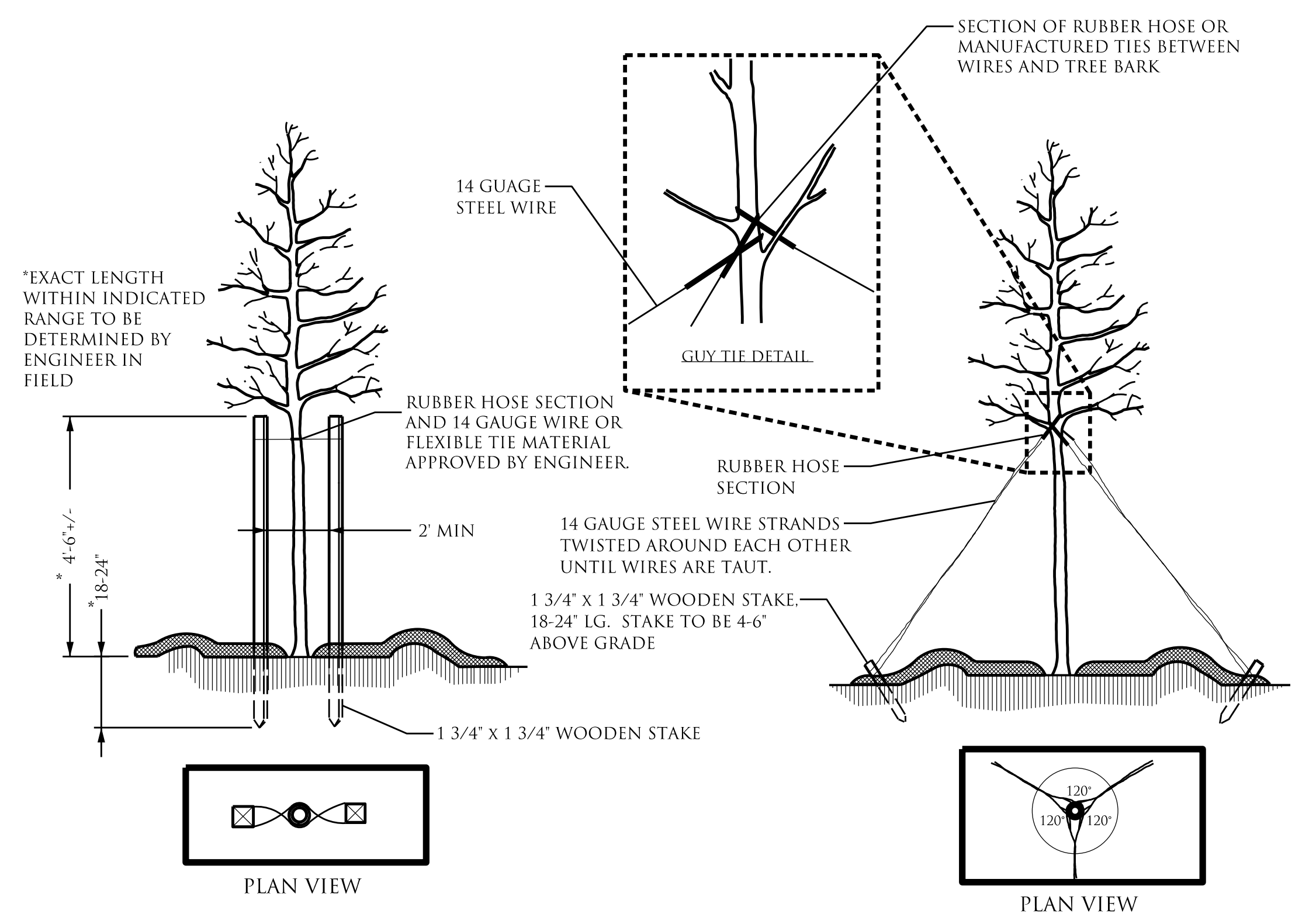

**STAKING DETAIL
(TREES 6-10')**
USE AS DIRECTED BY FIELD ENGINEER
NTS

**GUYING DETAIL
(TREES 10' OR LARGER)**
USE AS DIRECTED BY FIELD ENGINEER
NTS

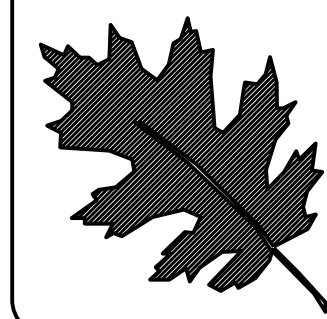

NCDOT - ROADSIDE ENVIRONMENTAL UNIT
LANDSCAPE DESIGN & DEVELOPMENT
1557 MAIL SERVICE CENTER RALEIGH NC 27699-1557
PH: 919-707-2935 FAX: 919-715-2554
[HTTP://WWW.NCDOT.ORG/DOH/OPERATIONS/DP_CHIEF_ENG/ROADSIDE/](http://www.ncdot.org/DOH/OPERATIONS/DP_CHIEF_ENG/ROADSIDE/)

NC 701 & NC 87 BYPASS IN ELIZABETHTOWN,
BLADEN COUNTY
TIP #: R-4903
REV. DESIGNER
Kyle Coady

PREL. DESIGN DATE:	APRIL 6, 2018
CHECKED BY & DATE:	---
FINAL DESIGN DATE:	MARCH 7, 2019

PLANTING DETAILS
LANDSCAPE PLAN SHEET

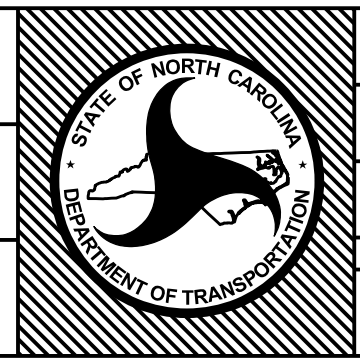

T.I.P. #	R-4903
WBS #	40226.1.1
FED I.D. #	
SHEET NO.:	L-2
TOTAL SHEET NO.:	L-6

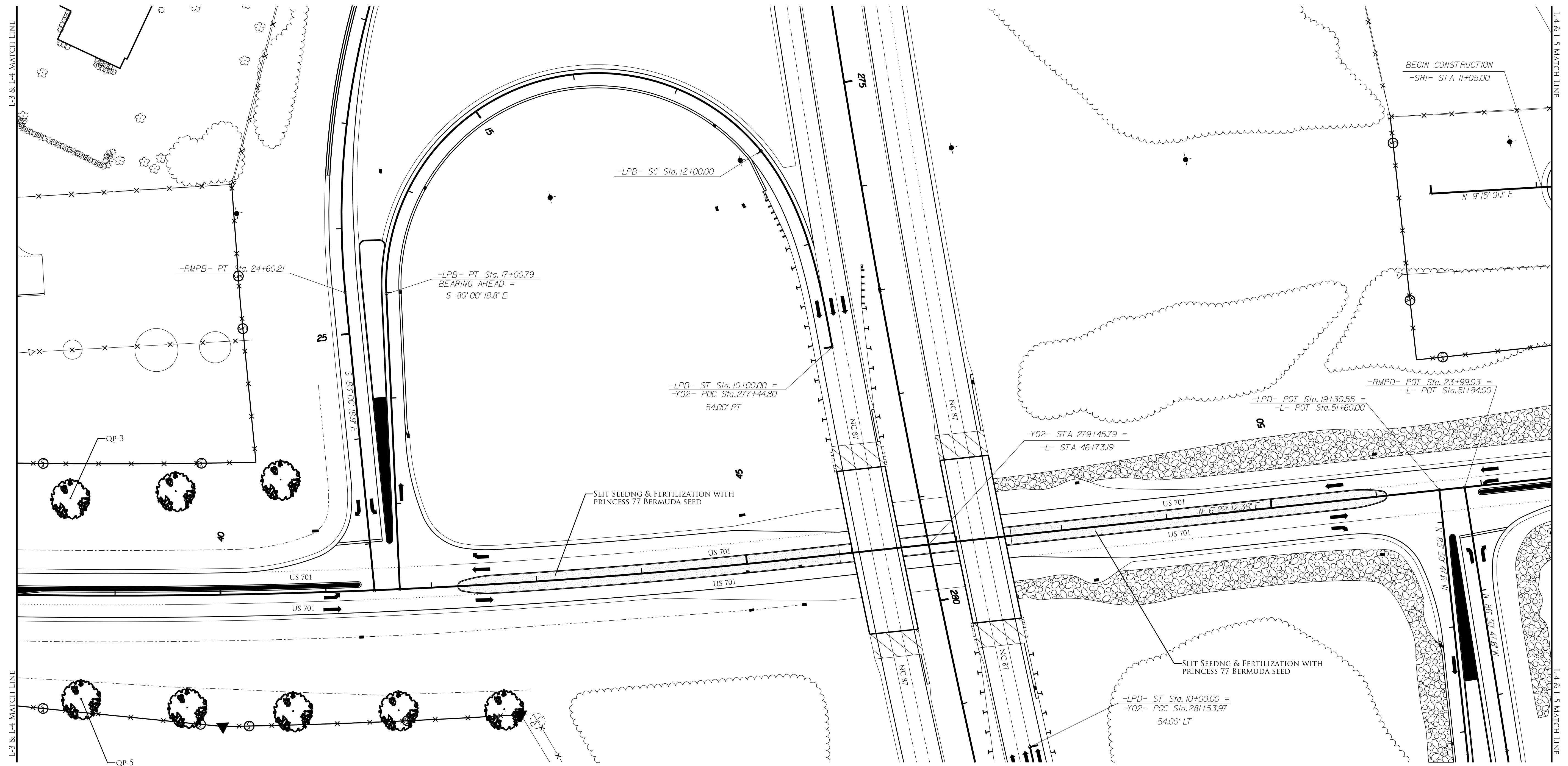

NOTE: PLEASE FOLLOW DIRECTIONS OF
ROADSIDE DIVISION ENGINEER

- ALL PLANT BED LAYOUTS AND TREE GROUPINGS MUST BE APPROVED BY THE ROADSIDE ENGINEER BEFORE MULCHING OR PLANTING.
- ENGINEER MUST APPROVE ANY PLANT BED CHANGES.



QTY	KEY	BOTANICAL NAME	COMMON NAME	SPACING
8	QP	QUERCUS PHELLOS 'HIGHTOWER'	HIGHTOWER WILLOW OAK	100' O.C.

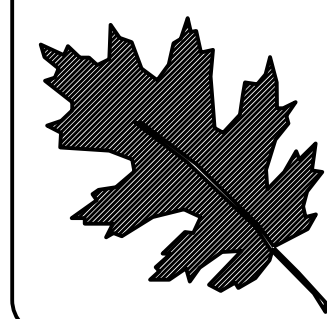

NCDOT - ROADSIDE ENVIRONMENTAL UNIT
LANDSCAPE DESIGN & DEVELOPMENT
1557 MAIL SERVICE CENTER RALEIGH NC 27699-1557
PH: 919-707-2935 FAX: 919-715-2554
[HTTP://WWW.NCDOT.ORG/DOH/OPERATIONS/DP_CHIEF_ENG/ROADSIDE/](http://www.ncdot.org/DOH/OPERATIONS/DP_CHIEF_ENG/ROADSIDE/)

NC 701 & NC 87 BYPASS IN ELIZABETHTOWN,
BLADEN COUNTY
TIP #: R-4903

REV. DESIGNER
Kyle Corder

PREL. DESIGN DATE: APRIL 6, 2018
CHECKED BY & DATE: _____
FINAL DESIGN DATE: MARCH 7, 2019

PLANTING PLAN
LANDSCAPE PLAN SHEET

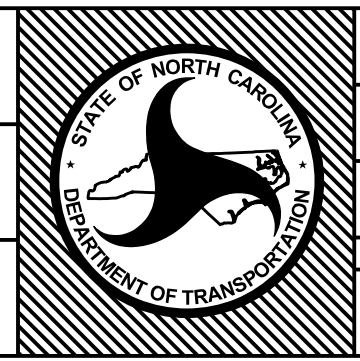

T.I.P. # R-4903
WBS # 40226.1.1
FED I.D. # _____
SHEET NO.: **L-4** / **L-6**
TOTAL SHEET NO.: _____

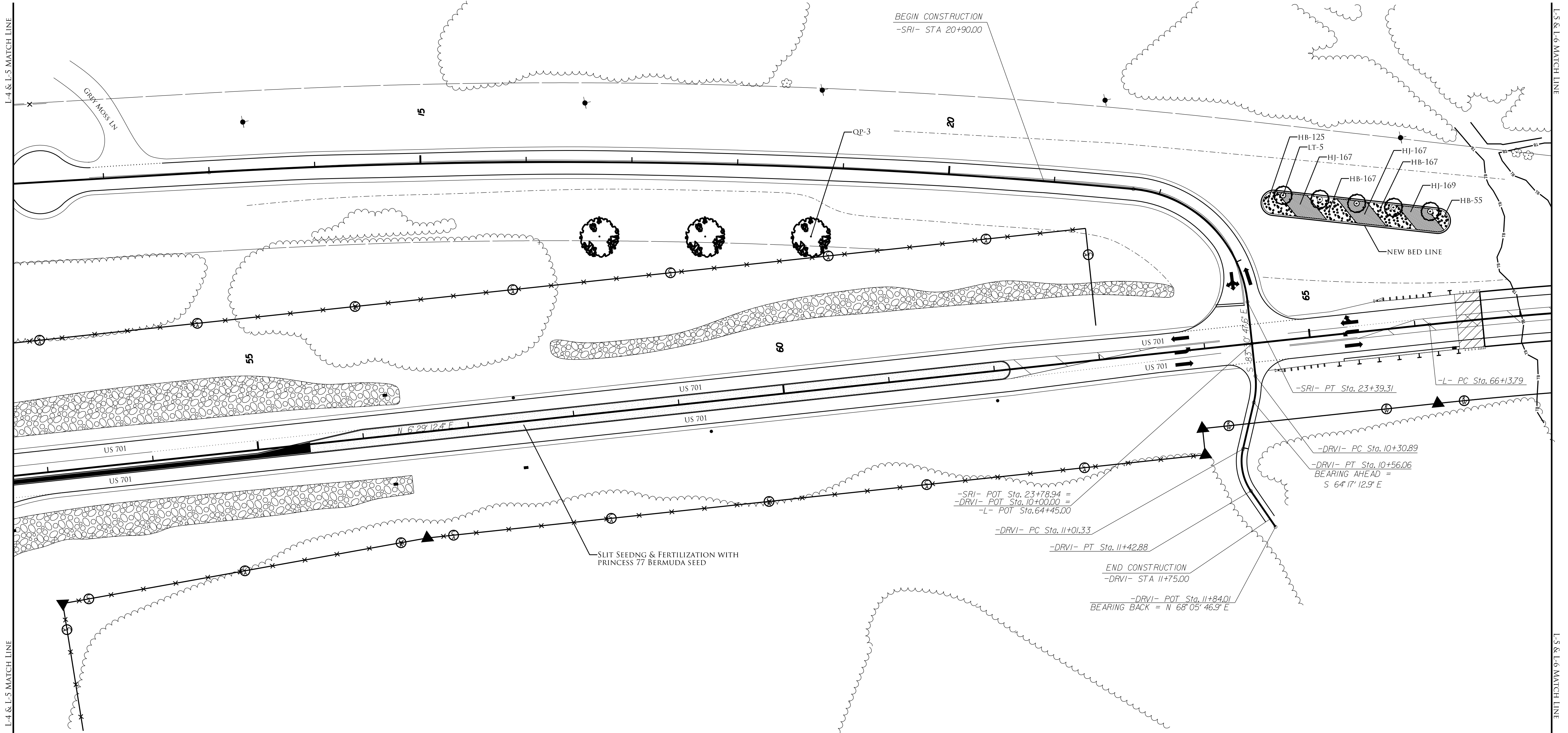

QTY	KEY	BOTANICAL NAME	COMMON NAME	SPACING
514	HB	HEMEROCALLIS 'BUTTERED POPCORN'	BUTTERED POPCORN DAYLILY	2 O.C.
503	HJ	HEMEROCALLIS 'JOAN SENIOR'	JOAN SENIOR DAYLILY	2 O.C.
5	LT	LAGERSTROEMIA INDICA X FAURIEI 'TUSCARORA'	TUSCARORA CRAPE MYRTLE	35' O.C.
3	QP	QUERCUS PHELLOS 'HIGHTOWER'	HIGHTOWER WILLOW OAK	100' O.C.

NOTE: PLEASE FOLLOW DIRECTIONS OF
ROADSIDE DIVISION ENGINEER

- ALL PLANT BED LAYOUTS AND TREE GROUPINGS MUST BE
APPROVED BY THE ROADSIDE ENGINEER BEFORE MULCHING
OR PLANTING.

- ENGINEER MUST APPROVE ANY PLANT BED CHANGES.

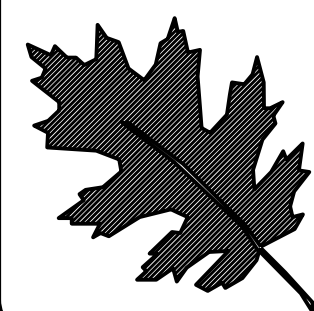

NCDOT - ROADSIDE ENVIRONMENTAL UNIT
LANDSCAPE DESIGN & DEVELOPMENT
1557 MAIL SERVICE CENTER RALEIGH NC 27699-1557
PH: 919-707-2935 FAX: 919-715-2554
[HTTP://WWW.NCDOT.ORG/DOH/OPERATIONS/DP_CHIEF_ENG/ROADSIDE/](http://www.ncdot.org/DOH/OPERATIONS/DP_CHIEF_ENG/ROADSIDE/)

NC 701 & NC 87 BYPASS IN ELIZABETHTOWN,
BLADEN COUNTY
TIP #: R-4903

REV. DESIGNER
Kyle Corder

PREL. DESIGN DATE: APRIL 6, 2018
CHECKED BY & DATE: _____
FINAL DESIGN DATE: MARCH 7, 2019

PLANTING PLAN
LANDSCAPE PLAN SHEET

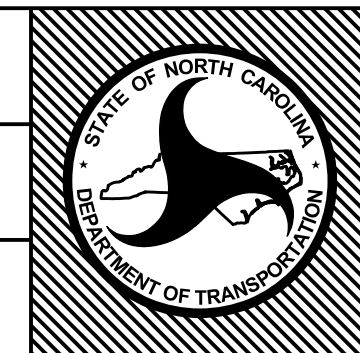

T.I.P. # R-4903
WBS # 40226.1.1
FED I.D. # _____
SHEET NO.: **L-5** TOTAL SHEET NO.: **L-6**

L-5 & L-6 MATCH LINE

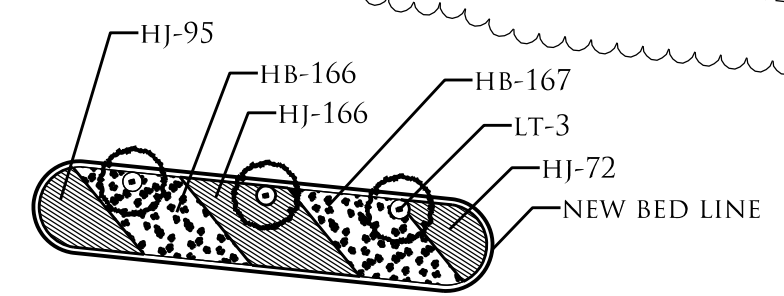
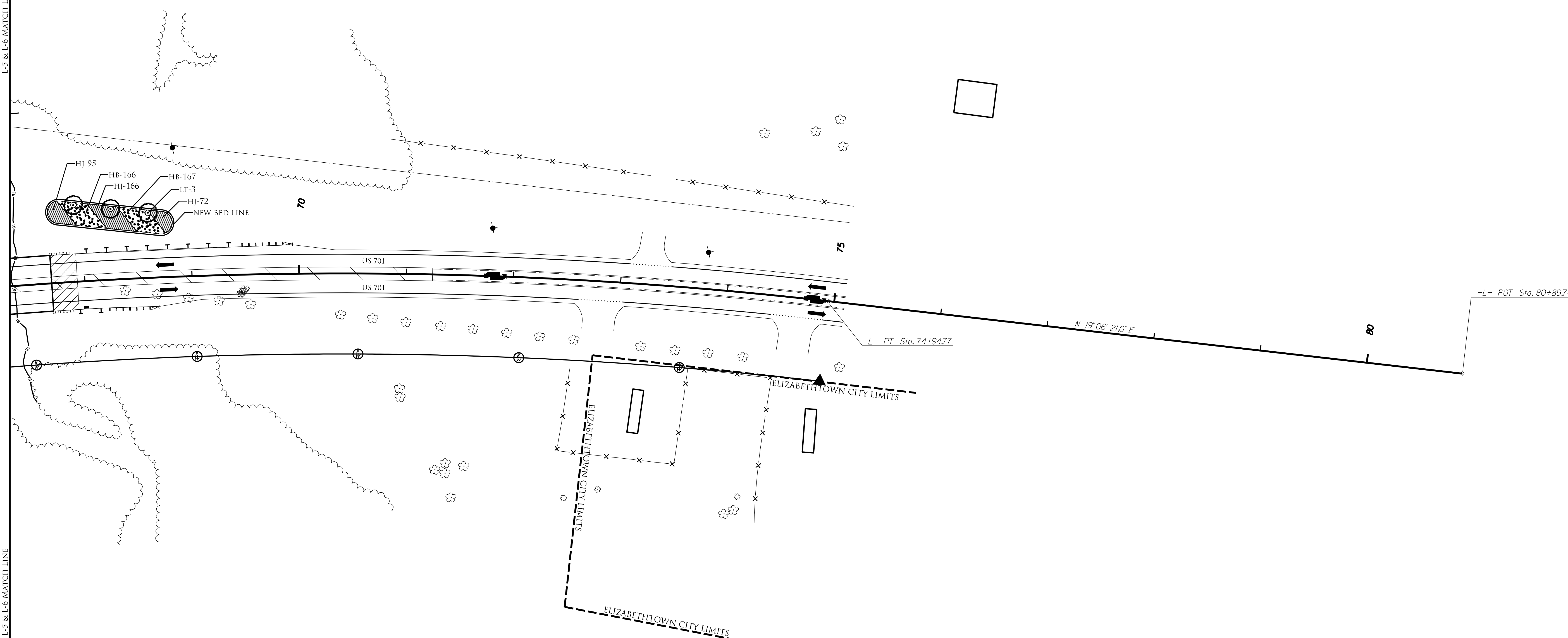

-L- POT Sta. 80+89.74
 -L- PT Sta. 74+94.77
 N 19° 06' 21.0\"/>

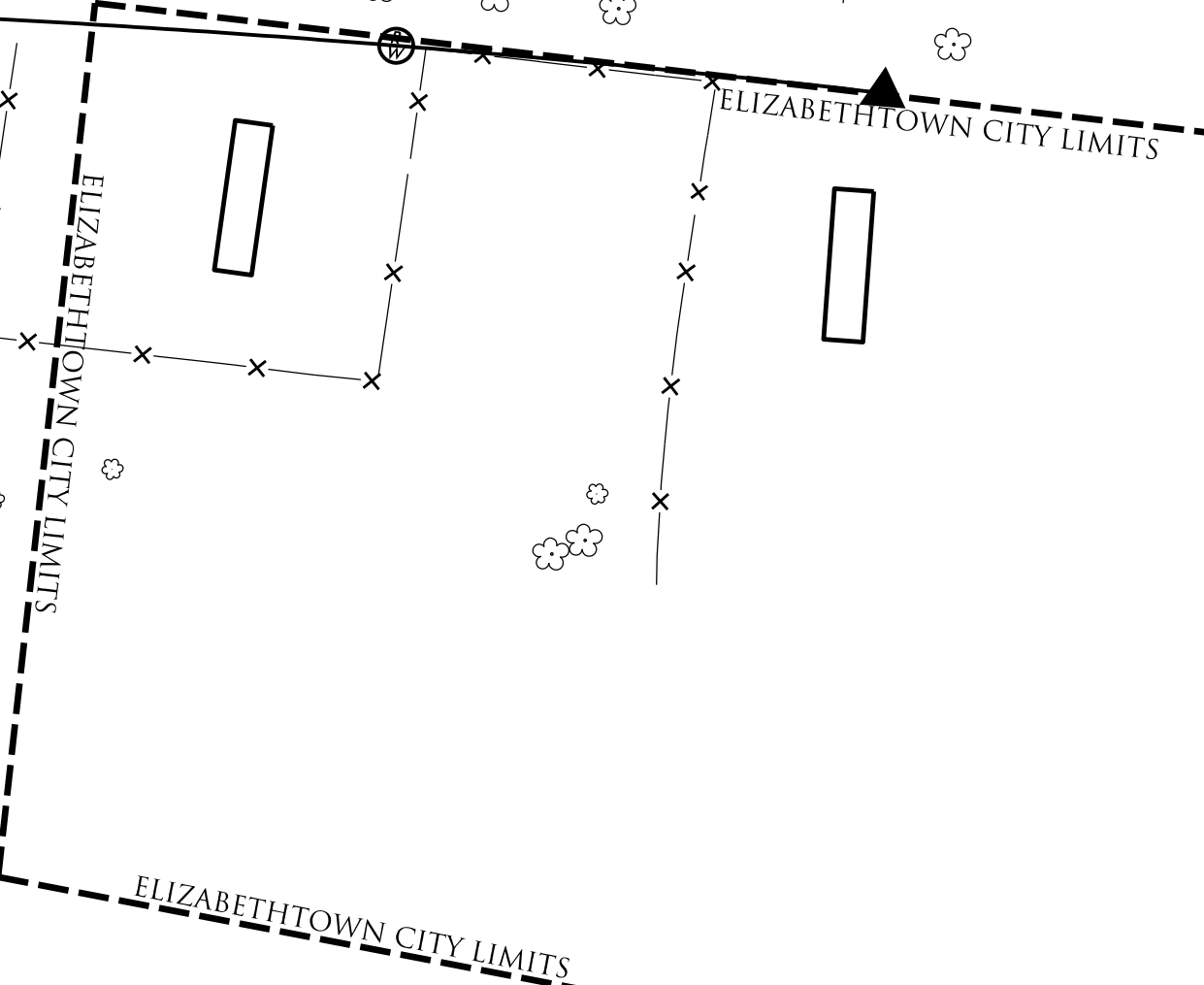

NOTE: PLEASE FOLLOW DIRECTIONS OF
 ROADSIDE DIVISION ENGINEER

- ALL PLANT BED LAYOUTS AND TREE GROUPINGS MUST BE
 APPROVED BY THE ROADSIDE ENGINEER BEFORE MULCHING
 OR PLANTING.

- ENGINEER MUST APPROVE ANY PLANT BED CHANGES.



QTY	KEY	BOTANICAL NAME	COMMON NAME	SPACING
333	HB	HEMEROCALLIS 'BUTTERED POPCORN'	BUTTERED POPCORN DAYLILY	2' O.C.
333	HJ	HEMEROCALLIS 'JOAN SENIOR'	JOAN SENIOR DAYLILY	2' O.C.
3	LT	LAGERSTROEMIA INDICA X FAURIEI 'TUSCARORA'	TUSCARORA CRAPE MYRTLE	35' O.C.

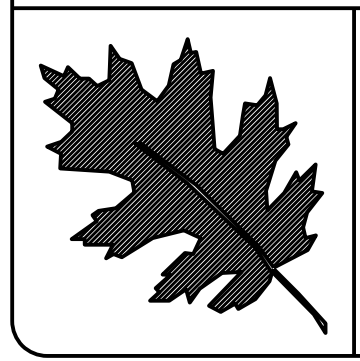

NCDOT - ROADSIDE ENVIRONMENTAL UNIT
 LANDSCAPE DESIGN & DEVELOPMENT
 1557 MAIL SERVICE CENTER RALEIGH NC 27699-1557
 PH: 919-707-2935 FAX: 919-715-2554
[HTTP://WWW.NCDOT.ORG/DOH/OPERATIONS/DP_CHIEF_ENG/ROADSIDE/](http://www.ncdot.org/DOH/OPERATIONS/DP_CHIEF_ENG/ROADSIDE/)

NC 701 & NC 87 BYPASS IN ELIZABETHTOWN,
 BLADEN COUNTY
 TIP #: R-4903

REV. DESIGNER
 Kyle Corder

SHEET DESCRIPTION:
 PREL. DESIGN DATE: APRIL 6, 2018
 CHECKED BY & DATE: - - - -
 FINAL DESIGN DATE: MARCH 7, 2019

PLANTING PLAN
 LANDSCAPE PLAN SHEET

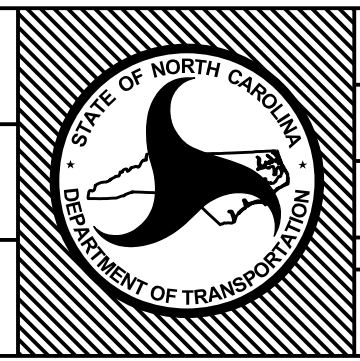

T.I.P. # R-4903
 WBS # 40226.1.1
 FED I.D. #
 SHEET NO.: L-6
 TOTAL SHEET NO.: L-6