

STATE OF NORTH CAROLINA  
DEPARTMENT OF TRANSPORTATION  
HIGHWAY DIVISION 6

## **REVISED PLANS – 8-15-16**

**CONTRACT ID: DF00134**

**TIP NO.: SS-4906CK**

**WBS ELEMENT NO.: 44699.3.1**

**COUNTY: HARNETT**

**ROUTE NO.: SR 1120 (OVERHILLS ROAD)**

**LOCATION: 0.3 MI. SOUTH OF SR 1144**

**TYPE OF WORK: GRADING, PAVING, SIGNING, MILLED CENTERLINE AND  
EDGE LINE RUMBLE STRIPS & PAVEMENT MARKINGS**

-L-

PI Sta 12+60.39  
 $\Delta = 2^\circ 23' 47.6"$  (LT)  
 $D = 1^\circ 22' 13.3"$   
 $L = 174.88'$   
 $T = 87.46'$   
 $R = 4,181.09'$

PI Sta 14+54.57  
 $\Delta = 12^\circ 18' 45.6"$  (LT)  
 $D = 5^\circ 47' 20.3"$   
 $L = 212.69'$   
 $T = 106.76'$   
 $R = 989.74'$

PI Sta 16+07.96  
 $\Delta = 8^\circ 33' 17.4"$  (LT)  
 $D = 9^\circ 01' 53.9"$   
 $L = 94.72'$   
 $T = 47.45'$   
 $R = 634.39'$

PI Sta 18+32.38  
 $\Delta = 18^\circ 12' 14.2"$  (LT)  
 $D = 5^\circ 10' 54.2"$   
 $L = 351.31'$   
 $T = 177.15'$   
 $R = 1,105.73'$

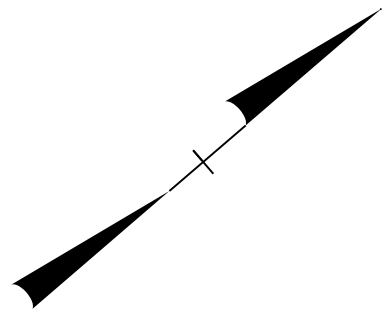

**BEGIN STATE PROJECT SS-4906CK**  
**-L- STA POT 10+00.00**

**END STATE PROJECT SS-4906CK**  
**-L- STA POT 22+25.00**

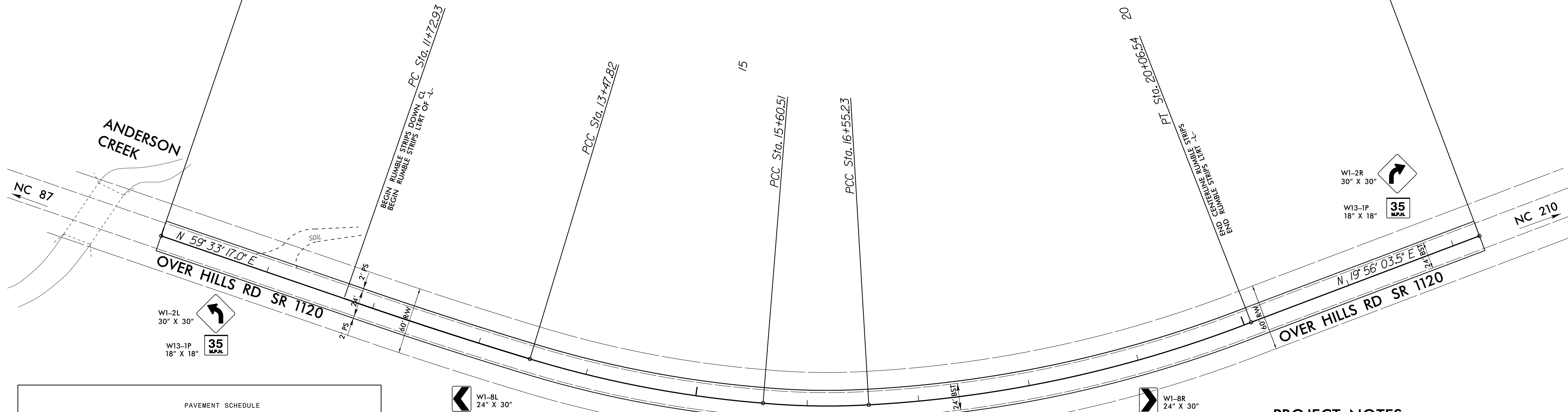

| PAVEMENT SCHEDULE |  |
|-------------------|--|
| D1                | PROP. APPROX. 6" ASPHALT CONCRETE BASE COURSE, TYPE B25.0B, AT AN AVERAGE RATE OF 684 LBS. PER SQ. YD. |
| H1                | 16" CENTERLINE MILLED RUMBLE STRIP   |
| H2                | 8" EDGETLINE MILLED RUMBLE STRIP   |
| U                 | EXISTING PAVEMENT  |

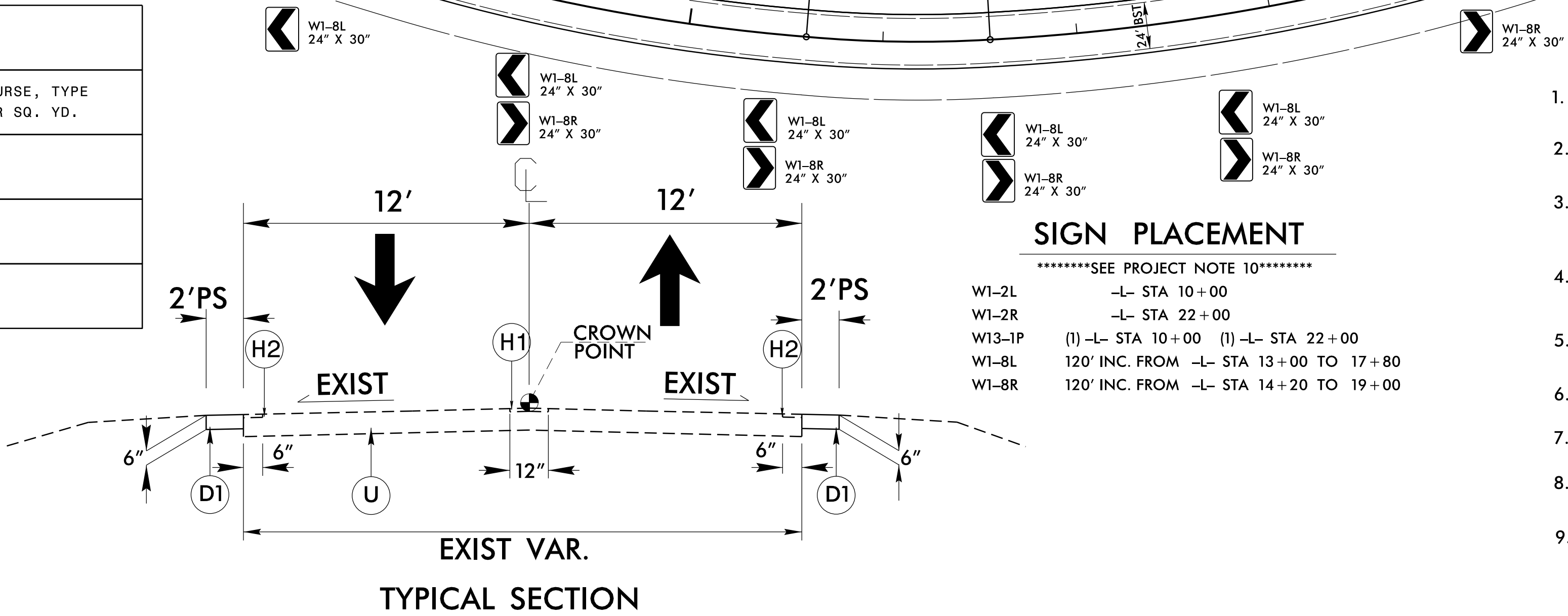

#### PROJECT NOTES

1. The Contractor shall not work on both sides of the road simultaneously within the same area.
2. Ingress and egress shall be maintained to all businesses and dwellings on the project.
3. At the end of each workday, the Contractor shall be required to backfill any area adjacent to existing travelway that has been graded leaving no more than a 1" drop-off.
4. A minimum of two-way, two-lane traffic (plus all existing left and right turn lanes) shall be maintained during periods of construction inactivity.
5. The Contractor shall not be allowed to stop traffic for more than 5 minutes at a time in any one direction.
6. During periods of construction inactivity, the difference in elevation between lanes shall not exceed 1-1/2 inch.
7. Access to police and fire station, fire hydrants, and hospitals shall be maintained at all times.
8. During periods of construction inactivity, place cones/drums 3' from existing edge of pavement (travelway) as directed by the Engineer.
9. Contractor shall coordinate with the Division Six Traffic Services Unit (910-486-1452) for placement of all pavement markings and signs.

#### SIGN PLACEMENT

\*\*\*\*\*SEE PROJECT NOTE 10\*\*\*\*\*  
-L- STA 10+00  
-L- STA 22+00  
(1) -L- STA 10+00 (1) -L- STA 22+00  
120' INC. FROM -L- STA 13+00 TO 17+80  
120' INC. FROM -L- STA 14+20 TO 19+00

REVISIONS

8/17/99

16-AUG-2016 08:51 \\SS-4906CK SR 1120 Overhills D:\Roadway\proj\SS-4906CK\_Rd.dgn and typ.dgn  
SS-4906CK SR 1120 Overhills D:\Roadway\proj\SS-4906CK\_Rd.dgn and typ.dgn

DOCUMENT NOT CONSIDERED FINAL  
UNLESS ALL SIGNATURES COMPLETED

## EDGE LINE TREATMENT

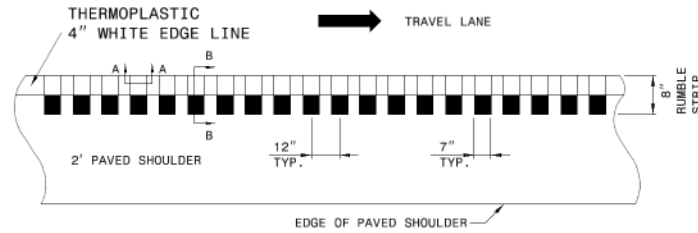

## EDGE LINE MILLING DETAIL

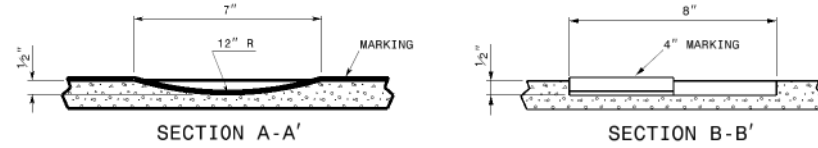

## CENTER LINE

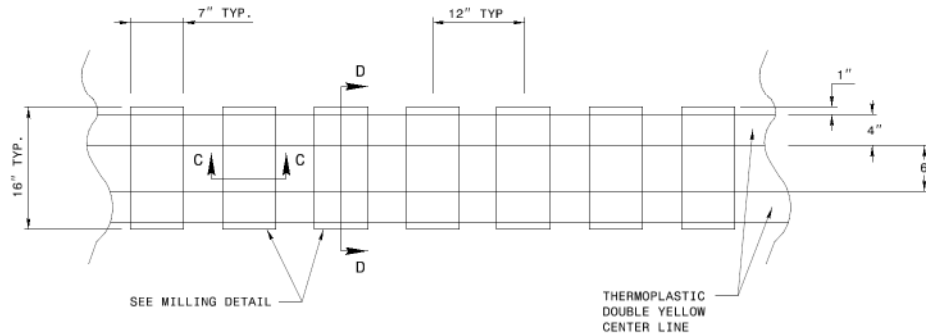

## CENTER LINE MILLING DETAIL

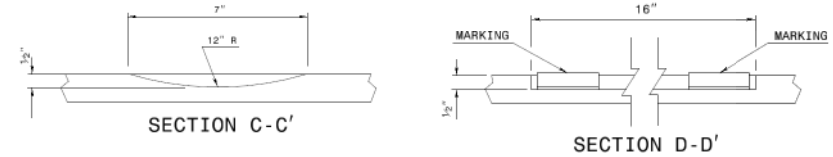

### NOTE:

- 1) USING A VACUUM, REMOVE ALL DEBRIS FROM THE MILLINGS JUST PRIOR TO PLACING ANY PAVEMENT MARKINGS
- 2) ENSURE GLASS BEADS ARE SPREAD UNIFORMLY OVER THE ENTIRE SURFACE OF THE PAVEMENT MARKING MATERIAL.
- 3) PLACE MILLED RUMBLES AS SHOWN ABOVE IN THIS DETAIL ON BOTH SHOULDER IN BOTH DIRECTIONS.

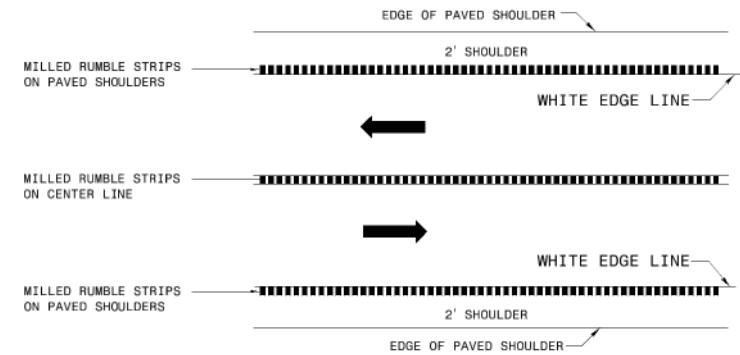

## LANE TREATMENT