

**This electronic collection of documents is provided
for the convenience of the user
and is Not a Certified Document –**

**The documents contained herein were originally issued
and sealed by the individuals whose names and license
numbers appear on each page, on the dates appearing
with their signature on that page.**

**This file or an individual page
shall not be considered a certified document.**

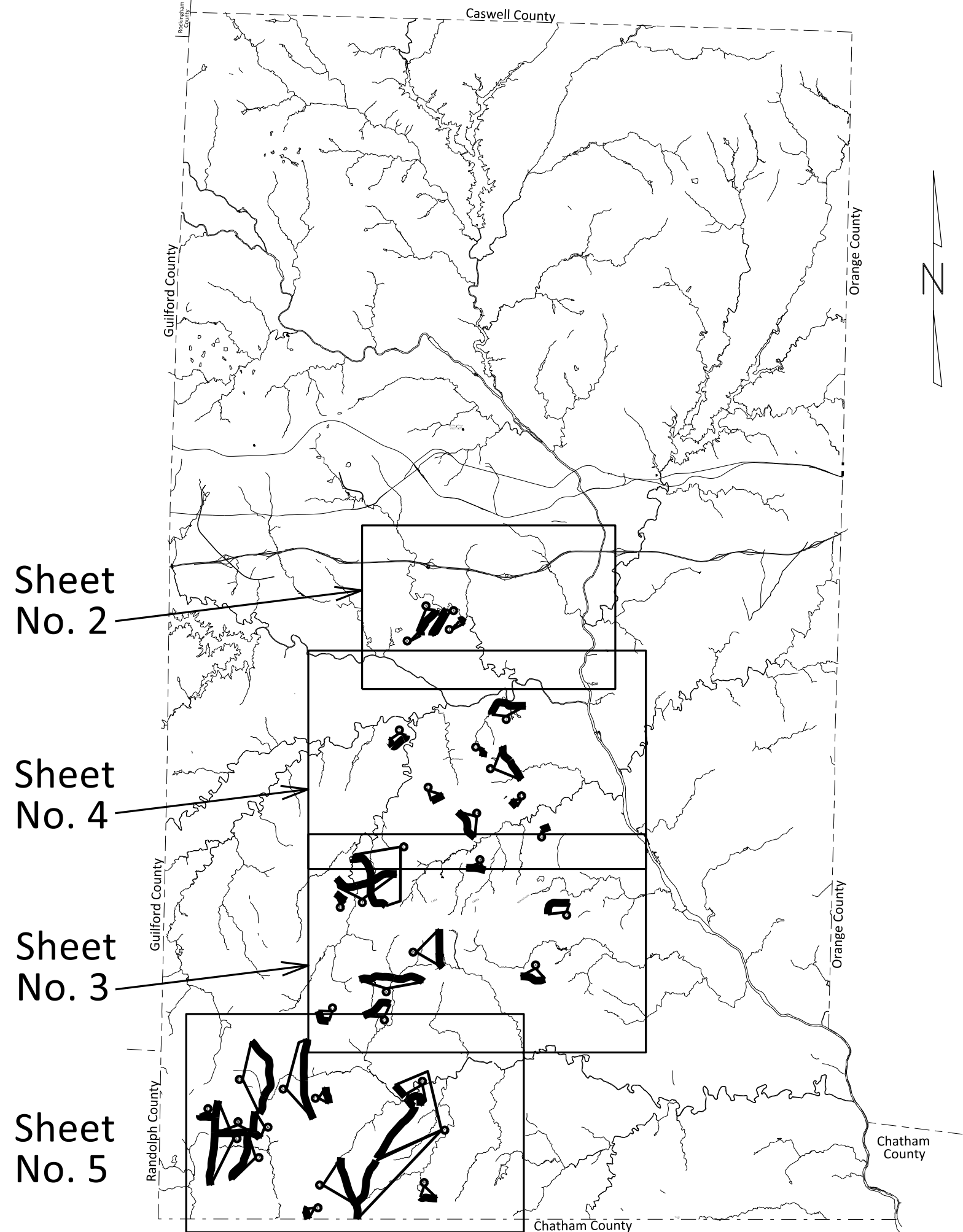

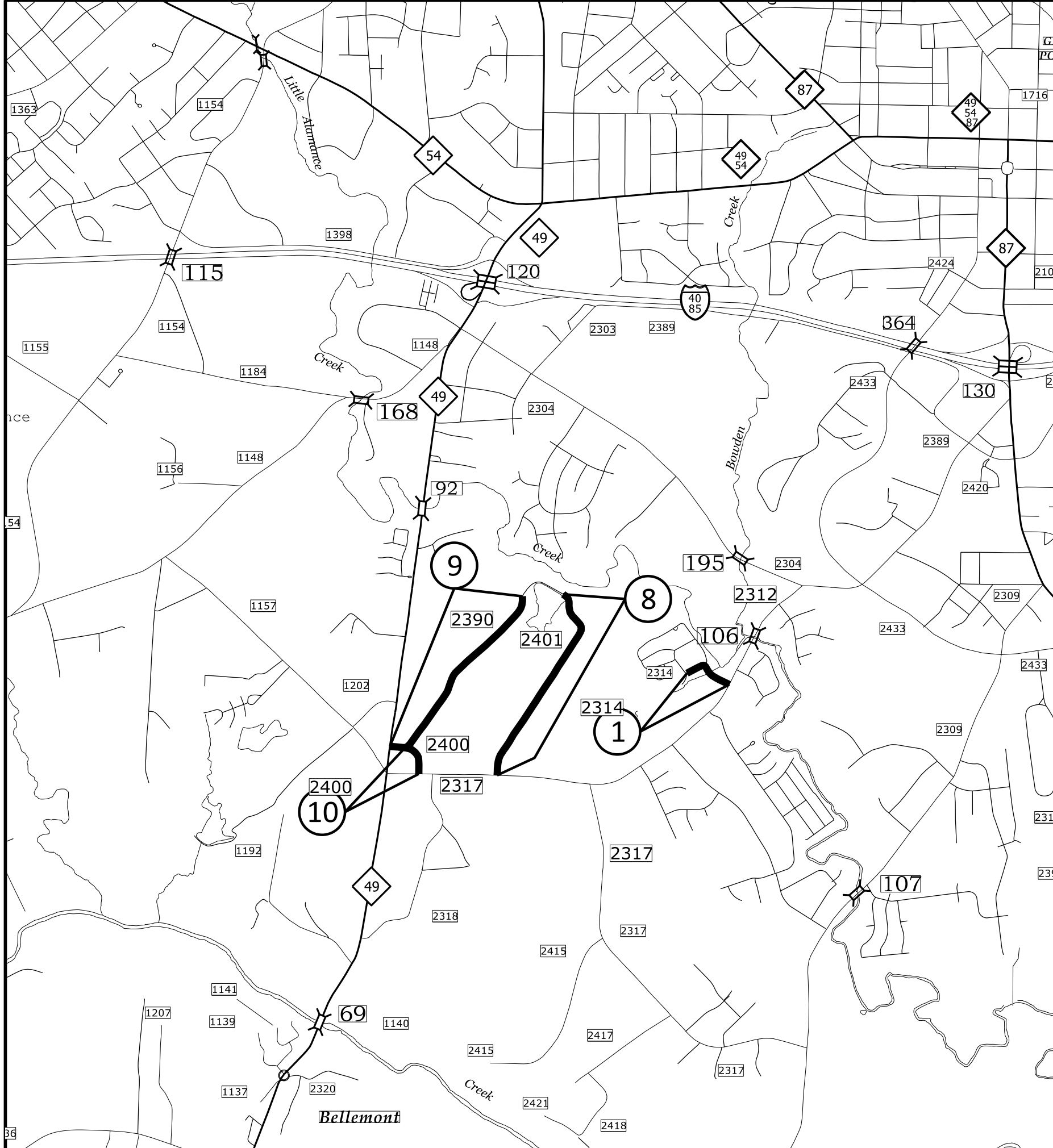

- Map 1 SR 2314 Kernodle Lane
- Map 8 SR 2401 Shamrock Dr.
- Map 9 SR 2390 Shamrock Dr.
- Map 10 SR 2400 Parkway Dr.

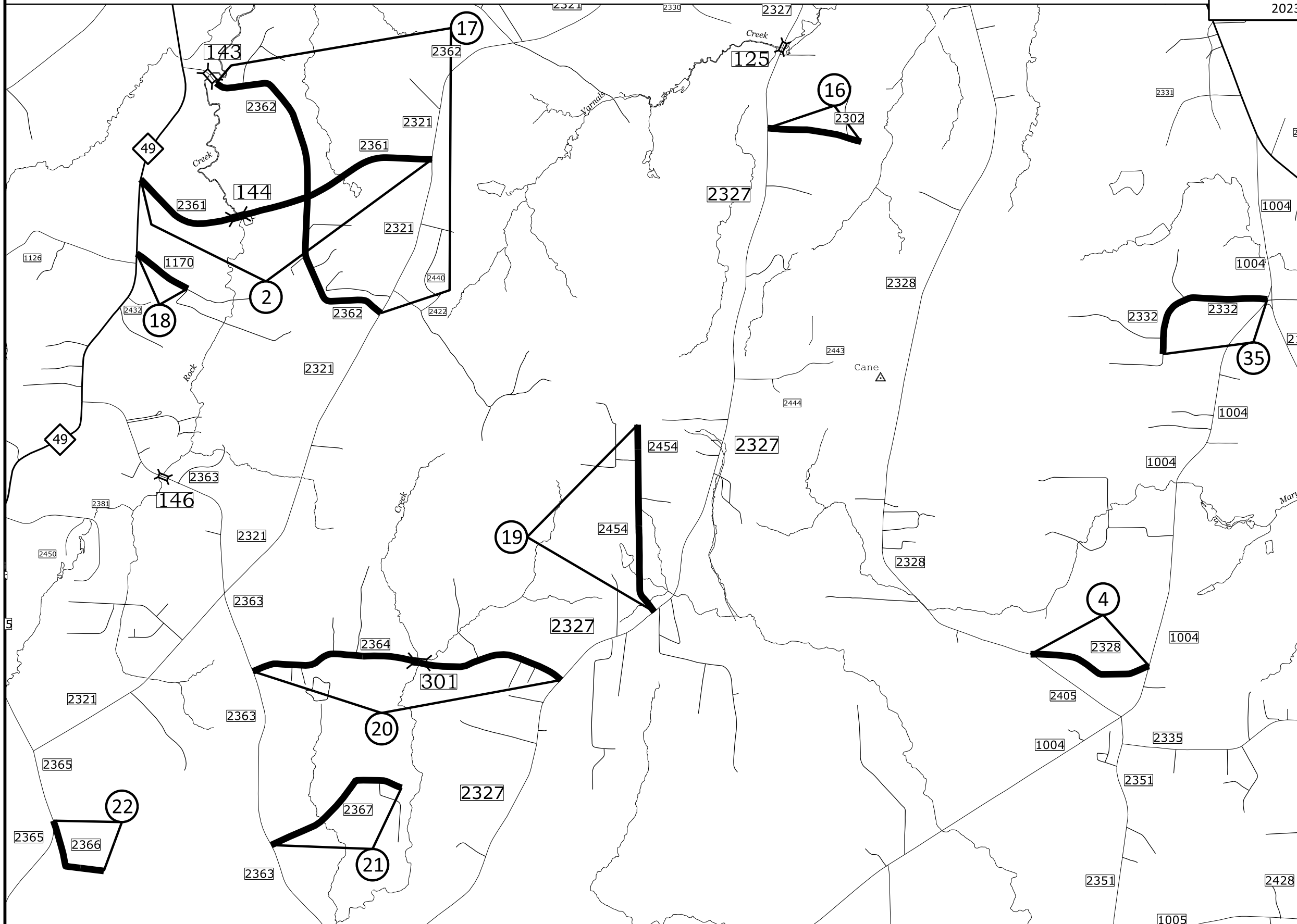

- Map 2 SR 2361 - Russell Mcpherson Rd
- Map 4 Bridge # 144 - Resurface
- Map 16 SR 2328 - Thompson Mill Rd
- Map 17 SR 2302 - Tingen Rd
- SR 2362 - Holt Cross Rd/
Holt Crossroads Rd
- Bridge # 143 Not within Map Limits
- Skip paving at Map 2 Intersection
- DO NOT Pave through
- Map 18 SR 1170 - Charley Ln
- Map 19 SR 2454 - Mountain Tr
- Map 20 SR 2364 - Carl Noah Rd
- Bridge #301 - Resurface
- Map 21 SR 2367 - Longest Acres Rd
- Map 22 SR 2366 - Cleve Rd
- Map 35 SR 2332 - Stone Rd

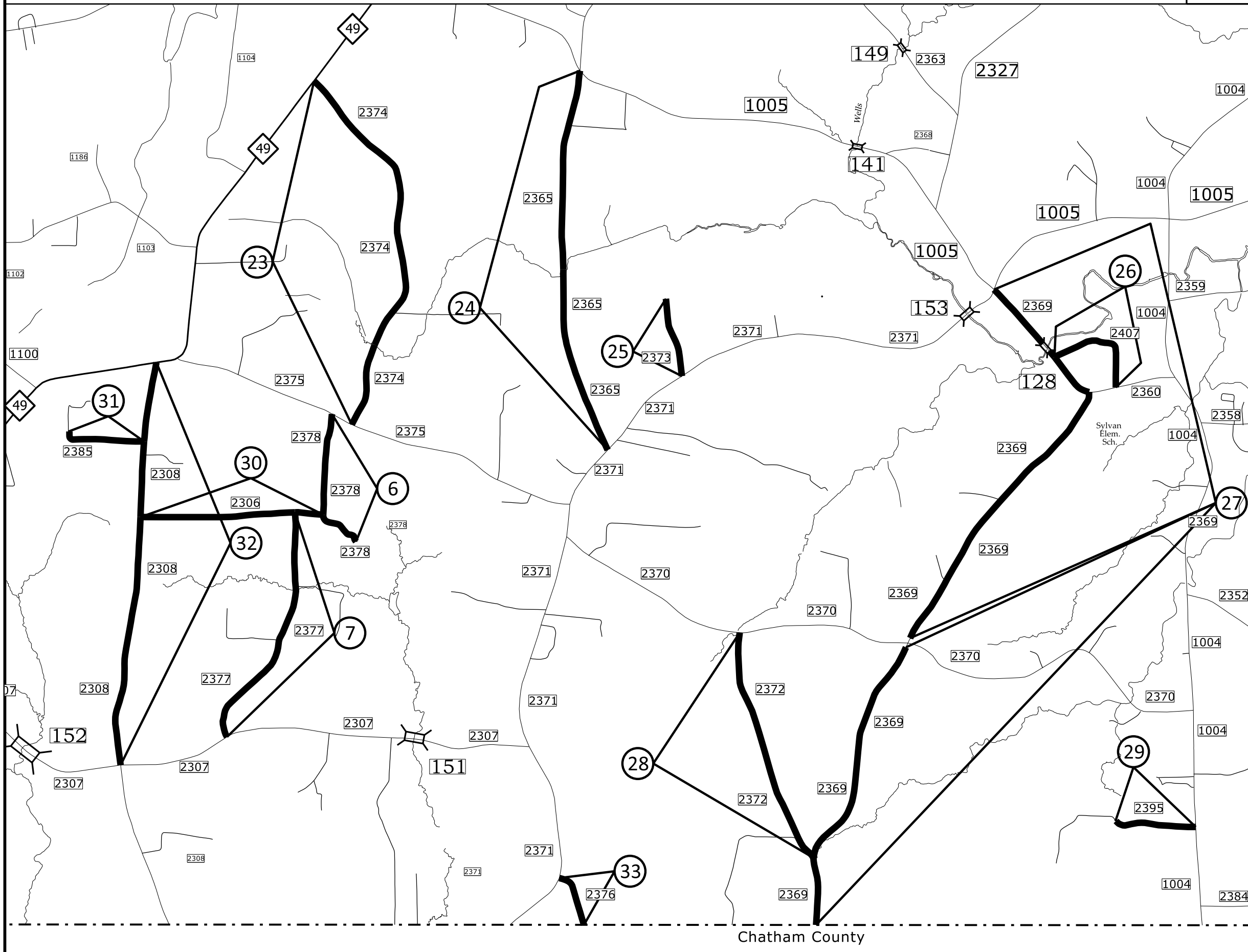

- Map 6 SR 2378 - Kenly Dr
- Map 7 SR 2377 - Moody Rd
- Map 23 SR 2374 - Rural View Rd
- Map 24 SR 2365 - Coble Mill Rd
- Map 25 SR 2373 - Charlie Euliss Rd
- Map 26 SR 2407 - Drama Rd
- Map 27 SR 2369 - Sylvan Rd
- Skip new Pavement at Bridge #128
- DO NOT Pav
- Skip SR 2370 - OLD DAM RD
- DO NOT Pav
- Skip Gravel Section
- DO NOT Pav
- Map 28 SR 2372 - Cocoa Rd
- Map 29 SR 2395 - R P Cox Rd
- Map 30 SR 2306 - Pike Rd
- Map 31 SR 2385 - Hinshaw Rd
- Map 32 SR 2308 - Hinshaw Shop Rd
- Map 33 SR 2376 - Anders Rd

Chatham County

ALAMANCE COUNTY
NORTH CAROLINA

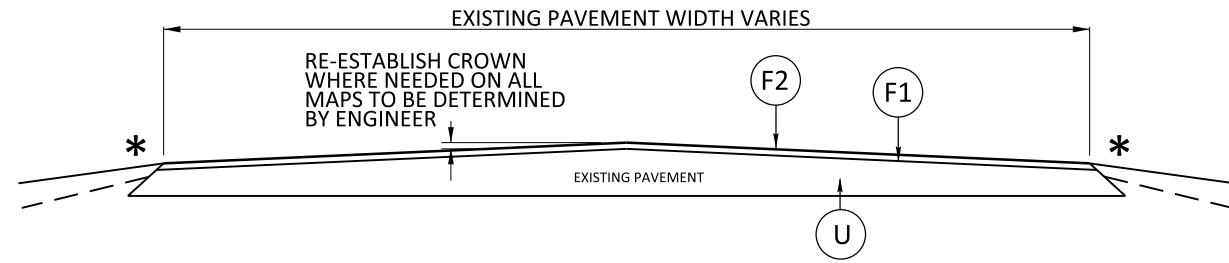

NOTE:
* THE SURFACE TO BE TREATED SHALL BE CLEANED TO THE SATISFACTION OF THE INSPECTOR PRIOR TO STARTING ON EACH MAP

TYPICAL SECTION NO. 1

Map 1	SR 2314 - Kernodle Ln	Map 17	SR 2362 - Holt Cross Rd / Holt Crossroads Rd	Map 27	SR 2369 - Sylvan Rd
Map 2	SR 2361 - Russell Mcpherson Rd		Bridge # 143 Not within Map Limits		Skip new Pavement at Bridge #128
	Bridge # 144 - Resurface		Skip paving at Map 2 Intersection		DO NOT Pave
Map 3	SR 2319 - Boggs Ranch Rd		DO NOT Pave through		Skip SR 2370 - Old Dam Rd
Map 4	SR 2328 - Thompson Mill Rd				DO NOT Pave
Map 5	SR 2325 - Watkins Rd	Map 18	SR 1170 - Charley Ln		Skip Gravel Section
Map 6	SR 2378 - Kenly Dr	Map 19	SR 2454 - Mountain Tr		DO NOT Pave
Map 7	SR 2377 - Moody Rd	Map 20	SR 2364 - Carl Noah Rd		
Map 8	SR 2401 - Shamrock Dr		Bridge #301 - Resurface	Map 28	SR 2372 - Cocoa Rd
Map 9	SR 2390 - Shamrock Dr	Map 21	SR 2367 - Longest Acres Rd	Map 29	SR 2395 - R P Cox Rd
Map 10	SR 2400 - Parkway Dr	Map 22	SR 2366 - Cleve Rd	Map 30	SR 2306 - Pike Rd
Map 11	SR 2324 - Woods Chapel Rd	Map 23	SR 2374 - Rural View Rd	Map 31	SR 2385 - Hinshaw Rd
Map 12	SR 2408 - Glenwood Dr	Map 24	SR 2365 - Coble Mill Rd	Map 32	SR 2308 - Hinshaw Shop Rd
Map 13	SR 2392 - Antioch Church Rd	Map 25	SR 2373 - Charlie Euliss Rd	Map 33	SR 2376 - Anders Rd
Map 14	SR 2329 - Keystone Rd	Map 26	SR 2407 - Drama Rd	Map 34	SR 2391 - Graves Rd
Map 15	SR 2379 - Shady Grove Ln			Map 35	SR 2332 - Stone Rd
Map 16	SR 2302 - Tingen Rd				

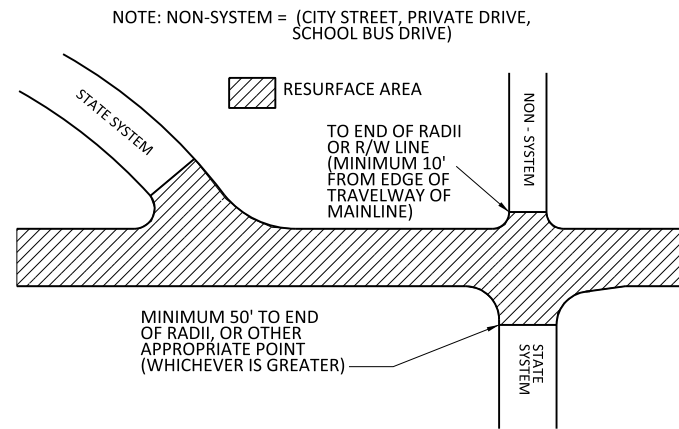

PAVING DETAIL 1
MAIN LINE IS BEING RESURFACED

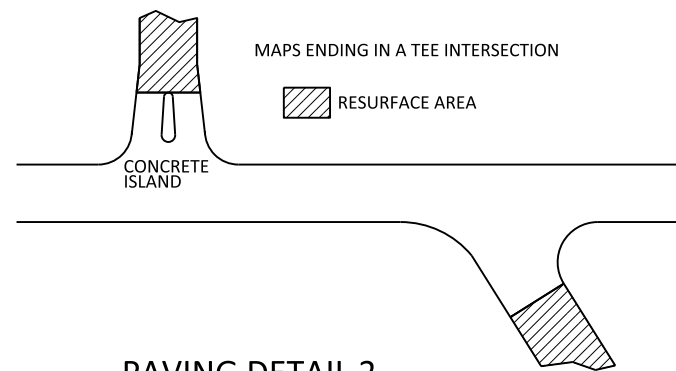

PAVING DETAIL 2
MAIN LINE NOT BEING RESURFACED

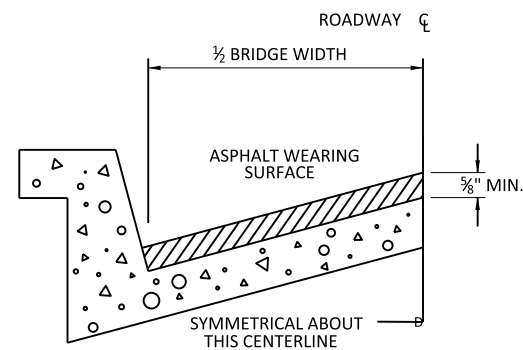

BRIDGE HALF TYPICAL SECTION

FOR BRIDGES WITH FLOOR DRAINS, CARE SHALL BE EXERCISED IN PLACING THE WEARING SURFACE AROUND FLOOR DRAINS SO AS NOT TO HINDER EFFECTIVE DRAINAGE. ALL DRAINS SHALL BE LEFT OPEN. THE PROPOSED WEARING SURFACE SHALL VARY IN THICKNESS AS NECESSARY TO PROVIDE A SMOOTH RIDING SURFACE. A THICKNESS OF NOT LESS THAN 3/8" SHALL BE PROVIDED. THE MAXIMUM THICKNESS SHALL PREFERABLY BE 1-1/2" UNLESS IT IS IMPRACTICAL TO PROVIDE A SMOOTH RIDING SURFACE OTHERWISE.

NOTES
ALL UNPAVED S.R. ROUTES TO BE SURFACED 50' FROM EDGE OF PAVEMENT OF MAIN PROJECT.
ALL PAVED S.R. ROUTES TO BE RESURFACED TO END OF RADDII, OR AS DIRECTED BY THE ENGINEER. EDGES, PAVEMENT WIDENING, INTERSECTIONS AND BRIDGE FLARES ARE INCLUDED IN THE SUMMARY OF QUANTITIES. BRIDGES TO BE RESURFACED AT LOCATIONS AND DEPTH AS DIRECTED BY THE ENGINEER.

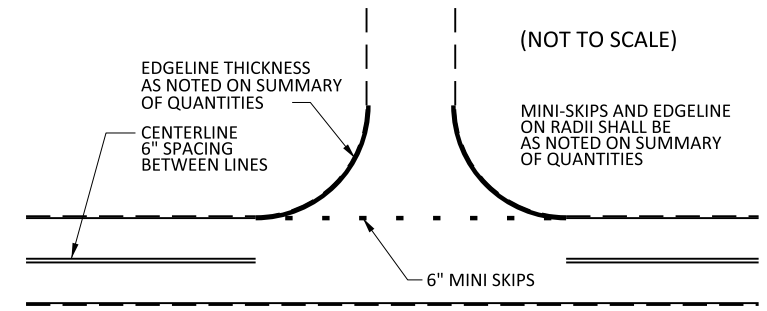

NOTE: MINI SKIPS SHALL BE PLACED ON A 8' CYCLE, CONTAINING A 6' AND 2' SKIP, THE WIDTH OF THE SKIP SHALL BE 6".

NON-SIGNALIZED INTERSECTIONS
TO BE USED AS DIRECTED BY ENGINEER

PAVEMENT SCHEDULE	
F1	PROPOSED ASPHALT SURFACE TREATMENT, DOUBLE SEAL
F2	PROPOSED FOG SEAL
U	EXISTING PAVEMENT

SIGNING FOR ASPHALT SURFACE TREATMENT

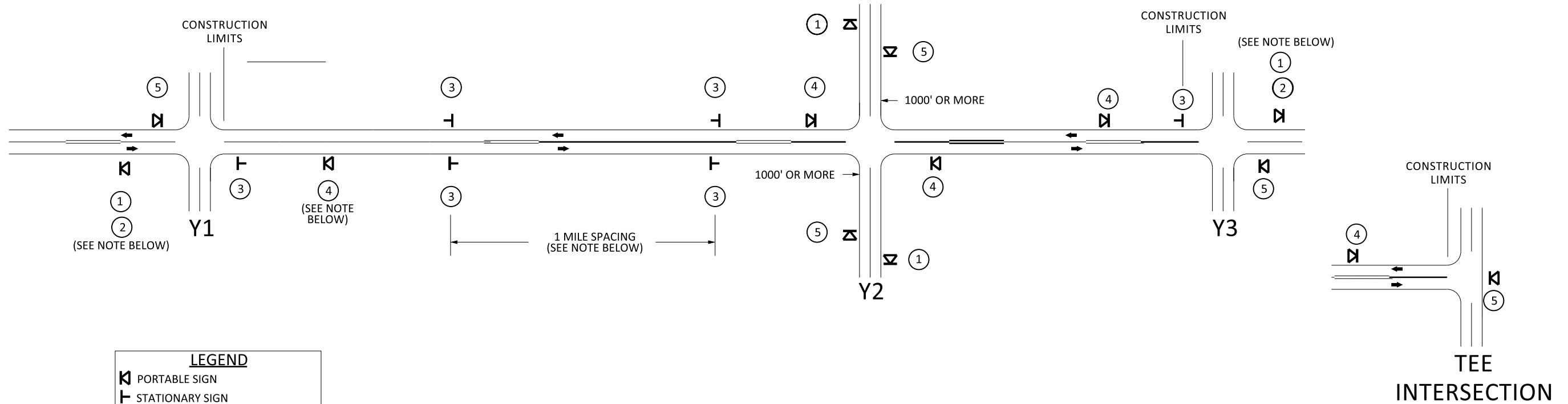

LEGEND	
K	PORTABLE SIGN
T	STATIONARY SIGN
←	DIRECTION OF TRAFFIC FLOW

MAINLINE (-L-) SIGNING

-Y- LINE SIGNING

SIGNING NOTES AND PLACEMENT PER DIRECTION	1	<p>W20-1 48" X 48"</p>	PLACE 1000' PRIOR TO BEGINNING OF CONSTRUCTION LIMITS. ONLY USED ON -Y- LINES IF RESURFACING LIMITS EXTEND 1000' ALONG -Y- LINE.
	2	<p>W7-3aP 24" X 18"</p>	#2 SIGN ONLY USED WHEN RESURFACING LIMITS ARE 2 OR MORE MILES IN LENGTH. ROUND UP TO NEXT WHOLE NUMBER.(NO FRACTIONAL OR DECIMAL NUMBERS)
	3	<p>WB-7 48" X 48"</p>	- ALTERNATE THE FOLLOWING TWO SIGNS: - STARTING WITH "LOOSE GRAVEL" (WB-7) FOLLOWED BY "UNMARKED PAVEMENT". - PLACE INITIALLY AT THE CONSTRUCTION LIMITS AND SPACED 1 MILE APART THEREAFTER.
		<p>SP 13106 48" X 48"</p>	- AT TEE INTERSECTIONS INSTALL INITIALLY 0.5 MILES FROM INTERSECTION AND SPACE 1 MILE APART THEREAFTER.
	4	<p>SP 13106 48" X 48"</p>	THESE ARE FOR -Y- LINES THAT ARE "THROUGH" ROADWAYS. DEAD END AND SUBDIVISION ROADS ARE NOT "THROUGH" ROADWAYS. INSTALL 500' +/- FROM EACH -Y- LINE APPROACH AS SHOWN ABOVE. FOR MULTIPLE -Y- LINES THAT ARE SEPARATED BY 0.25 MILES OR LESS, TREAT AS A SINGLE UNIT AND INSTALL WITHIN 500' OF EACH APPROACH. A MAXIMUM OF 2 SIGN SETS PER MILE. DO NOT INSTALL WHEN -Y- LINES ARE WITHIN 0.5 MILES FROM "END ROAD WORK" SIGN.
5	<p>G20-2 A 48" X 24"</p>	PLACE 500' FOLLOWING THE END OF CONSTRUCTION LIMITS.	

NO REQUIRED STATIONARY SIGNING FOR THE FOLLOWING -Y- LINE CONDITIONS:

- 1) LESS THAN 1000' OF RESURFACING ALONG -Y- LINE
- 2) SUBDIVISION ROADS
- 3) DEAD END ROADS

WHEN PAVING/CONSTRUCTION ACTIVITIES PROCEED ACROSS AN UNSIGNED -Y- LINE, ADVANCE WARNING PORTABLE SIGNS SHALL BE USED ALONG THE -Y- LINE AS SHOWN BELOW. REMOVE UPON COMPLETION OF WORK.

W20-1
48" X 48"

PLACED 500' IN ADVANCE OF FLAGGER.

W20-7 A
48" X 48"

PLACED 250' IN ADVANCE OF FLAGGER.

THE ABOVE SIGNS ARE ALL THAT ARE REQUIRED FOR A CONTRACTOR TO BEGIN A RESURFACING CONTRACT. ANY ADDITIONAL SIGNS REQUESTED BY NCDOT DIVISIONS SHALL BE INSTALLED WITHIN 7 BUSINESS DAYS OF THE START OF CONTRACT WORK.

MAPS LESS THAN 2 MILES

FOR AST RESURFACING MAPS WITH CONSTRUCTION LIMITS LESS THAN 2 MILES IN LENGTH, USE A STATIONARY "LOOSE GRAVEL" SIGN AT THE BEGINNING CONSTRUCTION LIMIT FOLLOWED BY AN "UNMARKED PAVEMENT" SIGN MIDWAY THROUGH AND AN "END ROAD WORK" SIGN AT THE END CONSTRUCTION LIMIT.

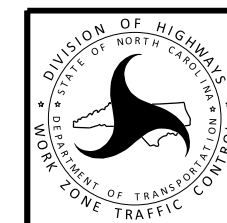

RESURFACING
ADVANCE WARNING SIGNS
FOR
RURAL AND SUBURBAN
2 LANE ROADWAYS

PROJECT NO.	SHEET NO.	TOTAL NO.
2023CPT.07.01.20012	8	

SUMMARY OF QUANTITIES

PROJECT NO	COUNTY	MAP NO	ROUTE	DESCRIPTION	TYP NO	LENGTH		1803500000-E	1820000000-E	1838000000-E	1838500000-N	4413000000-E	4457000000-N	4688000000-E	4720000000-E			4890000000-E			4891000000-E
						MI	FT	SY	SY	GAL	WK	SF	LS	LF	EA	EA	EA	LF	LF	LF	LF
2023CPT.07.01.20012	Alamance	1	SR 2314 - KERNODLE LN	FROM SR 2312 - MONROE HOLT RD TO DEAD END	1	0.17	20	2,403	2,403	1,322	3	19	1.00								
TOTAL FOR MAP NO. 1						0.17		2,403	2,403	1,322	3	19	1								
2023CPT.07.01.20012	Alamance	2	SR 2361 - RUSSELL MCPHERSON RD	FROM SR 2321 - MT HERMON ROCK CREEK RD TO NC 49	1	1.52	21-24	19,454	19,454	10,749		170		44				16,350	15,250		
TOTAL FOR MAP NO. 2						1.52		19,454	19,454	10,749		170		44				16,350	15,250		
2023CPT.07.01.20012	Alamance	3	SR 2319 - BOGGS RANCH RD	FROM NC 87 SOUTH TO DEAD END	1	0.999	20	11,814	11,814	6,498		112						10,250	10,000		
TOTAL FOR MAP NO. 3						0.999		11,814	11,814	6,498		112						10,250	10,000		
2023CPT.07.01.20012	Alamance	4	SR 2328 - THOMPSON MILL RD	FROM SR 2405 - BETHEL SOUTH FORK RD TO SR 1004 - SNOW CAMP RD	1	0.582	20-21	7,848	7,848	4,316		65						6,200	6,200		
TOTAL FOR MAP NO. 4						0.582		7,848	7,848	4,316		65						6,200	6,200		
2023CPT.07.01.20012	Alamance	5	SR 2325 - WATKINS RD	FROM NC 49 SOUTH TO DEAD END	1	0.513	20	6,037	6,037	3,320		57									
TOTAL FOR MAP NO. 5						0.513		6,037	6,037	3,320		57									
2023CPT.07.01.20012	Alamance	6	SR 2378 - KENLY DR	FROM SR 2375 - PLEASANT HILL LIBERTY RD TO DEAD END	1	0.642	19-20	7,795	7,795	4,287		72						6,500	6,500	16	
TOTAL FOR MAP NO. 6						0.642		7,795	7,795	4,287		72						6,500	6,500	16	
2023CPT.07.01.20012	Alamance	7	SR 2377 - MOODY RD	FROM SR 2306 - PIKE RD TO SR 2307 - STALEY STORE RD	1	1.199	20	14,068	14,068	7,734		134						12,750	12,750		
TOTAL FOR MAP NO. 7						1.199		14,068	14,068	7,734		134						12,750	12,750		
2023CPT.07.01.20012	Alamance	8	SR 2401 - SHAMROCK DR	FROM SR 2317 - MONROE HOLT RD TO SR 2321 - BELLEFONT MT HERMON RD	1	0.665	19-20	7,608	7,608	4,184		74						7,020	7,020		
TOTAL FOR MAP NO. 8						0.665		7,608	7,608	4,184		74						7,020	7,020		
2023CPT.07.01.20012	Alamance	9	SR 2390 - SHAMROCK DR	FROM NC 49 TO END OF MAINT	1	0.727	18.5	8,101	8,101	4,456		81						7,680	7,680	30	
TOTAL FOR MAP NO. 9						0.727		8,101	8,101	4,456		81						7,680	7,680	30	
2023CPT.07.01.20012	Alamance	10	SR 2400 - PARKWAY DR	FROM SR 2390 - SHAMROCK DR TO SR 2317 - MONROE HOLT RD	1	0.093	19-20	1,326	1,326	729		10						1,200	1,200	10	
TOTAL FOR MAP NO. 10						0.093		1,326	1,326	729		10						1,200	1,200	10	
2023CPT.07.01.20012	Alamance	11	SR 2324 - WOODS CHAPEL RD	FROM SR 2321 - BELLEFONT MT HERMON RD TO NC 87	1	0.852	20-21	10,424	10,424	5,733		95						9,000	9,000	20	
TOTAL FOR MAP NO. 11						0.852		10,424	10,424	5,733		95						9,000	9,000	20	
2023CPT.07.01.20012	Alamance	12	SR 2408 - GLENWOOD DR	FROM SR 2387 - SOUTHERN HIGH SCHOOL RD TO DEAD END	1	0.169	17-18	1,735	1,735	954		19									
TOTAL FOR MAP NO. 12						0.169		1,735	1,735	954		19									
2023CPT.07.01.20012	Alamance	13	SR 2392 - ANTIOCH CHURCH RD	FROM SR 1136 - BELLEFONT ALAMANCE RD TO DEAD END	1	0.352	20-22	4,337	4,337	2,385		39									
TOTAL FOR MAP NO. 13						0.352		4,337	4,337	2,385		39									
2023CPT.07.01.20012	Alamance	14	SR 2329 - KEYSTONE RD	FROM SR 2321 - BELLEFONT MT HERMON RD TO SR 2327 - HERBERT DR	1	0.725	20-21	8,719	8,719	4,795		81						7,700	7,700		
TOTAL FOR MAP NO. 14						0.725		8,719	8,719	4,795		81						7,700	7,700		
2023CPT.07.01.20012	Alamance	15	SR 2379 - SHADY GROVE LN	FROM SR 2328 - THOMPSON MILL RD TO END OF MAINT	1	0.27	18-22	3,421	3,421	1,882		30									
TOTAL FOR MAP NO. 15						0.27		3,421	3,421	1,882		30									
2023CPT.07.01.20012	Alamance	16	SR 2302 - TINGEN RD	FROM SR 2327 - HERBERT DR TO CUL-DE-SAC	1	0.445	19-20	5,495	5,495	3,022		50									
TOTAL FOR MAP NO. 16						0.445		5,495	5,495	3,022		50									
2023CPT.07.01.20012	Alamance	17	SR 2362 - HOLT CROSS RD / HOLT CROSSROADS RD	FROM BEG PVMT AT BRIDGE #143 TO SR 2321 - BELLEFONT MT HERMON RD	1	1.612	19-20	18,667	18,667	10,267		181						17,250	16,500		
TOTAL FOR MAP NO. 17						1.612		18,667	18,667	10,267		181						17,250	16,500		
2023CPT.07.01.20012	Alamance	18	SR 1170 - CHARLEY LN	FROM NC 49 TO MAINTENANCE END	1	0.294	18-19	3,277	3,277	1,802		33									
TOTAL FOR MAP NO. 18						0.294		3,277	3,277	1,802		33									
2023CPT.07.01.20012	Alamance	19	SR 2454 - MOUNTAIN TR	FROM SR 2327 - HERBERT DR TO END OF MAINT	1	0.919	20	10,789	10,789	5,934		103									
TOTAL FOR MAP NO. 19						0.919		10,789	10,789	5,934		103									
2023CPT.07.01.20012	Alamance	20	SR 2364 - CARL NOAH RD	FROM SR 2363 - BEALE RD TO SR 2327 - HERBERT DR	1	1.527	20-26	18,200	18,200	10,010		171						16,250	16,250		
TOTAL FOR MAP NO. 20						1.527		18,200	18,200	10,010		171						16,250	16,250		
2023CPT.07.01.20012	Alamance	21	SR 2367 - LONGEST ACRES RD	FROM SR 2363 - BEALE RD TO DEAD END	1	0.712	20	8,360	8,360	4,598		80									
TOTAL FOR MAP NO. 21						0.712		8,360	8,360	4,598		80									
2023CPT.07.01.20012	Alamance	22	SR 2366 - CLEVE RD	FROM SR 2365 - COBLE MILL RD TO END OF MAINT	1	0.411	18-20	4,491	4,491	2,470		46									
TOTAL FOR MAP NO. 22						0.411		4,491	4,491	2,470		46									
2023CPT.07.01.20012	Alamance	23	SR 2374 - RURAL VIEW RD	FROM SR 2375 - PLEASANT HILL LIBERTY RD TO NC 49	1	1.889	20	22,179	22,179	12,198		212						20,000	20,000		
TOTAL FOR MAP NO. 23						1.889		22,179	22,179	12,198		212						20,000	20,000		
2023CPT.07.01.20012	Alamance	24	SR 2365 - COBLE MILL RD	FROM SR 2371 - PLEASANT HILL CHURCH RD TO SR 1005 - W GREENSBORO CHAPEL HILL RD	1	1.87	20	21,950	21,950	12,072		209						19,750	17,500		
TOTAL FOR MAP NO. 24						1.87		21,950	21,950	12,072		209						19,750	17,500		
2023CPT.07.01.20012	Alamance	25	SR 2373 - CHARLIE EULISS RD	FROM SR 2371 - PLEASANT HILL CHURCH RD TO DEAD END	1	0.426	17-21	5,068	5,068	2,770		48									
TOTAL FOR MAP NO. 25						0.426		5,068	5,068	2,770		48									
2023CPT.07.01.20012	Alamance	26	SR 2407 - DRAMA RD	FROM SR 2360 - SYLVAN SCHOOL RD TO SR 2369 - SYLVAN RD	1	0.485	20	5,714	5,714	3,143		54						5,150	5,150		
TOTAL FOR MAP NO. 26						0.485		5,714	5,714	3,143		54						5,150	5,150		
2023CPT.07.01.20012	Alamance	27	SR 2369 - SYLVAN RD/SYLVAN SCHOOL RD (SKIP SR 2370 - OLD DAM RD, SKIP GRAVEL SECTION, AND SKIP NEW PVMT. AT BRIDGE # 128)	FROM SR 1005 - W GREENSBORO CHAPEL HILL RD TO CHATHAM CO	1	3.312	19-22	39,887	39,887	21,938		371		12	4	5		37,100	31,400	102	100
TOTAL FOR MAP NO. 27						3.312		39,887	39,887	21,938		371		12	4	5		37,100	31,400	102	100
2023CPT.07.01.20012	Alamance	28	SR 2372 - COCOA RD	FROM SR 2370 - OLD DAM RD TO SR 2369 - SYLVAN RD	1	1.142	20	13,400	13,400	7,370		128						12,250	10,250		
TOTAL FOR MAP NO. 28						1.142		13,400	13,400	7,370		128						12,250	10,250		
2023CPT.07.01.20012	Alamance	29	SR 2395 - R P COX RD	FROM SR 1004 - SNOW CAMP RD TO DEAD END	1	0.341	17-19	3,616	3,616	1,989		38									
TOTAL FOR MAP NO. 29						0.341		3,616	3,616	1,989		38									
2023CPT.07.01.20012	Alamance	30	SR 2306 - PIKE RD	FROM SR 2378 - KENLY DR TO SR 2308 - HINSHAW SHOP RD	1	0.867	20	10,178	10,178	5,598		97						9,300	7,000	20	
TOTAL FOR MAP NO. 30						0.867		10,178	10,178	5,598		97						9,300	7,000	20	