

STATE	PROJECT NO.	SHEET NO.	TOTAL SHEETS
N.C.	2016CPT.07.08.20681	1	5

# 2016 ORANGE COUNTY

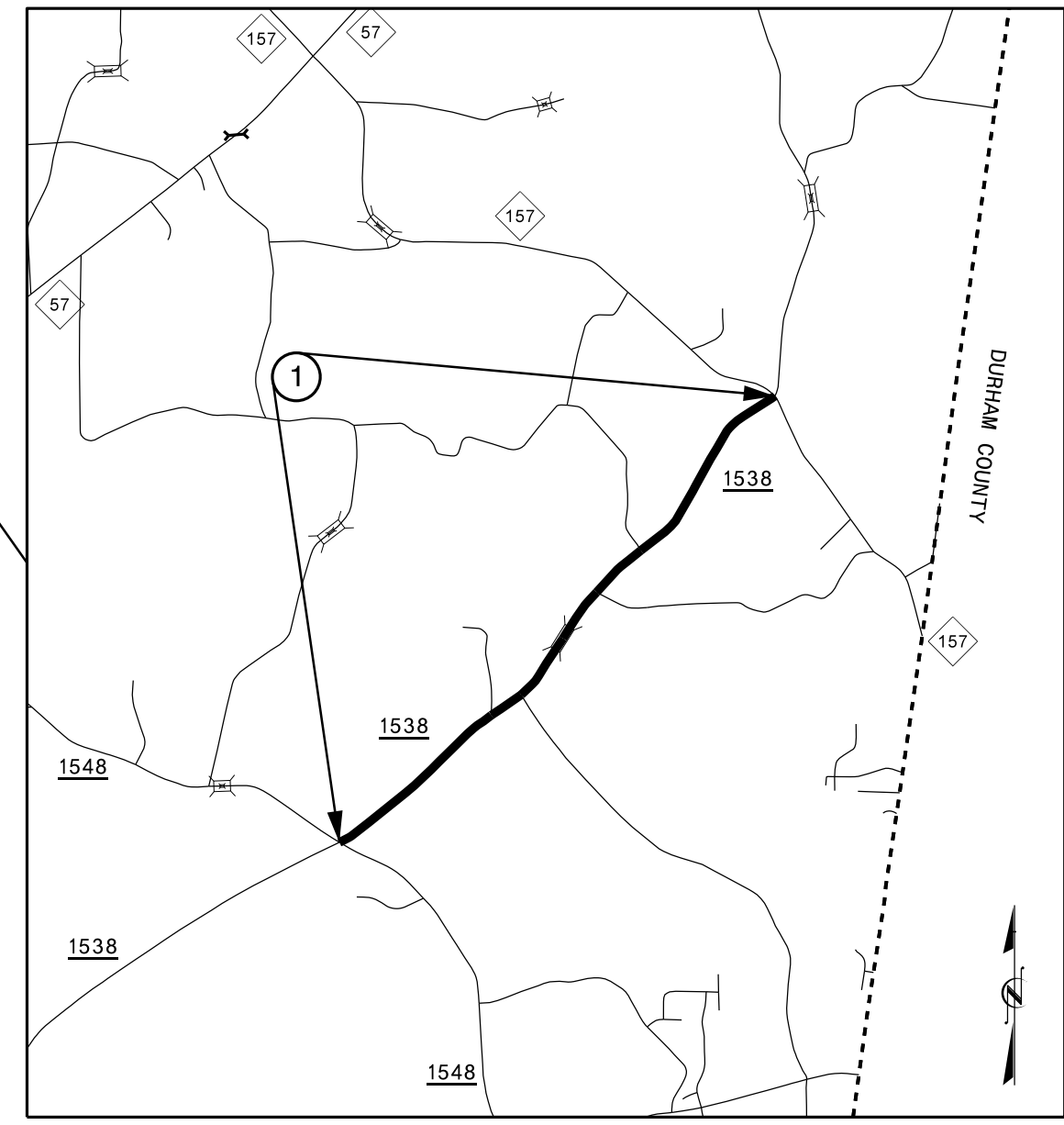
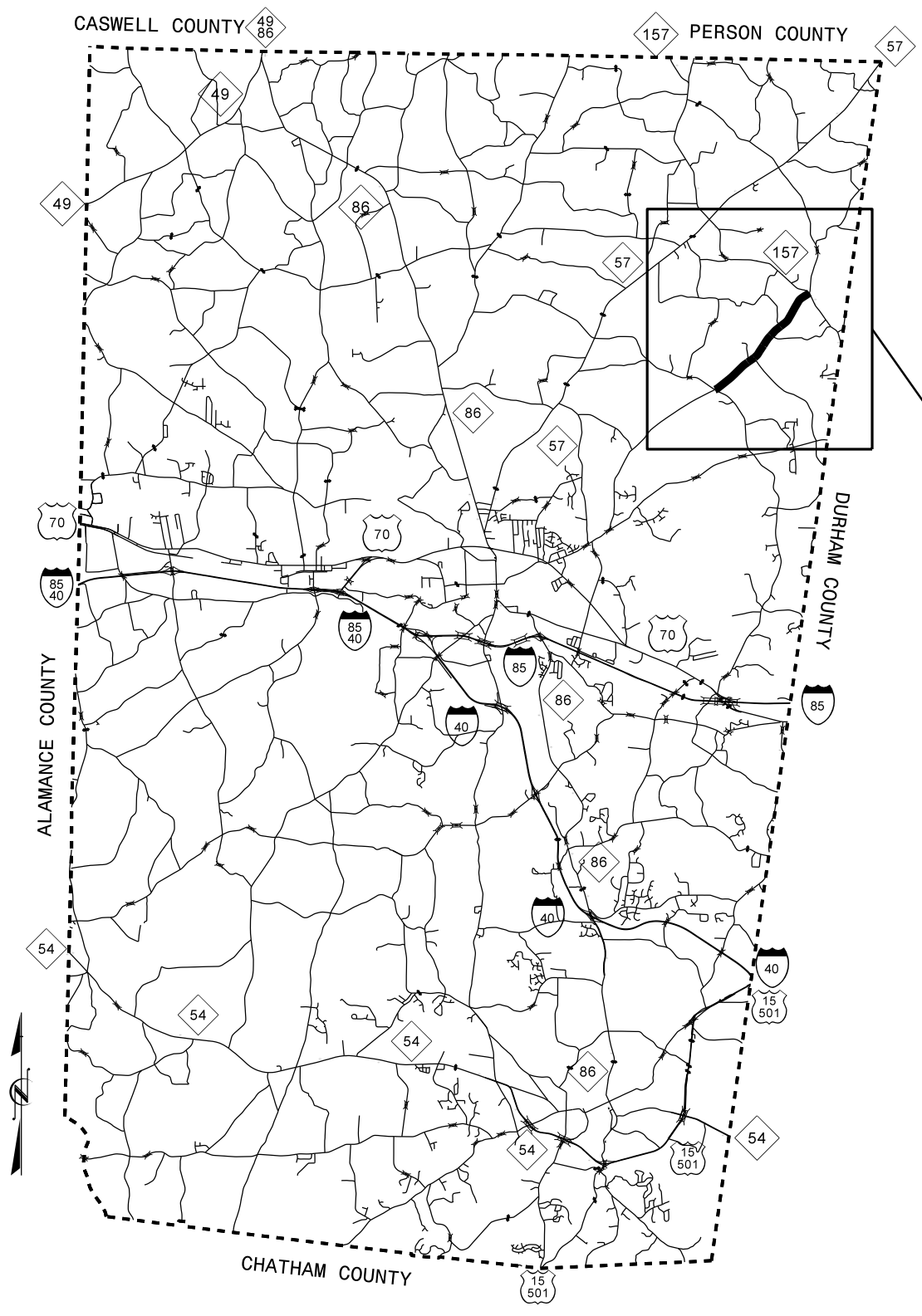

20-AUG-2015 09:20  
 S:\DDC\Resur\2016 PO Contracts\Orange\SR 1538 (New Sharon Church Road)\CADD\orange\_vicinity.dgn  
 CHUSKINS AT D:\CADD\1574

STATE	PROJECT NO.	SHEET NO.	TOTAL SHEETS
N.C.	2016CPT.07.08.20681	2	5

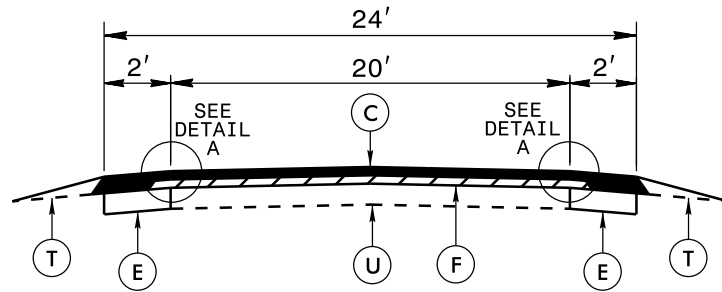

**TYPICAL SECTION NO. 1**

TO BE USED ON MAP 1  
 STA. 0+00 TO STA. 68+70  
 STA. 79+30 TO STA. 154+10

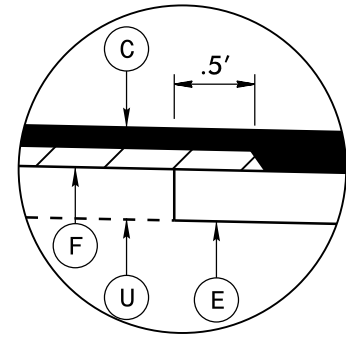

**DETAIL A**

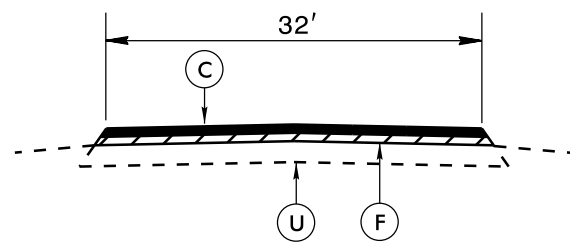

\*NOTE: RESURFACE BRIDGE #57  
 STA. 73+10 TO STA. 74+40

**TYPICAL SECTION NO. 2**

TO BE USED ON MAP 1  
 STA. 68+70 TO STA. 79+30

**PAVING DETAIL 1  
 MAIN LINE IS NOT BEING RESURFACED**

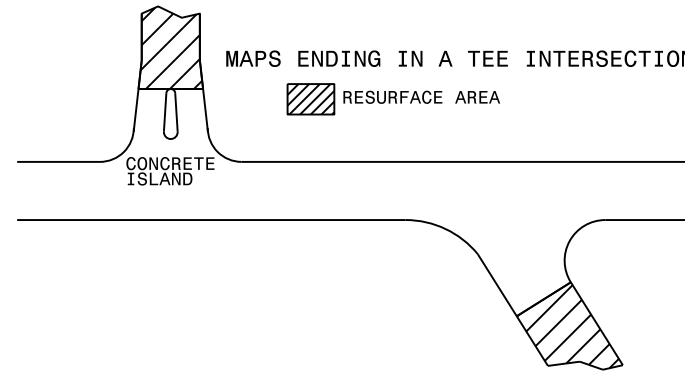

MAPS ENDING IN A TEE INTERSECTION

RESURFACE AREA

**PAVING DETAIL 2  
 MAIN LINE IS BEING RESURFACED**

NOTE: NON-SYSTEM (CITY STREET, PRIVATE DRIVE, SCHOOL BUS DRIVE)

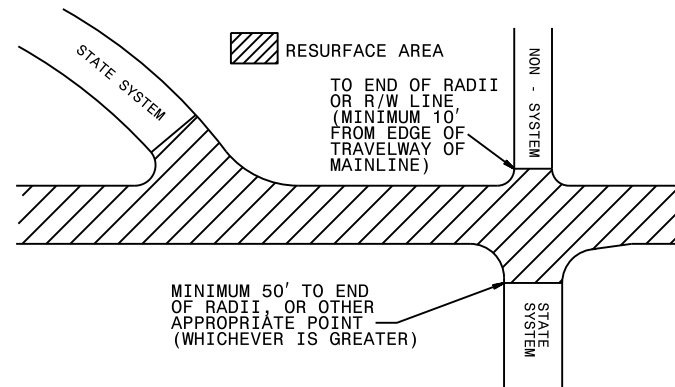

RESURFACE AREA

TO END OF RADII OR R/W LINE (MINIMUM 10' FROM EDGE OF TRAVELWAY OF MAINLINE)

MINIMUM 50' TO END OF RADII, OR OTHER APPROPRIATE POINT (WHICHEVER IS GREATER)

TO BE USED AT ALL  
 NON-SIGNALIZED INTERSECTIONS

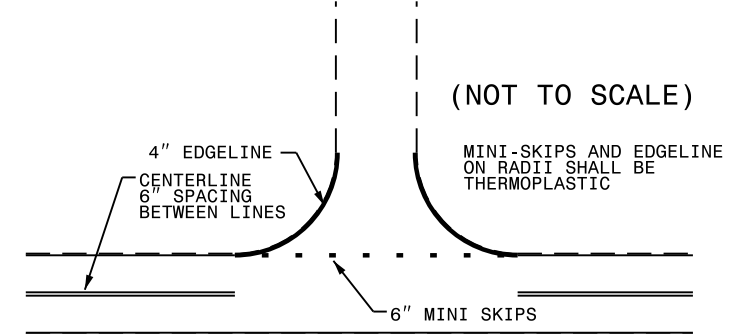

(NOT TO SCALE)

MINI-SKIPS AND EDGELINE ON RADII SHALL BE THERMOPLASTIC

NOTE: MINI SKIPS SHALL BE PLACED ON A 8' CYCLE, CONTAINING A 6' AND 2' SKIP, THE WIDTH OF THE SKIP SHALL BE 6".

**STRIPING DETAIL 1  
 GENERAL STRIPING DETAIL FOR ENTIRE PROJECT**

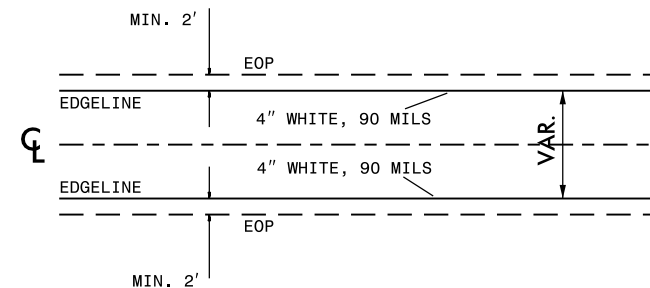

NOTE:  
 1. TO BE USED IN CONJUNCTION WITH TYPICAL SECTIONS NO. 1  
 2. USE IN CONJUNCTION WITH THE EXISTING PAVEMENT MARKINGS TO ESTABLISH THE STRIPING.  
 3. USE IN CONJUNCTION WITH THE NCDOT STANDARD DRAWINGS.

**PAVEMENT SCHEDULE**

C	PROP. APPROX. 1 1/2" ASPHALT CONCRETE SURFACE COURSE, TYPE SF9.5A, AT AN AVERAGE RATE OF 165 LBS. PER SQ. YD.
E	PROP. APPROX. 7" ASPHALT CONCRETE BASE COURSE, TYPE B25.0B, AT AN AVERAGE RATE OF 399 LBS. PER SQ. YD. IN EACH OF TWO LAYERS
F	AST MAT COAT #67 STONE
T	SHOULDER RECONSTRUCTION, AS DIRECTED BY THE ENGINEER.
U	EXISTING PAVEMENT.

- NOTES:  
 1) DETAIL DOES NOT APPLY TO OGAFB AND ULTRA-THIN BONDED WEARING COURSE.  
 2) BACKFILL SHOULDER WITH APPROVED MATERIAL.  
 3) THE SHOULDER WEDGE DEVICE MAY BE DISENGAGED AT PAVED DRIVEWAYS AND SIDE STREETS.

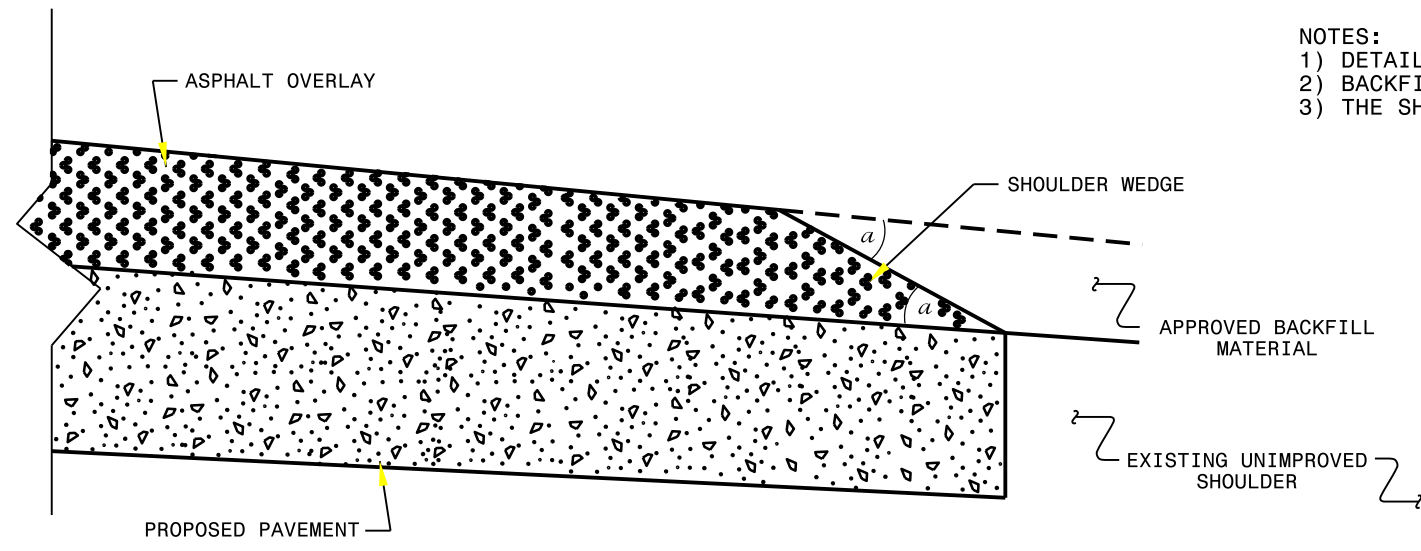

**SHOULDER WEDGE DETAIL**  
 (Resurfacing Projects w/ Widening or  
 with Existing Paved Shoulder having no dropoffs)

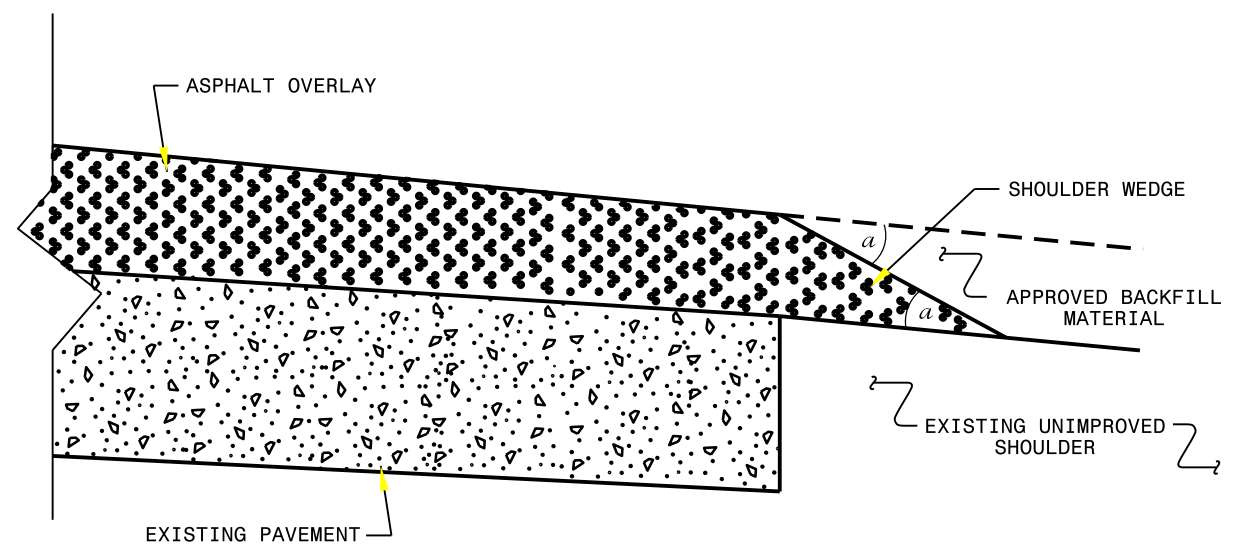

**SHOULDER WEDGE DETAIL**  
 (Resurfacing Projects w/ NO Widening)

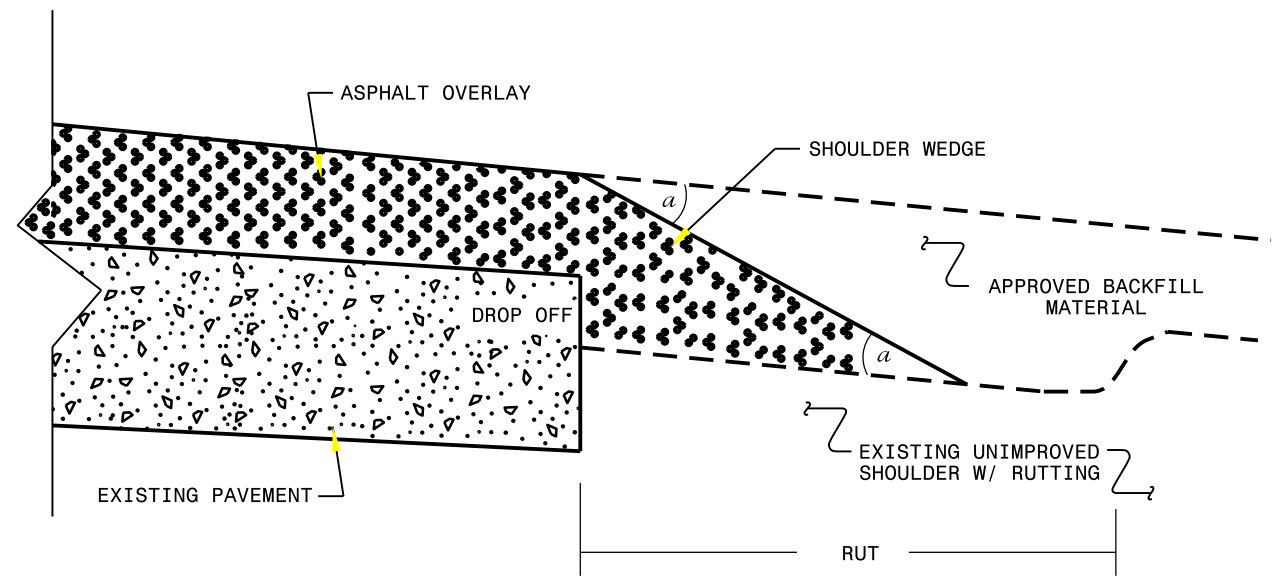

**SHOULDER WEDGE DETAIL**  
 (Resurfacing Adjacent to  
 Rutted Shoulder)

- SHOULDER WEDGE ANGLE = 30°

<b>CONTRACT STANDARDS AND DEVELOPMENT UNIT</b>			
Office 919-707-6950		FAX 919-250-4119	
<b>SHOULDER WEDGE DETAILS</b>			
ORIGINAL BY:	T.SPELL	DATE:	7-19-11
MODIFIED BY:		DATE:	10/16/12
CHECKED BY:		DATE:	
FILE SPEC.:	a:usr/details/stand/shoulderwedgedetail.dgn		

20-AUG-2015 09:20  
 S:\000\Resurfacing\Projects\2016 PO Contracts\Orange\2016CPT.07.08.20681\CADD\typical.dgn  
 .schukins AT D7CADD21374

### SIGNING FOR RESURFACING PROJECTS

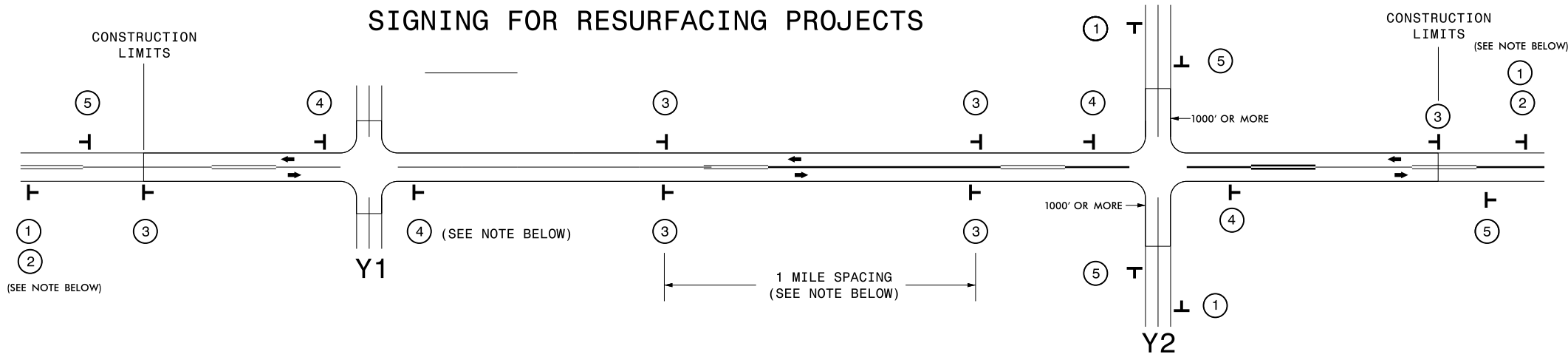

LEGEND	
T	STATIONARY SIGN
←	DIRECTION OF TRAFFIC FLOW

### MAINLINE (-L-) SIGNING

### -Y- LINE SIGNING

SIGNING NOTES AND PLACEMENT PER DIRECTION	 	<p>PLACE 1000' PRIOR TO BEGINNING OF CONSTRUCTION LIMITS. ONLY USED ON -Y- LINES IF RESURFACING LIMITS EXTEND 1000' ALONG -Y- LINE.</p> <p>#2 SIGN ONLY USED WHEN RESURFACING LIMITS ARE 2 OR MORE MILES IN LENGTH. ROUND UP TO NEXT WHOLE NUMBER. (NO FRACTIONAL OR DECIMAL NUMBERS)</p>	<p>NO REQUIRED STATIONARY SIGNING FOR THE FOLLOWING -Y- LINE CONDITIONS:</p> <ol style="list-style-type: none"> <li>1) LESS THAN 1000' OF RESURFACING ALONG -Y- LINE</li> <li>2) SUBDIVISION ROADS</li> <li>3) DEAD END ROADS</li> </ol> <p>WHEN PAVING/CONSTRUCTION ACTIVITIES PROCEED ACROSS AN UNSIGNED -Y- LINE, ADVANCE WARNING PORTABLE SIGNS SHALL BE USED ALONG THE -Y- LINE AS SHOWN BELOW. REMOVE UPON COMPLETION OF WORK.</p> <div style="display: flex; justify-content: space-around;"> <div style="text-align: center;">             PLACE INITIALLY AT THE CONSTRUCTION LIMITS AND SPACED 1 MILE APART THEREAFTER. IF NO -Y- LINES EXIST, PLACE 2ND SET 1/2 MILE FROM THE CONSTRUCTION LIMITS AND THEN SPACE 1 MILE THEREAFTER.         </div> <div style="text-align: center;">             THESE ARE FOR -Y- LINES THAT ARE "THROUGH" ROADWAYS. DEAD END AND SUBDIVISION ROADS ARE NOT "THROUGH" ROADWAYS. INSTALL 500' +/- FROM EACH -Y- LINE APPROACH AS SHOWN ABOVE. FOR MULTIPLE -Y- LINES THAT ARE SEPARATED BY 0.25 MILES OR LESS, TREAT AS A SINGLE UNIT AND INSTALL WITHIN 500' OF EACH APPROACH. A MAXIMUM OF 2 SIGN SETS PER MILE. DO NOT INSTALL WHEN -Y- LINES ARE WITHIN 0.5 MILES FROM "END ROAD WORK" SIGN.         </div> </div> <div style="display: flex; justify-content: space-around; margin-top: 10px;"> <div style="text-align: center;">             PLACE 500' FOLLOWING THE END OF CONSTRUCTION LIMITS.         </div> <div style="text-align: center;">               PLACED 500' IN ADVANCE OF FLAGGER. PLACED 250' IN ADVANCE OF FLAGGER.         </div> </div>
	3		
	4		
	5		

20-AUG-2015 09:20 S:\DDC\Resurfacing\Projects\2016 PO Contracts\Orange\2016CPT.07.08.20681\CADD\Typical.dgn CHUSKINS AT DTCADD2\1314



**RESURFACING  
ADVANCE WARNING SIGNS  
FOR  
RURAL AND SUBURBAN  
2 LANE ROADWAYS**

PROJECT NO.	SHEET NO.	TOTAL NO.
7C.068110, 2016CPT.07.08.20681	5	5

### SUMMARY OF QUANTITIES

PROJECT NO	COUNTY	MAP NO	ROUTE	DESCRIPTION	TYP	LANES	LANE TYPE	FINAL SURFACE TESTING REQUIRED	WARM MIX ASPHALT REQUIRED	LENGTH MI	WIDTH FT	BORROW EXCAVATION CY	INCIDENTAL STONE BASE TONS	SHOULDER RECONSTRUCTION SMI	ASPHALT CONC BASE COURSE, TYPE B25.0B TONS	ASPHALT CONC SURFACE COURSE, TYPE SF9.5A TONS	ASPHALT BINDER FOR PLANT MIX TONS	ASPHALT SURFACE TREATMENT, MATCOAT, #67 STONE SY	EMULSION FOR ASPHALT SURFACE TREATMENT GAL	SEEDING & MULCHING AC	RESIDENTIAL SEEDING ACR		
7C.068110	Orange	1	SR 1538 (NEW SHARON CHURCH ROAD)	FROM SR 1548 (SCHLEY ROAD) - 4.13 TO NC 157 (GUESS ROAD) - 7.05	1	2	2WU	NO	NO	1.301	20	20	200	5.44		1,567	105	16,030	6,091.40	0.99	0.99		
				BRIDGE #57 - SKIP	2	2	2WU	NO	NO	0.083	32							129	9	1,558	594.49		
					2	2	2WU	NO	NO	0.025	32							39	3	469	175.64		
					2	2	2WU	NO	NO	0.093	32							145	10	1,746	662.04		
					1	2	2WU	NO	NO	1.417	20							1,703	114	17,453	6,632.27		
TOTAL FOR MAP NO. 1										2.919		20	200	5.44		3,583	241	37,256	14,155.84	0.99	0.99		
TOTAL FOR PROJ NO. 7C.068110										2.919		20	200	5.44		3,583	241	37,256	14,155.84	0.99	0.99		
2016CPT.07.08.20681	Orange	2	SR 1538 (NEW SHARON CHURCH ROAD)	--WIDENING ONLY--	N/A	2	2WU	NO	NO	2.718	4				2,916		128						
				TOTAL FOR MAP NO. 2									2.718					2,916		128			
				TOTAL FOR PROJ NO. 2016CPT.07.08.20681									2.718					2,916		128			
GRAND TOTAL										5.637		20	200	5.44	2,916	3,583	369	37,256	14,155.84	0.99	0.99		

### THERMOPLASTIC AND PAINT QUANTITIES

PROJECT NO	COUNTY	MAP NO	ROUTE	DESCRIPTION	TYP	LANES	LANE TYPE	LENGTH	WIDTH	4399000000-N TEMPORARY TRAFFIC CONTROL LS	4413000000-E WORK ZONE ADVANCE/G ENERAL WARNING SIGNING SF	4685000000-E 4" X 90 M WHITE THERMO LF	4690000000-E 6" X 120 M WHITE THERMO LF	4810000000-E 4" WHITE PAINT LF	4810000000-E 4" YELLOW PAINT LF			
7C.068110	Orange	1	SR 1538 (NEW SHARON CHURCH ROAD)	FROM SR 1548 (SCHLEY ROAD) - 4.13 TO NC 157 (GUESS ROAD) - 7.05	1-2	2	2WU	2.919	20-32	1	328	300	82	61,040	46,865			
				TOTAL FOR MAP NO. 1									1	328	300	82	61,040	46,865
				TOTAL FOR PROJ NO. 7C.068110									1	328	300	82	61,040	46,865
2016CPT.07.08.20681	Orange	2	SR 1538 (NEW SHARON CHURCH ROAD)	--WIDENING ONLY--	N/A	2	2WU	2.718	20									
				TOTAL FOR MAP NO. 2														
				TOTAL FOR PROJ NO. 2016CPT.07.08.20681														
GRAND TOTAL							5.637			1	328	300	82	61,040	46,865			