

Moore County

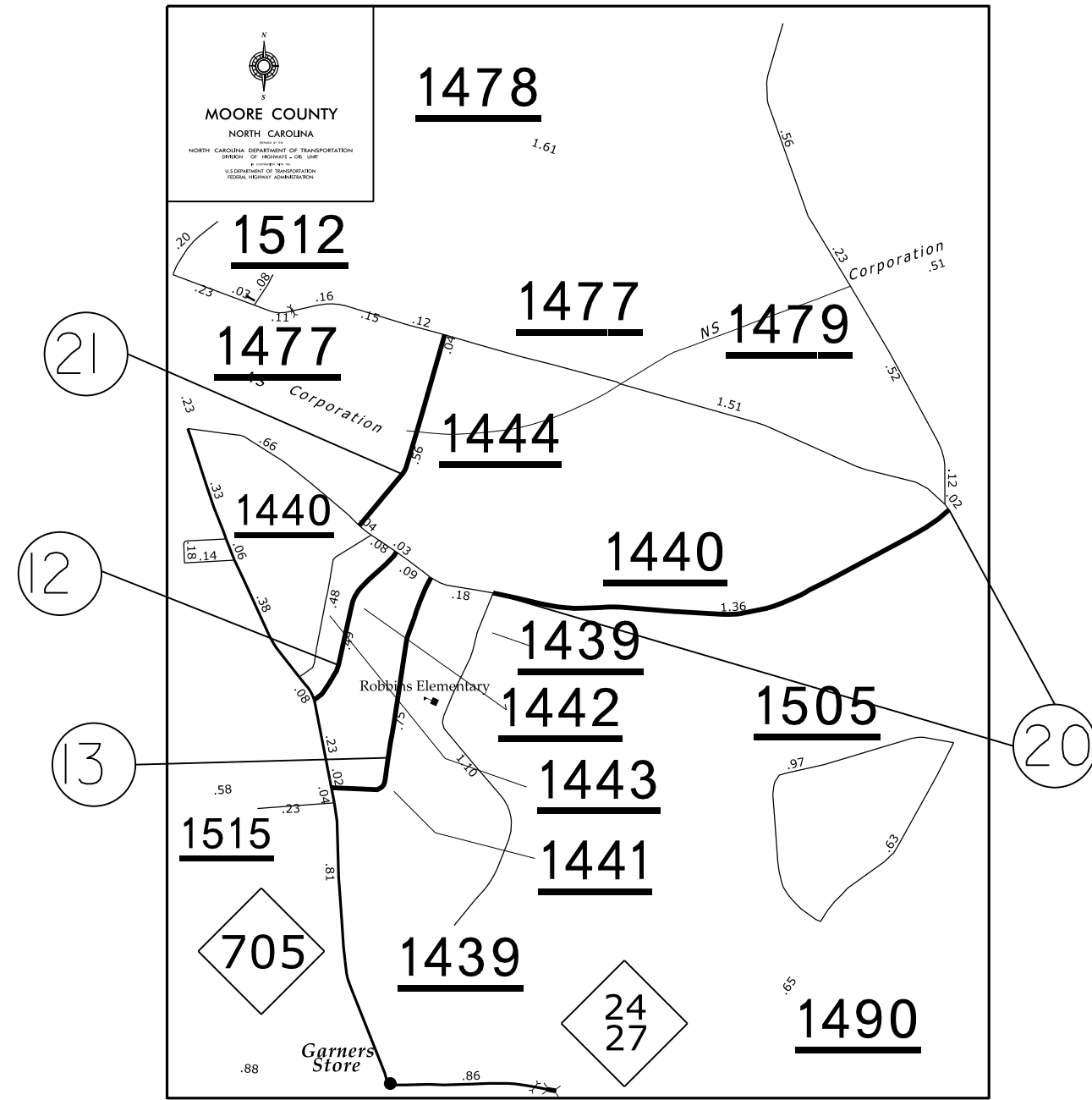

DETAILS OF PATCHING EXISTING PAVEMENT PRIOR TO RESURFACING

DETAIL

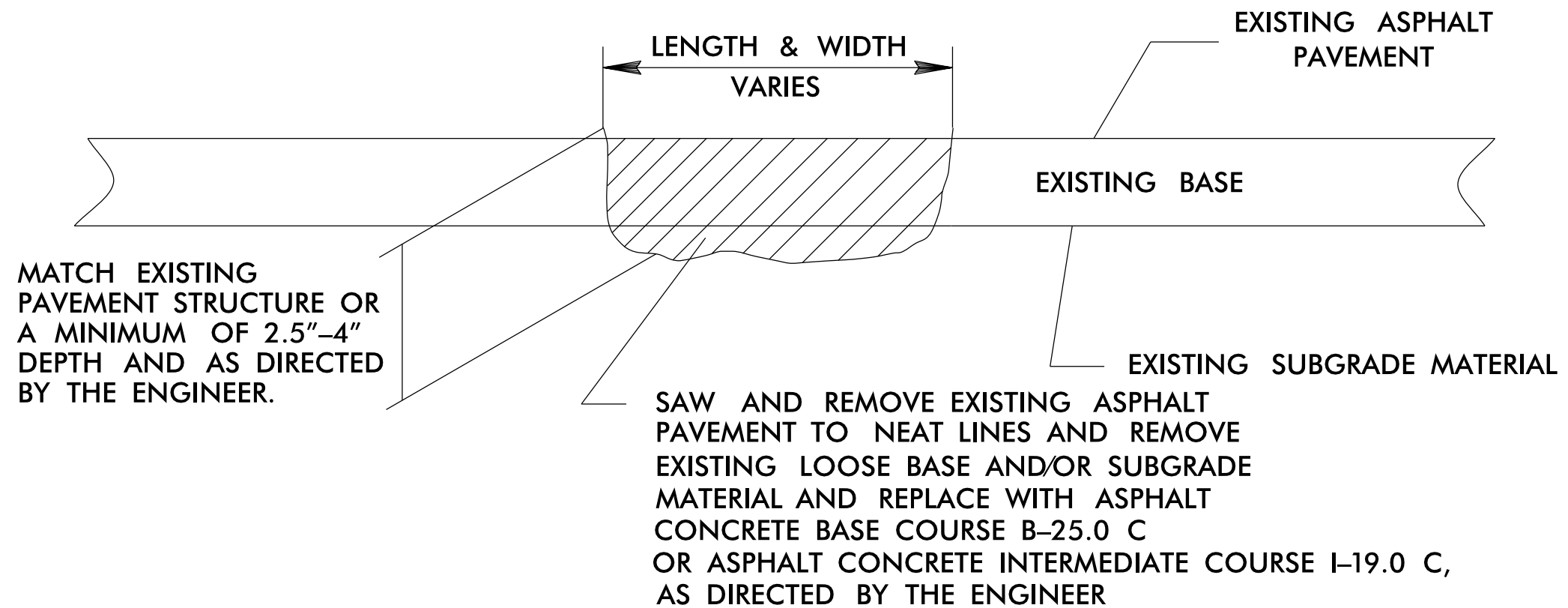

PROJECT NO.	SHEET NO.	TOTAL NO.
2019CPT.08.12.20632	5	

SUMMARY OF QUANTITIES

PROJECT NO	COUNTY	MAP NO	ROUTE	DESCRIPTION	LENGTH	WIDTH	170400000-E	180350000-E	183800000-E	183850000-N	189100000-E	214300000-E	441300000-E	445700000-N	481000000-E	481000000-E	
							PATCHING EXISTING PAVEMENT	ASPHALT SURFACE TREATMENT, DOUBLE SEAL	EMULSION FOR ASPHALT SURFACE TREATMENT	VACUUM TRUCK	GENERIC PAVING ITEM - ASPHALT SURFACE TREATMENT, SLURRY SEAL	BLOTTING SAND	WORK ZONE ADVANCE/GENERAL WARNING SIGNING	TEMPORARY TRAFFIC CONTROL	4" WHITE PAINT	4" YELLOW PAINT	
					MI	FT	TONS	SY	GAL	WK	SY	TON	SF	LS	LF	LF	
2019CPT.08.12.20632	Moore	1	SR 1135 (DEAD MAN CURVE RD)	FROM 211 TO 211	1	18	200	12,560.00	6,453				112		10,560	8,265	
TOTAL FOR MAP NO. 1					1		200	12,560.00	6,453				112		10,560	8,265	
2019CPT.08.12.20632	Moore	2	SR 1139 (EAGLE BRANCH RD)	FROM SR 1140 (MARTIN RD) TO SR 1138 EAGLE SPRINGS RD	1.25	18	325	13,800.00	7,590				140		13,200	9,082	
TOTAL FOR MAP NO. 2					1.25		325	13,800.00	7,590				140		13,200	9,082	
2019CPT.08.12.20632	Moore	3	SR 1163 (SHERWOOD DR)	FROM SR SR 1103 (SANDPIT RD) TO DEAD END	0.17	20	100	1,995.00	1,098				20				
TOTAL FOR MAP NO. 3					0.17		100	1,995.00	1,098				20				
2019CPT.08.12.20632	Moore	4	SR 1164 (FOREST DR)	FROM SR 1163 (SHERWOOD DR TO DEAD END	0.36	20	75	4,424.00	2,434				41				
TOTAL FOR MAP NO. 4					0.36		75	4,424.00	2,434				41				
2019CPT.08.12.20632	Moore	5	SR 1166 (ROSEMARK DR)	FROM SR 1167 (FROM US 1 TO DEAD END	0.23	18	75	2,628.00	1,446				30				
TOTAL FOR MAP NO. 5					0.23		75	2,628.00	1,446				30				
2019CPT.08.12.20632	Moore	6	SR 1648 (KESTER RD)	FROM SR 1647 (NEEDMORE RD) TO SR 1644 (GLENDON RD)	0.43	18	45	4,740.00	2,607				48		9,254	9,254	
TOTAL FOR MAP NO. 6					0.43		45	4,740.00	2,607				48		9,254	9,254	
2019CPT.08.12.20632	Moore	7	SR 1262 (LEATHERWOOD RD)	FROM NC 24 TO SR 1493 (CRABTREE)	0.28	18	100	3,158.00	1,737				25		2,956	2,392	
TOTAL FOR MAP NO. 7					0.28		100	3,158.00	1,737				25		2,956	2,392	
2019CPT.08.12.20632	Moore	8	SR 1270 (FIRE TOWER RD)	FROM NC 705 TO PVNT CHANGE	1.58	20	200	21,538.00	10,196				120		16,684	12,059	
TOTAL FOR MAP NO. 8					1.58		200	21,538.00	10,196				120		16,684	12,059	
2019CPT.08.12.20632	Moore	9	SR 1281 (TARRY CH RD)	FROM 24 TO MONTGOMERY CO. LINE	1.54	22	350	19,876.00	9,938				145		16,262	11,537	
TOTAL FOR MAP NO. 9					1.54		350	19,876.00	9,938				145		16,262	11,537	
2019CPT.08.12.20632	Moore	10	SR 1310 (MCCRARY RD)	FROM SR 1261 (BETHLEHEM CH RD) TO DEAD END	0.22	18	100	25,323.00	1,419				25				
TOTAL FOR MAP NO. 10					0.22		100	25,323.00	1,419				25				
2019CPT.08.12.20632	Moore	11	SR 1404 (BREWER RD)	FROM MONT. CO TO SR 1405 (DOVER CH RD)	1.64	21	375	20,604.00	10,583				165		17,318	13,924	
TOTAL FOR MAP NO. 11					1.64		375	20,604.00	10,583				165		17,318	13,924	
2019CPT.08.12.20632	Moore	12	SR 1442 (S EMMA LN)	FROM NC 705 TO SR 1440 (E HEMP ST)	0.49	20	75	6,166.00	3,162				30		5,280	4,982	
TOTAL FOR MAP NO. 12					0.49		75	6,166.00	3,162				30		5,280	4,982	
2019CPT.08.12.20632	Moore	13	SR 1441 (GARDENIA RD)	FROM SR 1440 (E HEMP ST) TO NC 705	0.6	18	100	6,636.00	3,650				40		6,336	6,336	
TOTAL FOR MAP NO. 13					0.6		100	6,636.00	3,650				40		6,336	6,336	
2019CPT.08.12.20632	Moore	14	SR 1450 (BROWER RD)	FROM SR 1002 (SPIES RD) TO DEAD END	0.69	18	100	7,686.00	4,228				65				
TOTAL FOR MAP NO. 14					0.69		100	7,686.00	4,228				65				
2019CPT.08.12.20632	Moore	15	SR 1466 (BERNARD PURVIS RD)	FROM CHATHAM CO TO SR 1461 (GEORGE P RD)	0.81	18	200	9,153.00	5,035				45		8,553	81,925	
TOTAL FOR MAP NO. 15					0.81		200	9,153.00	5,035				45		8,553	81,925	
2019CPT.08.12.20632	Moore	16	SR 1140 (MARTIN RD)	FROM SR 1141 (ROBERT RD) TO SR 1139 (EAGLE BRANCH RD)	2	18	125	21,420.00	11,781				224		43,040	34,392	
TOTAL FOR MAP NO. 16					2		125	21,420.00	11,781				224		43,040	34,392	
2019CPT.08.12.20632	Moore	17	SR 1488 (LONNIE RD)	FROM SR 1487 (BORDEN RD) TO SR 1477 (PLANK RD)	1.4	20	125	10,125.00	9,034				156		14,784	13,952	
TOTAL FOR MAP NO. 17					1.4		125	10,125.00	9,034				156		14,784	13,952	
2019CPT.08.12.20632	Moore	18	SR 1605 (TOMMY RD)	FROM SR 1600 (WILSON RD) TO CHATHAM CO	0.67	18	225	8,125.00	4,469				75		7,075	6,835	
TOTAL FOR MAP NO. 18					0.67		225	8,125.00	4,469				75		7,075	6,835	
2019CPT.08.12.20632	Moore	19	SR 2059 (MIDWAY RD)	FROM N SYCAMORE ST TO SR 2053 (SAUNDER BLVD)	1.52	20	150	17,850.00	9,809				170		16,052	16,052	
TOTAL FOR MAP NO. 19					1.52		150	17,850.00	9,809				170		16,052	16,052	
2019CPT.08.12.20632	Moore	20	SR 1440 (HEMP ST)	FROM SR 1439 (RUSHWOOD RD) TO SR 1477 (PLANK RD)	1.23	20	100	14,432.00	7,937				137		12,988	10,856	
TOTAL FOR MAP NO. 20					1.23		100	14,432.00	7,937				137		12,988	10,856	
2019CPT.08.12.20632	Moore	21	SR 1441 (S GREEN ST)	FROM SR 1440 (HEMP ST) TO SR 1477 (PLANK RD)	0.6	20	60	7,040.00	3,872				68				
TOTAL FOR MAP NO. 21					0.6		60	7,040.00	3,872				68				
2019CPT.08.12.20632	Moore	22	SR 2109 (SELKIRK TRL)	FROM ACCESS ST TO SR 2076 (MCNEILL RD)	0.65	20	50				7,626.00		73				
TOTAL FOR MAP NO. 22					0.65		50				7,626.00		73				
2019CPT.08.12.20632	Moore	23	SR 2146 (DUNDEE TRL)	DEAD END TO SR 2076 (MCNEILL RD)	0.26	20	25				3,050.00		30				
TOTAL FOR MAP NO. 23					0.26		25				3,050.00		30				
2019CPT.08.12.20632	Moore	24	SR 2122 (STRATHMORE RD)	FROM SR 2162 (E HEDGELAWN WAY) TO SR 2110 (S GLENWOOD TRL)	0.22	20	25				2,581.00		25				
TOTAL FOR MAP NO. 24					0.22		25				2,581.00		25				
2019CPT.08.12.20632	Moore	25	SR 2184 (BRIDGE WATER DR)	FROM (E HEDGELAWN WAY) TO SR2075 (E INDIANA AVE)	0.65	20	50				7,626.00		73				
TOTAL FOR MAP NO. 25					0.65		50				7,626.00		73				
2019CPT.08.12.20632	Moore	26	SR 1891 (HYLAND HILLS RD)	FROM SR 1857 (VALLEY VIEW RD) TO US 1	0.83	20	75	9,740.00	5,356				93		8,765	6,857	
TOTAL FOR MAP NO. 26					0.83		75	9,740.00	5,356				93		8,765	6,857	
2019CPT.08.12.20632	Moore	27	SR 1857 (VALLEY VIEW RD)	FROM SR 2080 (N MAY ST) TO SR 1802 (NIAGRA-CARTHAGE RD)	1.12	20	75	13,141.00	7,227				125		11,827	11,827	
TOTAL FOR MAP NO. 27					1.12		75	13,141.00	7,227				125		11,827	11,827	
2019CPT.08.12.20632	Moore	28	SR 1929 (HORSESHOE DR)	FROM SR 1928 (LAKEVIEW DR) TO DEAD END	0.33	20	20				3,872.00		37				
TOTAL FOR MAP NO. 28					0.33		20				3,872.00		37				
2019CPT.08.12.20632	Moore	29	SR 1909 (SKYLINE MANOR RD)	FROM SR 1857 (VALLEY VIEW RD) TO DEAD END	0.18	18	20				1,900.00		20				
TOTAL FOR MAP NO. 29					0.18		20				1,900.00		20				
2019CPT.08.12.20632	Moore	30	SR 1928 (LAKEVIEW DR)	FROM SR 1909 (SKYLINE MANOR RD) TO SR 1929 (HORSESHOE DR)	0.2	18	20				2,112.00		22				
TOTAL FOR MAP NO. 30					0.2		20				2,112.00		22				
2019CPT.08.12.20632	Moore	31	SR 1940 (COTTON PATCH PL)	FROM SR 1929 (HORSESHOE DR) TO DEAD END	0.07	18					740.00		8				
TOTAL FOR MAP NO. 31					0.07						740.00		8				
2019CPT.08.12.20632	Moore	32	SR 1942 (TANNEN DR)	FROM SR 1909 (SKYLINE MANOR RD) TO DEAD END	0.09	18	20				950.00		10				
TOTAL FOR MAP NO. 32					0.09		20				950.00		10				
2019CPT.08.12.20632	Moore	33	SR 1923 (BROOKS LN)	FROM SR 1909 (SKYLINE MANOR RD) TO END MAINT.	0.17	18	30				1,900.00		20				
TOTAL FOR MAP NO. 33					0.17		30				1,900.00		20				
2019CPT.08.12.20632	Moore	34	SR 2148 (KYLOE RD)	FROM SR 2147 (N GLENWOOD TRL) TO DEAD END	0.26	18	25				2,745.00		26				
TOTAL FOR MAP NO. 34					0.26		25				2,745.00		26				
2019CPT.08.12.20632	Moore	35	SR 2147 (N GLENWOOD TRL)	FROM SR 2146 (DUNDEE TRL) TO DEAD END	0.6	18	40				6,336.00		68				
TOTAL FOR MAP NO. 35					0.6		40				6,336.00		68				
TOTAL FOR PROJ NO. 2019CPT.08.12.20632					24.34			3,680	262,160.00	131,061	15	41,438.00	25	2,511	1	220,934	260,527
															481,461		
GRAND TOTAL					24.34												

SIGNING FOR ASPHALT SURFACE TREATMENT

LEGEND

- ◻ PORTABLE SIGN
- └ STATIONARY SIGN
- ← DIRECTION OF TRAFFIC FLOW

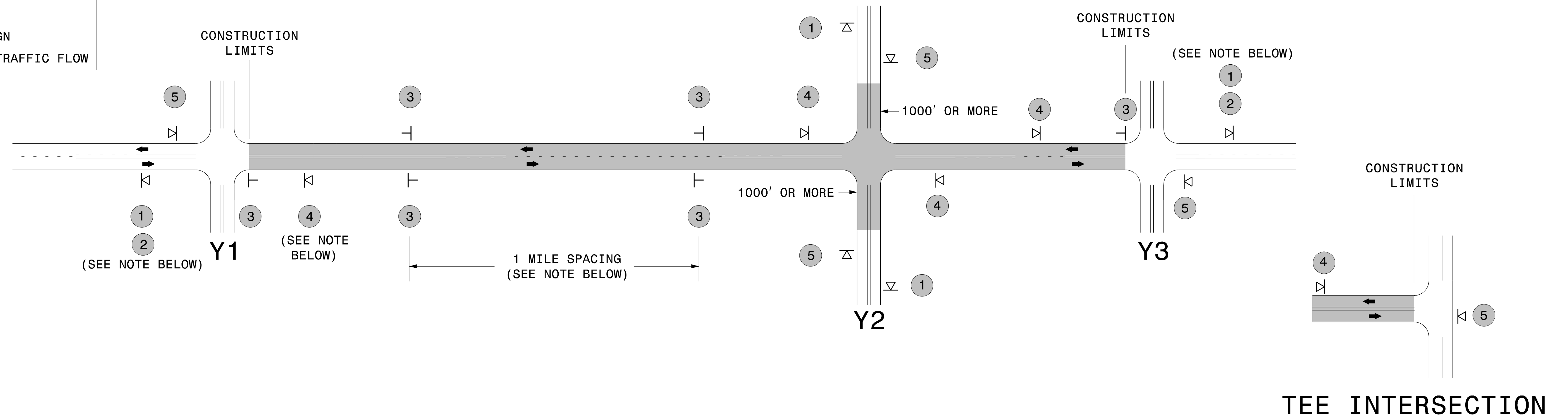

MAINLINE (-L-) SIGNING

-Y- LINE SIGNING

SIGNING NOTES AND PLACEMENT PER DIRECTION	1	 	<ul style="list-style-type: none"> - PLACE 1000' PRIOR TO BEGINNING OF CONSTRUCTION LIMITS. ONLY USED ON -Y- LINES IF RESURFACING LIMITS EXTEND 1000' ALONG -Y- LINE. - SIGN #2 ONLY USED WHEN RESURFACING LIMITS ARE 2 OR MORE MILES IN LENGTH. ROUND UP TO THE NEAREST WHOLE NUMBER. DO NOT USE FRACTIONAL OR DECIMAL NUMBERS. 	<p>STATIONARY SIGNING NOT REQUIRED FOR THE FOLLOWING -Y- LINE CONDITIONS:</p> <ol style="list-style-type: none"> 1) LESS THAN 1000' OF RESURFACING ALONG -Y- LINE 2) SUBDIVISION ROADS 3) DEAD END ROADS <p>WHEN PAVING/CONSTRUCTION ACTIVITIES PROCEED ACROSS AN UNSIGNED -Y- LINE, PORTABLE ADVANCE WARNING SIGNS SHALL BE USED ALONG THE -Y- LINE AS SHOWN BELOW. REMOVE UPON COMPLETION OF WORK.</p> <div style="display: flex; justify-content: space-around; align-items: center;"> <div style="text-align: center;"> <small>W20-1 48" X 48"</small> PLACED 500' IN ADVANCE OF FLAGGER. </div> <div style="text-align: center;"> <small>W20-7 A 48" X 48"</small> PLACED 250' IN ADVANCE OF FLAGGER. </div> </div>
	3	 	<ul style="list-style-type: none"> - ALTERNATE THE FOLLOWING TWO SIGNS: - STARTING WITH "LOOSE GRAVEL" (W8-7) FOLLOWED BY "UNMARKED PAVEMENT". - PLACE INITIALLY AT THE CONSTRUCTION LIMITS AND SPACED 1 MILE APART THEREAFTER. - AT TEE INTERSECTIONS INSTALL INITIALLY 0.5 MILE FROM INTERSECTION AND SPACE 1 MILE APART THEREAFTER. 	
	4		<ul style="list-style-type: none"> - THESE ARE FOR -Y- LINES THAT ARE "THROUGH" ROADWAYS. DEAD END AND SUBDIVISION ROADS ARE NOT "THROUGH" ROADWAYS. - INSTALL 500' +/- FROM EACH -Y- LINE APPROACH AS SHOWN ABOVE. - FOR MULTIPLE -Y- LINES THAT ARE SEPARATED BY 0.25 MILES OR LESS, TREAT AS A SINGLE UNIT AND INSTALL WITHIN 500' OF EACH APPROACH. - A MAXIMUM OF 2 SIGN SETS PER MILE. DO NOT INSTALL WHEN -Y- LINES ARE WITHIN 0.5 MILES FROM "END ROAD WORK" SIGN. 	
	5		<ul style="list-style-type: none"> - PLACE 500' FOLLOWING THE END OF CONSTRUCTION LIMITS OR AS SHOWN WHEN WORK ENDS AT A 3-WAY TEE INTERSECTION. 	
	<p>THE ABOVE SIGNS ARE ALL THAT ARE REQUIRED FOR A CONTRACTOR TO BEGIN A RESURFACING CONTRACT. ANY ADDITIONAL SIGNS REQUESTED BY NCDOT DIVISIONS SHALL BE INSTALLED WITHIN 7 BUSINESS DAYS OF THE START OF CONTRACT WORK.</p>			

MAPS LESS THAN 2 MILES

FOR AST RESURFACING MAPS WITH CONSTRUCTION LIMITS LESS THAN 2 MILES IN LENGTH, USE A STATIONARY "LOOSE GRAVEL" SIGN AT THE BEGINNING CONSTRUCTION LIMIT FOLLOWED BY AN "UNMARKED PAVEMENT" SIGN MIDWAY THROUGH AND AN "END ROAD WORK" SIGN AT THE END CONSTRUCTION LIMIT.



**ADVANCE WARNING SIGNS
FOR
2-LANE ROADWAY
ASPHALT SURFACE TREATMENT**