

**MONTGOMERY COUNTY**  
SECONDARY RESURFACING  
REQUEST MAP

040397  
20-FEB-2017 13:44  
C:\Users\jgibson\OneDrive\Documents\Richmond\2018\_SEAL\_VICINITY\_MAPS\_AND\_OVERVIEW\_MAP.dgn

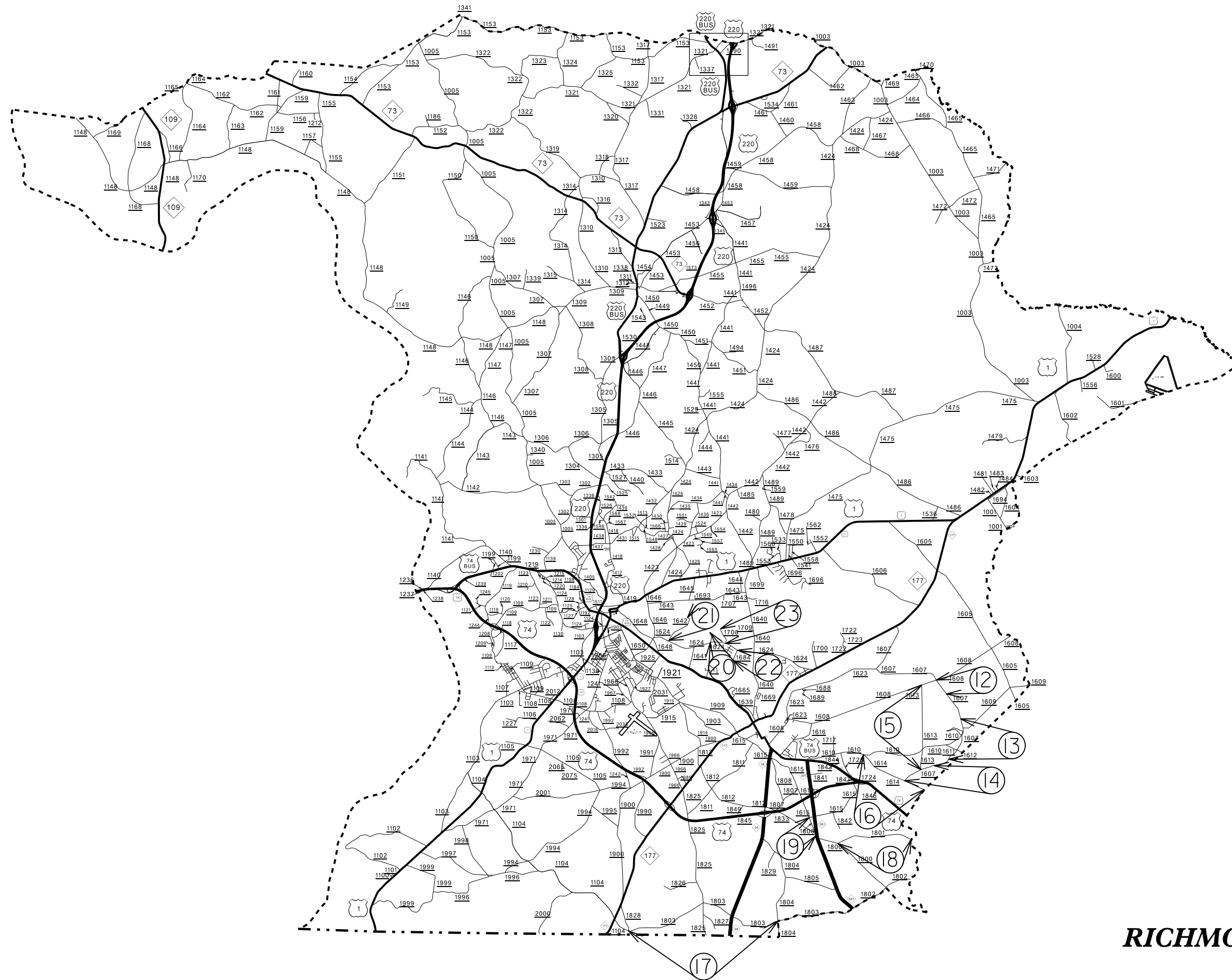

# RICHMOND COUNTY

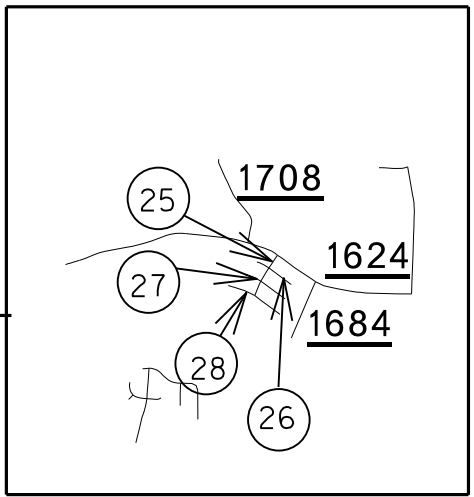
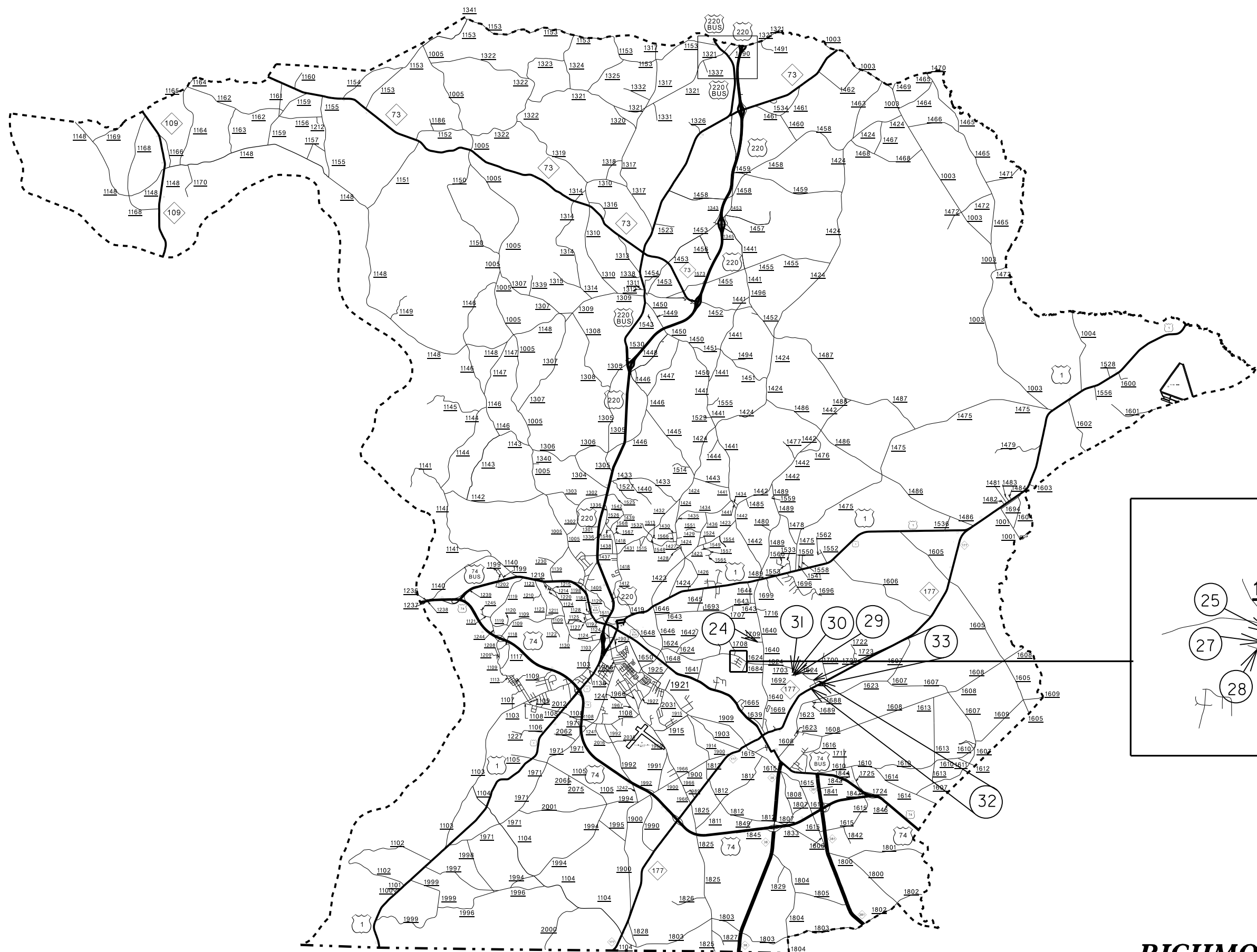

**RICHMOND COUNTY**

### MAPS #1 & #9 - #10

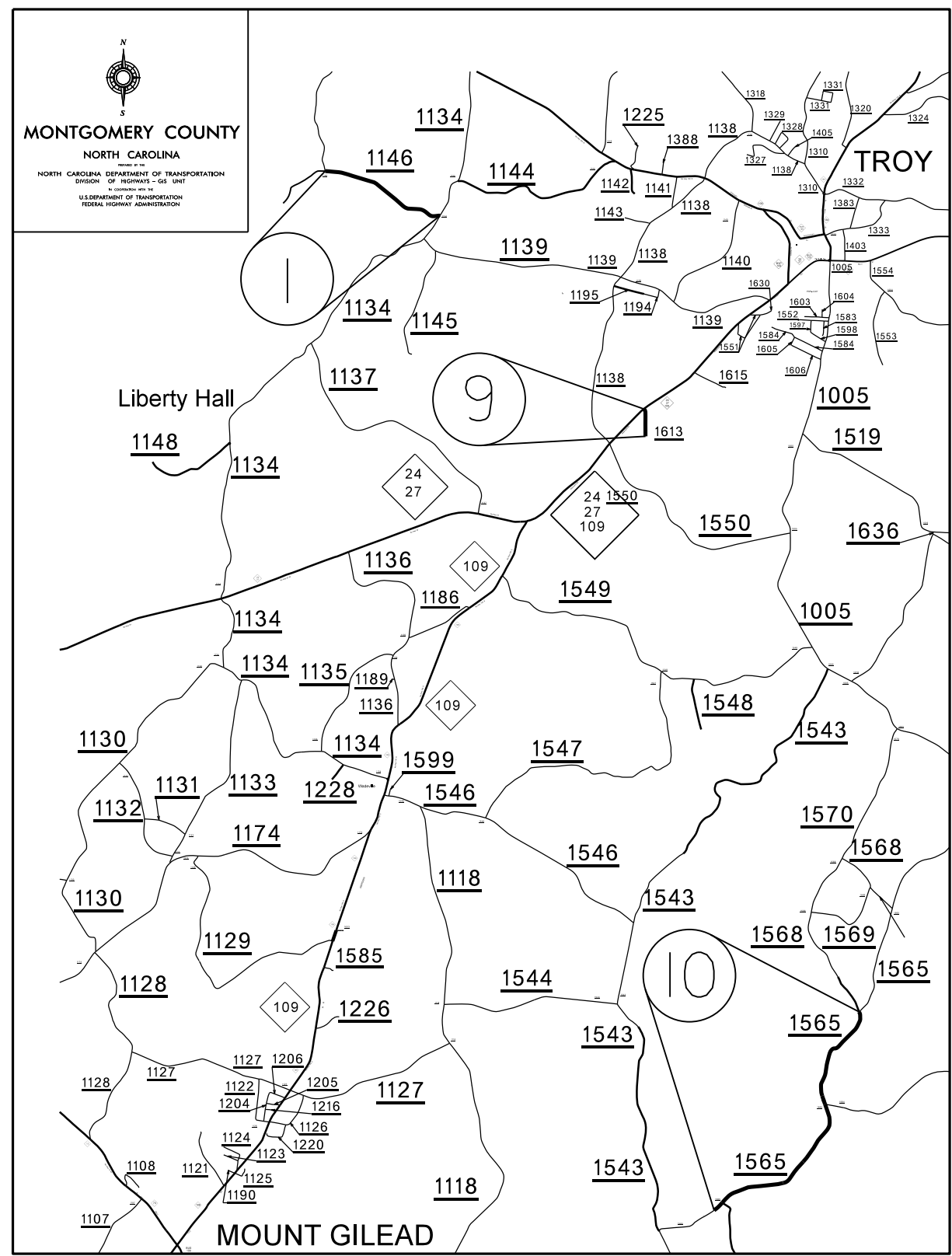

### MAPS #2 - #4 & #7

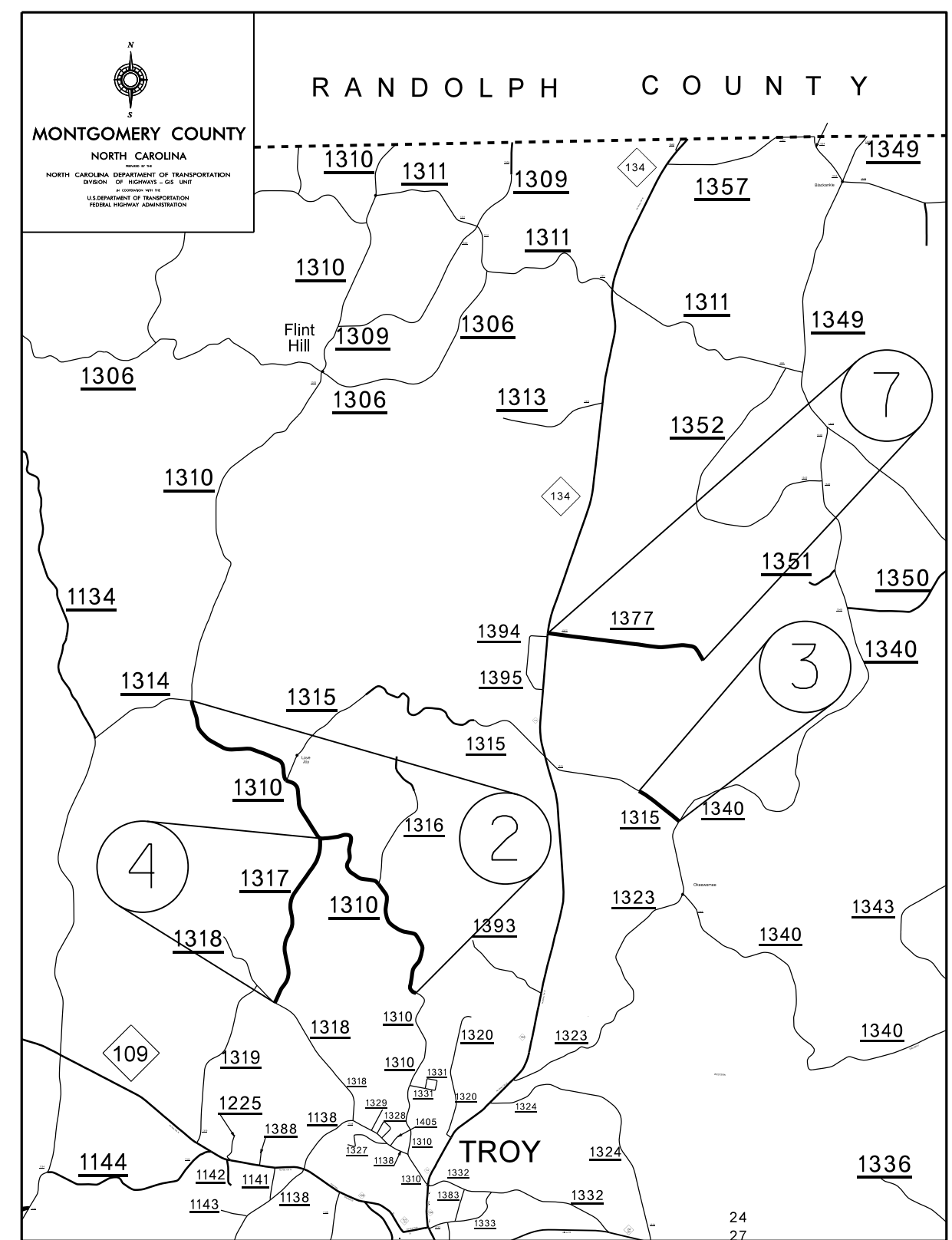

040397  
0170-FEB-2017 13:44  
C:\Users\seal\OneDrive\Richmond\2018-SEAL\_VICINITY\_MAPS\_AND\_OVERVIEW\_MAP.dgn



PROJECT NO.	SHEET NO.	TOTAL NO.
2017CPT.08.20.20622	6	
2017CPT.08.20.20772		

## SUMMARY OF QUANTITIES

PROJECT NO	COUNTY	MAP NO	ROUTE	DESCRIPTION	LANES	LANE TYPE	LENGTH MI	WIDTH FT	ASPHALT SURFACE TREATMENT, DOUBLE SEAL SY	ASPHALT SURFACE TREATMENT, FOG SEAL SY	ASPHALT SURFACE TREATMENT, TRIPLE SEAL SY	EMULSION FOR ASPHALT SURFACE TREATMENT GAL	BLOTTING SAND TON		
2017CPT.08.20.20622	Montgomery	1	SR 1146 (DUSTY LEVEL RD)	FROM SR 1134 (MT CARMEL CH RD) TO SR 1147 (CORRELL RD)	2	2WU	1.24	20			14,600.00	11,070			
<b>TOTAL FOR MAP NO. 1</b>							<b>1.24</b>				<b>14,600.00</b>	<b>11,070</b>			
2017CPT.08.20.20622	Montgomery	2	SR 1310 (LOVEJOY RD)	FROM BRIDGE #133 OVER DOOMAS CREEK TO SR 1314 ( AUNT QUEEN RD)	2	2WU	4.2	20			49,300.00	37,500			
<b>TOTAL FOR MAP NO. 2</b>							<b>4.2</b>				<b>49,300.00</b>	<b>37,500</b>			
2017CPT.08.20.20622	Montgomery	3	SR 1315 (FLOYD FARM RD)	FROM SR 1340 (OKWEEMEE-STAR RD) TO PAVEMENT CHANGE (0.51MI N OF SR1340 OKWEEMEE RD)	2	2WU	0.51	20			6,000.00	4,580			
<b>TOTAL FOR MAP NO. 3</b>							<b>0.51</b>				<b>6,000.00</b>	<b>4,580</b>			
2017CPT.08.20.20622	Montgomery	4	SR 1317 (BEAMAN RD)	FROM SR 1310 (LOVE JOY RD) TO SR 1318 (SHILOH CH RD)	2	2WU	1.67	20			19,600.00	15,000			
<b>TOTAL FOR MAP NO. 4</b>							<b>1.67</b>				<b>19,600.00</b>	<b>15,000</b>			
2017CPT.08.20.20622	Montgomery	5	SR 1360 (TALC MINE RD)	FROM US 220 ALT TO MOORE CO	2	2WU	0.5	20	5,900.00			3,250			
<b>TOTAL FOR MAP NO. 5</b>							<b>0.5</b>		<b>5,900.00</b>			<b>3,250</b>			
2017CPT.08.20.20622	Montgomery	6	SR 1365 (DOVER RD)	FROM SR 1364 (DOVER CH. RD) TO US 220 ALT	2	2WU	1.69	22	21,900.00			12,000			
<b>TOTAL FOR MAP NO. 6</b>							<b>1.69</b>		<b>21,900.00</b>			<b>12,000</b>			
2017CPT.08.20.20622	Montgomery	7	SR 1377 (ATKINS DAIRY RD)	FROM NC 134 TO END MAINT	2	2WU	1.53	20			18,000.00	13,680			
<b>TOTAL FOR MAP NO. 7</b>							<b>1.53</b>				<b>18,000.00</b>	<b>13,680</b>			
2017CPT.08.20.20622	Montgomery	8	SR 1500 (HUNSUCKER ST)	FROM SR 1577 (MCCASKILL STREET) TO US 220 ALT	2	2WU	0.56	16			5,300.00	4,000			
<b>TOTAL FOR MAP NO. 8</b>							<b>0.56</b>				<b>5,300.00</b>	<b>4,000</b>			
2017CPT.08.20.20622	Montgomery	9	SR 1613 (ALEXANDER RD)	FROM NC 24 TO PAVEMENT CHANGE (0.2MIS OF NC 24)	2	2WU	0.2	18			2,150.00	1,630			
<b>TOTAL FOR MAP NO. 9</b>							<b>0.2</b>				<b>2,150.00</b>	<b>1,630</b>			
2017CPT.08.20.20622	Montgomery	10	SR 1565 (THICKETY CREEK RD)	FROM BRIDGE #60 OVER LITTLE CREEK TO SR 1568 (ONVIL ROAD)	2	2WU	2.86	20			33,600.00	25,550			
<b>TOTAL FOR MAP NO. 10</b>							<b>2.86</b>				<b>33,600.00</b>	<b>25,550</b>			
2017CPT.08.20.20622	Montgomery	11	SR 1118 (YANK RD)	FROM SR 1546 (SHOE FACTORY RD) TO NC 731	2	2WU	5.37	20			63,700.00	47,800	*		
<b>TOTAL FOR MAP NO. 11</b>							<b>5.37</b>				<b>63,700.00</b>	<b>47,800</b>			
<b>TOTAL FOR PROJ NO. 2017CPT.08.20.20622</b>							<b>20.33</b>		<b>27,800.00</b>		<b>212,250.00</b>	<b>176,060</b>	<b>25</b>		
2017CPT.08.20.20772	Richmond	12	SR 1607 (MARKS CREEK CH RD)	FROM SR 1608 (BOYDS LAKE RD) TO END PVMT	2	2WU	0.37	20	4,350.00			2,393			
<b>TOTAL FOR MAP NO. 12</b>							<b>0.37</b>		<b>4,350.00</b>			<b>2,393</b>			
2017CPT.08.20.20772	Richmond	13	SR 1607 (MARKS CREEK CH RD)	FROM BEG PVMT TO SR 1610 (PEGGY MILL RD)	2	2WU	1.41	20	16,544.00			9,100			
<b>TOTAL FOR MAP NO. 13</b>							<b>1.41</b>		<b>16,544.00</b>			<b>9,100</b>			
2017CPT.08.20.20772	Richmond	14	SR 1607 (MARKS CREEK CHURCH RD)	FROM BEG PAVMT TO SR 1614 (OLD LAURINBURG RD)	2	2WU	1.02	20	11,970.00			6,584			
<b>TOTAL FOR MAP NO. 14</b>							<b>1.02</b>		<b>11,970.00</b>			<b>6,584</b>			
2017CPT.08.20.20772	Richmond	15	SR 1613 (COLES STORE RD)	FROM SR 1607 (MARKS CRK CH RD) TO SR 1608 (BOYDS LAKE RD)	2	2WU	2.37	20	27,810.00			15,295			
<b>TOTAL FOR MAP NO. 15</b>							<b>2.37</b>		<b>27,810.00</b>			<b>15,295</b>			
2017CPT.08.20.20772	Richmond	16	SR 1614 (OLD LAURINBURG RD)	FROM SR 1610 (PEGGY MILL RD) TO SCOT. CO. LINE	2	2WU	1.98	22	25,908.00			14,250			
<b>TOTAL FOR MAP NO. 16</b>							<b>1.98</b>		<b>25,908.00</b>			<b>14,250</b>			
2017CPT.08.20.20772	Richmond	17	SR 1803 (OSBORNE RD)	FROM SR 1804 (SPRING HILL CH RD) TO SR 1104 (OSBORNE RD)	2	2WU	4.69	20	57,000.00			31,350			
<b>TOTAL FOR MAP NO. 17</b>							<b>4.69</b>		<b>57,000.00</b>			<b>31,350</b>			
2017CPT.08.20.20772	Richmond	18	SR 1801 (GREEN CHAPEL CH RD)	FROM SCOT. CO LINE TO SR 1800 (MT MORIAH CH. RD)	2	2WU	2.1	20	24,716.00			13,594			
<b>TOTAL FOR MAP NO. 18</b>							<b>2.1</b>		<b>24,716.00</b>			<b>13,594</b>			
2017CPT.08.20.20772	Richmond	19	SR 1806 (GIBSON SMITH RD)	FROM SR 1615 (MAIN ST) TO DEAD END	2	2WU	0.52	20	6,532.00			3,593			
<b>TOTAL FOR MAP NO. 19</b>							<b>0.52</b>		<b>6,532.00</b>			<b>3,593</b>			
2017CPT.08.20.20772	Richmond	20	SR 1654 (FORDTOWN RD)	FROM SR 1624 (COUNTY HOME RD) TO END MAINT.	2	2WU	0.45	20	5,382.00	5,382.00		2,965			
<b>TOTAL FOR MAP NO. 20</b>							<b>0.45</b>		<b>5,382.00</b>	<b>5,382.00</b>		<b>2,965</b>			
2017CPT.08.20.20772	Richmond	21	SR 1642 (BALDWIN RD)	FROM SR 1624 (COUNTY HOME RD) TO END MAINT.	2	2WU	0.91	18	9,616.00	9,616.00		4,808			
<b>TOTAL FOR MAP NO. 21</b>							<b>0.91</b>		<b>9,616.00</b>	<b>9,616.00</b>		<b>4,808</b>			
2017CPT.08.20.20772	Richmond	22	SR 1684 (KRISTY LN)	FROM SR 1624 (COUNTY HOME RD) TO END MAINT.	2	2WU	0.3	20	3,533.00	3,533.00		1,944			
<b>TOTAL FOR MAP NO. 22</b>							<b>0.3</b>		<b>3,533.00</b>	<b>3,533.00</b>		<b>1,944</b>			
2017CPT.08.20.20772	Richmond	23	SR 1708 (WILDERNESS DR)	FROM SR 1624 (COUNTY HOME RD) TO DEAD END	2	2WU	0.44	24	6,506.00	6,506.00		3,579			
<b>TOTAL FOR MAP NO. 23</b>							<b>0.44</b>		<b>6,506.00</b>	<b>6,506.00</b>		<b>3,579</b>			
2017CPT.08.20.20772	Richmond	24	SR 1709 (AMANDA LN)	FROM SR 1640 (WIREGRASS RD) TO DEAD END	2	2WU	0.15	20	1,720.00	1,720.00		946			
<b>TOTAL FOR MAP NO. 24</b>							<b>0.15</b>		<b>1,720.00</b>	<b>1,720.00</b>		<b>946</b>			
2017CPT.08.20.20772	Richmond	25	SR 1710 (DORAL DR)	FROM SR 1624 (COUNTY HOME RD) TO SR 1728 (DORAL DR)	2	2WU	18	18	2,264.00	2,264.00		1,246			
<b>TOTAL FOR MAP NO. 25</b>							<b>18</b>		<b>2,264.00</b>	<b>2,264.00</b>		<b>1,246</b>			
2017CPT.08.20.20772	Richmond	26	SR 1711 (GLENMORE DR)	FROM CUL-DE-SAC TO CUL-DE-SAC	2	2WU	0.21	30	2,964.00	2,964.00		1,631			
<b>TOTAL FOR MAP NO. 26</b>							<b>0.21</b>		<b>2,964.00</b>	<b>2,964.00</b>		<b>1,631</b>			
2017CPT.08.20.20772	Richmond	27	SR 1712 (DANIELS LANE)	FROM END MAINT. TO END MAINT.	2	2WU	0.24	30	3,334.00	3,334.00		1,834			
<b>TOTAL FOR MAP NO. 27</b>							<b>0.24</b>		<b>3,334.00</b>	<b>3,334.00</b>		<b>1,834</b>			
2017CPT.08.20.20772	Richmond	28	SR 1728 (MOTLOW LANE)	FROM CUL-DE-SAC TO CUL-DE-SAC	2	2WU	0.3	20	4,206.00	4,206.00		2,314			
<b>TOTAL FOR MAP NO. 28</b>							<b>0.3</b>		<b>4,206.00</b>	<b>4,206.00</b>		<b>2,314</b>			
2017CPT.08.20.20772	Richmond	29	SR 1691 (CLOUD AVE)	FROM SR 1624 (COUNTY HOME RD) TO END MAINT.	2	2WU	0.17	20	2,510.00	2,510.00		1,382			
<b>TOTAL FOR MAP NO. 29</b>							<b>0.17</b>		<b>2,510.00</b>	<b>2,510.00</b>		<b>1,382</b>			
2017CPT.08.20.20772	Richmond	30	SR 1692 (GRAHAM ST)	FROM 1691 (CLOUD DR) TO DEAD END	2	2WU	0.09	18	996.00	996.00		548			
<b>TOTAL FOR MAP NO. 30</b>							<b>0.09</b>		<b>996.00</b>	<b>996.00</b>		<b>548</b>			
2017CPT.08.20.20772	Richmond	31	SR 1703 (CARROLL ST)	FROM 1691 (CLOUD DR) TO DEAD END	2	2WU	0.09	18	986.00	986.00		543			
<b>TOTAL FOR MAP NO. 31</b>							<b>0.09</b>		<b>986.00</b>	<b>986.00</b>		<b>543</b>			
2017CPT.08.20.20772	Richmond	32	SR 1625 (GIBBONS ST)	FROM SR 1624 (COUNTY HOME RD) TO NC 177	2	2WU	0.34	16	3,551.00	3,551.00		1,954			
<b>TOTAL FOR MAP NO. 32</b>							<b>0.34</b>		<b>3,551.00</b>	<b>3,551.00</b>		<b>1,954</b>			
2017CPT.08.20.20772	Richmond	33	SR 1626 (COCHRAN ST)	FROM 1624 (COUNTY HOME RD) TO NC 177	2	2WU	0.35	20	1,855.00	1,855.00		1,021	*		
<b>TOTAL FOR MAP NO. 33</b>							<b>0.35</b>		<b>1,855.00</b>	<b>1,855.00</b>		<b>1,021</b>			
<b>TOTAL FOR PROJ NO. 2017CPT.08.20.20772</b>							<b>36.5</b>		<b>224,253.00</b>	<b>49,423.00</b>		<b>122,874</b>	<b>25</b>		
<b>GRAND TOTAL</b>									<b>56.83</b>		<b>252,053.00</b>	<b>49,423.00</b>	<b>212,250.00</b>	<b>298,934</b>	<b>50</b>



PROJECT NO.	SHEET NO.	TOTAL NO.
2017CPT.08.20.20622	7	
2017CPT.08.20.20772		

## THERMOPLASTIC AND PAINT QUANTITIES

PROJECT NO	COUNTY	MAP NO	ROUTE	DESCRIPTION	LANES	LANE TYPE	LENGTH	WIDTH	4413000000-E	4457000000-N	4705000000-E	4710000000-E	4721000000-E	4810000000-E		
									WORK ZONE ADVANCE/GENERAL WARNING SIGNING SF	TEMPORARY TRAFFIC CONTROL LS	16" X 120 M WHITE THERMO LF	24" X 120 M WHITE THERMO LF	THERMO RXR 120 M EA	4" WHITE PAINT LF	4" YELLOW PAINT LF	
2017CPT.08.20.20622	Montgomery	1	SR 1146 (DUSTY LEVEL RD)	FROM SR 1134 (MT CARMEL CH RD) TO SR 1147 (CORRELL RD)	2	2WU	1.24	20	140						26,685	26,685
<b>TOTAL FOR MAP NO. 1</b>									<b>140</b>					<b>26,685</b>	<b>26,685</b>	
2017CPT.08.20.20622	Montgomery	2	SR 1310 (LOVEJOY RD)	FROM BRIDGE #133 OVER DOOMAS CREEK TO SR 1314 (AUNT QUEEN RD)	2	2WU	4.2	20	500						90,384	90,384
<b>TOTAL FOR MAP NO. 2</b>									<b>500</b>					<b>90,384</b>	<b>90,384</b>	
2017CPT.08.20.20622	Montgomery	3	SR 1315 (FLOYD FARM RD)	FROM SR 1340 (OKEWEEMEE-STAR RD) TO PAVEMENT CHANGE (0.51MI N OF SR1340 OKOWEEMEE RD)	2	2WU	0.51	20	60						10,975	10,975
<b>TOTAL FOR MAP NO. 3</b>									<b>60</b>					<b>10,975</b>	<b>10,975</b>	
2017CPT.08.20.20622	Montgomery	4	SR 1317 (BEAMAN RD)	FROM SR 1310 (LOVE JOY RD) TO SR 1318 (SHILOH CH RD)	2	2WU	1.67	20	200						35,938	35,938
<b>TOTAL FOR MAP NO. 4</b>									<b>200</b>					<b>35,938</b>	<b>35,938</b>	
2017CPT.08.20.20622	Montgomery	5	SR 1360 (TALC MINE RD)	FROM US 220 ALT TO MOORE CO	2	2WU	0.5	20	60						10,760	10,760
<b>TOTAL FOR MAP NO. 5</b>									<b>60</b>					<b>10,760</b>	<b>10,760</b>	
2017CPT.08.20.20622	Montgomery	6	SR 1365 (DOVER RD)	FROM SR 1364 (DOVER CH. RD) TO US 220 ALT	2	2WU	1.69	22	200						36,369	36,369
<b>TOTAL FOR MAP NO. 6</b>									<b>200</b>					<b>36,369</b>	<b>36,369</b>	
2017CPT.08.20.20622	Montgomery	7	SR 1377 (ATKINS DAIRY RD)	FROM NC 134 TO END MAINT	2	2WU	1.53	20	200						32,926	32,926
<b>TOTAL FOR MAP NO. 7</b>									<b>200</b>					<b>32,926</b>	<b>32,926</b>	
2017CPT.08.20.20622	Montgomery	8	SR 1500 (HUNSUCKER ST)	FROM SR 1577 (MCCASKILL STREET) TO US 220 ALT	2	2WU	0.56	16	70						12,051	12,051
<b>TOTAL FOR MAP NO. 8</b>									<b>70</b>					<b>12,051</b>	<b>12,051</b>	
2017CPT.08.20.20622	Montgomery	9	SR 1613 (ALEXANDER RD)	FROM NC 24 TO PAVEMENT CHANGE (0.2MI S OF NC 24)	2	2WU	0.2	18	30						4,304	4,304
<b>TOTAL FOR MAP NO. 9</b>									<b>30</b>					<b>4,304</b>	<b>4,304</b>	
2017CPT.08.20.20622	Montgomery	10	SR 1565 (THICKETY CREEK RD)	FROM BRIDGE #60 OVER LITTLE CREEK TO SR 1568 (ONVIL ROAD)	2	2WU	2.86	20	400						61,547	61,547
<b>TOTAL FOR MAP NO. 10</b>									<b>400</b>					<b>61,547</b>	<b>61,547</b>	
2017CPT.08.20.20622	Montgomery	11	SR 1118 (YANK RD)	FROM SR 1546 (SHOE FACTORY RD) TO NC 731	2	2WU	5.37	20	602						115,562	115,562
<b>TOTAL FOR MAP NO. 11</b>									<b>602</b>					<b>115,562</b>	<b>115,562</b>	
<b>TOTAL FOR PROJ NO. 2017CPT.08.20.20622</b>									<b>2,462</b>	<b>1</b>				<b>437,501</b>	<b>437,501</b>	
															<b>875,002</b>	
2017CPT.08.20.20772	Richmond	12	SR 1607 (MARKS CREEK CH RD)	FROM SR 1608 (BOYDS LAKE RD) TO END PVMT	2	2WU	0.37	20	42							
<b>TOTAL FOR MAP NO. 12</b>									<b>42</b>							
2017CPT.08.20.20772	Richmond	13	SR 1607 (MARKS CREEK CH RD)	FROM BEG PVMT TO SR 1610 (PEGGY MILL RD)	2	2WU	1.41	20	158						23,414	16,641
<b>TOTAL FOR MAP NO. 13</b>									<b>158</b>					<b>23,414</b>	<b>16,641</b>	
2017CPT.08.20.20772	Richmond	14	SR 1607 (MARKS CREEK CHURCH RD)	FROM BEG PAVMT TO SR 1614 (OLD LAURINBURG RD)	2	2WU	1.02	20	114						21,173	16,506
<b>TOTAL FOR MAP NO. 14</b>									<b>114</b>					<b>21,173</b>	<b>16,506</b>	
2017CPT.08.20.20772	Richmond	15	SR 1613 (COLES STORE RD)	FROM SR 1607 (MARKS CRK CH RD) TO SR 1608 (BOYDS LAKE RD)	2	2WU	2.37	20	265						51,002	42,342
<b>TOTAL FOR MAP NO. 15</b>									<b>265</b>					<b>51,002</b>	<b>42,342</b>	
2017CPT.08.20.20772	Richmond	16	SR 1614 (OLD LAURINBURG RD)	FROM SR 1610 (PEGGY MILL RD) TO SCOT. CO. LINE	2	2WU	1.98	22	222						41,910	21,126
<b>TOTAL FOR MAP NO. 16</b>									<b>222</b>					<b>41,910</b>	<b>21,126</b>	
2017CPT.08.20.20772	Richmond	17	SR 1803 (OSBORNE RD)	FROM SR 1804 (SPRING HILL CH RD) TO SR 1104 (OSBORNE RD)	2	2WU	4.69	20	525		100	69	4		68,517	54,772
<b>TOTAL FOR MAP NO. 17</b>									<b>525</b>		<b>100</b>	<b>69</b>	<b>4</b>	<b>68,517</b>	<b>54,772</b>	
2017CPT.08.20.20772	Richmond	18	SR 1801 (GREEN CHAPEL CH RD)	FROM SCOT. CO LINE TO SR 1800 (MT MORIAH CH. RD)	2	2WU	2.1	20	235						44,488	27,556
<b>TOTAL FOR MAP NO. 18</b>									<b>235</b>					<b>44,488</b>	<b>27,556</b>	
2017CPT.08.20.20772	Richmond	19	SR 1806 (GIBSON SMITH RD)	FROM SR 1615 (MAIN ST) TO DEAD END	2	2WU	0.52	20	58						8,678	8,980
<b>TOTAL FOR MAP NO. 19</b>									<b>58</b>					<b>8,678</b>	<b>8,980</b>	
2017CPT.08.20.20772	Richmond	20	SR 1654 (FORDTOWN RD)	FROM SR 1624 (COUNTY HOME RD) TO END MAINT.	2	2WU	0.45	20	51							
<b>TOTAL FOR MAP NO. 20</b>									<b>51</b>							
2017CPT.08.20.20772	Richmond	21	SR 1642 (BALDWIN RD)	FROM SR 1624 (COUNTY HOME RD) TO END MAINT.	2	2WU	0.91	18	102						18,880	14,654
<b>TOTAL FOR MAP NO. 21</b>									<b>102</b>					<b>18,880</b>	<b>14,654</b>	
2017CPT.08.20.20772	Richmond	22	SR 1684 (KRISTY LN)	FROM SR 1624 (COUNTY HOME RD) TO END MAINT.	2	2WU	0.3	20	34							
<b>TOTAL FOR MAP NO. 22</b>									<b>34</b>							
2017CPT.08.20.20772	Richmond	23	SR 1708 (WILDERNESS DR)	FROM SR 1624 (COUNTY HOME RD) TO DEAD END	2	2WU	0.44	24	50						9,016	9,016
<b>TOTAL FOR MAP NO. 23</b>									<b>50</b>					<b>9,016</b>	<b>9,016</b>	
2017CPT.08.20.20772	Richmond	24	SR 1709 (AMANDA LN)	FROM SR 1640 (WIREGRASS RD) TO DEAD END	2	2WU	0.15	20	17							
<b>TOTAL FOR MAP NO. 24</b>									<b>17</b>							
2017CPT.08.20.20772	Richmond	25	SR 1710 (DORAL DR)	FROM SR 1624 (COUNTY HOME RD) TO SR 1728 (DORAL DR)	2	2WU	18	18	24							
<b>TOTAL FOR MAP NO. 25</b>									<b>24</b>							
2017CPT.08.20.20772	Richmond	26	SR 1711 (GLENMORE DR)	FROM CUL-DE-SAC TO CUL-DE-SAC	2	2WU	0.21	30	24							
<b>TOTAL FOR MAP NO. 26</b>									<b>24</b>							
2017CPT.08.20.20772	Richmond	27	SR 1712 (DANIELS LANE)	FROM END MAINT. TO END MAINT.	2	2WU	0.24	30	27							
<b>TOTAL FOR MAP NO. 27</b>									<b>27</b>							
2017CPT.08.20.20772	Richmond	28	SR 1728 (MOTLOW LANE)	FROM CUL-DE-SAC TO CUL-DE-SAC	2	2WU	0.3	20	34							
<b>TOTAL FOR MAP NO. 28</b>									<b>34</b>							
2017CPT.08.20.20772	Richmond	29	SR 1691 (CLOUD AVE)	FROM SR 1624 (COUNTY HOME RD) TO END MAINT.	2	2WU	0.17	20	20							
<b>TOTAL FOR MAP NO. 29</b>									<b>20</b>							
2017CPT.08.20.20772	Richmond	30	SR 1692 (GRAHAM ST)	FROM 1691 (CLOUD DR) TO DEAD END	2	2WU	0.09	18	10							
<b>TOTAL FOR MAP NO. 30</b>									<b>10</b>							
2017CPT.08.20.20772	Richmond	31	SR 1703 (CARROLL ST)	FROM 1691 (CLOUD DR) TO DEAD END	2	2WU	0.09	18	10							
<b>TOTAL FOR MAP NO. 31</b>									<b>10</b>							
2017CPT.08.20.20772	Richmond	32	SR 1625 (GIBBONS ST)	FROM SR 1624 (COUNTY HOME RD) TO NC 177	2	2WU	0.34	16	38							
<b>TOTAL FOR MAP NO. 32</b>									<b>38</b>							
2017CPT.08.20.20772	Richmond	33	SR 1626 (COCHRAN ST)	FROM 1624 (COUNTY HOME RD) TO NC 177	2	2WU	0.35	20	39							
<b>TOTAL FOR MAP NO. 33</b>									<b>39</b>							
<b>TOTAL FOR PROJ NO. 2017CPT.08.20.20772</b>									<b>2,099</b>	<b>1</b>	<b>100</b>	<b>69</b>	<b>4</b>	<b>287,078</b>	<b>211,593</b>	
															<b>498,671</b>	
<b>GRAND TOTAL</b>									<b>56.83</b>	<b>1</b>	<b>100</b>	<b>69</b>	<b>4</b>	<b>724,579</b>	<b>649,094</b>	
															<b>1,373,673</b>	

# SIGNING FOR ASPHALT SURFACE TREATMENT

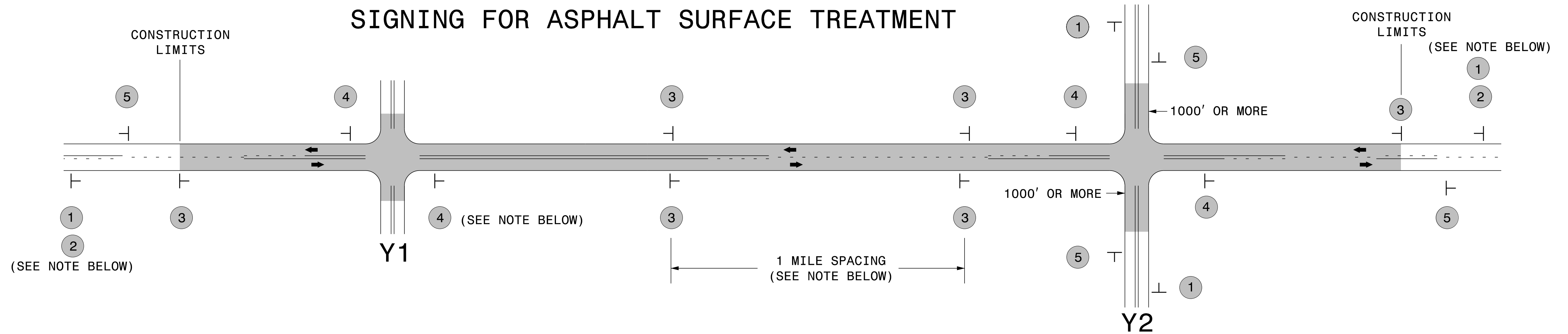

LEGEND	
⊥	STATIONARY SIGN
←	DIRECTION OF TRAFFIC FLOW

## MAINLINE (-L-) SIGNING

## -Y- LINE SIGNING

SIGNING NOTES AND PLACEMENT PER DIRECTION	1	<p>PLACE 1000' PRIOR TO BEGINNING OF CONSTRUCTION LIMITS. ONLY USED ON -Y- LINES IF RESURFACING LIMITS EXTEND 1000' ALONG -Y- LINE.</p>
	2	<p>#2 SIGN ONLY USED WHEN RESURFACING LIMITS ARE 2 OR MORE MILES IN LENGTH. ROUND UP TO NEXT WHOLE NUMBER. (NO FRACTIONAL OR DECIMAL NUMBERS)</p>
	3	<p>ALTERNATE THE FOLLOWING TWO SIGNS: STARTING WITH "LOOSE GRAVEL" (W8-7) FOLLOWED BY "UNMARKED PAVEMENT".</p> <p>PLACE INITIALLY AT THE CONSTRUCTION LIMITS AND SPACED 1 MILE APART THEREAFTER. IF NO -Y- LINES EXIST, PLACE 2ND SET 1/2 MILE FROM THE CONSTRUCTION LIMITS AND THEN SPACE 1 MILE THEREAFTER.</p>
	4	<p>THESE ARE FOR -Y- LINES THAT ARE "THROUGH" ROADWAYS. DEAD END AND SUBDIVISION ROADS ARE NOT "THROUGH" ROADWAYS. INSTALL 500' +/- FROM EACH -Y- LINE APPROACH AS SHOWN ABOVE. FOR MULTIPLE -Y- LINES THAT ARE SEPARATED BY 0.25 MILES OR LESS, TREAT AS A SINGLE UNIT AND INSTALL WITHIN 500' OF EACH APPROACH. A MAXIMUM OF 2 SIGN SETS PER MILE. DO NOT INSTALL WHEN -Y- LINES ARE WITHIN 0.5 MILES FROM "END ROAD WORK" SIGN.</p>
	5	<p>PLACE 500' FOLLOWING THE END OF CONSTRUCTION LIMITS.</p>

NO REQUIRED STATIONARY SIGNING FOR THE FOLLOWING -Y- LINE CONDITIONS:

- 1) LESS THAN 1000' OF RESURFACING ALONG -Y- LINE
- 2) SUBDIVISION ROADS
- 3) DEAD END ROADS

WHEN PAVING/CONSTRUCTION ACTIVITIES PROCEED ACROSS AN UNSIGNED -Y- LINE, ADVANCE WARNING PORTABLE SIGNS SHALL BE USED ALONG THE -Y- LINE AS SHOWN BELOW. REMOVE UPON COMPLETION OF WORK.



PLACED 500' IN ADVANCE OF FLAGGER. PLACED 250' IN ADVANCE OF FLAGGER.



ADVANCE WARNING SIGNS FOR ASPHALT SURFACE TREATMENTS 2 LANE ROADWAYS