

INSET "A" CONTAINS MAPS=
 12,15,20,27,28,29,38,60,61,62,63,64,65,83,
 85,84,86,87,89,90,92,93,95,96,97,98,106,
 107,108,109,112,113

INSET "B" CONTAINS MAPS=
 6,13,16,17,18,19,55,94,99,
 100,101,102,103,104,105

INSET "C" CONTAINS MAPS=
 1,8,9,10,26,35,39,54,71,72,73,74,75,110,111

INSET "D" CONTAINS MAPS=
 14,30,31,32,33,34,66,67,69,70

INSET "E" CONTAINS MAPS=
 40,41,56,57,58,59,114,115,116,117,118,119,120,
 121,130,131,132,133,134,135,137,138,139,140,
 141,142,143,144

INSET "F" CONTAINS MAPS=
 2,3,4,5,11,21,22,23,24,36,37,42,47,48,50,
 68,76,77,78,79,80,81,82,88,91,122,123,124,
 125,126,127,128,129,136

INSET "G" CONTAINS MAPS=
 7,43,44,45,46,145,146

INSET "H" CONTAINS MAPS=
 25,49,51,52,53

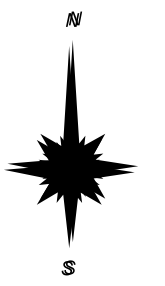

040397
 STINE
 COUNTY

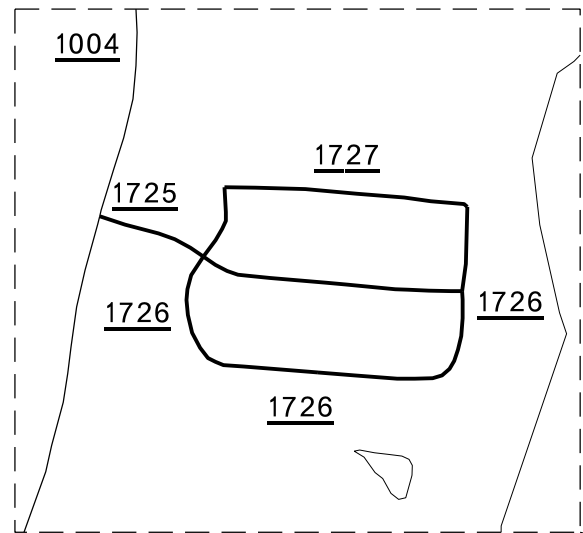

SR 1725 = MAP 17
 SR 1726 = MAP 18
 SR 1727 = MAP 19

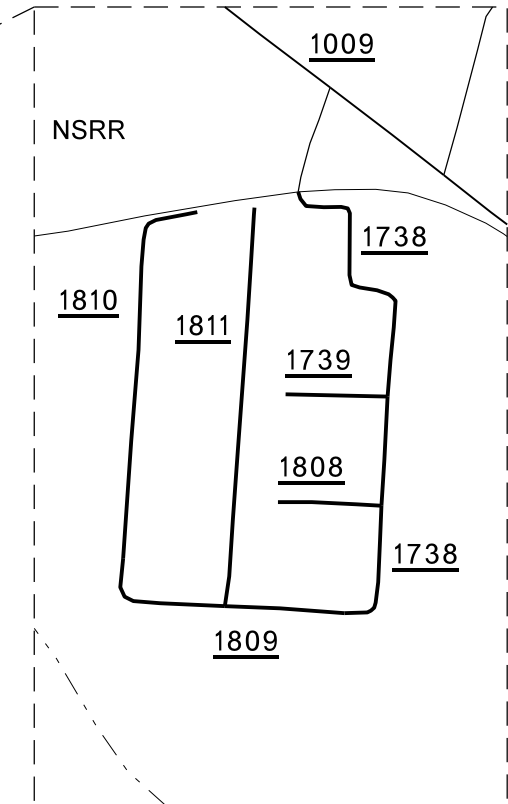
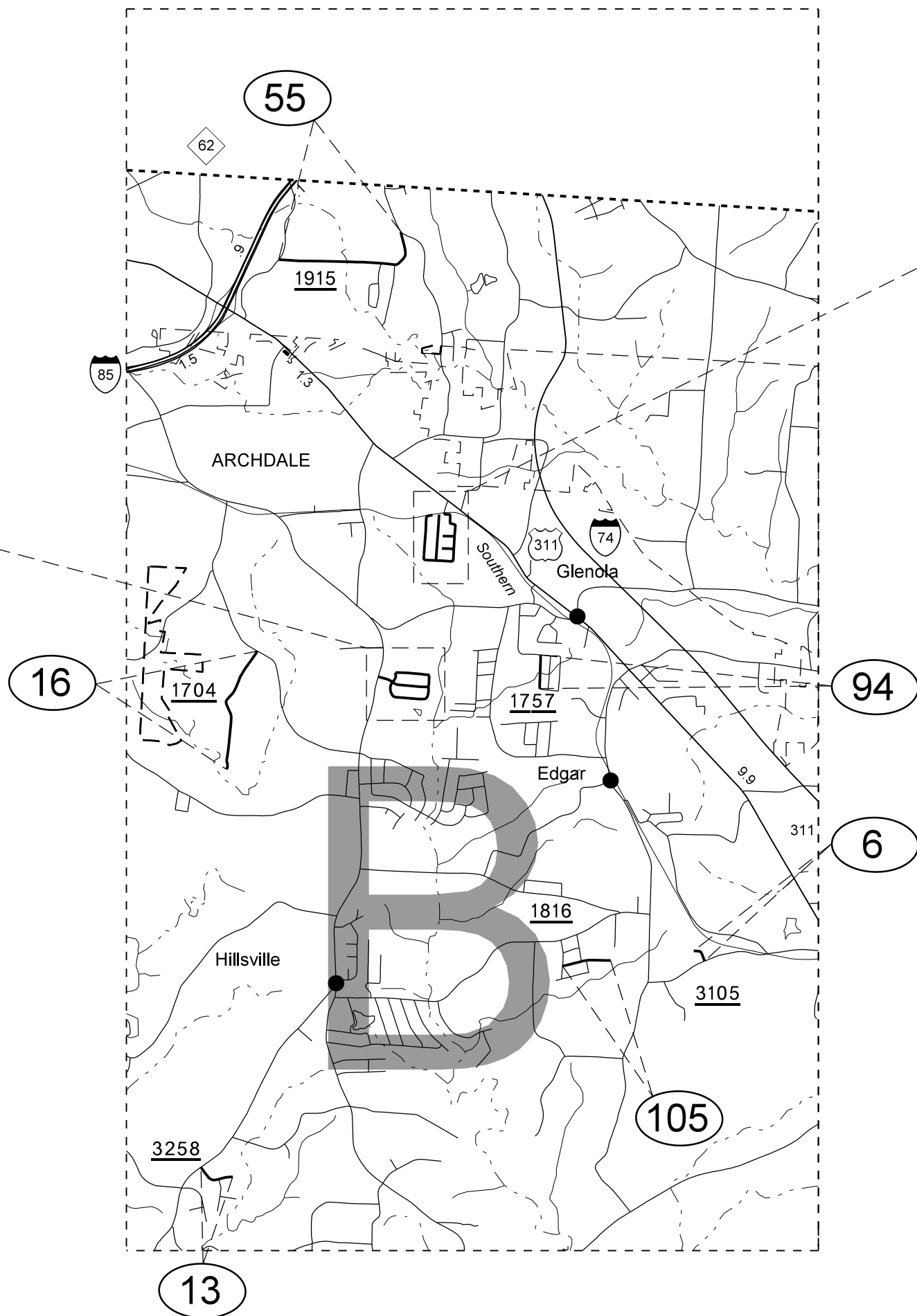

SR 1738 = MAP 99 SR 1809 = MAP 102
 SR 1739 = MAP 100 SR 1810 = MAP 103
 SR 1808 = MAP 101 SR 1811 = MAP 104

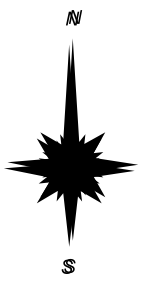

RANDOLPH COUNTY
 SECONDARY SEAL REQUEST MAP

040397
 SYSTEMS DESIGN & CONSULTING
 1000 W. MAIN ST. SUITE 100
 HILLSVILLE, NC 27540
 (919) 680-1000
 WWW.SDCCONSULTING.COM

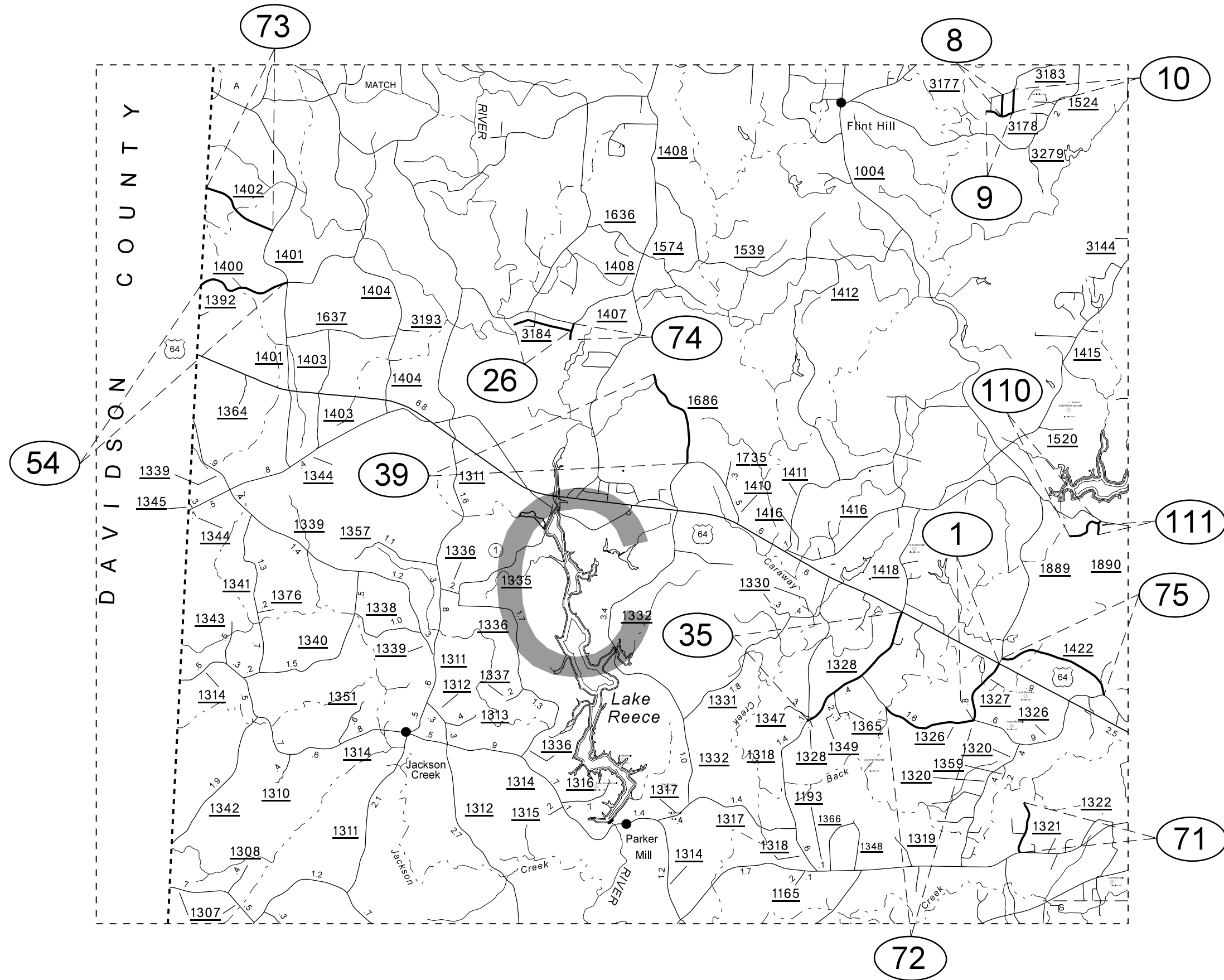

RANDOLPH COUNTY
 SECONDARY SEAL REQUEST MAP

040397

SYSTEMS SECTION

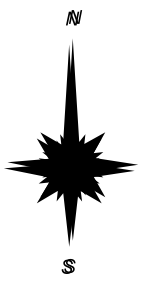
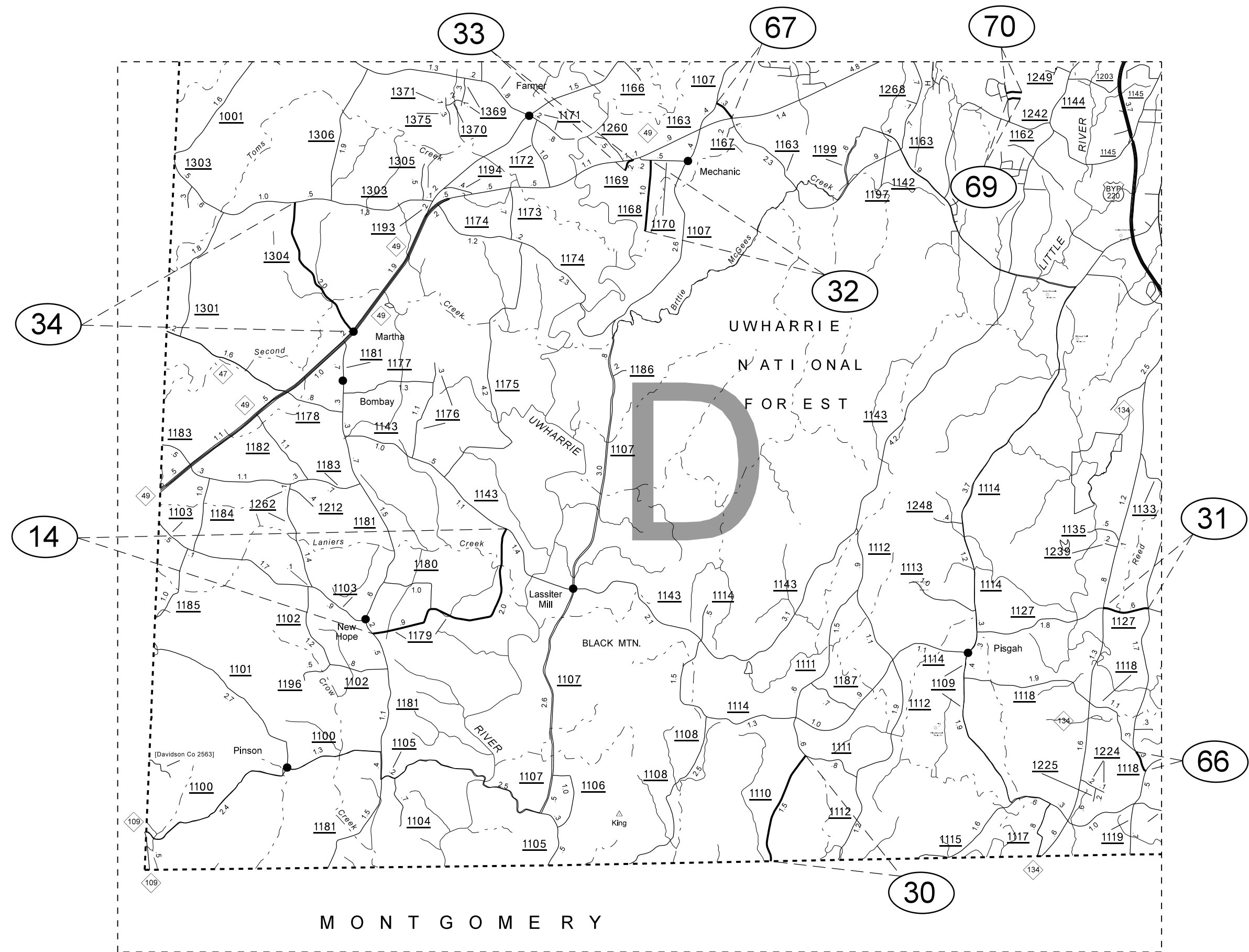

RANDOLPH COUNTY
SECONDARY SEAL REQUEST MAP

040397

SYSTEMS ENGINEERING

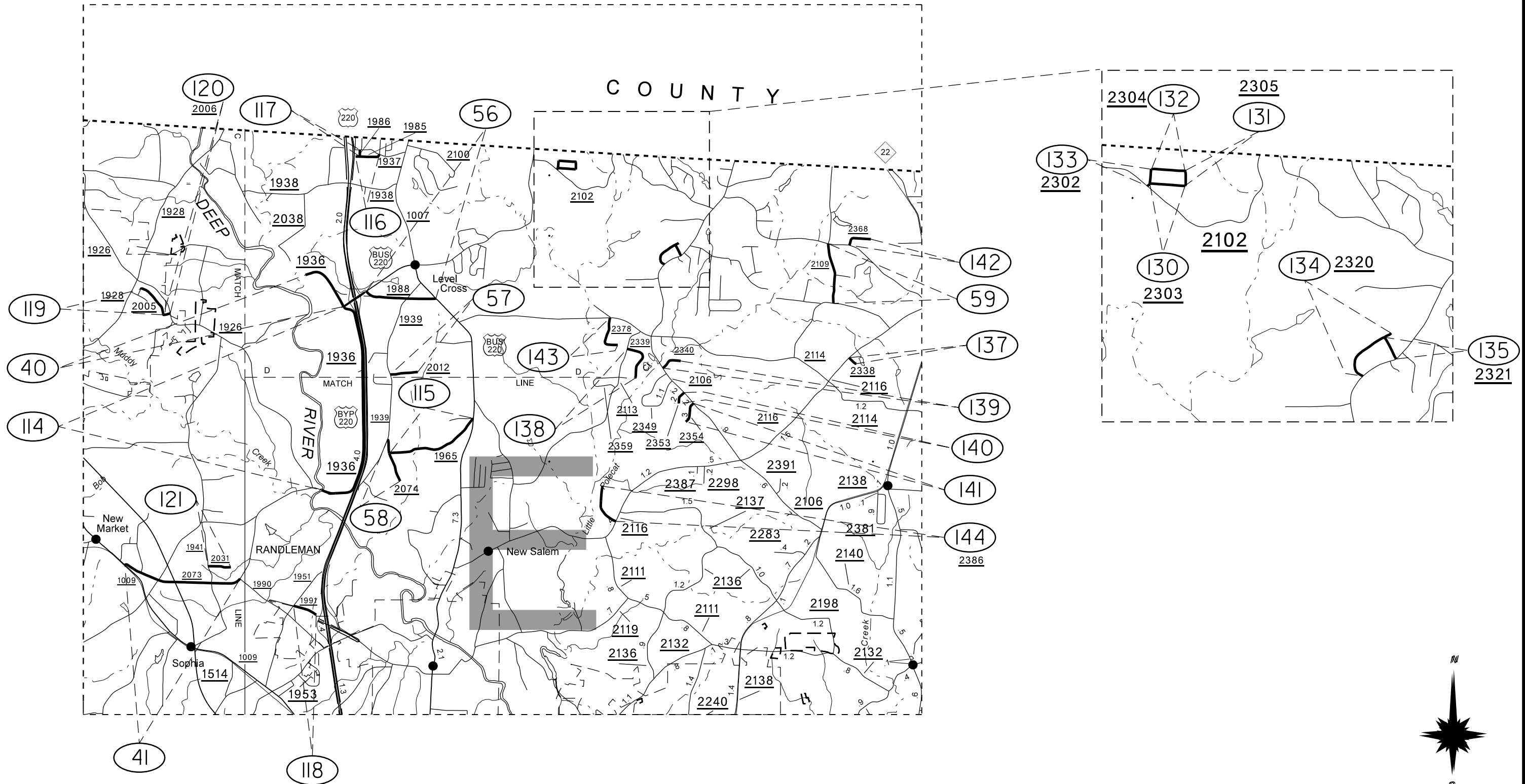

RANDOLPH COUNTY
SECONDARY SEAL REQUEST MAP

SYSTEMS ENGINEERING & DESIGN
 1000 W. MAIN ST. SUITE 100
 RALEIGH, NC 27601
 (919) 876-1000
 WWW.SED-NC.COM

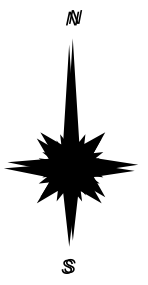
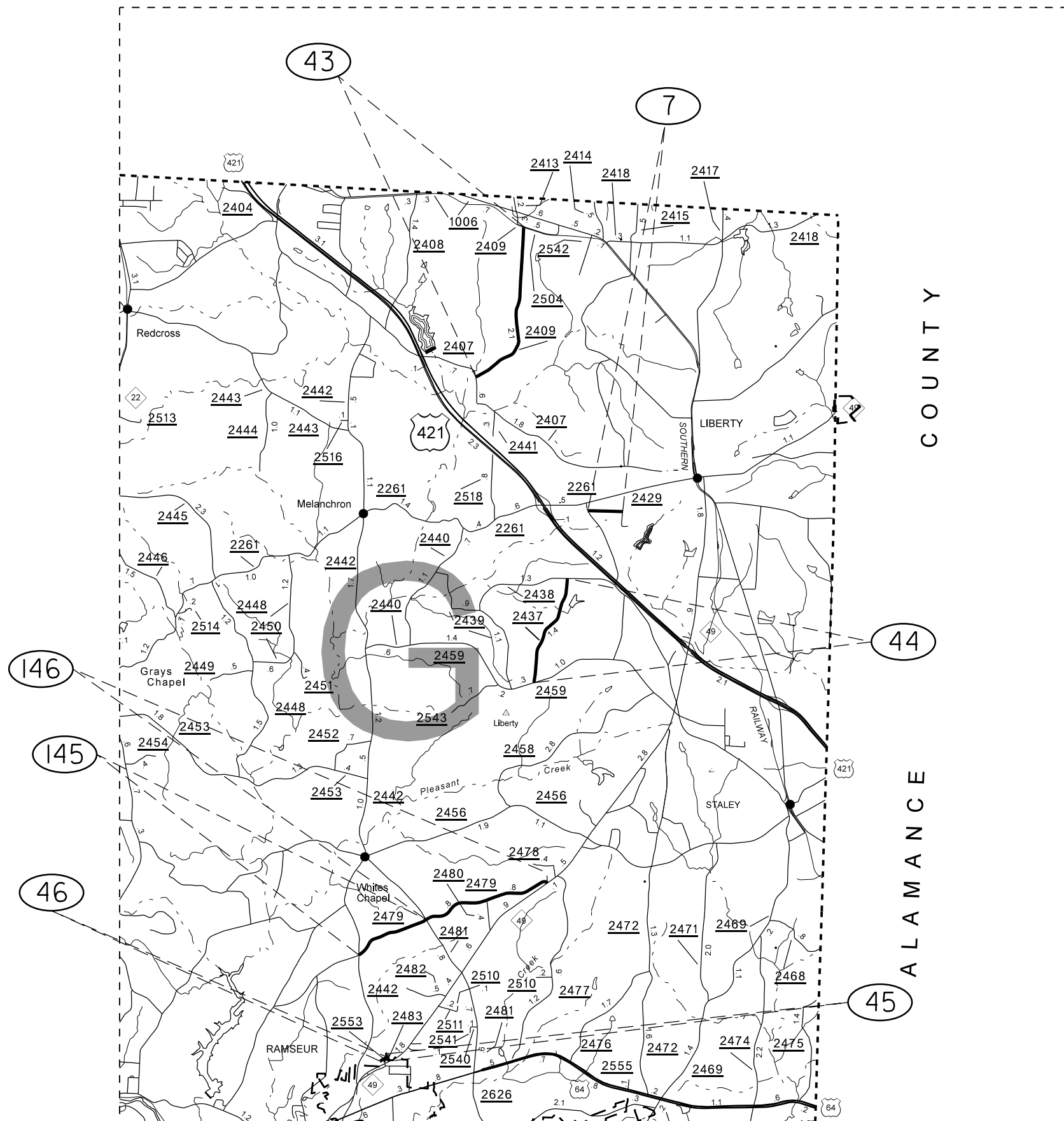

RANDOLPH COUNTY
SECONDARY SEAL REQUEST MAP

040397

SYSTEMS DESIGN CONSULTANTS

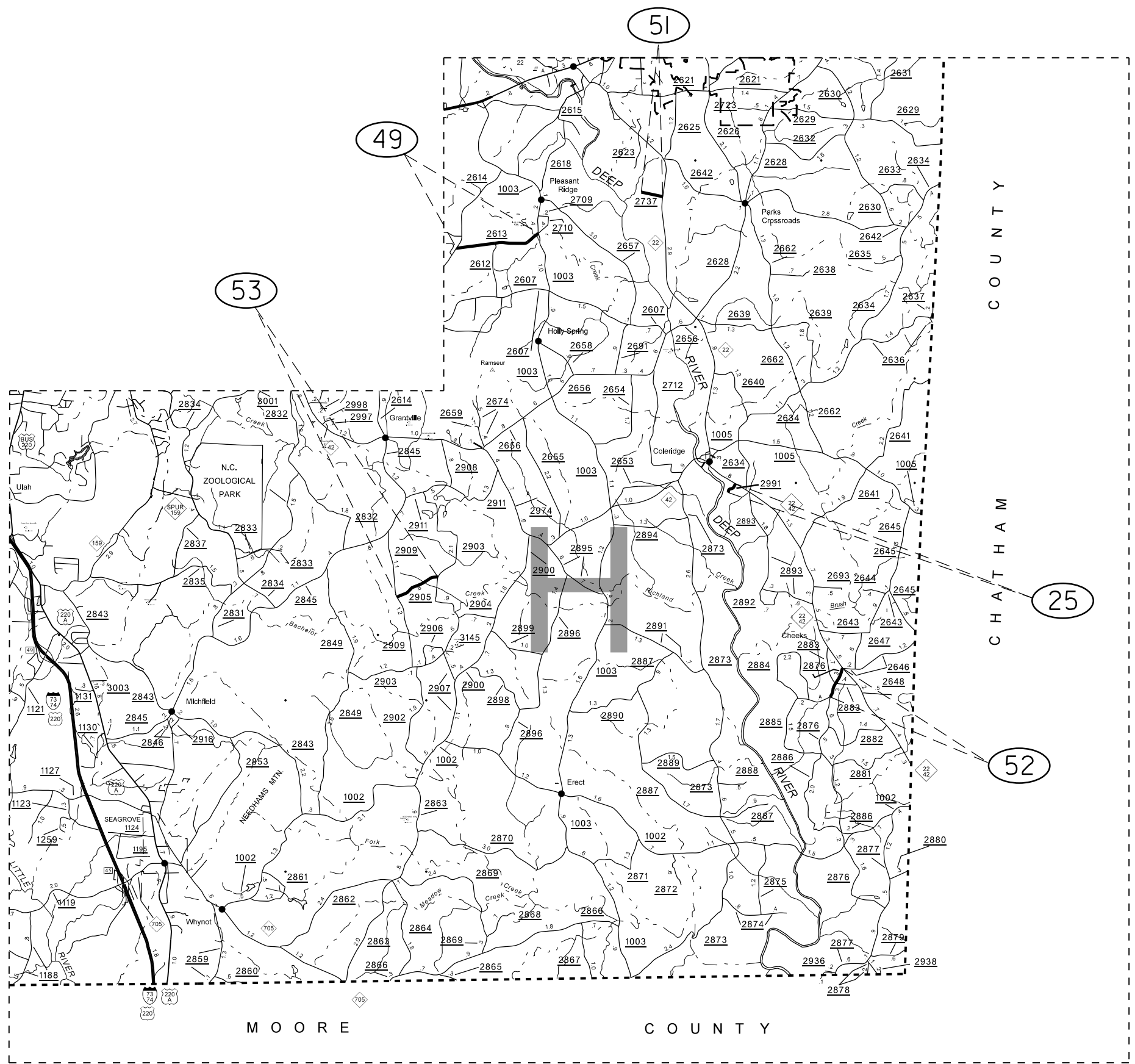

RANDOLPH COUNTY
 SECONDARY SEAL REQUEST MAP

040397

SYSTEMS ENGINEERING

PROJECT NO.	SHEET NO.	TOTAL NO.
2017CPT.08.19.20762	10	

SUMMARY OF QUANTITIES

PROJECT NO	COUNTY	MAP NO	ROUTE	DESCRIPTION	LANES	LANE TYPE	LENGTH MI	WIDTH FT	ASPHALT SURFACE TREATMENT, DOUBLE SEAL SY	ASPHALT SURFACE TREATMENT, FOG SEAL SY	EMULSION FOR ASPHALT SURFACE TREATMENT GAL	BLOTTING SAND TON
2017CPT.08.19.20762	Randolph	1	SR 1327 (BACK CREEK CH RD)	FROM US 64 TO SR 1326 STUTTS RD	2	2WU	0.704	20	8,300.00		4,550	
TOTAL FOR MAP NO. 1												
2017CPT.08.19.20762	Randolph	2	SR 2810 (BROOK DR)	FROM SR 2915 (RIDGE ST) TO SR 2919 (ELDORADO RD)	2	2WU	0.616	18	6,530.00	6,530.00	3,580	
TOTAL FOR MAP NO. 2												
2017CPT.08.19.20762	Randolph	3	SR 2815 (MC DERMONT ST)	FROM SR 2819 (HAWTHORNE DR) TO END OF MAINTENANCE	2	2WU	0.155	16	7,450.00	7,450.00	4,080	
TOTAL FOR MAP NO. 3												
2017CPT.08.19.20762	Randolph	4	SR 2818 (HOWARD AVE)	FROM SR 2913 (AUMAN AVE) TO SR 2819 (HAWTHORNE DR)	2	2WU	0.34	17	3,420.00	3,420.00	1,870	
TOTAL FOR MAP NO. 4												
2017CPT.08.19.20762	Randolph	5	SR 2979 (HORSE MOUNTAIN RD)	FROM SR 2826 (BROWERS CHAPEL RD) TO DEAD END	2	2WU	0.23	20	2,750.00	2,750.00	1,490	
TOTAL FOR MAP NO. 5												
2017CPT.08.19.20762	Randolph	6	SR 3105 (BRAD RD)	FROM SR 1527 (MARLBORO CHURCH RD) TO CUL-DE-SAC	2	2WU	0.097	19	1,100.00	1,100.00	600	
TOTAL FOR MAP NO. 6												
2017CPT.08.19.20762	Randolph	7	SR 2429 (KIRKMAN STREET EXT.)	FROM SR 2434 (TROY ESTATE RD) TO SR 2433 S (ALLISON ST)	2	2WU	0.42	18	4,500.00		2,450	
TOTAL FOR MAP NO. 7												
2017CPT.08.19.20762	Randolph	8	SR 3177 (MEADOW ACRES LN)	FROM SR 1523 (MARSH MOUNTAIN RD) TO SR 3178 (FOREST TRL)	2	2WU	0.24	18	2,570.00	2,570.00	1,400	
TOTAL FOR MAP NO. 8												
2017CPT.08.19.20762	Randolph	9	SR 3178 (FORREST TRL)	FROM SR 3183 (GREEN GLADE RD) TO DEAD END	2	2WU	0.331	18	3,550.00	3,550.00	1,930	
TOTAL FOR MAP NO. 9												
2017CPT.08.19.20762	Randolph	10	SR 3183 (GREEN GLADE RD)	FROM SR 1523 (MARSH MOUNTAIN RD) TO SR 3178 (FOREST TRL)	2	2WU	0.257	18	2,740.00	2,740.00	1,500	
TOTAL FOR MAP NO. 10												
2017CPT.08.19.20762	Randolph	11	SR 3211 (PINE NEEDLES DR)	FROM SR 3101 (WESTLAKE RD) TO CUL-DE-SAC	2	2WU	0.112	18	1,200.00	1,200.00	660	
TOTAL FOR MAP NO. 11												
2017CPT.08.19.20762	Randolph	12	SR 3257 (HUCKLEBERRY LN)	FROM SR 3256 (WILDWOOD RD) TO CUL-DE-SAC	2	2WU	0.271	18	2,900.00	2,900.00	1,580	
TOTAL FOR MAP NO. 12												
2017CPT.08.19.20762	Randolph	13	SR 3258 (HUNTINGTON DR)	FROM SR 1408 (HOOVER HILL RD) TO CUL-DE-SAC	2	2WU	0.249	18	2,700.00	2,700.00	1,450	
TOTAL FOR MAP NO. 13												
2017CPT.08.19.20762	Randolph	14	SR 1179 (LOU CRANFORD RD)	FROM SR 1181 (NEW HOPE RD) TO SR 1143 (HIGH PINE CH RD)	2	2WU	2.97	18	31,400.00		17,260	
TOTAL FOR MAP NO. 14												
2017CPT.08.19.20762	Randolph	15	SR 1640 (RIDGE DR)	FROM SR 1564 (MEADOWBROOK DR) TO END MAINTENANCE AT YOUNTS VIEW DR (PRIVARTE)	2	2WU	0.389	18	4,150.00	4,150.00	2,270	
TOTAL FOR MAP NO. 15												
2017CPT.08.19.20762	Randolph	16	SR 1704 (PEACE RD)	FROM SR 1567 (ROBBINS COUNTRY RD) TO CUL-DE-SAC	2	2WU	0.85	18	9,000.00	9,000.00	4,950	
TOTAL FOR MAP NO. 16												
2017CPT.08.19.20762	Randolph	17	SR 1725 (PINE RIDGE DR)	FROM SR 1004 (ARCHDALE RD) TO SR 1726 (WINDEMERE CIR)	2	2WU	0.358	18	3,800.00	3,800.00	2,080	
TOTAL FOR MAP NO. 17												
2017CPT.08.19.20762	Randolph	18	SR 1726 (WINDERMERE DR)	FROM SR 1727 (ARBOR DR) TO SR 1727 (ARBOR DR - CIRCLES AROUND)	2	2WU	0.593	18	6,300.00	6,300.00	3,450	
TOTAL FOR MAP NO. 18												
2017CPT.08.19.20762	Randolph	19	SR 1727 (ARBOR DR)	FROM SR 1726 (WINDERMERE DR) TO SR 1726 (WINDERMERE DR - CONNECTS THE ARC)	2	2WU	0.23	18	2,450.00	2,450.00	1,340	
TOTAL FOR MAP NO. 19												
2017CPT.08.19.20762	Randolph	20	SR 1827 (MEYERS ST)	FROM SR 1558 (TURNPIKE RD) TO DEAD END	2	2WU	0.164	20	2,000.00	2,000.00	1,070	
TOTAL FOR MAP NO. 20												
2017CPT.08.19.20762	Randolph	21	SR 2690 (LOE FALL AVE)	FROM SR 2714 (CLEON ST) TO SR 2682 (RILLA ST)	2	2WU	0.1	18	1,060.00	1,060.00	584	
TOTAL FOR MAP NO. 21												
2017CPT.08.19.20762	Randolph	22	SR 2682 (RILLA ST)	FROM SR 2690 (LOE FALL AVE) TO SR 2607 (BUFFALO FORD RD)	2	2WU	0.303	18	3,250.00	3,250.00	1,770	
TOTAL FOR MAP NO. 22												
2017CPT.08.19.20762	Randolph	23	SR 2714 (CLEON ST)	FROM SR 2607 (BUFFALO FORD RD) TO SR 2690 (LOE FALL AVE)	2	2WU	0.31	18	3,300.00	3,300.00	1,810	
TOTAL FOR MAP NO. 23												
2017CPT.08.19.20762	Randolph	24	SR 2950 (CLEARVIEW DR)	FROM SR 2948 (LINDALE DR) TO DEAD END	2	2WU	0.339	18	3,600.00	3,600.00	1,970	
TOTAL FOR MAP NO. 24												
2017CPT.08.19.20762	Randolph	25	SR 2991 (RIVER HEIGHTS DR)	FROM NC 22 TO DEAD END	2	2WU	0.213	18	2,500.00	2,500.00	1,240	
TOTAL FOR MAP NO. 25												
2017CPT.08.19.20762	Randolph	26	SR 3184 (PARINNA DR)	FROM SR 1407 (HARRIS RD) TO DEAD END	2	2WU	0.696	18	7,400.00	7,400.00	4,050	
TOTAL FOR MAP NO. 26												
2017CPT.08.19.20762	Randolph	27	SR 3194 (FARLOW ST)	FROM SR 1558 (TURNPIKE RD) TO DEAD END	2	2WU	0.258	22	3,370.00	3,370.00	1,840	
TOTAL FOR MAP NO. 27												
2017CPT.08.19.20762	Randolph	28	SR 3274 (STONESIDE CT)	FROM SR 3273 (STONEHENGE RD) TO DEAD END	2	2WU	0.257	20	3,050.00	3,050.00	1,670	
TOTAL FOR MAP NO. 28												
2017CPT.08.19.20762	Randolph	29	SR 3275 (STONEHENGE PL)	FROM SR 3273 (STONEHENGE RD) TO CUL-DE-SAC	2	2WU	0.145	20	1,750.00	1,750.00	940	
TOTAL FOR MAP NO. 29												
2017CPT.08.19.20762	Randolph	30	SR 1110 (RANDALL HURLEY RD)	FROM MONTG CO TO SR 1111 (MT LEBANON RD)	2	2WU	1.503	18	15,900.00		8,740	
TOTAL FOR MAP NO. 30												
2017CPT.08.19.20762	Randolph	31	SR 1127 (BURNEY RD)	FROM SR 1121 (NEW HOPE CH RD) TO NC 134	2	2WU	0.581	18	6,170.00		3,380	
TOTAL FOR MAP NO. 31												
2017CPT.08.19.20762	Randolph	32	SR 1168 (BINGHAM LOFLIN RD)	FROM SR 1170 (MECHANIC RD) TO DEAD END	2	2WU	0.946	20	11,120.00		6,110	
TOTAL FOR MAP NO. 32												
2017CPT.08.19.20762	Randolph	33	SR 1169 (TROTTER RD)	FROM NC 49 TO END PVT	2	2WU	0.206	18	2,200.00		1,200	
TOTAL FOR MAP NO. 33												
2017CPT.08.19.20762	Randolph	34	SR 1304 (SALEM CH RD)	FROM NC 49 TO SR 1303 (BRANTLEY GORDON RD)	2	2WU	1.871	20	22,000.00		12,080	
TOTAL FOR MAP NO. 34												
2017CPT.08.19.20762	Randolph	35	SR 1328 (SAWYERSVILLE RD)	FROM US 64 TO SR 1318 (MOORE RD)	2	2WU	1.72	18	19,200.00		10,550	
TOTAL FOR MAP NO. 35												
2017CPT.08.19.20762	Randolph	36	SR 1505 (CARL DR)	FROM SR 1504 (W CENTRAL AVE) TO END BST.	2	2WU	0.737	22	9,550.00		5,240	
TOTAL FOR MAP NO. 36												
2017CPT.08.19.20762	Randolph	37	SR 1630 (WESLEYAN RD)	FROM SR 2270 US 311 EXT TO PVT. JT. OF RR@ US 220 BUS	2	2WU	0.53	20	6,250.00		3,430	
TOTAL FOR MAP NO. 37												
2017CPT.08.19.20762	Randolph	38	SR 1679 (SUNSET VIEW DR)	FROM SR 1612 (UW HARRIE RD) TO END MAINT	2	2WU	0.33	17	3,320.00	3,320.00	1,820	
TOTAL FOR MAP NO. 38												
2017CPT.08.19.20762	Randolph	39	SR 1686 (MT SHEPHERD RD EXT.)	FROM SR 1410 (MT. SHEPHERD RD) TO DEAD END	2	2WU	1.16	20	13,670.00		7,490	
TOTAL FOR MAP NO. 39												
2017CPT.08.19.20762	Randolph	40	SR 1936 (ADAMS FARM RD)	FROM BEG PVT TO SR 1987 (OLD US 220 BUS)	2	2WU	0.648	20	7,630.00		4,190	
TOTAL FOR MAP NO. 40												
2017CPT.08.19.20762	Randolph	41	SR 2073 (WALKER MILL RD)	FROM SR 1009 (PREV US 311) TO SR 1990 (COMMON WEALTH RD)	2	2WU	1.195	19	13,360.00		7,330	
TOTAL FOR MAP NO. 41												
2017CPT.08.19.20762	Randolph	42	SR 2217 (RANDOLPH TABERNACLE RD)	FROM SR 2183 (GOLD HILL RD) TO SR 2215 (HENLEY COUNTRY RD)	2	2WU	1.017	20	12,000.00		6,570	
TOTAL FOR MAP NO. 42												
2017CPT.08.19.20762	Randolph	43	SR 2409 (TROY SMITH RD)	FROM SR 2504 (MACEDONIA LOOP RD) TO SR 2407 (STARMOUNT RD)	2	2WU	2.105	20	24,750.00		13,590	
TOTAL FOR MAP NO. 43												
2017CPT.08.19.20762	Randolph	44	SR 2437 (BUMPASS RD)	FROM SR 2438 (WILLARD RD) TO SR 2459 (SANDY CREEK CH RD)	2	2WU	1.375	20	16,180.00		8,890	
TOTAL FOR MAP NO. 44												
2017CPT.08.19.20762	Randolph	45	SR 2483 (THORNBROOK RD)	FROM NC 49 TO CUL-DE-SAC	2	2WU	0.09	18	970.00		530	
TOTAL FOR MAP NO. 45												
2017CPT.08.19.20762	Randolph	46	SR 2553 (CC SQUARE RD)	FROM SR 2483 (THORNBROOK RD) TO CUL-DE-SAC	2	2WU	0.1	20	1,100.00		590	
TOTAL FOR MAP NO. 46												
2017CPT.08.19.20762	Randolph	47	SR 2603 (GLENN COUNTRY RD)	FROM NC 42 TO END MAINT	2	2WU	0.599	20	7,070.00		3,870	
TOTAL FOR MAP NO. 47												
2017CPT.08.19.20762	Randolph	48	SR 2609 (IRON MOUNTAIN VIEW RD)	FROM SR 2610 (CHANEY RD) TO DEAD END	2	2WU	1.032	20	12,140.00		6,670	
TOTAL FOR MAP NO. 48												
2017CPT.08.19.20762	Randolph	49	SR 2613 (YOUNG RD)	FROM SR 2614 (GRANTVILLE LN) TO SR 1003 (PLEASANT RIDGE RD)	2	2WU	1.451	20	17,060.00		9,370	
TOTAL FOR MAP NO. 49												
2017CPT.08.19.20762	Randolph	50	SR 2667 (SPOONS CHAPEL CH RD)	FROM SR 2606 (SPOONS CHAPEL RD) TO DEAD END	2	2WU	0.178	20	2,100.00		1,150	
TOTAL FOR MAP NO. 50												

PROJECT NO.	SHEET NO.	TOTAL NO.
2017CPT.08.19.20762	11	

SUMMARY OF QUANTITIES

PROJECT NO	COUNTY	MAP NO	ROUTE	DESCRIPTION	LANES	LANE TYPE	LENGTH		ASPHALT SURFACE TREATMENT, DOUBLE SEAL SY	ASPHALT SURFACE TREATMENT, FOG SEAL SY	EMULSION FOR ASPHALT SURFACE TREATMENT GAL	BLOTTING SAND TON
							MI	FT				
2017CPT.08.19.20762	Randolph	51	SR 2737 (PARKWOOD RD)	FROM NC 22 TO END PVMT	2	2WU	0.088	20	1,070.00	1,070.00	570	
TOTAL FOR MAP NO. 51							0.088		1,070.00	1,070.00	570	
2017CPT.08.19.20762	Randolph	52	SR 2876 (PLEASANT GROVE RD)	FROM SR 2885 (CARL BRADY RD) TO NC 42	2	2WU	0.535	20	6,300.00		3,460	
TOTAL FOR MAP NO. 52							0.535		6,300.00		3,460	
2017CPT.08.19.20762	Randolph	53	SR 2905 (LEACH MEADOW RD)	FROM SR 2903 (OSBORN MILL RD) TO SR 2909 (WOODFERN RD)	2	2WU	0.79	20	9,300.00		5,100	
TOTAL FOR MAP NO. 53							0.79		9,300.00		5,100	
2017CPT.08.19.20762	Randolph	54	SR 1400 (HIGES GROVE RD)	FROM DAVIDSN CO TO SR 1401 (KENNEDY FARM RD)	2	2WU	1.115	20	13,100.00		7,200	
TOTAL FOR MAP NO. 54							1.115		13,100.00		7,200	
2017CPT.08.19.20762	Randolph	55	SR 1915 (HUFF RD)	FROM SR 1912 (ALDRIDGE RD) TO SR 1916 (WEANT ST)	2	2WU	1.1	19	12,290.00	12,290.00	6,750	
TOTAL FOR MAP NO. 55							1.1		12,290.00	12,290.00	6,750	
2017CPT.08.19.20762	Randolph	56	SR 1988 (HOLDER INMAN RD)	FROM US 220 BUS TO US 220 BUS	2	2WU	0.817	20	9,600.00		5,280	
TOTAL FOR MAP NO. 56							0.817		9,600.00		5,280	
2017CPT.08.19.20762	Randolph	57	SR 2012 (WOODOAK TRL)	FROM SR 1939 (OLD WALKER MILL RD) TO END MAINT (AT THE FIRST BIG CURVE TO THE NORTH)	2	2WU	0.319	18	3,390.00	3,390.00	1,860	
TOTAL FOR MAP NO. 57							0.319		3,390.00	3,390.00	1,860	
2017CPT.08.19.20762	Randolph	58	SR 2074 (JESSE SMALL RD)	FROM DEAD END TO SR 1939 (OLD WALKER MILL RD)	2	2WU	0.54	20	6,390.00		3,490	
TOTAL FOR MAP NO. 58							0.54		6,390.00		3,490	
2017CPT.08.19.20762	Randolph	59	SR 2109 (HUNTING LODGE RD)	FROM SR 2108 (WAYNE WHITE RD) TO SR 2112 (BETHEL CH RD)	2	2WU	0.691	20	8,140.00		4,470	
TOTAL FOR MAP NO. 59							0.691		8,140.00		4,470	
2017CPT.08.19.20762	Randolph	60	SR 3103 (TONY DR)	FROM SR 1656 (ELMWOOD ST) TO SR 3104 (JAMES AVE)	2	2WU	0.16	18	1,700.00	1,700.00	930	
TOTAL FOR MAP NO. 60							0.16		1,700.00	1,700.00	930	
2017CPT.08.19.20762	Randolph	61	SR 3245 (ABIGAIL DR)	FROM SR 1553 (OLD MOUNTAIN RD) TO CUL-DE-SAC	2	2WU	0.369	20	4,360.00	4,360.00	2,390	
TOTAL FOR MAP NO. 61							0.369		4,360.00	4,360.00	2,390	
2017CPT.08.19.20762	Randolph	62	SR 3246 (LEAH JUSTINE DR)	FROM SR 3245 (ABIGAIL DR) TO SR 3248 (JENNIFER LYNN DR)	2	2WU	0.173	20	2,060.00	2,060.00	1,120	
TOTAL FOR MAP NO. 62							0.173		2,060.00	2,060.00	1,120	
2017CPT.08.19.20762	Randolph	63	SR 3247 (LEAH JUSTINE DR)	FROM SR 1553 (OLD MOUNTAIN RD) TO SR 3245 (ABIGAIL DR)	2	2WU	0.356	20	4,200.00	4,200.00	2,300	
TOTAL FOR MAP NO. 63							0.356		4,200.00	4,200.00	2,300	
2017CPT.08.19.20762	Randolph	64	SR 3248 (JENNIFER LYNN DR)	FROM CUL-DE-SACT O CUL-DE-SAC	2	2WU	0.24	20	2,850.00	2,850.00	1,550	
TOTAL FOR MAP NO. 64							0.24		2,850.00	2,850.00	1,550	
2017CPT.08.19.20762	Randolph	65	SR 3253 (COURTLAND DR)	FROM SR 1547 (FULLER MILL RD N) TO END MAINT - 320FT W OF COURTLAND CIR (PRIVATE)	2	2WU	0.358	20	4,230.00	4,230.00	2,320	
TOTAL FOR MAP NO. 65							0.358		4,230.00	4,230.00	2,320	
2017CPT.08.19.20762	Randolph	66	SR 1118 (BETHEL LUCAS RD)	FROM SR 1119 (LITTLE RIVER RD) TO SR 1121 (NEW HOPE CH RD)	2	2WU	0.355	20	4,190.00		2,300	
TOTAL FOR MAP NO. 66							0.355		4,190.00		2,300	
2017CPT.08.19.20762	Randolph	67	SR 1163 (SCIENCE HILL RD)	FROM NC 49 TO SR 1107 (LASSITER MILL RD)	2	2WU	0.297	20	3,500.00		1,920	
TOTAL FOR MAP NO. 67							0.297		3,500.00		1,920	
2017CPT.08.19.20762	Randolph	68	SR 1221 (CARDINAL ST)	FROM SR 1150 (MCDOWELL RD) TO DEAD END	2	2WU	0.133	20	1,590.00	1,590.00	860	
TOTAL FOR MAP NO. 68							0.133		1,590.00	1,590.00	860	
2017CPT.08.19.20762	Randolph	69	SR 1242 (BONITA SR)	FROM SR 1214 (BRILES DR) TO DEAD END	2	2WU	0.179	20	2,130.00	2,130.00	1,160	
TOTAL FOR MAP NO. 69							0.179		2,130.00	2,130.00	1,160	
2017CPT.08.19.20762	Randolph	70	SR 1249 (MURIEL LN)	FROM SR1214 (BRILES DR) TO DEAD END	2	2WU	0.205	20	2,430.00	2,430.00	1,330	
TOTAL FOR MAP NO. 70							0.205		2,430.00	2,430.00	1,330	
2017CPT.08.19.20762	Randolph	71	SR 1321 (MOFFITT RD)	FROM SR 1193 (OLD NC 49) TO DEAD END	2	2WU	0.624	20	7,360.00		4,030	
TOTAL FOR MAP NO. 71							0.624		7,360.00		4,030	
2017CPT.08.19.20762	Randolph	72	SR 1326 (STUTTS RD)	FROM SR 1327 (BACK CREEK CH RD) TO BRIDGE	2	2WU	1.113	20	1,390.00		7,190	
TOTAL FOR MAP NO. 72							1.113		1,390.00		7,190	
2017CPT.08.19.20762	Randolph	73	SR 1402 (LITTLE UWHARRIE RD)	FROM DAVIDSN CO TO SR 1401 (KENNEDY FARM RD)	2	2WU	0.945	20	11,100.00		6,100	
TOTAL FOR MAP NO. 73							0.945		11,100.00		6,100	
2017CPT.08.19.20762	Randolph	74	SR 1407 (HARRIS RD)	FROM SR 1406 (COVERED BRIDGE RD) TO END PAVEMENT	2	2WU	0.179	18	2,000.00	2,000.00	1,040	
TOTAL FOR MAP NO. 74							0.179		2,000.00	2,000.00	1,040	
2017CPT.08.19.20762	Randolph	75	SR 1422 (POOLE TOWN RD)	FROM SR 1420 (BACK CREEK RD) TO SR 1424 (WESTCHAPEL RD)	2	2WU	1.4	20	16,460.00		9,040	
TOTAL FOR MAP NO. 75							1.4		16,460.00		9,040	
2017CPT.08.19.20762	Randolph	76	SR 1448 (DUNDEE ST)	FROM US 64 TO DEAD END	2	2WU	0.273	16	2,600.00	2,600.00	1,410	
TOTAL FOR MAP NO. 76							0.273		2,600.00	2,600.00	1,410	
2017CPT.08.19.20762	Randolph	77	SR 1455 (N MCCRARY ST)	FROM NCL ASHEBORO TO SR 1462 (PARK DR)	2	2WU	0.452	18	4,800.00	4,800.00	2,630	
TOTAL FOR MAP NO. 77							0.452		4,800.00	4,800.00	2,630	
2017CPT.08.19.20762	Randolph	78	SR 1476 (N PARK DR)	FROM SR 1462 (PARK DR) TO DEAD END	2	2WU	0.109	18	1,180.00	1,180.00	640	
TOTAL FOR MAP NO. 78							0.109		1,180.00	1,180.00	640	
2017CPT.08.19.20762	Randolph	79	SR 1458 (LINCOLN AVE)	FROM SR 1462 (PARK DR) TO SR 1459 (MOUNTAIN RD)	2	2WU	0.564	17	5,660.00	5,660.00	3,100	
TOTAL FOR MAP NO. 79							0.564		5,660.00	5,660.00	3,100	
2017CPT.08.19.20762	Randolph	80	SR 1459 (MOUNTAIN RD)	FROM SR 1004 (LEXINGTON RD) TO SR 1458 (LINCOLN AVE)	2	2WU	0.134	19	1,520.00	1,520.00	830	
TOTAL FOR MAP NO. 80							0.134		1,520.00	1,520.00	830	
2017CPT.08.19.20762	Randolph	81	SR 1485 (HAMPTON RD)	FROM PVT. JT W OF US 220 BUS TO DEAD END	2	2WU	0.249	18	2,660.00	2,660.00	1,450	
TOTAL FOR MAP NO. 81							0.249		2,660.00	2,660.00	1,450	
2017CPT.08.19.20762	Randolph	82	SR 1517 (DAVIDSON RD)	FROM SR 1504 (SPERO RD) TO SR 3196 (NORTHMONT DR)	2	2WU	0.129	18	1,390.00	1,390.00	750	
TOTAL FOR MAP NO. 82							0.129		1,390.00	1,390.00	750	
2017CPT.08.19.20762	Randolph	83	SR 1554 (WRIGHT RD)	FROM SR 1547 (FULLER MILL RD) TO DEAD END	2	2WU	1.213	21	15,000.00	15,000.00	8,220	
TOTAL FOR MAP NO. 83							1.213		15,000.00	15,000.00	8,220	
2017CPT.08.19.20762	Randolph	84	SR 1561 (ELLEN AVE/REDDICK DR)	FROM SR 1558 (TURNPIKE RD) TO DEAD END	2	2WU	0.141	18	1,500.00	1,500.00	820	
TOTAL FOR MAP NO. 84							0.141		1,500.00	1,500.00	820	
2017CPT.08.19.20762	Randolph	85	SR 1585 (HILLCREST LN)	FROM NC 62 TO END MAINT	2	2WU	0.156	24	2,220.00	2,220.00	1,220	
TOTAL FOR MAP NO. 85							0.156		2,220.00	2,220.00	1,220	
2017CPT.08.19.20762	Randolph	86	SR 1606 (TRINITY BLVD)	FROM SR 1564 (MEADOWBROOK DR) TO SR 1702 (TRINITY BLVD)	2	2WU	0.19	18	2,030.00	2,030.00	1,110	
TOTAL FOR MAP NO. 86							0.19		2,030.00	2,030.00	1,110	
2017CPT.08.19.20762	Randolph	87	SR 1702 (TRINITY BLVD)	FROM SR 1606 (TRINITY BLVD) TO SR 1703 (TRINITY BLVD)	2	2WU	0.12	18	1,300.00	1,300.00	700	
TOTAL FOR MAP NO. 87							0.12		1,300.00	1,300.00	700	
2017CPT.08.19.20762	Randolph	88	SR 2952 (HAYES RD)	FROM SR 2819 (HAWTHORNE DR) TO SR 29+51 (KIMBERLY DR)	2	2WU	0.19	18	2,020.00	2,020.00	1,111	
TOTAL FOR MAP NO. 88							0.19		2,020.00	2,020.00	1,111	
2017CPT.08.19.20762	Randolph	89	SR 1613 (CIRCLE DR)	FROM SR 1612 (UWHARRIE RD) TO SR 1612 (LOOPS AROUND)	2	2WU	0.505	18	5,370.00	5,370.00	2,940	
TOTAL FOR MAP NO. 89							0.505		5,370.00	5,370.00	2,940	
2017CPT.08.19.20762	Randolph	90	SR 1620 (THOMPSON RD)	FROM SR 1619 (PROSPECT ST) TO DEAD END	2	2WU	0.22	16	1,720.00	1,720.00	1,140	
TOTAL FOR MAP NO. 90							0.22		1,720.00	1,720.00	1,140	
2017CPT.08.19.20762	Randolph	91	SR 1666 (MOUNTAIN RD)	FROM SR 1462 (PARK DR) TO SR 1460 (CLEVELAND ST)	2	2WU	0.17	17	2,250.00	2,250.00	940	
TOTAL FOR MAP NO. 91							0.17		2,250.00	2,250.00	940	
2017CPT.08.19.20762	Randolph	92	SR 1683 (OAK KNOLL DR)	FROM SR 1596 (SEALY DR) TO DEAD END	2	2WU	0.2	19	3,240.00	3,240.00	1,230	
TOTAL FOR MAP NO. 92							0.2		3,240.00	3,240.00	1,230	
2017CPT.08.19.20762	Randolph	93	SR 1737 (JOAN DR)	FROM SR 1595 (SURRETT DR) TO DEAD END	2	2WU	0.304	18	2,570.00	2,570.00	1,770	
TOTAL FOR MAP NO. 93							0.304		2,570.00	2,570.00	1,770	
2017CPT.08.19.20762	Randolph	94	SR 1757 (ELMONT ST)	FROM SR 1697 (GLENVIEW DR) TO SR 1756 (ENFIELD DR)	2	2WU	0.24	18	780.00	780.00	1,400	
TOTAL FOR MAP NO. 94							0.24		780.00	780.00	1,400	
2017CPT.08.19.20762	Randolph	95	SR 1762 (DAWNWOOD DR)	FROM SR 1767 (LOWERYWOOD CIR) TO SR 1765 (HEATHWOOD DR)	2	2WU	0.071	10	780.00	780.00	420	
TOTAL FOR MAP NO. 95							0.071		780.00	780.00		

PROJECT NO.	SHEET NO.	TOTAL NO.
2017CPT.08.19.20762	12	

SUMMARY OF QUANTITIES

PROJECT NO	COUNTY	MAP NO	ROUTE	DESCRIPTION	LANES	LANE TYPE	LENGTH MI	WIDTH FT	ASPHALT SURFACE TREATMENT, DOUBLE SEAL SY	ASPHALT SURFACE TREATMENT, FOG SEAL SY	EMULSION FOR ASPHALT SURFACE TREATMENT GAL	BLOTTING SAND TON
2017CPT.08.19.20762	Randolph	101	SR 1808 (FERNWOOD DR)	FROM SR 1738 (DRIFTWOOD DR) TO DEAD END	2	2WU	0.065	18	710.00	710.00	380	
TOTAL FOR MAP NO. 101												
2017CPT.08.19.20762	Randolph	102	SR 1809 (KREAMER DR)	FROM SR 1738 (DRIFTWOOD DR) TP 1810 (ARNETTE DR)	2	2WU	0.196	18	2,100.00	2,100.00	1,140	
TOTAL FOR MAP NO. 102												
2017CPT.08.19.20762	Randolph	103	1810 (ARNETTE DR)	FROM SR 1809 (KREAMER DR) TO DONNA VIEW DR (PRIVATE)	2	2WU	0.295	18	3,150.00	3,150.00	1,720	
TOTAL FOR MAP NO. 103												
2017CPT.08.19.20762	Randolph	104	SR 1811 (CRESTWOOD DR)	FROM SR 1814 (PHEASANT RIDGE RD) TO END MAINT	2	2WU	0.32	18	3,410.00	3,410.00	1,870	
TOTAL FOR MAP NO. 104												
2017CPT.08.19.20762	Randolph	105	SR 1816 (LOBLOLLY DR)	FROM SR 1814 (PHEASANT RIDGE RD) TO END MAINT	2	2WU	0.32	18	3,400.00	3,400.00	1,860	
TOTAL FOR MAP NO. 105												
2017CPT.08.19.20762	Randolph	106	SR 1824 (OAKWOOD DR)	FROM SR 1565 (RONNIEDALE RD) TO SR 1825 (NOLA ST)	2	2WU	0.204	18	2,200.00	2,200.00	1,190	
TOTAL FOR MAP NO. 106												
2017CPT.08.19.20762	Randolph	107	SR 1825 (NOLA ST)	FROM SR 1824 (OAKWOOD DR) TO SR 1826 (NOLA ST EXT)	2	2WU	0.075	18	820.00	820.00	440	
TOTAL FOR MAP NO. 107												
2017CPT.08.19.20762	Randolph	108	SR 1881 (OLD MEADOWBROOK RD)	FROM NC 62 TO DEAD END	2	2WU	0.16	18	1,710.00	1,710.00	930	
TOTAL FOR MAP NO. 108												
2017CPT.08.19.20762	Randolph	109	SR 1888 (BROKAW DR)	FROM SR 1564 (MEADOWBROOK DR) TO DEAD END	2	2WU	0.24	18	2,570.00	2,570.00	1,400	
TOTAL FOR MAP NO. 109												
2017CPT.08.19.20762	Randolph	110	SR 1889 (W RIVER RUN)	FROM SR 1004 (OLD LEXINGTON RD) TO CUL-DE-SAC	2	2WU	0.47	18	5,000.00	5,000.00	2,730	
TOTAL FOR MAP NO. 110												
2017CPT.08.19.20762	Randolph	111	SR 1890 (E RIVER RUN)	FROM SR 1889 (W RIVER RUN) TO CUL-DE-SAC	2	2WU	0.14	18	1,500.00	1,500.00	820	
TOTAL FOR MAP NO. 111												
2017CPT.08.19.20762	Randolph	112	SR 1897 (ALAMO DR)	FROM SR 3106 (KENNEDY DR) TO DEAD END	2	2WU	0.384	18	4,100.00	4,100.00	2,240	
TOTAL FOR MAP NO. 112												
2017CPT.08.19.20762	Randolph	113	SR 1898 (ALAMO CT)	FROM SR 1897 (ALAMO DR) TO DEAN END	2	2WU	0.051	18	570.00	570.00	300	
TOTAL FOR MAP NO. 113												
2017CPT.08.19.20762	Randolph	114	SR 1936 (ADAMS FARM DR)	FROM SR 1987 (US 220 BUS) TO CUL-DE-SAC	2	2WU	3.3	22	44,570.00	44,570.00	24,500	
TOTAL FOR MAP NO. 114												
2017CPT.08.19.20762	Randolph	115	SR 1965 (ST PETER CH RD)	FROM SR 1969 (PRICE NOBLE RD) TO SR 2074 (JESSE SMALL RD)	2	2WU	1.183	20	13,910.00		7,640	
TOTAL FOR MAP NO. 115												
2017CPT.08.19.20762	Randolph	116	SR 1985 (COLONIAL LOOP RD)	FROM SR 1937 (ROCKETT RD) TO DEAD END	2	2WU	0.302	20	3,570.00	3,570.00	1,950	
TOTAL FOR MAP NO. 116												
2017CPT.08.19.20762	Randolph	117	SR 1986 (COLONIAL LN)	FROM SR 1937 (ROCKETT RD) TO SR 1985 (COLONIAL LOOP RD)	2	2WU	0.082	20	990.00	990.00	530	
TOTAL FOR MAP NO. 117												
2017CPT.08.19.20762	Randolph	118	SR 1991 (HUNTERS RIDGE RD)	FROM SR 1951 (ISLAND FORD RD) TO DEAD END	2	2WU	0.291	18	4,000.00		1,700	
TOTAL FOR MAP NO. 118												
2017CPT.08.19.20762	Randolph	119	SR 2005 (CEDAR LN)	FROM SR 2004 (PINWOOD DR) TO SR 2006 (HICKORY WOOD LN)	2	2WU	0.441	18	4,700.00	4,700.00	2,570	
TOTAL FOR MAP NO. 119												
2017CPT.08.19.20762	Randolph	120	SR 2006 (HICKORY WOOD LN)	FROM SR 2005 (CEDAR LN) TO SR 1926 (DAVIS COUNTRY RD)	2	2WU	0.084	18	910.00	910.00	490	
TOTAL FOR MAP NO. 120												
2017CPT.08.19.20762	Randolph	121	SR 2031 (BEECH TREE CT)	FROM SR 1941 (WALL BROS. RD) TO CUL-DE-SAC	2	2WU	0.277	20	3,280.00	3,280.00	1,790	
TOTAL FOR MAP NO. 121												
2017CPT.08.19.20762	Randolph	122	SR 2213 (CRESCENT DR - LOOPS AROUND)	FROM US 64 TO US 64	2	2WU	0.559	20	6,600.00	6,600.00	3,610	
TOTAL FOR MAP NO. 122												
2017CPT.08.19.20762	Randolph	123	SR 2214 (NORTHVIEW DR)	FROM SR 2213 (CRESCENT DR - LOOPS AROUND) TO DEAD END	2	2WU	0.235	20	2,790.00	2,790.00	1,520	
TOTAL FOR MAP NO. 123												
2017CPT.08.19.20762	Randolph	124	SR 2246 (BROOKWOOD DR)	FROM SR2184 (MEADOWBROOK RD) TO DEAD END	2	2WU	0.116	20	1,390.00	1,390.00	750	
TOTAL FOR MAP NO. 124												
2017CPT.08.19.20762	Randolph	125	SR 2247 (KEYSTONE DR)	FROM SR 2246 (BROOKWOOD DR) TO SR 2250 (FERN DR)	2	2WU	0.245	20	2,900.00	2,900.00	1,590	
TOTAL FOR MAP NO. 125												
2017CPT.08.19.20762	Randolph	126	SR 2250 (FERN DR)	FROM SR 2182 (E ALLRED ST) TO SR2184 (MEADOWBROOK RD)	2	2WU	0.31	18	3,300.00	3,300.00	1,810	
TOTAL FOR MAP NO. 126												
2017CPT.08.19.20762	Randolph	127	SR 2248 (CRAVEN DR)	FROM SR2184 (MEADOWBROOK RD) TO SR 2247 (KEYSTONE DR)	2	2WU	0.143	20	1,700.00	1,700.00	930	
TOTAL FOR MAP NO. 127												
2017CPT.08.19.20762	Randolph	128	SR 2249 (TWIN DR)	FROM DEAD END TO DEAD END	2	2WU	0.077	20	930.00	930.00	500	
TOTAL FOR MAP NO. 128												
2017CPT.08.19.20762	Randolph	129	SR 2272 (HARVEST CIR)	FROM SR 2182 (E ALLRED ST) TO SR 2272 (HARVEST CIR)	2	2WU	0.472	20	5,570.00	5,570.00	3,050	
TOTAL FOR MAP NO. 129												
2017CPT.08.19.20762	Randolph	130	SR 2303 (PATRICIA DR)	FROM SR 2302 (HIDDEN LN) TO SR 2305 (JENNIFER DR)	2	2WU	0.216	18	2,310.00	2,310.00	1,260	
TOTAL FOR MAP NO. 130												
2017CPT.08.19.20762	Randolph	131	SR 2305 (JENNIFER DR)	FROM SR 2304 (SHARON DR) TO SR 2303 (PATRICIA DR)	2	2WU	0.8	18	8,480.00	8,480.00	4,650	
TOTAL FOR MAP NO. 131												
2017CPT.08.19.20762	Randolph	132	SR 2304 (SHARON DR)	FROM SR 2302 (HIDDEN LN) TO SR 2305 (JENNIFER DR)	2	2WU	0.21	18	2,250.00	2,250.00	4,650	
TOTAL FOR MAP NO. 132												
2017CPT.08.19.20762	Randolph	133	SR 2302 (HIDDEN LN)	FROM SR 2102 (BANTAM RD) TO SR 2304 (SHARON DR)	2	2WU	0.11	18	1,190.00	1,190.00	640	
TOTAL FOR MAP NO. 133												
2017CPT.08.19.20762	Randolph	134	SR 2320 (QUAIL HOLLOW DR)	FROM SR 2106 (RACINE RD) TO DEAD END	2	2WU	0.403	20	4,760.00	4,760.00	2,610	
TOTAL FOR MAP NO. 134												
2017CPT.08.19.20762	Randolph	135	SR 2321 (BLUE RIDGE RD)	FROM SR 2106 (RACINE RD) TO SR 2320 (QUAIL HOLLOW DR)	2	2WU	0.15	20	1,790.00	1,790.00	1,000	
TOTAL FOR MAP NO. 135												
2017CPT.08.19.20762	Randolph	136	SR 2324 (WOODLAND TRL)	FROM SR 2228 (PENTECOSTAL CH RD) TO END MAINT	2	2WU	0.214	20	2,540.00	2,540.00	1,390	
TOTAL FOR MAP NO. 136												
2017CPT.08.19.20762	Randolph	137	SR 2338 (RED CROSS CT N)	FROM SR 2116 (NEW SALEM RD) TO DEAD END	2	2WU	0.121	20	1,450.00	1,450.00	790	
TOTAL FOR MAP NO. 137												
2017CPT.08.19.20762	Randolph	138	SR 2339 (NIGHTWOOD DR)	FROM SR 2113 (FRED LINEBERRY RD) TO DEAD END	2	2WU	0.524	20	6,180.00	6,180.00	3,390	
TOTAL FOR MAP NO. 138												
2017CPT.08.19.20762	Randolph	139	SR 2340 (CREEKSIDE DR)	FROM SR 2106 (RACINE RD) TO DEAD END	2	2WU	0.26	20	3,080.00	3,080.00	1,680	
TOTAL FOR MAP NO. 139												
2017CPT.08.19.20762	Randolph	140	SR 2353 (MEADOWLARK CT)	FROM SR 2106 (RACINE RD) TO DEAD END	2	2WU	0.165	20	1,970.00	1,970.00	1,070	
TOTAL FOR MAP NO. 140												
2017CPT.08.19.20762	Randolph	141	SR 2354 (ROBIN LN)	FROM SR 2106 (RACINE RD) TO DEAD END	2	2WU	0.263	20	3,110.00	3,110.00	1,700	
TOTAL FOR MAP NO. 141												
2017CPT.08.19.20762	Randolph	142	SR 2368 (BRIAR OAK DR)	FROM SR 2108 (WAYNE WHITE RD) TO DEAD END	2	2WU	0.32	20	3,780.00	3,780.00	2,070	
TOTAL FOR MAP NO. 142												
2017CPT.08.19.20762	Randolph	143	SR 2378 (WOODSTREAM DR)	FROM SR 2114 (PROVIDENCE CH RD) TO DEAD END	2	2WU	0.48	20	5,670.00	5,670.00	3,100	
TOTAL FOR MAP NO. 143												
2017CPT.08.19.20762	Randolph	144	SR 2386 (RIVEROAKS DR)	FROM SR 2116 (NEW SALEM RD) TO DEAD END	2	2WU	0.528	20	6,230.00	6,230.00	3,410	
TOTAL FOR MAP NO. 144												
2017CPT.08.19.20762	Randolph	145	SR 2479 (FERGUSON RD)	FROM SR 2442 (RAMSEUR JULIAN RD) TO SR 2481 (LOW BRIDGE RD)	2	2WU	0.953	19	10,660.00		5,850	
TOTAL FOR MAP NO. 145												
2017CPT.08.19.20762	Randolph	146	SR 2479 (FERGUSON RD)	FROM SR 2481 (LOW BRIDGE RD) TO NC 49	2	2WU	1.606	19	17,930.00		9,850	
TOTAL FOR MAP NO. 146												
TOTAL FOR PROJ NO. 2017CPT.08.19.20762												
GRAND TOTAL							70.171		795810	387860	445905	1

PROJECT NO.	SHEET NO.	TOTAL NO.
2017CPT.08.19.20762	13	

THERMOPLASTIC AND PAINT QUANTITIES

PROJECT NO	COUNTY	MAP NO	ROUTE	DESCRIPTION	LANES	LANE TYPE	LENGTH	WIDTH	441300000-E	445700000-N	470500000-E	471000000-E	472100000-E	472500000-E	481000000-E		
									WORK ZONE ADVANCE/GENERAL WARNING SIGNING SF	TEMPORARY TRAFFIC CONTROL	16" X 120 M WHITE THERMO	24" X 120 M WHITE THERMO	THERMO RXR 120 M	THERMO LT ARROW M	THERMO RT ARROW M	4" WHITE PAINT	4" YELLOW PAINT
									LS		LF	LF	EA	EA	EA	LF	LF
2017CPT.08.19.20762	Randolph	1	SR 1327 (BACK CREEK CH RD)	FROM US 64 TO SR 1326 STUTTS RD	2	2WU	0.704	20	90							15,150	15,150
TOTAL FOR MAP NO. 1																	
2017CPT.08.19.20762	Randolph	2	SR 2810 (BROOK DR)	FROM SR 2915 (RIDGE ST) TO SR 2919 (ELDORADO RD)	2	2WU	0.616	18	80								
TOTAL FOR MAP NO. 2																	
2017CPT.08.19.20762	Randolph	3	SR 2815 (MC DERMONT ST)	FROM SR 2819 (HAWTHORNE DR) TO END OF MAINTENANCE	2	2WU	0.155	16	100								
TOTAL FOR MAP NO. 3																	
2017CPT.08.19.20762	Randolph	4	SR 2818 (HOWARD AVE)	FROM SR 2913 (AUMAN AVE) TO SR 2819 (HAWTHORNE DR)	2	2WU	0.34	17	45								
TOTAL FOR MAP NO. 4																	
2017CPT.08.19.20762	Randolph	5	SR 2979 (HORSE MOUNTAIN RD)	FROM SR 2826 (BROWERS CHAPEL RD) TO DEAD END	2	2WU	0.23	20	35								
TOTAL FOR MAP NO. 5																	
2017CPT.08.19.20762	Randolph	6	SR 3105 (BRAD RD)	FROM SR 1527 (MARLBORO CHURCH RD) TO CUL-DE-SAC	2	2WU	0.097	19	20								
TOTAL FOR MAP NO. 6																	
2017CPT.08.19.20762	Randolph	7	SR 2429 (KIRKMAN STREET EXT.)	FROM SR 2434 (TROY ESTATE RD) TO SR 2433 S (ALLISON ST)	2	2WU	0.42	18	55							9,038	9,038
TOTAL FOR MAP NO. 7																	
2017CPT.08.19.20762	Randolph	8	SR 3177 (MEADOW ACRES LN)	FROM SR 1523 (MARSH MOUNTAIN RD) TO SR 3178 (FOREST TRL)	2	2WU	0.24	18	35								
TOTAL FOR MAP NO. 8																	
2017CPT.08.19.20762	Randolph	9	SR 3178 (FORREST TRL)	FROM SR 3183 (GREEN GLADE RD) TO DEAD END	2	2WU	0.331	18	50								
TOTAL FOR MAP NO. 9																	
2017CPT.08.19.20762	Randolph	10	SR 3183 (GREEN GLADE RD)	FROM SR 1523 (MARSH MOUNTAIN RD) TO SR 3178 (FOREST TRL)	2	2WU	0.257	18	40								
TOTAL FOR MAP NO. 10																	
2017CPT.08.19.20762	Randolph	11	SR 3211 (PINE NEEDLES DR)	FROM SR 3101 (WESTLAKE RD) TO CUL-DE-SAC	2	2WU	0.112	18	25								
TOTAL FOR MAP NO. 11																	
2017CPT.08.19.20762	Randolph	12	SR 3257 (HUCKLEBERRY LN)	FROM SR 3256 (WILDWOOD RD) TO CUL-DE-SAC	2	2WU	0.271	18	40								
TOTAL FOR MAP NO. 12																	
2017CPT.08.19.20762	Randolph	13	SR 3258 (HUNTINGTON DR)	FROM SR 1408 (HOOVER HILL RD) TO CUL-DE-SAC	2	2WU	0.249	18	40								
TOTAL FOR MAP NO. 13																	
2017CPT.08.19.20762	Randolph	14	SR 1179 (LOU GRANFORD RD)	FROM SR 1181 (NEW HOPE RD) TO SR 1143 (HIGH PINE CH RD)	2	2WU	2.97	18	360							63,914	63,914
TOTAL FOR MAP NO. 14																	
2017CPT.08.19.20762	Randolph	15	SR 1640 (RIDGE DR)	FROM SR 1564 (MEADOWBROOK DR) TO END MAINTENANCE AT YOUNTS VIEW DR (PRIVATE)	2	2WU	0.389	18	55								
TOTAL FOR MAP NO. 15																	
2017CPT.08.19.20762	Randolph	16	SR 1704 (PEACE RD)	FROM SR 1567 (ROBBINS COUNTRY RD) TO CUL-DE-SAC	2	2WU	0.85	18	105							18,292	18,292
TOTAL FOR MAP NO. 16																	
2017CPT.08.19.20762	Randolph	17	SR 1725 (PINE RIDGE DR)	FROM SR 1004 (ARCHDALE RD) TO SR 1726 (WINDEMERE CIR)	2	2WU	0.358	18	50								
TOTAL FOR MAP NO. 17																	
2017CPT.08.19.20762	Randolph	18	SR 1726 (WINDERMERE DR)	FROM SR 1727 (ARBOR DR) TO SR 1727 (ARBOR DR - CIRCLES AROUND)	2	2WU	0.593	18	80								
TOTAL FOR MAP NO. 18																	
2017CPT.08.19.20762	Randolph	19	SR 1727 (ARBOR DR)	FROM SR 1726 (WINDERMERE DR) TO SR 1726 (WINDERMERE DR - CONNECTS THE ARC)	2	2WU	0.23	18	35								
TOTAL FOR MAP NO. 19																	
2017CPT.08.19.20762	Randolph	20	SR 1827 (MEYERS ST)	FROM SR 1558 (TURNPIKE RD) TO DEAD END	2	2WU	0.164	20	35								
TOTAL FOR MAP NO. 20																	
2017CPT.08.19.20762	Randolph	21	SR 2690 (LOE FALL AVE)	FROM SR 2714 (CLEON ST) TO SR 2682 (RILLA ST)	2	2WU	0.1	18	12								
TOTAL FOR MAP NO. 21																	
2017CPT.08.19.20762	Randolph	22	SR 2682 (RILLA ST)	FROM SR 2690 (LOE FALL AVE) TO SR 2607 (BUFFALO FORD RD)	2	2WU	0.303	18	50								
TOTAL FOR MAP NO. 22																	
2017CPT.08.19.20762	Randolph	23	SR 2714 (CLEON ST)	FROM SR 2607 (BUFFALO FORD RD) TO SR 2690 (LOE FALL AVE)	2	2WU	0.31	18	45								
TOTAL FOR MAP NO. 23																	
2017CPT.08.19.20762	Randolph	24	SR 2950 (CLEARVIEW DR)	FROM SR 2948 (LINDALE DR) TO DEAD END	2	2WU	0.339	18	45								
TOTAL FOR MAP NO. 24																	
2017CPT.08.19.20762	Randolph	25	SR 2991 (RIVER HEIGHTS DR)	FROM NC 22 TO DEAD END	2	2WU	0.213	18	40								
TOTAL FOR MAP NO. 25																	
2017CPT.08.19.20762	Randolph	26	SR 3184 (PARINNA DR)	FROM SR 1407 (HARRIS RD) TO DEAD END	2	2WU	0.696	18	90								
TOTAL FOR MAP NO. 26																	
2017CPT.08.19.20762	Randolph	27	SR 3194 (FARLOW ST)	FROM SR 1558 (TURNPIKE RD) TO DEAD END	2	2WU	0.258	22	35								
TOTAL FOR MAP NO. 27																	
2017CPT.08.19.20762	Randolph	28	SR 3274 (STONESIDE CT)	FROM SR 3273 (STONEHENGE RD) TO DEAD END	2	2WU	0.257	20	40								
TOTAL FOR MAP NO. 28																	
2017CPT.08.19.20762	Randolph	29	SR 3275 (STONEHENGE PL)	FROM SR 3273 (STONEHENGE RD) TO CUL-DE-SAC	2	2WU	0.145	20	25								
TOTAL FOR MAP NO. 29																	
2017CPT.08.19.20762	Randolph	30	SR 1110 (RANDALL HURLEY RD)	FROM MONTG CO TO SR 1111 (MT LEBANON RD)	2	2WU	1.503	18	190							32,345	32,345
TOTAL FOR MAP NO. 30																	
2017CPT.08.19.20762	Randolph	31	SR 1127 (BURNEY RD)	FROM SR 1121 (NEW HOPE CH RD) TO NC 134	2	2WU	0.581	18	75							12,503	12,503
TOTAL FOR MAP NO. 31																	
2017CPT.08.19.20762	Randolph	32	SR 1168 (BINGHAM LOFLIN RD)	FROM SR 1170 (MECHANIC RD) TO DEAD END	2	2WU	0.946	20	125								
TOTAL FOR MAP NO. 32																	
2017CPT.08.19.20762	Randolph	33	SR 1169 (TROTTER RD)	FROM NC 49 TO END PVMT	2	2WU	0.206	18	35								
TOTAL FOR MAP NO. 33																	
2017CPT.08.19.20762	Randolph	34	SR 1304 (SALEM CH RD)	FROM NC 49 TO SR 1303 (BRANTLEY GORDON RD)	2	2WU	1.871	20	220							40,264	40,264
TOTAL FOR MAP NO. 34																	
2017CPT.08.19.20762	Randolph	35	SR 1328 (SAWYERSVILLE RD)	FROM US 64 TO SR 1318 (MOORE RD)	2	2WU	1.72	18	200							37,014	37,014
TOTAL FOR MAP NO. 35																	
2017CPT.08.19.20762	Randolph	36	SR 1505 (CARL DR)	FROM SR 1504 (W CENTRAL AVE) TO END BST.	2	2WU	0.737	22	90							15,860	15,860
TOTAL FOR MAP NO. 36																	
2017CPT.08.19.20762	Randolph	37	SR 1630 (WESLEYAN RD)	FROM SR 2270 US 311 EXT TO PVT. JT. OF RR@ US 220 BUS	2	2WU	0.53	20	70							11,406	11,406
TOTAL FOR MAP NO. 37																	
2017CPT.08.19.20762	Randolph	38	SR 1679 (SUNSET VIEW DR)	FROM SR 1612 (UWHARRIE RD) TO END MAINT	2	2WU	0.33	17	45								
TOTAL FOR MAP NO. 38																	
2017CPT.08.19.20762	Randolph	39	SR 1686 (MT SHEPHERD RD EXT.)	FROM SR 1410 (MT. SHEPHERD RD) TO DEAD END	2	2WU	1.16	20	140							24,963	24,963
TOTAL FOR MAP NO. 39																	
2017CPT.08.19.20762	Randolph	40	SR 1936 (ADAMS FARM RD)	FROM BEG PVMT TO SR 1987 (OLD US 220 BUS)	2	2WU	0.648	20	80							13,945	13,945
TOTAL FOR MAP NO. 40																	
2017CPT.08.19.20762	Randolph	41	SR 2073 (WALKER MILL RD)	FROM SR 1009 (PREV US 311) TO SR 1990 (COMMON WEALTH RD)	2	2WU	1.195	19	140							25,716	25,716
TOTAL FOR MAP NO. 41																	
2017CPT.08.19.20762	Randolph	42	SR 2217 (RANDOLPH TABERNACLE RD)	FROM SR 2183 (GOLD HILL RD) TO SR 2215 (HENLEY COUNTRY RD)	2	2WU	1.017	20	130							21,886	21,886
TOTAL FOR MAP NO. 42																	
2017CPT.08.19.20762	Randolph	43	SR 2409 (TROY SMITH RD)	FROM SR 2504 (MACEDONIA LOOP RD) TO SR 2407 (STARMOUNT RD)	2	2WU	2.105	20	250							45,300	45,300
TOTAL FOR MAP NO. 43																	
2017CPT.08.19.20762	Randolph	44	SR 2437 (BUMPASS RD)	FROM SR 2438 (WILLARD RD) TO SR 2459 (SANDY CREEK CH RD)	2	2WU	1.375	20	170							29,590	29,590
TOTAL FOR MAP NO. 44																	
2017CPT.08.19.20762	Randolph	45	SR 2483 (THORNBROOK RD)	FROM NC 49 TO CUL-DE-SAC	2	2WU	0.09	18	20								
TOTAL FOR MAP NO. 45																	
2017CPT.08.19.20762	Randolph	46	SR 2553 (CC SQUARE RD)	FROM SR 2483 (THORNBROOK RD) TO CUL-DE-SAC	2	2WU	0.1	20	20								
TOTAL FOR MAP NO. 46																	
2017CPT.08.19.20762	Randolph	47	SR 2603 (GLENN COUNTRY RD)	FROM NC 42 TO END MAINT	2	2WU	0.599	20	80								
TOTAL FOR MAP NO. 47																	
2017CPT.08.19.20762	Randolph	48	SR 2609 (IRON MOUNTAIN VIEW RD)	FROM SR 2610 (CHANEY RD) TO DEAD END	2	2WU	1.032	20	130							22,209	22,209
TOTAL FOR MAP NO. 48																	
2017CPT.08.19.20762	Randolph	49	SR 2613 (YOUNG RD)	FROM SR 2614 (GRANTVILLE LN) TO SR 1003 (PLEASANT RIDGE RD)	2	2WU	1.451	20	180							31,226	31,226
TOTAL FOR MAP NO. 49																	
2017CPT.08.19.20762	Randolph	50	SR 2667 (SPOONS CHAPEL CH RD)	FROM SR 2606 (SPOONS CHAPEL RD) TO DEAD END	2	2WU	0.178	20	30								
TOTAL FOR MAP NO. 50																	

PROJECT NO.	SHEET NO.	TOTAL NO.
2017CPT.08.19.20762	14	

THERMOPLASTIC AND PAINT QUANTITIES

PROJECT NO	COUNTY	MAP NO	ROUTE	DESCRIPTION	LANES	LANE TYPE	LENGTH	WIDTH	4413000000-E WORK ZONE ADVANCE/GE NERAL WARNING SIGNING SF	4457000000-N TEMPORARY TRAFFIC CONTROL	4705000000-E 16" X 120 M WHITE THERMO	4710000000-E 24" X 120 M WHITE THERMO	4721000000-E THERMO RXR 120 M	4725000000-E THERMO LT ARROW M 90	4725000000-E THERMO RT ARROW M 90	4810000000-E	
																4" WHITE PAINT LF	4" YELLOW PAINT LF
2017CPT.08.19.20762	Randolph	51	SR 2737 (PARKWOOD RD)	FROM NC 22 TO END PVMT	2	2WU	0.088	20	20	LS	LF	LF	EA	EA	EA	LF	LF
TOTAL FOR MAP NO. 51																	
2017CPT.08.19.20762	Randolph	52	SR 2876 (PLEASANT GROVE RD)	FROM SR 2885 (CARL BRADY RD) TO NC 42	2	2WU	0.535	20	70							11,513	11,513
TOTAL FOR MAP NO. 52																11,513	11,513
2017CPT.08.19.20762	Randolph	53	SR 2905 (LEACH MEADOW RD)	FROM SR 2903 (OSBORN MILL RD) TO SR 2909 (WOODFERN RD)	2	2WU	0.79	20	100							17,001	17,001
TOTAL FOR MAP NO. 53																17,001	17,001
2017CPT.08.19.20762	Randolph	54	SR 1400 (HIGHER GROVE RD)	FROM DAVIDSN CO TO SR 1401 (KENNEDY FARM RD)	2	2WU	1.115	20	135							23,995	23,995
TOTAL FOR MAP NO. 54																23,995	23,995
2017CPT.08.19.20762	Randolph	55	SR 1915 (HUFF RD)	FROM SR 1912 (ALDRIDGE RD) TO SR 1916 (WEANT ST)	2	2WU	1.1	19	140							23,672	23,672
TOTAL FOR MAP NO. 55																23,672	23,672
2017CPT.08.19.20762	Randolph	56	SR 1988 (HOLDER INMAN RD)	FROM US 220 BUS TO US 220 BUS	2	2WU	0.817	20	100							17,582	17,582
TOTAL FOR MAP NO. 56																17,582	17,582
2017CPT.08.19.20762	Randolph	57	SR 2012 (WOODOAK TRL)	FROM SR 1939 (OLD WALKER MILL RD) TO END MAINT (AT THE FIRST BIG CURVE TO THE NORTH)	2	2WU	0.319	18	45								
TOTAL FOR MAP NO. 57																	
2017CPT.08.19.20762	Randolph	58	SR 2074 (JESSE SMALL RD)	FROM DEAD END TO SR 1939 (OLD WALKER MILL RD)	2	2WU	0.54	20	70							11,621	11,621
TOTAL FOR MAP NO. 58																11,621	11,621
2017CPT.08.19.20762	Randolph	59	SR 2109 (HUNTING LODGE RD)	FROM SR 2108 (WAYNE WHITE RD) TO SR 2112 (BETHEL CH RD)	2	2WU	0.691	20	90							14,870	14,870
TOTAL FOR MAP NO. 59																14,870	14,870
2017CPT.08.19.20762	Randolph	60	SR 3103 (TONY DR)	FROM SR 1656 (ELMWOOD ST) TO SR 3104 (JAMES AVE)	2	2WU	0.16	18	25								
TOTAL FOR MAP NO. 60																	
2017CPT.08.19.20762	Randolph	61	SR 3245 (ABIGAIL DR)	FROM SR 1553 (OLD MOUNTAIN RD) TO CUL-DE-SAC	2	2WU	0.369	20	50								
TOTAL FOR MAP NO. 61																	
2017CPT.08.19.20762	Randolph	62	SR 3246 (LEAH JUSTINE DR)	FROM SR 3245 (ABIGAIL DR) TO SR 3248 (JENNIFER LYNN DR)	2	2WU	0.173	20	25								
TOTAL FOR MAP NO. 62																	
2017CPT.08.19.20762	Randolph	63	SR 3247 (LEAH JUSTINE DR)	FROM SR 1553 (OLD MOUNTAIN RD) TO SR 3245 (ABIGAIL DR)	2	2WU	0.356	20	45								
TOTAL FOR MAP NO. 63																	
2017CPT.08.19.20762	Randolph	64	SR 3248 (JENNIFER LYNN DR)	FROM CUL-DE-SACT O CUL-DE-SAC	2	2WU	0.24	20	35								
TOTAL FOR MAP NO. 64																	
2017CPT.08.19.20762	Randolph	65	SR 3253 (COURTLAND DR)	FROM SR 1547 (FULLER MILL RD N) TO END MAINT - 320FT W OF COURTLAND CIR (PRIVATE)	2	2WU	0.358	20	50								
TOTAL FOR MAP NO. 65																	
2017CPT.08.19.20762	Randolph	66	SR 1118 (BETHEL LUCAS RD)	FROM SR 1119 (LITTLE RIVER RD) TO SR 1121 (NEW HOPE CH RD)	2	2WU	0.355	20	45							7,640	7,640
TOTAL FOR MAP NO. 66																7,640	7,640
2017CPT.08.19.20762	Randolph	67	SR 1163 (SCIENCE HILL RD)	FROM NC 49 TO SR 1107 (LASSITER MILL RD)	2	2WU	0.297	20	40							6,391	6,391
TOTAL FOR MAP NO. 67																6,391	6,391
2017CPT.08.19.20762	Randolph	68	SR 1221 (CARDINAL ST)	FROM SR 1150 (MCDOWELL RD) TO DEAD END	2	2WU	0.133	20	25								
TOTAL FOR MAP NO. 68																	
2017CPT.08.19.20762	Randolph	69	SR 1242 (BONITA SR)	FROM SR 1214 (BRILES DR) TO DEAD END	2	2WU	0.179	20	30								
TOTAL FOR MAP NO. 69																	
2017CPT.08.19.20762	Randolph	70	SR 1249 (MURIEL LN)	FROM SR1214 (BRILES DR) TO DEAD END	2	2WU	0.205	20	30								
TOTAL FOR MAP NO. 70																	
2017CPT.08.19.20762	Randolph	71	SR 1321 (MOFFITT RD)	FROM SR 1193 (OLD NC 49) TO DEAD END	2	2WU	0.624	20	80							13,428	13,428
TOTAL FOR MAP NO. 71																13,428	13,428
2017CPT.08.19.20762	Randolph	72	SR 1326 (STUTTS RD)	FROM SR 1327 (BACK CREEK CH RD) TO BRIDGE	2	2WU	1.113	20	135							23,952	23,952
TOTAL FOR MAP NO. 72																23,952	23,952
2017CPT.08.19.20762	Randolph	73	SR 1402 (LITTLE UWHARRIE RD)	FROM DAVIDSN CO TO SR 1401 (KENNEDY FARM RD)	2		0.945	20	115							20,336	20,336
TOTAL FOR MAP NO. 73																20,336	20,336
2017CPT.08.19.20762	Randolph	74	SR 1407 (HARRIS RD)	FROM SR 1406 (COVERED BRIDGE RD) TO END PAVEMENT	2	2WU	0.179	18	30								
TOTAL FOR MAP NO. 74																	
2017CPT.08.19.20762	Randolph	75	SR 1422 (POOLE TOWN RD)	FROM SR 1420 (BACK CREEK RD) TO SR 1424 (WESTCHAPEL RD)	2	2WU	1.4	20	170							30,128	30,128
TOTAL FOR MAP NO. 75																30,128	30,128
2017CPT.08.19.20762	Randolph	76	SR 1448 (DUNDEE ST)	FROM US 64 TO DEAD END	2	2WU	0.273	16	40								
TOTAL FOR MAP NO. 76																	
2017CPT.08.19.20762	Randolph	77	SR 1455 (N MCCRARY ST)	FROM NCL ASHEBORO TO SR 1462 (PARK DR)	2	2WU	0.452	18	60								
TOTAL FOR MAP NO. 77																	
2017CPT.08.19.20762	Randolph	78	SR 1476 (N PARK DR)	FROM SR 1462 (PARK DR) TO DEAD END	2	2WU	0.109	18	20								
TOTAL FOR MAP NO. 78																	
2017CPT.08.19.20762	Randolph	79	SR 1458 (LINCOLN AVE)	FROM SR 1462 (PARK DR) TO SR 1459 (MOUNTAIN RD)	2	2WU	0.564	17	75								
TOTAL FOR MAP NO. 79																	
2017CPT.08.19.20762	Randolph	80	SR 1459 (MOUNTAIN RD)	FROM SR 1004 (LEXINGTON RD) TO SR 1458 (LINCOLN AVE)	2	2WU	0.134	19	25								
TOTAL FOR MAP NO. 80																	
2017CPT.08.19.20762	Randolph	81	SR 1485 (HAMPTON RD)	FROM PVT. JT W OF US 220 BUS TO DEAD END	2	2WU	0.249	18	35								
TOTAL FOR MAP NO. 81																	
2017CPT.08.19.20762	Randolph	82	SR 1517 (DAVIDSON RD)	FROM SR 1504 (SPERO RD) TO SR 3196 (NORTHMONT DR)	2	2WU	0.129	18	25							2,776	2,776
TOTAL FOR MAP NO. 82																2,776	2,776
2017CPT.08.19.20762	Randolph	83	SR 1554 (WRIGHT RD)	FROM SR 1547 (FULLER MILL RD) TO DEAD END	2	2WU	1.213	21	150								
TOTAL FOR MAP NO. 83																	
2017CPT.08.19.20762	Randolph	84	SR 1561 (ELLEN AVE/REDDICK DR)	FROM SR 1558 (TURNPIKE RD) TO DEAD END	2	2WU	0.141	18	25								
TOTAL FOR MAP NO. 84																	
2017CPT.08.19.20762	Randolph	85	SR 1585 (HILLCREST LN)	FROM NC 62 TO END MAINT	2	2WU	0.156	24	25								
TOTAL FOR MAP NO. 85																	
2017CPT.08.19.20762	Randolph	86	SR 1606 (TRINITY BLVD)	FROM SR 1564 (MEADOWBROOK DR) TO SR 1702 (TRINITY BLVD)	2	2WU	0.19	18	30							4,089	4,089
TOTAL FOR MAP NO. 86																4,089	4,089
2017CPT.08.19.20762	Randolph	87	SR 1702 (TRINITY BLVD)	FROM SR 1606 (TRINITY BLVD) TO SR 1703 (TRINITY BLVD)	2	2WU	0.12	18	25								
TOTAL FOR MAP NO. 87																	
2017CPT.08.19.20762	Randolph	88	SR 2952 (HAYES RD)	FROM SR 2819 (HAWTHORNE DR) TO SR 29+51 (KIMBERLY DR)	2	2WU	0.19	18	35								
TOTAL FOR MAP NO. 88																	
2017CPT.08.19.20762	Randolph	89	SR 1613 (CIRCLE DR)	FROM SR 1612 (UWHARRIE RD) TO SR 1612 (LOOPS AROUND)	2	2WU	0.505	18	65								
TOTAL FOR MAP NO. 89																	
2017CPT.08.19.20762	Randolph	90	SR 1620 (THOMPSON RD)	FROM SR 1619 (PROSPECT ST) TO DEAD END	2	2WU	0.22	16	35								
TOTAL FOR MAP NO. 90																	
2017CPT.08.19.20762	Randolph	91	SR 1666 (MOUNTAIN RD)	FROM SR 1462 (PARK DR) TO SR 1460 (CLEVELAND ST)	2	2WU	0.17	17	30								
TOTAL FOR MAP NO. 91																	
2017CPT.08.19.20762	Randolph	92	SR 1683 (OAK KNOLL DR)	FROM SR 1596 (SEALY DR) TO DEAD END	2	2WU	0.2	19	30								
TOTAL FOR MAP NO. 92																	
2017CPT.08.19.20762	Randolph	93	SR 1737 (JOAN DR)	FROM SR 1595 (SURRETT DR) TO DEAD END	2	2WU	0.304	18	40								
TOTAL FOR MAP NO. 93																	
2017CPT.08.19.20762	Randolph	94	SR 1757 (ELMONT ST)	FROM SR 1697 (GLENVIEW DR) TO SR 1756 (ENFIELD DR)	2	2WU	0.24	18	15								
TOTAL FOR MAP NO. 94																	
2017CPT.08.19.20762	Randolph	95	SR 1762 (DAWNWOOD DR)	FROM SR 1767 (LOWERYWOOD CIR) TO SR 1765 (HEATHWOOD DR)	2	2WU	0.071	10	15							1,528	1,528
TOTAL FOR MAP NO. 95																1,528	1,528
2017CPT.08.19.20762	Randolph	96	SR 1763 (FAIRWOOD RD)	FROM SR 1765 (HEATHWOOD DR) TO SR 1556 (WELBORN RD)	2	2WU	0.373	19	50								
TOTAL FOR MAP NO. 96																	
2017CPT.08.19.20762	Randolph	97	SR 1767 (LOWERYWOOD CIR)	FROM SR 1766 (TWINWOOD DR) TO DEAD END	2	2WU	0.371	18	50</								

SIGNING FOR ASPHALT SURFACE TREATMENT

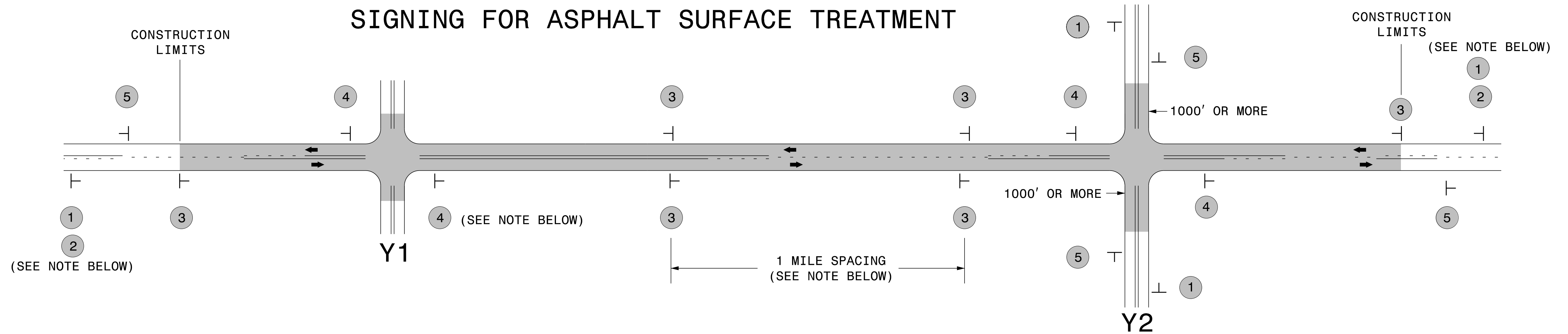

LEGEND	
	STATIONARY SIGN
←	DIRECTION OF TRAFFIC FLOW

MAINLINE (-L-) SIGNING

-Y- LINE SIGNING

SIGNING NOTES AND PLACEMENT PER DIRECTION	MAINLINE (-L-) SIGNING
1	<p>PLACE 1000' PRIOR TO BEGINNING OF CONSTRUCTION LIMITS. ONLY USED ON -Y- LINES IF RESURFACING LIMITS EXTEND 1000' ALONG -Y- LINE.</p>
2	<p>#2 SIGN ONLY USED WHEN RESURFACING LIMITS ARE 2 OR MORE MILES IN LENGTH. ROUND UP TO NEXT WHOLE NUMBER. (NO FRACTIONAL OR DECIMAL NUMBERS)</p>
3	<p>ALTERNATE THE FOLLOWING TWO SIGNS: STARTING WITH "LOOSE GRAVEL" (W8-7) FOLLOWED BY "UNMARKED PAVEMENT".</p> <p>PLACE INITIALLY AT THE CONSTRUCTION LIMITS AND SPACED 1 MILE APART THEREAFTER. IF NO -Y- LINES EXIST, PLACE 2ND SET 1/2 MILE FROM THE CONSTRUCTION LIMITS AND THEN SPACE 1 MILE THEREAFTER.</p>
4	<p>THESE ARE FOR -Y- LINES THAT ARE "THROUGH" ROADWAYS. DEAD END AND SUBDIVISION ROADS ARE NOT "THROUGH" ROADWAYS. INSTALL 500' +/- FROM EACH -Y- LINE APPROACH AS SHOWN ABOVE. FOR MULTIPLE -Y- LINES THAT ARE SEPARATED BY 0.25 MILES OR LESS, TREAT AS A SINGLE UNIT AND INSTALL WITHIN 500' OF EACH APPROACH. A MAXIMUM OF 2 SIGN SETS PER MILE. DO NOT INSTALL WHEN -Y- LINES ARE WITHIN 0.5 MILES FROM "END ROAD WORK" SIGN.</p>
5	<p>PLACE 500' FOLLOWING THE END OF CONSTRUCTION LIMITS.</p>

NO REQUIRED STATIONARY SIGNING FOR THE FOLLOWING -Y- LINE CONDITIONS:

- 1) LESS THAN 1000' OF RESURFACING ALONG -Y- LINE
- 2) SUBDIVISION ROADS
- 3) DEAD END ROADS

WHEN PAVING/CONSTRUCTION ACTIVITIES PROCEED ACROSS AN UNSIGNED -Y- LINE, ADVANCE WARNING PORTABLE SIGNS SHALL BE USED ALONG THE -Y- LINE AS SHOWN BELOW. REMOVE UPON COMPLETION OF WORK.

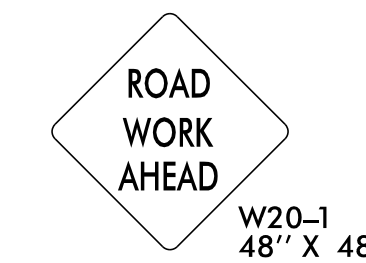

PLACED 500' IN ADVANCE OF FLAGGER. PLACED 250' IN ADVANCE OF FLAGGER.

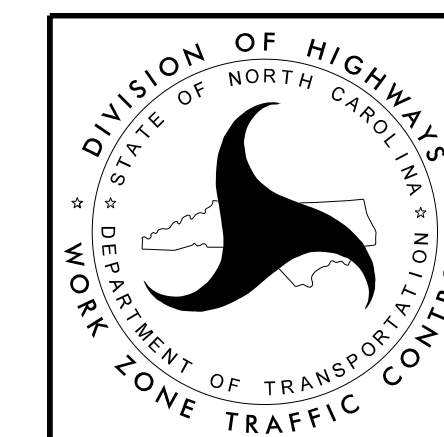

ADVANCE WARNING SIGNS FOR ASPHALT SURFACE TREATMENTS 2 LANE ROADWAYS