

MONTGOMERY COUNTY
SECONDARY SEAL
REQUEST MAP

040397
 2016-APR-20 15:41
 2016-SP-PLAN-59741.dwg
 J:\GIS\Projects\2016\Montgomery\Over-view.mxd
 map_Original.dgn

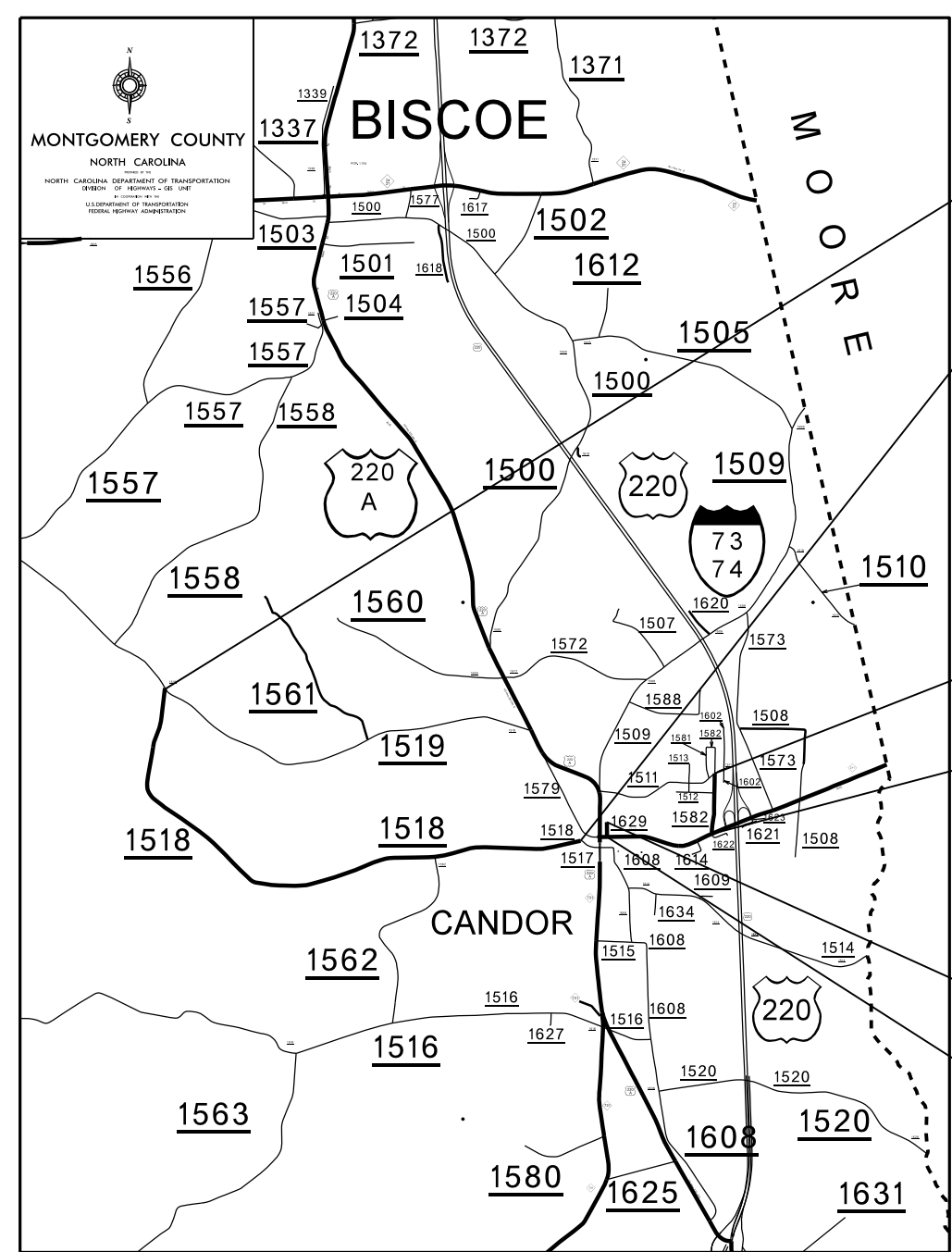
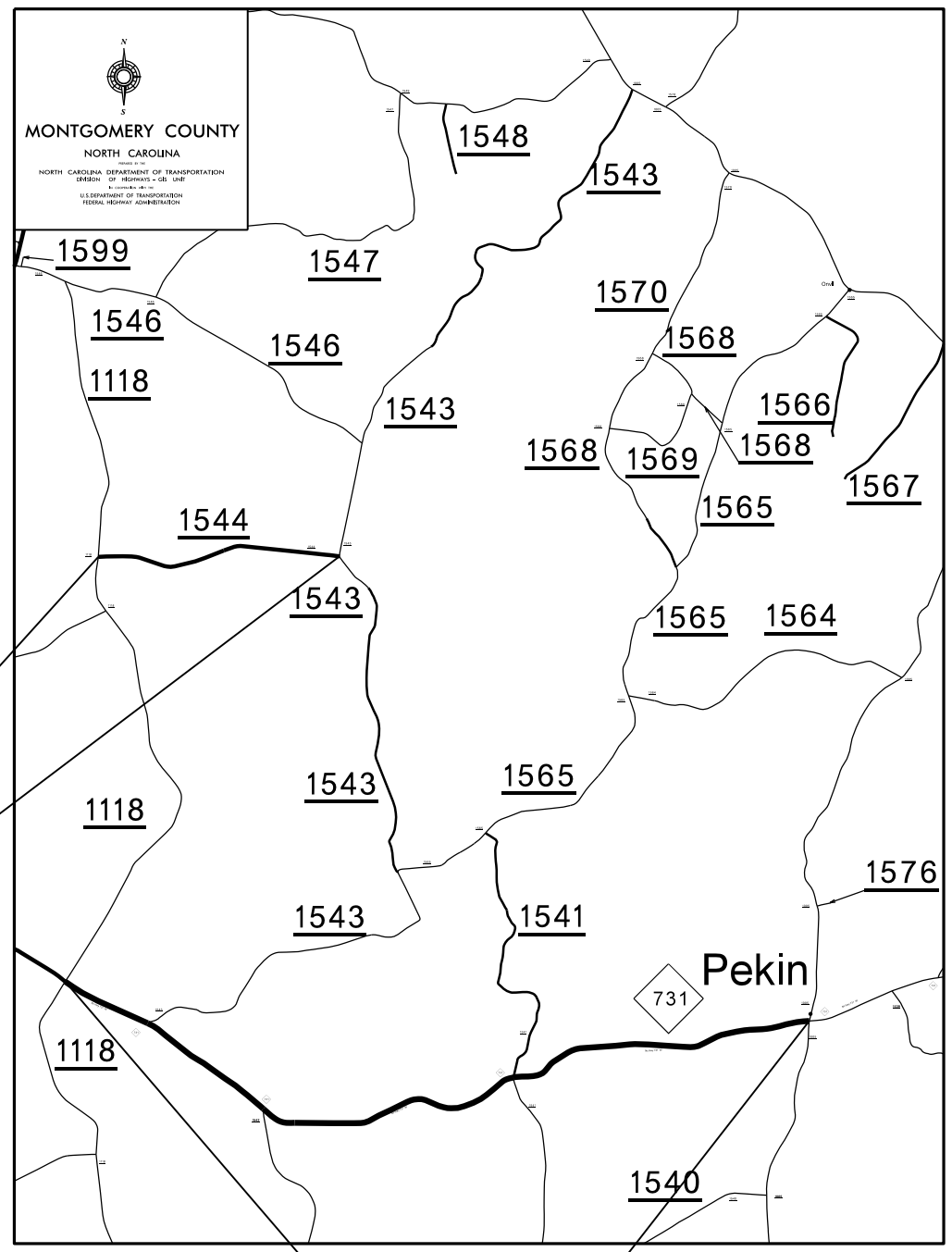

040397

2016-APR-20 15:42
C:\Users\jgallagher\OneDrive\Documents\Montgomery\Overview map_Original.dgn

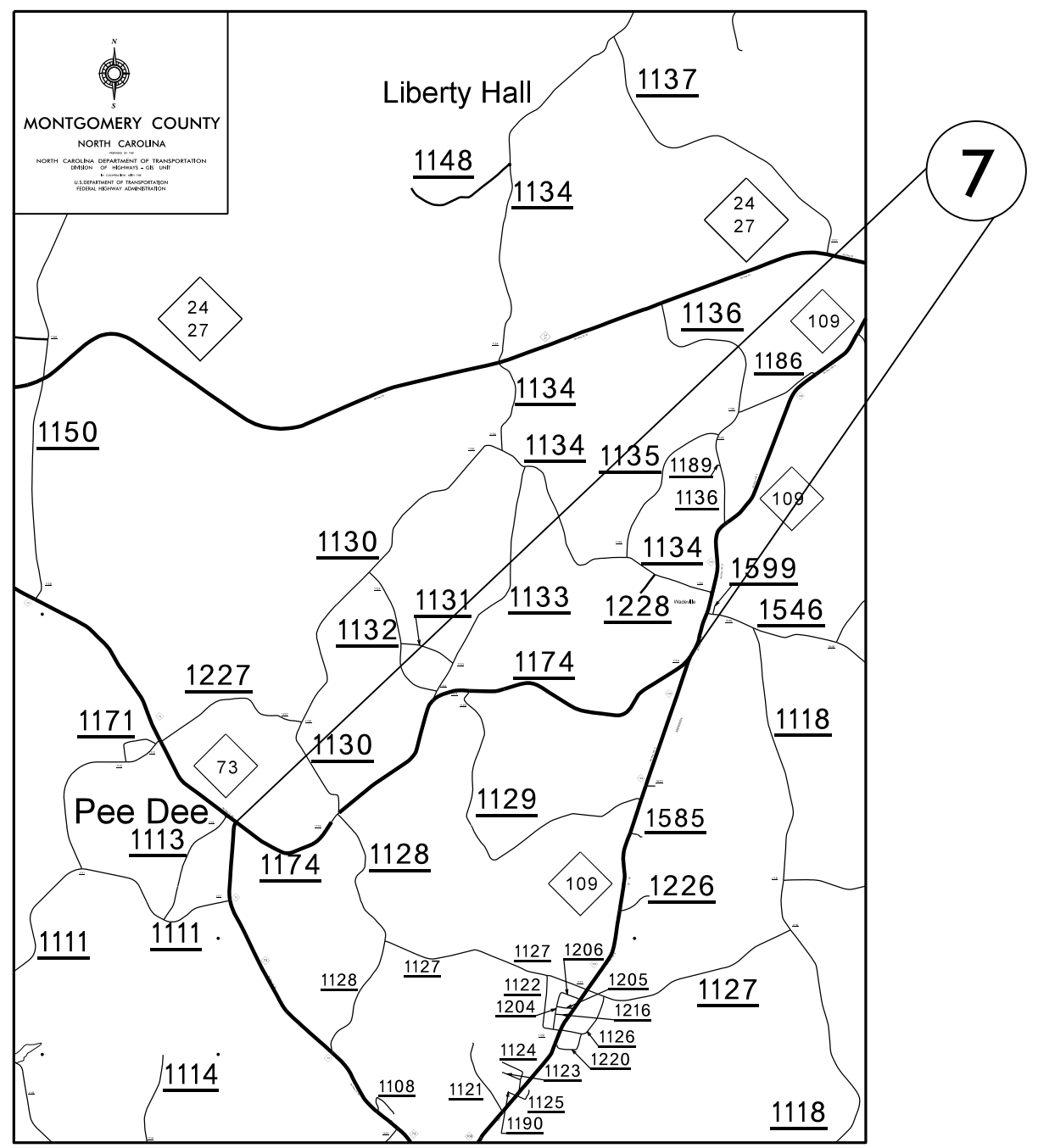
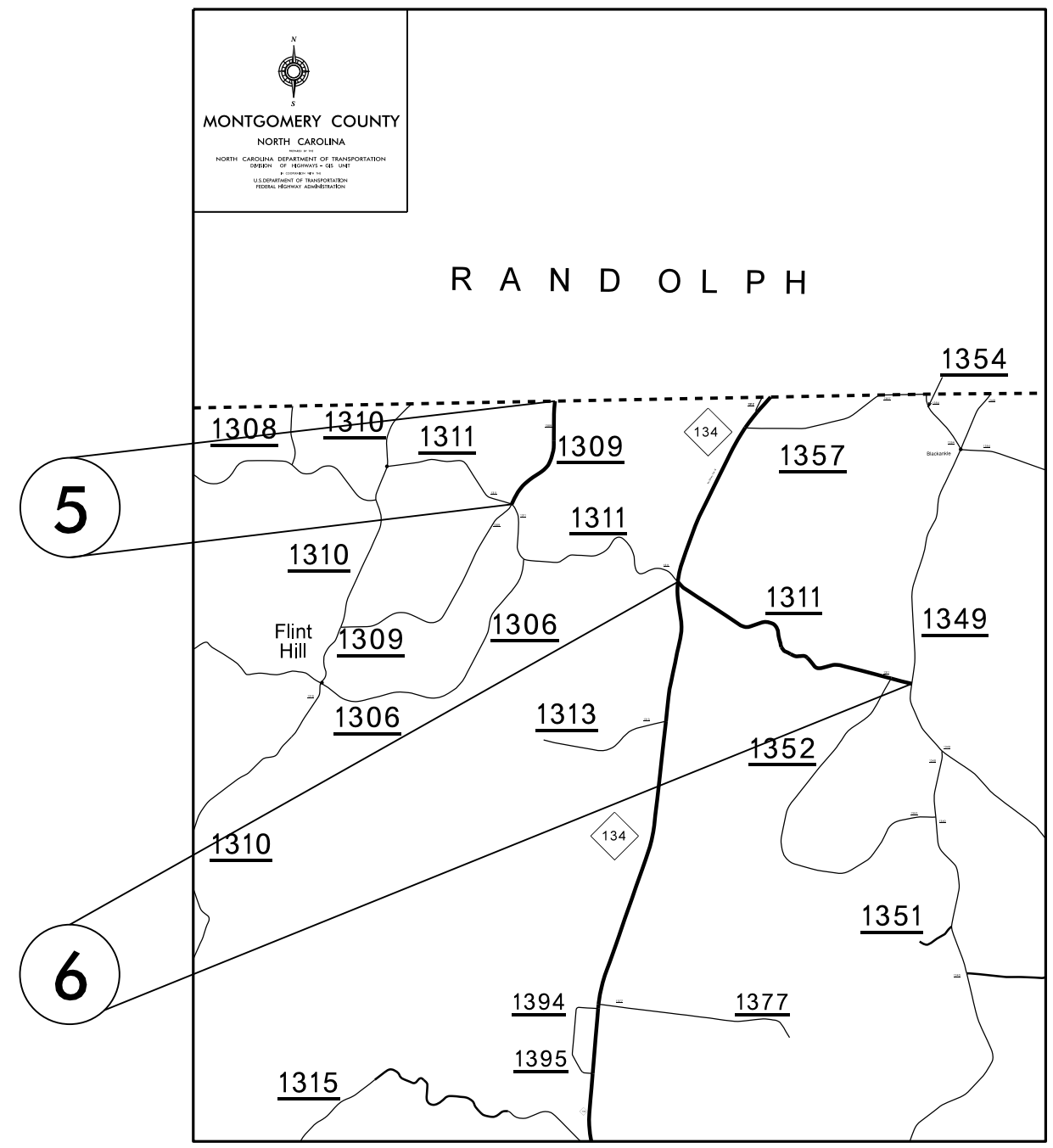

PROJECT NO.	SHEET NO.	TOTAL NO.
2016CPT.08.22.10622	4	
8SP.20624.15		

SUMMARY OF QUANTITIES

PROJECT NO	COUNTY	MAP NO	ROUTE	DESCRIPTION	LENGTH MI	WIDTH FT	ASPHALT SURFACE TREATMENT, DOUBLE SEAL SY	ASPHALT SURFACE TREATMENT, TRIPLE SEAL SY	EMULSION FOR ASPHALT SURFACE TREATMENT GAL	BLOTTING SAND TON	4413000000-E	4457000000-N	4810000000-E	4810000000-E	
											WORK ZONE ADVANCE/GENERAL WARNING SIGNING SF	TEMPORARY TRAFFIC CONTROL LS	4" WHITE PAINT LF	4" YELLOW PAINT LF	
2016CPT.08.22.10622	Montgomery	1	NC 731	FROM SR 1118 (HAYWOOD RD) TO SR 1005 (PEKIN RD)	7.94	23		96,525.00	73,360	*	810	*	170,869	170,869	
TOTAL FOR MAP NO. 1					7.94			96,525.00	73,360		810		170,869	170,869	
TOTAL FOR PROJ NO. 2016CPT.08.22.10622					7.94			96,525.00	73,360	*	810	1	170,869	170,869	
													341,738		
8SP.20624.15	Montgomery	2	SR 1518 (W. CURRIE RD)	FROM SR 1517 (W CURRIE RD) TO SR 1519 (CANDOR-TROY RD)	3.97	20	46,600.00		25,650		450		85,434	85,434	
TOTAL FOR MAP NO. 2					3.97		46,600.00		25,650		450		85,434	85,434	
8SP.20624.15	Montgomery	3	SR 1582 (HILLVIEW ST. EXT)	FROM NC 211 TO SR 1511 (BRUTONVILLE RD)	0.43	22	5,550.00		3,055		50		9,254	9,254	
TOTAL FOR MAP NO. 3					0.43		5,550.00		3,055		50		9,254	9,254	
8SP.20624.15	Montgomery	4	SR 1309 (HURLEY FARM RD)	FROM RANDOLPH CO LINE TO SR 1311 (ABNER RD)	0.86	20	10,100.00		5,600		100		18,507	18,507	
TOTAL FOR MAP NO. 4					0.86		10,100.00		5,600		100		18,507	18,507	
8SP.20624.15	Montgomery	5	SR 1311 (ABNER RD)	FROM NC 134 TO SR 1349 (ETHER RD)	2.05	20	24,080.00		13,250		230		44,116	44,116	
TOTAL FOR MAP NO. 5					2.05		24,080.00		13,250		230		44,116	44,116	
8SP.20624.15	Montgomery	6	SR 1629 (E. EWING ST)	FROM NC 211 TO E. PARSONS ST (NON-SYSTEM)	0.1	17	1,000.00		550		12				
TOTAL FOR MAP NO. 6					0.1		1,000.00		550		12				
8SP.20624.15	Montgomery	7	SR 1174 (PEE DEE RD)	FROM NC 73 TO NC 109	4.2	20		49,300.00	37,470		480		90,384	90,384	
TOTAL FOR MAP NO. 7					4.2			49,300.00	37,470		480		90,384	90,384	
8SP.20624.15	Montgomery	8	SR 1544 (CALVARY CH RD)	FROM SR 1118 (YANK RD) TO SR 1543 (PLEASANT GROVE CH RD)	1.67	20	19,600.00		10,780		190		35,938	35,938	
TOTAL FOR MAP NO. 8					1.67		19,600.00		10,780		190		35,938	35,938	
TOTAL FOR PROJ NO. 8SP.20624.15					13.28			106,930.00	49,300.00	96,355	*	1,512	*	283,633	283,633
													567,266		
GRAND TOTAL					21.22			106,930.00	145,825.00	169,715	50	2,322	1	454,502	454,502
													909,004		

SIGNING FOR ASPHALT SURFACE TREATMENT

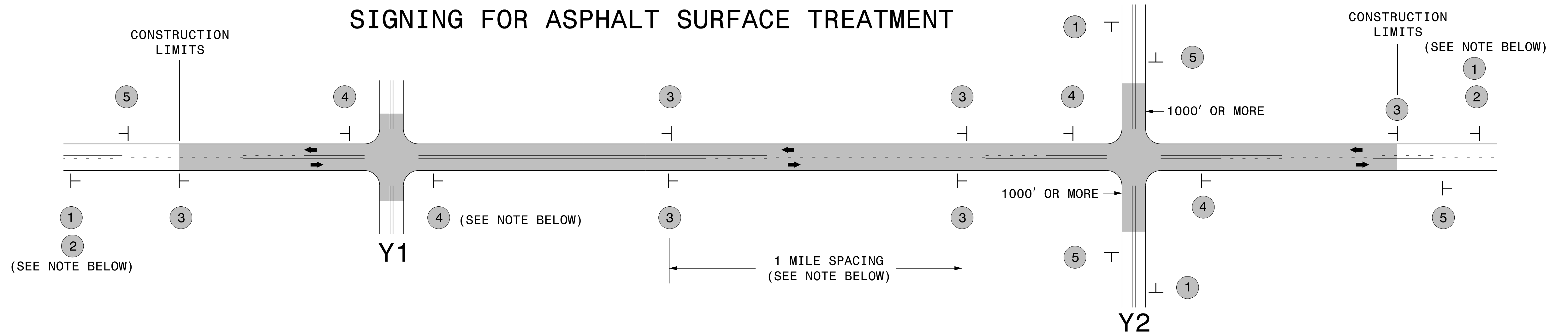

LEGEND	
┆	STATIONARY SIGN
←	DIRECTION OF TRAFFIC FLOW

MAINLINE (-L-) SIGNING

-Y- LINE SIGNING

SIGNING NOTES AND PLACEMENT PER DIRECTION	1	 <small>W20-1 48" X 48"</small>	PLACE 1000' PRIOR TO BEGINNING OF CONSTRUCTION LIMITS. ONLY USED ON -Y- LINES IF RESURFACING LIMITS EXTEND 1000' ALONG -Y- LINE.	<p style="text-align: center;">NO REQUIRED STATIONARY SIGNING FOR THE FOLLOWING -Y- LINE CONDITIONS:</p> <ol style="list-style-type: none"> 1) LESS THAN 1000' OF RESURFACING ALONG -Y- LINE 2) SUBDIVISION ROADS 3) DEAD END ROADS <p style="text-align: center;">WHEN PAVING/CONSTRUCTION ACTIVITIES PROCEED ACROSS AN UNSIGNED -Y- LINE, ADVANCE WARNING PORTABLE SIGNS SHALL BE USED ALONG THE -Y- LINE AS SHOWN BELOW. REMOVE UPON COMPLETION OF WORK.</p> <div style="display: flex; justify-content: space-around; align-items: center;"> <div style="text-align: center;"> <small>W20-1 48" X 48"</small> </div> <div style="text-align: center;"> <small>W20-7 A 48" X 48"</small> </div> </div> <p style="text-align: center;">PLACED 500' IN ADVANCE OF FLAGGER. PLACED 250' IN ADVANCE OF FLAGGER.</p>
	2	 <small>W7-3aP 24" X 18"</small>	#2 SIGN ONLY USED WHEN RESURFACING LIMITS ARE 2 OR MORE MILES IN LENGTH. ROUND UP TO NEXT WHOLE NUMBER. (NO FRACTIONAL OR DECIMAL NUMBERS)	
	3	 <small>W8-7 48" X 48"</small> <small>SP 48" X 48"</small>	ALTERNATE THE FOLLOWING TWO SIGNS: STARTING WITH "LOOSE GRAVEL" (W8-7) FOLLOWED BY "UNMARKED PAVEMENT". PLACE INITIALLY AT THE CONSTRUCTION LIMITS AND SPACED 1 MILE APART THEREAFTER. IF NO -Y- LINES EXIST, PLACE 2ND SET 1/2 MILE FROM THE CONSTRUCTION LIMITS AND THEN SPACE 1 MILE THEREAFTER.	
	4	 <small>SP 13106 48" X 48"</small>	THESE ARE FOR -Y- LINES THAT ARE "THROUGH" ROADWAYS. DEAD END AND SUBDIVISION ROADS ARE NOT "THROUGH" ROADWAYS. INSTALL 500' +/- FROM EACH -Y- LINE APPROACH AS SHOWN ABOVE. FOR MULTIPLE -Y- LINES THAT ARE SEPARATED BY 0.25 MILES OR LESS, TREAT AS A SINGLE UNIT AND INSTALL WITHIN 500' OF EACH APPROACH. A MAXIMUM OF 2 SIGN SETS PER MILE. DO NOT INSTALL WHEN -Y- LINES ARE WITHIN 0.5 MILES FROM "END ROAD WORK" SIGN.	
	5	 <small>G20-2 A 48" X 24"</small>	PLACE 500' FOLLOWING THE END OF CONSTRUCTION LIMITS.	

DIVISION OF HIGHWAYS
STATE OF NORTH CAROLINA
DEPARTMENT OF TRANSPORTATION
WORK ZONE TRAFFIC CONTROL

**ADVANCE WARNING SIGNS
FOR
ASPHALT SURFACE TREATMENTS
2 LANE ROADWAYS**

12/22/2014 8:11:11 AM S:\TMC\WZTC\Apps\WorkZoneGeneral\ExternalWebPage\DesRes\Resurfacing\Resurfacing\AdvWarn_2Ln - AST.dgn User:rmgarr