

RANDOLPH COUNTY
SECONDARY SEAL REQUEST MAP

02-MAY-2016 16:24 RAND SUMMER SEAL CONTRACT 2016 RANDOLPH SUMMER SEAL OVERVIEW MAPS.dgn
 040397

MAPS #27 & #32 - #34

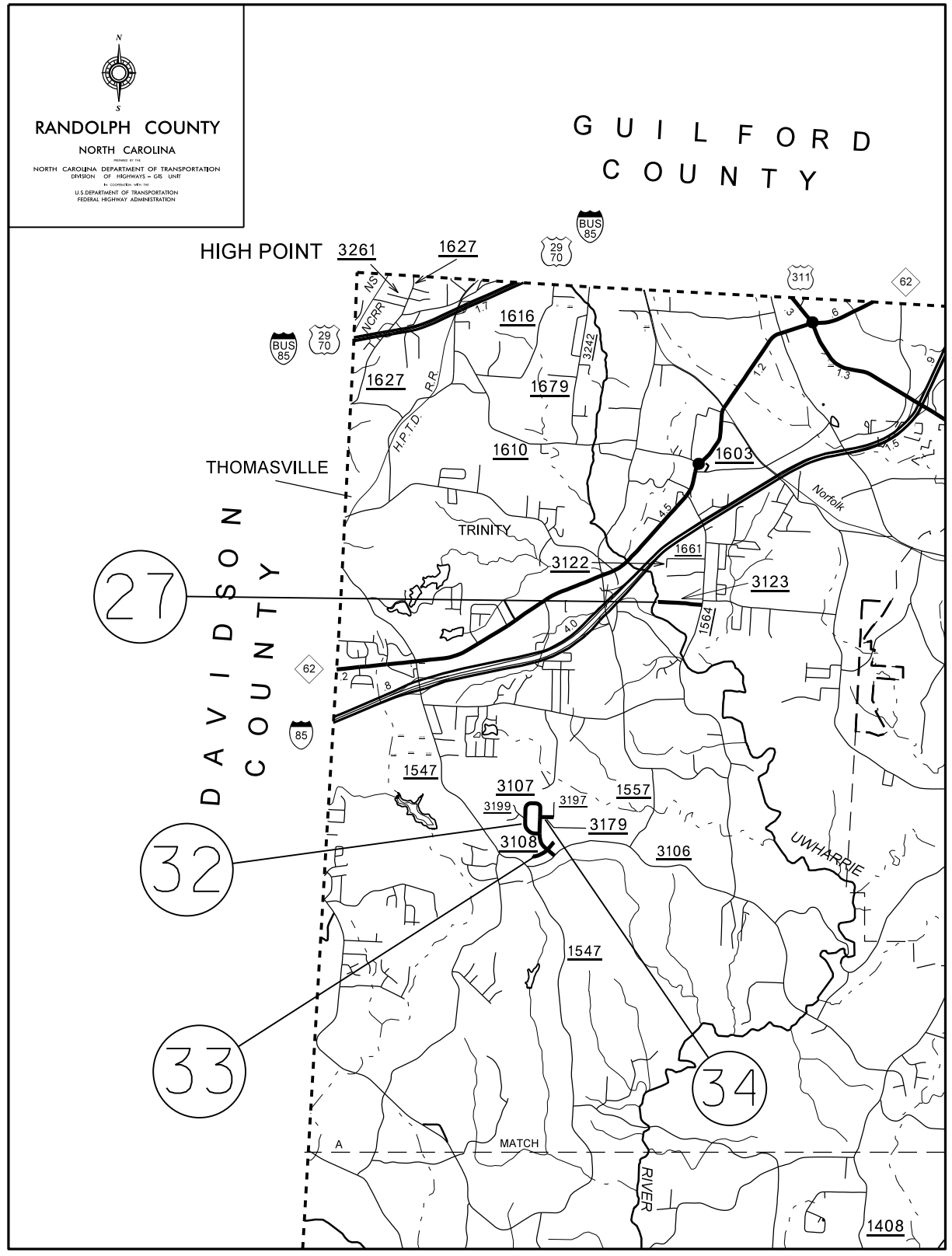

MAPS #1, #3, #29, & #37 - #39

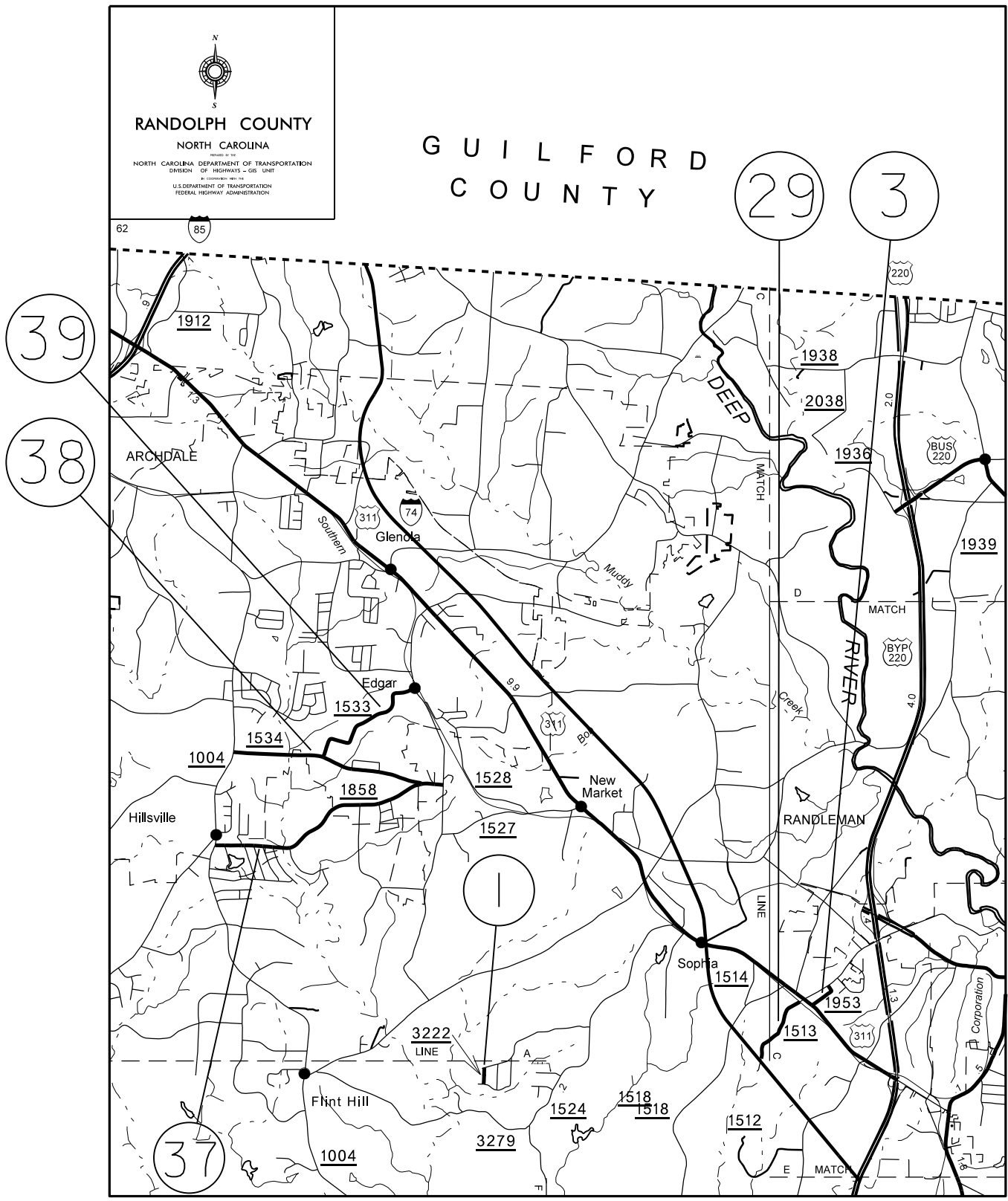

040397
02-MAY-2016 17:36 RAND. SUMMER SEAL CONTRACT 2016.RANDOLPH.SUMMER.SEAL.VICINITY_MAPS.dgn

MAPS #4, #10, #11, & #14

MAPS #12 & #18

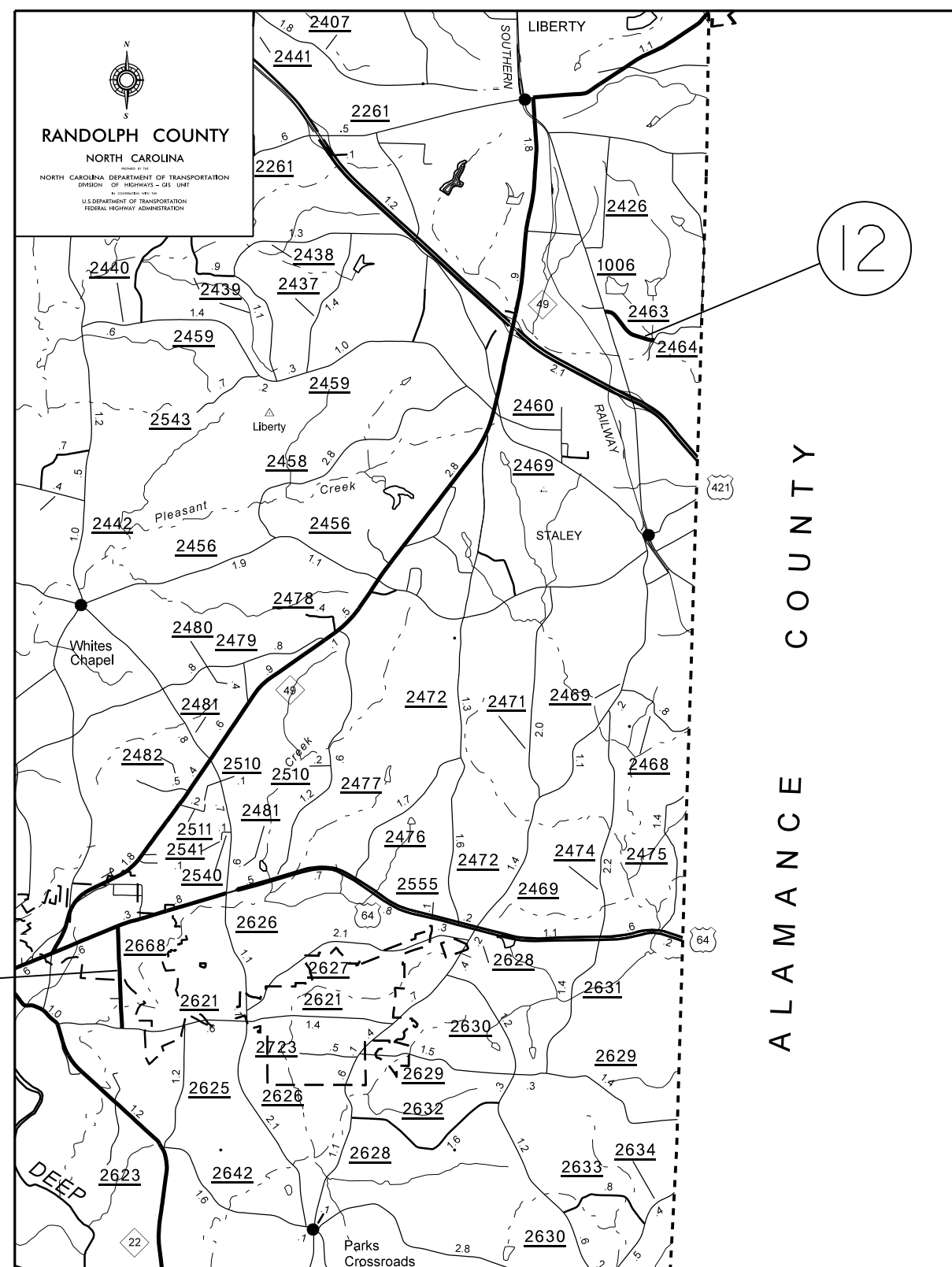
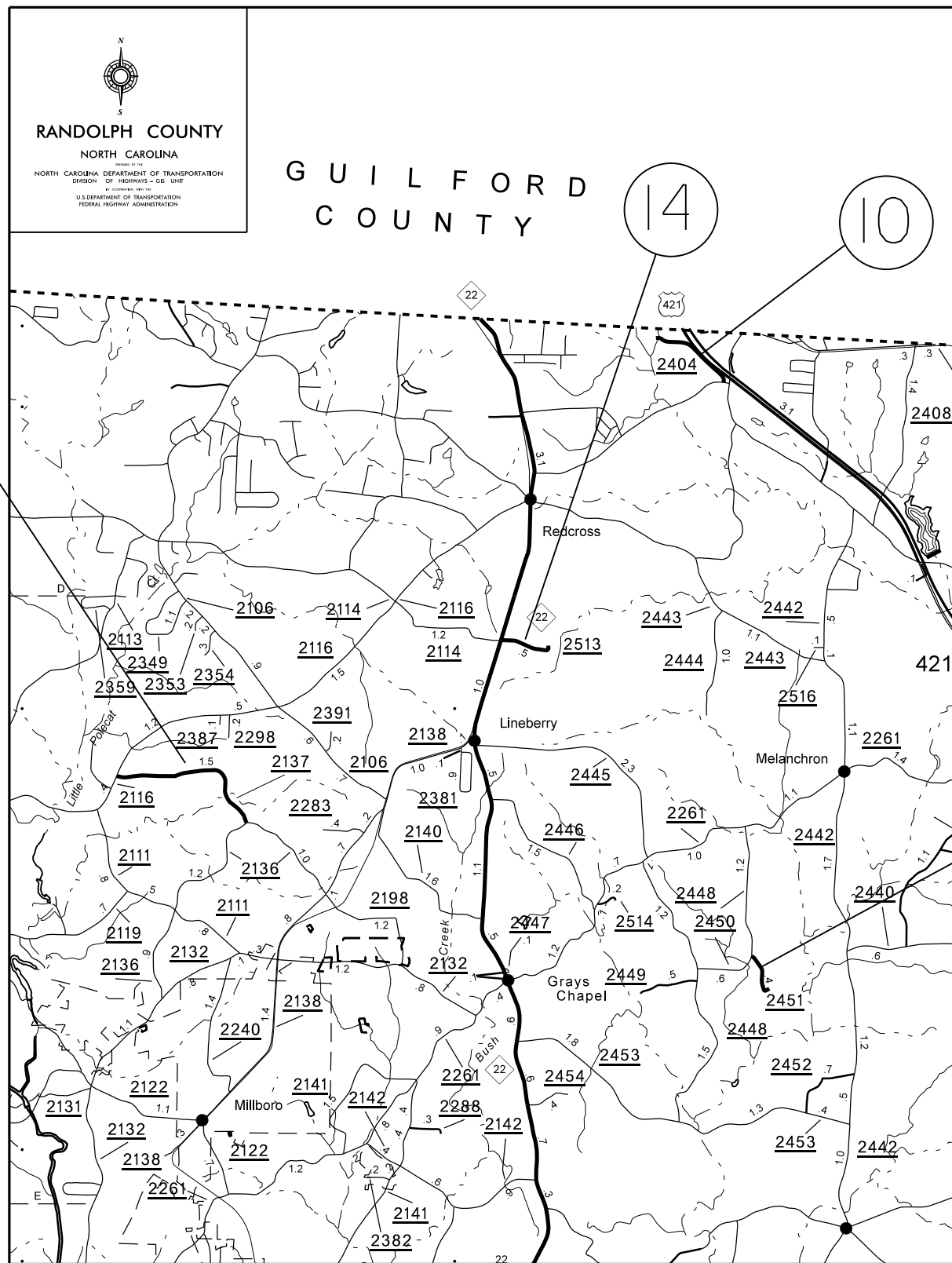

040397

02-MAY-2016 17:36 RANDOLPH_SUMMER_SEAL_CONTRACT_V2016.RANDOLPH_SUMMER_SEAL_VICINITY_MAPS.dgn

MAPS #6, - #8, #13, #15, #17, #18, & #31

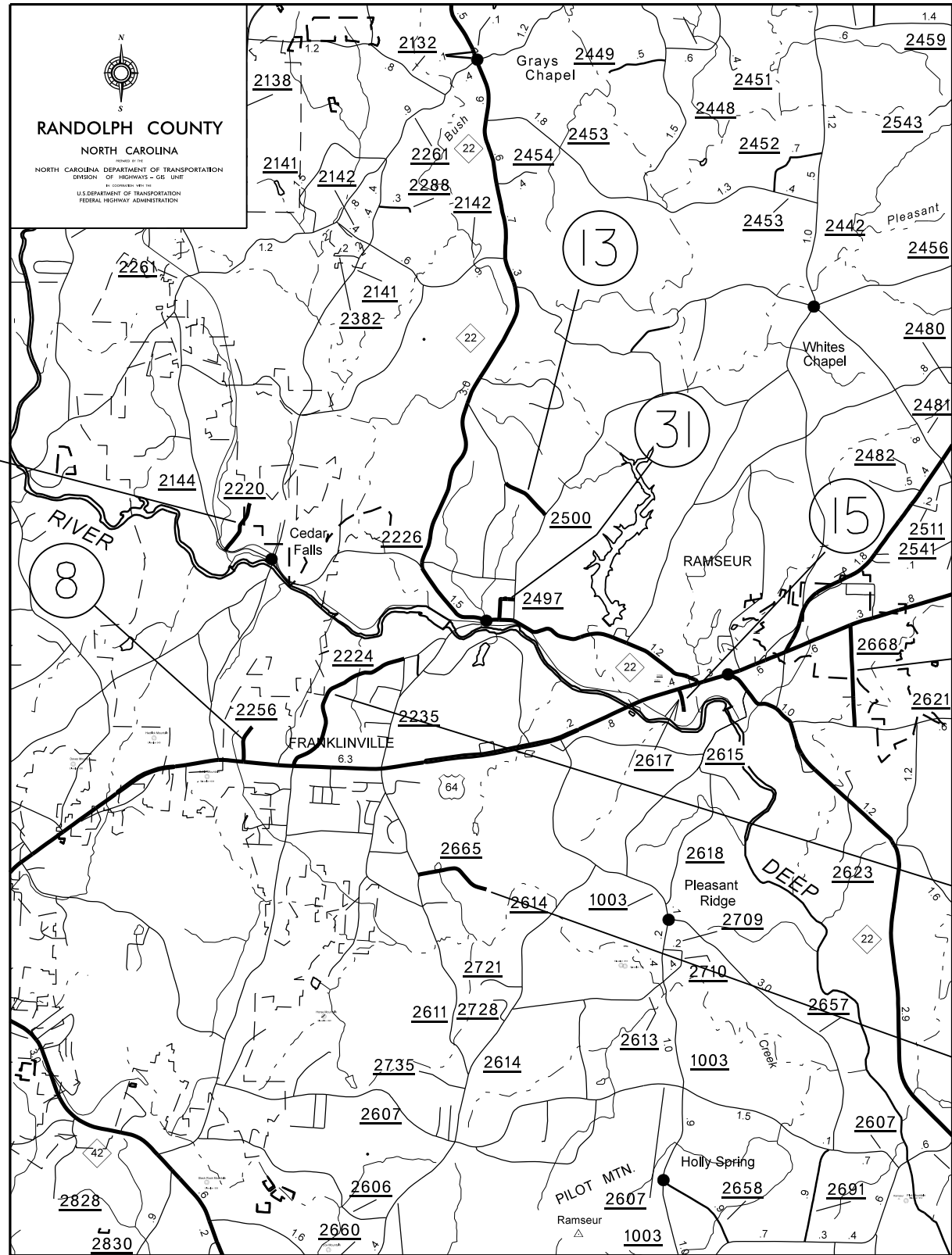

MAPS #2, #5, #9, #24 & #36

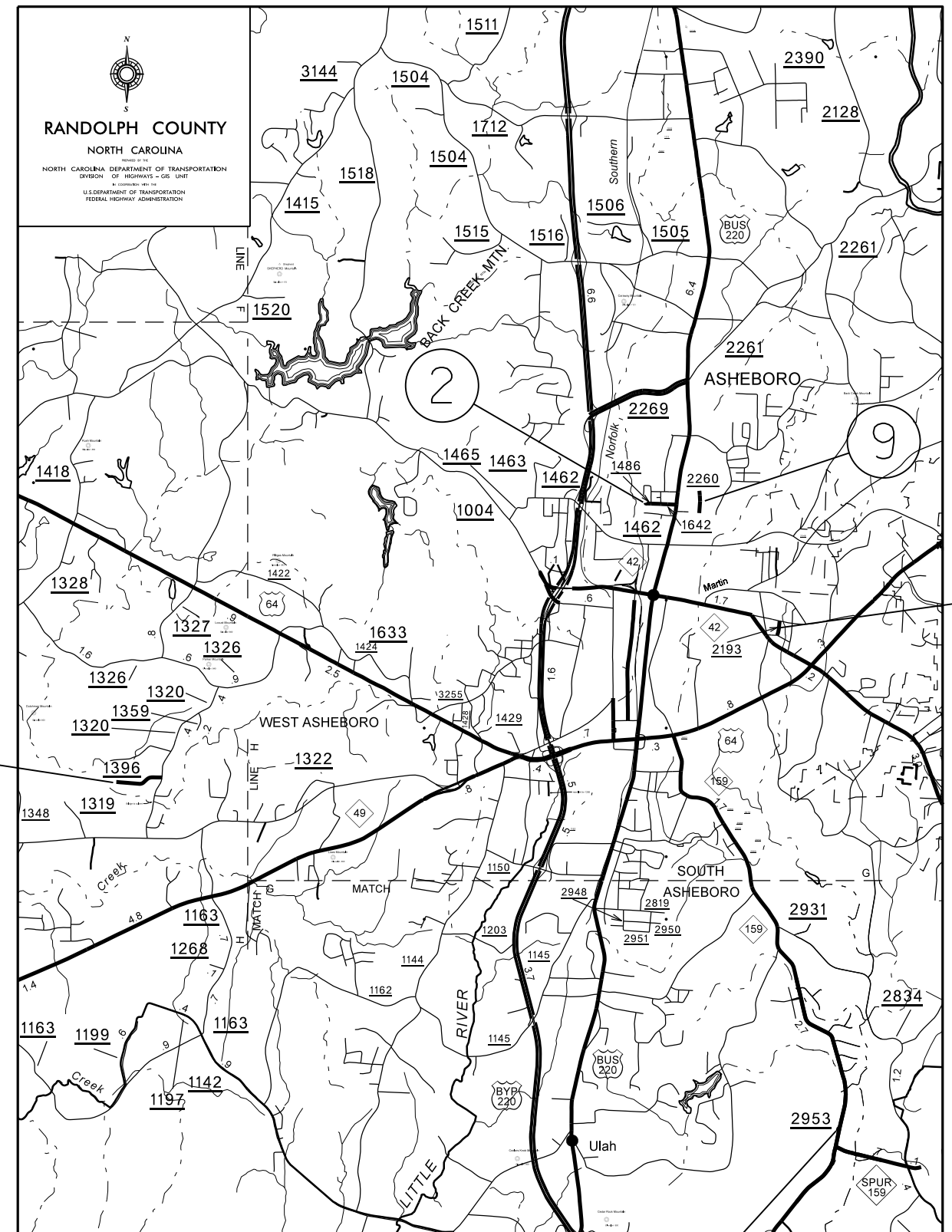

02-MAY-2016 17:36 RAND. SUMMER SEAL CONTRACT 2016.RANDOLPH.SUMMER.SEAL.VICINITY_MAPS.dgn

MAPS #16, #19, #21, #25, #26, #28, #40 & #42

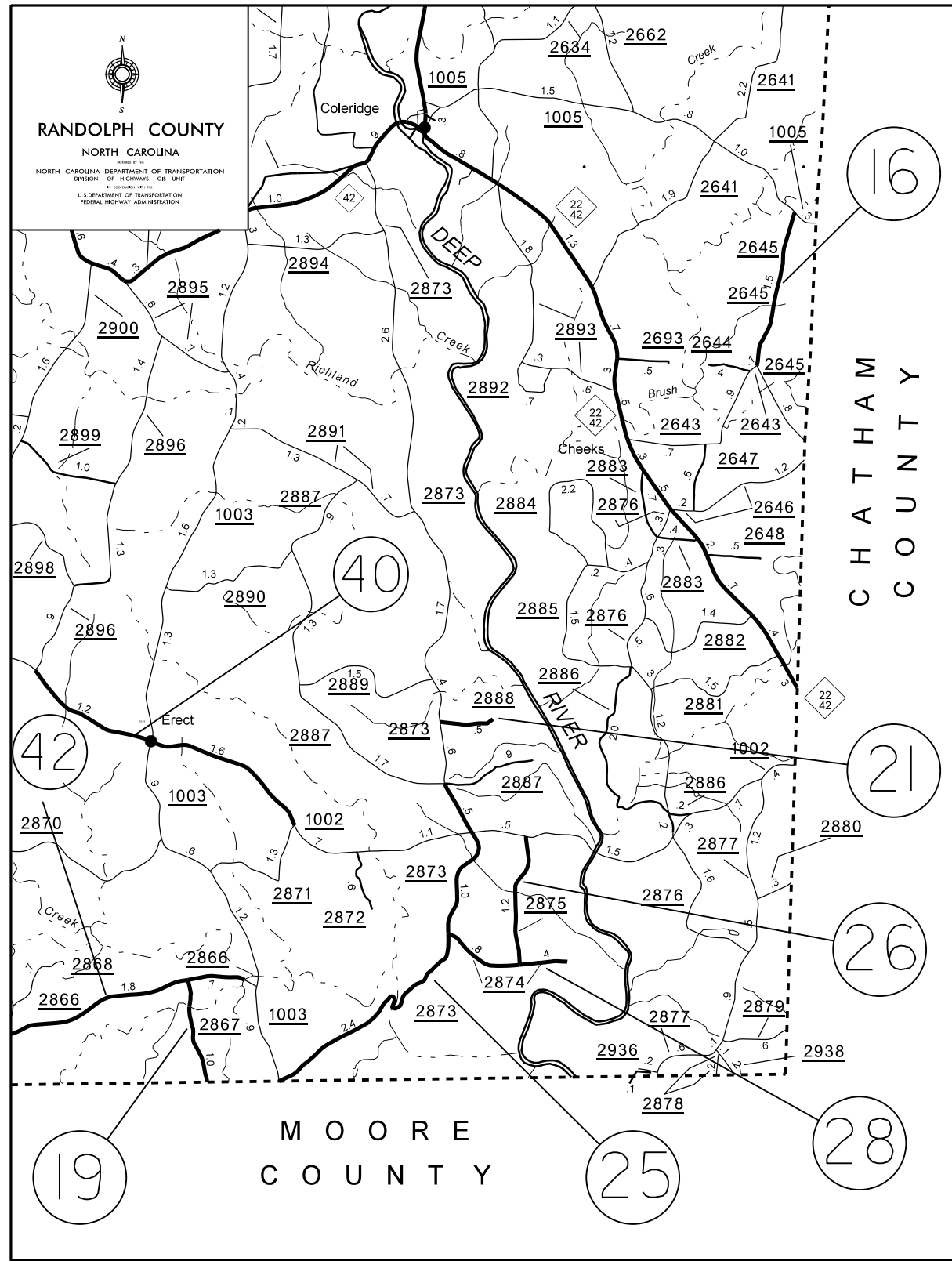

MAPS #20, #22 - #24, #30, & #40 - #43

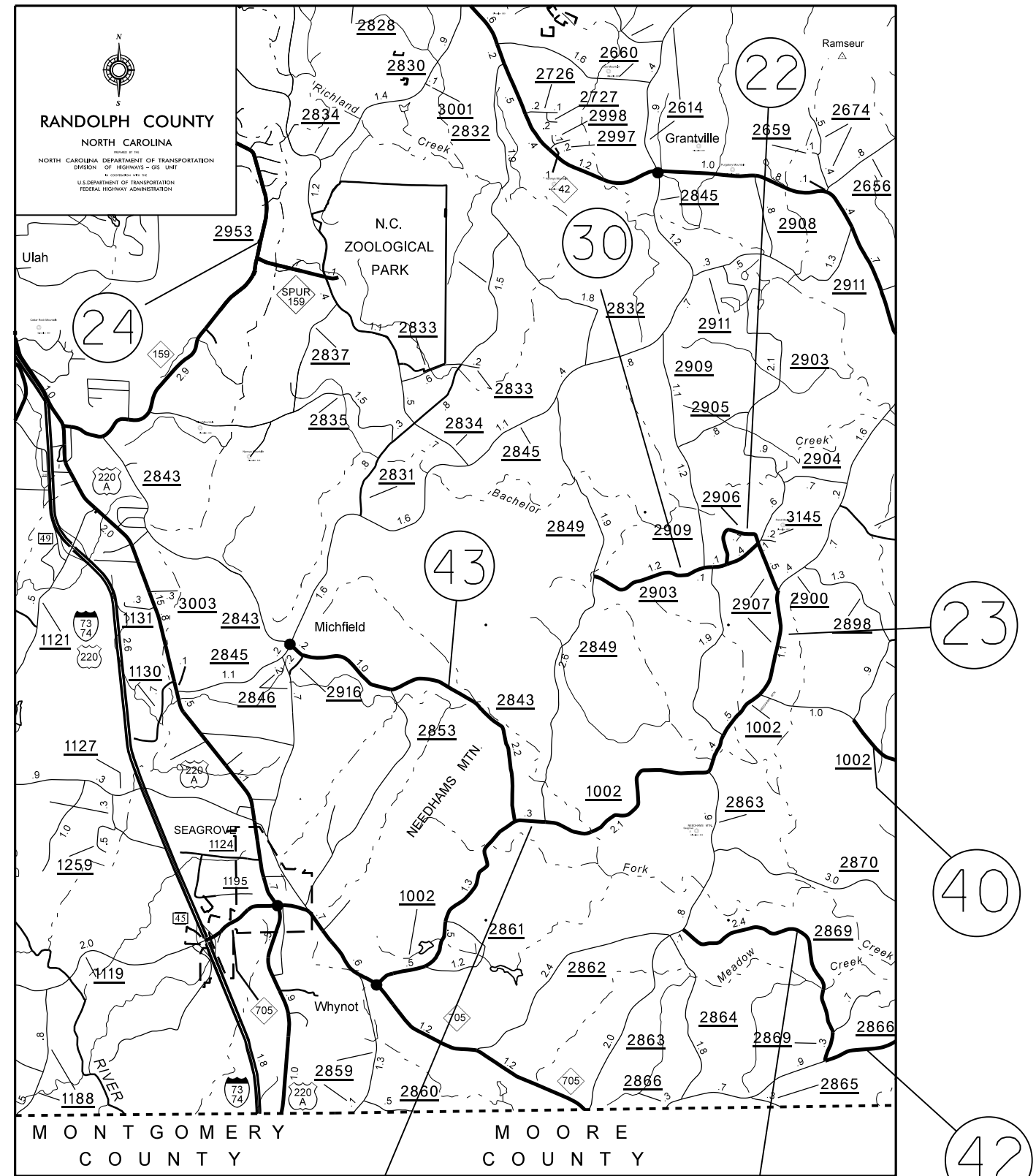

040397
02-MAY-2016 17:36 RANDOLPH_SUMMER_SEAL_VICINITY_MAPS.dgn

BRIDGES

MAPS #35 & #36

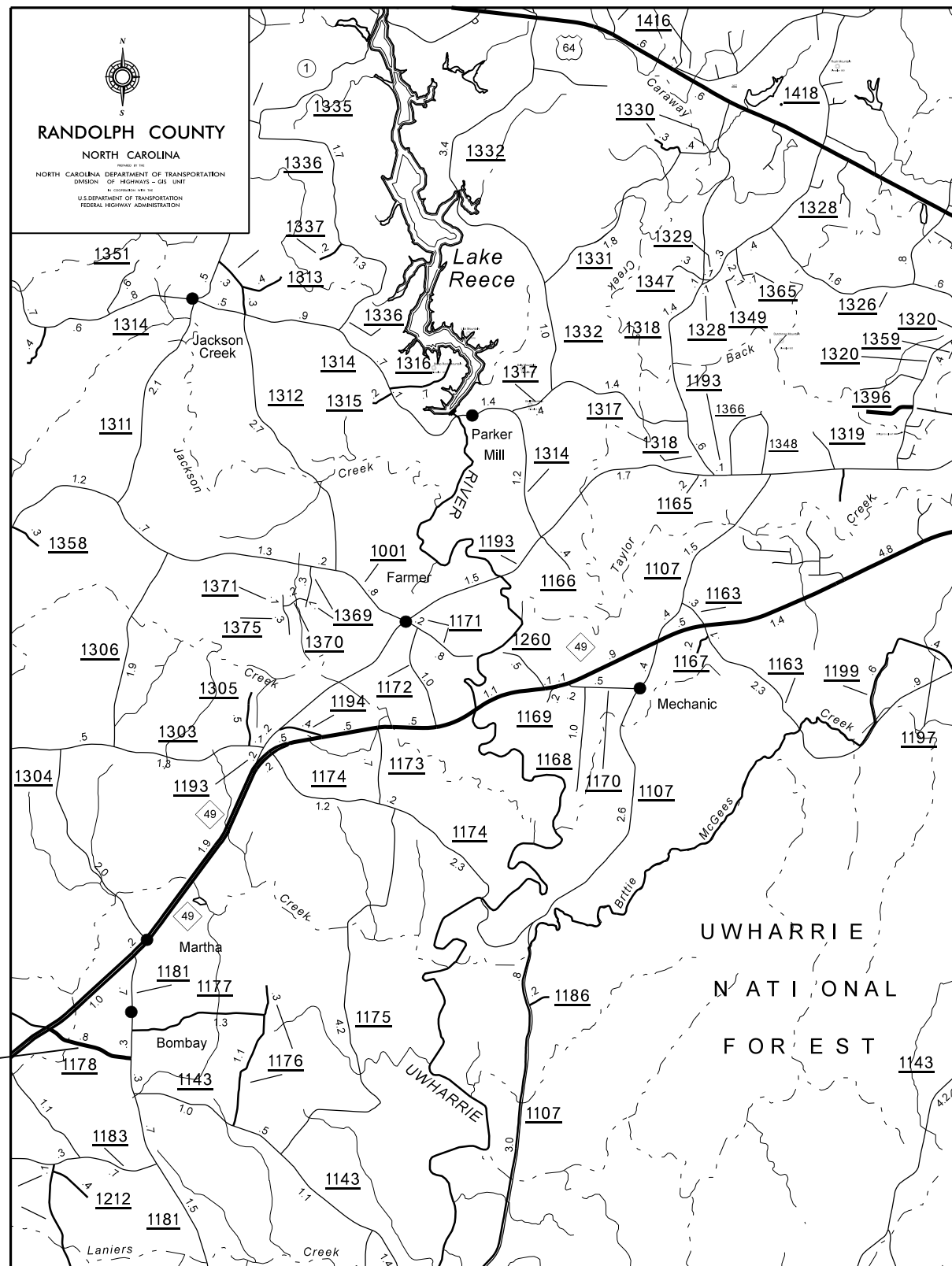

MAP# 20 SR 2869 B# 210
(DO NOT SEAL – TIE AT CONSTRUCTION JT'S)

MAP# 25 SR 2873 B# 415
(DO NOT SEAL)

MAP# 37 SR 1858 B# 79
(DO NOT SEAL – TIE AT CONSTRUCTION JT'S)

MAP# 41 SR 1002 B# 206
(DO NOT SEAL – TIE AT CONSTRUCTION JT'S)

MAP# 42 SR 1002 B# 209
(SEAL)

MAPS FOR CAPE SEAL

MAP# 1 SR 3222 (SHANNON ACRES)

MAP# 3 SR 1953 (BROWN LOOP RD)

MAP# 32 SR 3107 (EVERGREEN DR.)

MAP# 33 SR 3108 (GADDY DR.)

MAP# 34 SR 3179 (LONGVIEW AVE.)

MAP# 36 SR 1396 (GLADE RD.)

PROJECT NO.	SHEET NO.	TOTAL NO.
8SP.20764.15	7	

SUMMARY OF QUANTITIES

PROJECT NO	COUNTY	MAP NO	ROUTE	DESCRIPTION	LENGTH MI	WIDTH FT	ASPHALT SURFACE TREATMENT, SLURRY SEAL SY	ASPHALT SURFACE TREATMENT, DOUBLE SEAL SY	ASPHALT SURFACE TREATMENT, SINGLE SEAL SY	EMULSION FOR ASPHALT SURFACE TREATMENT GAL	BLOTTING SAND TON	4413000000-E	4457000000-N	4810000000-E	4830000000-E	4835000000-E	4840000000-N	
												WORK ZONE ADVANCE/GENERAL WARNING SIGNING SF	TEMPORARY TRAFFIC CONTROL LS	4" WHITE PAINT LF	4" YELLOW PAINT LF	16" WHITE PAINT LF	24" WHITE PAINT LF	PAINT MSG RXR EA
8SP.20764.15	Randolph	1	SR 3222 (SHANNON ACRES)	FROM SR 1523 (MARSH MOUNTAIN RD) TO SR 3178 (FOREST TRL)	0.16	20	1,880.00		1,880.00	660	50	18	1.0000					
TOTAL FOR MAP NO. 1					0.16		1,880.00		1,880.00	660	50	18	1					
8SP.20764.15	Randolph	2	SR1486 (PLUMMER ST)	FROM US 220 BUS TO DEAD END	0.274	16		2,580.00		1,420		31						
TOTAL FOR MAP NO. 2					0.274			2,580.00		1,420		31						
8SP.20764.15	Randolph	3	SR 1953 (BROWN LOOP RD)	FROM SR 1952 (OLD HIGH POINT ST) TO SR 1009 (PREV US 311)	0.269	17	2,690.00		2,690.00	945		31						
TOTAL FOR MAP NO. 3					0.269		2,690.00		2,690.00	945		31						
8SP.20764.15	Randolph	4	SR 2137 (HAWKSVIEW RD)	FROM SR 2116 (NEW SALEM RD) TO SR 2136 (MAMIE MAY RD)	1.483	20		17,410.00		9,580		167		31,914	31,914			
TOTAL FOR MAP NO. 4					1.483			17,410.00		9,580		167		31,914	31,914			
8SP.20764.15	Randolph	5	SR 2193 (CALLICUT ST)	FROM SR 2237 (SALISBURY ST) TO SR 2195 (THOMAS ST)	0.131	16		1,240.00		680		15						
TOTAL FOR MAP NO. 5					0.131			1,240.00		680		15						
8SP.20764.15	Randolph	6	SR 2220 (JENNINGS RD)	FROM SR 2144 (WICKER LOVELL RD) TO DEAD END	0.488	20		5,730.00		3,160		55						
TOTAL FOR MAP NO. 6					0.488			5,730.00		3,160		55						
8SP.20764.15	Randolph	7	SR 2224 (PLEASANT CROSS RD)	FROM US 64 TO SR 2235 (ANDREW HUNTER RD)	2.03	20		23,820.00		13,105		228		43,686	43,686			
TOTAL FOR MAP NO. 7					2.03			23,820.00		13,105		228		43,686	43,686			
8SP.20764.15	Randolph	8	SR 2256 (DEWEY RD)	FROM US 64 TO DEAD END	0.29	16		2,730.00		1,510		33						
TOTAL FOR MAP NO. 8					0.29			2,730.00		1,510		33						
8SP.20764.15	Randolph	9	SR 2260 (EASTVIEW DR)	FROM END C&G TO END MAINT	0.291	18		3,080.00		1,700		33						
TOTAL FOR MAP NO. 9					0.291			3,080.00		1,700		33						
8SP.20764.15	Randolph	10	SR 2404 (HAROLD MEADOW RD)	FROM SR 2450 (WILLIAMS DAIRY RD) TO DEAD END	0.803	20		9,430.00		5,190		90						
TOTAL FOR MAP NO. 10					0.803			9,430.00		5,190		90						
8SP.20764.15	Randolph	11	SR 2451 (SPRINGSIDE RD)	FROM SR 2450 (WILLIAMS DAIRY RD) TO DEAD END	0.354	20		4,160.00		2,290		40						
TOTAL FOR MAP NO. 11					0.354			4,160.00		2,290		40						
8SP.20764.15	Randolph	12	SR 2463 (JOHN MARSH RD)	SR 2464 (PIKE FARM RD) TO SR 1006 (OLD US 421)	0.534	20		6,270.00		3,450		60		11,492	11,492			
TOTAL FOR MAP NO. 12					0.534			6,270.00		3,450		60		11,492	11,492			
8SP.20764.15	Randolph	13	SR 2500 (ACADEMY RD)	FROM SR 2499 (BUTLERS CHAPEL RD) TO SR 2495 (MULBERRY ACADEMY ST)	0.482	18		5,090.00		2,800		54		10,373	10,373			
TOTAL FOR MAP NO. 13					0.482			5,090.00		2,800		54		10,373	10,373			
8SP.20764.15	Randolph	14	SR 2513 (UNDERWOOD RD)	FROM NC 22 TO DEAD END	0.432	18		4,570.00		2,520		49						
TOTAL FOR MAP NO. 14					0.432			4,570.00		2,520		49						
8SP.20764.15	Randolph	15	SR 2617 (GREENHILL RD)	FROM US 64 TO DEAD END	0.2	18		2,120.00		1,180		23						
TOTAL FOR MAP NO. 15					0.2			2,120.00		1,180		23						
8SP.20764.15	Randolph	16	SR 2645 (LEWIS BROWN RD)	FROM SR 2643 (BRUSH CREEK RD) TO SR 1005 (LANES MILL RD)	1.407	20		16,520.00		9,090		158		30,279	30,279			
TOTAL FOR MAP NO. 16					1.407			16,520.00		9,090		158		30,279	30,279			
8SP.20764.15	Randolph	17	SR 2665 (KINDLEY FARM RD)	FROM SR 2611 (FOX FIRE RD) TO END MAINT	0.711	19		8,000.00		4,360		80						
TOTAL FOR MAP NO. 17					0.711			8,000.00		4,360		80						
8SP.20764.15	Chatham	18	SR 2668 (REED CREEK RD)	FROM PVT. JT. S OF US 64 TO SR 2621 (FOUSHEE RD)	0.843	24		11,880.00		6,540		95		18,141	18,141			
TOTAL FOR MAP NO. 18					0.843			11,880.00		6,540		95		18,141	18,141			
8SP.20764.15	Randolph	19	SR 2867 (JUGTOWN RD)	FROM MOORE CO TO SR 2866 (BROWER MILL RD)	0.959	20		11,260.00		6,200		108		20,638	20,638			
TOTAL FOR MAP NO. 19					0.959			11,260.00		6,200		108		20,638	20,638			

PROJECT NO.	SHEET NO.	TOTAL NO.
8SP.20764.15	8	

SUMMARY OF QUANTITIES

PROJECT NO	COUNTY	MAP NO	ROUTE	DESCRIPTION	LENGTH MI	WIDTH FT	ASPHALT SURFACE TREATMENT, SLURRY SEAL SY	ASPHALT SURFACE TREATMENT, DOUBLE SEAL SY	ASPHALT SURFACE TREATMENT, SINGLE SEAL SY	EMULSION FOR ASPHALT SURFACE TREATMENT GAL	BLOTTING SAND TON	4413000000-E	4457000000-N	4810000000-E	4830000000-E	4835000000-E	4840000000-N	
												WORK ZONE ADVANCE/GENERAL WARNING SIGNING SF	TEMPORARY TRAFFIC CONTROL LS	4" WHITE PAINT LF	4" YELLOW PAINT LF	16" WHITE PAINT LF	24" WHITE PAINT LF	PAINT MSG RXR EA
8SP.20764.15	Randolph	20	SR 2869 (MEADOWBRANCH RD)	FROM SR 2866 (BROWER MILL RD) TO	2.605	20		30,570.00		16,820		292		56,060	56,060			
TOTAL FOR MAP NO. 20					2.605			30,570.00		16,820		292		56,060	56,060			
8SP.20764.15	Randolph	21	SR 2888 (SEAREY RD)	FROM SR 2873 (RIVERSIDE DR) TO END MAINT	0.43	20		5,050.00		2,790		49						
TOTAL FOR MAP NO. 21					0.43			5,050.00		2,790		49						
8SP.20764.15	Randolph	22	SR 2906 (GERTRUDE LOOP RD)	FROM SR 2903 (OSBORN MILL RD) TO SR 2903 (OSBORN MILL RD)	0.71	20		8,340.00		4,600		80		15,279	15,279			
TOTAL FOR MAP NO. 22					0.71			8,340.00		4,600		80		15,279	15,279			
8SP.20764.15	Randolph	23	SR 2907 (PINEY RIDGE CH RD/LITTLE BEANE STORE RD)	FROM SR 1002 (CREEK MILL RD) TO SR 2903 (OSBORN MILL RD)	1.552	20		18,220.00		10,025		174		33,399	33,399			
TOTAL FOR MAP NO. 23					1.552			18,220.00		10,025		174		33,399	33,399			
8SP.20764.15	Randolph	24	SR 2953 (DEER RUN)	FROM NC 159 TO DEAD END	0.054	18		580.00		330		7						
TOTAL FOR MAP NO. 24					0.054			580.00		330		7						
8SP.20764.15	Randolph	25	SR 2873 (RIVERSIDE RD.)	FROM SR 1003 (ERECT RD.) TO SR 2887 (ANTIOCH CH RD)	3.725	20		43,710.00		24,050		418		80,162	80,162			
TOTAL FOR MAP NO. 25					3.725			43,710.00		24,050		418		80,162	80,162			
8SP.20764.15		26	SR 2875 (SIDE CH RD)	FROM SR 1002 (BENNETT RD) TO SR 2874 (WADDELLS FERRY RD)	1.218	20		14,300.00		7,880		137		26,211	26,211			
TOTAL FOR MAP NO. 26					1.218			14,300.00		7,880		137		26,211	26,211			
8SP.20764.15	Randolph	27	SR 3123 (WAGONER RD.)	FROM SR 1564 (MEADOWBROOK DR.) TO DEAD END	0.41	20		4,820.00		2,660		46						
TOTAL FOR MAP NO. 27					0.41			4,820.00		2,660		46						
8SP.20764.15	Randolph	28	SR 2874 (WADDELLS FERRY RD.)	FROM SR 2873 (RIVERSIDE RD.) TO DEAD END	1.2	20		14,090.00		7,760		135		25,824	25,824			
TOTAL FOR MAP NO. 28					1.2			14,090.00		7,760		135		25,824	25,824			
8SP.20764.15	Randolph	29	SR 1513 (OLD COURTHOUSE RD.)	FROM US 311 TO END PAVEMENT	0.75	20		8,810.00		4,860		85		12,180	12,180	50	50	2
TOTAL FOR MAP NO. 29					0.75			8,810.00		4,860		85		12,180	12,180	50	50	2
8SP.20764.15	Randolph	30	SR 2903 (OSBORN MILL RD.)	FROM SR 2849 (BACHELOR CREEK RD.) TO SR 2907 (PINEY RIDGE CH. RD.)	1.77	20		20,780.00		11,435		199		28,745	28,745			
TOTAL FOR MAP NO. 30					1.77			20,780.00		11,435		199		28,745	28,745			
8SP.20764.15	Randolph	31	SR 2497 (PINE ST. / ROSE ST.)	FROM NC 22 TO SR 2495 (ACADEMY ST)	0.32	22		4,140.00		2,290		36		5,200	5,200			
TOTAL FOR MAP NO. 31					0.32			4,140.00		2,290		36		5,200	5,200			
8SP.20764.15	Randolph	32	SR 3107 (EVERGREEN DR)	FROM SR 3106 (KENNEDY RD.) TO SR 3107 (EVERGREEN DR)	1.01	20	11,860.00		11,860.00	4,160		113						
TOTAL FOR MAP NO. 32					1.01		11,860.00		11,860.00	4,160		113						
8SP.20764.15	Randolph	33	SR 3108 (GADDY DR.)	FROM END MAINTENANCE TO END MAINTENANCE	0.25	20	2,940.00		2,940.00	1,040		29						
TOTAL FOR MAP NO. 33					0.25		2,940.00		2,940.00	1,040		29						
8SP.20764.15	Randolph	34	SR 3179 (LONGVIEW AVE.)	FROM 3107 (EVERGREEN DR.) TO END MAINTENANCE	0.13	20	1,530.00		1,530.00	560		15						
TOTAL FOR MAP NO. 34					0.13		1,530.00		1,530.00	560		15						
8SP.20764.15	Randolph	35	SR 1178 (BOMBAY SCHOOL RD.)	FROM SR 1181 (NEW HOPE RD.) TO NC 49	0.81	20		9,510.00		5,240		91		17,431	17,431			
TOTAL FOR MAP NO. 35					0.81			9,510.00		5,240		91		17,431	17,431			
8SP.20764.15	Randolph	36	SR 1396 (GLADE RD.)	FROM SR 1320 (CABLE CREEK RD.) TO DEAD END	0.45	20	5,290.00		5,290.00	1,870		51						
TOTAL FOR MAP NO. 36					0.45		5,290.00		5,290.00	1,870		51						
8SP.20764.15	Randolph	37	SR 1858 (OLD MARLBORO RD.)	FROM SR 1526 (EDGAR RD.) TO SR 1004 (HILLSVILLE RD.)	0.241	20		2,830.00		1,570		27		5,186	5,186			
TOTAL FOR MAP NO. 37					0.241			2,830.00		1,570		27		5,186	5,186			

PROJECT NO.	SHEET NO.	TOTAL NO.
8SP.20764.15	9	

SUMMARY OF QUANTITIES

PROJECT NO	COUNTY	MAP NO	ROUTE	DESCRIPTION	LENGTH MI	WIDTH FT	ASPHALT SURFACE TREATMENT, SLURRY SEAL SY	ASPHALT SURFACE TREATMENT, DOUBLE SEAL SY	ASPHALT SURFACE TREATMENT, SINGLE SEAL SY	EMULSION FOR ASPHALT SURFACE TREATMENT GAL	BLOTTING SAND TON	4413000000-E	4457000000-N	4810000000-E	4830000000-E	4835000000-E	4840000000-N		
												WORK ZONE ADVANCE/GENERAL WARNING SIGNING SF	TEMPORARY TRAFFIC CONTROL LS	4" WHITE PAINT LF	4" YELLOW PAINT LF	16" WHITE PAINT LF	24" WHITE PAINT LF	PAINT MSG RXR EA	
8SP.20764.15	Randolph	38	SR 1534 (ROY FARLOW RD.)	FROM SR 1004 (HILLSVILLE RD.) TO SR 1858 (J)OLD MARLBORO RD.)	1.86	20		21,830.00		12,015									
TOTAL FOR MAP NO. 38					1.86			21,830.00		12,015									
8SP.20764.15	Randolph	39	SR 1533 (PINEY FARLOW RD.)	FROM SR 1526 (EDGAR RD.) TO SR 1534 (ROY FARLOW RD.)	1.29	20		15,140.00		8,340									
TOTAL FOR MAP NO. 39					1.29			15,140.00		8,340									
8SP.20764.15	Randolph	40	SR 1002 (BENNETT RD.)	FROM SR 2871 (MANESS RD.) TO SR 2896 (PICKETTS MILL RD.)	2.91	20		34,150.00		18,800									
TOTAL FOR MAP NO. 40					2.91			34,150.00		18,800									
8SP.20764.15	Randolph	41	SR 1002 (FORK CREEK MILL RD.)	FROM SR 2907 (LITTLE BEANE STORE RD.) TO NC 705	5.6	20		65,710.00		36,150									
TOTAL FOR MAP NO. 41					5.6			65,710.00		36,150									
8SP.20764.15	Randolph	42	SR 2866 (BROWER MILL RD.)	FROM SR 2869 (MEADOWBRANCH RD.) TO SR 1003 (ERECT RD.)	2.44	20		28,640.00		15,760									
TOTAL FOR MAP NO. 42					2.44			28,640.00		15,760									
8SP.20764.15	Randolph	43	SR 2843 (CLYDE KING RD.)	FROM SR 2845 (OLD NC 13) TO SR 1002 (FORK CREEK MILL RD.)	3.36	20		39,430.00		21,700									
TOTAL FOR MAP NO. 43					3.36			39,430.00		21,700									
TOTAL FOR PROJ NO. 8SP.20764.15					47.236			26,190.00	526,540.00	26,190.00	299,085	50	5,311	1	847,939	847,939	50	50	2
													1,695,878						
GRAND TOTAL					47.236			26,190.00	526,540.00	26,190.00	299,085	50	5,311	1	847,939	847,939	50	50	2
													1,695,878						

SIGNING FOR ASPHALT SURFACE TREATMENT

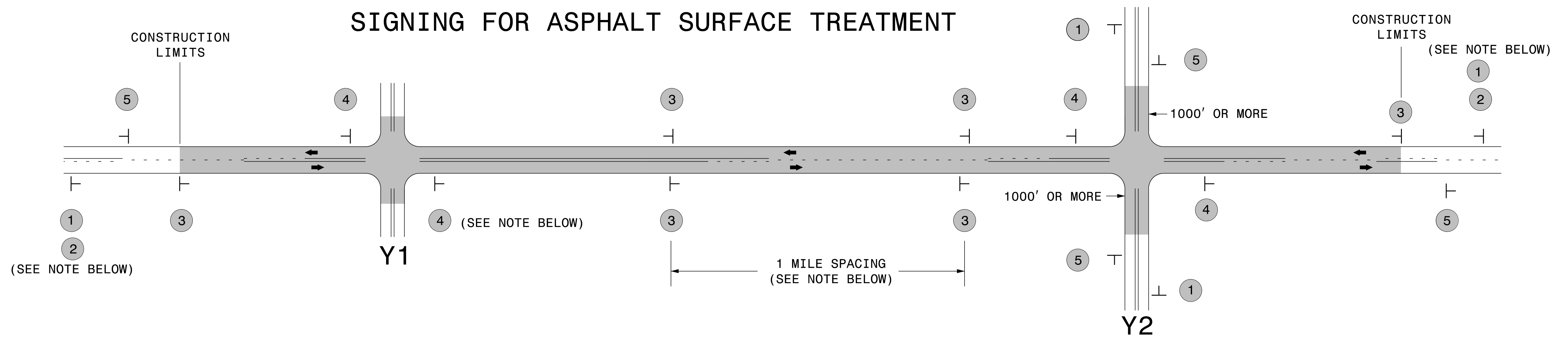

LEGEND	
	STATIONARY SIGN
←	DIRECTION OF TRAFFIC FLOW

MAINLINE (-L-) SIGNING

-Y- LINE SIGNING

SIGNING NOTES AND PLACEMENT PER DIRECTION	MAINLINE (-L-) SIGNING
1	<p>PLACE 1000' PRIOR TO BEGINNING OF CONSTRUCTION LIMITS. ONLY USED ON -Y- LINES IF RESURFACING LIMITS EXTEND 1000' ALONG -Y- LINE.</p>
2	<p>#2 SIGN ONLY USED WHEN RESURFACING LIMITS ARE 2 OR MORE MILES IN LENGTH. ROUND UP TO NEXT WHOLE NUMBER. (NO FRACTIONAL OR DECIMAL NUMBERS)</p>
3	<p>ALTERNATE THE FOLLOWING TWO SIGNS:</p> <p>STARTING WITH "LOOSE GRAVEL" (W8-7) FOLLOWED BY "UNMARKED PAVEMENT".</p> <p>PLACE INITIALLY AT THE CONSTRUCTION LIMITS AND SPACED 1 MILE APART THEREAFTER. IF NO -Y- LINES EXIST, PLACE 2ND SET 1/2 MILE FROM THE CONSTRUCTION LIMITS AND THEN SPACE 1 MILE THEREAFTER.</p>
4	<p>THESE ARE FOR -Y- LINES THAT ARE "THROUGH" ROADWAYS. DEAD END AND SUBDIVISION ROADS ARE NOT "THROUGH" ROADWAYS. INSTALL 500' +/- FROM EACH -Y- LINE APPROACH AS SHOWN ABOVE. FOR MULTIPLE -Y- LINES THAT ARE SEPARATED BY 0.25 MILES OR LESS, TREAT AS A SINGLE UNIT AND INSTALL WITHIN 500' OF EACH APPROACH. A MAXIMUM OF 2 SIGN SETS PER MILE. DO NOT INSTALL WHEN -Y- LINES ARE WITHIN 0.5 MILES FROM "END ROAD WORK" SIGN.</p>
5	<p>PLACE 500' FOLLOWING THE END OF CONSTRUCTION LIMITS.</p>

NO REQUIRED STATIONARY SIGNING FOR THE FOLLOWING -Y- LINE CONDITIONS:

- 1) LESS THAN 1000' OF RESURFACING ALONG -Y- LINE
- 2) SUBDIVISION ROADS
- 3) DEAD END ROADS

WHEN PAVING/CONSTRUCTION ACTIVITIES PROCEED ACROSS AN UNSIGNED -Y- LINE, ADVANCE WARNING PORTABLE SIGNS SHALL BE USED ALONG THE -Y- LINE AS SHOWN BELOW. REMOVE UPON COMPLETION OF WORK.

W20-1
48" X 48"

W20-7 A
48" X 48"

PLACED 500' IN ADVANCE OF FLAGGER. PLACED 250' IN ADVANCE OF FLAGGER.

**ADVANCE WARNING SIGNS
FOR
ASPHALT SURFACE TREATMENTS
2 LANE ROADWAYS**

12/22/2014 8:11:10 AM S:\TMU\WZTC\apps\work\zonegeneral\external\webpage\desres\resurfacing\resurfacing\advwarn_2Ln - AST.dgn User:rmgarr