

STATE OF NORTH CAROLINA

DIVISION OF HIGHWAYS

MOORE COUNTY

STATE	STATE PROJECT REFERENCE NO.	SHEET NO.	TOTAL SHEETS
N.C.		1	1

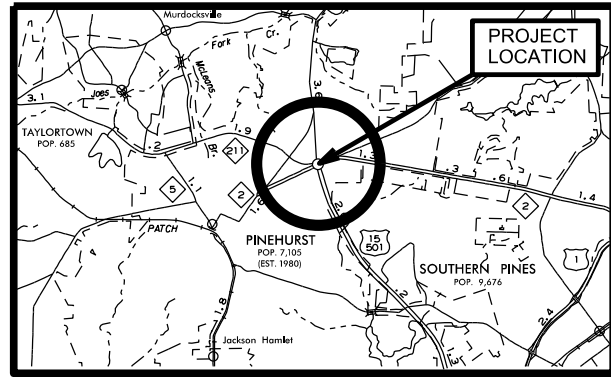

VICINITY MAP

CONVENTIONAL SYMBOLS	
County Line	-----
City or Town Line	-----
Exist. Right of Way Line Marker	-----▲-----
Prop. Right of Way Line Marker (By Others)	-----▲-----
Prop Right of Way Line Marker (By Contract)	-----▲-----
Exist. Control of Access Line	-----⊕-----
Prop. Control of Access Line	-----⊕-----
Property Line	-----E-----
Easement Line	-----E-----
Slope Stake Line	-----E-----
Exist. Fence	-----+-----
Prop. Woven Wire Fence	-----+-----
Prop. Chain Link Fence	-----+-----
Exist. Road	-----
Prop. Road	-----
Guardrail	-----
Survey Line	-----
Denotes Line Equality	-----
Bridge	-----
Culvert	-----
Railroad	-----
Woods	-----
Exist. Telephone Pole	-----●-----
Prop. Telephone Pole	-----○-----
Tower Pole and Line	-----
Exist. Power Pole	-----●-----
Prop. Power Pole	-----○-----
Sanitary Sewer Line	-----SS-----
Water Line	-----
Gas Line	-----
Picnic Shelter	-----
Regeneration	-----
Reforestation	-----
Large Deciduous Tree	-----
Evergreen Tree	-----
Small or Flowering Tree	-----
Shrubs	-----
Planting Bed	-----

Summary of Quantities

A) PLANT MATERIAL - Growing Contract (by others)						
Quantity	Unit	Key	Botanical Name	Common Name	Furnish	Spacing
56	Each Flat	ATY	Alternanthera ficoidea 'True Yellow'	Joseph's Coat	Flat of 18, Well rooted (1801)	10" O.C.
31	Each Flat	BRG	Begonia benariensis 'Big Red Green Leaf'	Big® Red Green Leaf Begonia	Flat of 18, Well rooted (1801)	12" O.C.
20	EA	CB	Colocasia esculenta 'Black Coral'	Black Coral Elephant Ear	#1 Cont.	36" O.C.
65	Each Flat	ISO	Impatiens x hybrida 'Sunpatiens Orange'	SunPatiens® Compact Orange	Flat of 8, Well rooted (5")	12" O.C.
92	EA	PF	Pennisetum setaceum 'Fireworks'	Fireworks Fountain Grass	#1 Cont.	24" O.C.
31	EA	PS	Pennisetum setaceum 'Sky Rocket'	Sky Rocket Fountain Grass	#1 Cont.	24" O.C.
41	Each Flat	PHP	Petunia x hybrida 'Tidal Wave Hot Pink'	Tidal Wave® Hot Pink Petunia	Flat of 18, Well rooted (1801)	10" O.C.
62	Each Flat	PTP	Petunia x hybrida 'Tidal Wave Purple'	Tidal Wave® Purple Petunia	Flat of 18, Well rooted (1801)	10" O.C.
99	Each Flat	PWW	Petunia x hybrida 'Easy Wave White'	Easy Wave® White Petunia	Flat of 18, Well rooted (1801)	10" O.C.
25	Each Flat	SC	Senecio cineraria	Silverdust Dusty Miller	Flat of 18, Well rooted (1801)	10" O.C.
1	EA		Delivery			

Notes:

The contractor and the engineer will coordinate the delivery of the annuals prior to installation. The proposed time schedule and the desired delivery locations will be agreed upon prior to the initiation of work.

The total number of annuals, as noted above, will include an additional 10% for replacements to be used ONLY as directed by the NCDOT engineer.

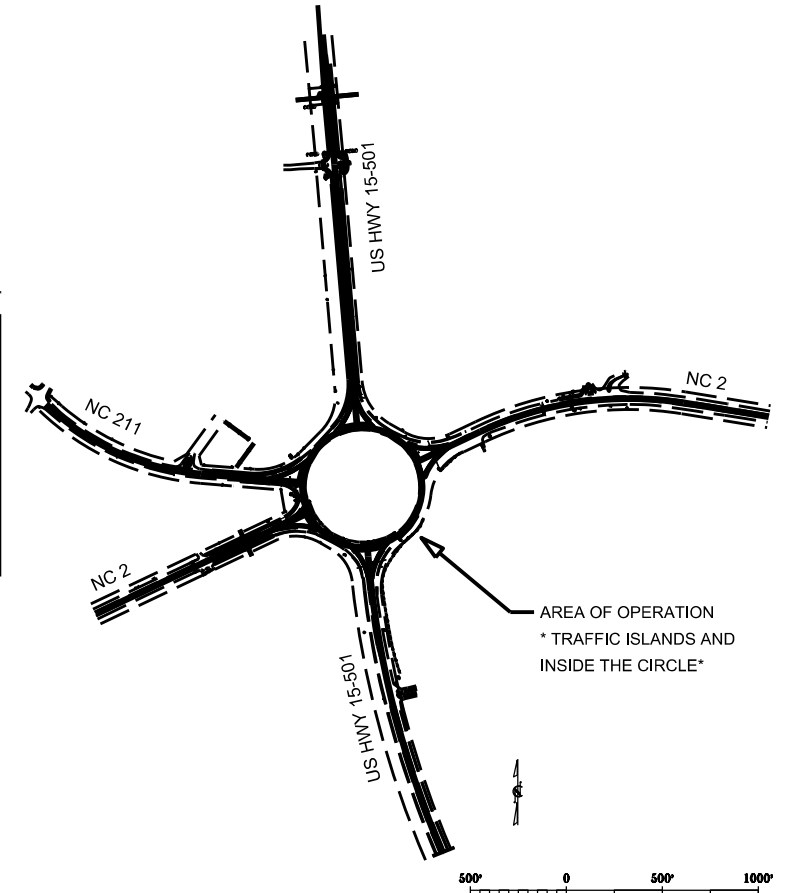

**2019 SPRING
ANNUALS
PLANTING**

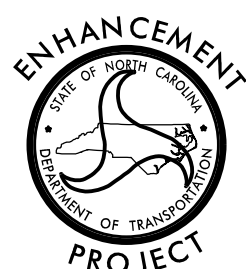

INDEX OF SHEETS :

TITLE, DESCRIPTION, & SUMMARY OF QUANTITIES	L1
CIRCLE LAYOUT & BED QUANTITIES	L2
DETAIL A & B PLAN	L3
DETAIL C, D, & E PLAN	L4

**ROADSIDE ENVIRONMENTAL UNIT
DEPARTMENT OF TRANSPORTATION
DIVISION OF HIGHWAYS
RALEIGH, N.C.**

2018 STANDARD SPECIFICATIONS

Drawn By: SKC Aesthetic Engineering Section May 8, 2018

NOTES:

THE CONTRACTOR SHALL CONSULT THE DIVISION'S SPECIAL PROVISIONS FOR PROCEDURES FOR PREPARING ANNUAL BEDS, INSTALLATION, FUMIGATION, AND PLANT BED AMENDMENTS. THE INSTALLATION SHALL NOT TAKE PLACE UNTIL THESE SPECIAL PROVISIONS ARE REVIEWED AND AGREED UPON.

ALL ANNUALS SHALL BE SPACED ON 12" AND/OR 8" CENTERS. ANNUALS SHALL BE PLANTED AT THE PROPER DEPTH ACCORDING TO THE SOIL LEVEL. THE SOIL SHALL BE FIRMLY PLACED AROUND THE PLANTS, AND 2" OF SOIL AMENDMENTS SHALL BE ADDED TO EACH PLANT BED AS DIRECTED BY THE ENGINEER IN THE FIELD. MULCH SHALL BE APPLIED TO THE BEDS AFTER PLANTING IS COMPLETE. THE CONTRACTOR SHALL COORDINATE WITH THE ENGINEER TO DETERMINE THE PREFERRED DELIVERY DATES AND THE APPROPRIATE QUANTITIES OF ANNUALS FOR EACH PLANT BED AREA.

ALL PLANTS SHALL BE WATERED IN IMMEDIATELY FOLLOWING THE PLANTING OPERATION. NO PORTION OF PLANTING SHALL GO UNWATERED OVERNIGHT. WATER THE SAME DAY AS THE PLANT INSTALLATION.

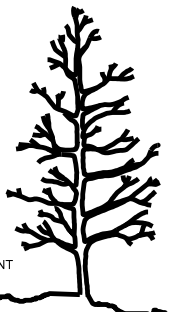

ISLAND REFERENCE KEY

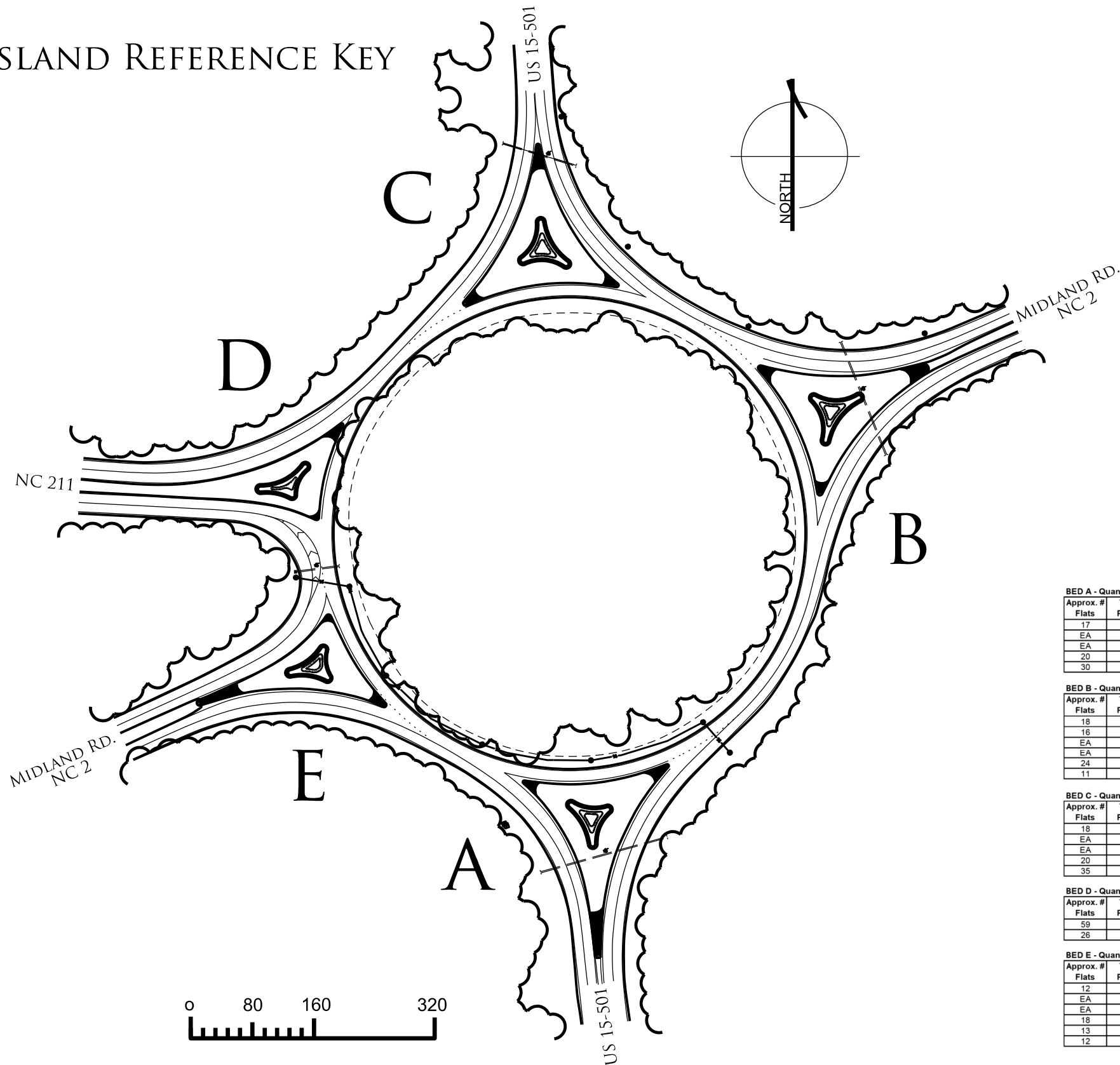

QUANTITY OF ANNUALS PER PLANT BED

BED A - Quantities

Approx. # Flats	Total Plants	Key	Plant Name	Common Name	Furnish	Spacing
17	294	ATY	Alternanthera ficoidea 'True Yellow'	Joseph's Coat	Flat of 18, Well rooted (1801)	10" O.C.
EA	8	CB	Colocasia esculenta 'Black Coral'	Black Coral Elephant Ear	#1 Cont.	36" O.C.
EA	17	PF	Pennisetum setaceum 'Fireworks'	Fireworks Fountain Grass	#1 Cont.	24" O.C.
20	355	PTP	Petunia x hybrida 'Tidal Wave Purple'	Tidal Wave® Purple Petunia	Flat of 18, Well rooted (1801)	10" O.C.
30	531	PWW	Petunia x hybrida 'Easy Wave White'	Easy Wave® White Petunia	Flat of 18, Well rooted (1801)	10" O.C.

BED B - Quantities

Approx. # Flats	Total Plants	Key	Plant Name	Common Name	Furnish	Spacing
18	312	ATY	Alternanthera ficoidea 'True Yellow'	Joseph's Coat	Flat of 18, Well rooted (1801)	10" O.C.
16	289	BRG	Begonia benariensis 'Big Red Green Leaf'	Big® Red Green Leaf Begonia	Flat of 18, Well rooted (1801)	12" O.C.
EA	30	PF	Pennisetum setaceum 'Fireworks'	Fireworks Fountain Grass	#1 Cont.	24" O.C.
EA	18	PS	Pennisetum setaceum 'Sky Rocket'	Sky Rocket Fountain Grass	#1 Cont.	24" O.C.
24	419	PTP	Petunia x hybrida 'Tidal Wave Purple'	Tidal Wave® Purple Petunia	Flat of 18, Well rooted (1801)	10" O.C.
11	191	SC	Senecio cineraria	Silverdust Dusty Miller	Flat of 18, Well rooted (1801)	10" O.C.

BED C - Quantities

Approx. # Flats	Total Plants	Key	Plant Name	Common Name	Furnish	Spacing
18	310	ATY	Alternanthera ficoidea 'True Yellow'	Joseph's Coat	Flat of 18, Well rooted (1801)	10" O.C.
EA	12	CB	Colocasia esculenta 'Black Coral'	Black Coral Elephant Ear	#1 Cont.	36" O.C.
EA	24	PF	Pennisetum setaceum 'Fireworks'	Fireworks Fountain Grass	#1 Cont.	24" O.C.
20	347	PHP	Petunia x hybrida 'Tidal Wave Hot Pink'	Tidal Wave® Hot Pink Petunia	Flat of 18, Well rooted (1801)	10" O.C.
35	617	PWW	Petunia x hybrida 'Easy Wave White'	Easy Wave® White Petunia	Flat of 18, Well rooted (1801)	10" O.C.

BED D - Quantities

Approx. # Flats	Total Plants	Key	Plant Name	Common Name	Furnish	Spacing
59	469	ISO	Impatiens x hybrida 'Sunpatiens Orange'	SunPatiens® Compact Orange	Flat of 8, Well rooted (5")	12" O.C.
26	468	PWW	Petunia x hybrida 'Easy Wave White'	Easy Wave® White Petunia	Flat of 18, Well rooted (1801)	10" O.C.

BED E - Quantities

Approx. # Flats	Total Plants	Key	Plant Name	Common Name	Furnish	Spacing
12	212	BRG	Begonia benariensis 'Big Red Green Leaf'	Big® Red Green Leaf Begonia	Flat of 18, Well rooted (1801)	12" O.C.
EA	21	PF	Pennisetum setaceum 'Fireworks'	Fireworks Fountain Grass	#1 Cont.	24" O.C.
EA	13	PS	Pennisetum setaceum 'Sky Rocket'	Sky Rocket Fountain Grass	#1 Cont.	24" O.C.
18	319	PHP	Petunia x hybrida 'Tidal Wave Hot Pink'	Tidal Wave® Hot Pink Petunia	Flat of 18, Well rooted (1801)	10" O.C.
13	233	PTP	Petunia x hybrida 'Tidal Wave Purple'	Tidal Wave® Purple Petunia	Flat of 18, Well rooted (1801)	10" O.C.
12	213	SC	Senecio cineraria	Silverdust Dusty Miller	Flat of 18, Well rooted (1801)	10" O.C.



NCDOT - ROADSIDE ENVIRONMENTAL UNIT
 LANDSCAPE DESIGN & DEVELOPMENT
 1557 MAIL SERVICE CENTER RALEIGH NC 27699-1557
 PH: 919-707-2935 FAX: 919-715-2554
[HTTP://WWW.NCDOT.ORG/DOH/OPERATIONS/DP_CHIEF_ENG/ROADSIDE/](http://www.ncdot.org/DOH/OPERATIONS/DP_CHIEF_ENG/ROADSIDE/)

PINEHURST TRAFFIC CIRCLE
 2019 SPRING ANNUALS PLANTING
 CONTRACT #:

PREPARED BY:
 Kyle Cooper

PREL. DESIGN DATE: MAY 2018
 CHECKED BY & DATE:
 FINAL DESIGN DATE: MAY 2018

TRAFFIC CIRCLE ISLANDS
 CIRCLE REFERENCE KEY

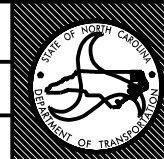

T.I.P. #
 WBS #
 FED I.D. #
 SHEET NO.: L-2 TOTAL SHEET NO.: 4

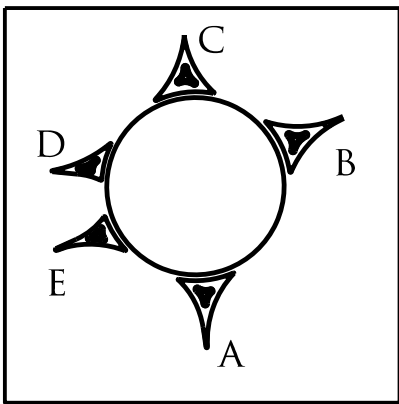

A
US 15-501 SOUTH

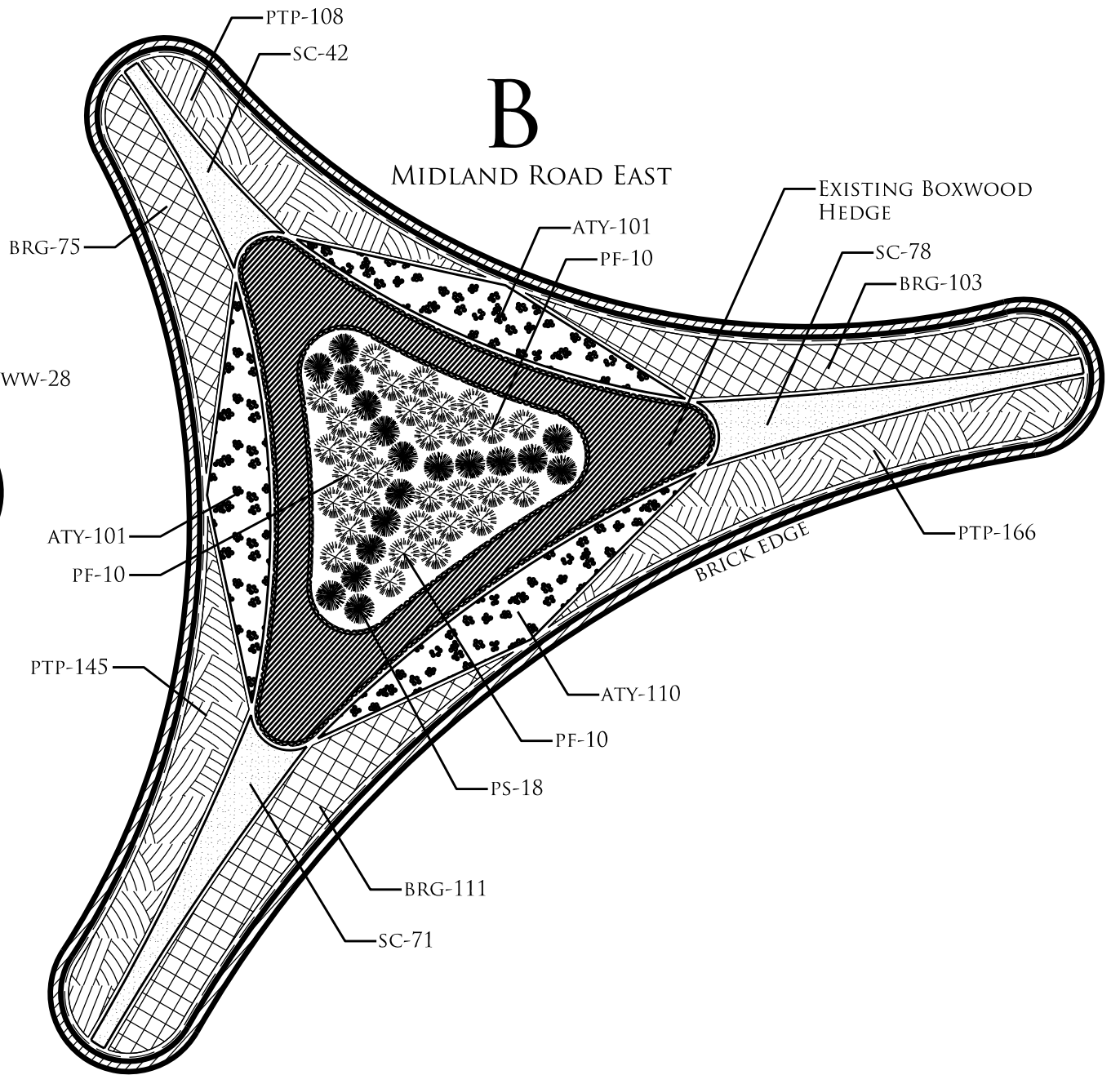
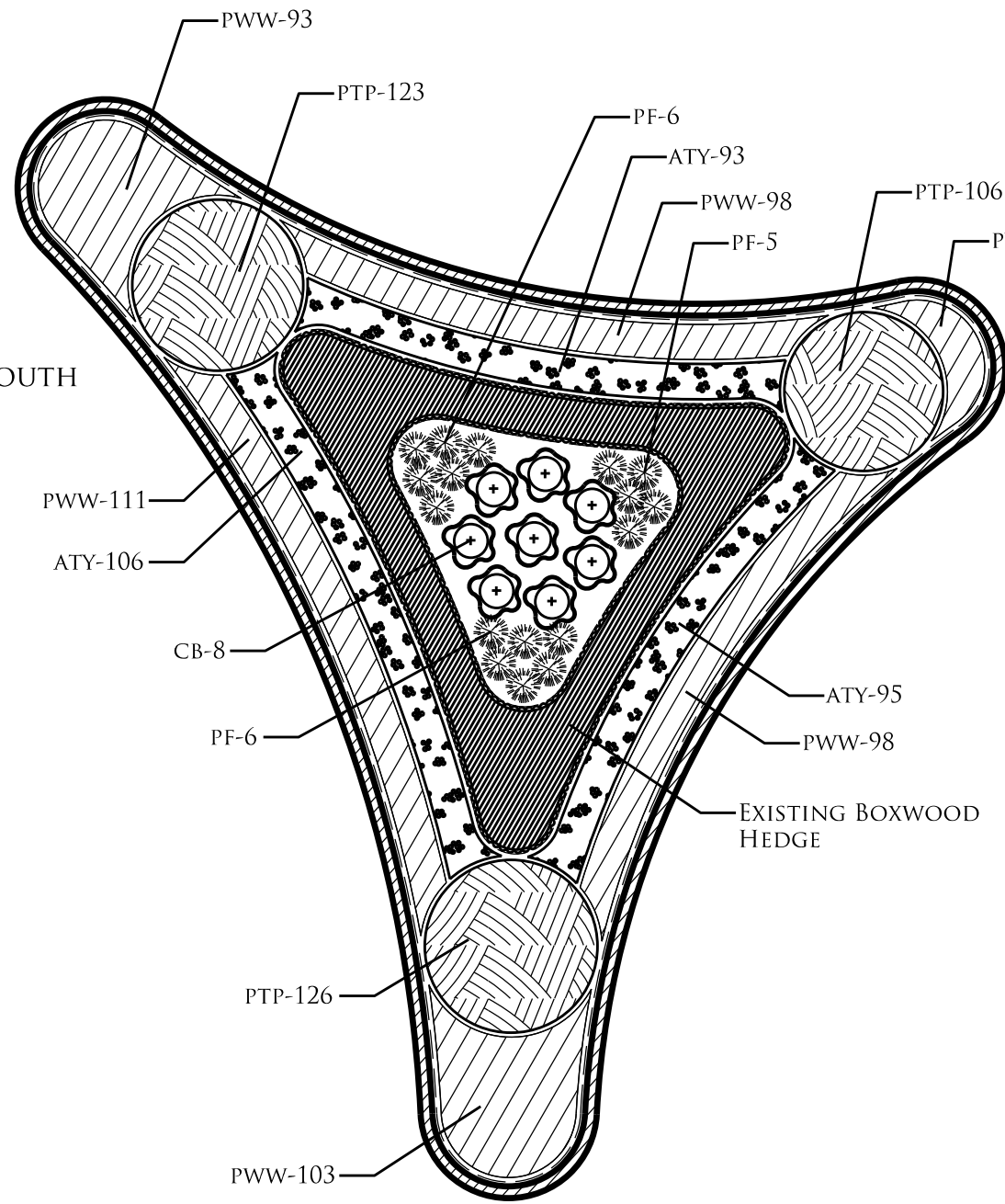

B
MIDLAND ROAD EAST

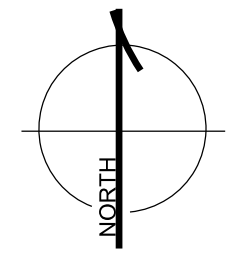

NCDOT - ROADSIDE ENVIRONMENTAL UNIT
LANDSCAPE DESIGN & DEVELOPMENT
1557 MAIL SERVICE CENTER RALEIGH NC 27699-1557
PH: 919-707-2935 FAX: 919-715-2554
[HTTP://WWW.NCDOT.ORG/DOH/OPERATIONS/DP_CHIEF_ENG/ROADSIDE/](http://www.ncdot.org/DOH/OPERATIONS/DP_CHIEF_ENG/ROADSIDE/)

PINEHURST TRAFFIC CIRCLE
2019 SPRING ANNUALS PLANTING
CONTRACT #:

PREPARED BY
Kyle Cooper

SHEET DESCRIPTION:	PREL. DESIGN DATE: MAY 2018
	CHECKED BY & DATE:
	FINAL DESIGN DATE: MAY 2018

TRAFFIC CIRCLE ISLANDS
INTERIOR PLANT BEDS
ISLANDS A & B

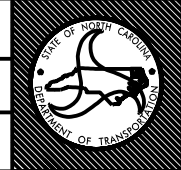

T.I.P. #	
WBS #	
FED I.D. #	
SHEET NO. L-3	TOTAL SHEET NO. 4

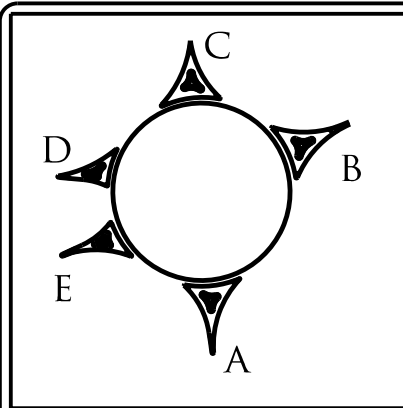

C
US 15-501 NORTH

D
NC 211 WEST

E
MIDLAND ROAD WEST

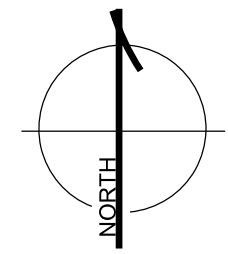
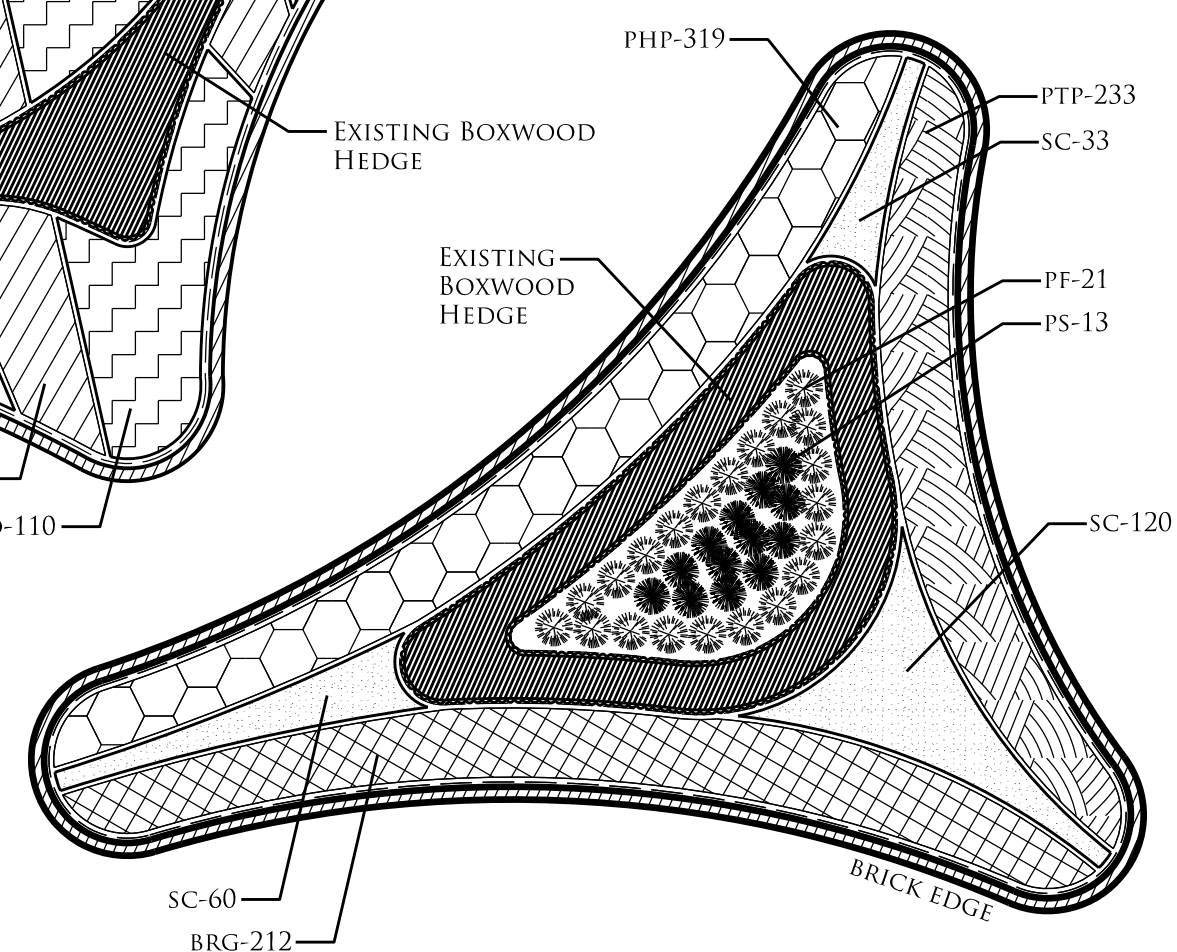
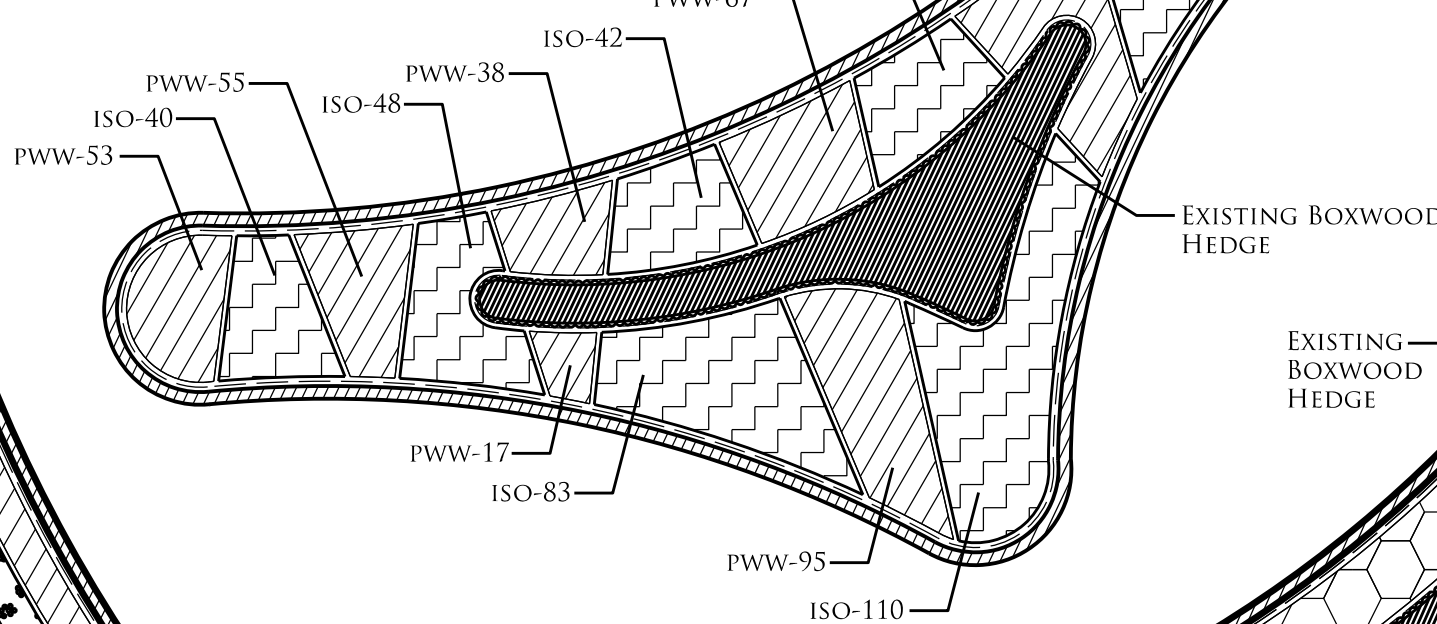
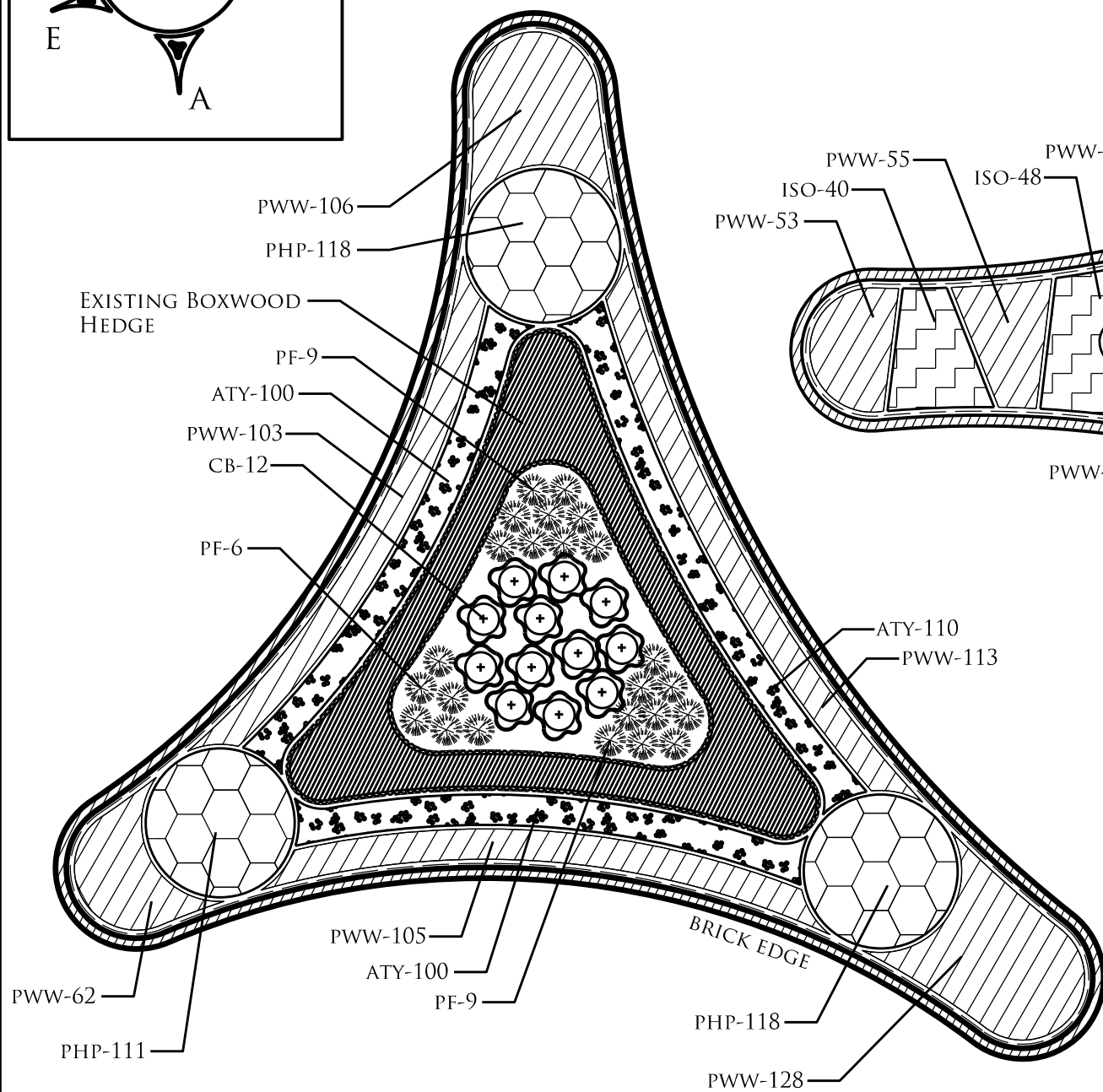

NCDOT - ROADSIDE ENVIRONMENTAL UNIT
LANDSCAPE DESIGN & DEVELOPMENT
1557 MAIL SERVICE CENTER RALEIGH NC 27699-1557
PH: 919-707-2935 FAX: 919-715-2554
[HTTP://WWW.NCDOT.ORG/DOH/OPERATIONS/DP_CHIEF_ENG/ROADSIDE/](http://www.ncdot.org/DOH/OPERATIONS/DP_CHIEF_ENG/ROADSIDE/)

PINEHURST TRAFFIC CIRCLE
2019 SPRING ANNUALS PLANTING
CONTRACT #:

PREU. DESIGNER
Kyle Cooper

SHEET DESCRIPTION:	PREL. DESIGN DATE: MAY 2018	TRAFFIC CIRCLE ISLANDS
	CHECKED BY & DATE:	INTERIOR PLANT BEDS
	FINAL DESIGN DATE: MAY 2018	ISLANDS C, D, & E

T.I.P. #	
WBS #	
FED I.D. #	
SHEET NO.:	TOTAL SHEET NO.:
L-4	4

