

STATE OF NORTH CAROLINA
DIVISION OF HIGHWAYS

TRANSPORTATION MANAGEMENT PLAN

FORSYTH COUNTY

DIVISION 9



FORSYTH CO. BRIDGE #115 - US 52/US 31/NC 8 (JOHN GOLD MEMORIAL EXPY.) OVER SR 4315 (WAUGHTOWN ST)

SHEET NO.
TMP-1

INDEX OF SHEETS

SHEET NO.	TITLE
TMP-1	TITLE SHEET AND INDEX OF SHEETS
TMP-1A	LIST OF APPLICABLE ROADWAY STANDARD DRAWINGS, AND LEGEND
TMP-2	TRANSPORTATION OPERATIONS PLAN: TRAFFIC MANAGEMENT STRATEGY AND GENERAL NOTES
TMP-3	TEMPORARY TRAFFIC CONTROL PHASING
TMP-4	FORSYTH CO. BRIDGE #115 - SR 4315 (WAUGHTOWN ST.) LEFT LANE CLOSURES
TMP-5	FORSYTH CO. BRIDGE #115 - SR 4315 (WAUGHTOWN ST.) RIGHT LANE CLOSURES

4/10/2015
User: C:\TrafficControl\BP 5500GG ForSyth\TMP\Plan Sheets\BP-5500GG-TMP-1.dwg
angood



N.C.D.O.T. WORK ZONE TRAFFIC CONTROL
1561 MAIL SERVICE CENTER (MSC) RALEIGH, NC 27699-1561
750 N. GREENFIELD PARKWAY, GARNER, NC 27529 (DELIVERY)
PHONE: (919) 773-2800 FAX: (919) 771-2745

D. W. BISSETTE, PE CENTRAL WORK ZONE TRAFFIC CONTROL ENGINEER

MIKE STEELMAN TRAFFIC CONTROL PROJECT DESIGN ENGINEER

D. ALLEN HAYES, EI TRAFFIC CONTROL DESIGN ENGINEER



Stantec
Stantec Consulting Services Inc.
801 Jones Franklin Rd-Suite 300
Raleigh, NC 27608
Tel. 919.851.6888
Fax. 919.851.7024
www.stantec.com
License No. F-0872

BETSY L. WATSON, PE
SENIOR TRANSPORTATION ENGINEER

GEORGE M. KARAGEORGE, PE
SENIOR TRANSPORTATION ENGINEER

ANDREW N. GOOD
TRAFFIC TECHNICIAN

APPROVED: _____
DATE: _____

SEAL

BP-5500GG

GENERAL NOTES

CHANGES MAY BE REQUIRED WHEN PHYSICAL DIMENSIONS IN THE DETAIL DRAWINGS, STANDARD DETAILS, AND ROADWAY DETAILS ARE NOT ATTAINABLE TO MEET FIELD CONDITIONS OR RESULT IN DUPLICATE OR UNDESIRABLE OVERLAPPING OF DEVICES. MODIFICATION MAY INCLUDE: MOVING, SUPPLEMENTING, COVERING, OR REMOVAL OF DEVICES AS DIRECTED BY THE ENGINEER.

THE FOLLOWING GENERAL NOTES APPLY AT ALL TIMES FOR THE DURATION OF THE CONSTRUCTION PROJECT EXCEPT WHEN OTHERWISE NOTED IN THE PLAN OR DIRECTED BY THE ENGINEER.

TIME RESTRICTIONS

A) DO NOT CLOSE OR NARROW TRAVEL LANES AS FOLLOWS:

ROAD NAME	DAY AND TIME RESTRICTIONS
US 52	6:00 A.M.-8:00 P.M. MONDAY THRU SUNDAY (EVERY DAY)
SR 4315 (WAUGHTOWN ST)	6:00 A.M.-7:00 P.M. MONDAY THRU SUNDAY (EVERY DAY)

B) DO NOT CLOSE OR NARROW TRAVEL LANES DURING HOLIDAYS AND SPECIAL EVENTS AS FOLLOWS:

ROAD NAME
ALL ROADS

HOLIDAY

- 1) FOR ANY UNEXPECTED OCCURRENCE THAT CREATES UNUSUALLY HIGH TRAFFIC VOLUMES, AS DIRECTED BY THE ENGINEER.
- 2) FOR NEW YEAR'S, BETWEEN THE HOURS OF 6:00 A.M. DECEMBER 31ST TO 8:00 P.M. JANUARY 2ND. IF NEW YEAR'S DAY IS ON A FRIDAY, SATURDAY, SUNDAY, OR MONDAY THEN UNTIL 8:00 P.M. THE FOLLOWING TUESDAY.
- 3) FOR EASTER, BETWEEN THE HOURS OF 6:00 A.M. THURSDAY AND 8:00 P.M. MONDAY.
- 4) FOR MEMORIAL DAY, BETWEEN THE HOURS OF 6:00 A.M. FRIDAY TO 8:00 P.M. TUESDAY.
- 5) FOR INDEPENDENCE DAY, BETWEEN THE HOURS OF 6:00 A.M. THE DAY BEFORE INDEPENDENCE DAY AND 8:00 P.M. THE DAY AFTER INDEPENDENCE DAY. IF INDEPENDENCE DAY IS ON A FRIDAY, SATURDAY, SUNDAY OR MONDAY; THEN BETWEEN THE HOURS OF 6:00 A.M. THE THURSDAY BEFORE INDEPENDENCE DAY AND 8:00 P.M. THE TUESDAY AFTER INDEPENDENCE DAY.
- 6) FOR LABOR DAY, BETWEEN THE HOURS OF 6:00 A.M. FRIDAY AND 8:00 P.M. TUESDAY.
- 7) FOR THANKSGIVING DAY, BETWEEN THE HOURS OF 6:00 A.M. TUESDAY TO 8:00 P.M. MONDAY.
- 8) FOR CHRISTMAS, BETWEEN THE HOURS OF 6:00 A.M. THE FRIDAY BEFORE THE WEEK OF CHRISTMAS DAY AND 8:00 P.M. THE FOLLOWING TUESDAY AFTER THE WEEK OF CHRISTMAS.
- 9) FOR BB&T BALLPARK EVENTS (WINSTON-SALEM DASH GAMES), WINSTON-SALEM AIR SHOW, WAKE FOREST UNIVERSITY EVENTS, LAWRENCE JOEL VETERANS MEMORIAL COLISEUM EVENTS, BB&T FIELD EVENTS, WINSTON-SALEM STATE UNIVERSITY EVENTS, BOWMAN GREY STADIUM EVENTS, DIXIE CLASSIC FAIR, AND ANY OTHER EVENTS AS DETERMINED BY THE ENGINEER, FOR THREE (3) HOURS BEFORE THE EVENT AND THREE (3) HOURS FOLLOWING THE EVENT.

LANE AND SHOULDER CLOSURE REQUIREMENTS

- C) REMOVE LANE CLOSURE DEVICES FROM THE LANE WHEN WORK IS NOT BEING PERFORMED BEHIND THE LANE CLOSURE OR WHEN A LANE CLOSURE IS NO LONGER NEEDED OR AS DIRECTED BY THE ENGINEER.
- D) WHEN PERSONNEL AND/OR EQUIPMENT ARE WORKING WITHIN 15 FT OF AN OPEN TRAVEL LANE, CLOSE THE NEAREST OPEN SHOULDER USING ROADWAY STANDARD DRAWING NO. 1101.04 UNLESS THE WORK AREA IS PROTECTED BY BARRIER OR GUARDRAIL OR A LANE CLOSURE IS INSTALLED.
- E) WHEN PERSONNEL AND/OR EQUIPMENT ARE WORKING ON THE SHOULDER ADJACENT TO AN UNDIVIDED FACILITY AND WITHIN 5 FT OF AN OPEN TRAVEL LANE, CLOSE THE NEAREST OPEN TRAVEL LANE USING ROADWAY STANDARD DRAWING NO. 1101.02 UNLESS THE WORK AREA IS PROTECTED BY BARRIER OR GUARDRAIL.
- F) WHEN PERSONNEL AND/OR EQUIPMENT ARE WORKING WITHIN A LANE OF TRAVEL OF AN UNDIVIDED OR DIVIDED FACILITY, CLOSE THE LANE ACCORDING TO THE TRANSPORTATION MANAGEMENT PLANS, ROADWAY STANDARD DRAWINGS, OR AS DIRECTED BY THE ENGINEER. CONDUCT THE WORK SO THAT ALL PERSONNEL AND/OR EQUIPMENT REMAIN WITHIN THE CLOSED TRAVEL LANE.
- G) DO NOT WORK SIMULTANEOUSLY WITHIN 15 FT ON BOTH SIDES OF AN OPEN TRAVELWAY, RAMP, OR LOOP WITHIN THE SAME LOCATION UNLESS PROTECTED WITH GUARDRAIL OR BARRIER.

TRAFFIC PATTERN ALTERATIONS

- H) NOTIFY THE ENGINEER TWENTY ONE (21) CALENDAR DAYS PRIOR TO ANY TRAFFIC PATTERN ALTERATION.

SIGNING

- I) PROVIDE SIGNING AND DEVICES REQUIRED TO CLOSE THE ROAD ACCORDING TO THE ROADWAY STANDARD DRAWINGS AND TRANSPORTATION MANAGEMENT PLANS.
- J) COVER OR REMOVE ALL SIGNS AND DEVICES REQUIRED TO CLOSE THE ROAD WHEN ROAD CLOSURE IS NOT IN OPERATION.
- K) ENSURE ALL NECESSARY SIGNING IS IN PLACE PRIOR TO ALTERING ANY TRAFFIC PATTERN.

TRAFFIC CONTROL DEVICES

- L) WHEN LANE CLOSURES ARE NOT IN EFFECT SPACE CHANNELIZING DEVICES IN WORK AREAS NO GREATER IN FEET THAN TWICE THE POSTED SPEED LIMIT (MPH), EXCEPT 10 FT ON-CENTER IN RADII, AND 3 FT OFF THE EDGE OF AN OPEN TRAVELWAY. REFER TO STANDARD SPECIFICATIONS FOR ROADS AND STRUCTURES SECTIONS 1130 (DRUMS), 1135 (CONES) AND 1180 (SKINNY DRUMS) FOR ADDITIONAL REQUIREMENTS.
- M) PLACE TYPE III BARRICADES WITH "ROAD CLOSED" SIGN R11-2 ATTACHED, OF SUFFICIENT LENGTH TO CLOSE ENTIRE ROADWAY.

PAVEMENT MARKINGS AND MARKERS

- N) IF NEEDED, INSTALL TEMPORARY PAVEMENT MARKINGS AND TEMPORARY PAVEMENT MARKERS ON INTERIM LAYERS OF PAVEMENT AS FOLLOWS:

ROAD NAME	MARKING	MARKER
US 52	PAINT	TEMPORARY RAISED

- O) PLACE ONE APPLICATION OF PAINT FOR TEMPORARY TRAFFIC PATTERNS. PLACE A SECOND APPLICATION OF PAINT SIX (6) MONTHS AFTER THE INITIAL APPLICATION AND EVERY SIX MONTHS AS DIRECTED BY THE ENGINEER.
- P) TIE PROPOSED PAVEMENT MARKING LINES TO EXISTING PAVEMENT MARKING LINES.
- Q) REMOVE/REPLACE ANY CONFLICTING/DAMAGED PAVEMENT MARKINGS AND MARKERS BEFORE OPENING TO TRAFFIC.



MISCELLANEOUS

- R) ENSURE THE OVERSIZED/OVERWEIGHT PERMIT UNIT (919) 733-4740 HAS BEEN ADVISED OF THE ONGOING TRAFFIC OPERATIONS THROUGH THE DIVISION OFFICE.

TRAFFIC MANAGEMENT STRATEGY

BRIDGE PAINTING AND REPAIR OPERATIONS WILL BE ACCOMPLISHED USING TIME RESTRICTED LANE CLOSURES.

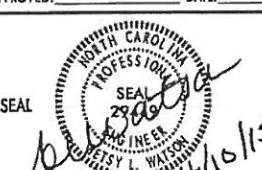
4/10/2015 11:21:01 AM C:\Users\jwalsh\Documents\Projects\BP-5500GG-TMP-02-TRANSF OF PLAN.dgn

 Stantec Consulting Services Inc. 801 Jones Franklin Road-Suite 300 Raleigh, NC 27606 Tel (919) 851-8866 Fax (919) 851-7024 www.stantec.com License No. F-0672	APPROVED: _____ DATE: _____			TRANSPORTATION OPERATIONS PLAN
	SEAL			

PHASING

FORSYTH COUNTY BRIDGE #115 - US 52/US 311/NC 8
OVER SR 4315 (WAUGHTOWN STREET)



INSTALL WORK ZONE ADVANCE WARNING SIGNS ON US 52/US 311/NC 8 AND SR 4315 (WAUGHTOWN STREET) PER RSD 1101.01.

TO COMPLETE WORK UNDER THE BRIDGE, USE LANE CLOSURES ON SR 4315 (WAUGHTOWN ST) PER SHEETS TMP-6 AND TMP-6A.

USE LANE CLOSURES ON US 52/US 311/NC 8 PER ROADWAY STANDARD DRAWING 1101.02 SHEETS 4, 5, AND/OR 6, AS NECESSARY TO COMPLETE PRESERVATION AND/OR SECURE CONTAINMENT. REFER TO LANE CLOSURE TIME RESTRICTIONS ON SHEET TMP-2.

COORDINATE US 52 LANE CLOSURES WITH CONTRACTOR FOR U-2925 (SALEM CREEK CONNECTOR).

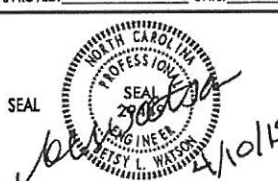
4/9/2015 10:00:00 AM C:\Traffic\Traffic\Control\BP 5500GG Forsyth\TMP\Phen Sheet\BP-5500GG.TMP_03.dwg

 <p>Stantec</p> <p><small>Stantec Consulting Services Inc. 801 Jones Franklin Road-Suite 300 Raleigh, NC 27606 Tel (919) 851-8888 Fax (919) 851-7024 www.stantec.com License No F-0672</small></p>	<p>APPROVED: _____ DATE: _____</p> <p>SEAL</p>  <p style="text-align: right;">4/10/15</p>		<p>PHASING</p>
--	--	---	----------------

LET LANE
CLOSED
AHEAD

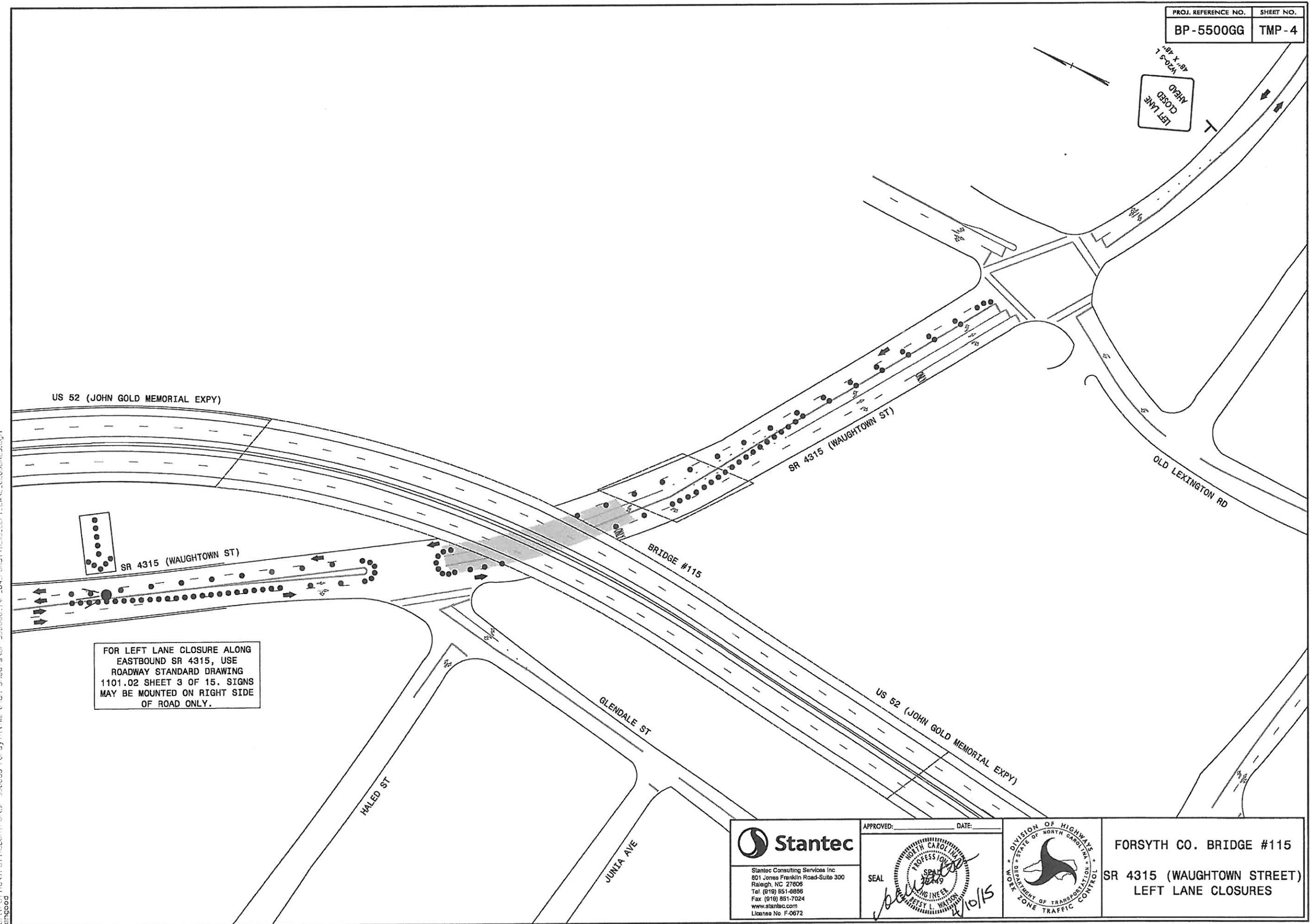

FOR LEFT LANE CLOSURE ALONG
EASTBOUND SR 4315, USE
ROADWAY STANDARD DRAWING
1101.02 SHEET 3 OF 15. SIGNS
MAY BE MOUNTED ON RIGHT SIDE
OF ROAD ONLY.

I:\Projects\TrafficControl\BP_5500GG_Forsyth\TMP\Plan_Sheet\SR-5500GG-TMP_04_FORSYTH_US_LEFT_LANE_CLOSURE.dgn
 4/10/15
 L:\Projects\TrafficControl\BP_5500GG_Forsyth\TMP\Plan_Sheet\SR-5500GG-TMP_04_FORSYTH_US_LEFT_LANE_CLOSURE.dgn

Stantec
 Stantec Consulting Services Inc
 801 Jones Franklin Road-Suite 300
 Raleigh, NC 27608
 Tel: (919) 851-8886
 Fax: (919) 851-7024
 www.stantec.com
 License No. F-0672

APPROVED: _____ DATE: _____
 SEAL

DIVISION OF HIGHWAYS
 STATE OF NORTH CAROLINA

 DEPARTMENT OF TRANSPORTATION
 WORK ZONE TRAFFIC CONTROL

FORSYTH CO. BRIDGE #115
 SR 4315 (WAUGHTOWN STREET)
 LEFT LANE CLOSURES

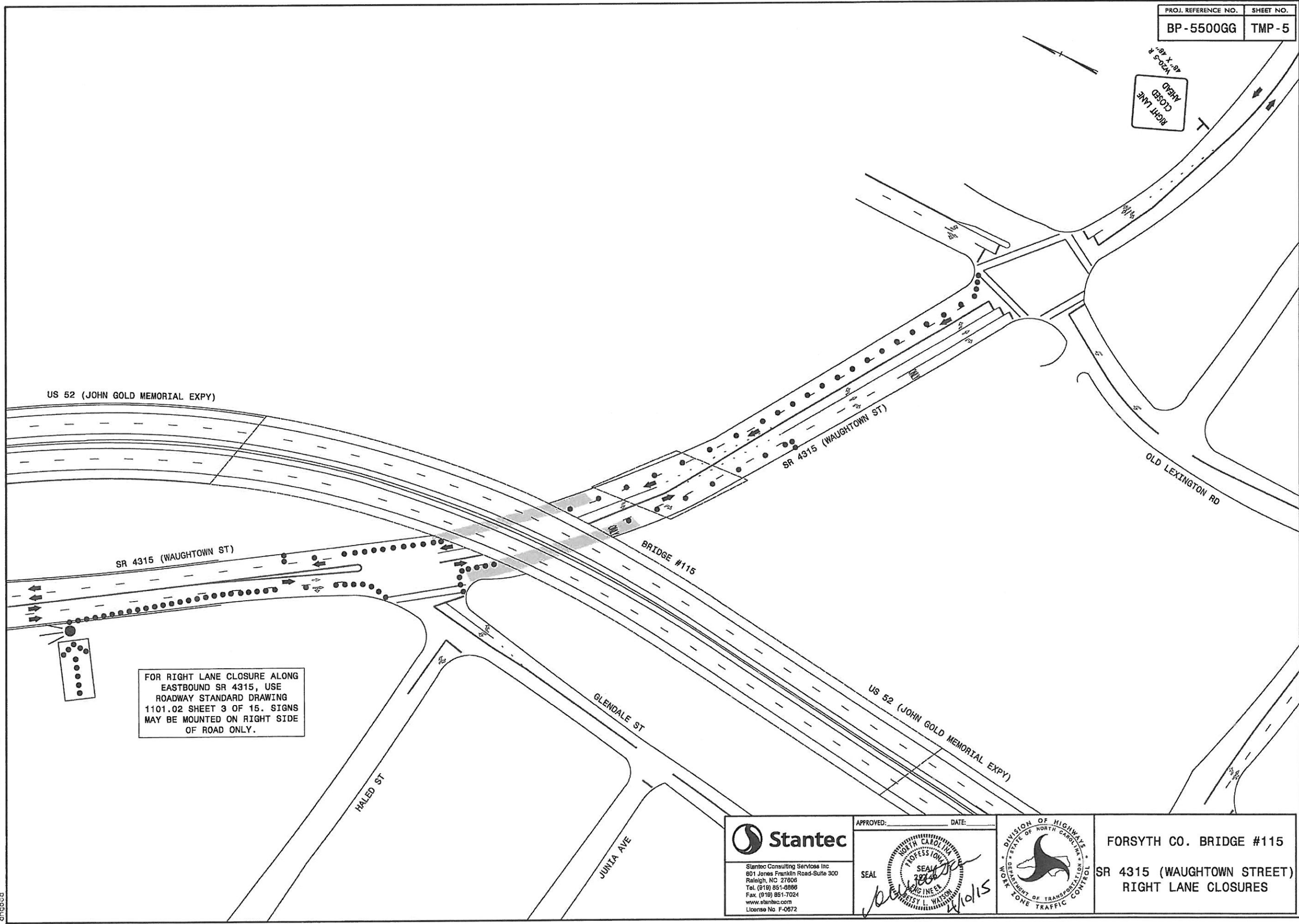

US 52 (JOHN GOLD MEMORIAL EXPY)

SR 4315 (WAUGHTOWN ST)

SR 4315 (WAUGHTOWN ST)

BRIDGE #115

OLD LEXINGTON RD

GLENDALE ST

US 52 (JOHN GOLD MEMORIAL EXPY)

HALED ST

JUNIA AVE

FOR RIGHT LANE CLOSURE ALONG EASTBOUND SR 4315, USE ROADWAY STANDARD DRAWING 1101.02 SHEET 3 OF 15. SIGNS MAY BE MOUNTED ON RIGHT SIDE OF ROAD ONLY.

4/10/2015
 Us:\Traffic\tr\BP-5500GG_Forsyth\TMP-5.dwg
 User: jwatson
 Plot: 11x17

Stantec
 Stantec Consulting Services Inc
 601 Jones Franklin Road-Suite 300
 Raleigh, NC 27606
 Tel. (919) 851-8866
 Fax. (919) 851-7024
 www.stantec.com
 License No. F-0672

APPROVED: _____ DATE: _____
 SEAL

DIVISION OF HIGHWAYS
 STATE OF NORTH CAROLINA

 DEPARTMENT OF TRANSPORTATION
 WORK ZONE TRAFFIC CONTROL

FORSYTH CO. BRIDGE #115
 SR 4315 (WAUGHTOWN STREET)
 RIGHT LANE CLOSURES