

STATE	STATE PROJECT REFERENCE NO.	SHEET NO.	TOTAL SHEETS
N.C.	COUNTRY CLUB RD	1	3
STATE PROJ. NO.	F.A. PROJ. NO.	DESCRIPTION	

STATE OF NORTH CAROLINA
DIVISION OF HIGHWAYS

FORSYTH COUNTY

**LOCATION: INTERSECTION OF COUNTRY CLUB ROAD (1001)
& MEADOWLARK DRIVE (1314)**

**TYPE OF WORK: GRADING, WIDENING, CURB & GUTTER,
PAVING, DRAINAGE AND STRUCTURES**

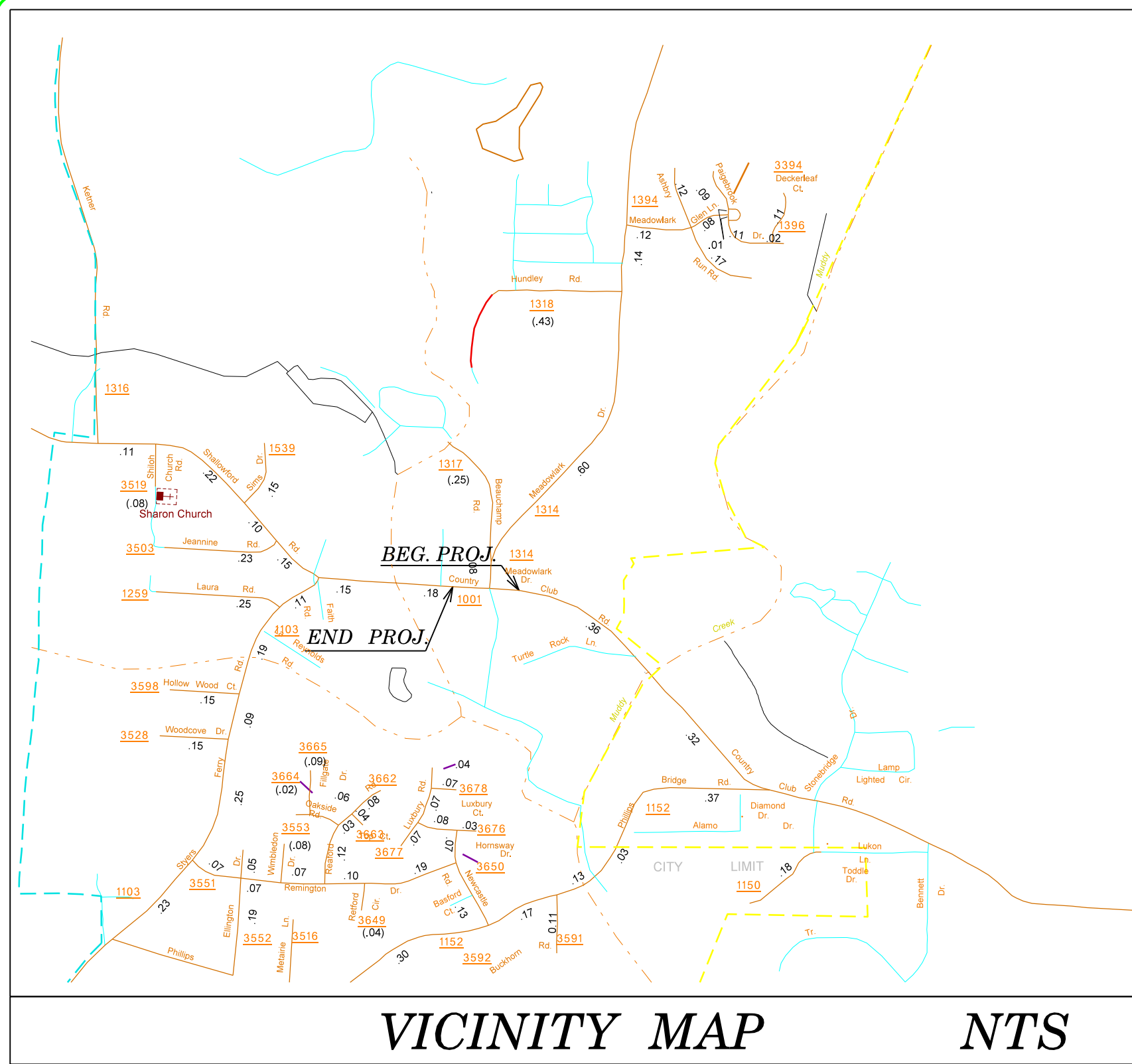

VICINITY MAP NTS

LEGEND

EXISTING EDGE OF PAVEMENT	-----
EXISTING BACK OF CURB	-----
EXISTING EDGE OF TRAVEL WAY	-----
EXISTING CONCRETE ISLAND	-----
PROPOSED EDGE OF PAVEMENT	-----
PROPOSED BACK OF CURB	-----
PROPOSED LANE LINES	-----
(NOTE: STRIPING WILL BE DRAWN UP BY TRAFFIC SERVICES)	
PROPOSED CONCRETE ISLAND	-----
EXISTING RIGHT-OF-WAY LINE	-----
PROPOSED RIGHT-OF-WAY LINE	-----
EXISTING PROPERTY LINE	-----
PROPOSED EASEMENT CONSTRUCTION	-----
PROPOSED TOE OF SLOPE	-----

UTILITIES & STRUCTURES

UTILITY & SIGNAL POLE	●
POWER POLE	○
TELEPHONE PEDESTAL	□
GUY WIRE	—
SIGNAL BOX	⊠
SANIT. SEWER MANHOLE	⊙
SANIT. SEWER CLEANOUT	⊙
WATER METER	⊙
WATER VALVE	⊙
FIRE HYDRANT	⊙
GAS METER	⊙
GAS VALVE	⊙
CATCH BASIN & D'S	⊙
GUARDRAIL	—
FENCE	—
SIDEWALK	—
TREE	⊙
HEDGE ROW	—
WOOD LINE	—

EROSION CONTROL LEGEND

ROCK INLET PROTECTION:

896.01	TYPE A	-----	A	OR A
896.02	TYPE B	-----	B	OR B
896.03	TYPE C	-----	C	OR C
897.01	ROCK PIPE INLET PROTECTION	-----	---	---
N.A.	PIPE OUTLET ENERGY DISSIPATOR	-----	---	---
N.A.	DRAINAGE TURNOUT	-----	---	---
N.A.	RIP-RAPLINED DITCH	-----	---	---
N.A.	STREAM	-----	---	---
N.A.	HIGH POINT/ WATER FLOW DIRECTION	-----	---	---
245.01	SILT BASIN TYPE A	-----	---	---
245.02	SILT BASIN TYPE B	-----	---	---
245.03	TEMPORARY SILT DITCH	-----	---	---
245.05	TEMPORARY DIVERSION DITCH	-----	---	---
100.01B	STORM DRAINAGE GE PIPE	-----	---	---
890.05	TEMP. SLOPE DRAIN W/ EARTH BERM	-----	---	---
892.01	TEMPORARY ROCK SEDIMENT DAM TYPE A	-----	---	---
892.02	TEMPORARY ROCK SEDIMENT DAM TYPE B	-----	---	---
A	BAFFLE IN A SEDIMENT DAM (EVERY 10')	-----	---	---
892.04	TEMPORARY ROCK SILT CHECK TYPE A	-----	---	---
893.01	TEMPORARY SILT FENCE	-----	---	---
894.01	ROCK SILT SCREEN	-----	---	---
895.10	TEMPORARY ROCK SILT CHECK TYPE B	-----	---	---
N.A.	WATTLE	-----	---	---

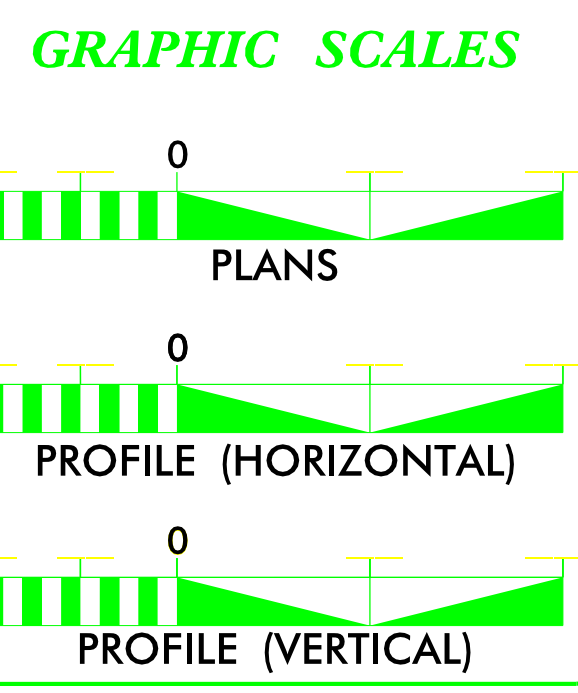
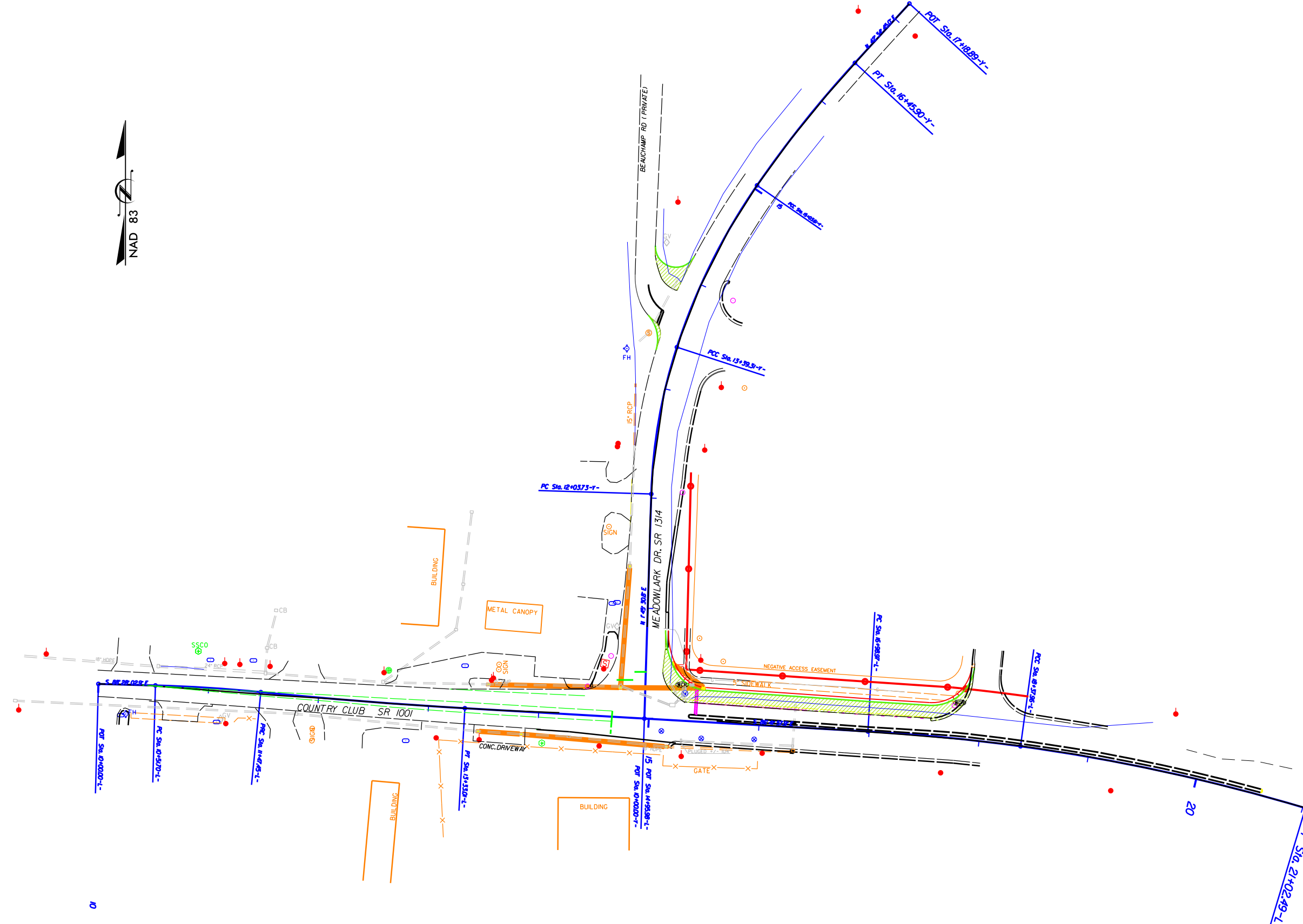

DESIGN DATA

NTS

PROJECT LENGTH

0.08 MILES

Prepared in the Office of:
DEPARTMENT OF TRANSPORTATION
DIV. 9 /DISTRICT II
375 Silas Creek Pkwy., Winston Salem NC, 27127

2012 STANDARD SPECIFICATIONS

COUNTY: FORSYTH 7/30/2014 GWG
DATE DRAWN DRAWN BY

W.O. NUMBER: NA 3/11/2015 GWG
REVISID DATE DRAWN BY

PLAN SCALE: NA

DISTRICT ENGINEER

SIGNATURE: _____ P.E.

DIVISION TRAFFIC ENGINEER

SIGNATURE: _____ P.E.

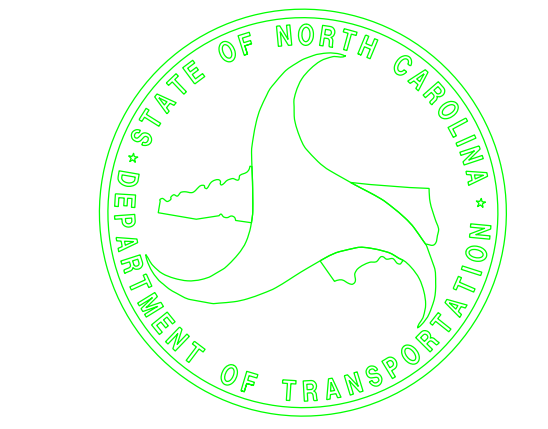

CB	STATION	B.O.C.	INVERT	GRATE
1	10+50-Y-	745.60	742.30	E
2	15+44.78-L-	746.50	741.85	F

PIPE TABLE DATA

From	To	Type	Length +/-	% Slope
CB1	CB2	15" HDPE	29.5'	0.68%
CB2	JB2	18" RCP	68.5'	F/D
JB 1	JB2	18" RCP	108'	F/D
JB2	DI 1	18" RCP	117'	F/D
DI 4	DI 3	18" RCP	129'	F/D
DI 3	DI 2	18" RCP	37'	F/D

DRAINAGE STRUCTURES

Structures	Grate Types	Total Amount (Approx.)
CB's	F	1
CB's	E	1
DI's	E	4
JB's	NA	2

PIPES

Types	Total Length (Approx.)
15" HDPE	29.5' +/-
18" RCP	459' +/-

PI Sta 14+22.04-Y-
 $\Delta = 16' 36" 22.8" (RT)$
 $D = 10' 06" 26.2"$
 $L = 164.30'$
 $T = 82.73'$
 $R = 566.88'$

PI Sta 12+71.98-Y-
 $\Delta = 16' 16' 56.5" (RT)$
 $D = 12' 00' 33.6"$
 $L = 135.58'$
 $T = 68.25'$
 $R = 477.09'$

PI Sta 17+68.50-L-
 $\Delta = 4' 29' 57.0" (RT)$
 $D = 3' 14' 13.2"$
 $L = 138.99'$
 $T = 69.53'$
 $R = 1770.03'$

PI Sta 10+99.60-L-
 $\Delta = 4' 11' 10.3" (RT)$
 $D = 4' 22' 19.5"$
 $L = 95.75'$
 $T = 47.90'$
 $R = 1,310.50'$

PI Sta 12+40.24-L-
 $\Delta = 2' 25' 05.3" (LT)$
 $D = 1' 18' 11.4"$
 $L = 185.56'$
 $T = 92.79'$
 $R = 4,396.68'$

REVISIONS
 I:\MAR-2015_1510_1510\2015\2015\2015\CURRENT\COUNTRY CLUB @ MEADOWLARK\MEADOWLARK_Rd.dwg
 I:\MAR-2015_1510_1510\2015\2015\2015\CURRENT\COUNTRY CLUB @ MEADOWLARK_Rd.dwg
 I:\MAR-2015_1510_1510\2015\2015\2015\CURRENT\COUNTRY CLUB @ MEADOWLARK_Rd.dwg

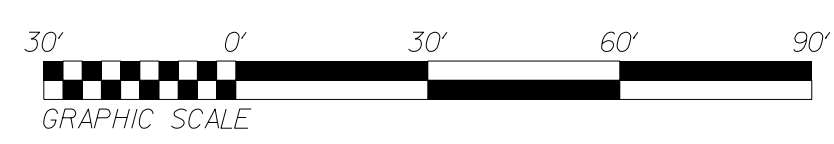
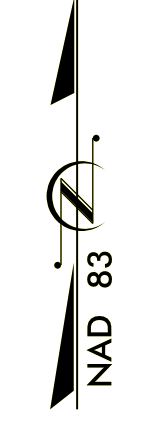
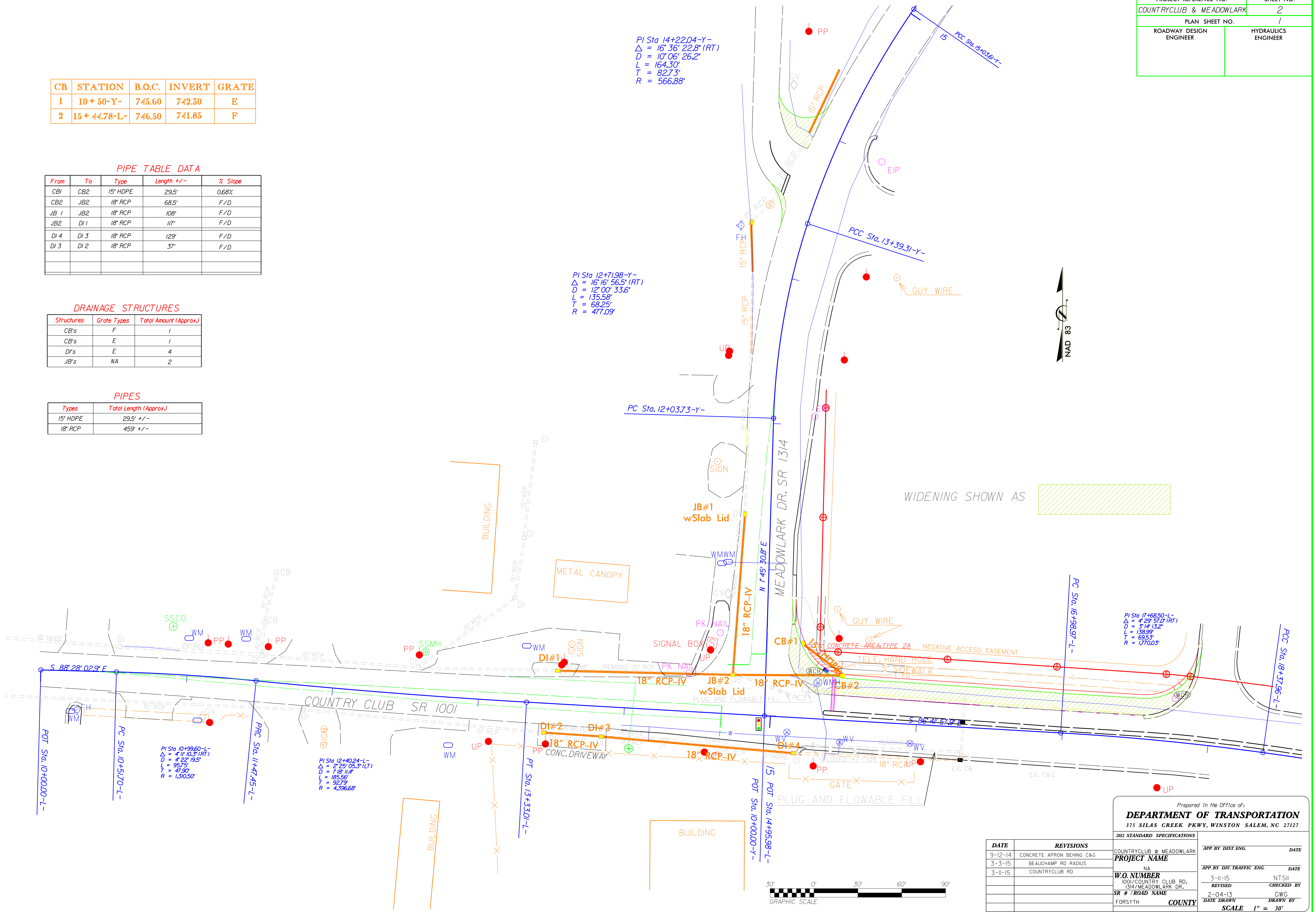

DATE	REVISIONS	APP. BY	DIST. ENG.	DATE
9-12-14	CONCRETE APRON BEHIND C&G			
3-3-15	BEAUCHAMP RD RADIUS			
3-11-15	COUNTRY CLUB RD			

DATE	REVISIONS	APP. BY	TRAFFIC ENG.	DATE
3-11-15				
2-04-13				

Prepared in the Office of:
DEPARTMENT OF TRANSPORTATION
 375 SILAS CREEK PKWY, WINSTON SALEM, NC 27127
 2012 STANDARD SPECIFICATIONS
 PROJECT NAME: COUNTRY CLUB @ MEADOWLARK
 W.O. NUMBER: 1001/COUNTRY CLUB RD, 1314/MEADOWLARK DR.
 SR # / ROAD NAME: FORSYTH COUNTY

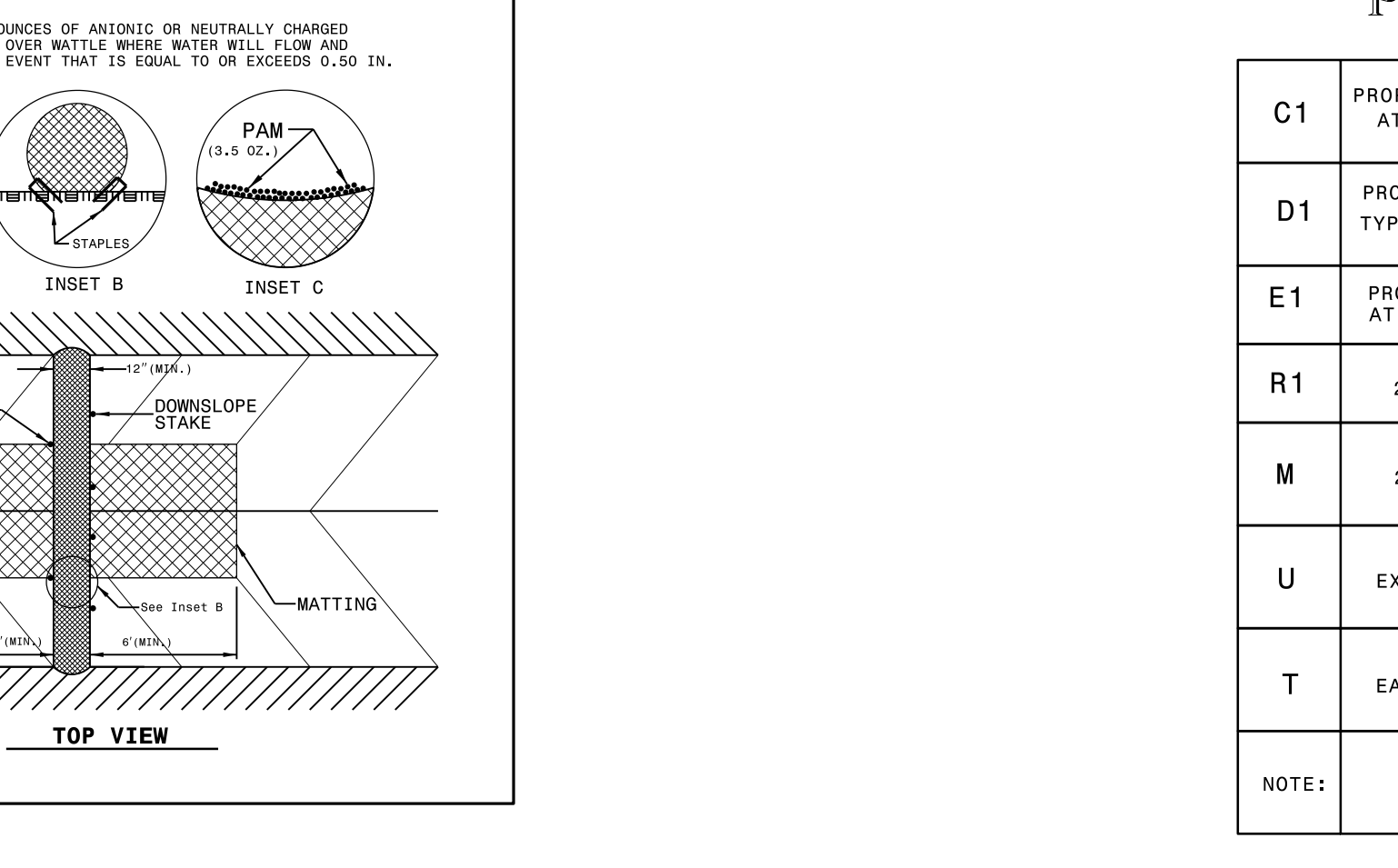
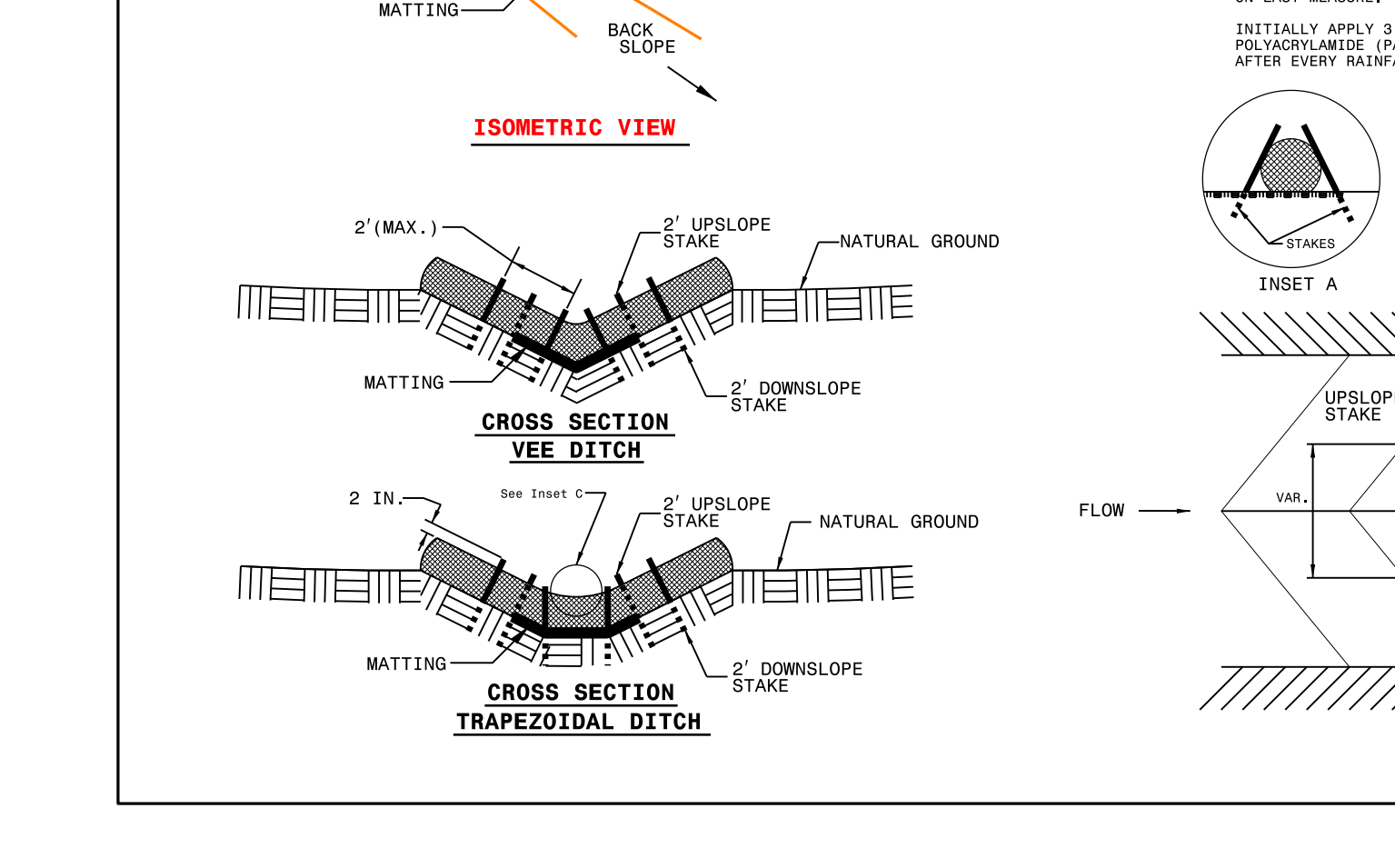
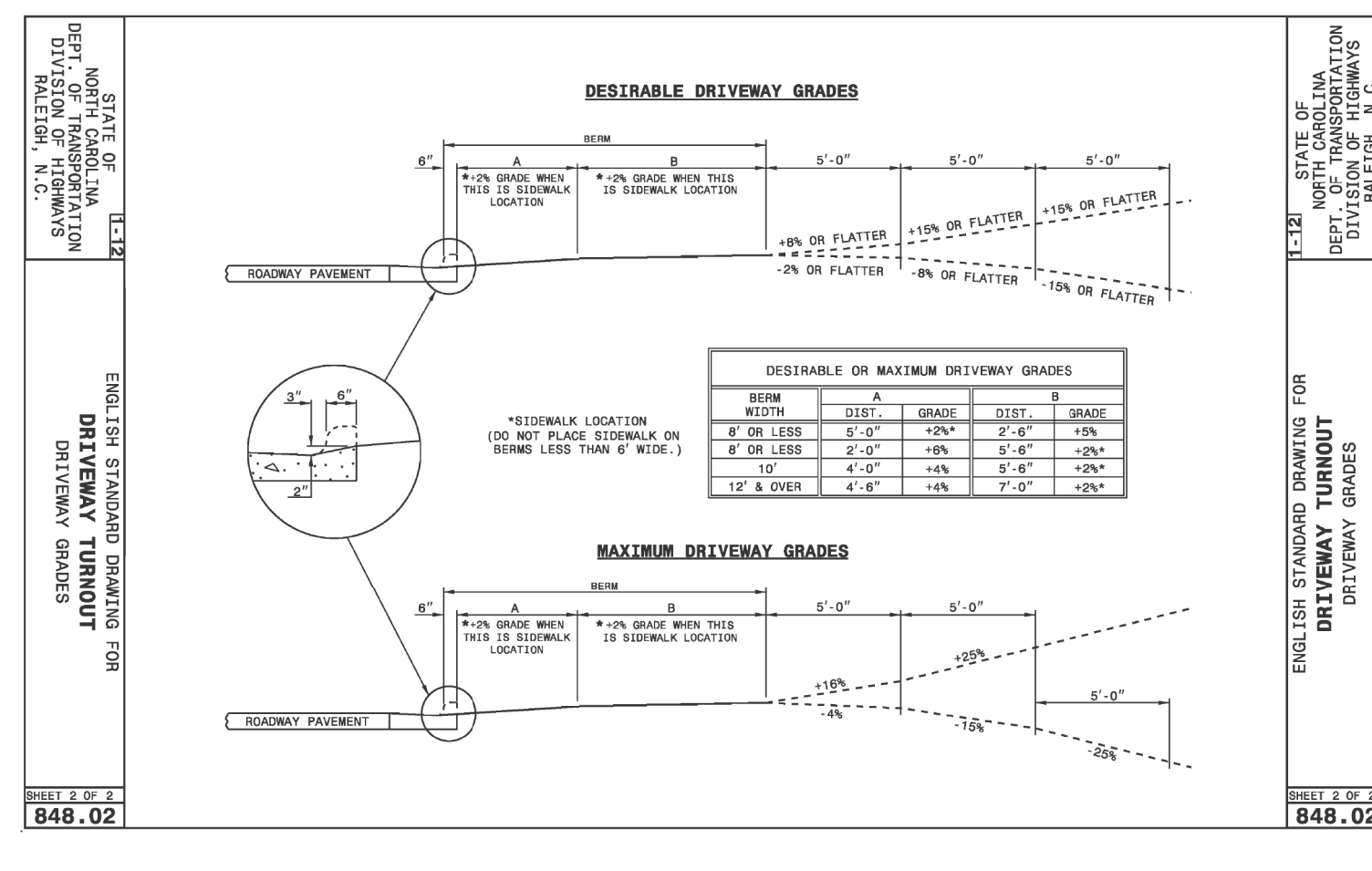
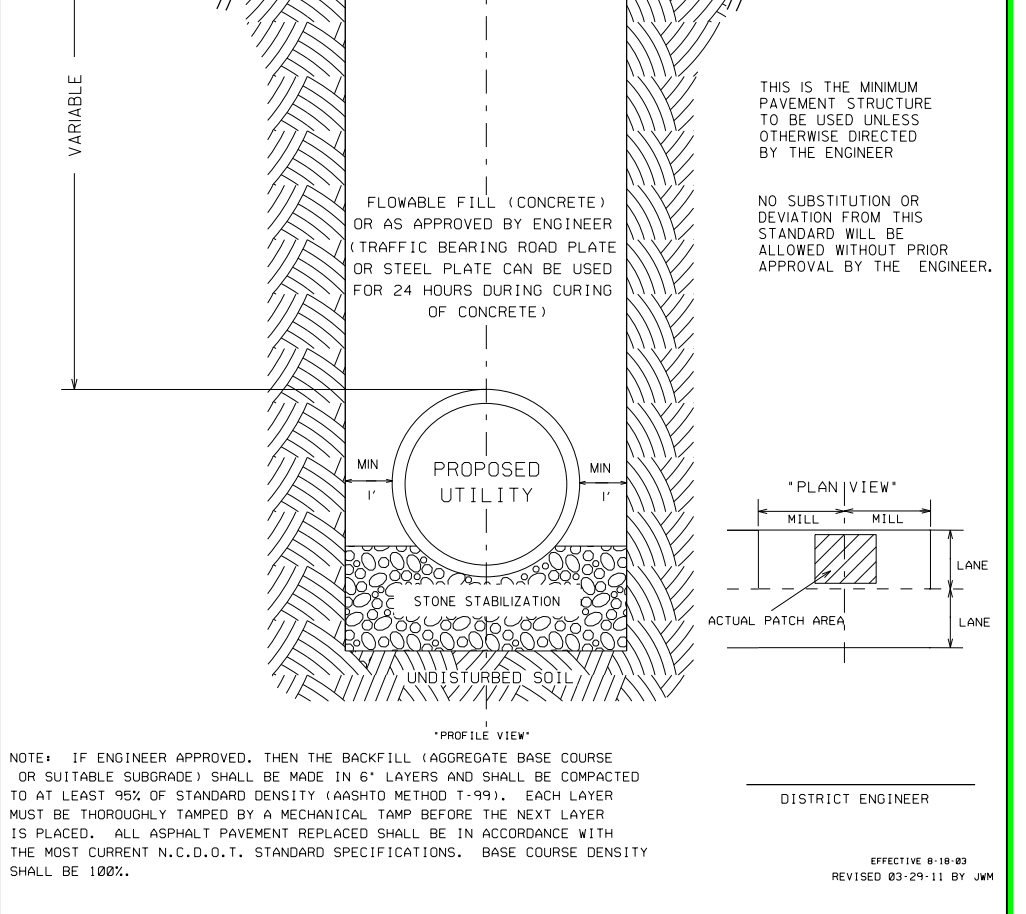
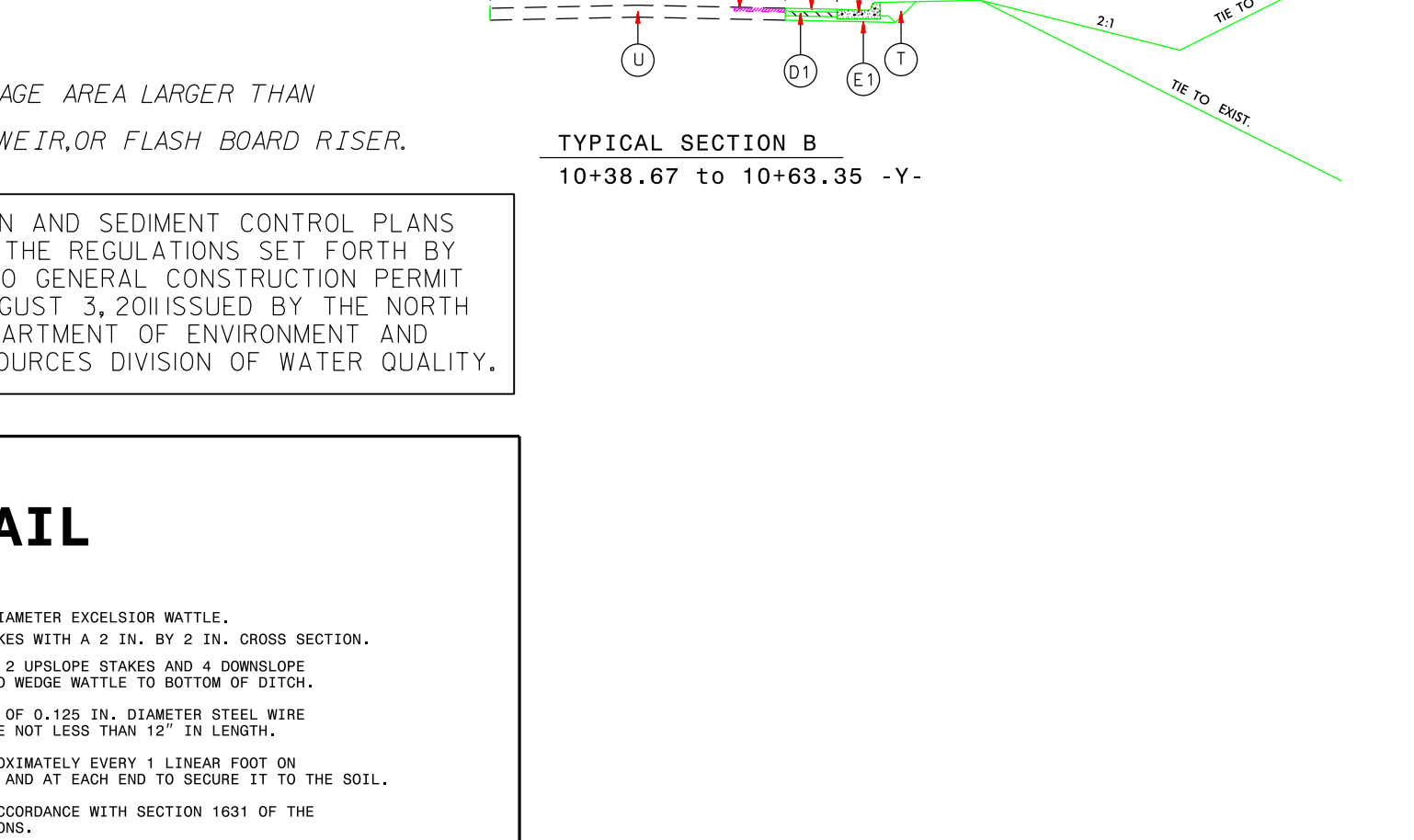
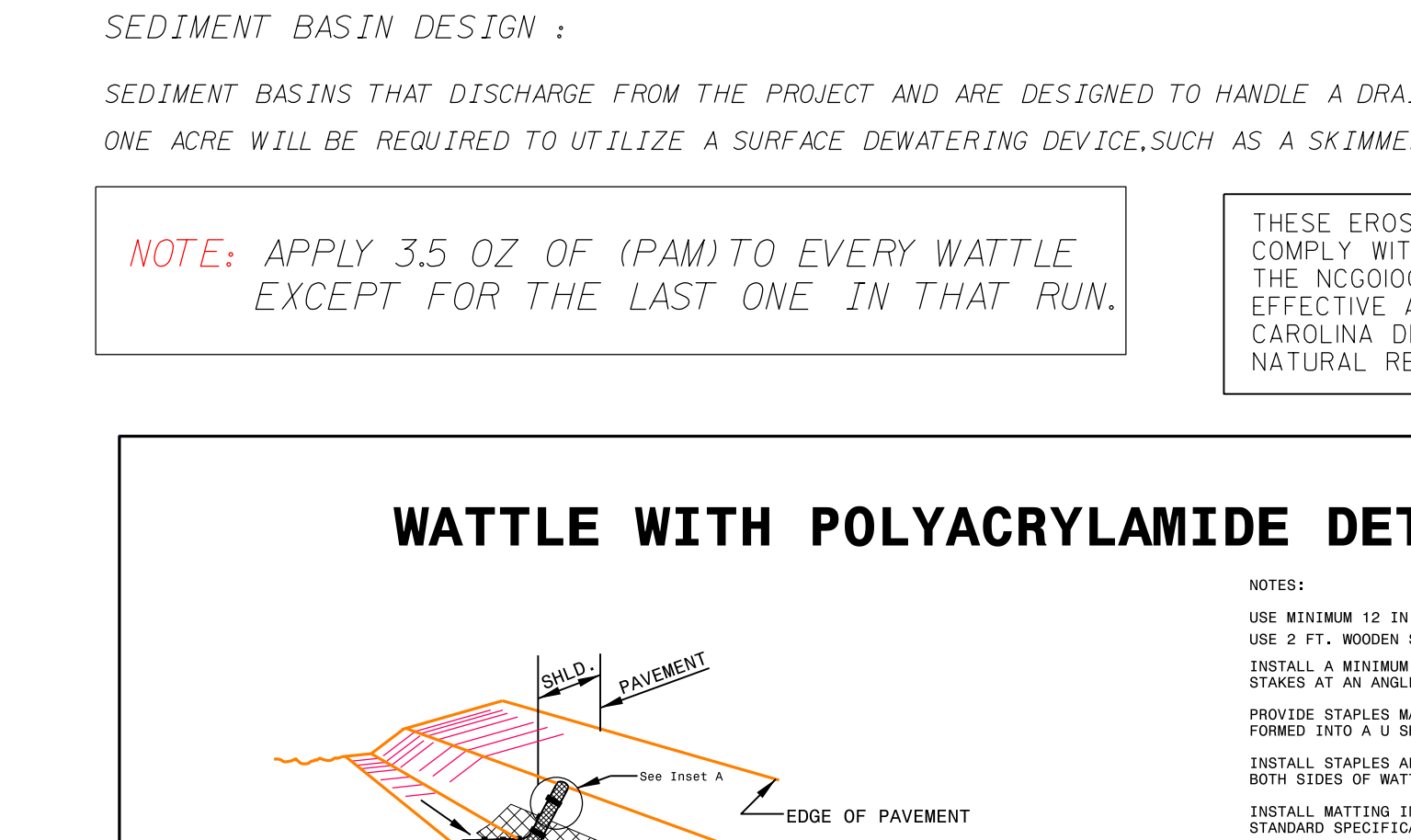
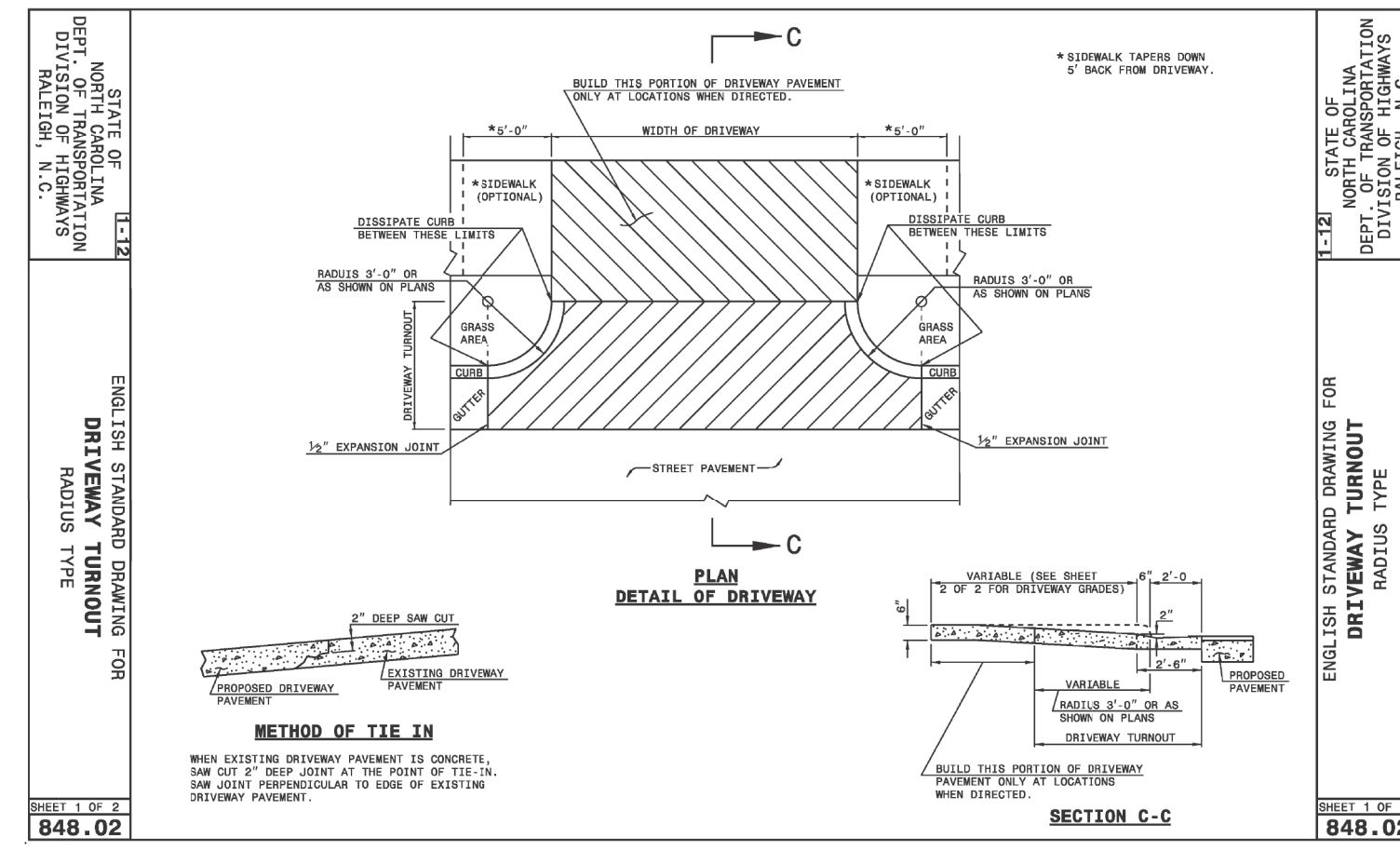
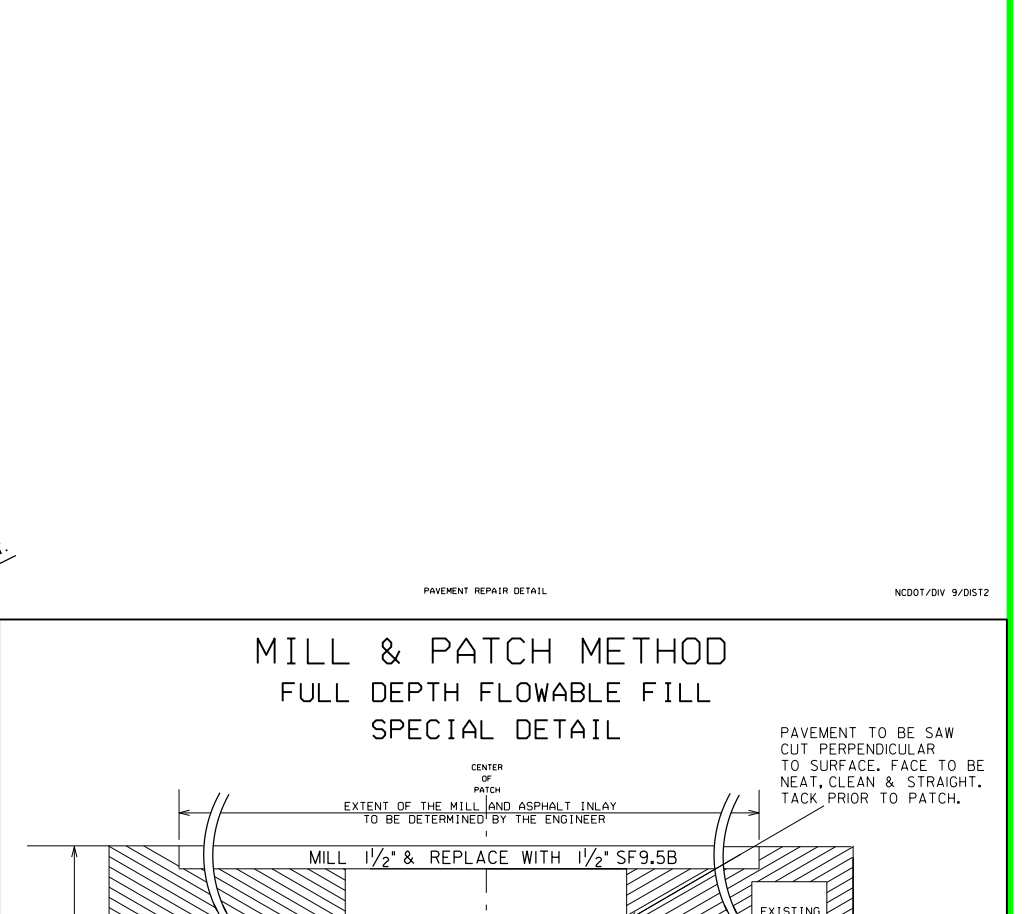
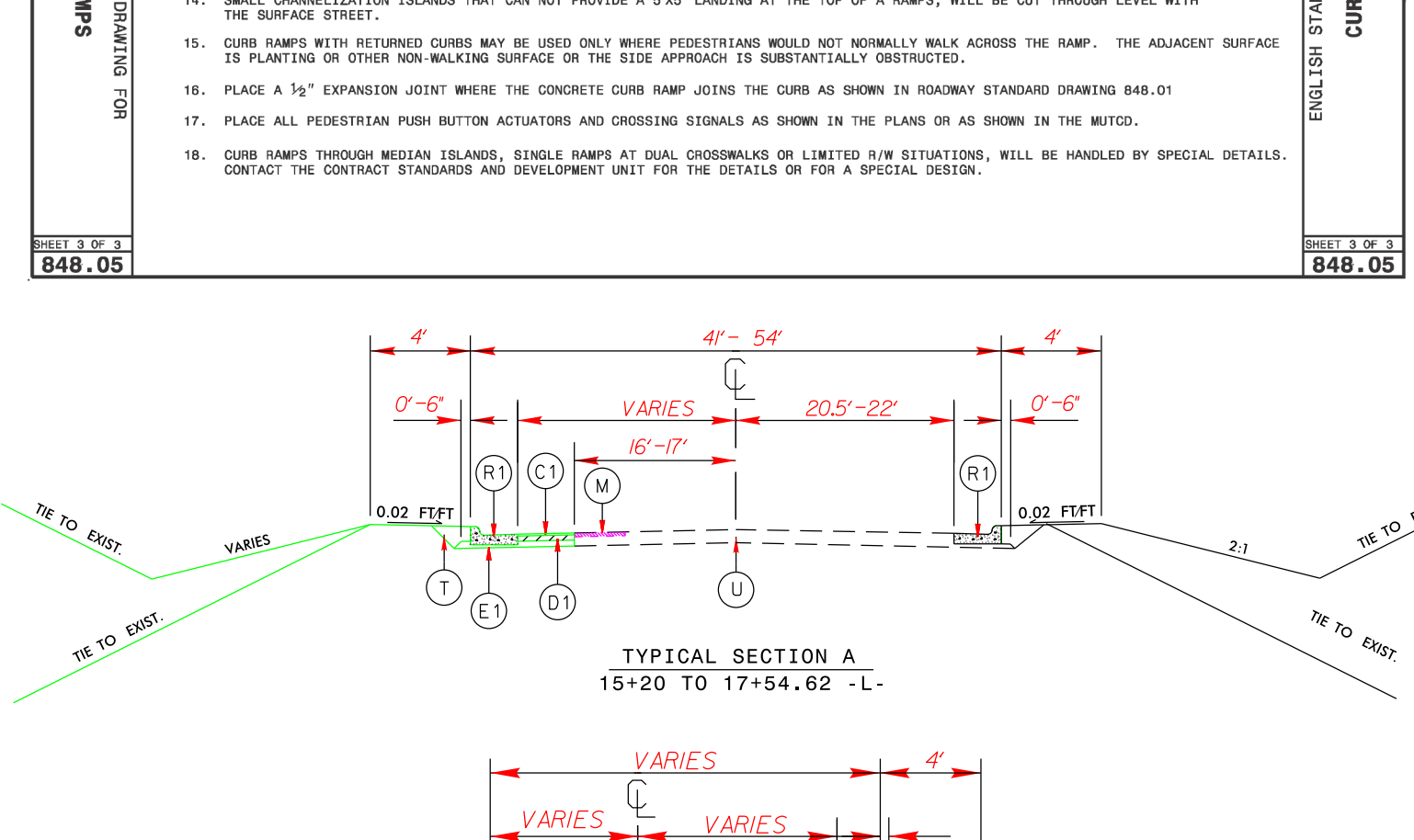
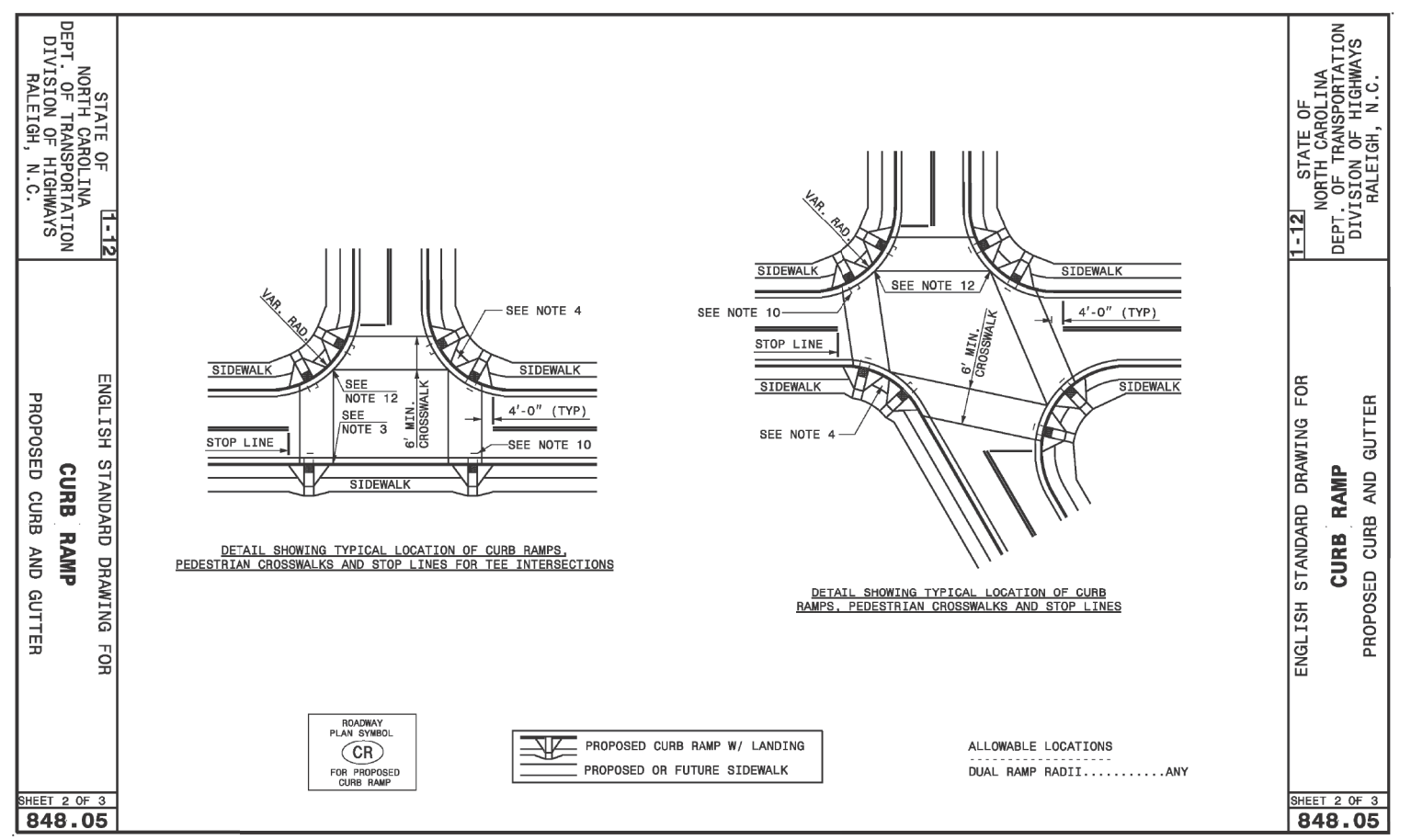
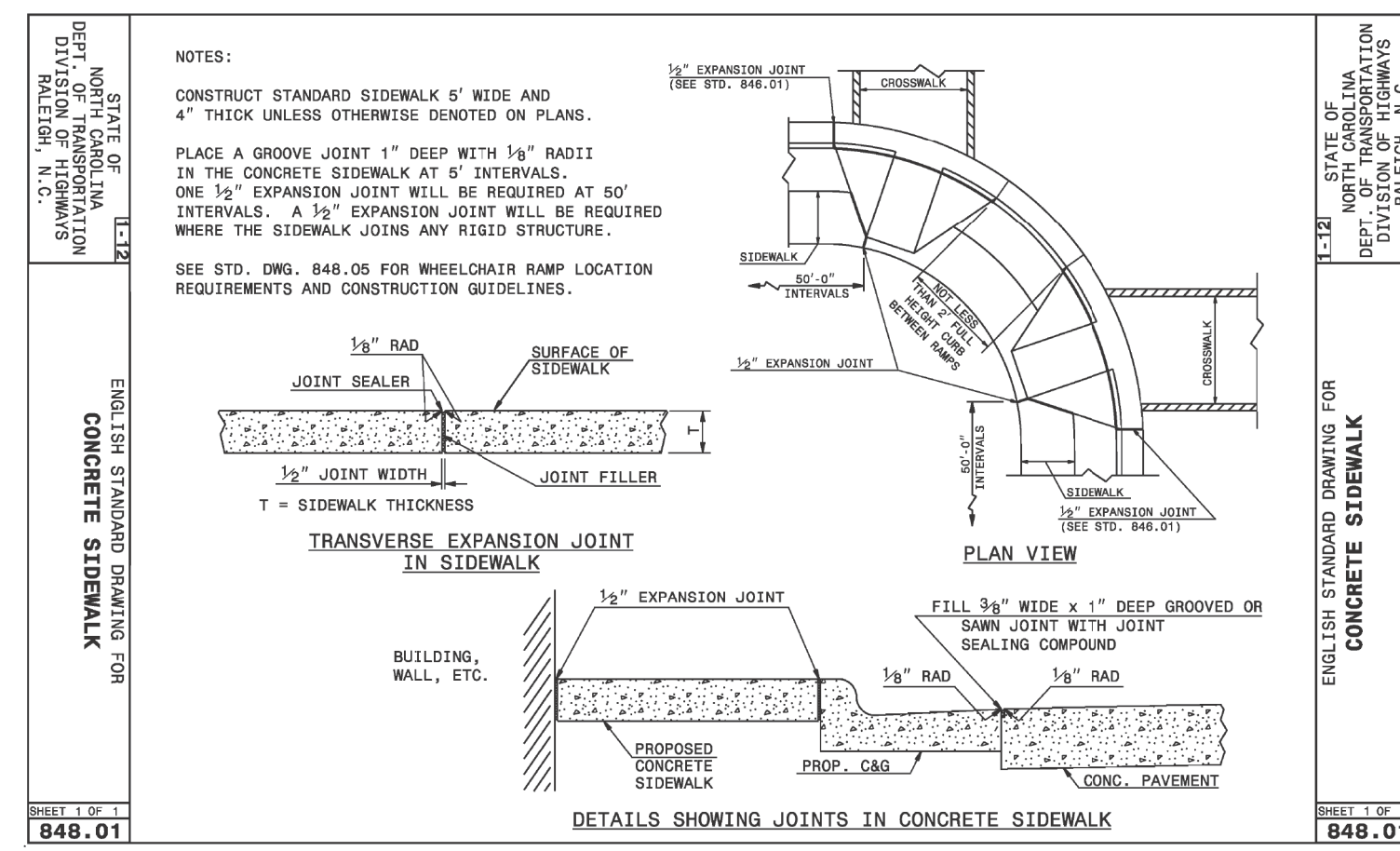
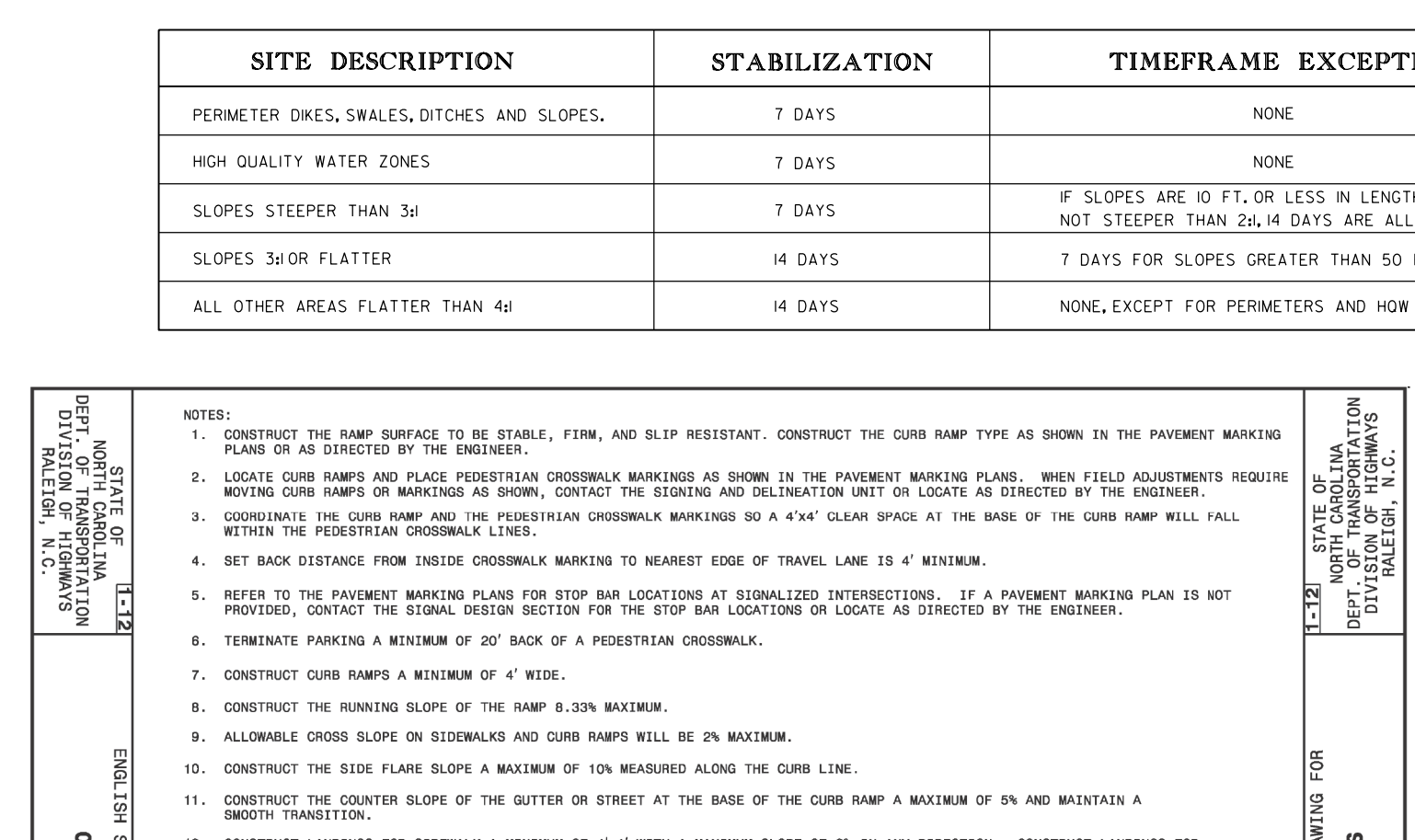
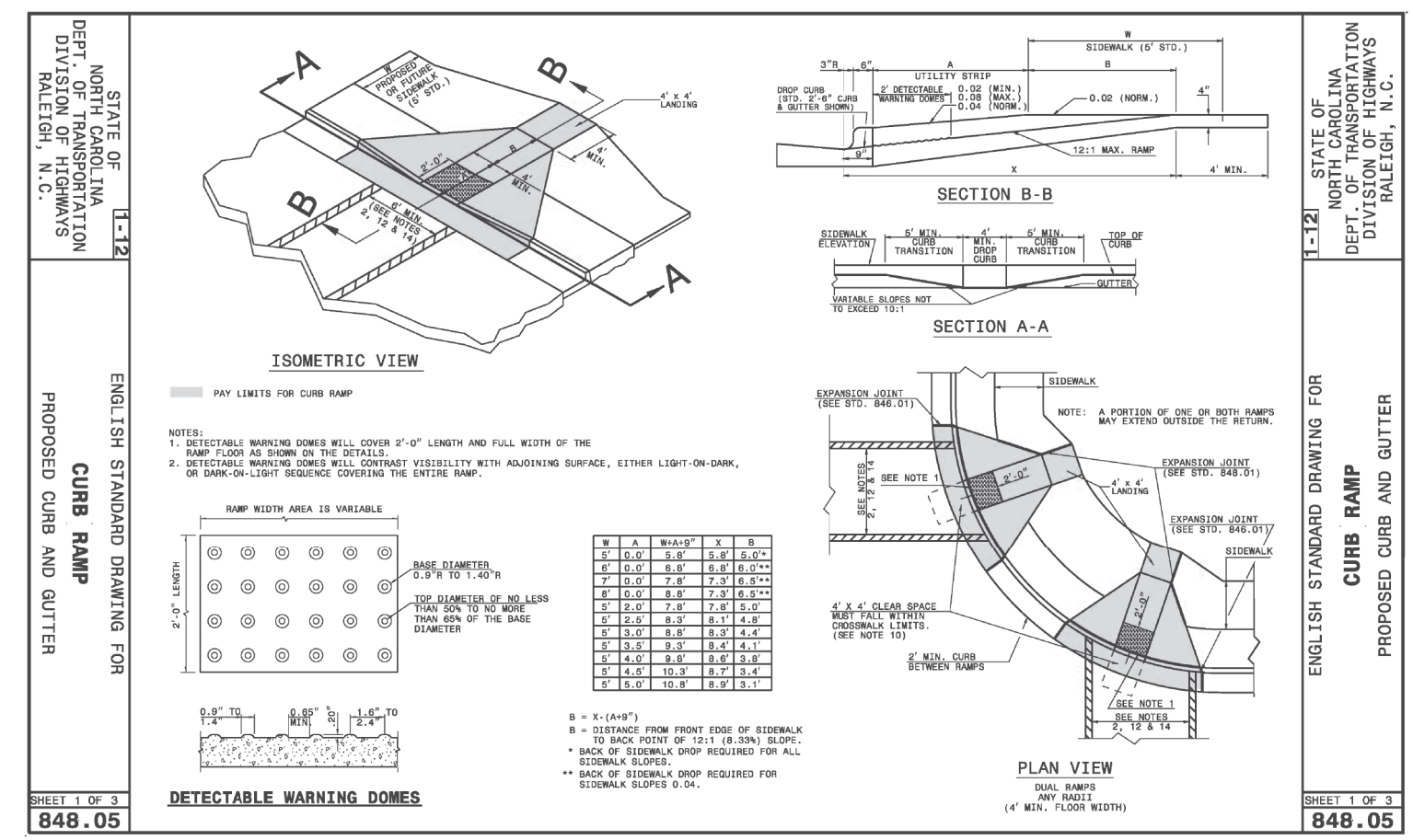
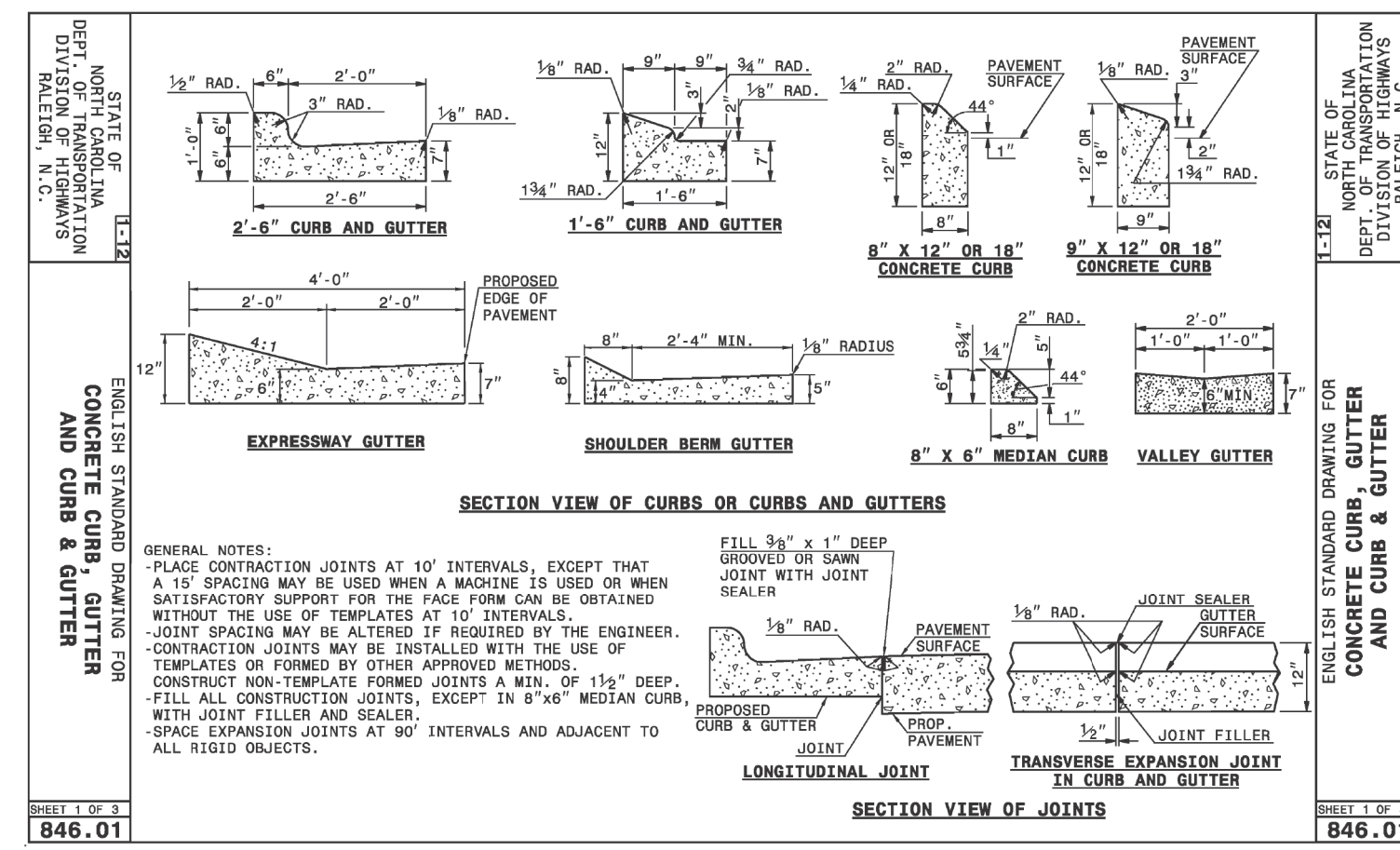

PAVEMENT STRUCTURE	DESCRIPTION
C1	PROP. APPROX. 1-1/2" ASPHALT CONCRETE SURFACE COURSE, TYPE S9.5B, AT AN AVERAGE RATE OF 112 LBS. PER IN. PER SQ. YD.
D1	PROP. APPROX. 4" ASPHALT CONCRETE INTERMEDIATE COURSE, TYPE I19.0B, AT AN AVERAGE RATE OF 114 LBS. PER IN. PER SQ. YD.
E1	PROP. APPROX. 5-1/2" ASPHALT CONCRETE BASE COURSE, TYPE B25.0 B, AT AN AVERAGE RATE OF 114 LBS. PER IN. PER SQ. YD.
R1	2'-6" STANDARD CONCRETE CURB AND GUTTER (STD. 846.01)
M	2" CURB REVEAL
U	EXISTING PAVEMENT
T	EARTH; SHOULDER (2'-3')
NOTE:	