



NORTH CAROLINA
Department of Transportation

Roundabout - Signing and Delineation

Kelvin Jordan

Western Region Signing and Delineation Regional Engineer

October 17, 2024

Connecting people, products and places safely and efficiently with customer focus, accountability and environmental sensitivity to enhance the economy and vitality of North Carolina

Single Lane Rural Roundabout

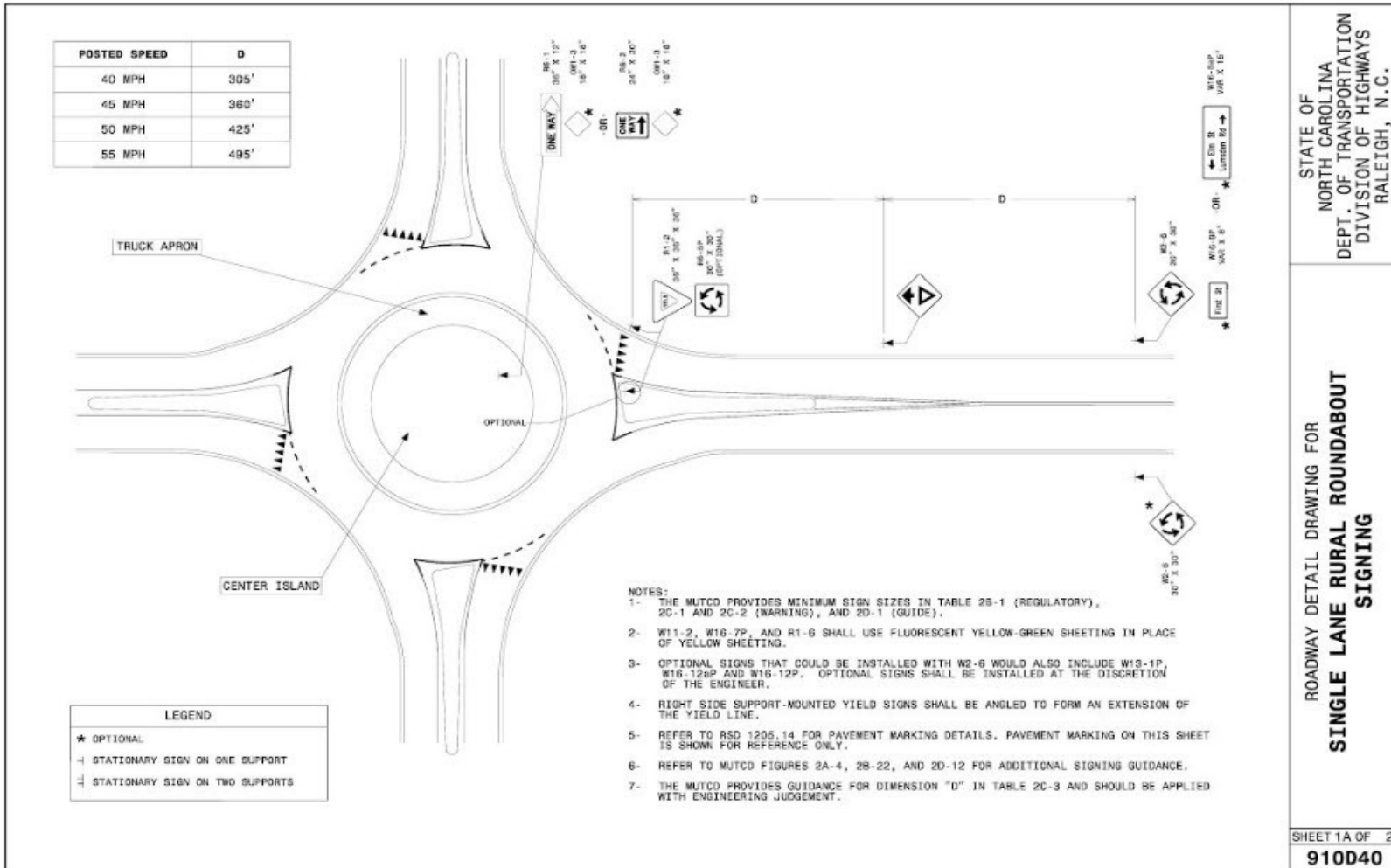

Single Lane Urban Roundabout Signing, With Pedestrians

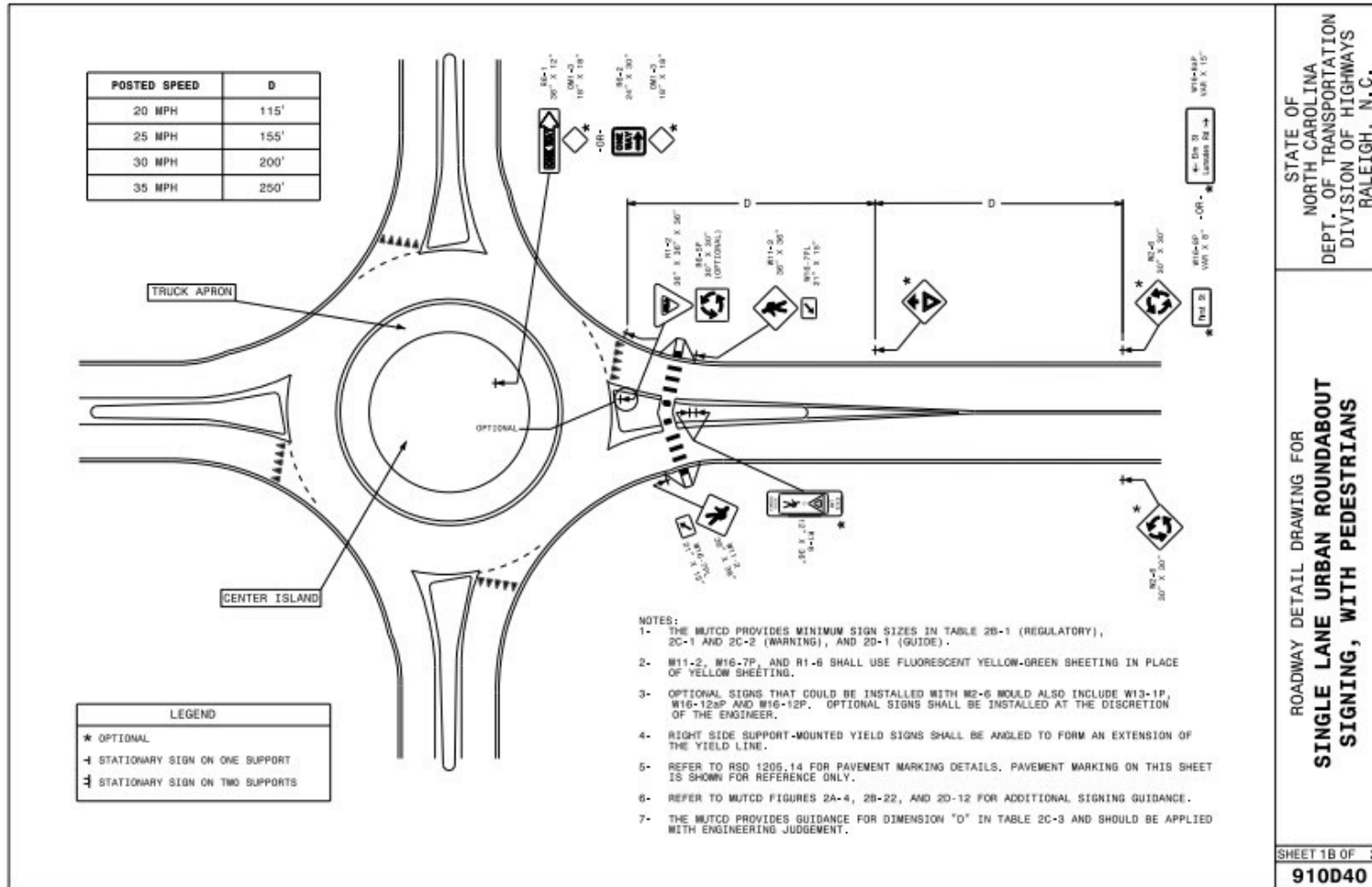

Two Lane Roundabout Signing, With Pedestrians

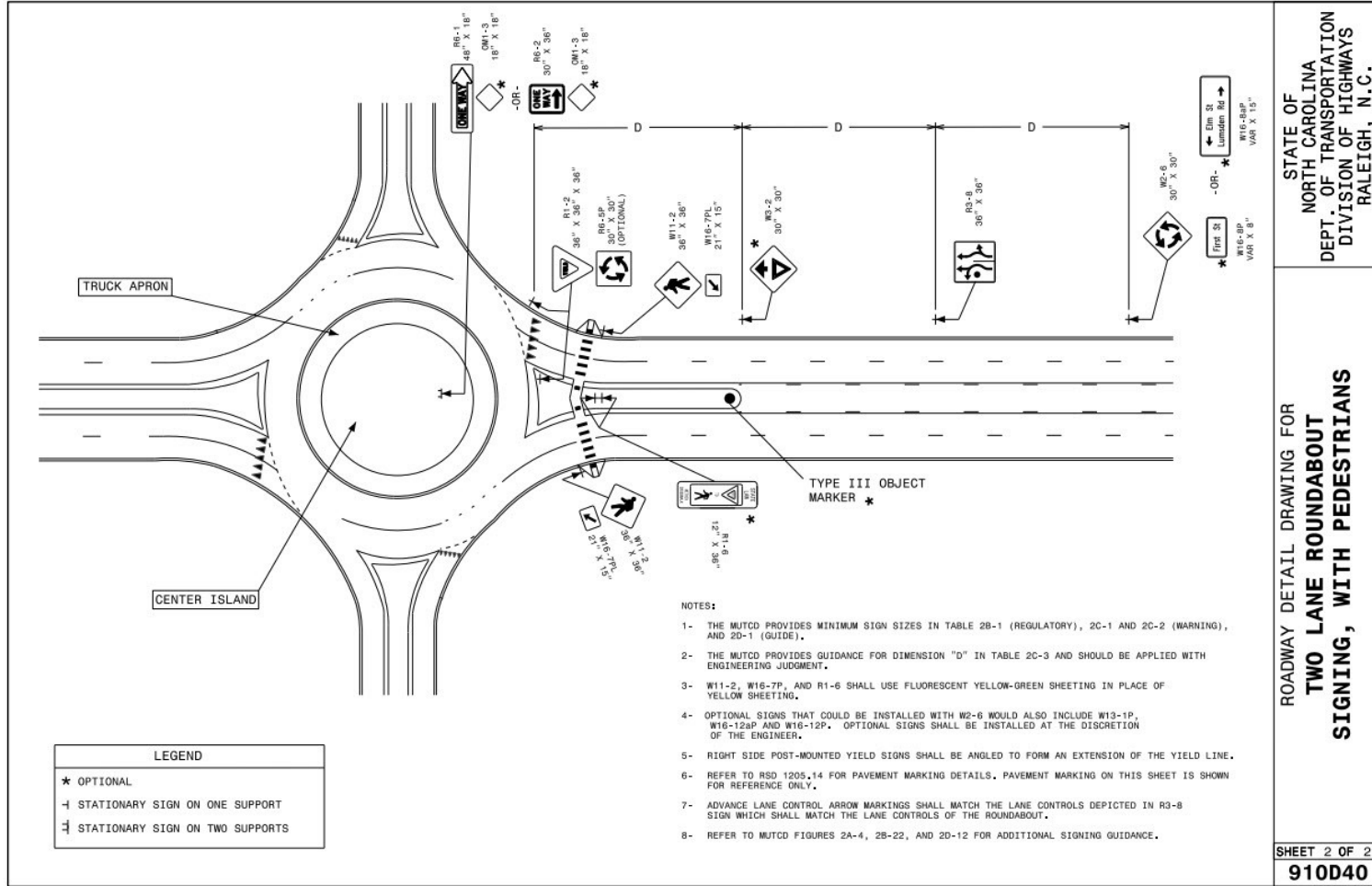

Single Lane Pavement Marking Roundabout

SINGLE-LANE ROUNDABOUT

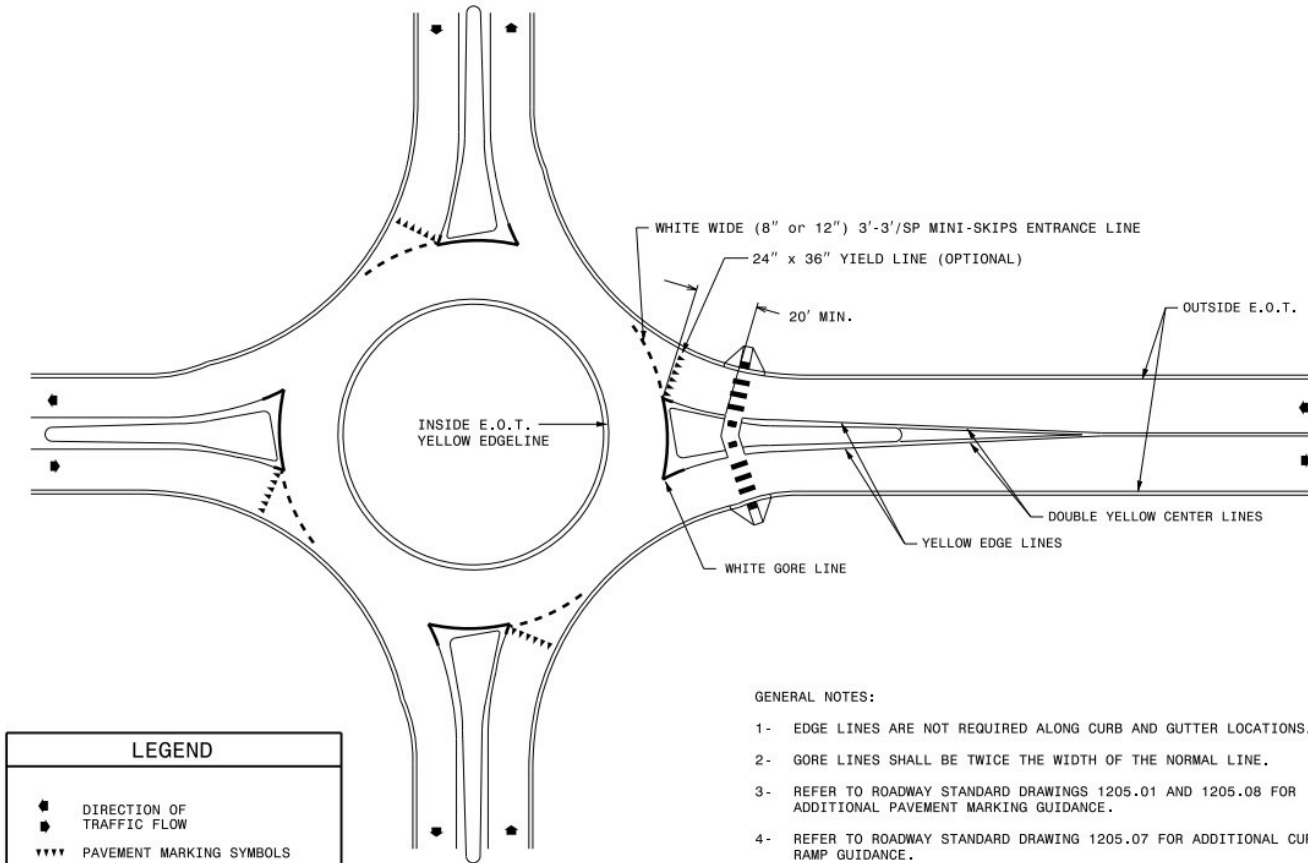

LEGEND	
◆	DIRECTION OF TRAFFIC FLOW
◆◆◆◆	PAVEMENT MARKING SYMBOLS

GENERAL NOTES:

- 1 - EDGE LINES ARE NOT REQUIRED ALONG CURB AND GUTTER LOCATIONS.
- 2 - GORE LINES SHALL BE TWICE THE WIDTH OF THE NORMAL LINE.
- 3 - REFER TO ROADWAY STANDARD DRAWINGS 1205.01 AND 1205.08 FOR ADDITIONAL PAVEMENT MARKING GUIDANCE.
- 4 - REFER TO ROADWAY STANDARD DRAWING 1205.07 FOR ADDITIONAL CURB RAMP GUIDANCE.

1-24] STATE OF NORTH CAROLINA
DEPT. OF TRANSPORTATION
DIVISION OF HIGHWAYS
RALEIGH, N.C.

ROADWAY STANDARD DRAWING FOR
PAVEMENT MARKINGS
ROUNDABOUTS

SHEET 1 OF 2
1205.14

Multi-Lane Pavement Marking Roundabout

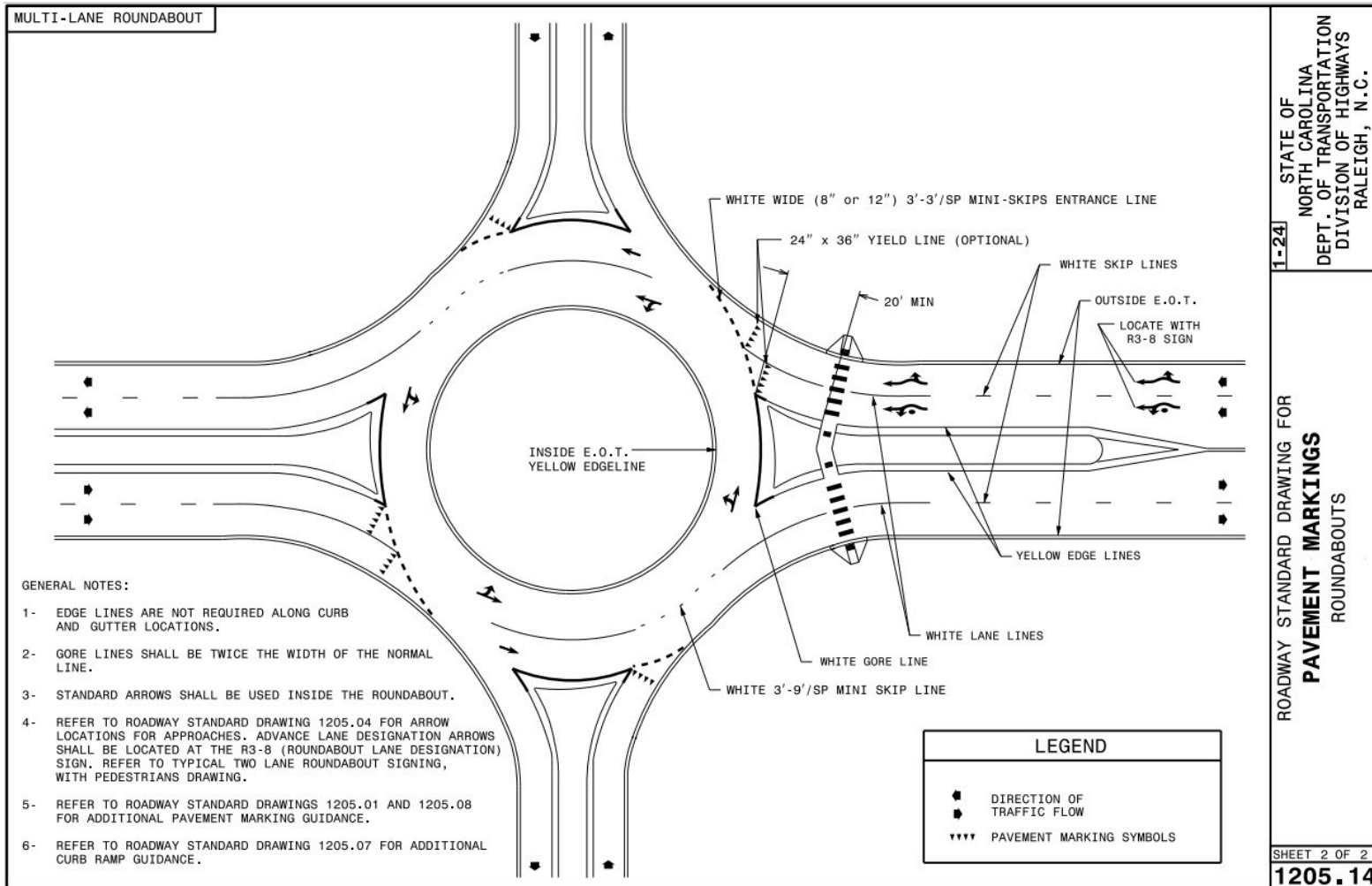

Additional Roundabout Guidance Per 2023 MUTCD

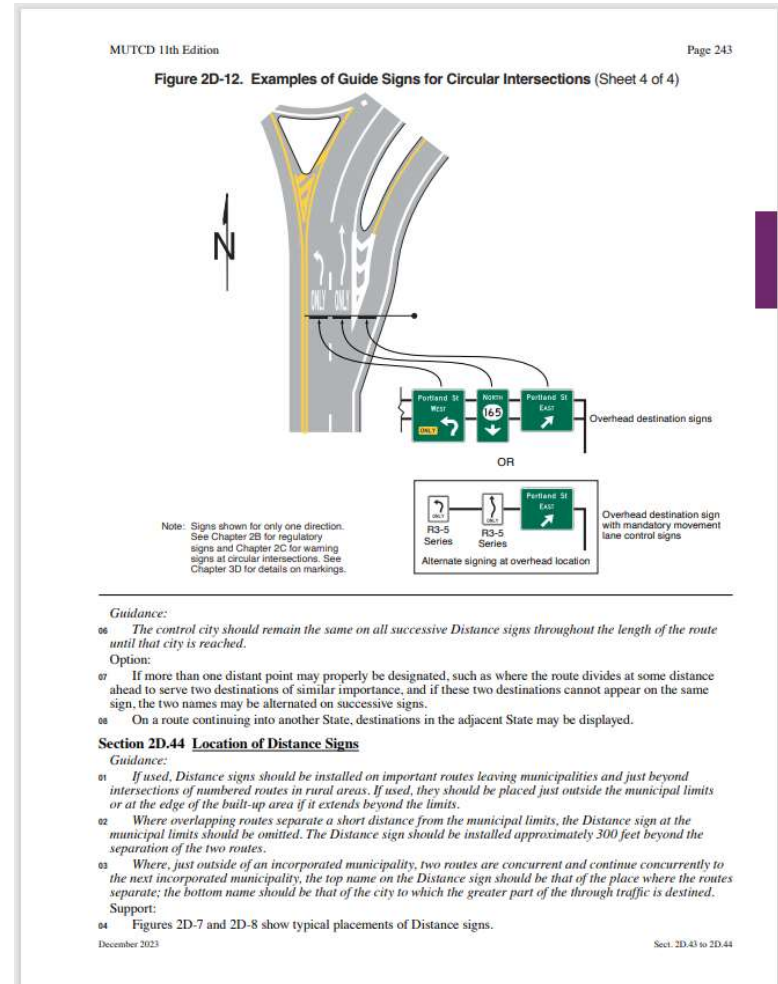
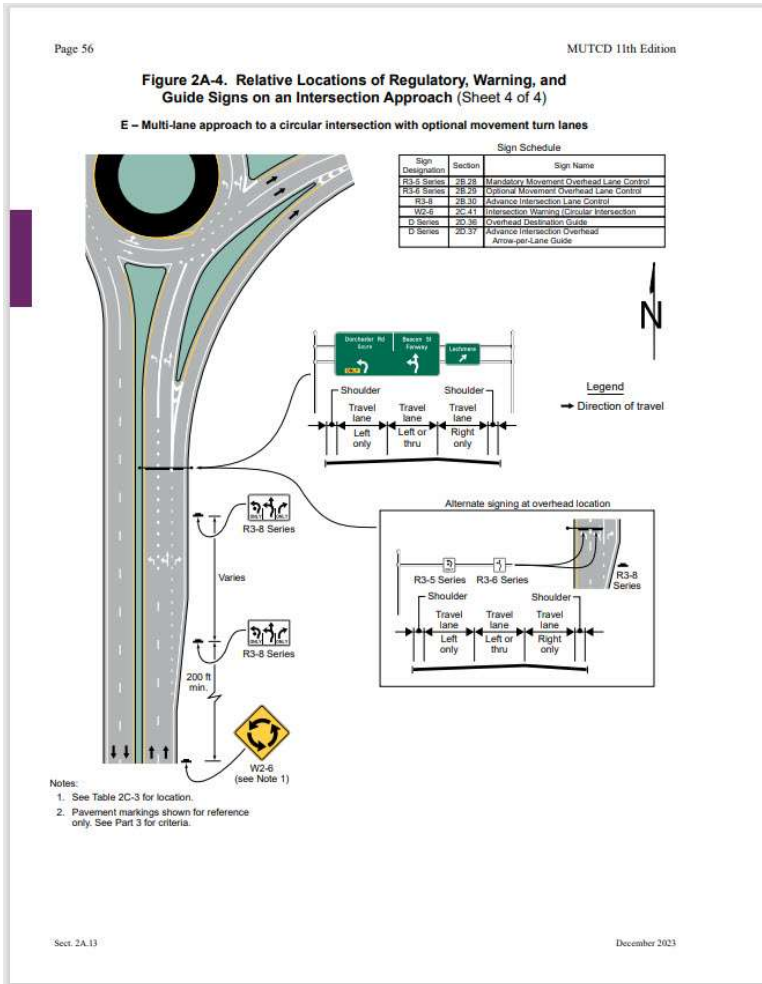

Bowtie Intersection With Roundabouts

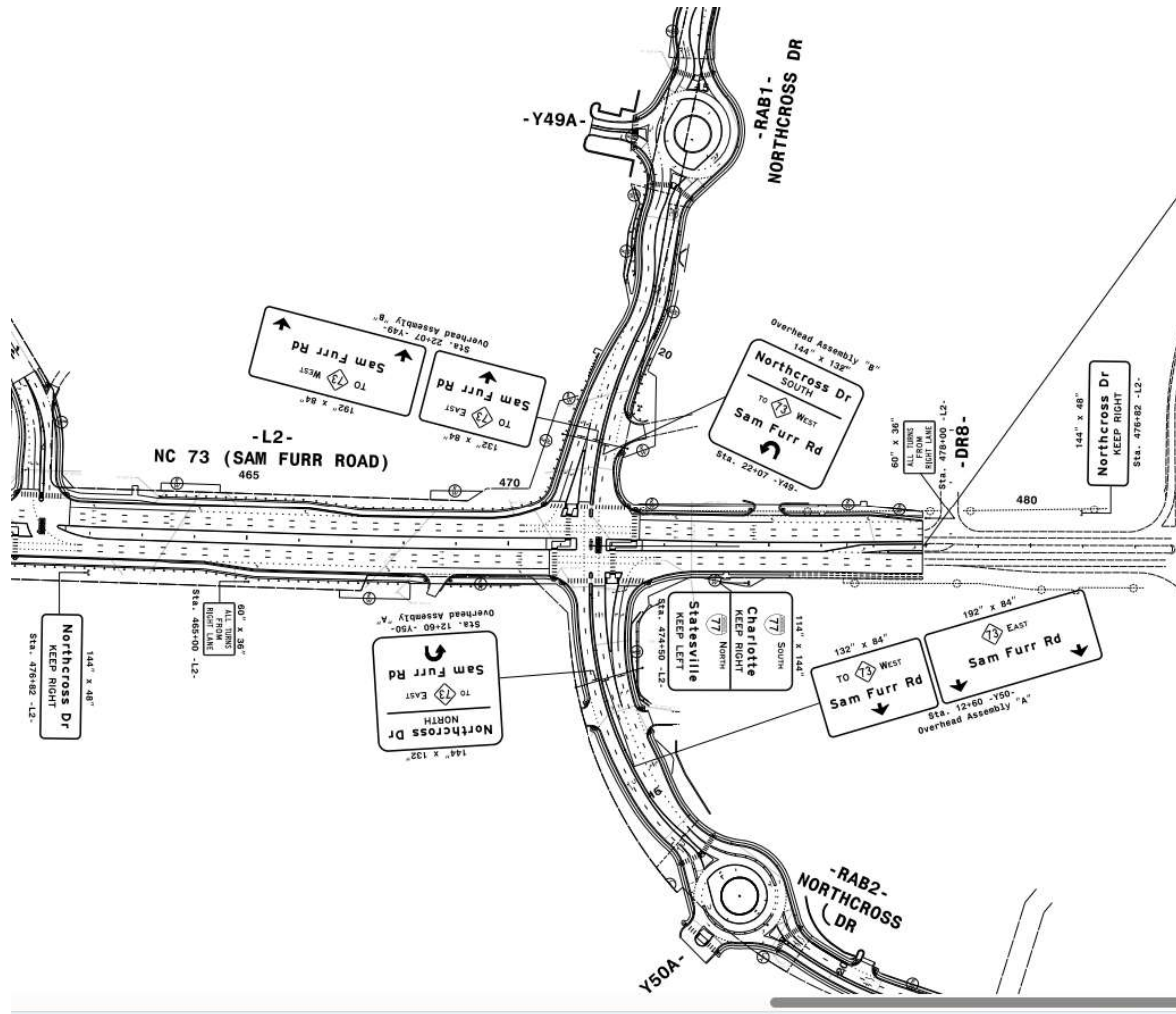

ncdot.gov

Resources For Roundabout Information

Signing & Delineation Website

<https://connect.ncdot.gov/resources/safety/Pages/Signing-and-Delineation.aspx>

December 23 MUTCD

[MUTCD 11th Edition - FHWA MUTCD \(dot.gov\)](#)

TEPPL Topic R-38

https://connect.ncdot.gov/resources/safety/Tepl/Pages/Tepl-Topic-Original.aspx?Topic_List=R38

Details in Lieu of Standards

<https://connect.ncdot.gov/resources/Specifications/Pages/2024-Roadway-Standard-Drawings.aspx>