



N.C. DEPARTMENT OF TRANSPORTATION
DIVISION OF HIGHWAYS
BRIDGE MAINTENANCE UNIT

ATTENTION:

BRIDGE INSPECTION REPORT

TYPE OF INSPECTION Routine

COUNTY JOHNSTON BRIDGE NUMBER 500082 INSPECTION CYCLE 2 YRS

ROUTE 195 NBL ACROSS BLACK CREEK M.P. 090+500

LOCATION 0.8MLN JCT US301/701

SUPERSTRUCTURE RC FLOOR/I-BEAMS

SUBSTRUCTURE EBTS;RC CAP H-PILES;INT.BTS.RCP&BEAM

SPANS 1 @ 50'3-2 @ 50'0-1 @ 51'6

PRESENT CONDITION FAIR

INVENTORY RATING HIS-22

INSPECTION DATE 10/19/2000

OPERATING RATING HIS-38

PRESENT POSTING NP

PROPOSED POSTING N.P.

COMPUTER UPDATE 12-8-00

ANALYSIS DATE 12-01-00

POSTING LETTER DATE

SPECIAL PERMIT

OTHER SIGNS PRESENT NONE



Photo Looking North

SIGN NOTICE ISSUED FOR	NUMBER REQUIRED
<u>No</u> WEIGHT LIMIT	<u> </u>
<u>No</u> SPECIAL PERMIT	<u> </u>
<u>No</u> DELINEATORS	<u> </u>
<u>No</u> NARROW BRIDGE	<u> </u>
<u>No</u> ONE LANE BRIDGE	<u> </u>
<u>No</u> LOW CLEARANCE	<u> </u>

***** IDENTIFICATION *****

(1) STATE NAME - NORTH CAROLINA BRIDGE 500082
(8) STRUCTURE NUMBER (FEDERAL) 000000001010082
(5) INVENTORY ROUTE (ON/UNDER) - ON = 111000950
(2) STATE HIGHWAY DEPARTMENT DISTRICT 04
(3) COUNTY CODE 101 (4) PLACE CODE
(6) FEATURES INTERSECTED - BLACK CREEK
(7) FACILITY CARRIED - I95 NBL
(9) LOCATION - 0.8MI N JCT US301/701
(11) MILEPOINT 090.500
(16) LATITUDE 35 D 28.6M (17) LONGITUDE 078 D 23.2M
(98) BORDER BRIDGE STATE CODE PCT SHARE
(99) BORDER BRIDGE STRUCTURE NO. #

***** STRUCTURE TYPE AND MATERIAL *****

(43) STRUCTURE TYPE MAIN: STEEL
TYPE - STRINGER/MBBEAM OR GIRDER CODE 302
(44) STRUCTURE TYPE APPR: OTHER
TYPE - OTHER CODE 000
(45) NUMBER OF SPANS IN MAIN UNIT 004
(46) NUMBER OF APPROACH SPANS 0000
(107) DECK STRUCTURE TYPE - CONCRETE C-I-P CODE 1
(108) WEARING SURFACE / PROTECTIVE SYSTEM:
A) TYPE OF WEARING SURFACE - BITUMINOUS CODE 6
B) TYPE OF MEMBRANE - NONE CODE 0
C) TYPE OF DECK PROTECTION - NONE CODE 0

***** AGE AND SERVICE *****

(27) YEAR BUILT 1958
(106) YEAR RECONSTRUCTED 0000
(42) TYPE OF SERVICE: ON - HIGHWAY
UNDER - WATERWAY CODE 15
(28) LANES: ON STRUCTURE 02 UNDER STRUCTURE 00
(29) AVERAGE DAILY TRAFFIC 021500
(30) YEAR OF ADT 1999 (109) TRUCK ADT PCT 23
(19) BYPASS, DETOUR LENGTH 01 MI

***** GEOMETRIC DATA *****

(48) LENGTH OF MAXIMUM SPAN 0052 FT
(49) STRUCTURE LENGTH 000202 FT
(50) CURB OR SIDEWALK: LBFT 01.5 FT RIGHT 01.5 FT
(51) BRIDGE ROADWAY WIDTH CURB TO CURB 028.3 FT
(52) DECK WIDTH OUT TO OUT 031.5 FT
(32) APPROACH ROADWAY WIDTH (W/SHOULDERS) 038 FT
(33) BRIDGE MEDIAN - OPEN MEDIAN CODE 1
(34) SKBW 00 DEG (35) STRUCTURE FLARED NO
(10) INVENTORY ROUTE MIN VERT CLEAR 99 FT 99 IN
(47) INVENTORY ROUTE TOTAL HORIZ CLEAR 28.3 FT
(53) MIN VERT CLEAR OVER BRIDGE RDWY 99 FT 99 IN
(54) MIN VERT UNDERCLEAR REF - NOT HY/RR 00 FT 00 IN
(55) MIN LAT UNDERCLEAR RT RBF - NOT HWY/RR 99.9 FT
(56) MIN LAT UNDERCLEAR LT 00.0 FT

***** NAVIGATION DATA *****

(38) NAVIGATION CONTROL - BRG PERMIT NOT REQ CODE 0
(111) PIER PROTECTION - NOT APPLICABLE CODE
(39) NAVIGATION VERTICAL CLEARANCE 000 FT
(116) VERT-LIFT BRIDGE NAV MIN VERT CLEAR FT
(40) NAVIGATION HORIZONTAL CLEARANCE 0000 FT

SUFFICIENCY RATING = 64.5
STATUS = FUNCTIONALLY OBSOLETE

***** CLASSIFICATION *****

(112) NBIS BRIDGE LENGTH - YES
(104) HIGHWAY SYSTEM - NHS ROUTE 1
(26) FUNCTIONAL CLASS - PRINCIPAL ARTERIAL- INTER 01
(100) DEFENSE HIGHWAY - YES DEFENSE HWY 1
(101) PARALLEL STRUCTURE - RT STR OF PARALLEL BRGS R
(102) DIRECTION OF TRAFFIC - 1-WAY TRAFFIC 1
(103) TEMPORARY STRUCTURE - NOT TEMPORARY
(110) DESIGNATED NATIONAL NETWORK - PART OF NETWORK 1
(20) TOLL - ON FREE ROAD 3
(21) MAINTAIN - STATE HIGHWAY AGENCY 01
(22) OWNER - STATE HIGHWAY AGENCY 01
(37) HISTORICAL SIGNIFICANCE - NOT ELIGIBLE 5

***** CONDITION *****

(58) DECK 5
(59) SUPERSTRUCTURE 5
(60) SUBSTRUCTURE 5
(61) CHANNEL & CHANNEL PROTECTION 8
(62) CULVERTS N

***** LOAD RATING AND POSTING *****

(31) DESIGN LOAD - HS 20+MOD 6
(64) OPERATING RATING - LF HS-38 168
(66) INVENTORY RATING - LF HS-22 139
(70) BRIDGE POSTING - NO POSTING REQUIRED 5
(41) STRUCTURE OPEN, POSTED, OR CLOSED A
DESCRIPTION - OPEN, NO RESTRICTION

***** APPRAISAL *****

(67) STRUCTURAL EVALUATION 5
(68) DECK GEOMETRY 3
(69) UNDERCLEARANCES, VERTICAL & HORIZONTAL N
(71) WATERWAY ADEQUACY 8
(72) APPROACH ROADWAY ALIGNMENT 8
(36) TRAFFIC SAFETY FEATURES 0111
(113) SCOUR CRITICAL BRIDGES 8

***** PROPOSED IMPROVEMENTS *****

(75) TYPE OF WORK - REPLACE FOR DEFICIENCY CODE 311
(76) LENGTH OF STRUCTURE IMPROVEMENT 000230 FT
(94) BRIDGE IMPROVEMENT COST \$ 671,000
(95) ROADWAY IMPROVEMENT COST \$ 67,000
(96) TOTAL PROJECT COST \$ 855,000
(97) YEAR OF IMPROVEMENT COST ESTIMATE 1999
(114) FUTURE ADT 043000 (115) YEAR FUTURE ADT 2010

***** INSPECTIONS *****

(90) INSPECTION DATE 10/2000 (91) FREQUENCY 24 MO
(92) CRITICAL FEATURE INSPECTION: (93) CFI DATE
A) FRACTURE CRIT DETAIL - NO - NO A)
B) UNDERWATER INSP - NO - NO B)
C) OTHER SPECIAL INSP - NO - NO C)
SCOUR -

BRIDGE INSPECTION RECORD AND SUMMARY

INSPECTION TYPE Routine INSPECTION DATE 10/19/2000
 BRIDGE NO. 500082 COUNTY JOHNSTON ROUTE 195 NBL OVER BLACK CREEK
 STRUCTURE TYPE RC FLOOR/I-BEAMS YEAR BUILT 1958
 ROUTE ORIENTATION S To N FOR SPAN 1-4 OF 4

EVALUATION CODE: 0 - 2 CRITICAL, 3 & 4 POOR, 5 & 6 FAIR, 7 - 9 GOOD

INSPECTION ITEMS					
DECK ITEMS			GRADE		
1 WEARING SURFACE			5	45 CHANNEL & CHANNEL PROT.	
2 DECK			5	a. WATERWAY	
NO. OF EA. TYPE SPN. GRADE RATES SI & A ITEM 58	a. CONCRETE	04	5	b. ALIGNMENT	
	b. TIMBER	00		c. SCOUR	
	c. STEEL PLANK	00		d. SLOPE PROT., RIP-RAP, DIKES, ETC.	
	d. OPEN GRID	00		50 APPROACH ROADWAY CONDITION	
3 RAILING			5	51 APPROACH SLABS	
a. CONCRETE b. TIMBER c. ALUMINUM d. STEEL				52 PAINT SYSTEM	
				CODE	A
				53 UTILITIES	
				54 RESPONSE TO LIVE LOAD	
4 CURBS - WHEELGUARDS - PARAPETS - MEDIANS			6	55 ESTIMATED REMAINING LIFE (YEARS)	
5 WALKWAYS (ON OR ATTACHED TO STRUCTURE)				60 REGULATORY SIGN NOTICE ISSUED	
6 DECK EXP			6	61 PROMPT - ACTION NOTICE ISSUED	
JTS OR DEVICES NO. OF EACH	a. STEEL PL. OR FINGER PL	00		62 PRESENTLY POSTED	
	b. MISC. PREFAB DEVICES	00		63 TOT. FIELD INSP. TIME (INCLUDE WRITE UP) (MH)	
	c. COMPRESSION SEALS	00		64 TOTAL SNOOPER INSP. TIME (HRS)	
	d. STANDARD JOINTS	05	4	65 TOTAL TRAFFIC CONTROL TIME (MH)	
	e. OPEN JOINTS	00		70 SI&A GENERAL CONDITION RATINGS	
7 DECK DEBRIS (INCLUDE EXCESS SAND / GRAVEL)			7	a. DECK	
				ITEM 58	
				b. SUPERSTRUCTURE	
				ITEM 59	
				c. SUBSTRUCTURE	
				ITEM 60	
				d. CHANNEL & CHANNEL PROT	
				ITEM 61	
				8	
				71 SI&A FIELD APPRAISAL RATINGS	
10 LONGITUDINAL BEAMS OR GIRDERS			6	a. WATERWAY ADAQUACY	
11 LONGITUDINAL JOIST OR STRINGERS				b. APPR. RDWY. ALIGNMENT	
12 INT. DIAP'S, X-FRAMES, BRACING, & CONN'S			8		
13 END DIAP'S, CURTAIN WALLS, & CONN'S			4		
14 FLOOR BEAMS AND CONNECTIONS					
15 BEARINGS ASSEMBLIES (INCLUDE MISALIGN)			5		
16 DRAINAGE SYSTEMS (ON STRUCTURES)			6	72 FIELD SCOUR EVALUATION	
17 MOVABLE SPAN MACHINERY					
USE OF INSP. ACCESSIBILITY EQUIPMENT					
SUBSTRUCTURE ITEMS, ITEM 60 (INCLUDES SCOUR)				SNOOPER (CODE P, S, 4 or N)	
35 TIM. SUBSTR.				LADDER	Y/N
a. ABUT. & INT. BENT CAPS & RISERS				OVERSIDE LADDER	Y/N
b. PILES, POST, SILLS, & BRACING				BUCKET TRUCK	Y/N
c. BULKHEADS, WING'S, & TIE BACKS				BOAT	Y/N
36 CONC. SUBSTR.			35	OTHER ()	Y/N
a. ABUT. & BENT CAPS			6	SPECIAL INSPECTION REQUESTED FOR:	
b. ABUT. & BENT COL'S & BREASTWALLS					
c. ABUT. & INT. BENT PILES					
d. BACKWALLS - WING'S - RETAIN. WALL			7		
e. ABUT. AND BENT FOOTINGS & SILLS					
37 STEEL SUBSTR.				NOTE:	
a. ABUT. & INT. BENT CAPS & RISERS					
b. PILES AND BRACING AND BULKHEADS					
38 FOUNDATION PILES, TYPE MATERIAL					
39 SLOPE PROT., RIP - RAP (INCLUDE DRAINAGE)			7		
40 FENDER SYSTEM				80 INSPECTED BY: P.F. SMITH	
41 DRIFT			8	81 REVIEWED BY: <i>PAB</i>	

J&J
126-00

Sheet of

BRIDGE INSPECTION RECORD AND SUMMARY

INSPECTION TYPE Routine INSPECTION DATE 8/11/98
 BRIDGE NO. 50082 COUNTY JOHNSTON ROUTE 195 NBL OVER BLACK CREEK
 STRUCTURE TYPE RC FLOOR/BEAMS YEAR BUILT 1958
 ROUTE ORIENTATION S To N FOR SPAN 1-4 OF 4

EVALUATION CODE: 0 - 2 CRITICAL, 3 & 4 POOR, 5 & 6 FAIR, 7 - 9 GOOD

INSPECTION ITEMS						
DECK ITEMS		GRADE	45 CHANNEL & CHANNEL PROT.	a. WATERWAY b. ALIGNMENT c. SCOUR d. SLOPE PROT., RIP-RAP, DIKES, ETC.	8	
1 WEARING SURFACE		6				
2 DECK NO. OF EA. TYPE SPN. GRADE RATES SI & A ITEM 58	a. CONCRETE	04	5			
	b. TIMBER	00				
	c. STEEL PLANK	00				
	d. OPEN GRID	00				
			50 APPROACH ROADWAY CONDITION		6	
			51 APPROACH SLABS		6	
			52 PAINT SYSTEM	CODE A	4	
			53 UTILITIES			
3 RAILING	a. CONCRETE		5	54 RESPONSE TO LIVE LOAD	7	
	b. TIMBER			55 ESTIMATED REMAINING LIFE (YEARS)	15	
	c. ALUMINUM					
	d. STEEL					
4 CURBS - WHEELGUARDS - PARAPETS - MEDIANS		6		60 REGULATORY SIGN NOTICE ISSUED	N	
5 WALKWAYS (ON OR ATTACHED TO STRUCTURE)				61 PROMPT - ACTION NOTICE ISSUED	Y	
6 DECK EXP JTS OR DEVICES NO. OF EACH		a. STEEL PL. OR FINGER PL b. MISC. PREFAB DEVICES c. COMPRESSION SEALS d. STANDARD JOINTS e. OPEN JOINTS	00 00 00 05 00	5	62 PRESENTLY POSTED 63 TOT. FIELD INSP. TIME (INCLUDE WRITE UP) (M/H) 64 TOTAL SNOOPER INSP. TIME (HRS) 65 TOTAL TRAFFIC CONTROL TIME (M/H)	N 0 0 0
7 DECK DEBRIS (INCLUDE EXCESS SAND / GRAVEL)		7		70 SI&A GENERAL CONDITION RATINGS		
				a. DECK	ITEM 58 5	
				b. SUPERSTRUCTURE	ITEM 59 5	
				c. SUBSTRUCTURE	ITEM 60 5	
				d. CHANNEL & CHANNEL PROT	ITEM 61 8	
SUPERSTRUCTURE (FM. 1(90)b TRUSS) I				71 SI&A FIELD APPRAISAL RATINGS		
10 LONGITUDINAL BEAMS OR GIRDERS		7		a. WATERWAY ADAQUACY	8	
11 LONGITUDINAL JOIST OR STRINGERS				b. APPR. RDWY. ALIGNMENT	8	
12 INT. DIAP'S, X-FRAMES, BRACING, & CONN'S		8		72 FIELD SCOUR EVALUATION	0	
13 END DIAP'S, CURTAIN WALLS, & CONN'S		5		USE OF INSP. ACCESSIBILITY EQUIPMENT		
14 FLOOR BEAMS AND CONNECTIONS		5		SUBSTRUCTURE ITEMS, ITEM 60 (INCLUDES SCOUR)		
15 BEARINGS ASSEMBLIES (INCLUDE MISALIGN)		5		SNOOPER (CODE P, S, 4 or N)		
16 DRAINAGE SYSTEMS (ON STRUCTURES)		6		LADDER	Y/N Y	
17 MOVABLE SPAN MACHINERY				OVERSIDE LADDER	Y/N N	
35 TIM. SUBSTR.	a. ABUT. & INT. BENT CAPS & RISERS			BUCKET TRUCK	Y/N N	
	b. PILES, POST, SILLS, & BRACING			BOAT	Y/N N	
	c. BULKHEADS, WING'S, & TIE BACKS			OTHER ()	Y/N N	
	d. BACKWALLS - WING'S - RETAIN. WALL	7		SPECIAL INSPECTION REQUESTED FOR:		
	e. ABUT. AND BENT FOOTINGS & SILLS					
36 CONC. SUBSTR.	a. ABUT. & BENT CAPS	5		NOTE:		
	b. ABUT. & BENT COL'S & BREASTWALLS	6				
37 STEEL SUBSTR.		a. ABUT. & INT. BENT CAPS & RISERS b. PILES AND BRACING AND BULKHEADS				
38 FOUNDATION PILES, TYPE MATERIAL						
39 SLOPE PROT., RIP - RAP (INCLUDE DRAINAGE)		7				
40 FENDER SYSTEM				80 INSPECTED BY: BOF		
41 DRIFT		8		81 REVIEWED BY: <i>BBB</i>		

Sheet of

Bridge I&A Form 1(82) H
 Revised 6/4/97

STATE OF NORTH CAROLINA
 DEPT. OF TRANSPORTATION
 DIVISION OF HIGHWAY

Bridge Maintenance Unit
 Bridge Inspection Sect.

Field Inspection Report

Bridge Inspection & Analysis

Bridge No. 500082

Route 195 NBL

County JOHNSTON

Team Leader: P.F. SMITH Date: 10/19/2000

Assisted By: RDH

Item No.			Description
1	ASPHALT WEARING SURFACE	5	CRACKED, BUCKLED AND BROKEN ALONG EXPANSION JOINTS AND AT END BENTS. [SEE PHOTOS]
2a	DECK	5	SHALLOW JOINT SPALLS AT EXPOSED AREAS ON TOP SURFACE. THERE ARE A FEW TRANSVERSE AND LONGITUDINAL CRACKS WITH EFFLO. BUILDUP ON THE UNDERSIDE. THERE ARE SEVERAL SHALLOW SPALLS ON THE UNDERSIDE OF THE DECK OVERHANG WITH EXPOSED REBARS.
3a	RAILS	5	MINOR SPALLING AT THE APPROACH ROADWAY GUARDRAIL ATTACHMENTS, WEST RAIL POST BRACKET OVER BENT NO. 3 SPALLED WITH EXPOSED REBARS. [SEE PHOTOS]
4	CURBS	6	MINOR CRACKS AND CHIPS.
6d	EXPANSION JOINTS	4	TOP SEAL DETERIORATED AND FILLER IS LOOSE, SIGNS OF HEAVY LEAKAGE ON UNDERSIDE.
7	DECK DEBRIS	7	THERE ARE A FEW DECK DRAINS BLOCKED BY DEBRIS.
10	BEAMS	6	RUSTING AND CORROSION AT THE WEBS AND FLANGES AT THE BEARING AREAS WITH UP TO 1/8" PITTING AND SECTION LOSS. [SEE PHOTOS] SURFACE RUST AT MANY LOCATIONS.
13	END DIAPHRAGMS, CURTAINWALLS,		SHALLOW SPALLING ALONG THE LOWER EDGES OF THE INTERIOR CURTAINWALLS THAT APPEAR TO BE CAUSED BY SUPERSTRUCTURE EXPANSION. THERE ARE ALSO CRACKS ALONG THE TOP OF THE CURTAINWALL IN SEVERAL BAYS WITH EFFLO. LEAKAGE. [SEE PHOTOS] THE END DIAPHRAGMS HAVE CRACKING AND EFFLO. LEAKAGE ALONG THE TOP AND APPEAR TO HAVE SEPARATED FROM THE DECK. [SEE PHOTOS]
15	BEARINGS	5	MODERATE RUST AND CORROSION AT THE INTERIOR BENT BEARINGS AND THE END BENTS.
16	DRAINAGE	6	SEVERAL DECK DRAINS BLOCKED BY DEBRIS, SIGNS OF MINOR PONDING.
36a	CAPS	3	BENT NO. 1 CAP IS SPALLED AT BEAM NO. 3 OF SPAN NO. 1 AND BEAM NO. 1 OF SPAN 2 ARE SPALLED TO BEYOND THE ANCHOR BOLTS. [SEE PHOTOS] (PROMPT ACTION ISSUED FOR THIS ITEM 10/20/00) THE REMAINING CAPS HAVE HAIRLINE CRACKING, SOME WITH EFFLO. AT SEVERAL LOCATIONS. THE END BENT CAPS HAVE HORIZ. AND DIAG. CRACKS IN THE VERTICAL FACE THAT START AT THE BRACE PILE CAPS. [SEE PHOTOS]
36b	COLUMNS	6	MINOR VERTICAL HAIRLINE CRACKS ALONG THE CORNER AREAS. SEVERAL AREAS OF DEEP HONEYCOMB AT COLD JOINTS.
50	APPROACH ROADWAY	6	MINOR CRACKING. ASPHALT WEARING SURFACE BROKEN ALONG CURTAINWALLS.
52	PAINT	4	BEAMS AND BEARINGS RUSTED AND CORRODED, PAINT PEELING AND SURFACE RUST AT MANY LOCATIONS.

BRIDGE INSPECTOR'S RECOMMENDATION FOR MAINTENANCE REPAIRS

BRIDGE 500082 COUNTY JOHNSTON DIVISION 04

INSPECTED BY P.F. SMITH DATE 10/19/2000

THESE REPAIRS SHOULD BE MADE WITHIN TWELVE MONTHS FROM DATE OF THIS INSPECTION

FUNCTION CODE	DESCRIPTION OF FUNCTION	UNIT	QUANTITY	REMARK	EST. COST
554	PARTIAL CLEANING AND PARTIAL PAINTING OF STRUC. STEEL	MHS	0000400	CLEAN AND PAINT STRUCTURAL STEEL [AS NEEDED]	
000	NO FUNCTION CODE AVAILABLE FOR THIS ITEM				
583	MAINTENANCE OF CONCRETE PIERS AND ABUTMENTS	MHS	0000200	REPAIR SPALLS IN BENT NO. 3 CAP PROMPT ACTION ISSUED FOR THIS ITEM 10/20/00	
583	MAINTENANCE OF CONCRETE PIERS AND ABUTMENTS	MHS	0000150	SEAL CRACKS AND HONEYCOMBED AREAS IN PIERS	
556	BRIDGE APPROACHES AND SURFACING REPLACEMENT	MHS	0000080	REPLACE MISSING ASPHALT WEARING SURFACE AT EXPANSION JOINTS	
566	MAINTENANCE OR REPAIRS TO CONCRETE BRIDGE HANDRAILS	LF	0000012	REPAIR SPALLED RAIL POSTS ON UNDERSIDE	
578	GENERAL MAINTENANCE OF BRIDGE SUPERSTRUCTURE	MHS	0000070	REPAIR CRACKS AND SPALLS IN DIAPHRAGMS	
000	NO FUNCTION CODE AVAILABLE FOR THIS ITEM				
000	NO FUNCTION CODE AVAILABLE FOR THIS ITEM				
000	NO FUNCTION CODE AVAILABLE FOR THIS ITEM				
000	NO FUNCTION CODE AVAILABLE FOR THIS ITEM				
000	NO FUNCTION CODE AVAILABLE FOR THIS ITEM				



ASPHALT WEARING SURFACE AT BENT 1 JOINT



ASPHALT WEARING SURFACE AT BENT 3 JOINT



DEBRIS ALONG EAST CURB



WEST RAIL AT BENT 3 UNDERSIDE SPALLED



END DIAPHRAGM IN BAY 1, SPAN 1 AT BENT 1 CRACKED /EFFLO



BAY 3 AT END BENT 1 CURTAINWALL SPALLS AND LEAKAGE



BEAM 2, SPAN 4 PAINT CONDITION SIMILAR



BY. 3 DIAPHRAGM SP. 1, & 2 AT BT. 1 SPALLS @ EXTERIOR JOINT



BENT 1 CAP AT BEAM 1 OF SPAN 2 SPALLED 15" X 34" X 10 1/2"
1" BEYOND ANCHOR BOLTS (P.A.)



COLUMN 2, AT BENT 1 MINOR HONEYCOMB



BENT 1 CAP AT BEAM 1 SPAN 2 SPALLED (P.A.)



BENT 1 CAP AT BEAM 3, SPAN 1 SPALLED AT EAST ANCHOR
BOLT 20"W X 13"H X 10"D (P.A.)



BENT 3 CAP SPAN 4 SIDE AT BEAM 3 CAP CRACKS



BAY 3 END BENT 2 CURTAINWALL W/ HORIZ. CRACKS 2" DOWN



BAY 2, & 3 SPAN 3 AT BENT 2 EFFLO. CRACKS & LEAKS @ DECK



END BENT 2 MAPCRACKS AT BRACE PILE 3



BAY 2 AT END BENT 2 CURTAINWALL VERT. & HORIZ. H.L'S



END BENT 2 CAP AT BRACE PILE 2 WITH DIAGONAL CRACK



SAME AS ABOVE PHOTO

NORTH CAROLINA

Revised 6/12/97

DEPARTMENT of TRANSPORTATION

DIVISION of HIGHWAYS

BRIDGE MAINTENANCE UNIT

STRUCTURE DATA FILE

COUNTY JOHNSTON

BRIDGE NO. 500082

- CONTENTS:
- DATA CARD
 - STRUCTURE DATA WORK SHEETS
 - STREAM BED SOUNDINGS & PROFILE SKETCH
 - FORM 501 or 502
 - FORM EMD - 9
 - RETURNED PROMPT ACTION NOTICE SHOWING REPAIRS
 - OTHER SKETCHES & NOTES SHOWING STRUCTURE DETAILS
 - PHOTOGRAPHS

NOTE. STRUCTURE ANALYSIS - CHECK / YES or NO _____
WHEN PLANS ARE AVAILABLE

FIELD INSPECTOR _____

PREVIOUS DATA CORRECT
AND RESUBMITTED

DATE: 10/19/00

BY: Paul J. [Signature]

B80028

BRIDGE MAINTENANCE UNIT
DATA ON EXISTING STRUCTURE

RUN DATE 12/08/00

COUNTY: JOHNSTON DIV.: 04 DIST.: 3 STRUCTURE NUMBER: 50 0082 LENGTH: 202 FEET

ROUTE CARRIED: I95 NBL FEATURE INTERSECTED: BLACK CREEK

LOCATED: 0.8MI N JCT US301/701 BRIDGE NAME:

FUNC. CLASS: IR SYST.ON: FA SYST.UNDER: ADT & YR: 21500 99 RAIL TYPE: LT 111 RT 111

BUILT: 1958 BY: SHC PROJ: 8.12339 FED.AID PROJ: DESIGN LOAD: HS20+MOD

REHAB: BY: PROJ: ALIGNMENT: TAN. SKEW: 090 LANES: ON 02 UNDER 00

NAVIGATION: VC --- FT HC --- FT HT.CRN.TO BED: 27 FT WATER DEPTH: 2 FT

SUPERSTRUCTURE: RC FLOOR/I-BEAMS

SUBSTRUCTURE: EBTS:RC CAP H-PILES;INT.BTS.RCP&BEAM

SPANS: 1 @ 50'3;2 @ 50'0;1 @ 51'6

BEAMS OR GIRDERS: 4 LINES W33X130 I-BEAMS @ 8'0 CENTERS

FLOOR: 6.75 RC/3 AWS ENCROACHMENTS: DECK (OUT TO OUT): 031.5

CLEAR ROADWAY: 028.3 BETWEEN RAILS: 031 .3 SIDEWALK OR CURB: LT 01.5 RT 01.5

VERT.CL.OVER: 99 FT 99 IN VERT.CL.UNDER: 00 FT 00 IN HOR.CL.UNDER: 00.0 FT SPECIAL PERMIT: ---

INV.RTG.: HS- 22 OPE.RTG.: HS- 38 CONTR.MEMBER: POSTED: SV -- TTST -- DATE --

SYSTEM: 3 INTERSTATE GREEN LINE ROUTE: YES

2ND OPENING: 3RD OPENING: 4TH OPENING: 5TH OPENING:

REMARKS:

FIELD SKETCH SHEET

FOR

VERTICAL & HORIZONTAL CLEARANCES

9-23-92

WB&

BRIDGE No. 500082 COUNTY JOHNSTON DATE 1-15-86 BY [Signature]
11-19-00-RDH 7-18-90 BOF

APPROACH ROADWAY (DEFINE S.I.A ITEMS 32, 33, & 47)

- APPR. RD'wy WIDTH
- APPR. MEDIAN
- TOTAL HORIZ. CLR.

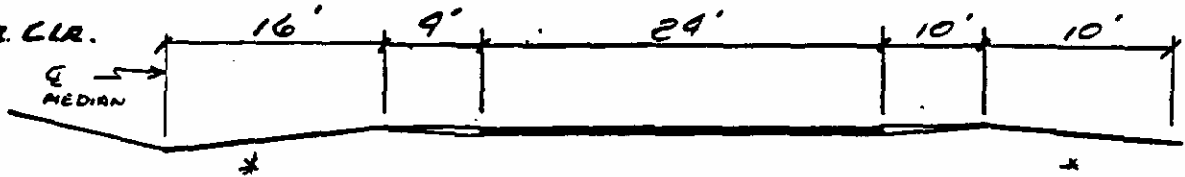

LOOKING NORTH

* UNSTABLE

STRUCTURE DATA WORKSHEET

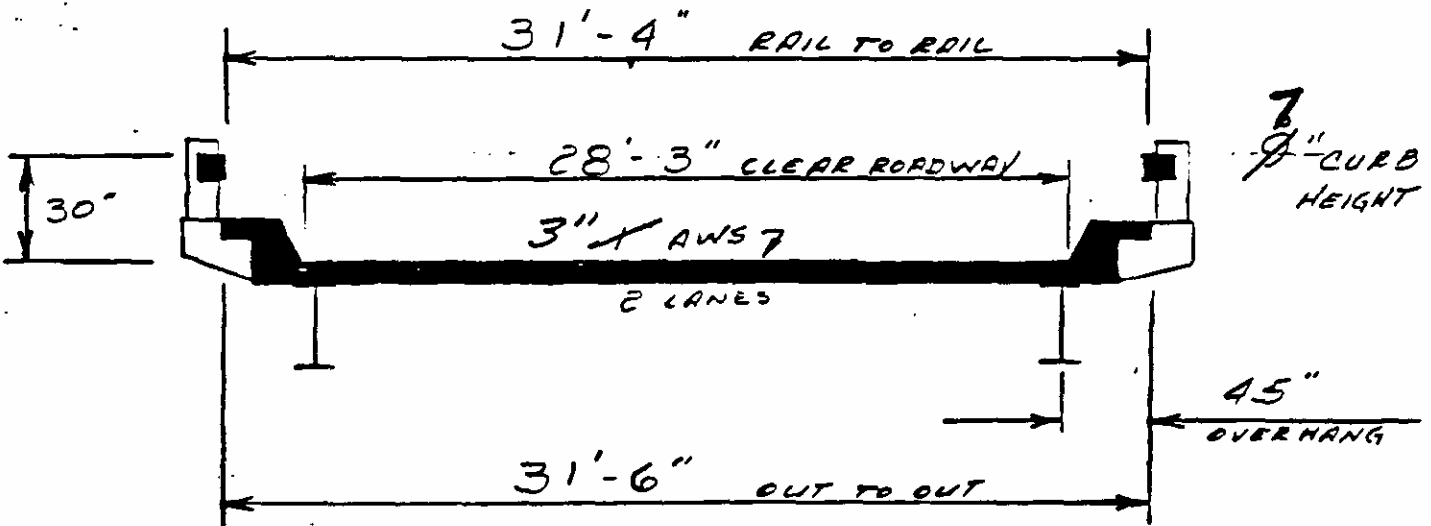

FILLED JOINTS

Bridge #: 500082 NBL

County: JOHNSTON

Date: 10-19-00

By: RDH Page

of

STREAMBED PROFILE (Downstream)

Top of Rail = 0 (Sounding)

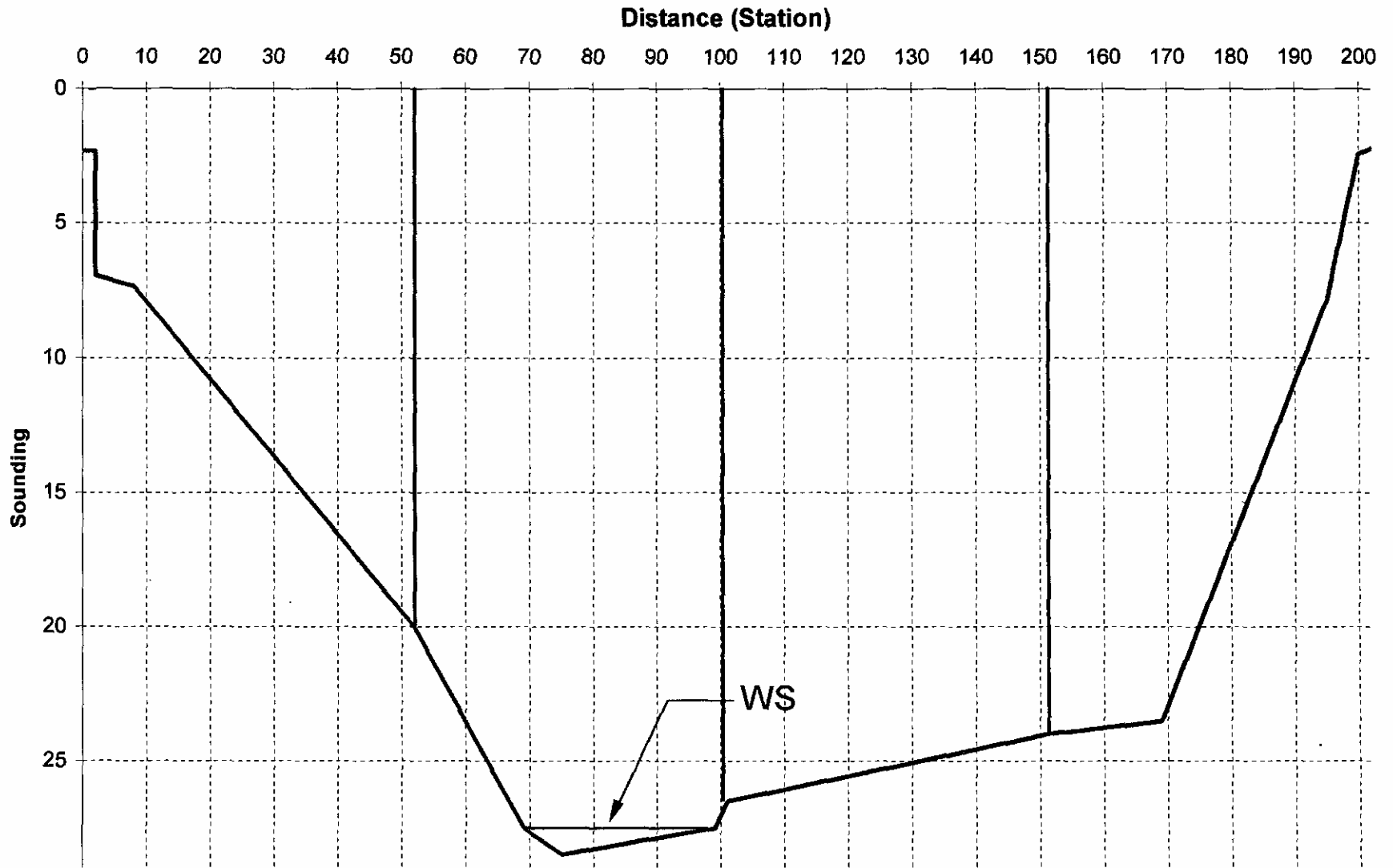

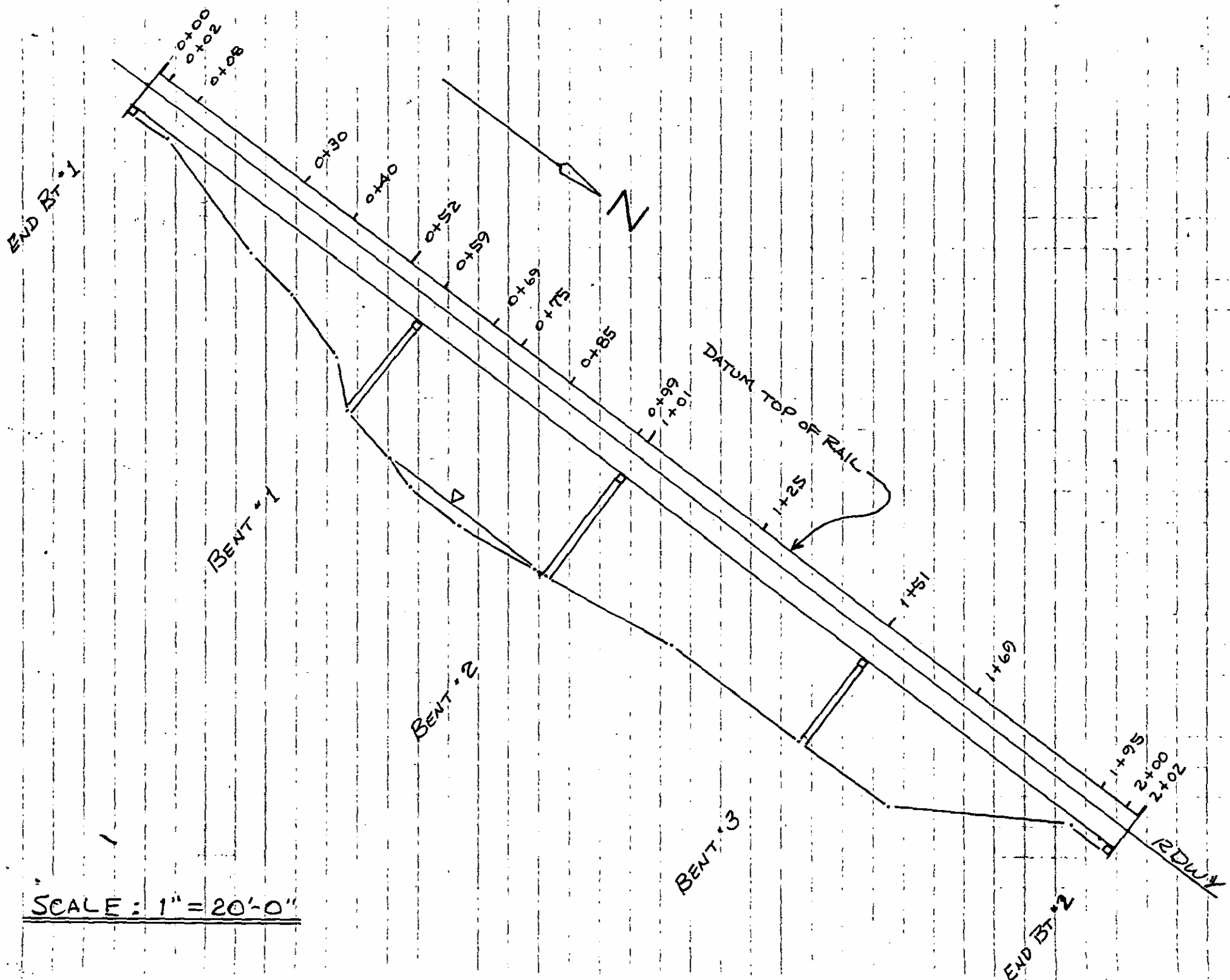

8-9-96 PDF

STREAM BED SOUNDINGS

(SEE NEXT SHEET FOR PROFILE SKETCH)

7-25-94 BOC

BRIDGE NO. 82 NSL COUNTY Jackson DATE 9-23-92 BY MSW

RECORD SOUNDINGS FROM TOP OF RAIL. OTHER LOCATION IF NEEDED: _____

DISTANCE N. M. MARK TO TOP OF RAIL 20'-0" LOCATION N. M. MARK STAINS

NOTE: DRAFT A STREAM BED PROFILE SKETCH AND RECORD SOUNDINGS AT THE STREAM FACE OF ABUTMENTS, C/L OF PIERS, WF, & WS, AND MAJOR CONTOUR CHANGES ON THE DOWNSTREAM SIDE. RECORD SOUNDINGS AT THE STREAM FACE OF ABUTMENTS AND C/L OF PIERS ON THE UPSTREAM SIDE.

DOWNSTREAM

UPSTREAM

STATION	SOUNDING	DESCRIPTION	STATION	SOUNDING	DESCRIPTION
0+00	2-4"	Top AWS			
0+02	6-11"	G.L.	0+02	7-0"	G.L.
0+08	7-3"	G.L.			
0+30	14-6"	G.L.			
0+40	16-0"	G.L.			
0+52	20-0"	MT 1	0+52	26-0"	MT 1
0+59	26-0"	G.L.			
0+69	28-0"	WSWE			
0+75	29-9"	WS			
0+85	29-9"	WS			
0+99	28-0"	WSWE			
1+01	27-9"	MT 2	1+01	25-0"	MT 2
1+25	24-0"	G.L.			
1+51	24-0"	MT 3	1+51	23-6"	MT 3
1+69	23-6"	Top Slope Prof.			
1+95	7-9"	Top Slope Prof.			
2+00	6-8"	Top Cap	2+00	7-6"	Top Cap
2+02	2-4"	Top AWS			

Stream Bed Profile
Downstream Side
#82 Johnston 9-23-92
MSW WBE

NORTH 

SOUNDINGS TAKEN FROM TOP OF RAIL

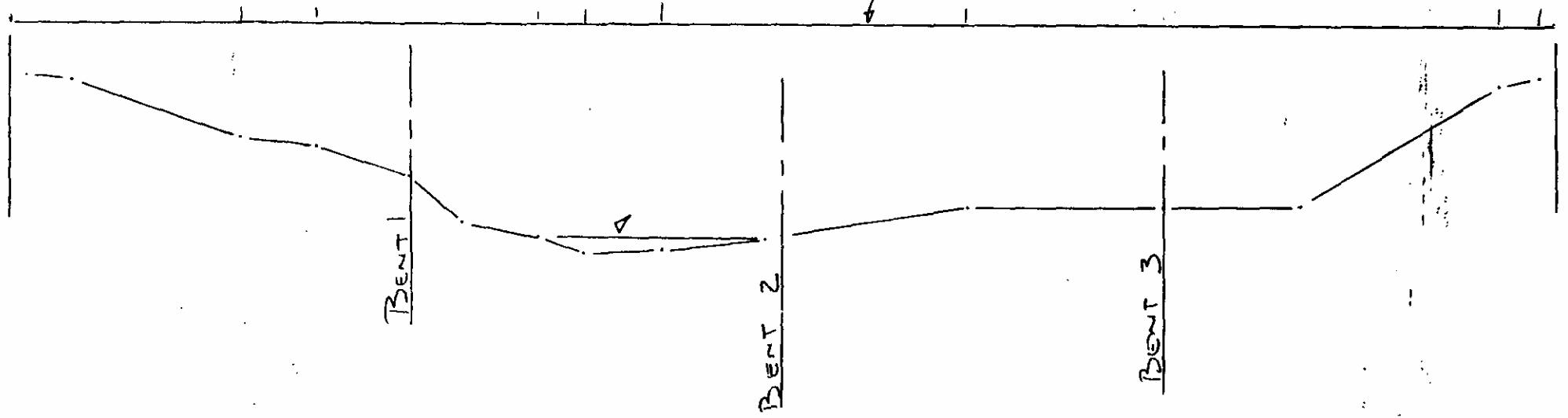

SCALE 1" = 20'-0"

7-25-94 BGF
8-9-96 BGF

STREAM BED SOUNDINGS

(SEE NEXT SHEET FOR PROFILE SKETCH)

7-25-94 BOC

BRIDGE NO. B2 NBL COUNTY Jackson DATE 9-23-92 BY MSW

RECORD SOUNDINGS FROM TOP OF RAIL. OTHER LOCATION IF NEEDED: _____

DISTANCE H. W. MARK TO TOP OF RAIL 20'-0" LOCATION H. W. MARK STAINS

NOTE: DRAFT A STREAM BED PROFILE SKETCH AND RECORD SOUNDINGS AT THE STREAM FACE OF ABUTMENTS, C/L OF PIEPS, WF, & WS, AND MAJOR CONTOUR CHANGES ON THE DOWNSTREAM SIDE. RECORD SOUNDINGS AT THE STREAM FACE OF ABUTMENTS AND C/L OF PIERS ON THE UPSTREAM SIDE.

DOWNSTREAM

UPSTREAM

STATION	SOUNDING	DESCRIPTION	STATION	SOUNDING	DESCRIPTION
0+00	2'-4"	Top AWS			
0+02	6'-11"	G.L.	0+02	7'-0"	G.L.
0+08	7'-3"	G.L.			
0+30	14'-6"	G.L.			
0+40	16'-0"	G.L.			
0+52	20'-0"	MT 1	0+52	26'-0"	MT 1
0+59	26'-0"	G.L.			
0+69	28'-0"	WSWE			
0+75	29'-9"	WSW			
0+85	29'-9"	WSW			
0+97	28'-0"	WSWE			
1+01	27'-9"	MT 2	1+01	25'-0"	MT 2
1+25	24'-0"	G.L.			
1+51	24'-0"	MT 3	1+51	23'-6"	MT 3
1+69	23'-6"	Toe Slope Prof.			
1+95	7'-9"	Top Slope Prof.			
2+00	6'-8"	Top Cap	2+00	7'-6"	Top Cap
2+02	2'-4"	Top AWS			

Stream Bed Profile
Downstream Side
#82 Johnston 9-23-92
MSW WBE

NORTH

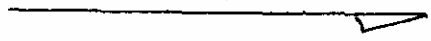

SOUNDINGS TAKEN FROM TOP OF RAIL

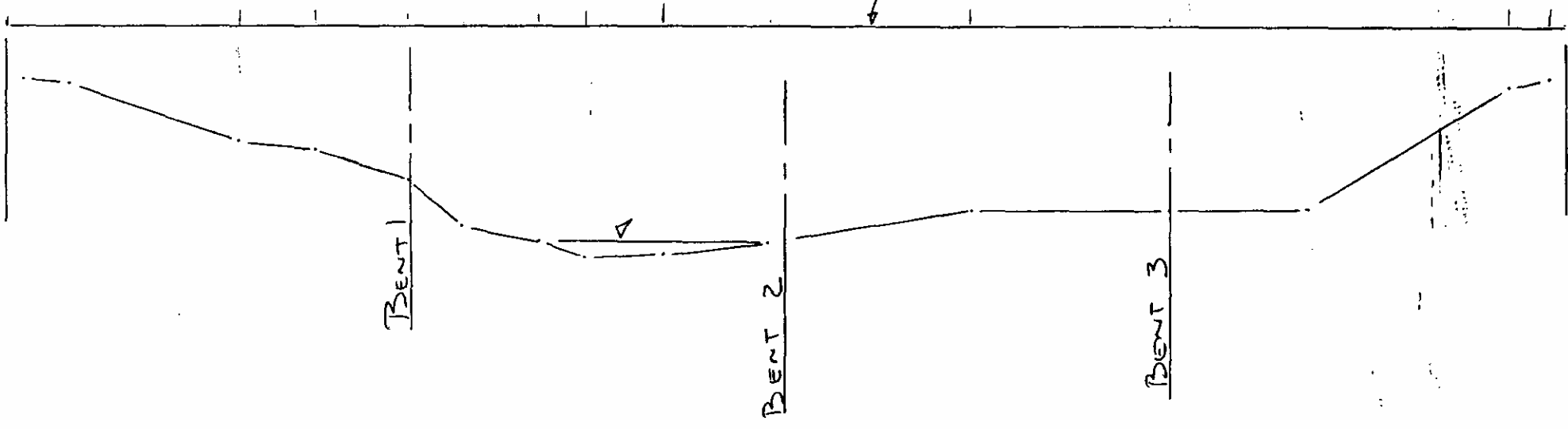

SCALE 1" = 20'-0"

7-25-94 B5F

8-9-96 BDF

STREAM BED SOUNDINGS

(SEE NEXT SHEET FOR PROFILE SKETCH)

7-25-94 BOC

BRIDGE NO. 82 NSL COUNTY Jackson DATE 9-23-92 BY MSW

RECORD SOUNDINGS FROM TOP OF RAIL. OTHER LOCATION IF NEEDED: _____

DISTANCE N. W. MARK TO TOP OF RAIL 20'-0" LOCATION N. W. MARK STAINS

NOTE: DRAFT A STREAM BED PROFILE SKETCH AND RECORD SOUNDINGS AT THE STREAM FACE OF ABUTMENTS, C/L OF PIERS, WE, & WS, AND MAJOR CONTOUR CHANGES ON THE DOWNSTREAM SIDE. RECORD SOUNDINGS AT THE STREAM FACE OF ABUTMENTS AND C/L OF PIERS ON THE UPSTREAM SIDE.

DOWNSTREAM

UPSTREAM

STATION	SOUNDING	DESCRIPTION	STATION	SOUNDING	DESCRIPTION
0+00	2'-4"	Top AWS			
0+02	6'-11"	G.L.	0+02	7'-0"	G.L.
0+08	7'-3"	G.L.			
0+30	14'-6"	G.L.			
0+40	16'-0"	G.L.			
0+52	20'-0"	MT 1	0+52	26'-0"	MT 1
0+59	26'-0"	G.L.			
0+69	28'-0"	WSWE			
0+75	29'-9"	BSW			
0+85	29'-9"	BSW			
0+99	28'-0"	WSWE			
1+01	27'-9"	MT 2	1+01	25'-0"	MT 2
1+25	24'-0"	G.L.			
1+51	24'-0"	MT 3	1+51	23'-6"	MT 3
1+69	23'-6"	Toe Slope Prof.			
1+95	7'-9"	Top Slope Prof.			
2+00	6'-8"	Top Cap	2+00	7'-6"	Top Cap
2+02	2'-4"	Top AWS			

Stream Bed Profile
Downstream Side
#82 Johnston 9-23-92
MSW WBE

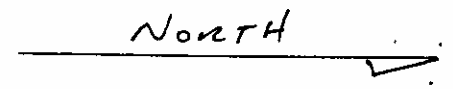

SOUNDINGS TAKEN FROM TOP OF RAIL

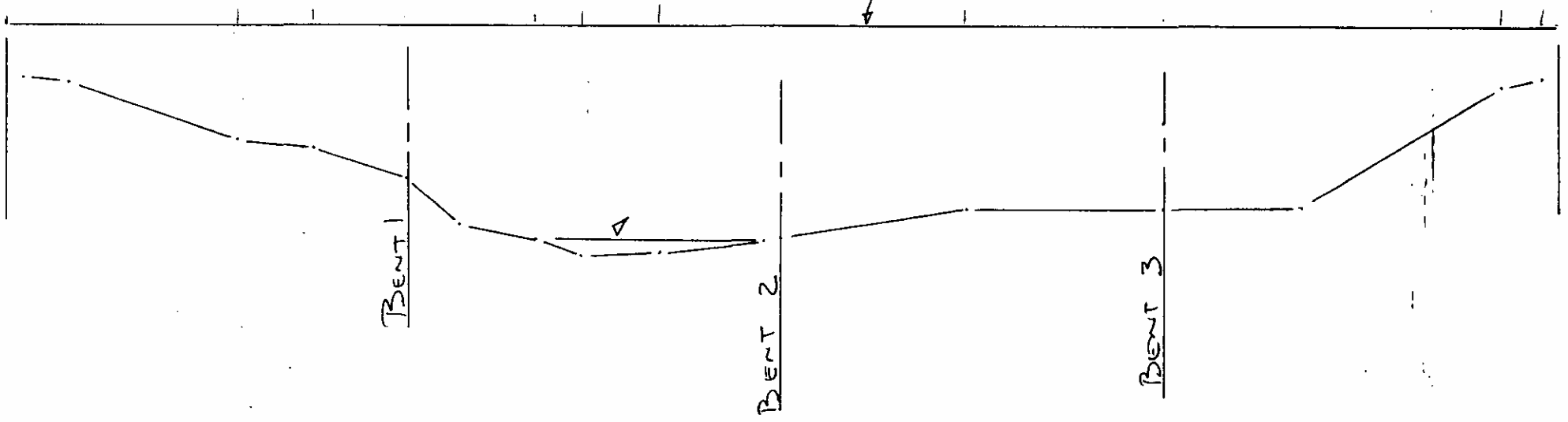

Scale 1" = 20'-0"

7-25-94 BGF
8-9-96 BGF

STREAM BED SOUNDINGS

(SEE NEXT SHEET FOR PROFILE SKETCH)

BRIDGE NO. 82 NBL COUNTY Johannston DATE 7-25-94 BOC
9-23-92 BY MSW

RECORD SOUNDINGS FROM TOP OF RAIL. OTHER LOCATION IF NEEDED: _____

DISTANCE H. W. MARK TO TOP OF RAIL 20'-0" LOCATION H. W. MARK STAINS
8"

NOTE: DRAFT A STREAM BED PROFILE SKETCH AND RECORD SOUNDINGS AT THE STREAM FACE OF ABUTMENTS, C/L OF PIERS, WE, & WS, AND MAJOR CONTOUR CHANGES ON THE DOWNSTREAM SIDE. RECORD SOUNDINGS AT THE STREAM FACE OF ABUTMENTS AND C/L OF PIERS ON THE UPSTREAM SIDE.

DOWNSTREAM

UPSTREAM

STATION	SOUNDING	DESCRIPTION	STATION	SOUNDING	DESCRIPTION
0+00	2'-4"	Top AWS			
0+02	6'-11"	G.L.	0+02	7'-0"	G.L.
0+08	7'-3"	G.L.			
0+30	14'-6"	G.L.			
0+40	16'-0"	G.L.			
0+52	20'-0"	BT 1	0+52	26'-0"	BT 1
0+59	26'-0"	G.L.			
0+69	28'-0"	WSWE			
0+75	29'-9"	BSW			
0+85	29'-9"	BSW			
0+99	28'-0"	WSWE			
1+01	27'-9"	BT 2	1+01	25'-0"	BT 2
1+25	24'-0"	G.L.			
1+51	24'-0"	BT 3	1+51	23'-6"	BT 3
1+69	23'-6"	Toe Slope Post			
1+95	7'-9"	Top Slope Post			
2+00	6'-8"	Top Cap	2+00	7'-6"	Top Cap
2+02	2'-4"	Top AWS			

STREAM BEN PROFILE
DOWNSTREAM SIDE
#82 JOHNSTON 9-23-92
MSW WBE

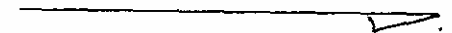
NORTH 

SOUNDINGS TAKEN FROM TOP OF RAIL

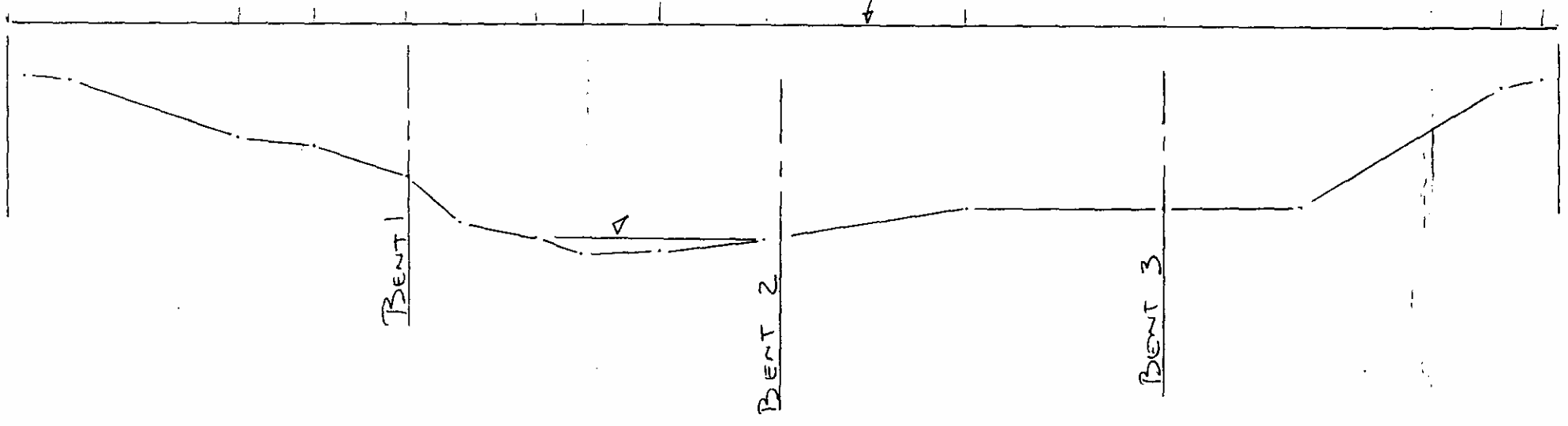

SCALE 1" = 20'-0"

7-25-94 BSE



LOOKING NORTH



LOOKING NORTH



LOOKING SOUTH



LOOKING SOUTH



ASPHALT WEARING SURFACE AT BENT 1 JOINT



ASPHALT WEARING SURFACE AT BENT 3 JOINT



EAST SIDE



WEST SIDE



SPAN 2 UNDERSIDE. (ALL SPANS SIMILAR)



BENT 2



EAST END OF BENT 1



UPSTREAM (WEST)



DOWNSTREAM (EAST)