



STATE OF NORTH CAROLINA  
DEPARTMENT OF TRANSPORTATION

MICHAEL F. EASLEY  
GOVERNOR

LYNDO TIPPETT  
SECRETARY

January 23, 2008

MEMORANDUM

To: M. L. Holder, P.E.  
Division Engineer

From: J. Kevin Lacy, P.E.  
State Traffic Engineer

Subject: Notification of Route Change

Attached are copies of the highway traffic ordinances, effective January 23, 2008, changing the routing of NC 16 in Catawba County. A map is also attached for your reference. Please revise signing as necessary.

If you have any questions or need additional information, please let me know.

JKL:jdj

Attachment

cc: J. A. Hamrick, P.E. att.  
R. J. Jaeger, P.E., att.  
S. Nichols, att.  
Hardee Cox, att.

MAILING ADDRESS:  
TRAFFIC ENGINEERING AND SAFETY SYSTEMS BRANCH  
1561 MAIL SERVICE CENTER  
RALEIGH NC 27699-1561

TELEPHONE: 919-733-3915  
FAX: 919-733-2261

WEBSITE: [WWW.DOH.DOT.STATE.NC.US](http://WWW.DOH.DOT.STATE.NC.US)

LOCATION:  
122 NORTH McDOWELL STREET  
RALEIGH NC 27603

File  
Room



STATE OF NORTH CAROLINA  
DEPARTMENT OF TRANSPORTATION

MICHAEL F. EASLEY  
GOVERNOR

LYNDO TIPPETT  
SECRETARY

January 23, 2008

MEMORANDUM

To: M. L. Holder, P.E.  
Division Engineer

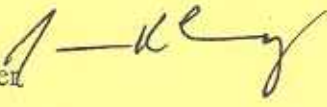
From: J. Kevin Lacy, P.E.   
State Traffic Engineer

Subject: Notification of Route Change

Attached are copies of the highway traffic ordinances, effective January 23, 2008, changing the routing of NC 150 in Lincoln County. A map is also attached for your reference. Please revise signing as necessary.

If you have any questions or need additional information, please let me know.

JKL:jdj

Attachment

cc: J. A. Hamrick, P.E. att.  
R. J. Jaeger, P.E., att.  
S. Nichols, att.  
Hardee Cox, att.

MAILING ADDRESS:  
TRAFFIC ENGINEERING AND SAFETY SYSTEMS BRANCH  
1561 MAIL SERVICE CENTER  
RALEIGH NC 27699-1561

TELEPHONE: 919-733-3915  
FAX: 919-733-2261

WEBSITE: [WWW.DOH.DOT.STATE.NC.US](http://WWW.DOH.DOT.STATE.NC.US)

LOCATION:  
122 NORTH McDOWELL STREET  
RALEIGH NC 27603



STATE OF NORTH CAROLINA  
 DEPARTMENT OF TRANSPORTATION  
 P.O. BOX 25201, RALEIGH, N.C. 27611-5201

**CERTIFICATION OF RULEMAKING**

Certifying Agency: Department of Transportation

---

Action:        X   Adoption      \_\_\_\_\_ Amendment        X   Repeal

---

Formal Action Date:	Statutory Authority: GS 136-30 GS 136-54	Public Notice Date: N/A
Public Hearing Date N/A	Public Hearing Not Required For This Action Under GS 150A-1, 20-1	

---

Rule Summary (Also indicate change in rule if amended):  
Route Change

---

Circumstances Requiring Rule Adoption, Amendment or Repeal:  
Necessary for public safety and welfare.

---

Effective Date: January 23, 2008

*J. Kevin Lacy*  
 OFFICER SIGNATURE

---

J. Kevin Lacy, P.E.  
 TYPED NAME

---

State Traffic Engineer  
 TITLE



BOARD OF TRANSPORTATION  
HIGHWAY TRAFFIC ORDINANCES

The Board of Transportation has delegated to the Secretary of Transportation the authority to adopt and promulgate all rules and regulations and ordinances regulating traffic on the highways pursuant to authority of N.C.G.S. 143B-350 (g) (see 19A1NCAC 4A.0104).

The State Traffic Engineer is subdelegated the authority by the Secretary of Transportation to adopt and promulgate all necessary rules, regulations and ordinances for the use of and to police traffic on state highways, pursuant to authority of N.C.G.S. 143B-350 (g) (see 19A1NCAC 4A.0104).

Pursuant to that delegation, the State Traffic Engineer hereby adopts and promulgates the following ordinances based on traffic and engineering studies performed by the Traffic Engineering Branch, Department of Transportation, and in accordance with General Statute 136-30, 136-54.

**ROUTE CHANGE**

Division 12

Catawba County

Delete the following routing of NC 16 and add the remaining segment as NC 16 Business:

NC 16 from SR 2105 northward to NC 16 South.

Delete the following routing of NC 16 North and add the remaining segment as NC 16 Business North:

NC 16 North from NC 10/ NC 16 northward to NC 16/ NC 16 South.

Delete the following routing of NC 16 South and add the remaining segment as NC 16 Business South:

NC 16 South from NC 10/16 northward to NC 16/ NC 16 North.

Delete the following routing of NC 16 and add the remaining segment as NC 16 Business:

NC 16 from the NC 16 North/ South split northward to NC 16 (New) (R-2404B).

Add the following routing of NC 16:

Project U-2404A from existing (Old NC 16) northward to just south of SR 1739 (Begin U-2404B).

Add the following routing of NC 16:

Project U-2404B from just south of SR 1739 northward to NC 16 (Old).

Delete the following routes:

SR 2642 from south of SR 1739 to US 70.

SR 2437 from US 70 to NC 16 (Old).

**ROUTE CHANGE**

Division 12

Lincoln County

Delete the following routing of NC 150 and add the remaining segment as a Secondary Route:

NC 150 from NC 150 (Project R-0617BA) just east of the Gaston County Line to NC 150 (Project R-0617BA east of SR 1177).

Add the following routing of NC 150:

Project R-0617BA from existing (Old NC 150) just east of the Gaston County Line) to existing (Old NC 150 east of SR 1177).



The foregoing Highway Traffic Ordinances are hereby adopted in accordance with the General Statutes of North Carolina (G.S. 136-18 (5); 143B-350 (f), 143B-350 (g) and 19ANCAC 4A.0004). The Highway Traffic Ordinances herein adopted are identified as follows:

ORDINANCE TYPE	ADOPT	REPEAL	AMEND	EFFECTIVE DATE
Route Changes	3	6	0	January 23, 2008

The Division Engineer for each affected Division shall cause to be erected appropriate signs indicating the action of the State Traffic Engineer, and these ordinances shall be in full force and effect from and after the erection of such signs.

*[Handwritten Signature]*  
 State Traffic Engineer

1/23/08  
 Date

## NC Route Change

Division 12

Catawba County

1. **Delete the following routing of NC 16 and add the remaining segment as NC 16 Business:**  
NC 16, from SR 2105 northward to NC 16 South.
2. **Delete the following routing of NC 16 North and add the remaining segment as NC 16 Business North:**  
NC 16 North from NC 10/ NC 16 northward to NC 16/ NC 16 South.
3. **Delete the following routing of NC 16 South and add the remaining segment as NC 16 Business South:**  
NC 16 South from NC 10/16 northward to NC 16/NC 16 North
4. **Delete the following routing of NC 16 and add the remaining segment as NC 16 Business:**  
NC 16 from the NC 16 North/ South split northward to NC 16 (New) (R-2404B)
5. **Add the following routing of NC 16:**  
Project U-2404A from existing (old NC 16) northward to just south of SR 1739 (Begin U-2404B).
6. **Add the following routing of NC 16:**  
Project U-2404B from just south of SR 1739 northward to NC 16 (old).
7. **Delete the following routes:**  
SR 2642 from south of SR 1739 to US 70  
SR 2437 from US 70 to NC 16 (old)



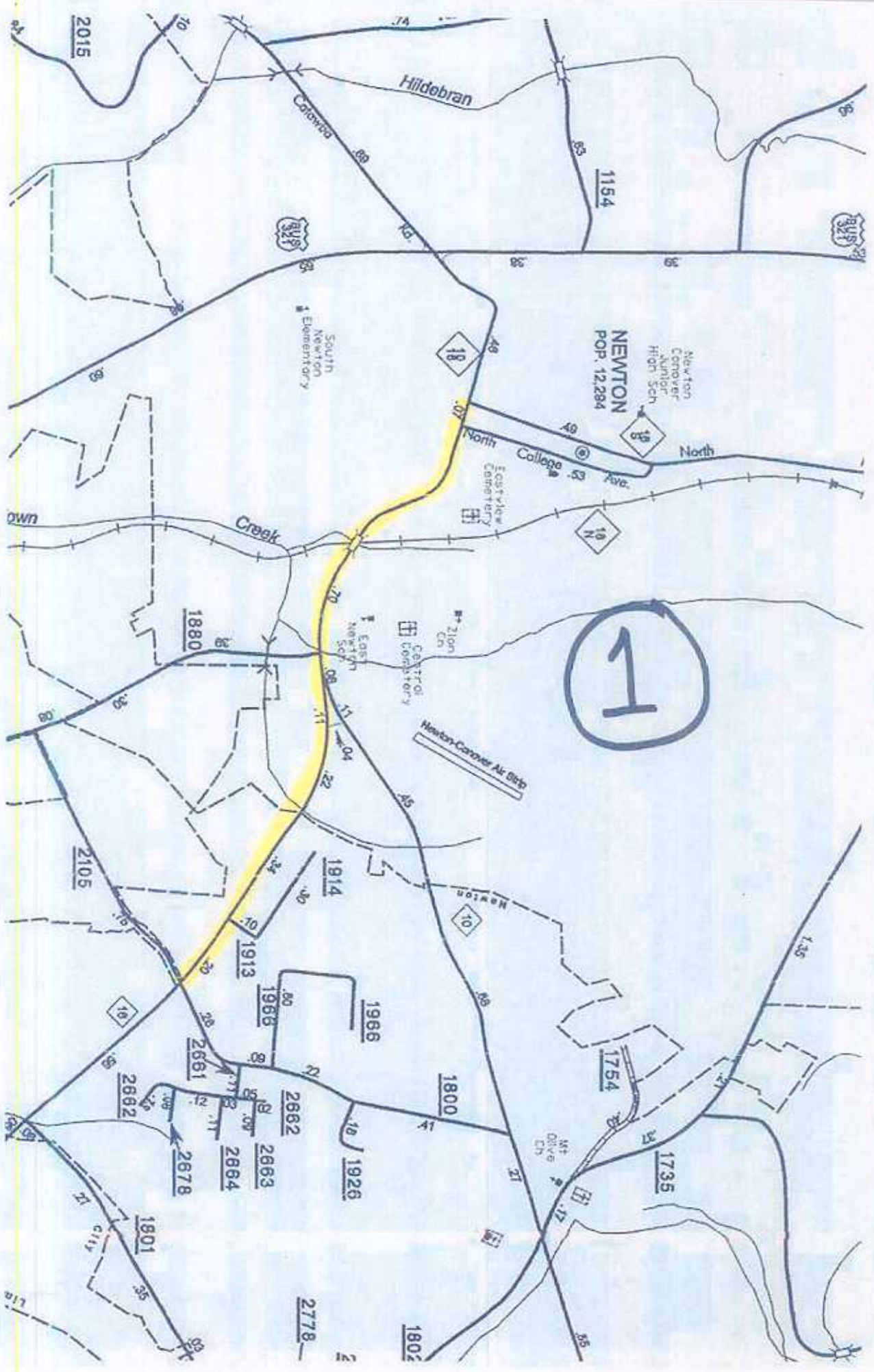



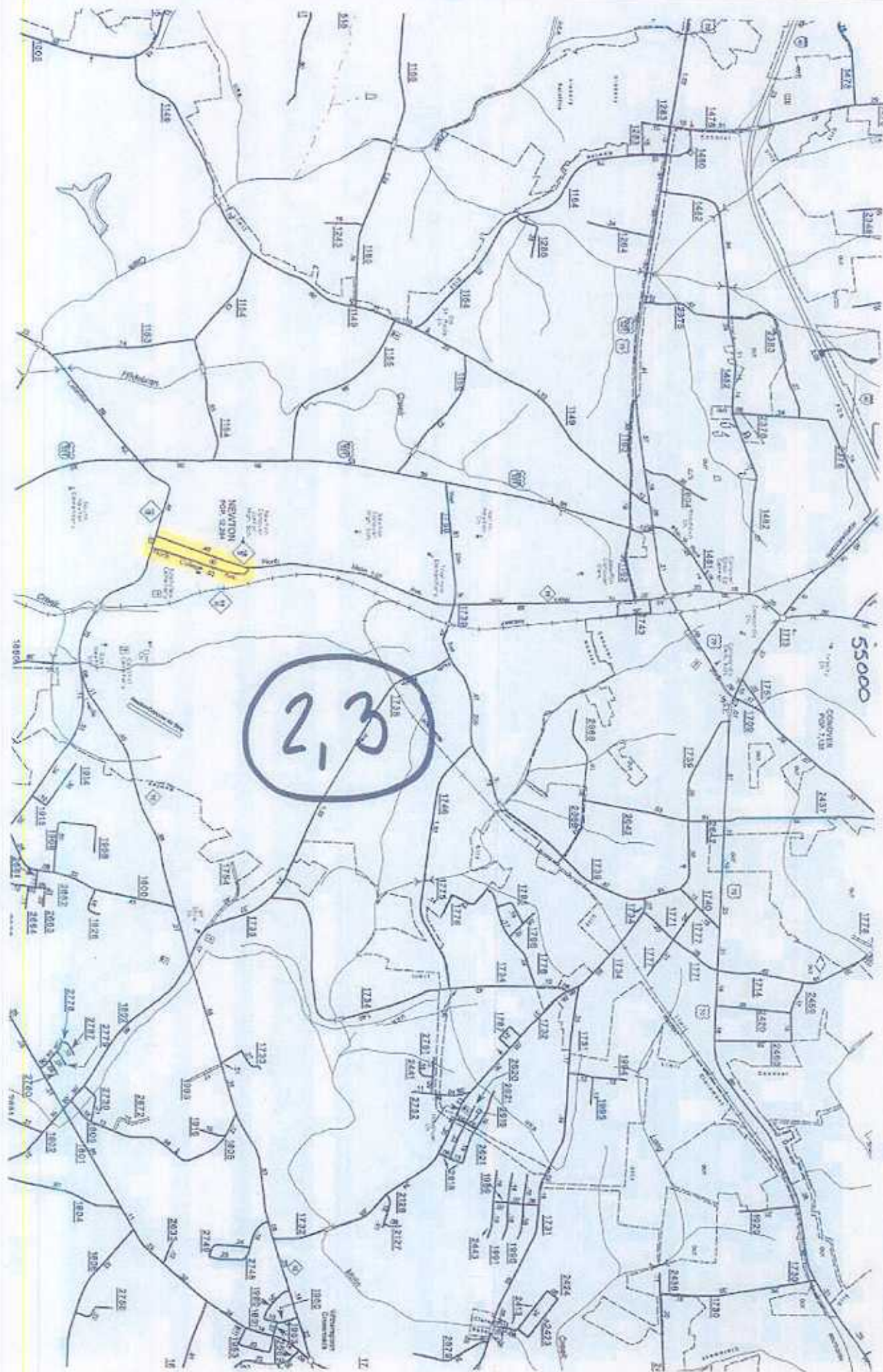



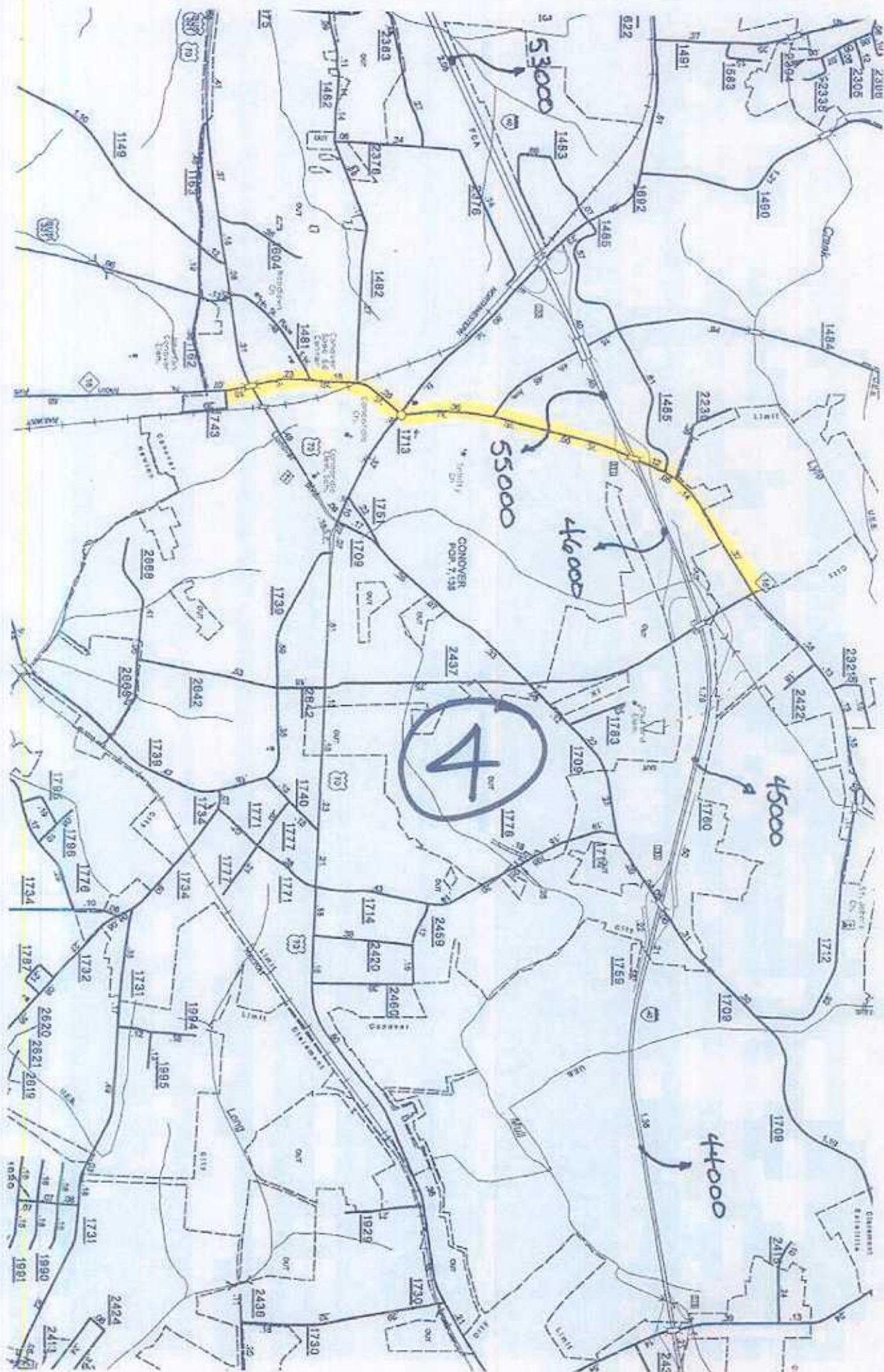



**U-2404A**

See Sheet 1-A For Index of Sheets  
See Sheet 1-B For Conventional Symbols

5

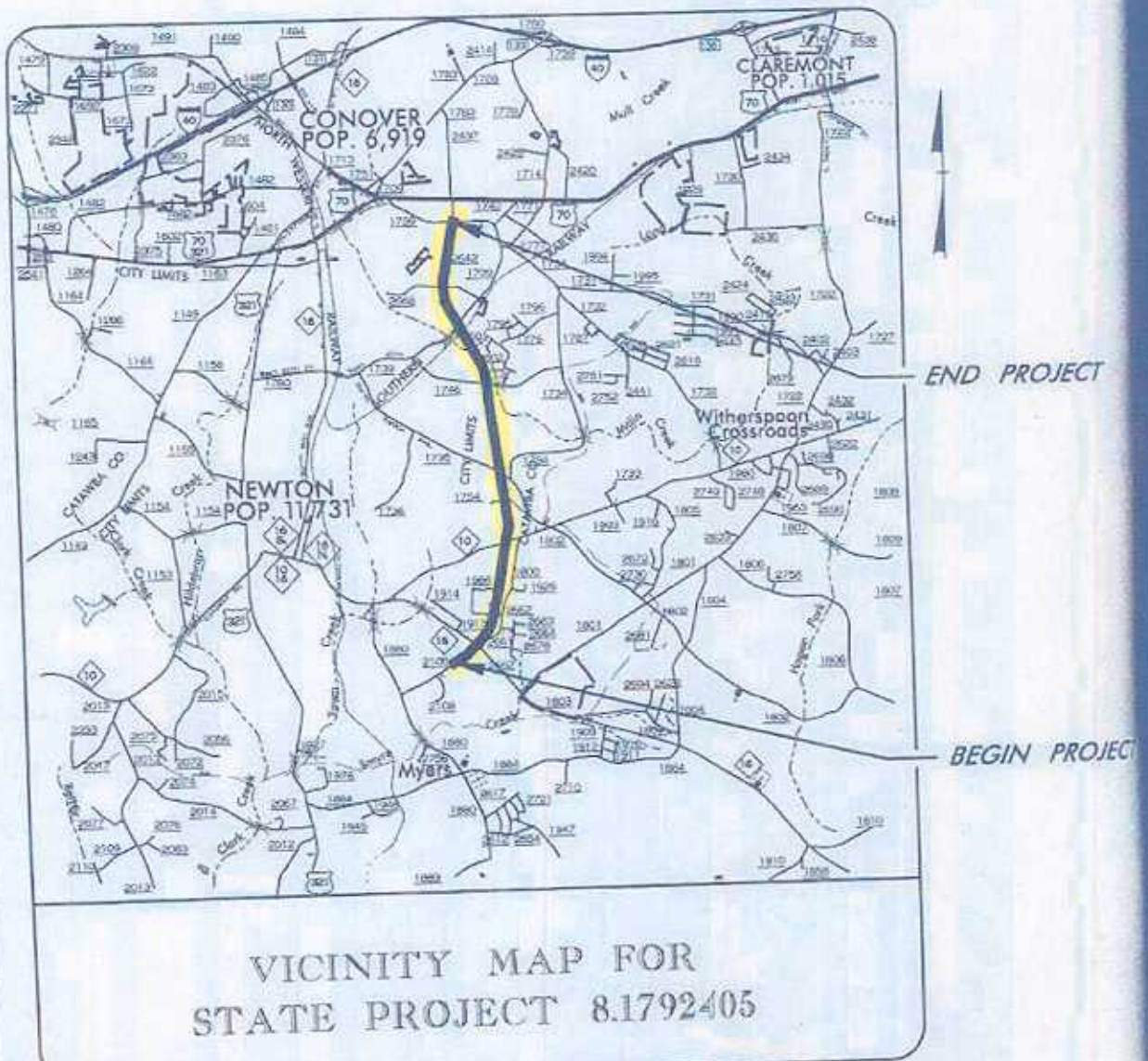



U-2404B

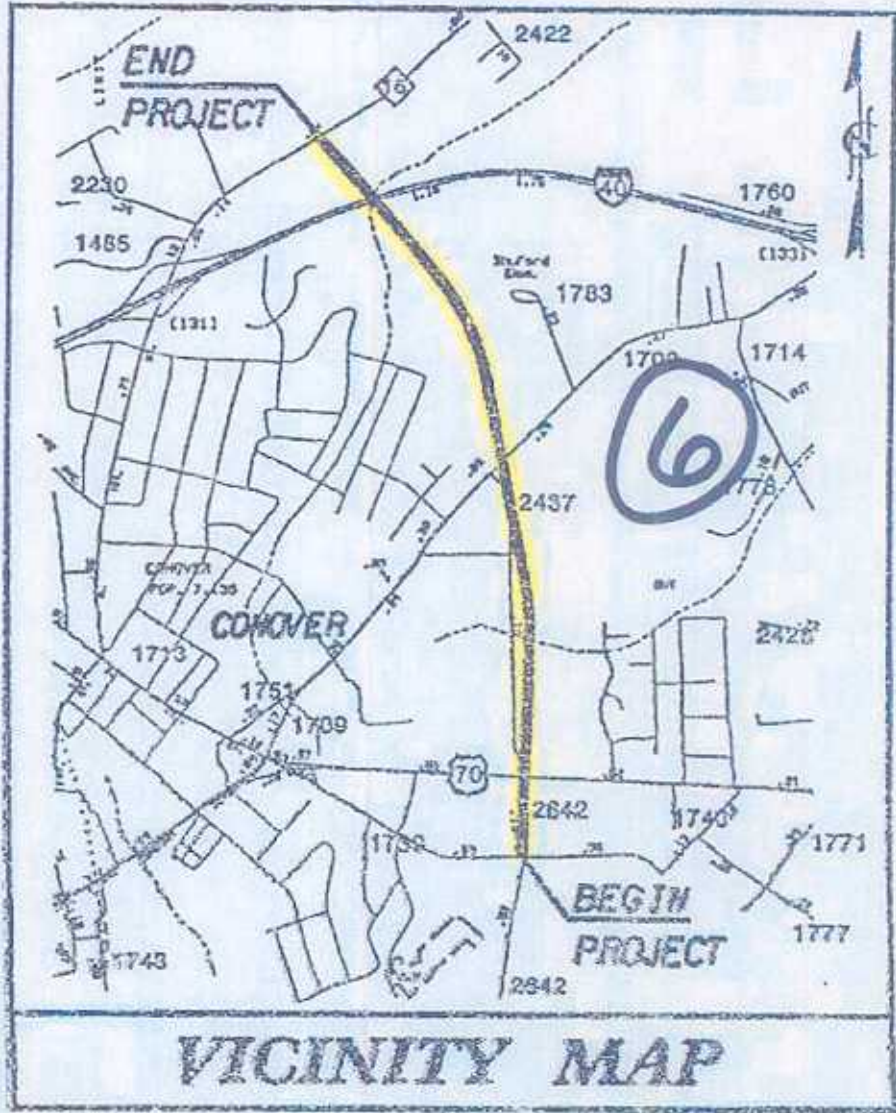

-L- DKT STA 9+00

BEGIN STATE PROJECT 837  
BEGIN F.A. PROJECT STP-1500

12-1251

01



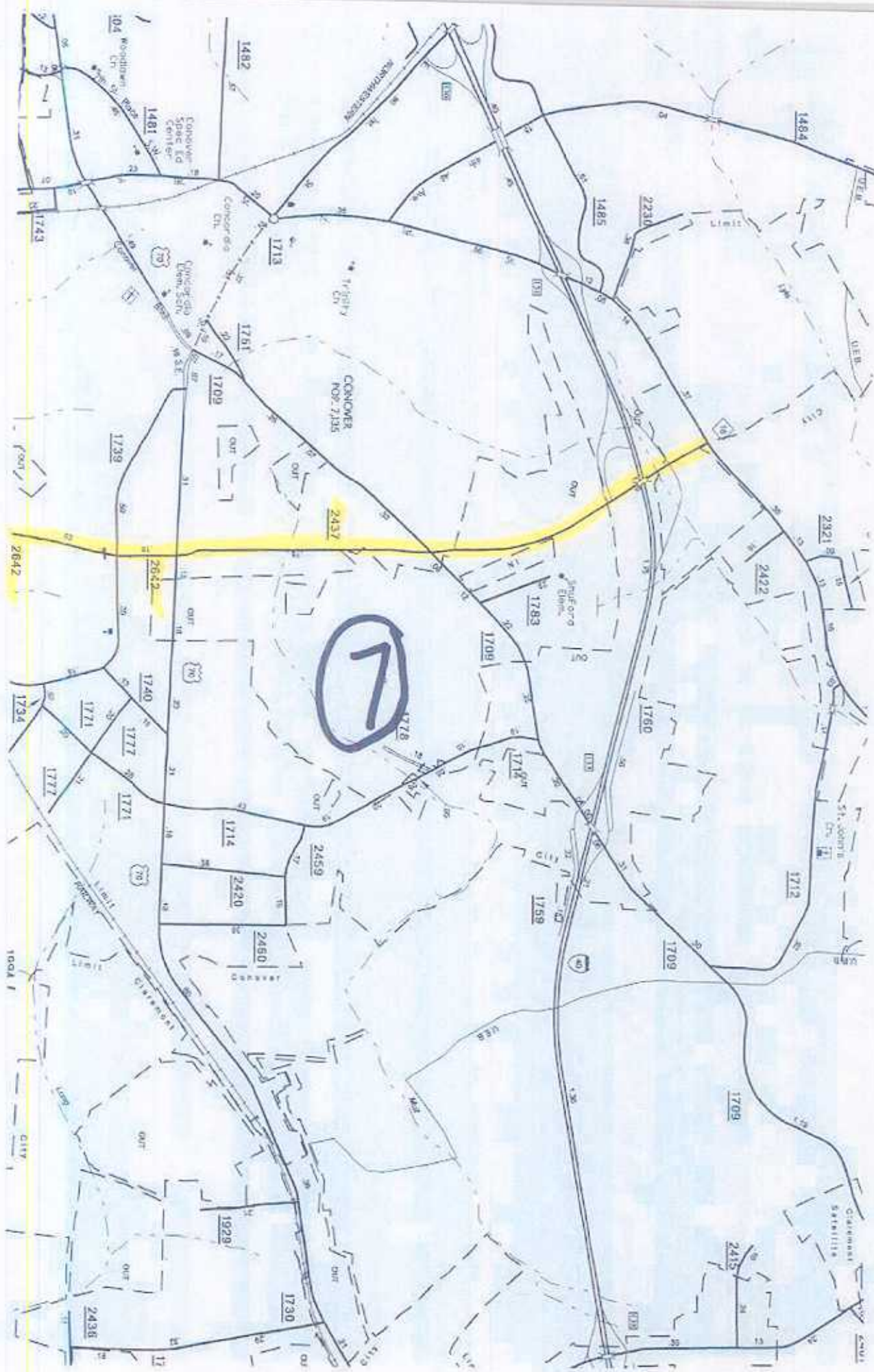

## NC Route Change

Division 12

Lincoln County

**Delete the following routing of NC 150 and add the remaining segment as a Secondary Route**

NC 150, from NC 150 (Project R-0617 BA, just east of the Gaston Co. Line) to NC 150 (Project R-0617BA, east of SR 1177).

**Add the following routing of NC 150:**

Project R-0617BA from existing (old NC 150 just east of Gaston Co. Line) to existing (old NC 150, east of SR 1177).

Submitted by: J. A. Hamrick, Regional Traffic Engineer  
January 2, 2008



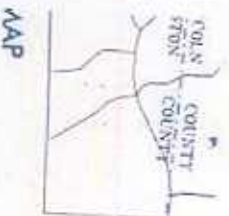

**LOCATION: NC 150 FROM GASTON COUNTY LINE TO WEST OF INDIAN CREEK**

**TYPE OF WORK: GRADING, DRAINAGE, SIGNALS AND PAVING**

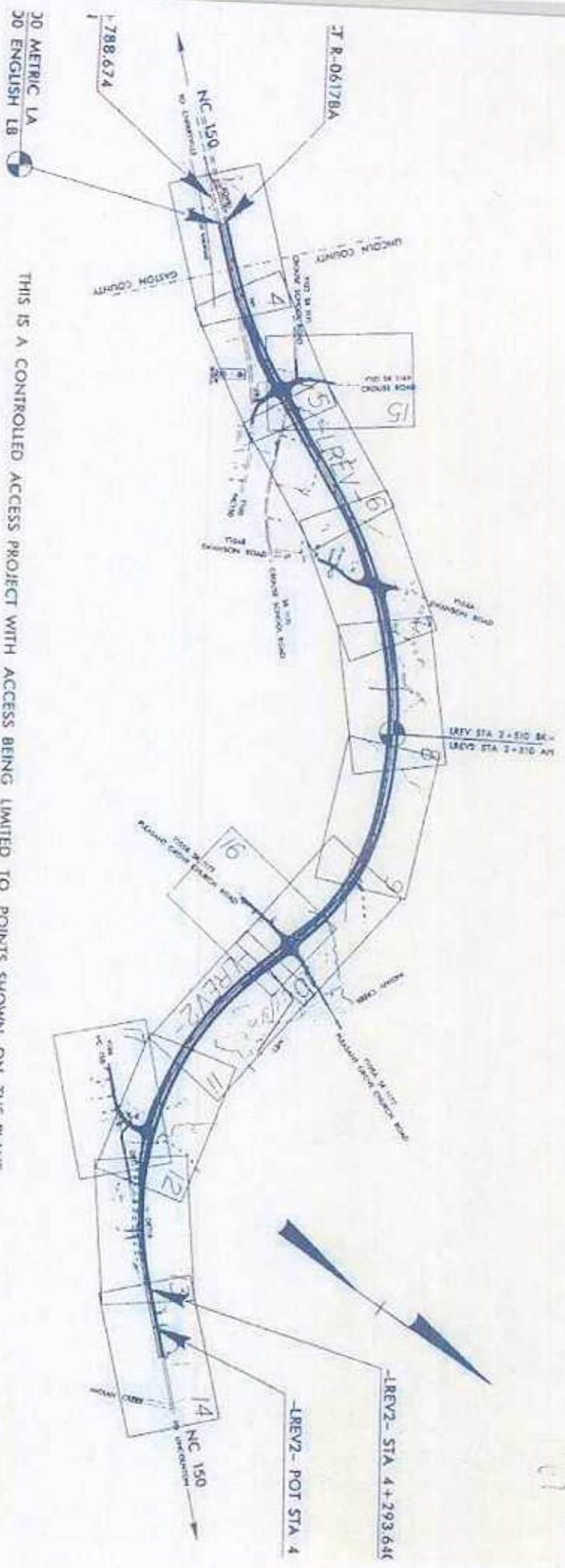

THIS IS A CONTROLLED ACCESS PROJECT WITH ACCESS BEING LIMITED TO POINTS SHOWN ON THE PLANS.

**DESIGN DATA**

T 2002 = 14600  
 T 2022 = 26600  
 DHV = 10 %  
 D = 60 %  
 T = 15 %  
 V = 100 km/h  
 T = 4%  
 DUAL = 11%

**PROJECT LENGTH**

LENGTH ROADWAY TIP PROJECT R-06178A = 3.294 KM  
 TOTAL LENGTH OF TIP PROJECT R-06178A = 3.294 KM

**DIVISION OF HIGHWAYS**

Present in the Office of:  
 TONY HOUSER, P.E.  
 PROJECT ENGINEER  
 RIGHT OF WAY DATE:  
 APRIL 21, 1997  
 LETTING DATE:  
 NOVEMBER 18, 2003

**HYDRAULICS ENGINEER**

Signature: [Handwritten Signature]  
 PROJECT ENGINEER  
 B. B. PAYNE, P.E.  
 PROJECT DESIGN ENGINEER



See Sheet 1-A For Index of Shee  
See Sheet 1-B For Conventional Sy.

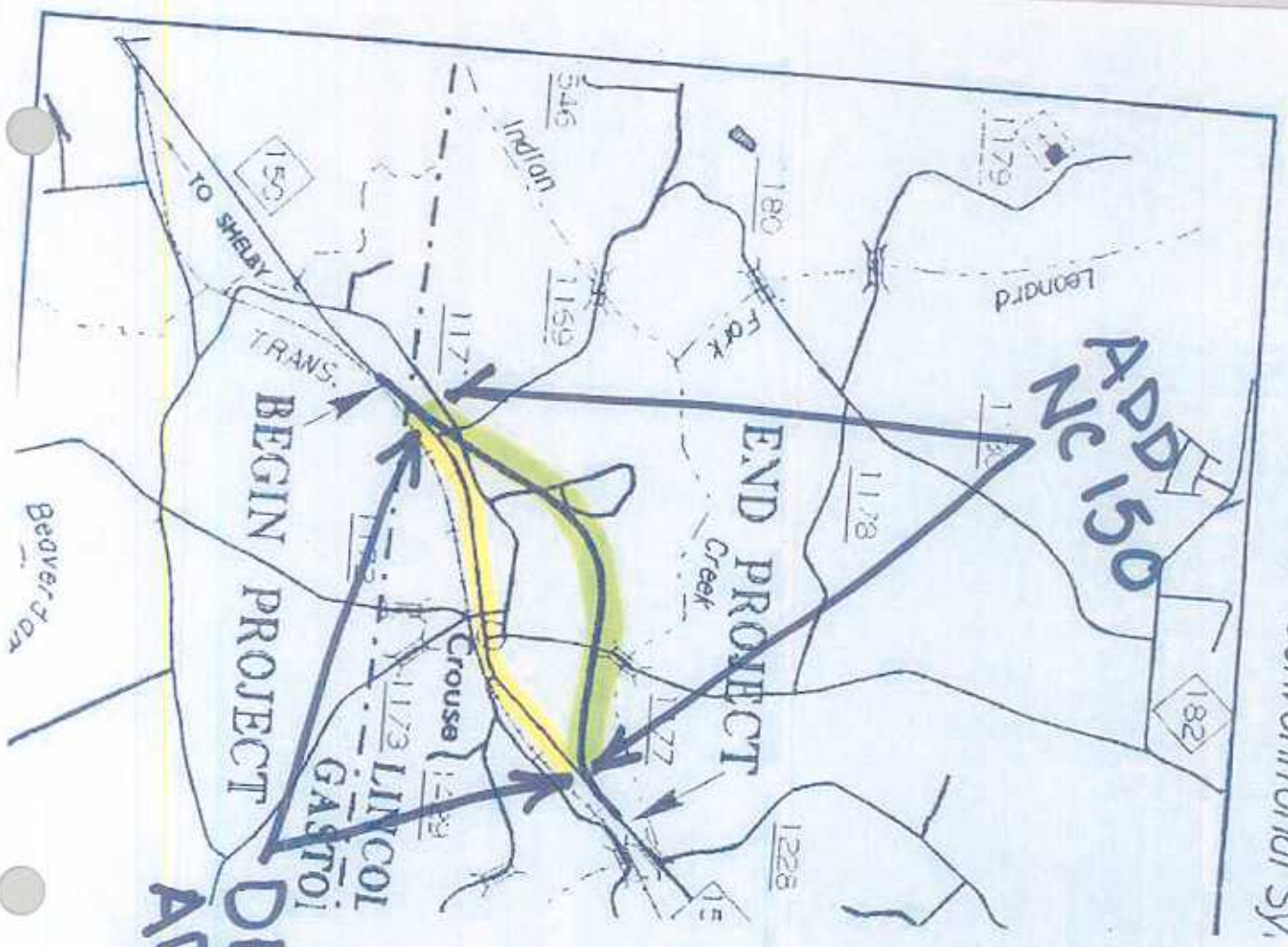

DELETE NC 150  
ADD AS SR



**CONTRACT: C200598 TIP PROJECT: R-0617BA**

See Sheet 1-A For Index of Sheets  
See Sheet 1-B For Conventional Symbols

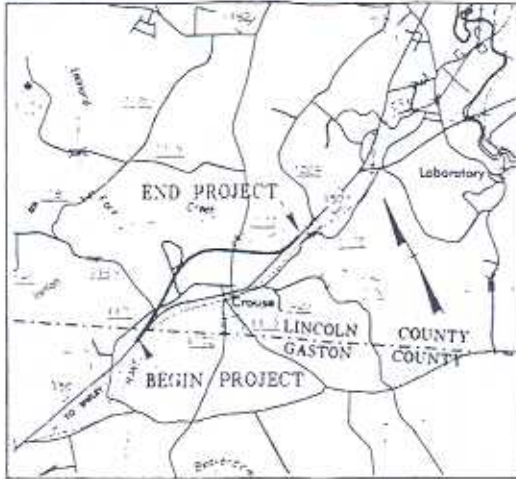

VICINITY MAP

STATE OF NORTH CAROLINA  
 DIVISION OF TRANSPORTATION  
 PLAN AND SPECIFICATIONS FOR  
 PROPOSED STATE HIGHWAY  
**LINCOLN COUNTY**

LOCATION: NC 150 FROM  
 TO WEST

TYPE OF WORK: GRADE

LREV STA 1+000 BEG TIP PROJECT R-0617BA

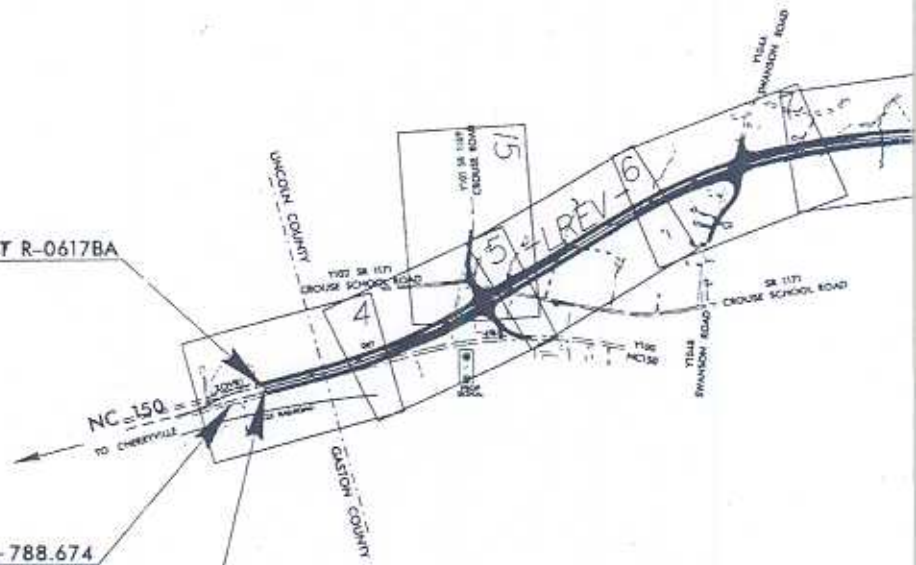

R-0617BA LREV STA 0+788.674  
 BEGIN CONSTRUCTION

R-0617BA LREV STA 1+000 METRIC LA  
 R-0617A LREV STA 180+00 ENGLISH LB

THIS IS A CONTROLLED ACCESS PROJECT WITH ACCESS

**GRAPHIC RATIO**

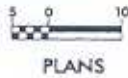

PLANS



PROFILE (HORIZONTAL)



PROFILE (VERTICAL)

**DESIGN DATA**

ADT 2002 = 14600  
 ADT 2022 = 26600

DHV = 10 %  
 D = 60 %  
 \*T = 15 %  
 V = 100 km/h

\* TTST = 4%      DUAL = 11%

**PROJECT LENGTH**

LENGTH ROADWAY TIP PROJECT R-0617BA = 3.294 KM  
 TOTAL LENGTH OF TIP PROJECT R-0617BA = 3.294 KM

# NORTH CAROLINA DIVISION OF HIGHWAYS

## PROFILE FOR STATE HIGHWAY

# COUNTY

FROM GASTON COUNTY LINE  
TO INDIAN CREEK

BRIDGING, DRAINAGE, SIGNALS AND PAVING



ALL DIMENSIONS IN THESE  
PLANS ARE IN METERS AND  
/OR MILLIMETERS UNLESS  
OTHERWISE NOTED

STATE	STATE PROJECT NUMBER
N.C.	R-0617BA
STATE PROJECT NO.	P.A. NO.
34350.1.1	STP-150
34350.2.3	STP-150
34350.5.7	STP-150
6.9 MIL	

LREV STA 3+510.00  
LREV STA 3+510.00

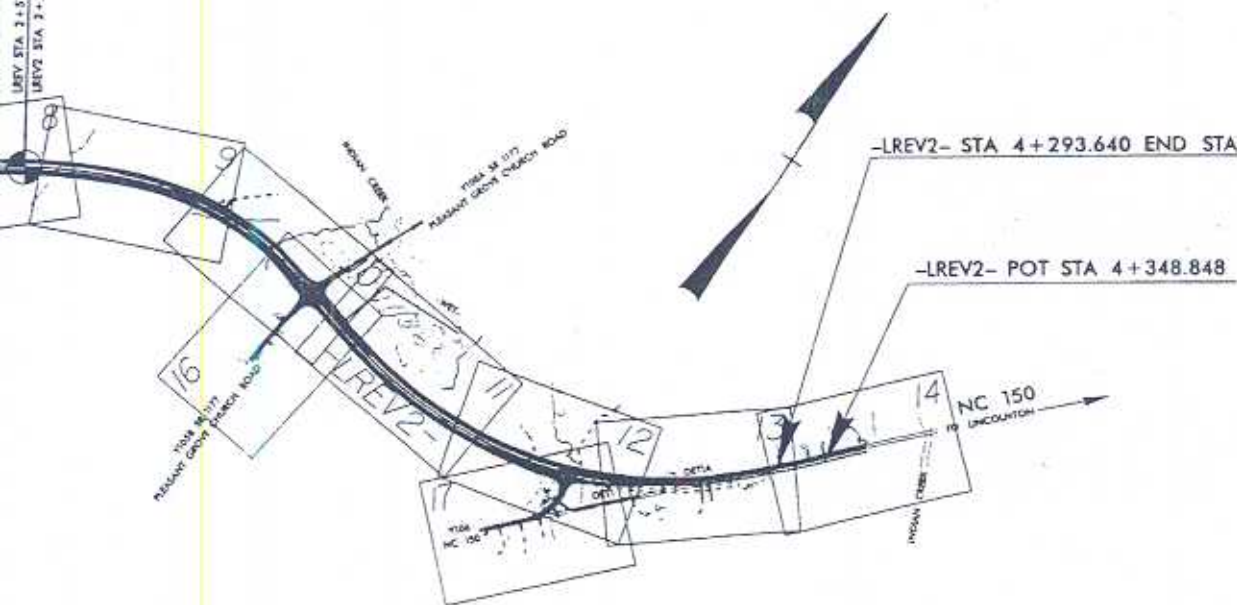

ACCESS BEING LIMITED TO POINTS SHOWN ON THE PLANS

Prepared in the Office of:

### DIVISION OF HIGHWAYS

2002 STANDARD SPECIFICATIONS

RIGHT OF WAY DATE:  
APRIL 21, 1997

LETTING DATE:  
NOVEMBER 18, 2003

TONY HOUSER, P.E.  
PROJECT ENGINEER

B. B. PAYNE, P.E.  
PROJECT DESIGN ENGINEER

HYDRAULICS ENGINEER

DIV.  
STATE

SIGNATURE:

ROADWAY DESIGN



SIGNATURE: *Bruce A. Payne*  
July 13, 2003

*D.M.*

STATE HIGHWAY  
DEPARTMENT  
FEDERAL

APPROVED BY  
DIVISION ADM