

STATE OF NORTH CAROLINA  
DIVISION OF HIGHWAYS

**MECKLENBURG COUNTY**

LOCATION: I-485 (CHARLOTTE OUTER LOOP) FROM  
EAST OF I-77 TO WEST I-85  
TYPE OF WORK: GRADING, DRAINAGE, PAVING, STRUCTURES, CULVERTS,  
NOISE WALLS, RETAINING WALLS, SIGNING AND SIGNALS

**SECTION 1**

STATE	STATE PROJECT REFERENCE NO.	SHEET NO.	TOTAL SHEETS
N.C.	R-2248E	I	
STATE PROJ. NO.	F.A. PROJ. NO.	DESCRIPTION	
34410.3.GV2	NHF-0485(27)	CONST.	



RELEASE FOR  
CONSTRUCTION  
DATE: 7/7/11

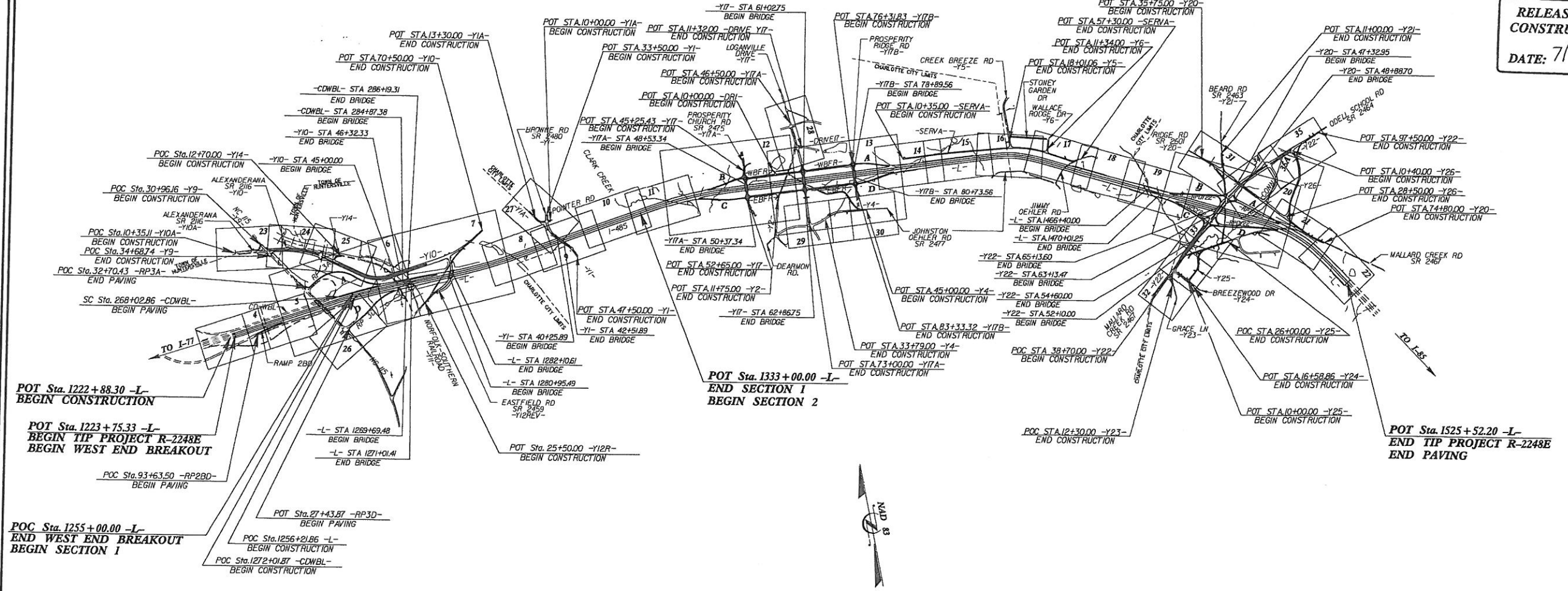
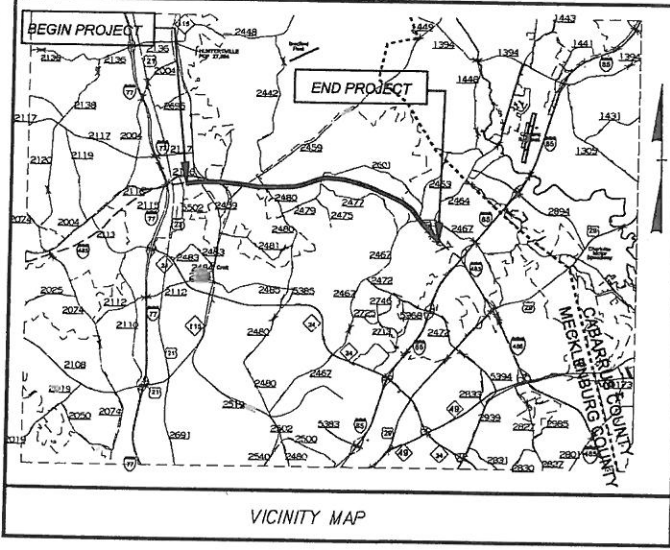

TIP PROJECT: R-2248E

CONTRACT: C202521

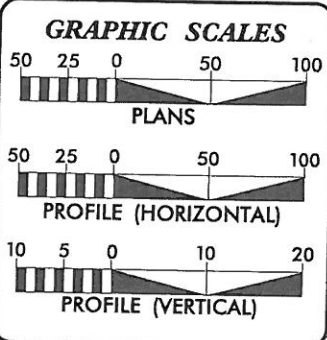

**DESIGN DATA**

ADT 2006 = 62,000  
ADT 2035 = 161,600  
DHV = 10 %  
D = 55 %  
T = 15 % \*  
V = 70 m/h  
\* TTST 10% DUAL 5%

FUNCTIONAL CLASSIFICATION  
FREEWAY

**PROJECT LENGTH**

LENGTH ROADWAY TIP PROJECT R-2248E = 5.594 miles  
LENGTH STRUCTURES TIP PROJECT R-2248E = 0.121 miles  
TOTAL LENGTH OF TIP PROJECT R-2248E = 5.715 miles

Prepared In the Office of:  
**WILBUR SMITH ASSOCIATES**  
421 Fayetteville Street, Suite 1303, Raleigh, NC 27601 Phone (919) 755-0583  
2006 STANDARD SPECIFICATIONS

RIGHT OF WAY DATE:  
JULY, 2011

LETTING DATE:  
JULY, 2011

DAVID L. WILVER, P.E.  
PROJECT ENGINEER

TODD H. BUCKNER, P.E.  
PROJECT DESIGN ENGINEER

**HYDRAULICS ENGINEER**

**ROADWAY DESIGN ENGINEER**

7/7/11

**DIVISION OF HIGHWAYS  
STATE OF NORTH CAROLINA**

STATE HIGHWAY DESIGN ENGINEER

THIS IS A CONTROLLED ACCESS PROJECT WITH ACCESS BEING LIMITED TO INTERCHANGES.

FILE: R:\indon\02248E\Roadway\Proj\2248e\_mf\_mh\_01.dgn  
DATE: 2/2/11 3:21:08 PM