

➡ DIRECTION OF TRAFFIC FLOW

NOTE:

ROUTE SIGN ASSEMBLIES MAY BE COMBINED WITH SMALL GUIDE SIGN ON "U" POST(S) WHEN SPACING CONSTRAINTS EXIST.

REFER TO 'AT GRADE CROSSING OF DIVIDED FACILITY SIGNING' LOCATED ON THE SIGNING UNIT'S WEB PAGE UNDER TYPICAL LAYOUT FOR ADDITIONAL SIGNING REQUIREMENTS FOR INTERSECTION.

TYPICAL DIAMOND INTERCHANGE LAYOUT
 FOR MULTI-LANE CROSSROAD SIGNING

ENGLISH DETAIL DRAWING FOR

NOTE:

ROUTE SIGN ASSEMBLIES MAY BE COMBINED WITH SMALL GUIDE SIGN ON "U" POST(S) WHEN SPACING CONSTRAINTS EXIST.

REFER TO 'AT GRADE CROSSING OF DIVIDED FACILITY SIGNING' LOCATED ON THE SIGNING UNIT'S WEB PAGE UNDER TYPICAL LAYOUT FOR ADDITIONAL SIGNING REQUIREMENTS FOR INTERSECTION.

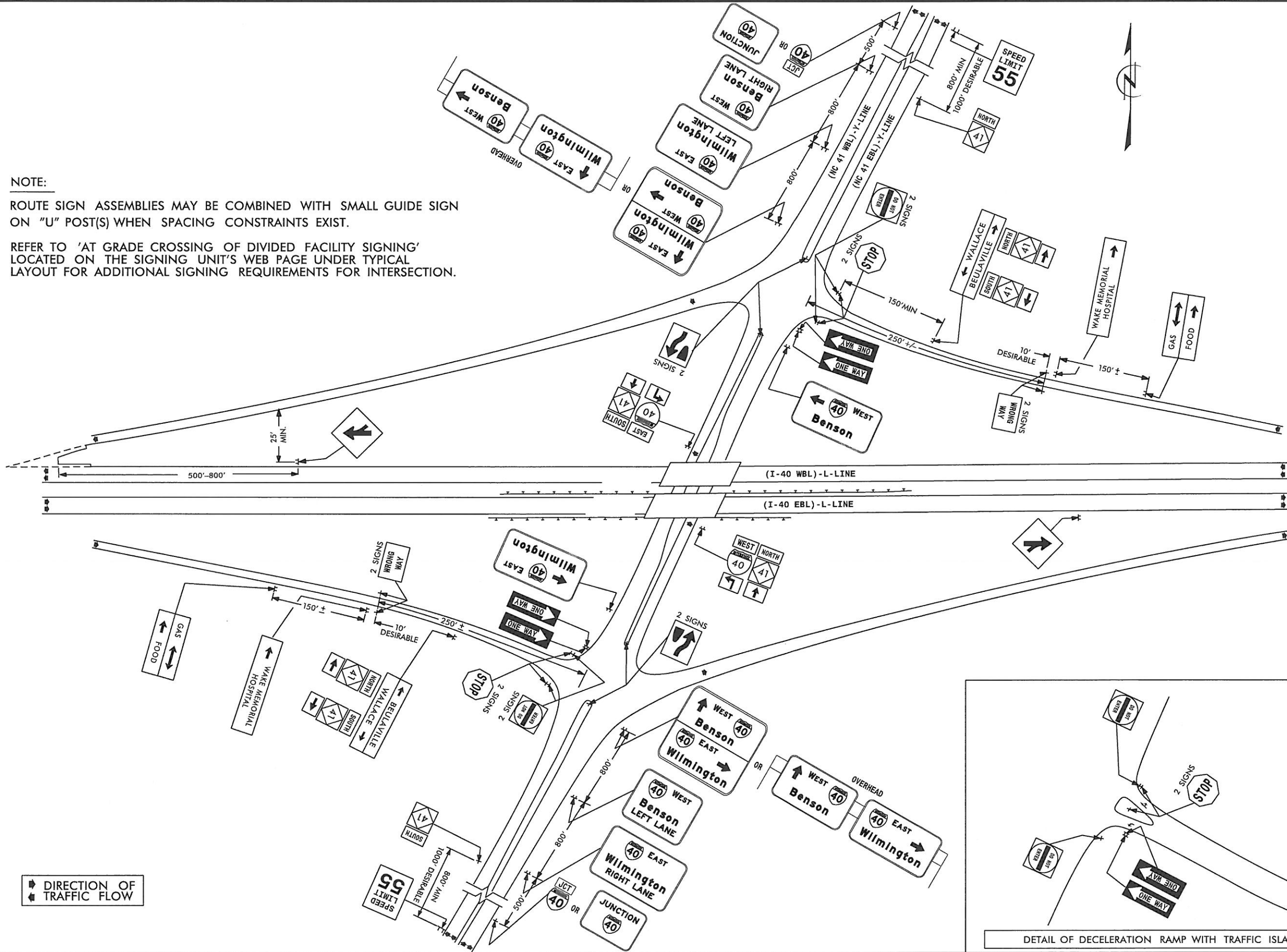

DIRECTION OF TRAFFIC FLOW

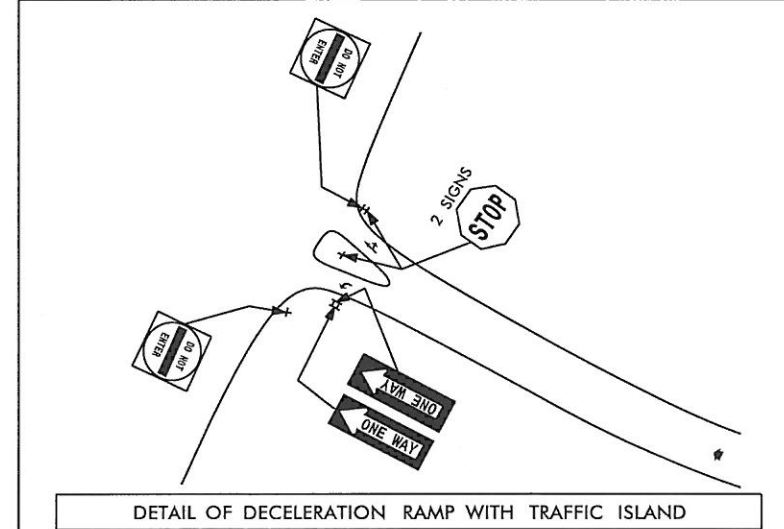

DETAIL OF DECELERATION RAMP WITH TRAFFIC ISLAND

ENGLISH DETAIL DRAWING FOR

TYPICAL DIAMOND INTERCHANGE LAYOUT
 FOR MULTI-LANE CROSSROAD SIGNING