

# QUALITY COUNTS LLC

920 Blairhill Rd Ste 106, Charlotte, NC 28217  
704.215.4616

Crossing Number: 629446Y

Count Number: 15-10208

County: New Hanover

City: Wilmington

Division: 3

Location: US 421 Third St

Location Type: Railroad crossing

Count Start Date: 1/12/2016

Count Time: 48 Hours

Count Type: Volume/Speed/Class Count

## Comments:

1. **Data Collector:** Mark Shields
2. **Data Processor:** Noah Smith
3. **Land Use:** Residential
4. **Data Collection/Tabulation:** Jamar Apollyon  
counters/TraxPro software
5. **Equipment Operating Properly:** Yes
6. **Crossing Control:** Lights, Gates, Crossbucks
7. **Weather:** Sunny      **Temp (Max, Min):** 56, 26  
**Avg Sky Cover:** 0.0      **Precip:** 0.00
8. **Avg Volume:** 16959  
**Unique Class conditions:** None

N↑

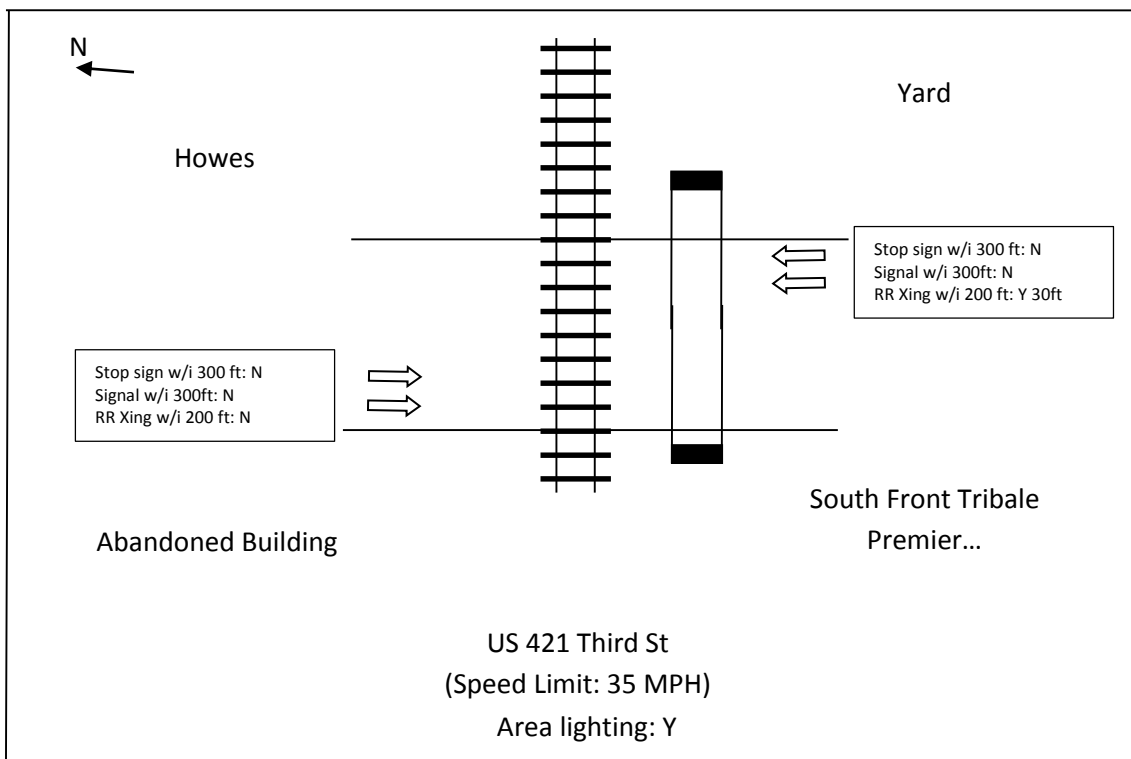
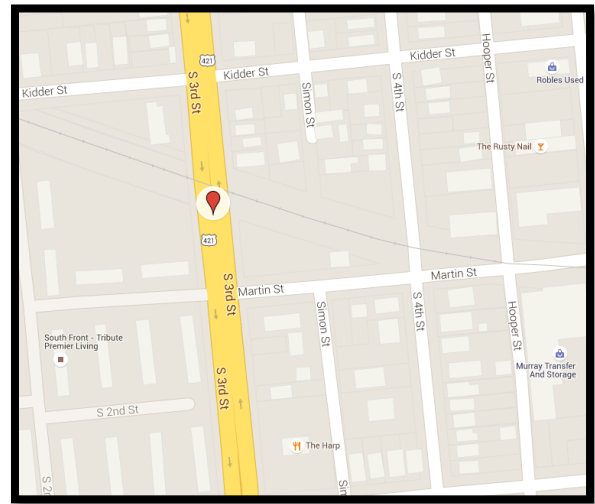

15-10208 ; Crossing 629 446Y



Facing North Toward Location



Facing South Toward Location

15-10208 ; Crossing 629 446Y



### Speed Data - 48 Hours (hour increments)

Division: 03  
County: NEW HANOVER  
City: IN WILMINGTON  
On Road: US 421 THIRD ST  
Milepost: N/A

Speed Limit: 35  
Advisory Speed: N/A

Contractor: Quality Counts, LLC  
Count Number: 15-10208  
Location: US 421 THIRD ST  
RR Crossing No: 629446Y

Start Date: 1/26/16  
Start Time (24-hour clock): 12:00

### SUMMARY

	<u><b>NB</b></u>	<u><b>SB</b></u>	<u><b>All Lanes</b></u>
Median Speed:	<u>36</u>	<u>38</u>	<u>37</u>
Mean Speed:	<u>35</u>	<u>39</u>	<u>37</u>
Pace Speed:	<u>31-40</u>	<u>36-45</u>	<u>36-45</u>
High Speed:	<u>66</u>	<u>75</u>	<u>75</u>
Low Speed:	<u>5</u>	<u>8</u>	<u>5</u>
85th Percentile Speed:	<u>41</u>	<u>44</u>	<u>43</u>
% Vehicles above Speed Limit:	<u>57.3%</u>	<u>76.8%</u>	<u>66.4%</u>

### Speed Data - 48 Hours (hour increments)

Division: 03  
 County: NEW HANOVER  
 City: IN WILMINGTON  
 On Road: US 421 THIRD ST  
 Milepost: N/A

Speed Limit: 35  
 Advisory Speed: N/A

Contractor: Quality Counts, LLC  
 Count Number: 15-10208  
 Location: US 421 THIRD ST  
 RR Crossing No: 629446Y

Start Date: 1/26/16  
 Start Time (24-hour clock): 12:00

Date	Start Time	NB															Total
		0-9.99	10-14.99	15-19.99	20-24.99	25-29.99	30-34.99	35-39.99	40-44.99	45-49.99	50-54.99	55-59.99	60-64.99	65-69.99	70-74.99	75+	
1/26/16	12:00	9	9	34	55	129	217	148	30	3	0	0	0	0	0	0	634
1/26/16	13:00	13	7	24	22	87	269	147	28	2	3	0	0	0	0	0	602
1/26/16	14:00	15	5	20	47	197	238	126	18	1	0	1	0	0	0	0	668
1/26/16	15:00	6	8	14	55	183	262	188	35	4	1	0	1	0	0	0	757
1/26/16	16:00	20	2	13	19	51	165	298	147	23	3	3	0	0	0	0	744
1/26/16	17:00	33	0	3	13	35	180	347	165	26	0	0	0	0	0	0	802
1/26/16	18:00	9	0	1	3	22	110	205	99	14	1	0	0	1	0	0	465
1/26/16	19:00	3	0	0	2	10	37	117	84	17	3	0	0	0	0	0	273
1/26/16	20:00	7	1	4	1	8	41	92	45	12	0	0	0	0	0	0	211
1/26/16	21:00	1	0	1	3	8	21	86	39	5	0	0	0	0	0	0	164
1/26/16	22:00	0	0	0	4	5	26	62	35	7	1	0	0	0	0	0	140
1/26/16	23:00	0	0	0	2	6	19	34	26	3	0	0	0	0	0	0	90
1/27/16	0:00	0	0	0	1	0	10	15	12	4	0	0	0	0	0	0	42
1/27/16	1:00	1	0	1	1	1	1	11	10	2	1	0	0	0	0	0	29
1/27/16	2:00	0	0	0	1	2	4	10	9	2	0	0	0	0	0	0	28
1/27/16	3:00	0	0	0	0	2	2	6	9	5	0	0	0	0	0	0	24
1/27/16	4:00	0	0	0	2	1	1	10	10	3	1	0	0	0	0	0	28
1/27/16	5:00	4	0	0	0	5	15	38	49	15	4	0	0	0	0	0	130
1/27/16	6:00	38	0	0	4	8	28	112	125	39	7	1	0	0	0	0	362
1/27/16	7:00	26	1	2	13	27	81	304	251	68	5	0	0	0	0	0	778
1/27/16	8:00	34	6	6	10	91	182	291	170	27	4	1	1	0	0	0	823
1/27/16	9:00	15	3	8	19	61	169	220	70	6	3	1	0	0	0	0	575
1/27/16	10:00	10	3	4	14	67	160	166	55	8	0	0	0	0	0	0	487
1/27/16	11:00	15	1	7	25	108	184	186	51	7	2	0	0	0	0	0	586
1/27/16	12:00	11	1	2	38	73	200	187	40	5	0	0	0	0	0	0	557
1/27/16	13:00	12	4	19	20	104	176	181	63	6	0	0	0	0	0	0	585
1/27/16	14:00	16	2	6	33	109	192	193	56	14	0	1	0	0	0	0	622

### Speed Data - 48 Hours (hour increments)

Division: 03  
 County: NEW HANOVER  
 City: IN WILMINGTON  
 On Road: US 421 THIRD ST  
 Milepost: N/A

Speed Limit: 35  
 Advisory Speed: N/A

Contractor: Quality Counts, LLC  
 Count Number: 15-10208  
 Location: US 421 THIRD ST  
 RR Crossing No: 629446Y

Start Date: 1/26/16  
 Start Time (24-hour clock): 12:00

1/27/16	15:00	17	2	9	21	121	244	210	59	6	1	0	0	0	0	0	690
1/27/16	16:00	26	2	4	9	48	190	286	131	21	3	0	0	0	0	0	720
1/27/16	17:00	17	0	0	3	35	194	365	159	23	0	0	0	0	0	0	796
1/27/16	18:00	5	0	1	2	21	92	220	104	23	0	0	0	0	0	0	468
1/27/16	19:00	6	2	0	0	17	46	136	79	15	1	0	0	0	0	0	302
1/27/16	20:00	1	0	0	1	12	42	120	54	8	1	0	0	0	0	0	239
1/27/16	21:00	2	0	1	1	5	35	80	39	9	1	0	0	0	0	0	173
1/27/16	22:00	7	0	3	7	2	16	41	27	4	1	0	0	0	0	0	108
1/27/16	23:00	0	0	0	0	4	13	45	28	2	0	0	0	0	0	0	92
1/28/16	0:00	3	0	1	0	3	8	20	8	3	0	0	0	0	0	0	46
1/28/16	1:00	0	0	0	2	2	5	13	7	0	0	0	0	0	0	0	29
1/28/16	2:00	0	0	0	0	2	3	12	7	1	0	0	0	0	0	0	25
1/28/16	3:00	0	0	0	1	1	2	5	9	0	0	0	0	0	0	0	18
1/28/16	4:00	0	0	0	0	3	4	10	15	2	0	0	0	0	0	0	34
1/28/16	5:00	3	0	0	0	6	8	46	42	10	1	0	0	0	0	0	116
1/28/16	6:00	33	1	2	6	7	36	122	114	37	4	1	0	0	0	0	363
1/28/16	7:00	34	0	2	9	19	98	351	224	46	1	0	0	0	0	0	784
1/28/16	8:00	38	7	11	20	50	157	331	192	22	3	0	0	0	0	0	831
1/28/16	9:00	19	5	13	12	45	136	249	100	11	0	0	0	0	0	0	590
1/28/16	10:00	17	9	16	40	52	155	200	83	10	0	1	0	0	0	0	583
1/28/16	11:00	5	0	2	21	83	175	165	59	8	1	0	0	0	0	0	519

<b>Total</b>	<b>531</b>	<b>81</b>	<b>234</b>	<b>562</b>	<b>1,938</b>	<b>4,649</b>	<b>6,807</b>	<b>3,271</b>	<b>589</b>	<b>57</b>	<b>10</b>	<b>2</b>	<b>1</b>	<b>0</b>	<b>0</b>	<b>0</b>	<b>18,732</b>
<b>Percent</b>	<b>3%</b>	<b>0%</b>	<b>1%</b>	<b>3%</b>	<b>10%</b>	<b>25%</b>	<b>36%</b>	<b>17%</b>	<b>3%</b>	<b>0%</b>	<b>0%</b>	<b>0%</b>	<b>0%</b>	<b>0%</b>	<b>0%</b>	<b>0%</b>	

<b>Day 1</b>	<b>259</b>	<b>46</b>	<b>142</b>	<b>316</b>	<b>1,114</b>	<b>2,422</b>	<b>3,219</b>	<b>1,572</b>	<b>303</b>	<b>39</b>	<b>7</b>	<b>2</b>	<b>1</b>	<b>0</b>	<b>0</b>	<b>0</b>	<b>9,442</b>
<b>Percent</b>	<b>3%</b>	<b>0%</b>	<b>2%</b>	<b>3%</b>	<b>12%</b>	<b>26%</b>	<b>34%</b>	<b>17%</b>	<b>3%</b>	<b>0%</b>	<b>0%</b>	<b>0%</b>	<b>0%</b>	<b>0%</b>	<b>0%</b>	<b>0%</b>	

<b>Day 2</b>	<b>272</b>	<b>35</b>	<b>92</b>	<b>246</b>	<b>824</b>	<b>2,227</b>	<b>3,588</b>	<b>1,699</b>	<b>286</b>	<b>18</b>	<b>3</b>	<b>0</b>	<b>0</b>	<b>0</b>	<b>0</b>	<b>0</b>	<b>9,290</b>
<b>Percent</b>	<b>3%</b>	<b>0%</b>	<b>1%</b>	<b>3%</b>	<b>9%</b>	<b>24%</b>	<b>39%</b>	<b>18%</b>	<b>3%</b>	<b>0%</b>	<b>0%</b>	<b>0%</b>	<b>0%</b>	<b>0%</b>	<b>0%</b>	<b>0%</b>	

### Speed Data - 48 Hours (hour increments)

Division: 03  
 County: NEW HANOVER  
 City: IN WILMINGTON  
 On Road: US 421 THIRD ST  
 Milepost: N/A

Speed Limit: 35  
 Advisory Speed: N/A

Contractor: Quality Counts, LLC  
 Count Number: 15-10208  
 Location: US 421 THIRD ST  
 RR Crossing No: 629446Y

Start Date: 1/26/16  
 Start Time (24-hour clock): 12:00

<b>Average</b>	<b>266</b>	<b>41</b>	<b>117</b>	<b>281</b>	<b>969</b>	<b>2,325</b>	<b>3,404</b>	<b>1,636</b>	<b>295</b>	<b>29</b>	<b>5</b>	<b>1</b>	<b>1</b>	<b>0</b>	<b>0</b>	<b>9,366</b>
<b>Percent</b>	<b>3%</b>	<b>0%</b>	<b>1%</b>	<b>3%</b>	<b>10%</b>	<b>25%</b>	<b>36%</b>	<b>17%</b>	<b>3%</b>	<b>0%</b>	<b>0%</b>	<b>0%</b>	<b>0%</b>	<b>0%</b>	<b>0%</b>	



### Speed Data - 48 Hours (hour increments)

Division: 03  
 County: NEW HANOVER  
 City: IN WILMINGTON  
 On Road: US 421 THIRD ST  
 Milepost: N/A

Speed Limit: 35  
 Advisory Speed: N/A

Contractor: Quality Counts, LLC  
 Count Number: 15-10208  
 Location: US 421 THIRD ST  
 RR Crossing No: 629446Y

Start Date: 1/26/16  
 Start Time (24-hour clock): 12:00

Date	Start Time	SB															Total
		0-9.99	10-14.99	15-19.99	20-24.99	25-29.99	30-34.99	35-39.99	40-44.99	45-49.99	50-54.99	55-59.99	60-64.99	65-69.99	70-74.99	75+	
1/26/16	12:00	13	0	2	8	23	114	238	172	35	9	0	0	0	1	0	615
1/26/16	13:00	11	4	17	6	21	91	170	155	41	8	0	0	0	0	0	524
1/26/16	14:00	11	0	1	2	21	89	228	166	36	12	1	0	0	0	0	567
1/26/16	15:00	26	0	4	11	20	69	203	171	50	8	2	0	0	0	0	564
1/26/16	16:00	18	0	1	8	17	92	210	200	87	8	2	0	0	0	0	643
1/26/16	17:00	15	0	0	4	27	82	251	250	38	2	0	0	0	0	0	669
1/26/16	18:00	6	0	0	5	17	60	152	143	30	3	1	0	0	0	0	417
1/26/16	19:00	5	0	0	1	13	49	121	103	22	4	0	0	0	0	0	318
1/26/16	20:00	3	0	0	5	10	27	104	70	18	2	1	0	0	0	0	240
1/26/16	21:00	0	0	0	0	6	38	86	90	21	2	0	0	0	0	0	243
1/26/16	22:00	1	0	0	1	4	8	45	53	12	4	0	0	0	0	0	128
1/26/16	23:00	0	0	0	0	2	11	30	29	13	3	0	0	0	0	0	88
1/27/16	0:00	0	0	0	0	1	4	22	25	4	0	0	0	0	0	0	56
1/27/16	1:00	0	0	0	0	2	8	15	9	4	1	0	0	1	0	0	40
1/27/16	2:00	0	0	0	0	0	2	7	6	6	2	0	0	0	0	0	23
1/27/16	3:00	0	0	0	1	1	3	9	3	1	0	0	0	0	0	0	18
1/27/16	4:00	1	0	0	0	2	2	3	7	5	1	0	0	0	0	0	21
1/27/16	5:00	0	0	1	0	2	5	29	32	13	3	1	0	0	0	0	86
1/27/16	6:00	10	0	0	2	4	12	71	102	35	12	3	0	0	0	0	251
1/27/16	7:00	5	0	0	9	10	32	98	155	67	11	4	0	0	0	0	391
1/27/16	8:00	8	0	0	13	16	61	134	123	48	5	1	1	0	0	0	410
1/27/16	9:00	6	0	0	6	23	93	163	87	22	1	0	0	0	1	0	402
1/27/16	10:00	11	0	2	12	28	91	157	91	18	5	0	0	0	0	0	415
1/27/16	11:00	3	0	1	7	29	126	170	116	26	2	0	0	2	1	0	483
1/27/16	12:00	12	0	1	10	41	115	191	117	22	2	1	0	0	0	0	512
1/27/16	13:00	5	0	0	6	40	118	229	139	23	2	1	0	0	0	0	563
1/27/16	14:00	10	0	1	2	24	127	192	163	31	6	0	0	0	0	0	556



### Speed Data - 48 Hours (hour increments)

Division: 03  
 County: NEW HANOVER  
 City: IN WILMINGTON  
 On Road: US 421 THIRD ST  
 Milepost: N/A

Speed Limit: 35  
 Advisory Speed: N/A

Contractor: Quality Counts, LLC  
 Count Number: 15-10208  
 Location: US 421 THIRD ST  
 RR Crossing No: 629446Y

Start Date: 1/26/16  
 Start Time (24-hour clock): 12:00

1/27/16	15:00	11	0	2	11	11	69	182	194	74	10	1	0	0	0	0	565
1/27/16	16:00	13	0	2	7	19	59	200	208	67	14	2	0	0	0	0	591
1/27/16	17:00	11	0	0	12	20	103	258	237	52	6	0	0	0	0	0	699
1/27/16	18:00	10	0	0	4	26	63	166	141	37	7	0	0	0	0	0	454
1/27/16	19:00	4	0	3	4	18	58	117	109	28	3	0	0	0	0	0	344
1/27/16	20:00	3	0	0	1	13	45	88	63	22	5	0	0	0	0	0	240
1/27/16	21:00	2	0	0	1	8	35	97	81	13	0	0	0	0	0	0	237
1/27/16	22:00	4	0	3	9	11	16	38	38	12	1	1	0	1	0	0	134
1/27/16	23:00	0	1	1	0	1	12	27	31	8	4	0	0	0	0	0	85
1/28/16	0:00	1	0	0	0	0	5	24	17	2	0	0	0	0	0	0	49
1/28/16	1:00	0	0	0	0	1	2	15	13	3	1	0	0	0	0	0	35
1/28/16	2:00	0	0	0	0	0	2	20	5	2	2	0	0	0	0	0	31
1/28/16	3:00	0	0	0	0	0	5	8	6	0	1	0	0	0	0	0	20
1/28/16	4:00	0	0	0	0	1	3	8	8	2	1	0	0	0	0	0	23
1/28/16	5:00	0	1	0	0	1	11	24	30	15	3	3	0	0	0	0	88
1/28/16	6:00	1	0	1	2	3	20	67	107	32	11	2	0	0	0	0	246
1/28/16	7:00	12	0	0	7	14	29	143	143	48	14	2	0	0	0	0	412
1/28/16	8:00	4	0	2	12	13	60	119	128	45	10	0	0	0	0	0	393
1/28/16	9:00	1	0	2	5	14	81	170	100	17	3	1	0	0	0	0	394
1/28/16	10:00	7	0	0	8	22	87	203	103	26	6	0	0	0	0	0	462
1/28/16	11:00	9	0	1	2	16	78	154	127	39	11	2	1	0	0	0	440

<b>Total</b>	<b>273</b>	<b>6</b>	<b>48</b>	<b>204</b>	<b>616</b>	<b>2,372</b>	<b>5,456</b>	<b>4,666</b>	<b>1,272</b>	<b>231</b>	<b>32</b>	<b>2</b>	<b>4</b>	<b>3</b>	<b>0</b>	<b>15,185</b>
<b>Percent</b>	<b>2%</b>	<b>0%</b>	<b>0%</b>	<b>1%</b>	<b>4%</b>	<b>16%</b>	<b>36%</b>	<b>31%</b>	<b>8%</b>	<b>2%</b>	<b>0%</b>	<b>0%</b>	<b>0%</b>	<b>0%</b>	<b>0%</b>	

<b>Day 1</b>	<b>153</b>	<b>4</b>	<b>29</b>	<b>101</b>	<b>299</b>	<b>1,169</b>	<b>2,716</b>	<b>2,358</b>	<b>652</b>	<b>108</b>	<b>16</b>	<b>1</b>	<b>3</b>	<b>3</b>	<b>0</b>	<b>7,612</b>
<b>Percent</b>	<b>2%</b>	<b>0%</b>	<b>0%</b>	<b>1%</b>	<b>4%</b>	<b>15%</b>	<b>36%</b>	<b>31%</b>	<b>9%</b>	<b>1%</b>	<b>0%</b>	<b>0%</b>	<b>0%</b>	<b>0%</b>	<b>0%</b>	

<b>Day 2</b>	<b>120</b>	<b>2</b>	<b>19</b>	<b>103</b>	<b>317</b>	<b>1,203</b>	<b>2,740</b>	<b>2,308</b>	<b>620</b>	<b>123</b>	<b>16</b>	<b>1</b>	<b>1</b>	<b>0</b>	<b>0</b>	<b>7,573</b>
<b>Percent</b>	<b>2%</b>	<b>0%</b>	<b>0%</b>	<b>1%</b>	<b>4%</b>	<b>16%</b>	<b>36%</b>	<b>30%</b>	<b>8%</b>	<b>2%</b>	<b>0%</b>	<b>0%</b>	<b>0%</b>	<b>0%</b>	<b>0%</b>	

### Speed Data - 48 Hours (hour increments)

Division: 03  
 County: NEW HANOVER  
 City: IN WILMINGTON  
 On Road: US 421 THIRD ST  
 Milepost: N/A

Speed Limit: 35  
 Advisory Speed: N/A

Contractor: Quality Counts, LLC  
 Count Number: 15-10208  
 Location: US 421 THIRD ST  
 RR Crossing No: 629446Y

Start Date: 1/26/16  
 Start Time (24-hour clock): 12:00

<b>Average</b>	<b>137</b>	<b>3</b>	<b>24</b>	<b>102</b>	<b>308</b>	<b>1,186</b>	<b>2,728</b>	<b>2,333</b>	<b>636</b>	<b>116</b>	<b>16</b>	<b>1</b>	<b>2</b>	<b>2</b>	<b>0</b>	<b>7,593</b>
<b>Percent</b>	<b>2%</b>	<b>0%</b>	<b>0%</b>	<b>1%</b>	<b>4%</b>	<b>16%</b>	<b>36%</b>	<b>31%</b>	<b>8%</b>	<b>2%</b>	<b>0%</b>	<b>0%</b>	<b>0%</b>	<b>0%</b>	<b>0%</b>	

### Speed Data - 48 Hours (hour increments)

Division: 03  
 County: NEW HANOVER  
 City: IN WILMINGTON  
 On Road: US 421 THIRD ST  
 Milepost: N/A

Speed Limit: 35  
 Advisory Speed: N/A

Contractor: Quality Counts, LLC  
 Count Number: 15-10208  
 Location: US 421 THIRD ST  
 RR Crossing No: 629446Y

Start Date: 1/26/16  
 Start Time (24-hour clock): 12:00

Date	Start Time	Total															Total
		0-9.99	10-14.99	15-19.99	20-24.99	25-29.99	30-34.99	35-39.99	40-44.99	45-49.99	50-54.99	55-59.99	60-64.99	65-69.99	70-74.99	75+	
1/26/16	12:00	22	9	36	63	152	331	386	202	38	9	0	0	0	1	0	1,249
1/26/16	13:00	24	11	41	28	108	360	317	183	43	11	0	0	0	0	0	1,126
1/26/16	14:00	26	5	21	49	218	327	354	184	37	12	2	0	0	0	0	1,235
1/26/16	15:00	32	8	18	66	203	331	391	206	54	9	2	1	0	0	0	1,321
1/26/16	16:00	38	2	14	27	68	257	508	347	110	11	5	0	0	0	0	1,387
1/26/16	17:00	48	0	3	17	62	262	598	415	64	2	0	0	0	0	0	1,471
1/26/16	18:00	15	0	1	8	39	170	357	242	44	4	1	0	1	0	0	882
1/26/16	19:00	8	0	0	3	23	86	238	187	39	7	0	0	0	0	0	591
1/26/16	20:00	10	1	4	6	18	68	196	115	30	2	1	0	0	0	0	451
1/26/16	21:00	1	0	1	3	14	59	172	129	26	2	0	0	0	0	0	407
1/26/16	22:00	1	0	0	5	9	34	107	88	19	5	0	0	0	0	0	268
1/26/16	23:00	0	0	0	2	8	30	64	55	16	3	0	0	0	0	0	178
1/27/16	0:00	0	0	0	1	1	14	37	37	8	0	0	0	0	0	0	98
1/27/16	1:00	1	0	1	1	3	9	26	19	6	2	0	0	1	0	0	69
1/27/16	2:00	0	0	0	1	2	6	17	15	8	2	0	0	0	0	0	51
1/27/16	3:00	0	0	0	1	3	5	15	12	6	0	0	0	0	0	0	42
1/27/16	4:00	1	0	0	2	3	3	13	17	8	2	0	0	0	0	0	49
1/27/16	5:00	4	0	1	0	7	20	67	81	28	7	1	0	0	0	0	216
1/27/16	6:00	48	0	0	6	12	40	183	227	74	19	4	0	0	0	0	613
1/27/16	7:00	31	1	2	22	37	113	402	406	135	16	4	0	0	0	0	1,169
1/27/16	8:00	42	6	6	23	107	243	425	293	75	9	2	2	0	0	0	1,233
1/27/16	9:00	21	3	8	25	84	262	383	157	28	4	1	0	0	1	0	977
1/27/16	10:00	21	3	6	26	95	251	323	146	26	5	0	0	0	0	0	902
1/27/16	11:00	18	1	8	32	137	310	356	167	33	4	0	0	2	1	0	1,069
1/27/16	12:00	23	1	3	48	114	315	378	157	27	2	1	0	0	0	0	1,069
1/27/16	13:00	17	4	19	26	144	294	410	202	29	2	1	0	0	0	0	1,148
1/27/16	14:00	26	2	7	35	133	319	385	219	45	6	1	0	0	0	0	1,178

### Speed Data - 48 Hours (hour increments)

Division: 03  
 County: NEW HANOVER  
 City: IN WILMINGTON  
 On Road: US 421 THIRD ST  
 Milepost: N/A

Speed Limit: 35  
 Advisory Speed: N/A

Contractor: Quality Counts, LLC  
 Count Number: 15-10208  
 Location: US 421 THIRD ST  
 RR Crossing No: 629446Y

Start Date: 1/26/16  
 Start Time (24-hour clock): 12:00

1/27/16	15:00	28	2	11	32	132	313	392	253	80	11	1	0	0	0	0	1,255
1/27/16	16:00	39	2	6	16	67	249	486	339	88	17	2	0	0	0	0	1,311
1/27/16	17:00	28	0	0	15	55	297	623	396	75	6	0	0	0	0	0	1,495
1/27/16	18:00	15	0	1	6	47	155	386	245	60	7	0	0	0	0	0	922
1/27/16	19:00	10	2	3	4	35	104	253	188	43	4	0	0	0	0	0	646
1/27/16	20:00	4	0	0	2	25	87	208	117	30	6	0	0	0	0	0	479
1/27/16	21:00	4	0	1	2	13	70	177	120	22	1	0	0	0	0	0	410
1/27/16	22:00	11	0	6	16	13	32	79	65	16	2	1	0	1	0	0	242
1/27/16	23:00	0	1	1	0	5	25	72	59	10	4	0	0	0	0	0	177
1/28/16	0:00	4	0	1	0	3	13	44	25	5	0	0	0	0	0	0	95
1/28/16	1:00	0	0	0	2	3	7	28	20	3	1	0	0	0	0	0	64
1/28/16	2:00	0	0	0	0	2	5	32	12	3	2	0	0	0	0	0	56
1/28/16	3:00	0	0	0	1	1	7	13	15	0	1	0	0	0	0	0	38
1/28/16	4:00	0	0	0	0	4	7	18	23	4	1	0	0	0	0	0	57
1/28/16	5:00	3	1	0	0	7	19	70	72	25	4	3	0	0	0	0	204
1/28/16	6:00	34	1	3	8	10	56	189	221	69	15	3	0	0	0	0	609
1/28/16	7:00	46	0	2	16	33	127	494	367	94	15	2	0	0	0	0	1,196
1/28/16	8:00	42	7	13	32	63	217	450	320	67	13	0	0	0	0	0	1,224
1/28/16	9:00	20	5	15	17	59	217	419	200	28	3	1	0	0	0	0	984
1/28/16	10:00	24	9	16	48	74	242	403	186	36	6	1	0	0	0	0	1,045
1/28/16	11:00	14	0	3	23	99	253	319	186	47	12	2	1	0	0	0	959

<b>Total</b>	<b>804</b>	<b>87</b>	<b>282</b>	<b>766</b>	<b>2,554</b>	<b>7,021</b>	<b>12,263</b>	<b>7,937</b>	<b>1,861</b>	<b>288</b>	<b>42</b>	<b>4</b>	<b>5</b>	<b>3</b>	<b>0</b>	<b>33,917</b>
<b>Percent</b>	<b>2%</b>	<b>0%</b>	<b>1%</b>	<b>2%</b>	<b>8%</b>	<b>21%</b>	<b>36%</b>	<b>23%</b>	<b>5%</b>	<b>1%</b>	<b>0%</b>	<b>0%</b>	<b>0%</b>	<b>0%</b>	<b>0%</b>	

<b>Day 1</b>	<b>412</b>	<b>50</b>	<b>171</b>	<b>417</b>	<b>1,413</b>	<b>3,591</b>	<b>5,935</b>	<b>3,930</b>	<b>955</b>	<b>147</b>	<b>23</b>	<b>3</b>	<b>4</b>	<b>3</b>	<b>0</b>	<b>17,054</b>
<b>Percent</b>	<b>2%</b>	<b>0%</b>	<b>1%</b>	<b>2%</b>	<b>8%</b>	<b>21%</b>	<b>35%</b>	<b>23%</b>	<b>6%</b>	<b>1%</b>	<b>0%</b>	<b>0%</b>	<b>0%</b>	<b>0%</b>	<b>0%</b>	

<b>Day 2</b>	<b>392</b>	<b>37</b>	<b>111</b>	<b>349</b>	<b>1,141</b>	<b>3,430</b>	<b>6,328</b>	<b>4,007</b>	<b>906</b>	<b>141</b>	<b>19</b>	<b>1</b>	<b>1</b>	<b>0</b>	<b>0</b>	<b>16,863</b>
<b>Percent</b>	<b>2%</b>	<b>0%</b>	<b>1%</b>	<b>2%</b>	<b>7%</b>	<b>20%</b>	<b>38%</b>	<b>24%</b>	<b>5%</b>	<b>1%</b>	<b>0%</b>	<b>0%</b>	<b>0%</b>	<b>0%</b>	<b>0%</b>	

### Speed Data - 48 Hours (hour increments)

Division: 03  
 County: NEW HANOVER  
 City: IN WILMINGTON  
 On Road: US 421 THIRD ST  
 Milepost: N/A

Speed Limit: 35  
 Advisory Speed: N/A

Contractor: Quality Counts, LLC  
 Count Number: 15-10208  
 Location: US 421 THIRD ST  
 RR Crossing No: 629446Y

Start Date: 1/26/16  
 Start Time (24-hour clock): 12:00

<b>Average</b>	<b>402</b>	<b>44</b>	<b>141</b>	<b>383</b>	<b>1,277</b>	<b>3,511</b>	<b>6,132</b>	<b>3,969</b>	<b>931</b>	<b>144</b>	<b>21</b>	<b>2</b>	<b>3</b>	<b>2</b>	<b>0</b>	<b>16,959</b>
<b>Percent</b>	<b>2%</b>	<b>0%</b>	<b>1%</b>	<b>2%</b>	<b>8%</b>	<b>21%</b>	<b>36%</b>	<b>23%</b>	<b>5%</b>	<b>1%</b>	<b>0%</b>	<b>0%</b>	<b>0%</b>	<b>0%</b>	<b>0%</b>	

# Volume/Class Data - 48 Hours (hour increments)

Division: 03  
 County: NEW HANOVER  
 City: IN WILMINGTON  
 On Road: US 421 THIRD ST  
 Milepost: N/A

Contractor: Quality Counts, LLC  
 Count Number: 15-10208  
 Location: US 421 THIRD ST  
 RR Crossing No: 629446Y

Speed Limit: 35  
 Advisory Speed: N/A

Start Date: 1/26/16  
 Start Time (24-hour clock): 12:00

Date	Start Time	NB														
		1	2	3	4	5	6	7	8	9	10	11	12	13	Und.	Total
1/26/16	12:00	7	477	102	1	29	1	0	5	1	0	0	0	0	11	634
1/26/16	13:00	9	423	132	0	17	2	0	6	1	0	1	0	0	11	602
1/26/16	14:00	3	485	132	0	26	2	0	6	0	0	0	0	0	14	668
1/26/16	15:00	4	565	152	1	22	2	0	3	2	0	0	0	0	6	757
1/26/16	16:00	4	557	119	1	29	1	0	7	3	2	0	0	0	21	744
1/26/16	17:00	4	593	117	0	28	4	0	14	0	5	0	0	0	37	802
1/26/16	18:00	0	350	78	1	13	1	0	8	0	0	2	0	0	12	465
1/26/16	19:00	1	214	43	0	9	0	0	2	1	0	0	0	0	3	273
1/26/16	20:00	0	160	35	0	7	0	0	1	0	0	0	0	0	8	211
1/26/16	21:00	0	135	24	0	3	1	0	0	0	0	0	0	0	1	164
1/26/16	22:00	0	112	23	0	5	0	0	0	0	0	0	0	0	0	140
1/26/16	23:00	2	75	13	0	0	0	0	0	0	0	0	0	0	0	90
1/27/16	0:00	0	30	7	0	4	1	0	0	0	0	0	0	0	0	42
1/27/16	1:00	0	18	7	0	2	1	0	0	0	0	0	0	0	1	29
1/27/16	2:00	0	22	5	1	0	0	0	0	0	0	0	0	0	0	28
1/27/16	3:00	0	19	5	0	0	0	0	0	0	0	0	0	0	0	24
1/27/16	4:00	1	19	7	0	0	1	0	0	0	0	0	0	0	0	28
1/27/16	5:00	0	86	33	1	6	0	0	0	0	0	0	0	0	4	130
1/27/16	6:00	3	224	75	0	16	1	0	5	0	0	0	0	0	38	362
1/27/16	7:00	1	564	138	1	22	3	0	17	0	2	0	0	1	29	778
1/27/16	8:00	6	616	116	2	25	1	1	15	2	1	3	0	0	35	823
1/27/16	9:00	2	427	106	0	16	1	0	7	0	0	0	0	0	16	575
1/27/16	10:00	3	337	102	3	19	1	0	8	4	1	0	0	0	9	487
1/27/16	11:00	3	424	104	5	29	1	0	4	2	0	0	0	0	14	586
1/27/16	12:00	1	403	113	2	16	3	1	5	1	1	0	0	0	11	557
1/27/16	13:00	5	422	120	0	19	0	2	5	0	1	0	0	0	11	585

# Volume/Class Data - 48 Hours (hour increments)

Division: 03  
 County: NEW HANOVER  
 City: IN WILMINGTON  
 On Road: US 421 THIRD ST  
 Milepost: N/A

Contractor: Quality Counts, LLC  
 Count Number: 15-10208  
 Location: US 421 THIRD ST  
 RR Crossing No: 629446Y

Speed Limit: 35  
 Advisory Speed: N/A

Start Date: 1/26/16  
 Start Time (24-hour clock): 12:00

Date	Start Time	NB														
		1	2	3	4	5	6	7	8	9	10	11	12	13	Und.	Total
1/27/16	14:00	4	456	111	1	19	2	1	9	3	0	0	0	0	16	622
1/27/16	15:00	2	527	117	1	20	2	0	4	1	0	0	0	0	16	690
1/27/16	16:00	1	531	125	0	18	4	0	9	2	1	1	0	0	28	720
1/27/16	17:00	3	614	98	1	34	4	0	15	2	1	1	0	1	22	796
1/27/16	18:00	2	366	75	0	13	0	0	6	0	0	0	0	0	6	468
1/27/16	19:00	1	238	46	0	7	0	0	2	1	0	0	0	0	7	302
1/27/16	20:00	2	201	29	0	4	0	0	1	0	0	0	0	0	2	239
1/27/16	21:00	1	143	23	0	2	0	0	1	0	0	0	0	0	3	173
1/27/16	22:00	3	84	11	0	3	0	0	0	1	0	0	0	0	6	108
1/27/16	23:00	0	74	15	0	0	0	0	2	1	0	0	0	0	0	92
1/28/16	0:00	2	38	3	0	1	0	0	0	0	0	0	0	0	2	46
1/28/16	1:00	1	26	1	0	0	1	0	0	0	0	0	0	0	0	29
1/28/16	2:00	1	21	3	0	0	0	0	0	0	0	0	0	0	0	25
1/28/16	3:00	0	13	3	1	1	0	0	0	0	0	0	0	0	0	18
1/28/16	4:00	2	22	10	0	0	0	0	0	0	0	0	0	0	0	34
1/28/16	5:00	0	74	30	2	7	0	0	0	0	0	0	0	0	3	116
1/28/16	6:00	3	207	92	0	23	2	0	3	1	1	0	0	0	31	363
1/28/16	7:00	2	562	145	0	25	0	0	13	2	0	0	0	0	35	784
1/28/16	8:00	3	616	119	2	36	2	0	11	1	2	0	0	1	38	831
1/28/16	9:00	2	422	112	1	26	2	0	5	1	0	0	0	0	19	590
1/28/16	10:00	5	409	111	3	22	4	0	7	2	1	1	0	0	18	583
1/28/16	11:00	3	368	103	2	28	4	0	5	1	0	0	0	0	5	519

Total	102	13,769	3,290	33	651	55	5	211	36	19	9	0	3	549	18,732
Percent	1%	74%	18%	0%	3%	0%	0%	1%	0%	0%	0%	0%	0%	3%	



# Volume/Class Data - 48 Hours (hour increments)

Division: 03  
 County: NEW HANOVER  
 City: IN WILMINGTON  
 On Road: US 421 THIRD ST  
 Milepost: N/A

Contractor: Quality Counts, LLC  
 Count Number: 15-10208  
 Location: US 421 THIRD ST  
 RR Crossing No: 629446Y

Speed Limit: 35  
 Advisory Speed: N/A

Start Date: 1/26/16  
 Start Time (24-hour clock): 12:00

Date	Start Time	NB														
		1	2	3	4	5	6	7	8	9	10	11	12	13	Und.	Total
Day 1		53	6,932	1,675	17	327	25	1	108	16	11	6	0	1	270	9,442
Percent		1%	73%	18%	0%	3%	0%	0%	1%	0%	0%	0%	0%	0%	3%	
Day 2		49	6,837	1,615	16	324	30	4	103	20	8	3	0	2	279	9,290
Percent		1%	74%	17%	0%	3%	0%	0%	1%	0%	0%	0%	0%	0%	3%	
Average		51	6,885	1,645	17	326	28	3	106	18	10	5	0	2	275	9,366
Percent		1%	74%	18%	0%	3%	0%	0%	1%	0%	0%	0%	0%	0%	3%	

# Volume/Class Data - 48 Hours (hour increments)

Division: 03  
 County: NEW HANOVER  
 City: IN WILMINGTON  
 On Road: US 421 THIRD ST  
 Milepost: N/A

Contractor: Quality Counts, LLC  
 Count Number: 15-10208  
 Location: US 421 THIRD ST  
 RR Crossing No: 629446Y

Speed Limit: 35  
 Advisory Speed: N/A

Start Date: 1/26/16  
 Start Time (24-hour clock): 12:00

Date	Start Time	NB					
		PV	DUALS	TTST	TWINS	UNDEFINED	TOTAL
1/26/16	12:00	586	31	6	0	11	634
1/26/16	13:00	564	19	7	1	11	602
1/26/16	14:00	620	28	6	0	14	668
1/26/16	15:00	721	25	5	0	6	757
1/26/16	16:00	680	31	12	0	21	744
1/26/16	17:00	714	32	19	0	37	802
1/26/16	18:00	428	15	8	2	12	465
1/26/16	19:00	258	9	3	0	3	273
1/26/16	20:00	195	7	1	0	8	211
1/26/16	21:00	159	4	0	0	1	164
1/26/16	22:00	135	5	0	0	0	140
1/26/16	23:00	90	0	0	0	0	90
1/27/16	0:00	37	5	0	0	0	42
1/27/16	1:00	25	3	0	0	1	29
1/27/16	2:00	27	1	0	0	0	28
1/27/16	3:00	24	0	0	0	0	24
1/27/16	4:00	27	1	0	0	0	28
1/27/16	5:00	119	7	0	0	4	130
1/27/16	6:00	302	17	5	0	38	362
1/27/16	7:00	703	26	19	1	29	778
1/27/16	8:00	738	29	18	3	35	823
1/27/16	9:00	535	17	7	0	16	575
1/27/16	10:00	442	23	13	0	9	487
1/27/16	11:00	531	35	6	0	14	586
1/27/16	12:00	517	22	7	0	11	557
1/27/16	13:00	547	21	6	0	11	585

# Volume/Class Data - 48 Hours (hour increments)

Division: 03  
 County: NEW HANOVER  
 City: IN WILMINGTON  
 On Road: US 421 THIRD ST  
 Milepost: N/A

Contractor: Quality Counts, LLC  
 Count Number: 15-10208  
 Location: US 421 THIRD ST  
 RR Crossing No: 629446Y

Speed Limit: 35  
 Advisory Speed: N/A

Start Date: 1/26/16  
 Start Time (24-hour clock): 12:00

Date	Start Time	NB					
		PV	DUALS	TTST	TWINS	UNDEFINED	TOTAL
1/27/16	14:00	571	23	12	0	16	622
1/27/16	15:00	646	23	5	0	16	690
1/27/16	16:00	657	22	12	1	28	720
1/27/16	17:00	715	39	18	2	22	796
1/27/16	18:00	443	13	6	0	6	468
1/27/16	19:00	285	7	3	0	7	302
1/27/16	20:00	232	4	1	0	2	239
1/27/16	21:00	167	2	1	0	3	173
1/27/16	22:00	98	3	1	0	6	108
1/27/16	23:00	89	0	3	0	0	92
1/28/16	0:00	43	1	0	0	2	46
1/28/16	1:00	28	1	0	0	0	29
1/28/16	2:00	25	0	0	0	0	25
1/28/16	3:00	16	2	0	0	0	18
1/28/16	4:00	34	0	0	0	0	34
1/28/16	5:00	104	9	0	0	3	116
1/28/16	6:00	302	25	5	0	31	363
1/28/16	7:00	709	25	15	0	35	784
1/28/16	8:00	738	40	14	1	38	831
1/28/16	9:00	536	29	6	0	19	590
1/28/16	10:00	525	29	10	1	18	583
1/28/16	11:00	474	34	6	0	5	519

Total	17,161	744	266	12	549	18,732
Percent	92%	4%	1%	0%	3%	

# Volume/Class Data - 48 Hours (hour increments)

Division: 03  
 County: NEW HANOVER  
 City: IN WILMINGTON  
 On Road: US 421 THIRD ST  
 Milepost: N/A

Contractor: Quality Counts, LLC  
 Count Number: 15-10208  
 Location: US 421 THIRD ST  
 RR Crossing No: 629446Y

Speed Limit: 35  
 Advisory Speed: N/A

Start Date: 1/26/16  
 Start Time (24-hour clock): 12:00

Date	Start Time	NB					
		PV	DUALS	TTST	TWINS	UNDEFINED	TOTAL
Day 1		8,660	370	135	7	270	9,442
Percent		92%	4%	1%	0%	3%	
Day 2		8,501	374	131	5	279	9,290
Percent		92%	4%	1%	0%	3%	
Average		8,581	372	133	6	275	9,366
Percent		92%	4%	1%	0%	3%	

# Volume/Class Data - 48 Hours (hour increments)

Division: 03  
 County: NEW HANOVER  
 City: IN WILMINGTON  
 On Road: US 421 THIRD ST  
 Milepost: N/A

Contractor: Quality Counts, LLC  
 Count Number: 15-10208  
 Location: US 421 THIRD ST  
 RR Crossing No: 629446Y

Speed Limit: 35  
 Advisory Speed: N/A

Start Date: 1/26/16  
 Start Time (24-hour clock): 12:00

Date	Start Time	SB														
		1	2	3	4	5	6	7	8	9	10	11	12	13	Und.	Total
1/26/16	12:00	5	386	159	2	39	1	0	7	2	0	0	0	0	14	615
1/26/16	13:00	3	346	117	2	40	0	0	6	0	0	0	0	0	10	524
1/26/16	14:00	2	386	117	4	40	2	0	3	2	0	0	0	0	11	567
1/26/16	15:00	2	373	114	6	31	1	0	7	0	0	0	0	0	30	564
1/26/16	16:00	1	437	127	3	37	1	0	13	1	1	1	1	0	20	643
1/26/16	17:00	2	465	114	5	47	4	0	9	4	0	0	0	0	19	669
1/26/16	18:00	2	286	94	1	17	0	0	8	0	2	1	0	0	6	417
1/26/16	19:00	0	235	57	0	16	1	0	4	0	0	0	0	0	5	318
1/26/16	20:00	1	195	30	1	7	0	0	3	0	0	0	0	0	3	240
1/26/16	21:00	0	197	37	0	7	0	0	2	0	0	0	0	0	0	243
1/26/16	22:00	0	90	32	0	5	0	0	0	0	0	0	0	0	1	128
1/26/16	23:00	1	75	10	0	2	0	0	0	0	0	0	0	0	0	88
1/27/16	0:00	0	43	12	0	1	0	0	0	0	0	0	0	0	0	56
1/27/16	1:00	0	33	5	0	2	0	0	0	0	0	0	0	0	0	40
1/27/16	2:00	0	16	7	0	0	0	0	0	0	0	0	0	0	0	23
1/27/16	3:00	1	9	4	0	2	1	0	0	1	0	0	0	0	0	18
1/27/16	4:00	0	14	0	0	4	2	0	0	0	0	0	0	0	1	21
1/27/16	5:00	0	49	24	1	9	1	0	1	1	0	0	0	0	0	86
1/27/16	6:00	4	155	56	0	15	1	0	10	0	0	0	0	0	10	251
1/27/16	7:00	2	249	82	6	36	2	0	6	1	1	0	0	1	5	391
1/27/16	8:00	1	268	88	11	25	1	0	5	1	0	1	1	0	8	410
1/27/16	9:00	0	247	111	5	25	3	0	1	3	0	1	0	0	6	402
1/27/16	10:00	4	247	102	11	33	2	0	2	2	0	0	0	0	12	415
1/27/16	11:00	3	308	116	9	35	2	0	4	3	0	0	0	0	3	483
1/27/16	12:00	1	313	130	5	45	1	0	1	4	0	0	0	0	12	512
1/27/16	13:00	4	395	118	1	35	2	0	3	0	0	0	0	0	5	563

# Volume/Class Data - 48 Hours (hour increments)

Division: 03  
 County: NEW HANOVER  
 City: IN WILMINGTON  
 On Road: US 421 THIRD ST  
 Milepost: N/A

Contractor: Quality Counts, LLC  
 Count Number: 15-10208  
 Location: US 421 THIRD ST  
 RR Crossing No: 629446Y

Speed Limit: 35  
 Advisory Speed: N/A

Start Date: 1/26/16  
 Start Time (24-hour clock): 12:00

Date	Start Time	SB														
		1	2	3	4	5	6	7	8	9	10	11	12	13	Und.	Total
1/27/16	14:00	1	375	111	4	39	0	0	13	3	0	0	0	0	10	556
1/27/16	15:00	1	375	117	8	38	1	0	11	1	1	1	0	0	11	565
1/27/16	16:00	1	381	137	4	40	1	0	13	0	0	1	0	0	13	591
1/27/16	17:00	2	495	122	1	47	3	0	14	0	3	0	1	0	11	699
1/27/16	18:00	3	320	95	0	18	1	0	5	0	0	0	0	0	12	454
1/27/16	19:00	1	270	51	0	10	0	0	6	2	0	0	0	0	4	344
1/27/16	20:00	2	183	34	0	9	0	0	2	2	1	1	0	0	6	240
1/27/16	21:00	0	182	39	1	10	0	0	2	0	0	0	0	0	3	237
1/27/16	22:00	2	106	13	0	7	1	0	1	0	0	0	0	0	4	134
1/27/16	23:00	1	63	17	0	2	1	0	0	1	0	0	0	0	0	85
1/28/16	0:00	0	34	12	0	2	0	0	0	0	0	0	0	0	1	49
1/28/16	1:00	0	28	6	0	1	0	0	0	0	0	0	0	0	0	35
1/28/16	2:00	0	22	6	0	2	0	0	0	1	0	0	0	0	0	31
1/28/16	3:00	0	11	4	0	3	0	0	1	1	0	0	0	0	0	20
1/28/16	4:00	1	14	1	1	3	2	0	1	0	0	0	0	0	0	23
1/28/16	5:00	1	52	25	0	9	0	0	1	0	0	0	0	0	0	88
1/28/16	6:00	4	140	66	1	22	3	0	8	1	0	0	0	0	1	246
1/28/16	7:00	2	246	93	5	36	3	1	8	4	1	0	0	0	13	412
1/28/16	8:00	3	237	89	12	39	2	0	4	2	0	1	0	0	4	393
1/28/16	9:00	3	222	117	3	41	1	1	5	0	0	0	0	0	1	394
1/28/16	10:00	1	264	139	5	38	5	2	0	1	0	0	0	0	7	462
1/28/16	11:00	0	263	114	5	37	2	1	7	0	1	0	0	0	10	440

Total	68	10,100	3,271	123	1,008	54	5	197	44	11	8	3	1	292	15,185
Percent	0%	67%	22%	1%	7%	0%	0%	1%	0%	0%	0%	0%	0%	2%	

# Volume/Class Data - 48 Hours (hour increments)

Division: 03  
 County: NEW HANOVER  
 City: IN WILMINGTON  
 On Road: US 421 THIRD ST  
 Milepost: N/A

Contractor: Quality Counts, LLC  
 Count Number: 15-10208  
 Location: US 421 THIRD ST  
 RR Crossing No: 629446Y

Speed Limit: 35  
 Advisory Speed: N/A

Start Date: 1/26/16  
 Start Time (24-hour clock): 12:00

Date	Start Time	SB														
		1	2	3	4	5	6	7	8	9	10	11	12	13	Und.	Total
Day 1		34	5,109	1,615	67	475	25	0	91	21	4	4	2	1	164	7,612
Percent		0%	67%	21%	1%	6%	0%	0%	1%	0%	0%	0%	0%	0%	2%	
Day 2		34	4,991	1,656	56	533	29	5	106	23	7	4	1	0	128	7,573
Percent		0%	66%	22%	1%	7%	0%	0%	1%	0%	0%	0%	0%	0%	2%	
Average		34	5,050	1,636	62	504	27	3	99	22	6	4	2	1	146	7,593
Percent		0%	67%	22%	1%	7%	0%	0%	1%	0%	0%	0%	0%	0%	2%	



# Volume/Class Data - 48 Hours (hour increments)

Division: 03  
 County: NEW HANOVER  
 City: IN WILMINGTON  
 On Road: US 421 THIRD ST  
 Milepost: N/A

Contractor: Quality Counts, LLC  
 Count Number: 15-10208  
 Location: US 421 THIRD ST  
 RR Crossing No: 629446Y

Speed Limit: 35  
 Advisory Speed: N/A

Start Date: 1/26/16  
 Start Time (24-hour clock): 12:00

Date	Start Time	SB					
		PV	DUALS	TTST	TWINS	UNDEFINED	TOTAL
1/26/16	12:00	550	42	9	0	14	615
1/26/16	13:00	466	42	6	0	10	524
1/26/16	14:00	505	46	5	0	11	567
1/26/16	15:00	489	38	7	0	30	564
1/26/16	16:00	565	41	15	2	20	643
1/26/16	17:00	581	56	13	0	19	669
1/26/16	18:00	382	18	10	1	6	417
1/26/16	19:00	292	17	4	0	5	318
1/26/16	20:00	226	8	3	0	3	240
1/26/16	21:00	234	7	2	0	0	243
1/26/16	22:00	122	5	0	0	1	128
1/26/16	23:00	86	2	0	0	0	88
1/27/16	0:00	55	1	0	0	0	56
1/27/16	1:00	38	2	0	0	0	40
1/27/16	2:00	23	0	0	0	0	23
1/27/16	3:00	14	3	1	0	0	18
1/27/16	4:00	14	6	0	0	1	21
1/27/16	5:00	73	11	2	0	0	86
1/27/16	6:00	215	16	10	0	10	251
1/27/16	7:00	333	44	8	1	5	391
1/27/16	8:00	357	37	6	2	8	410
1/27/16	9:00	358	33	4	1	6	402
1/27/16	10:00	353	46	4	0	12	415
1/27/16	11:00	427	46	7	0	3	483
1/27/16	12:00	444	51	5	0	12	512
1/27/16	13:00	517	38	3	0	5	563

# Volume/Class Data - 48 Hours (hour increments)

Division: 03  
 County: NEW HANOVER  
 City: IN WILMINGTON  
 On Road: US 421 THIRD ST  
 Milepost: N/A

Contractor: Quality Counts, LLC  
 Count Number: 15-10208  
 Location: US 421 THIRD ST  
 RR Crossing No: 629446Y

Speed Limit: 35  
 Advisory Speed: N/A

Start Date: 1/26/16  
 Start Time (24-hour clock): 12:00

Date	Start Time	SB					
		PV	DUALS	TTST	TWINS	UNDEFINED	TOTAL
1/27/16	14:00	487	43	16	0	10	556
1/27/16	15:00	493	47	13	1	11	565
1/27/16	16:00	519	45	13	1	13	591
1/27/16	17:00	619	51	17	1	11	699
1/27/16	18:00	418	19	5	0	12	454
1/27/16	19:00	322	10	8	0	4	344
1/27/16	20:00	219	9	5	1	6	240
1/27/16	21:00	221	11	2	0	3	237
1/27/16	22:00	121	8	1	0	4	134
1/27/16	23:00	81	3	1	0	0	85
1/28/16	0:00	46	2	0	0	1	49
1/28/16	1:00	34	1	0	0	0	35
1/28/16	2:00	28	2	1	0	0	31
1/28/16	3:00	15	3	2	0	0	20
1/28/16	4:00	16	6	1	0	0	23
1/28/16	5:00	78	9	1	0	0	88
1/28/16	6:00	210	26	9	0	1	246
1/28/16	7:00	341	45	13	0	13	412
1/28/16	8:00	329	53	6	1	4	393
1/28/16	9:00	342	46	5	0	1	394
1/28/16	10:00	404	50	1	0	7	462
1/28/16	11:00	377	45	8	0	10	440

Total	13,439	1,190	252	12	292	15,185
Percent	89%	8%	2%	0%	2%	

# Volume/Class Data - 48 Hours (hour increments)

Division: 03  
 County: NEW HANOVER  
 City: IN WILMINGTON  
 On Road: US 421 THIRD ST  
 Milepost: N/A

Contractor: Quality Counts, LLC  
 Count Number: 15-10208  
 Location: US 421 THIRD ST  
 RR Crossing No: 629446Y

Speed Limit: 35  
 Advisory Speed: N/A

Start Date: 1/26/16  
 Start Time (24-hour clock): 12:00

Date	Start Time	SB					
		PV	DUALS	TTST	TWINS	UNDEFINED	TOTAL
Day 1		6,758	567	116	7	164	7,612
Percent		89%	7%	2%	0%	2%	
Day 2		6,681	623	136	5	128	7,573
Percent		88%	8%	2%	0%	2%	
Average		6,720	595	126	6	146	7,593
Percent		89%	8%	2%	0%	2%	

### Volume/Class Data - 48 Hours (hour increments)

Division: 03  
 County: NEW HANOVER  
 City: IN WILMINGTON  
 On Road: US 421 THIRD ST  
 Milepost: N/A

Contractor: Quality Counts, LLC  
 Count Number: 15-10208  
 Location: US 421 THIRD ST  
 RR Crossing No: 629446Y

Speed Limit: 35  
 Advisory Speed: N/A

Start Date: 1/26/16  
 Start Time (24-hour clock): 12:00

Date	Start Time	TOTAL														
		1	2	3	4	5	6	7	8	9	10	11	12	13	Und.	Total
1/26/16	12:00	12	863	261	3	68	2	0	12	3	0	0	0	0	25	1,249
1/26/16	13:00	12	769	249	2	57	2	0	12	1	0	1	0	0	21	1,126
1/26/16	14:00	5	871	249	4	66	4	0	9	2	0	0	0	0	25	1,235
1/26/16	15:00	6	938	266	7	53	3	0	10	2	0	0	0	0	36	1,321
1/26/16	16:00	5	994	246	4	66	2	0	20	4	3	1	1	0	41	1,387
1/26/16	17:00	6	1,058	231	5	75	8	0	23	4	5	0	0	0	56	1,471
1/26/16	18:00	2	636	172	2	30	1	0	16	0	2	3	0	0	18	882
1/26/16	19:00	1	449	100	0	25	1	0	6	1	0	0	0	0	8	591
1/26/16	20:00	1	355	65	1	14	0	0	4	0	0	0	0	0	11	451
1/26/16	21:00	0	332	61	0	10	1	0	2	0	0	0	0	0	1	407
1/26/16	22:00	0	202	55	0	10	0	0	0	0	0	0	0	0	1	268
1/26/16	23:00	3	150	23	0	2	0	0	0	0	0	0	0	0	0	178
1/27/16	0:00	0	73	19	0	5	1	0	0	0	0	0	0	0	0	98
1/27/16	1:00	0	51	12	0	4	1	0	0	0	0	0	0	0	1	69
1/27/16	2:00	0	38	12	1	0	0	0	0	0	0	0	0	0	0	51
1/27/16	3:00	1	28	9	0	2	1	0	0	1	0	0	0	0	0	42
1/27/16	4:00	1	33	7	0	4	3	0	0	0	0	0	0	0	1	49
1/27/16	5:00	0	135	57	2	15	1	0	1	1	0	0	0	0	4	216
1/27/16	6:00	7	379	131	0	31	2	0	15	0	0	0	0	0	48	613
1/27/16	7:00	3	813	220	7	58	5	0	23	1	3	0	0	2	34	1,169
1/27/16	8:00	7	884	204	13	50	2	1	20	3	1	4	1	0	43	1,233
1/27/16	9:00	2	674	217	5	41	4	0	8	3	0	1	0	0	22	977
1/27/16	10:00	7	584	204	14	52	3	0	10	6	1	0	0	0	21	902
1/27/16	11:00	6	732	220	14	64	3	0	8	5	0	0	0	0	17	1,069
1/27/16	12:00	2	716	243	7	61	4	1	6	5	1	0	0	0	23	1,069
1/27/16	13:00	9	817	238	1	54	2	2	8	0	1	0	0	0	16	1,148

# Volume/Class Data - 48 Hours (hour increments)

Division: 03  
 County: NEW HANOVER  
 City: IN WILMINGTON  
 On Road: US 421 THIRD ST  
 Milepost: N/A

Contractor: Quality Counts, LLC  
 Count Number: 15-10208  
 Location: US 421 THIRD ST  
 RR Crossing No: 629446Y

Speed Limit: 35  
 Advisory Speed: N/A

Start Date: 1/26/16  
 Start Time (24-hour clock): 12:00

Date	Start Time	TOTAL														
		1	2	3	4	5	6	7	8	9	10	11	12	13	Und.	Total
1/27/16	14:00	5	831	222	5	58	2	1	22	6	0	0	0	0	26	1,178
1/27/16	15:00	3	902	234	9	58	3	0	15	2	1	1	0	0	27	1,255
1/27/16	16:00	2	912	262	4	58	5	0	22	2	1	2	0	0	41	1,311
1/27/16	17:00	5	1,109	220	2	81	7	0	29	2	4	1	1	1	33	1,495
1/27/16	18:00	5	686	170	0	31	1	0	11	0	0	0	0	0	18	922
1/27/16	19:00	2	508	97	0	17	0	0	8	3	0	0	0	0	11	646
1/27/16	20:00	4	384	63	0	13	0	0	3	2	1	1	0	0	8	479
1/27/16	21:00	1	325	62	1	12	0	0	3	0	0	0	0	0	6	410
1/27/16	22:00	5	190	24	0	10	1	0	1	1	0	0	0	0	10	242
1/27/16	23:00	1	137	32	0	2	1	0	2	2	0	0	0	0	0	177
1/28/16	0:00	2	72	15	0	3	0	0	0	0	0	0	0	0	3	95
1/28/16	1:00	1	54	7	0	1	1	0	0	0	0	0	0	0	0	64
1/28/16	2:00	1	43	9	0	2	0	0	0	1	0	0	0	0	0	56
1/28/16	3:00	0	24	7	1	4	0	0	1	1	0	0	0	0	0	38
1/28/16	4:00	3	36	11	1	3	2	0	1	0	0	0	0	0	0	57
1/28/16	5:00	1	126	55	2	16	0	0	1	0	0	0	0	0	3	204
1/28/16	6:00	7	347	158	1	45	5	0	11	2	1	0	0	0		577
1/28/16	7:00	4	808	238	5	61	3	1	21	6	1	0	0	0	48	1,196
1/28/16	8:00	6	853	208	14	75	4	0	15	3	2	1	0	1	42	1,224
1/28/16	9:00	5	644	229	4	67	3	1	10	1	0	0	0	0	20	984
1/28/16	10:00	6	673	250	8	60	9	2	7	3	1	1	0	0	25	1,045
1/28/16	11:00	3	631	217	7	65	6	1	12	1	1	0	0	0	15	959

Total	170	23,869	6,561	156	1,659	109	10	408	80	30	17	3	4	809	33,885
Percent	1%	70%	19%	0%	5%	0%	0%	1%	0%	0%	0%	0%	0%	2%	

# Volume/Class Data - 48 Hours (hour increments)

Division: 03  
 County: NEW HANOVER  
 City: IN WILMINGTON  
 On Road: US 421 THIRD ST  
 Milepost: N/A

Contractor: Quality Counts, LLC  
 Count Number: 15-10208  
 Location: US 421 THIRD ST  
 RR Crossing No: 629446Y

Speed Limit: 35  
 Advisory Speed: N/A

Start Date: 1/26/16  
 Start Time (24-hour clock): 12:00

Date	Start Time	TOTAL															
		1	2	3	4	5	6	7	8	9	10	11	12	13	Und.	Total	
Day 1		87	12,041	3,290	84	802	50	1	199	37	15	10	2	2	434	17,054	
Percent		1%	71%	19%	0%	5%	0%	0%	1%	0%	0%	0%	0%	0%	3%		
Day 2		83	11,828	3,271	72	857	59	9	209	43	15	7	1	2	375	16,831	
Percent		0%	70%	19%	0%	5%	0%	0%	1%	0%	0%	0%	0%	0%	2%		
Average		85	11,935	3,281	78	830	55	5	204	40	15	9	2	2	405	#####	
Percent		1%	70%	19%	0%	5%	0%	0%	1%	0%	0%	0%	0%	0%	2%		

# Volume/Class Data - 48 Hours (hour increments)

Division: 03  
 County: NEW HANOVER  
 City: IN WILMINGTON  
 On Road: US 421 THIRD ST  
 Milepost: N/A

Contractor: Quality Counts, LLC  
 Count Number: 15-10208  
 Location: US 421 THIRD ST  
 RR Crossing No: 629446Y

Speed Limit: 35  
 Advisory Speed: N/A

Start Date: 1/26/16  
 Start Time (24-hour clock): 12:00

Date	Start Time	TOTAL					
		PV	DUALS	TTST	TWINS	UNDEFINED	TOTAL
1/26/16	12:00	1,136	73	15	0	25	1,249
1/26/16	13:00	1,030	61	13	1	21	1,126
1/26/16	14:00	1,125	74	11	0	25	1,235
1/26/16	15:00	1,210	63	12	0	36	1,321
1/26/16	16:00	1,245	72	27	2	41	1,387
1/26/16	17:00	1,295	88	32	0	56	1,471
1/26/16	18:00	810	33	18	3	18	882
1/26/16	19:00	550	26	7	0	8	591
1/26/16	20:00	421	15	4	0	11	451
1/26/16	21:00	393	11	2	0	1	407
1/26/16	22:00	257	10	0	0	1	268
1/26/16	23:00	176	2	0	0	0	178
1/27/16	0:00	92	6	0	0	0	98
1/27/16	1:00	63	5	0	0	1	69
1/27/16	2:00	50	1	0	0	0	51
1/27/16	3:00	38	3	1	0	0	42
1/27/16	4:00	41	7	0	0	1	49
1/27/16	5:00	192	18	2	0	4	216
1/27/16	6:00	517	33	15	0	48	613
1/27/16	7:00	1,036	70	27	2	34	1,169
1/27/16	8:00	1,095	66	24	5	43	1,233
1/27/16	9:00	893	50	11	1	22	977
1/27/16	10:00	795	69	17	0	21	902
1/27/16	11:00	958	81	13	0	17	1,069
1/27/16	12:00	961	73	12	0	23	1,069
1/27/16	13:00	1,064	59	9	0	16	1,148



# Volume/Class Data - 48 Hours (hour increments)

Division: 03  
 County: NEW HANOVER  
 City: IN WILMINGTON  
 On Road: US 421 THIRD ST  
 Milepost: N/A

Contractor: Quality Counts, LLC  
 Count Number: 15-10208  
 Location: US 421 THIRD ST  
 RR Crossing No: 629446Y

Speed Limit: 35  
 Advisory Speed: N/A

Start Date: 1/26/16  
 Start Time (24-hour clock): 12:00

Date	Start Time	TOTAL					
		PV	DUALS	TTST	TWINS	UNDEFINED	TOTAL
1/27/16	14:00	1,058	66	28	0	26	1,178
1/27/16	15:00	1,139	70	18	1	27	1,255
1/27/16	16:00	1,176	67	25	2	41	1,311
1/27/16	17:00	1,334	90	35	3	33	1,495
1/27/16	18:00	861	32	11	0	18	922
1/27/16	19:00	607	17	11	0	11	646
1/27/16	20:00	451	13	6	1	8	479
1/27/16	21:00	388	13	3	0	6	410
1/27/16	22:00	219	11	2	0	10	242
1/27/16	23:00	170	3	4	0	0	177
1/28/16	0:00	89	3	0	0	3	95
1/28/16	1:00	62	2	0	0	0	64
1/28/16	2:00	53	2	1	0	0	56
1/28/16	3:00	31	5	2	0	0	38
1/28/16	4:00	50	6	1	0	0	57
1/28/16	5:00	182	18	1	0	3	204
1/28/16	6:00	512	51	14	0	32	609
1/28/16	7:00	1,050	70	28	0	0	1,148
1/28/16	8:00	1,067	93	20	2	42	1,224
1/28/16	9:00	878	75	11	0	20	984
1/28/16	10:00	929	79	11	1	25	1,045
1/28/16	11:00	851	79	14	0	15	959

Total	30,600	1,934	518	24	793	33,869
Percent	90%	6%	2%	0%	2%	

# Volume/Class Data - 48 Hours (hour increments)

Division: 03  
 County: NEW HANOVER  
 City: IN WILMINGTON  
 On Road: US 421 THIRD ST  
 Milepost: N/A

Contractor: Quality Counts, LLC  
 Count Number: 15-10208  
 Location: US 421 THIRD ST  
 RR Crossing No: 629446Y

Speed Limit: 35  
 Advisory Speed: N/A

Start Date: 1/26/16  
 Start Time (24-hour clock): 12:00

Date	Start Time	TOTAL					
		PV	DUALS	TTST	TWINS	UNDEFINED	TOTAL
Day 1		15,418	937	251	14	434	17,054
Percent		90%	5%	1%	0%	3%	
Day 2		15,182	997	267	10	359	16,815
Percent		90%	6%	2%	0%	2%	
Average		15,300	967	259	12	397	16,935
Percent		90%	6%	2%	0%	2%	